

# Planning process

We are following a combination of planning pathways for the Wee Waa High School redevelopment. This approach is often used to make the planning process faster and more efficient.



Artist impression of Wee Waa High School

## Indicative timeline

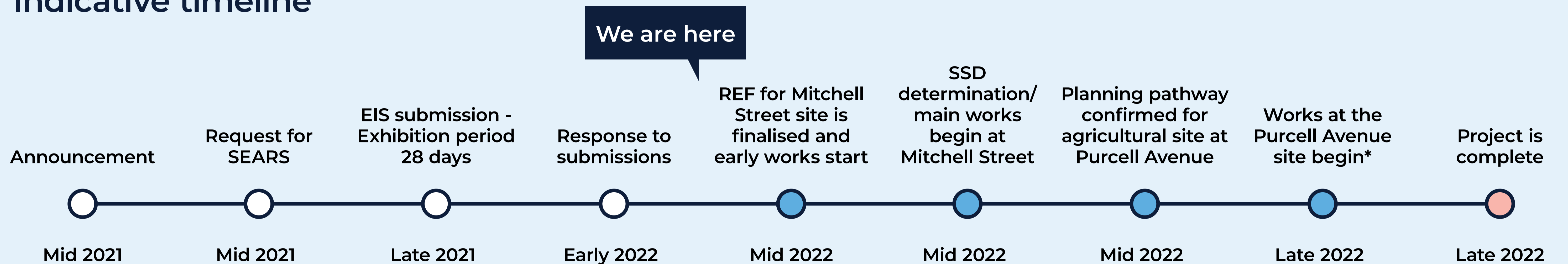

\*Subject to planning and weather conditions

## Wee Waa High School redevelopment

# Early works

## Mitchell Street site

Open drainage channels run through the proposed site, which retains water due to natural elevation. The solution to ensure the site is suitable for construction includes a landscaped stormwater flow channel along the southern and western boundaries of the site, and site grading.

The soil excavated from these channels will be used to elevate and level the site, this will ensure that stormwater can flow towards the new and upgraded stormwater infrastructure.

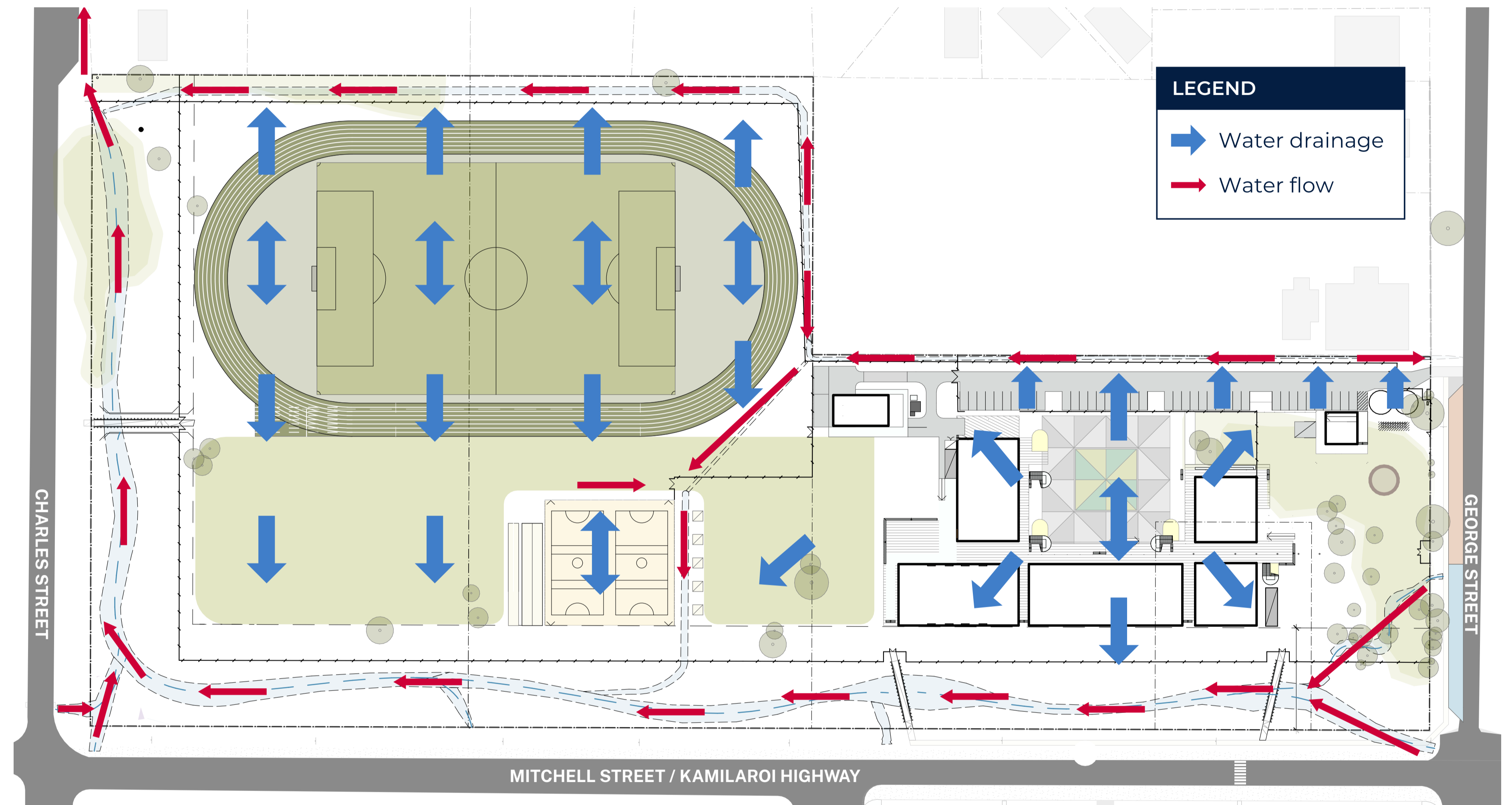

## Wee Waa High School redevelopment

For more information phone: 1300 482 651  
Email: [schoolinfrastructure@det.nsw.edu.au](mailto:schoolinfrastructure@det.nsw.edu.au)

# Early works

## Drainage towards Namoi River

We will be upgrading the stormwater drainage system to ensure water can flow to be discharged in the Namoi River. Existing pipes running from the proposed school site under Charles Street towards Boundary Street will be replaced with pipes double in size.

The existing engineered channel that carries water from Boundary Street towards the Namoi River will be lowered and upgraded, pipes that carry water underneath the town levee and a walking track outside of the levee will also be doubled in size. An additional flood evacuation pump will be installed at the town levee.

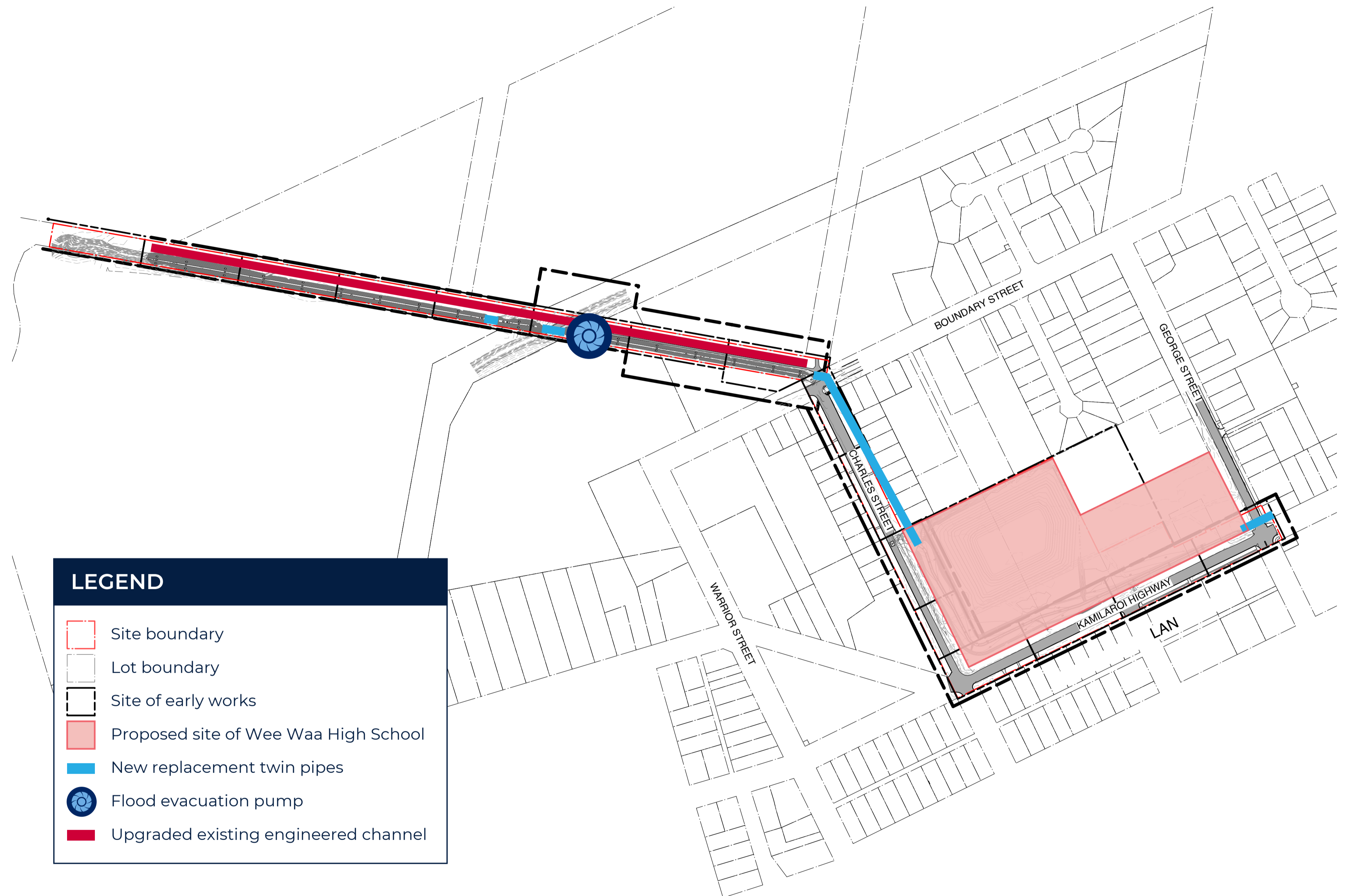

## Wee Waa High School redevelopment

For more information phone: 1300 482 651  
Email: schoolinfrastructure@det.nsw.edu.au

# The design

Some changes have been made to the proposed design of the new school. The car parking has been relocated from the western boundary and joined with the internal access road from George Street. The Internal access road width was increased to allow 2-way travel and the Indigenous Cultural Centre was shifted south to accommodate this change.

Changes to the landscape design include screening fencing along the northern side, maximising native species along the eastern side of the site as well as removing of two extra trees to facilitate access. Removed trees will be replaced and additional trees will be planted throughout the site. When mature, the new trees will increase the canopy cover from 2,000sqm to 4,700sqm; an area approximately the size of 18 full size tennis courts.

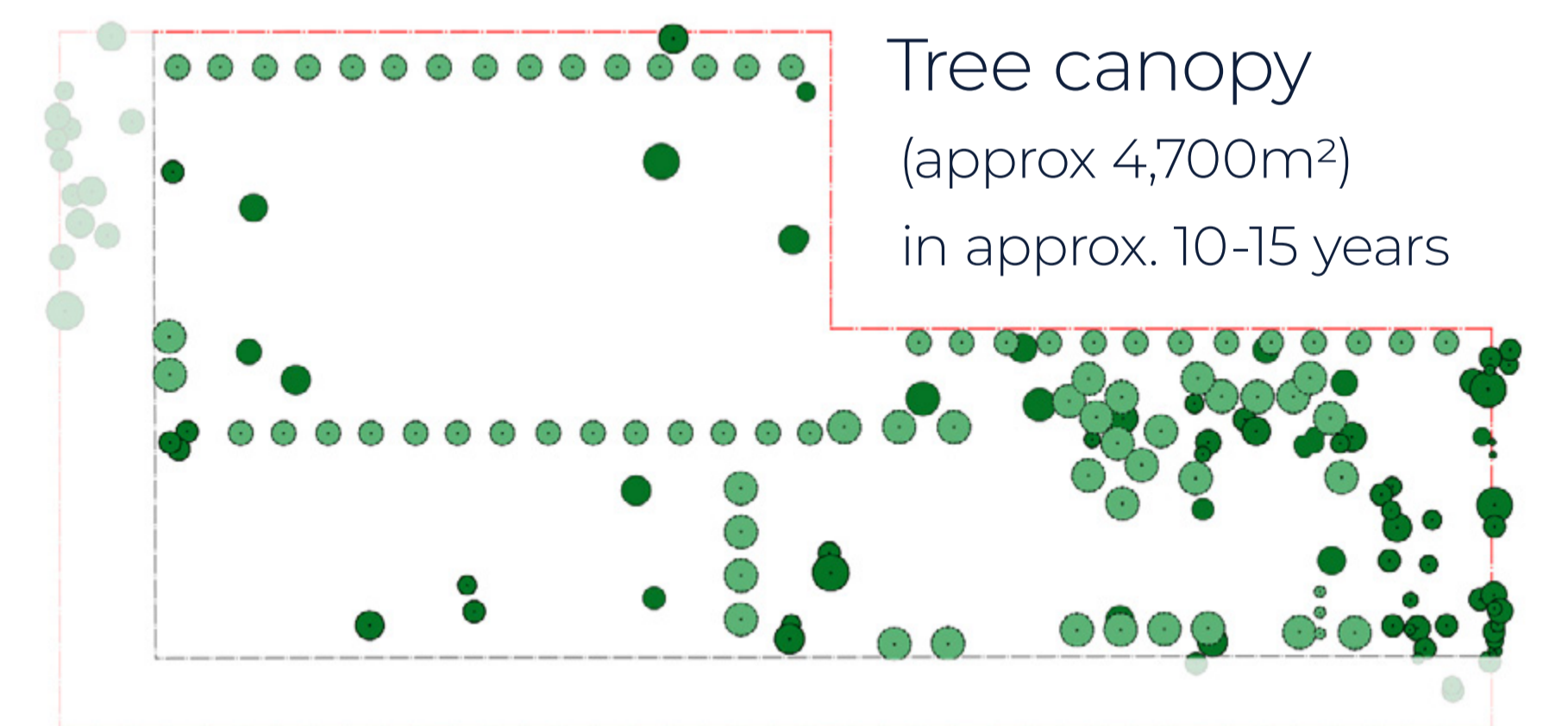
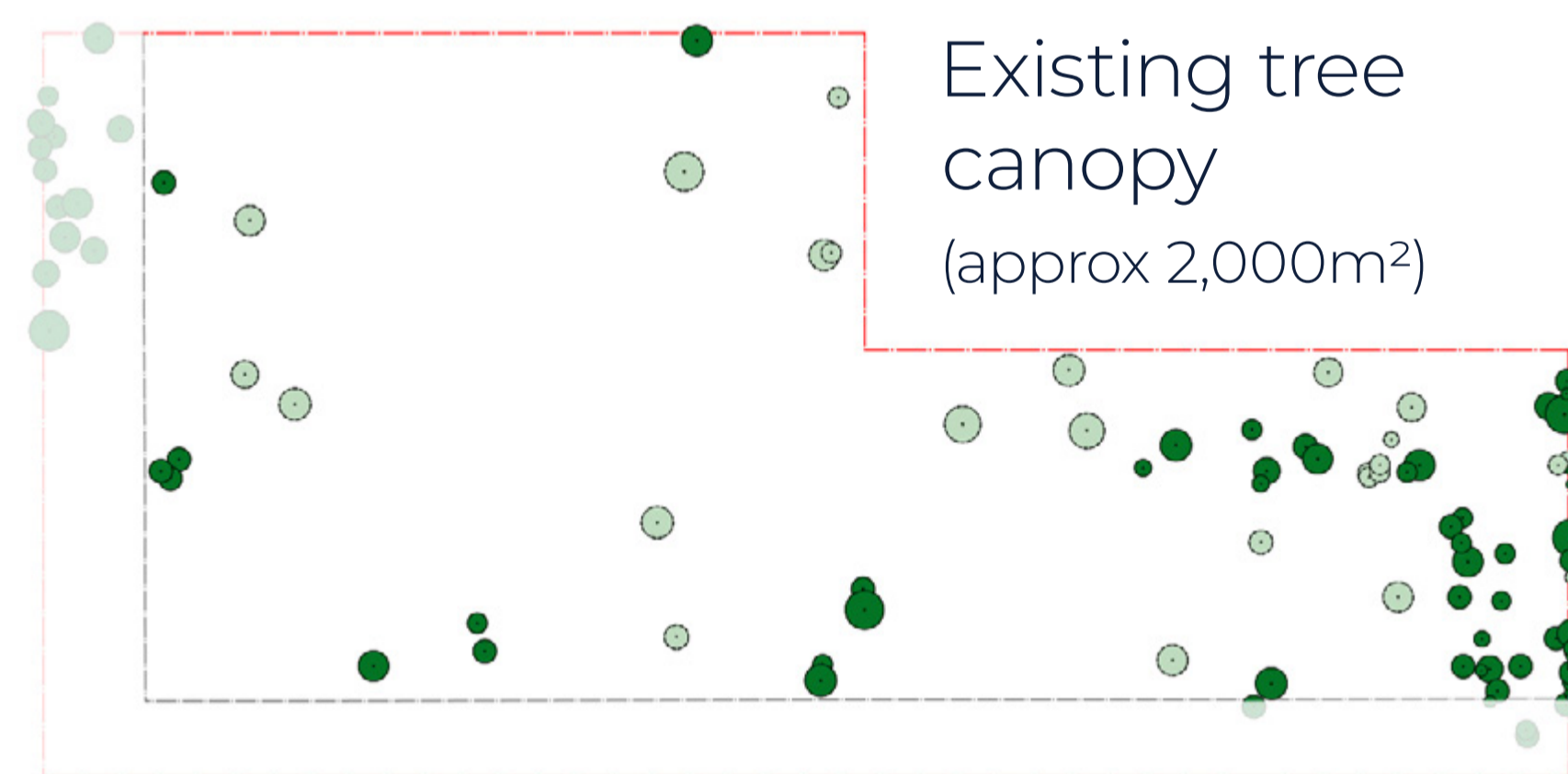
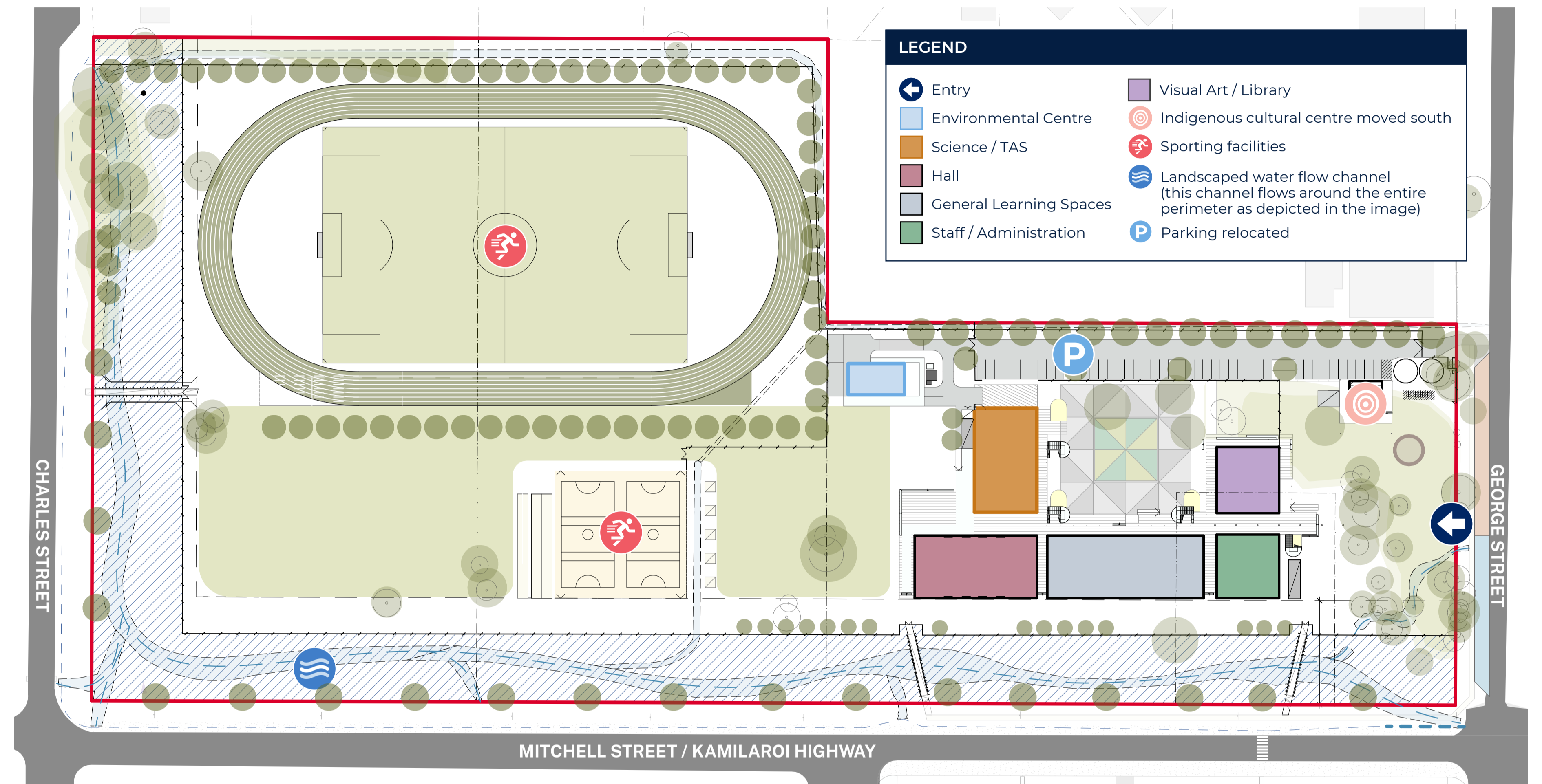

## Wee Waa High School redevelopment

For more information phone: 1300 482 651  
Email: schoolinfrastructure@det.nsw.edu.au

# Collaboration with our students

Our students are the most important stakeholders and capturing their ideas, aspirations and knowledge is a key element of our work.

We have held presentations with students of both schools who had the opportunity to ask questions about the project and voice their opinions.

The project team received valuable feedback which has been adopted into the design, where possible.

We will continue to look for opportunities to involve our students as we deliver their new school.



Artist Impression of library interior looking north to double height space and out to exterior walkways and courtyard

## Wee Waa High School redevelopment

# Connecting with country

Guided by the principles of the NSW Government's Connecting with Country Framework, we aim to ensure that the strength, diversity and richness of local Aboriginal cultures and Custodianship of Country are respected, valued and embedded throughout the design of the new high school.

To achieve this, we are conducting a series of workshops that invite local Gomeroi community, the broader community and our student representatives to share on the best way to reflect Wee Waa's Gomeroi heritage in the design.

The workshops are also attended by the project's architect SHAC who will work with local Aboriginal community members to incorporate the outcomes into the final design.



Artist impression of the new Indigenous Learning Centre

This artwork was created by Suzanna for the Department of Education's Reconciliation Action Plan. Suzanna is a student at Boggabilla Central School which is on Kamilaroi Country near the Queensland border in the north west of NSW. The artwork expresses the themes of community, school, friendship and family.

## Wee Waa High School redevelopment

# Offsite manufacture and onsite assembly

The construction approach uses kit of parts. This is where standardised building components including floor systems, panelised walls, roofs, beams, columns, facades, joinery and services for all room types are manufactured offsite and the parts are assembled at the school site.

## There are many benefits to these modern construction methods



We save time – it's around 30 per cent faster on the construction site.



There are great sustainability gains, including reduced carbon emissions, material waste and water waste on sites.



We are making a social impact, creating new jobs, expanding opportunities for local training and upskilling and harnessing inherent productivity and safety gains to improve working conditions in the construction industry.



It's safer to manufacture building parts in purpose-built spaces and the assembly requires less interface on sites.



Offsite manufacturing and onsite assembly means less noise, less dust, less traffic and less disruption.

## Wee Waa High School redevelopment

For more information phone: 1300 482 651  
Email: [schoolinfrastructure@det.nsw.edu.au](mailto:schoolinfrastructure@det.nsw.edu.au)