

# WEE WAA HIGH SCHOOL SSD CIVIL & STORMWATER

## ISSUED FOR REVIEW

Sheet List Table		
DWG	Sheet Title	REV
C1.01	Cover Sheet	1
C3.01	Bulk Earthworks Plan	1
C3.02	Bulk Earthworks Cut & Fill Plan	1
C3.10	Site Layout Plan	1
C3.11	Fill Pad School Buildings Section A-A	1
C3.12	Fill Pad Oval Section B-B	1
C3.13	Fill Pad Oval CH00.00 to CH182.41	1
C6.01	Stormwater Layout Plan - Sheet 1	1
C6.02	Stormwater Layout Plan - Sheet 2	1
C6.03	Stormwater Layout Plan - Sheet 3	1
C6.04	Stormwater Layout Plan - Sheet 4	1
C6.05	Stormwater Layout Plan - Sheet 5	1
C6.11	Stormwater Channel 2 & 3 Longitudinal Section	1
C6.21	Stormwater Channel 2 CH00.00 to CH50.00	1
C6.22	Stormwater Channel 3 CH00.00 to CH183.93	1
C6.31	Stormwater Pit Schedule	1

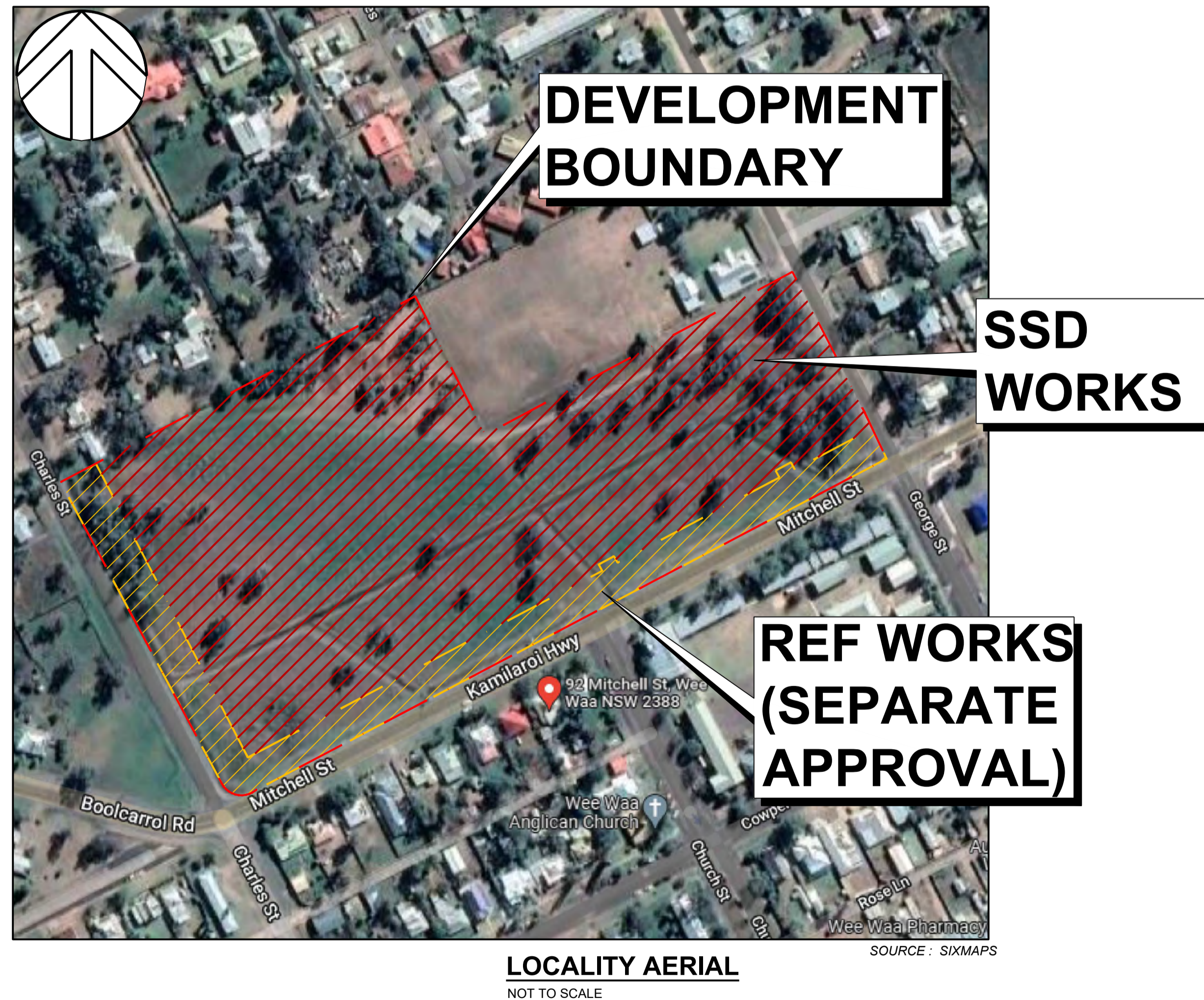

LOCALITY AERIAL  
NOT TO SCALE

CLIENT  
NSW GOVERNMENT

PROJECT MANAGER  
Built

ARCHITECT  
SHAC

Warren Smith  
Consulting Engineers

WARREN SMITH CONSULTING ENGINEERS PTY LTD

ACN 002 197 088 | ABN 36 300 430 126 | [wsp@warrensmith.com.au](mailto:wsp@warrensmith.com.au)

SINCE 1981.

NSW Level 9, 233 Castlereagh St Sydney 2000 NSW Australia | VIC Level 20/485 La Trobe St Melbourne 3000 Vic Australia

Hydraulic Fire Civil Utilities Infrastructure | [www.warrensmith.com.au](http://www.warrensmith.com.au) | PH +61 (2) 9299 1312 | PH +61 (3) 8648 9942

GLOBAL COMPLIANCE CERTIFICATION  
GCC  
ISO 9001 Certified

Serving the Construction Industry since 1981.

TITLE  
COVER SHEET

SCALE AS SHOWN	DRAWN N.G.	DESIGNED R.X.	CHECKED J.G.	APPROVED --
JOB No. 7490000	DRAWING No. C1.01		ISSUE 1	
DATE MARCH 2022	STATUS ISSUED FOR REVIEW			

Plot Date: 23/08/2022 11:53:07; Log Name: NSG.ctb; Client File: \\D:\01\WSP\LOCAL\wsp\160000\Drawings\AutoCAD\Drawings\2022\Issue for Review\C1.01 Cover Sheet.dwg







LEGEND	
---	SITE BOUNDARY
—	NATURAL SURFACE CONTOUR
---	DEPTH CONTOUR
---	TOP OF BATTER
---	BOTTOM OF BATTER
	APPROXIMATE EXTENT OF NATURAL GROUND LEVELS TO BE MAINTAINED

**NOTE:**

- VOLUMES ARE PRELIMINARY ONLY AND IS SUBJECT TO CHANGE. CONTRACTOR TO CONFIRM BULK EARTHWORKS VOLUMES AND LEVELS BASED ON THEIR OWN ASSUMPTIONS AND CALCULATIONS. THE FOLLOWING DEPTH PROFILES WERE ADOPTED FOR THE BULK EARTHWORKS.
  - ASSUMED CONCRETE STRUCTURAL SLABS (SLAB ON GROUND TBC BY THE STRUCTURAL ENGINEER) 350 mm
  - RIGID (CONCRETE) PAVEMENT THICKNESS 400 mm
  - FOOTPATHS 220 mm
  - LANDSCAPING TOP SOIL - 300 mm (TBC BY THE LANDSCAPE ARCHITECT)
  - FLEXIBLE PAVEMENT THICKNESS - 500 mm
- VOLUMES FROM PIPE TRENCH HAVE NOT BEEN INCLUDED IN THESE CALCULATIONS.
- TOP SOIL STRIPPING & REMOVAL - 300 mm, TOP SOIL STRIPPING EXTENDED TO NATURAL CLAY OR CLAYEY SAND SOIL IN ACCORDANCE WITH BARNSON PTY. LTD. REPORT 35754-GR01\_A, DATED 14/04/2021
- TEMPORARY BATTERS ASSUMED TO BE 1 in 2.
- BULKING FACTORS HAVE NOT BEEN INCLUDED.
- ALLOW A +/-15% TOLERANCE FOR THESE VOLUMES.
- EXTENT OF CUTTING/FILLING IN THE VICINITY OF EXISTING TREES SHALL BE CONFIRMED BY THE PROJECT ARBORIST.
- TREE PROTECTION ZONES TO BE CONFIRMED BY THE PROJECT ARBORIST.
- NO ALLOWANCE HAS BEEN MADE IN THE BULK EARTHWORKS CALCULATION FOR THE PURPOSE OF REMEDIATION WORKS. IF REQUIRED, CONTRACTOR TO ENSURE ALL ALLOWANCES HAS BEEN MADE TO UNDERTAKE ANY REMEDIATION WORKS.

**BULK EARTHWORKS SUMMARY 1: SSD WORKS**  
 NOTE: BULK EARTHWORKS COMPARISON BETWEEN SSD WORKS AND REF WORKS (SEPARATE APPROVAL)

CUT 9,350 m<sup>3</sup>  
 FILL 9,310 m<sup>3</sup>  
 NET 40 m<sup>3</sup> (REMOVAL)

TOTAL 40 m<sup>3</sup> (REMOVAL)

NOTE: PRELIMINARY BULK EARTHWORKS SUMMARY TO BE FURTHER REVIEWED AND DEVELOPED DURING THE DETAILS DESIGN STAGE

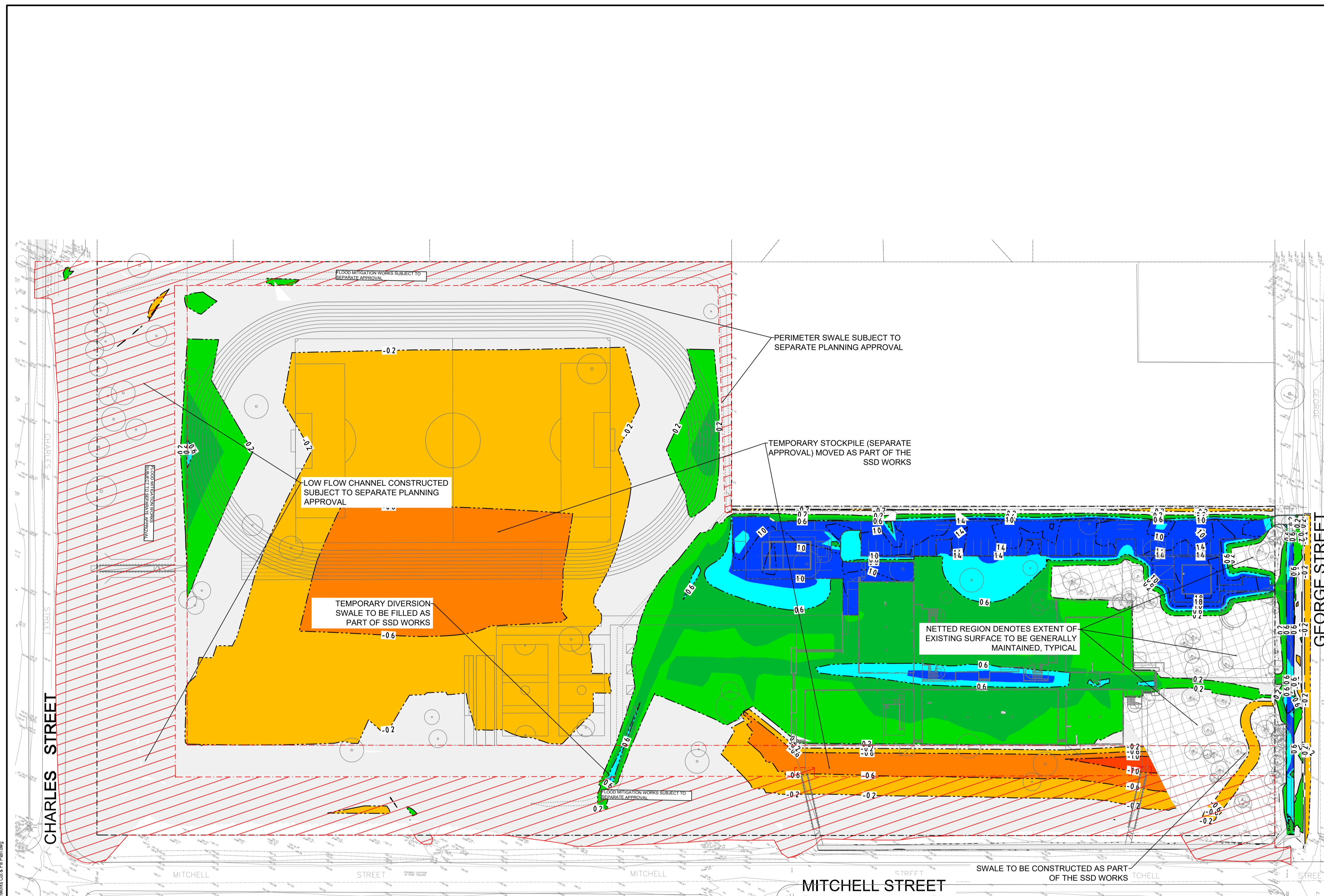

PRELIMINARY - NOT FOR CONSTRUCTION

Levels Table			
No.	From Depth	To Depth	Colour
1	-2.000	-1.500	Red
2	-1.500	-1.000	Orange
3	-1.000	-0.600	Yellow
4	-0.600	-0.200	Light Green
5	-0.200	0.000	White
6	0.000	0.200	Light Blue
7	0.200	0.400	Green
8	0.400	0.600	Dark Green
9	0.600	0.800	Cyan
10	0.800	1.900	Blue

DO NOT SCALE FROM DRAWINGS, CHECK & VERIFY ALL DIMENSIONS & LEVELS BEFORE COMMENCEMENT OF ANY WORK.

THIS DRAWING IS NOT TO BE COPIED IN PART OR WHOLE WITHOUT WRITTEN PERMISSION FROM WARREN SMITH CONSULTING ENGINEERS.

**DRAWING COLOUR CODED - PRINT ALL COPIES IN COLOUR**

**NORTH**

12.5 0 5 10 15 20 25m  
 PLAN SCALE 1:750 A1 SHEET

REVISION	AMENDMENT	DATE	REVISION	AMENDMENT	DATE
1	ISSUE FOR REVIEW	22/06/22			

CLIENT

**Built**

PROJECT

**WEE WAA HIGH SCHOOL SSD**

PREPARED BY

**Warren Smith Consulting Engineers**

WARREN SMITH CONSULTING ENGINEERS  
 SINCE 1981.

NSW 9/233 Castlereagh St. VIC Suite 7.03, 365 Little Collins St  
 Sydney 2000 NSW Australia Melbourne 3000 VIC Australia

PH +61 (2) 9299 1312 PH +61 (3) 8648 9942

www.warrensmith.com.au  
 wsp@warrensmith.com.au

ACN 002 197 088 ABN 36 300 430 126

Hydraulic Fire Civil Utilities Infrastructure

TITLE

**BULK EARTHWORKS CUT & FILL PLAN**

SCALE	DRAWN	DESIGNED	CHECKED	APPROVED
AS SHOWN	M.T.	R.X.	J.G.	--

JOB No. **7490000** DRAWING No. **C3.02** ISSUE **1**

DATE MARCH 2022 STATUS ISSUED FOR REVIEW









BATTER TO STORMWATER CHANNEL 1.

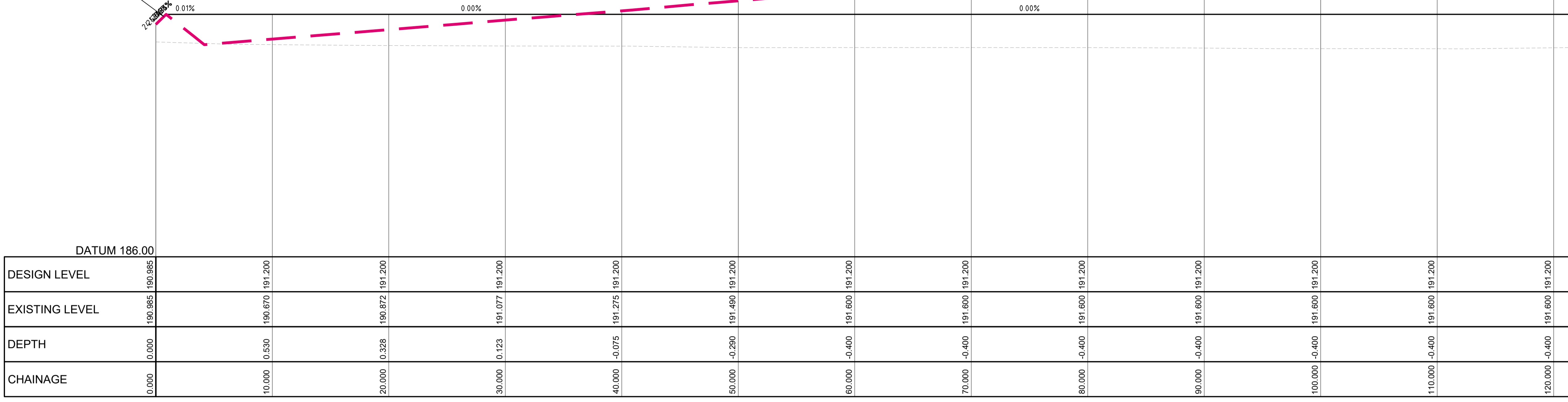

DATUM 186.00	
DESIGN LEVEL	190.985 191.200 191.200 191.200 191.200 191.200 191.200 191.200 191.200 191.200 191.200 191.200 191.200 191.200 191.200 191.200 191.200 191.200 191.200 191.200
EXISTING LEVEL	190.985 190.670 190.872 191.077 191.275 191.480 191.600 191.600 191.600 191.600 191.600 191.600 191.600 191.600 191.600 191.600 191.600 191.600 191.600 191.600 191.600
DEPTH	0.000 0.530 0.328 0.123 -0.075 -0.280 -0.400 -0.400 -0.400 -0.400 -0.400 -0.400 -0.400 -0.400 -0.400 -0.400 -0.400 -0.400 -0.400 -0.400 -0.400
CHAINAGE	0.000 10.000 20.000 30.000 40.000 50.000 60.000 70.000 80.000 90.000 100.000 110.000 120.000

REFER BELOW FOR CONTINUATION

**FILL PAD OVAL (SECTION B-B) LONGITUDINAL SECTION**  
 HORIZONTAL SCALE 1:200  
 VERTICAL SCALE 1:50

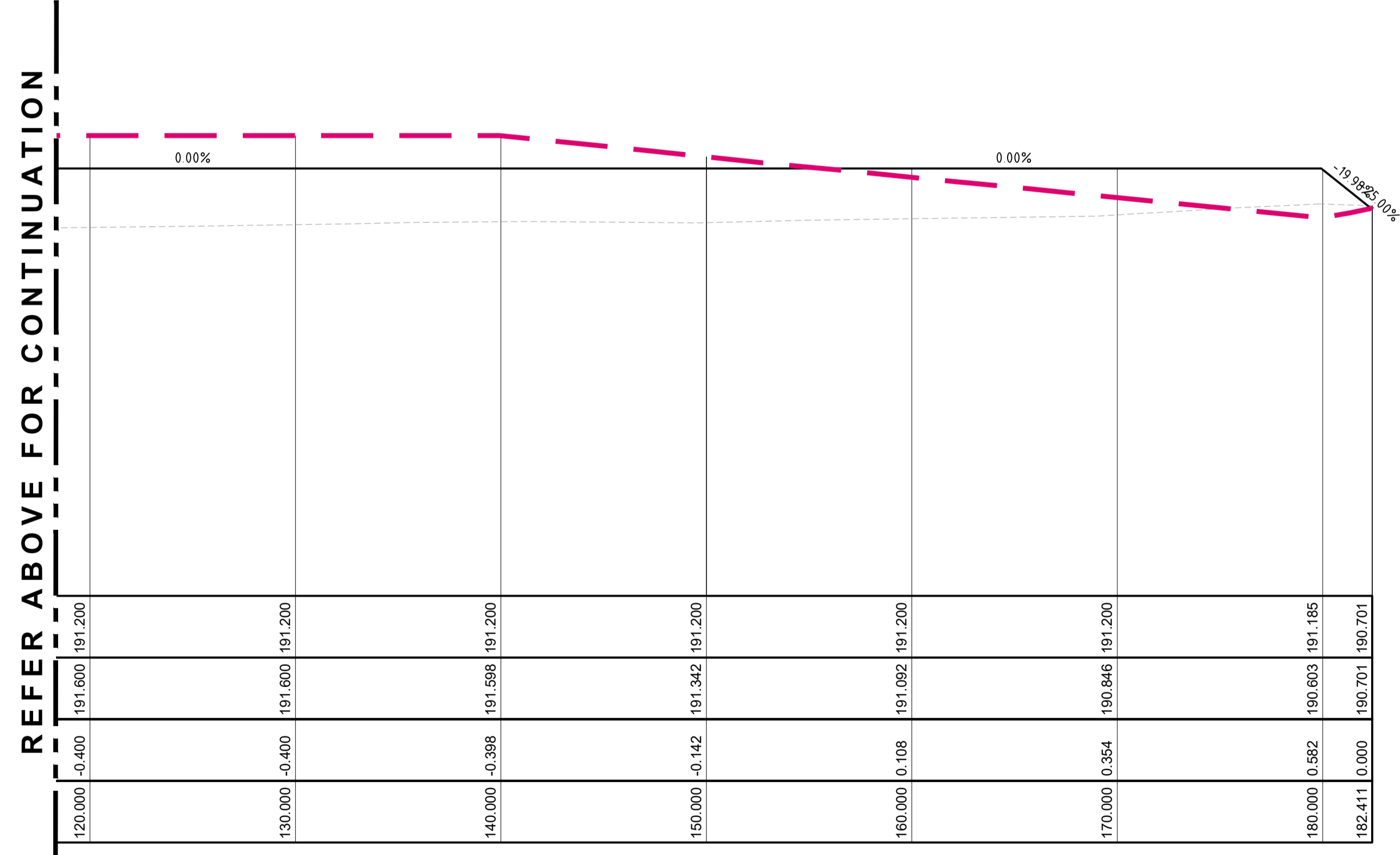

REFER ABOVE FOR CONTINUATION

120.000	-0.400	191.600	191.200
130.000	-0.400	191.600	191.200
140.000	-0.388	191.588	191.200
150.000	-0.142	191.342	191.200
160.000	0.108	191.092	191.200
170.000	0.354	190.846	191.200
180.000	0.582	190.603	191.185
182.411	0.000	190.701	190.701

**FILL PAD OVAL (SECTION B-B) LONGITUDINAL SECTION**  
 HORIZONTAL SCALE 1:200  
 VERTICAL SCALE 1:50

LEGEND	
	FINISHED SURFACE CONTOUR
	REF SURFACE (SUBJECT TO SEPARATE APPROVAL)
	EXISTING SURFACE CONTOUR
	GRADE ARROW

PRELIMINARY - NOT FOR CONSTRUCTION

Path: X:\20220319\_114\_18000\_WEE WAA\_High\_School\_SSD\_EIS\11\_CONSTRUCTION\_X\_2180000\_08\_Cover.dwg  
 Plot Date: 22/06/2022 11:12:21 User Name: NSG\jsh Cad File: \0301\NSP\_LOCAL\Drawings\450000\Drawings\CAD\01\Design\Ch4\2D\Issue for Review\C3.12 Fill Pad Oval Cross Section.dwg

DO NOT SCALE FROM DRAWINGS, CHECK & VERIFY ALL DIMENSIONS & LEVELS BEFORE COMMENCEMENT OF ANY WORK.

THIS DRAWING IS NOT TO BE COPIED IN PART OR WHOLE WITHOUT WRITTEN PERMISSION FROM WARREN SMITH CONSULTING ENGINEERS.

**DRAWING COLOUR CODED - PRINT ALL COPIES IN COLOUR**

SCALE 1:200 A1 SHEET

REVISION	AMENDMENT	DATE	REVISION	AMENDMENT	DATE
1	ISSUED FOR REVIEW	22/06/22			

CLIENT

PROJECT

**WEE WAA HIGH SCHOOL SSD**

PREPARED BY

WARREN SMITH CONSULTING ENGINEERS  
 SINCE 1981.

NSW 9/233 Castlereagh St. Sydney 2000 NSW Australia  
 VIC Suite 7.03, 365 Little Collins St Melbourne 3000 VIC Australia

PH +61 (2) 9299 1312 PH +61 (3) 8648 9942  
 www.warrensmith.com.au  
 wsp@warrensmith.com.au

ACN 002 197 088 ABN 36 300 430 126

Hydraulic Fire Civil Utilities Infrastructure

TITLE				
<b>FILL PAD OVAL SECTION B-B</b>				
SCALE	DRAWN	DESIGNED	CHECKED	APPROVED
AS SHOWN	N.G.	R.X.	J.G.	--
JOB No.	DRAWING No.		ISSUE	
<b>7490000</b>	<b>C3.12</b>		<b>1</b>	
DATE	STATUS			
MARCH 2022	ISSUED FOR REVIEW			

















REFER C6.02 FOR CONTINUATION

REFER C6.03 FOR CONTINUATION

REFER C6.05 FOR CONTINUATION

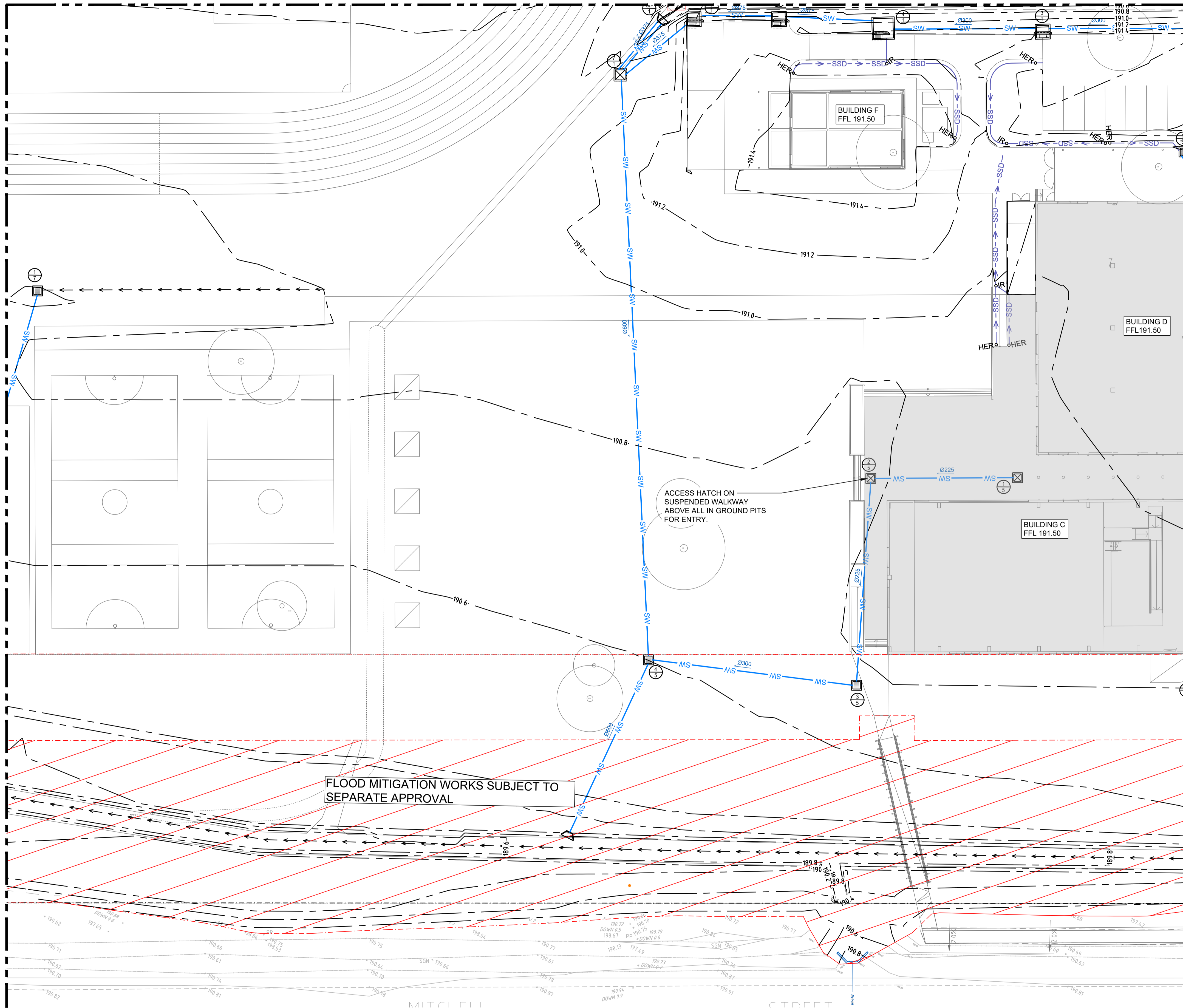

LEGEND

- BOUNDARY
- INDICATIVE OVERLAND FLOW ROUTE
- esw EXISTING STORMWATER PIPE
- Ø450 PIPE DIAMETER AND DIRECTION OF FLOW
- SW STORMWATER PIPE (SIZE <math>\leq \text{Ø}1050</math>)
- GRATED INLET PIT
- ▒ KERB INLET PIT (AT SAG)
- ▒ KERB INLET PIT (ON GRADE)
- ⊠ JUNCTION PIT
- ▒ CONCRETE HEADWALL
- PIT STRUCTURE NUMBER
- STORMWATER LINE NUMBER
- RL 91.86 FINISHED SURFACE LEVEL
- GRL 91.86 FINISHED STORMWATER PIT LID/GRATE LEVEL
- 2.5% GRADE ARROW
- SSD SUBSOIL DRAINAGE LINE
- SWALE FLOW ARROW
- SHADED REGION DENOTES STRUCTURE ELEVATED ABOVE THE FINISHED GROUND LEVEL

NOTES

- MINOR SYSTEMS, CONSISTING OF PITS AND PIPE HAVE BEEN DESIGNED TO CAPTURE AND ATTENUATE STORMWATER RUNOFF TO PROPOSED FLOODWAY CHANNEL FOR ALL EVENTS UP TO 5% AEP. BASED ON THE FLOOD ASSESSMENT REPORT PREPARED BY LYALL AND ASSOCIATES, THE FLOOD LEVEL FOR 5% AEP WITHIN THE PROPOSED CHANNEL AT DOWNSTREAM END OF THE MINOR SYSTEM = RL 190.55.
- ON-SITE DETENTION SYSTEM (OSD) HAS NOT BEEN CONSIDERED DUE TO THE SUBJECT SITE BEING FLOOD AFFECTED. HOWEVER, COUNCIL ENGINEER TO CONFIRM WHETHER OSD IS REQUIRED.
- COUNCIL ENGINEER TO CONFIRM WATER QUALITY TARGET OBJECTIVES FOR SUSPENDED SOLIDS (TSS), GROSS POLLUTANTS (GP), PHOSPHORUS (P) AND NITROGEN (N).
- IN REFERENCE TO NOTE 4, ADDITIONAL WATER QUALITY TREATMENT DEVICES MAY NEED TO BE INCORPORATED TO MEET COUNCIL OBJECTIVES.
- LOCATION AND SIZE OF RAINWATER TANK TO THE HYDRAULIC ENGINEERS DETAILS. INFORMATION TO BE CONFIRMED AND COORDINATED.

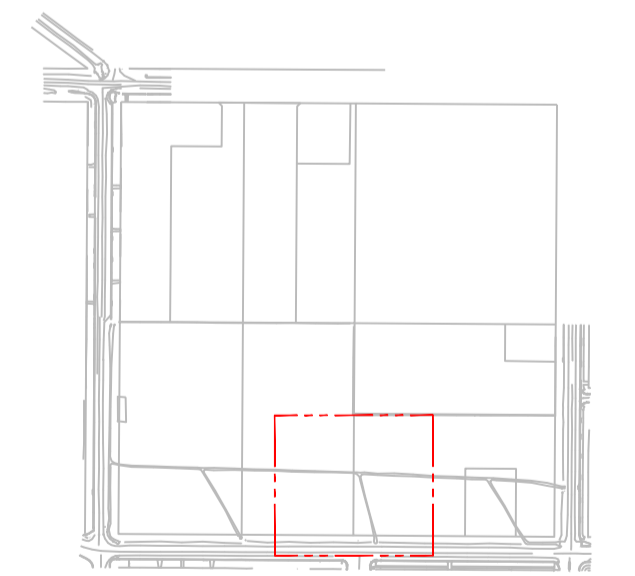

PRELIMINARY - NOT FOR CONSTRUCTION

Vertical text on the left edge: 22/06/22 11:55 AM... 7490000... C6.04... 1

DO NOT SCALE FROM DRAWINGS, CHECK & VERIFY ALL DIMENSIONS & LEVELS BEFORE COMMENCEMENT OF ANY WORK.

THIS DRAWING IS NOT TO BE COPIED IN PART OR WHOLE WITHOUT WRITTEN PERMISSION FROM WARREN SMITH CONSULTING ENGINEERS.

NORTH

DRAWING COLOUR CODED - PRINT ALL COPIES IN COLOUR

SCALE 1:250  
A1 SHEET

REVISION	AMENDMENT	DATE	REVISION	AMENDMENT	DATE
1	ISSUE FOR REVIEW	22/06/22			

CLIENT

PROJECT

WEE WAA HIGH SCHOOL  
SSD

PREPARED BY

WARREN SMITH CONSULTING ENGINEERS  
SINCE 1981.

NSW 9/223 Castlereagh St. Sydney 2000 NSW Australia  
VIC Suite 7/03, 365 Little Collins St Melbourne 3000 VIC Australia

PH +61 (2) 9299 1312 PH +61 (3) 8648 9942  
www.warrensmith.com.au  
wsp@warrensmith.com.au

ACN 002 197 088 ABN 36 300 430 126  
Hydraulic Fire Civil Utilities Infrastructure

TITLE

STORMWATER LAYOUT PLAN  
- SHEET 4

SCALE	DRAWN	DESIGNED	CHECKED	APPROVED
AS SHOWN	N.G.	N.G.	J.G.	

JOB No.	DRAWING No.	ISSUE
7490000	C6.04	1

DATE MARCH 2022 STATUS ISSUED FOR REVIEW



REFER C6.04 FOR CONTINUATION

REFER IN SET

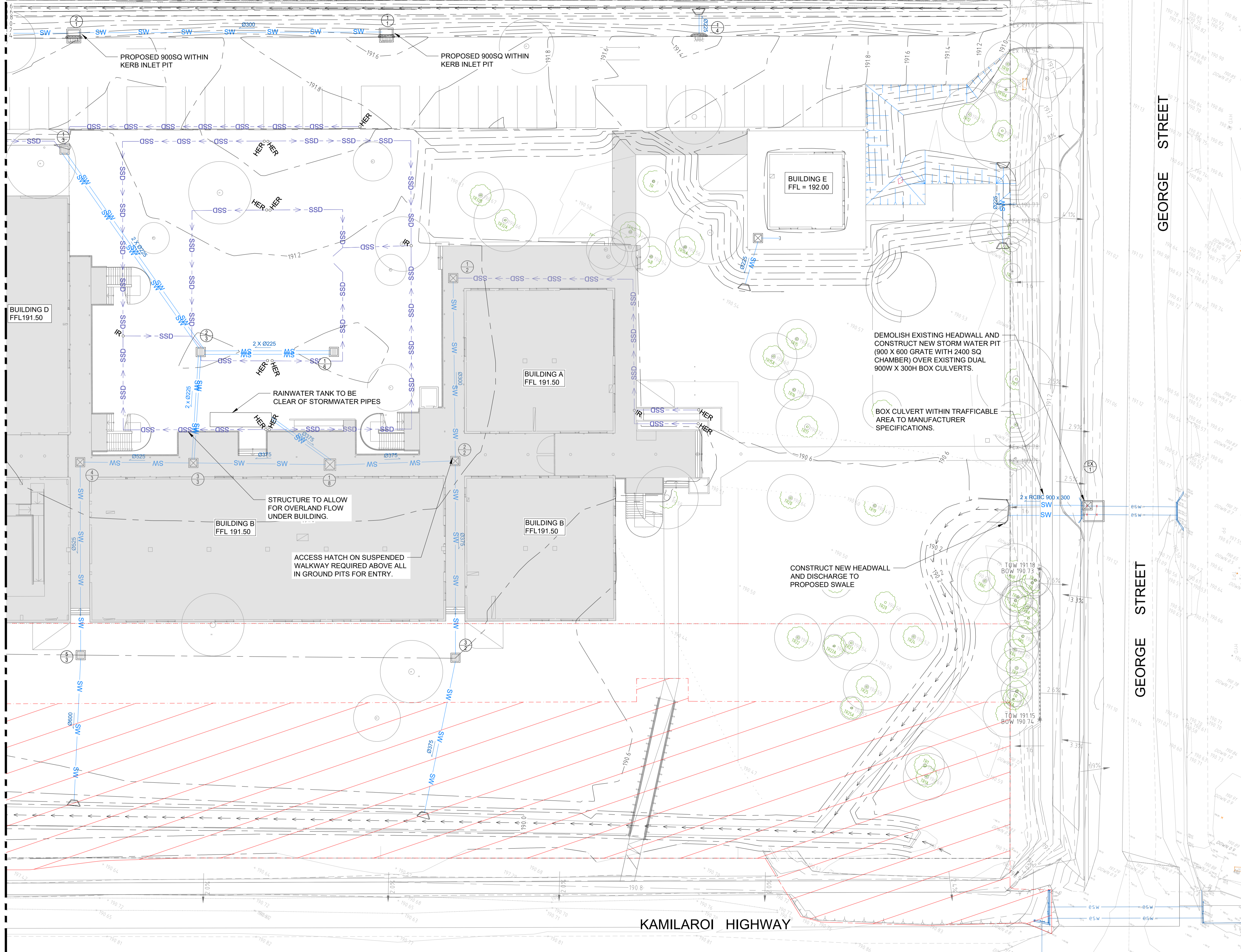

### LEGEND

- BOUNDARY
- INDICATIVE OVERLAND FLOW ROUTE
- EXISTING STORMWATER PIPE
- PIPE DIAMETER AND DIRECTION OF FLOW
- STORMWATER PIPE (SIZE <Ø1050)
- GRATED INLET PIT
- KERB INLET PIT (AT SAG)
- KERB INLET PIT (ON GRADE)
- JUNCTION PIT
- CONCRETE HEADWALL
- PIT STRUCTURE NUMBER
- STORMWATER LINE NUMBER
- FINISHED SURFACE LEVEL
- FINISHED STORMWATER PIT LID/GRATE LEVEL
- GRADE ARROW
- SUBSOIL DRAINAGE LINE
- SWALE FLOW ARROW
- SHADED REGION DENOTES STRUCTURE ELEVATED ABOVE THE FINISHED GROUND LEVEL

- ### NOTES
1. MINOR SYSTEMS, CONSISTING OF PITS AND PIPE HAVE BEEN DESIGNED TO CAPTURE AND ATTENUATE STORMWATER RUNOFF TO PROPOSED FLOODWAY CHANNEL FOR ALL EVENTS UP TO 5% AEP.
  2. BASED ON THE FLOOD ASSESSMENT REPORT PREPARED BY LYALL AND ASSOCIATES, THE FLOOD LEVEL FOR 5% AEP WITHIN THE PROPOSED CHANNEL AT DOWNSTREAM END OF THE MINOR SYSTEM = RL 190.55.
  3. ON-SITE DETENTION SYSTEM (OSD) HAS NOT BEEN CONSIDERED DUE TO THE SUBJECT SITE BEING FLOOD AFFECTED. HOWEVER, COUNCIL ENGINEER TO CONFIRM WHETHER OSD IS REQUIRED.
  4. COUNCIL ENGINEER TO CONFIRM WATER QUALITY TARGET OBJECTIVES FOR SUSPENDED SOLIDS (TSS), GROSS POLLUTANTS (GP), PHOSPHORUS (P) AND NITROGEN (N).
  5. IN REFERENCE TO NOTE 4. ADDITIONAL WATER QUALITY TREATMENT DEVICES MAY NEED TO BE INCORPORATED TO MEET COUNCIL OBJECTIVES.
  6. LOCATION AND SIZE OF RAINWATER TANK TO THE HYDRAULIC ENGINEERS DETAILS. INFORMATION TO BE CONFIRMED AND COORDINATED.

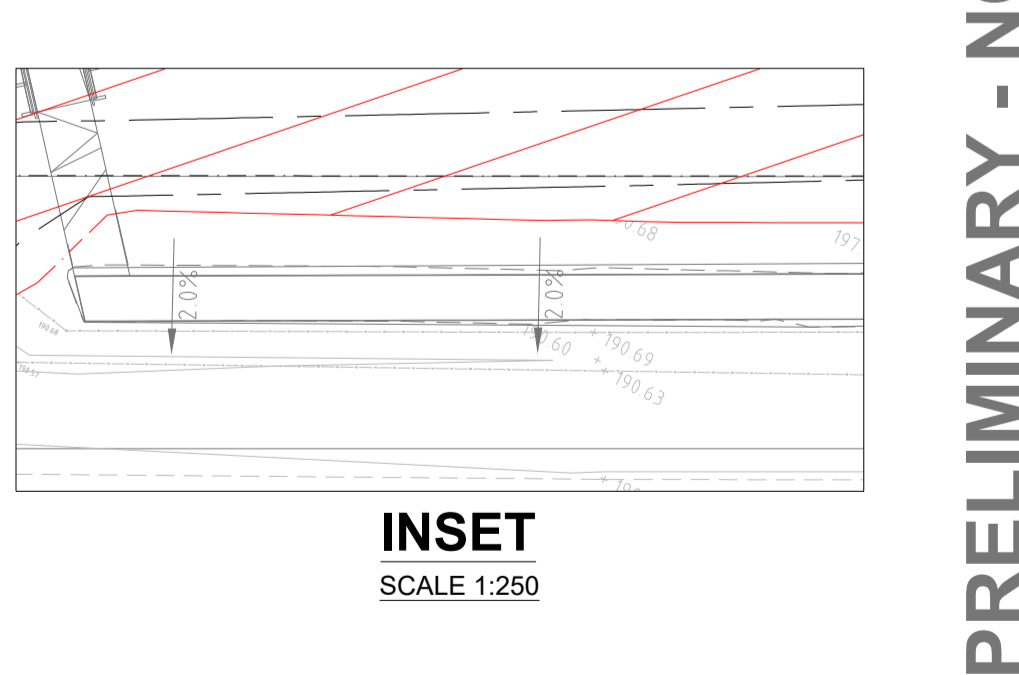
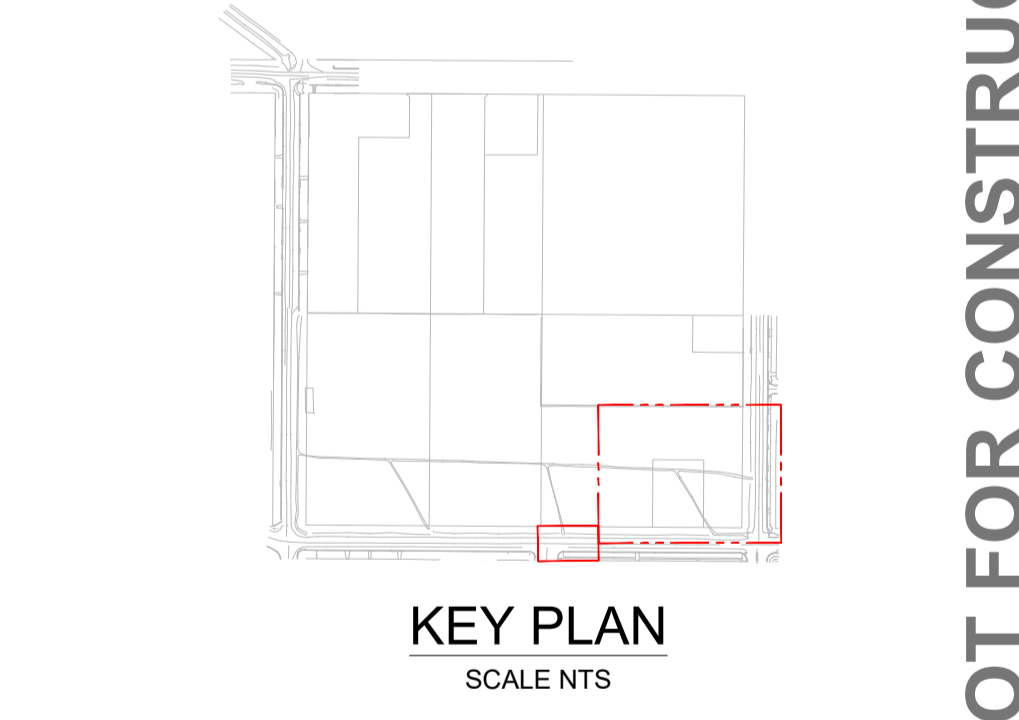

PRELIMINARY - NOT FOR CONSTRUCTION

DO NOT SCALE FROM DRAWINGS, CHECK & VERIFY ALL DIMENSIONS & LEVELS BEFORE COMMENCEMENT OF ANY WORK.

THIS DRAWING IS NOT TO BE COPIED IN PART OR WHOLE WITHOUT WRITTEN PERMISSION FROM WARREN SMITH CONSULTING ENGINEERS.

**NORTH**

**DRAWING COLOUR CODED - PRINT ALL COPIES IN COLOUR**

SCALE 1:250  
A1 SHEET

REVISION	AMENDMENT	DATE	REVISION	AMENDMENT	DATE
1	ISSUE FOR REVIEW	22/06/22			

CLIENT  
**Built** NSW GOVERNMENT

PROJECT  
**WEE WAA HIGH SCHOOL SSD**

PREPARED BY  
**Warren Smith Consulting Engineers**  
SINCE 1981.

NSW 9/233 Castlereagh St. Sydney 2000 NSW Australia  
VIC 306 Little Collins St Melbourne 3000 VIC Australia  
PH +61 (2) 9299 1312 PH +61 (3) 8648 9942  
www.warrensmith.com.au  
wsp@warrensmith.com.au

ACN 002 197 088 ABN 36 300 430 126  
Hydraulic Fire Civil Utilities Infrastructure

TITLE  
**STORMWATER LAYOUT PLAN - SHEET 5**

SCALE AS SHOWN	DRAWN N.G.	DESIGNED N.G.	CHECKED J.G.	APPROVED --
JOB No. <b>7490000</b>	DRAWING No. <b>C6.05</b>	ISSUE <b>1</b>		
DATE MARCH 2022	STATUS ISSUED FOR REVIEW			

1/24/2022 10:41 AM X:\2490000\_SSD\REV\2490000\_SSD.dwg X:\2490000\_SSD\REV\2490000\_SSD.dwg  
 2/24/2022 10:41 AM X:\2490000\_SSD\REV\2490000\_SSD.dwg X:\2490000\_SSD\REV\2490000\_SSD.dwg  
 3/24/2022 10:41 AM X:\2490000\_SSD\REV\2490000\_SSD.dwg X:\2490000\_SSD\REV\2490000\_SSD.dwg  
 4/24/2022 10:41 AM X:\2490000\_SSD\REV\2490000\_SSD.dwg X:\2490000\_SSD\REV\2490000\_SSD.dwg  
 5/24/2022 10:41 AM X:\2490000\_SSD\REV\2490000\_SSD.dwg X:\2490000\_SSD\REV\2490000\_SSD.dwg  
 6/24/2022 10:41 AM X:\2490000\_SSD\REV\2490000\_SSD.dwg X:\2490000\_SSD\REV\2490000\_SSD.dwg  
 7/24/2022 10:41 AM X:\2490000\_SSD\REV\2490000\_SSD.dwg X:\2490000\_SSD\REV\2490000\_SSD.dwg  
 8/24/2022 10:41 AM X:\2490000\_SSD\REV\2490000\_SSD.dwg X:\2490000\_SSD\REV\2490000\_SSD.dwg  
 9/24/2022 10:41 AM X:\2490000\_SSD\REV\2490000\_SSD.dwg X:\2490000\_SSD\REV\2490000\_SSD.dwg  
 10/24/2022 10:41 AM X:\2490000\_SSD\REV\2490000\_SSD.dwg X:\2490000\_SSD\REV\2490000\_SSD.dwg  
 11/24/2022 10:41 AM X:\2490000\_SSD\REV\2490000\_SSD.dwg X:\2490000\_SSD\REV\2490000\_SSD.dwg  
 12/24/2022 10:41 AM X:\2490000\_SSD\REV\2490000\_SSD.dwg X:\2490000\_SSD\REV\2490000\_SSD.dwg  
 13/24/2022 10:41 AM X:\2490000\_SSD\REV\2490000\_SSD.dwg X:\2490000\_SSD\REV\2490000\_SSD.dwg  
 14/24/2022 10:41 AM X:\2490000\_SSD\REV\2490000\_SSD.dwg X:\2490000\_SSD\REV\2490000\_SSD.dwg  
 15/24/2022 10:41 AM X:\2490000\_SSD\REV\2490000\_SSD.dwg X:\2490000\_SSD\REV\2490000\_SSD.dwg  
 16/24/2022 10:41 AM X:\2490000\_SSD\REV\2490000\_SSD.dwg X:\2490000\_SSD\REV\2490000\_SSD.dwg  
 17/24/2022 10:41 AM X:\2490000\_SSD\REV\2490000\_SSD.dwg X:\2490000\_SSD\REV\2490000\_SSD.dwg  
 18/24/2022 10:41 AM X:\2490000\_SSD\REV\2490000\_SSD.dwg X:\2490000\_SSD\REV\2490000\_SSD.dwg  
 19/24/2022 10:41 AM X:\2490000\_SSD\REV\2490000\_SSD.dwg X:\2490000\_SSD\REV\2490000\_SSD.dwg  
 20/24/2022 10:41 AM X:\2490000\_SSD\REV\2490000\_SSD.dwg X:\2490000\_SSD\REV\2490000\_SSD.dwg  
 21/24/2022 10:41 AM X:\2490000\_SSD\REV\2490000\_SSD.dwg X:\2490000\_SSD\REV\2490000\_SSD.dwg  
 22/24/2022 10:41 AM X:\2490000\_SSD\REV\2490000\_SSD.dwg X:\2490000\_SSD\REV\2490000\_SSD.dwg  
 23/24/2022 10:41 AM X:\2490000\_SSD\REV\2490000\_SSD.dwg X:\2490000\_SSD\REV\2490000\_SSD.dwg  
 24/24/2022 10:41 AM X:\2490000\_SSD\REV\2490000\_SSD.dwg X:\2490000\_SSD\REV\2490000\_SSD.dwg  
 25/24/2022 10:41 AM X:\2490000\_SSD\REV\2490000\_SSD.dwg X:\2490000\_SSD\REV\2490000\_SSD.dwg  
 26/24/2022 10:41 AM X:\2490000\_SSD\REV\2490000\_SSD.dwg X:\2490000\_SSD\REV\2490000\_SSD.dwg  
 27/24/2022 10:41 AM X:\2490000\_SSD\REV\2490000\_SSD.dwg X:\2490000\_SSD\REV\2490000\_SSD.dwg  
 28/24/2022 10:41 AM X:\2490000\_SSD\REV\2490000\_SSD.dwg X:\2490000\_SSD\REV\2490000\_SSD.dwg  
 29/24/2022 10:41 AM X:\2490000\_SSD\REV\2490000\_SSD.dwg X:\2490000\_SSD\REV\2490000\_SSD.dwg  
 30/24/2022 10:41 AM X:\2490000\_SSD\REV\2490000\_SSD.dwg X:\2490000\_SSD\REV\2490000\_SSD.dwg  
 31/24/2022 10:41 AM X:\2490000\_SSD\REV\2490000\_SSD.dwg X:\2490000\_SSD\REV\2490000\_SSD.dwg  
 32/24/2022 10:41 AM X:\2490000\_SSD\REV\2490000\_SSD.dwg X:\2490000\_SSD\REV\2490000\_SSD.dwg  
 33/24/2022 10:41 AM X:\2490000\_SSD\REV\2490000\_SSD.dwg X:\2490000\_SSD\REV\2490000\_SSD.dwg  
 34/24/2022 10:41 AM X:\2490000\_SSD\REV\2490000\_SSD.dwg X:\2490000\_SSD\REV\2490000\_SSD.dwg  
 35/24/2022 10:41 AM X:\2490000\_SSD\REV\2490000\_SSD.dwg X:\2490000\_SSD\REV\2490000\_SSD.dwg  
 36/24/2022 10:41 AM X:\2490000\_SSD\REV\2490000\_SSD.dwg X:\2490000\_SSD\REV\2490000\_SSD.dwg  
 37/24/2022 10:41 AM X:\2490000\_SSD\REV\2490000\_SSD.dwg X:\2490000\_SSD\REV\2490000\_SSD.dwg  
 38/24/2022 10:41 AM X:\2490000\_SSD\REV\2490000\_SSD.dwg X:\2490000\_SSD\REV\2490000\_SSD.dwg  
 39/24/2022 10:41 AM X:\2490000\_SSD\REV\2490000\_SSD.dwg X:\2490000\_SSD\REV\2490000\_SSD.dwg  
 40/24/2022 10:41 AM X:\2490000\_SSD\REV\2490000\_SSD.dwg X:\2490000\_SSD\REV\2490000\_SSD.dwg  
 41/24/2022 10:41 AM X:\2490000\_SSD\REV\2490000\_SSD.dwg X:\2490000\_SSD\REV\2490000\_SSD.dwg  
 42/24/2022 10:41 AM X:\2490000\_SSD\REV\2490000\_SSD.dwg X:\2490000\_SSD\REV\2490000\_SSD.dwg  
 43/24/2022 10:41 AM X:\2490000\_SSD\REV\2490000\_SSD.dwg X:\2490000\_SSD\REV\2490000\_SSD.dwg  
 44/24/2022 10:41 AM X:\2490000\_SSD\REV\2490000\_SSD.dwg X:\2490000\_SSD\REV\2490000\_SSD.dwg  
 45/24/2022 10:41 AM X:\2490000\_SSD\REV\2490000\_SSD.dwg X:\2490000\_SSD\REV\2490000\_SSD.dwg  
 46/24/2022 10:41 AM X:\2490000\_SSD\REV\2490000\_SSD.dwg X:\2490000\_SSD\REV\2490000\_SSD.dwg  
 47/24/2022 10:41 AM X:\2490000\_SSD\REV\2490000\_SSD.dwg X:\2490000\_SSD\REV\2490000\_SSD.dwg  
 48/24/2022 10:41 AM X:\2490000\_SSD\REV\2490000\_SSD.dwg X:\2490000\_SSD\REV\2490000\_SSD.dwg  
 49/24/2022 10:41 AM X:\2490000\_SSD\REV\2490000\_SSD.dwg X:\2490000\_SSD\REV\2490000\_SSD.dwg  
 50/24/2022 10:41 AM X:\2490000\_SSD\REV\2490000\_SSD.dwg X:\2490000\_SSD\REV\2490000\_SSD.dwg  
 51/24/2022 10:41 AM X:\2490000\_SSD\REV\2490000\_SSD.dwg X:\2490000\_SSD\REV\2490000\_SSD.dwg  
 52/24/2022 10:41 AM X:\2490000\_SSD\REV\2490000\_SSD.dwg X:\2490000\_SSD\REV\2490000\_SSD.dwg  
 53/24/2022 10:41 AM X:\2490000\_SSD\REV\2490000\_SSD.dwg X:\2490000\_SSD\REV\2490000\_SSD.dwg  
 54/24/2022 10:41 AM X:\2490000\_SSD\REV\2490000\_SSD.dwg X:\2490000\_SSD\REV\2490000\_SSD.dwg  
 55/24/2022 10:41 AM X:\2490000\_SSD\REV\2490000\_SSD.dwg X:\2490000\_SSD\REV\2490000\_SSD.dwg  
 56/24/2022 10:41 AM X:\2490000\_SSD\REV\2490000\_SSD.dwg X:\2490000\_SSD\REV\2490000\_SSD.dwg  
 57/24/2022 10:41 AM X:\2490000\_SSD\REV\2490000\_SSD.dwg X:\2490000\_SSD\REV\2490000\_SSD.dwg  
 58/24/2022 10:41 AM X:\2490000\_SSD\REV\2490000\_SSD.dwg X:\2490000\_SSD\REV\2490000\_SSD.dwg  
 59/24/2022 10:41 AM X:\2490000\_SSD\REV\2490000\_SSD.dwg X:\2490000\_SSD\REV\2490000\_SSD.dwg  
 60/24/2022 10:41 AM X:\2490000\_SSD\REV\2490000\_SSD.dwg X:\2490000\_SSD\REV\2490000\_SSD.dwg  
 61/24/2022 10:41 AM X:\2490000\_SSD\REV\2490000\_SSD.dwg X:\2490000\_SSD\REV\2490000\_SSD.dwg  
 62/24/2022 10:41 AM X:\2490000\_SSD\REV\2490000\_SSD.dwg X:\2490000\_SSD\REV\2490000\_SSD.dwg  
 63/24/2022 10:41 AM X:\2490000\_SSD\REV\2490000\_SSD.dwg X:\2490000\_SSD\REV\2490000\_SSD.dwg  
 64/24/2022 10:41 AM X:\2490000\_SSD\REV\2490000\_SSD.dwg X:\2490000\_SSD\REV\2490000\_SSD.dwg  
 65/24/2022 10:41 AM X:\2490000\_SSD\REV\2490000\_SSD.dwg X:\2490000\_SSD\REV\2490000\_SSD.dwg  
 66/24/2022 10:41 AM X:\2490000\_SSD\REV\2490000\_SSD.dwg X:\2490000\_SSD\REV\2490000\_SSD.dwg  
 67/24/2022 10:41 AM X:\2490000\_SSD\REV\2490000\_SSD.dwg X:\2490000\_SSD\REV\2490000\_SSD.dwg  
 68/24/2022 10:41 AM X:\2490000\_SSD\REV\2490000\_SSD.dwg X:\2490000\_SSD\REV\2490000\_SSD.dwg  
 69/24/2022 10:41 AM X:\2490000\_SSD\REV\2490000\_SSD.dwg X:\2490000\_SSD\REV\2490000\_SSD.dwg  
 70/24/2022 10:41 AM X:\2490000\_SSD\REV\2490000\_SSD.dwg X:\2490000\_SSD\REV\2490000\_SSD.dwg  
 71/24/2022 10:41 AM X:\2490000\_SSD\REV\2490000\_SSD.dwg X:\2490000\_SSD\REV\2490000\_SSD.dwg  
 72/24/2022 10:41 AM X:\2490000\_SSD\REV\2490000\_SSD.dwg X:\2490000\_SSD\REV\2490000\_SSD.dwg  
 73/24/2022 10:41 AM X:\2490000\_SSD\REV\2490000\_SSD.dwg X:\2490000\_SSD\REV\2490000\_SSD.dwg  
 74/24/2022 10:41 AM X:\2490000\_SSD\REV\2490000\_SSD.dwg X:\2490000\_SSD\REV\2490000\_SSD.dwg  
 75/24/2022 10:41 AM X:\2490000\_SSD\REV\2490000\_SSD.dwg X:\2490000\_SSD\REV\2490000\_SSD.dwg  
 76/24/2022 10:41 AM X:\2490000\_SSD\REV\2490000\_SSD.dwg X:\2490000\_SSD\REV\2490000\_SSD.dwg  
 77/24/2022 10:41 AM X:\2490000\_SSD\REV\2490000\_SSD.dwg X:\2490000\_SSD\REV\2490000\_SSD.dwg  
 78/24/2022 10:41 AM X:\2490000\_SSD\REV\2490000\_SSD.dwg X:\2490000\_SSD\REV\2490000\_SSD.dwg  
 79/24/2022 10:41 AM X:\2490000\_SSD\REV\2490000\_SSD.dwg X:\2490000\_SSD\REV\2490000\_SSD.dwg  
 80/24/2022 10:41 AM X:\2490000\_SSD\REV\2490000\_SSD.dwg X:\2490000\_SSD\REV\2490000\_SSD.dwg  
 81/24/2022 10:41 AM X:\2490000\_SSD\REV\2490000\_SSD.dwg X:\2490000\_SSD\REV\2490000\_SSD.dwg  
 82/24/2022 10:41 AM X:\2490000\_SSD\REV\2490000\_SSD.dwg X:\2490000\_SSD\REV\2490000\_SSD.dwg  
 83/24/2022 10:41 AM X:\2490000\_SSD\REV\2490000\_SSD.dwg X:\2490000\_SSD\REV\2490000\_SSD.dwg  
 84/24/2022 10:41 AM X:\2490000\_SSD\REV\2490000\_SSD.dwg X:\2490000\_SSD\REV\2490000\_SSD.dwg  
 85/24/2022 10:41 AM X:\2490000\_SSD\REV\2490000\_SSD.dwg X:\2490000\_SSD\REV\2490000\_SSD.dwg  
 86/24/2022 10:41 AM X:\2490000\_SSD\REV\2490000\_SSD.dwg X:\2490000\_SSD\REV\2490000\_SSD.dwg  
 87/24/2022 10:41 AM X:\2490000\_SSD\REV\2490000\_SSD.dwg X:\2490000\_SSD\REV\2490000\_SSD.dwg  
 88/24/2022 10:41 AM X:\2490000\_SSD\REV\2490000\_SSD.dwg X:\2490000\_SSD\REV\2490000\_SSD.dwg  
 89/24/2022 10:41 AM X:\2490000\_SSD\REV\2490000\_SSD.dwg X:\2490000\_SSD\REV\2490000\_SSD.dwg  
 90/24/2022 10:41 AM X:\2490000\_SSD\REV\2490000\_SSD.dwg X:\2490000\_SSD\REV\2490000\_SSD.dwg  
 91/24/2022 10:41 AM X:\2490000\_SSD\REV\2490000\_SSD.dwg X:\2490000\_SSD\REV\2490000\_SSD.dwg  
 92/24/2022 10:41 AM X:\2490000\_SSD\REV\2490000\_SSD.dwg X:\2490000\_SSD\REV\2490000\_SSD.dwg  
 93/24/2022 10:41 AM X:\2490000\_SSD\REV\2490000\_SSD.dwg X:\2490000\_SSD\REV\2490000\_SSD.dwg  
 94/24/2022 10:41 AM X:\2490000\_SSD\REV\2490000\_SSD.dwg X:\2490000\_SSD\REV\2490000\_SSD.dwg  
 95/24/2022 10:41 AM X:\2490000\_SSD\REV\2490000\_SSD.dwg X:\2490000\_SSD\REV\2490000\_SSD.dwg  
 96/24/2022 10:41 AM X:\2490000\_SSD\REV\2490000\_SSD.dwg X:\2490000\_SSD\REV\2490000\_SSD.dwg  
 97/24/2022 10:41 AM X:\2490000\_SSD\REV\2490000\_SSD.dwg X:\2490000\_SSD\REV\2490000\_SSD.dwg  
 98/24/2022 10:41 AM X:\2490000\_SSD\REV\2490000\_SSD.dwg X:\2490000\_SSD\REV\2490000\_SSD.dwg  
 99/24/2022 10:41 AM X:\2490000\_SSD\REV\2490000\_SSD.dwg X:\2490000\_SSD\REV\2490000\_SSD.dwg  
 100/24/2022 10:41 AM X:\2490000\_SSD\REV\2490000\_SSD.dwg X:\2490000\_SSD\REV\2490000\_SSD.dwg











**LEGEND**

- SSD WORKS SURFACE
- EXISTING SURFACE

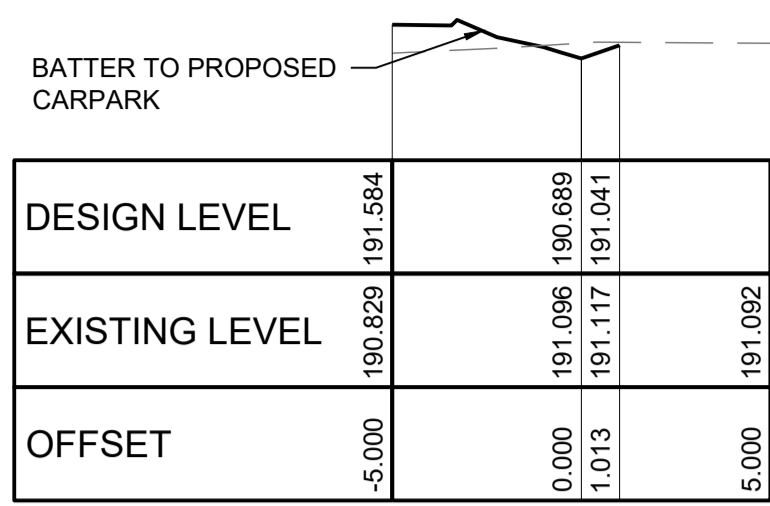

**CHAINAGE 30.00**  
HORIZONTAL SCALE 1:200  
VERTICAL SCALE 1:200

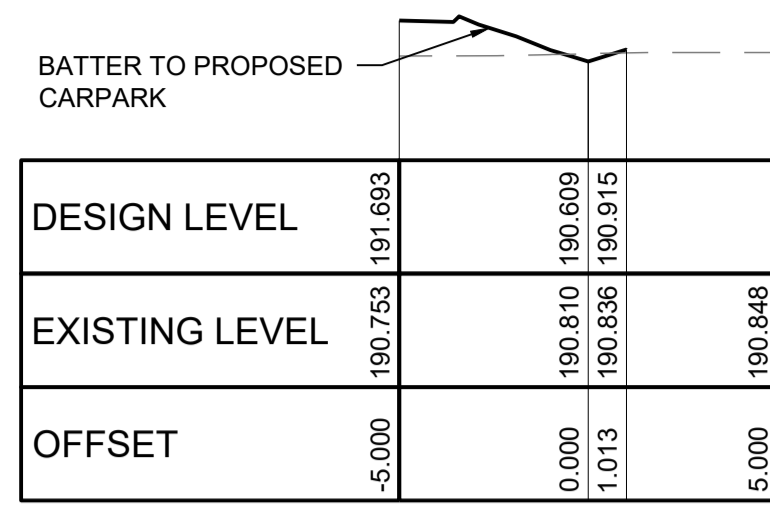

**CHAINAGE 70.00**  
HORIZONTAL SCALE 1:200  
VERTICAL SCALE 1:200

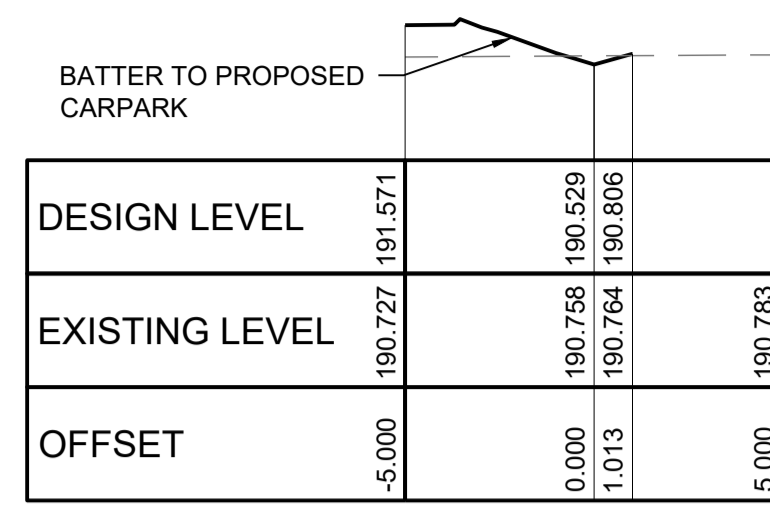

**CHAINAGE 110.00**  
HORIZONTAL SCALE 1:200  
VERTICAL SCALE 1:200

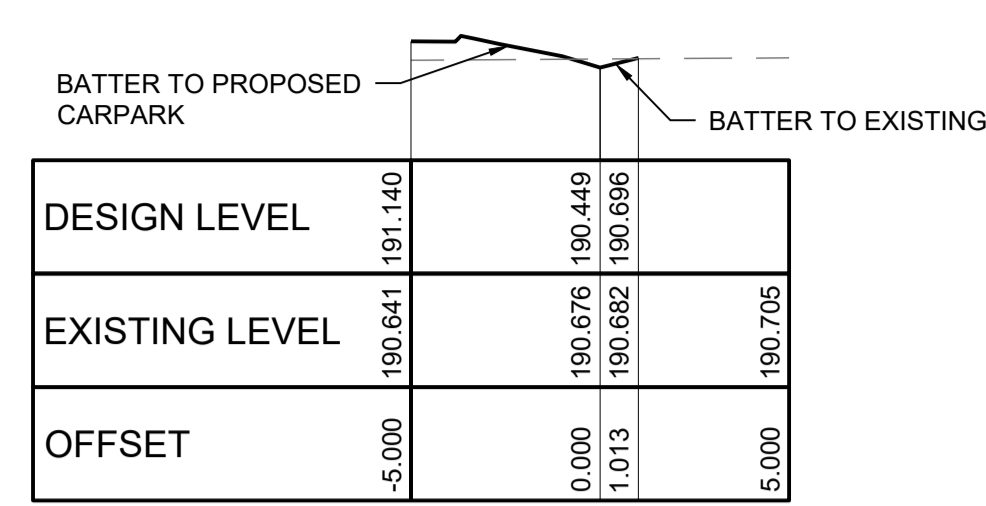

**CHAINAGE 150.00**  
HORIZONTAL SCALE 1:200  
VERTICAL SCALE 1:200

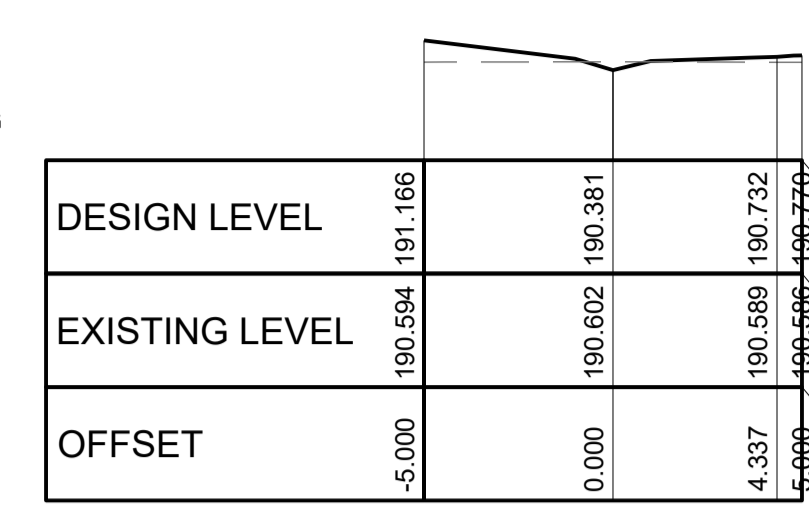

**CHAINAGE 183.93**  
HORIZONTAL SCALE 1:200  
VERTICAL SCALE 1:200

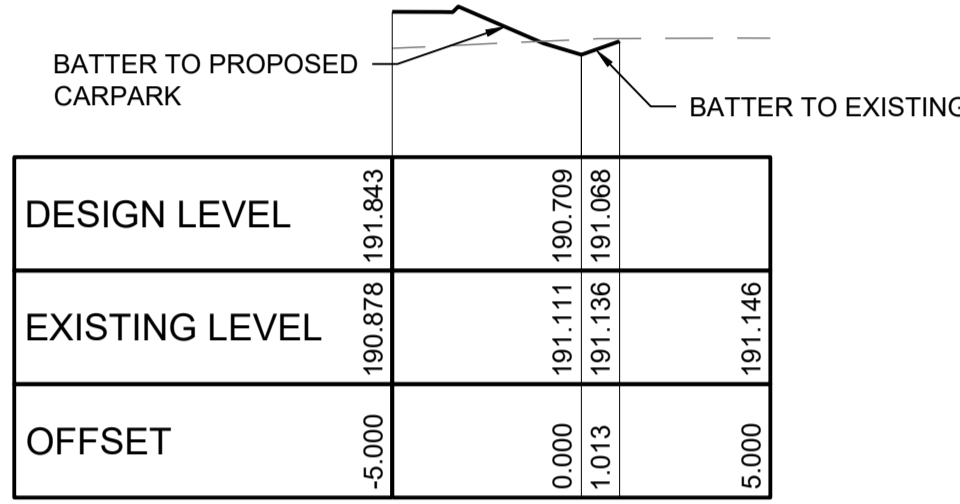

**CHAINAGE 20.00**  
HORIZONTAL SCALE 1:200  
VERTICAL SCALE 1:200

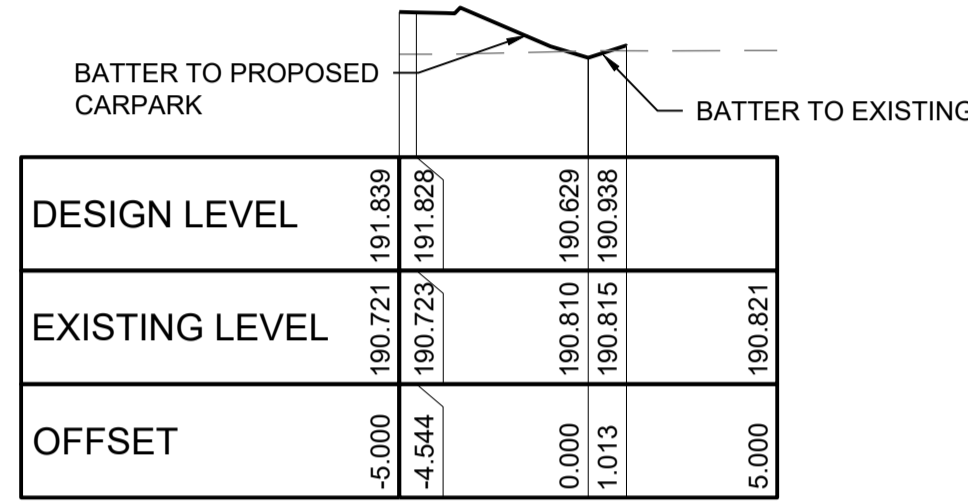

**CHAINAGE 60.00**  
HORIZONTAL SCALE 1:200  
VERTICAL SCALE 1:200

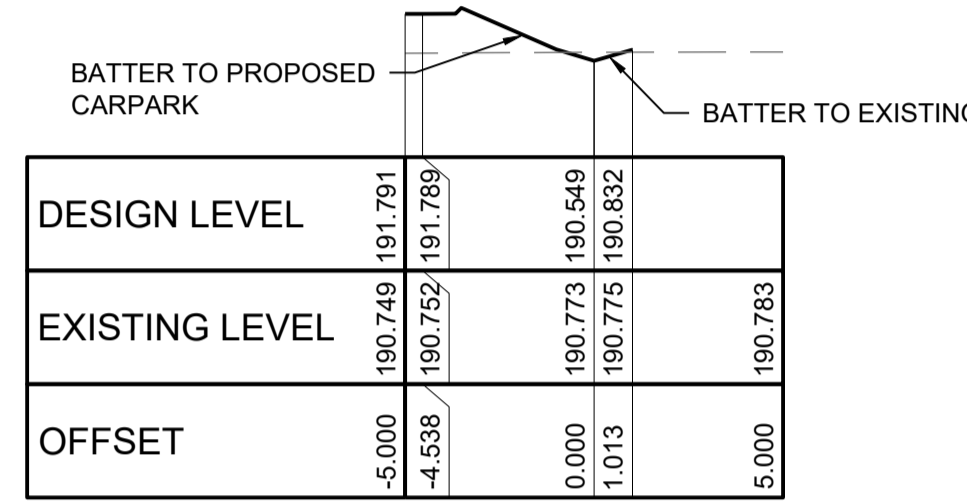

**CHAINAGE 100.00**  
HORIZONTAL SCALE 1:200  
VERTICAL SCALE 1:200

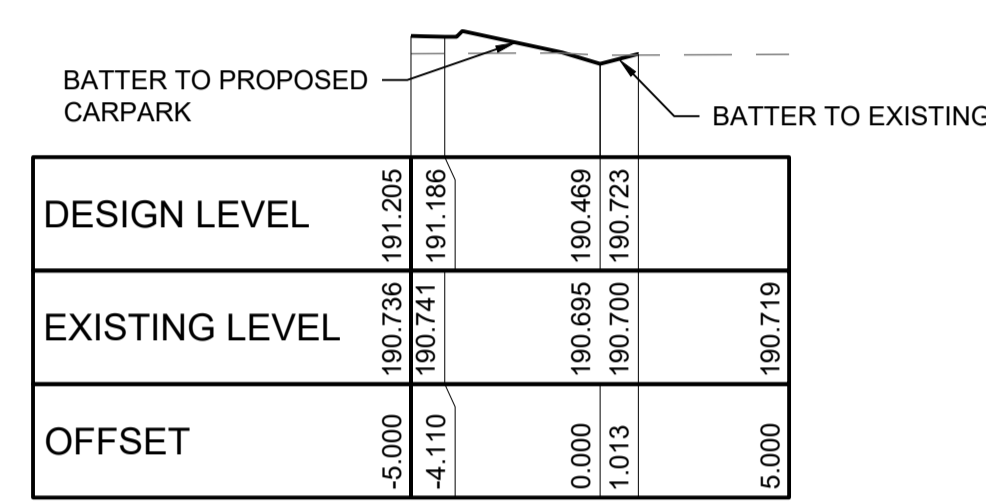

**CHAINAGE 140.00**  
HORIZONTAL SCALE 1:200  
VERTICAL SCALE 1:200

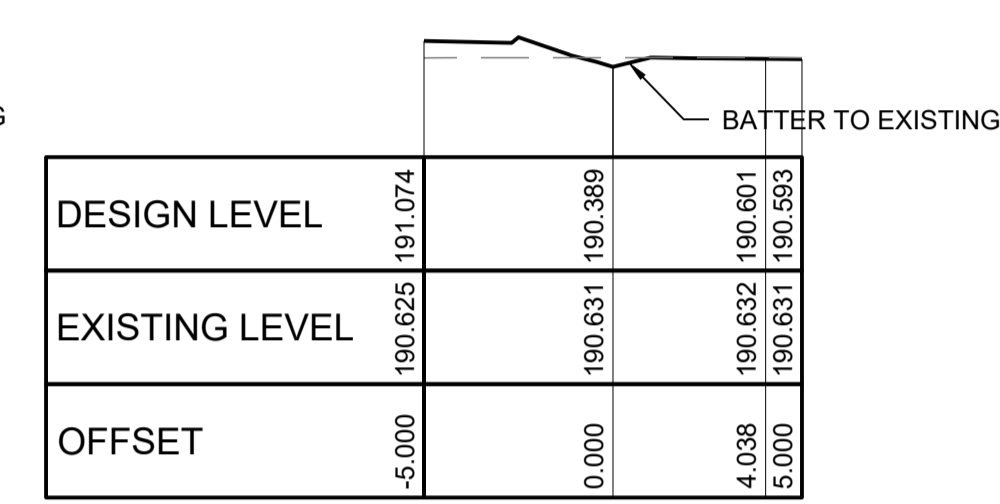

**CHAINAGE 180.00**  
HORIZONTAL SCALE 1:200  
VERTICAL SCALE 1:200

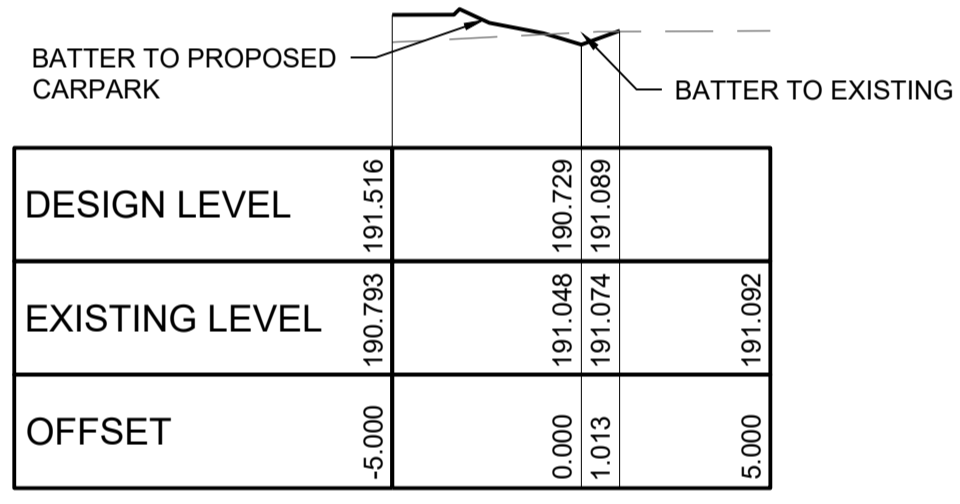

**CHAINAGE 10.00**  
HORIZONTAL SCALE 1:200  
VERTICAL SCALE 1:200

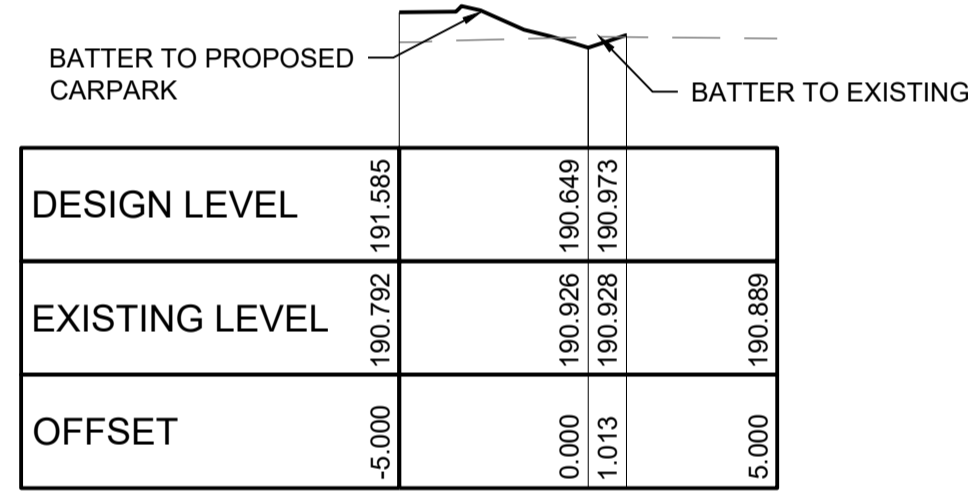

**CHAINAGE 50.00**  
HORIZONTAL SCALE 1:200  
VERTICAL SCALE 1:200

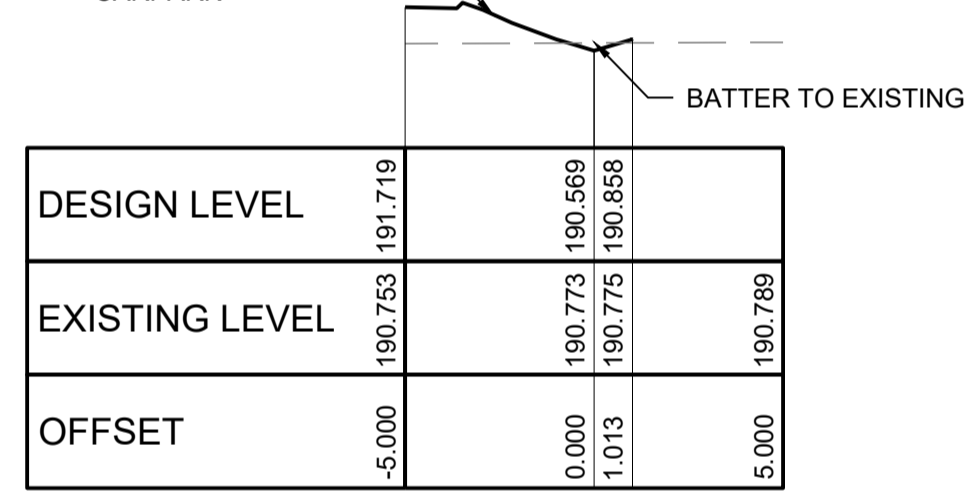

**CHAINAGE 90.00**  
HORIZONTAL SCALE 1:200  
VERTICAL SCALE 1:200

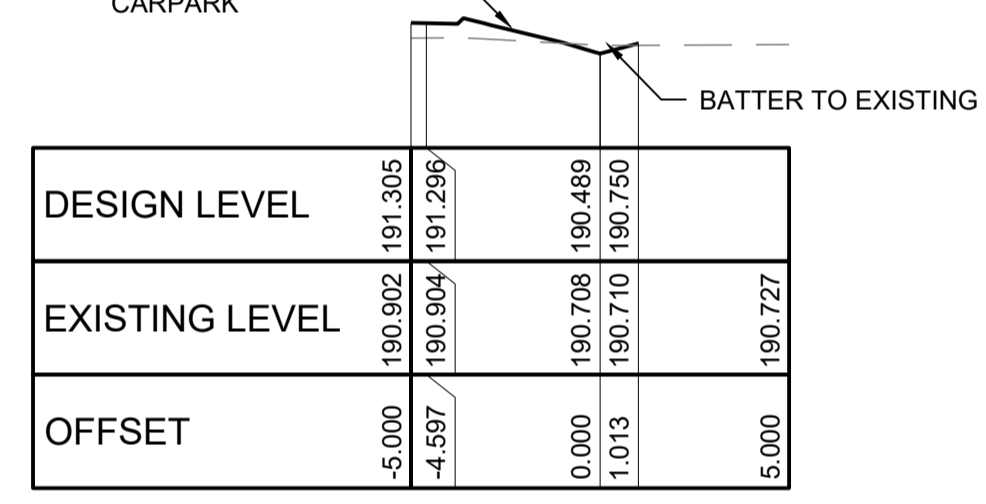

**CHAINAGE 130.00**  
HORIZONTAL SCALE 1:200  
VERTICAL SCALE 1:200

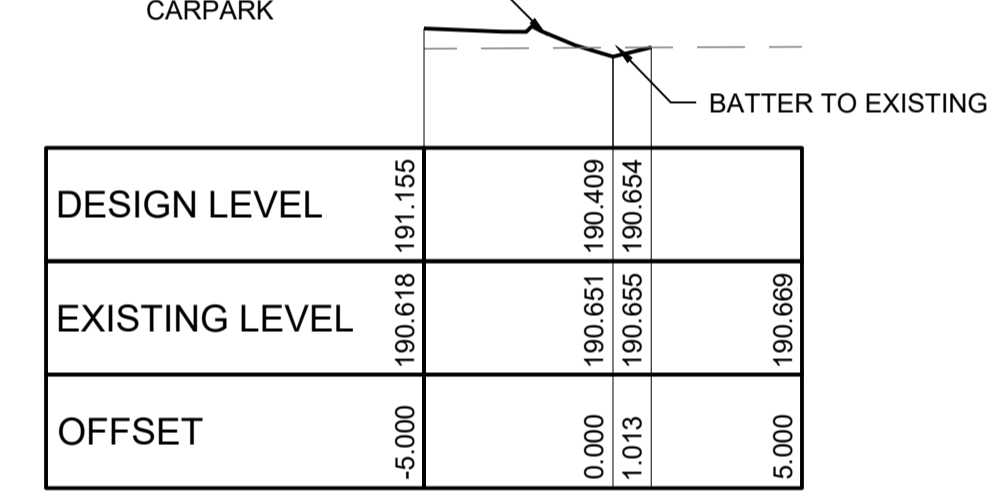

**CHAINAGE 170.00**  
HORIZONTAL SCALE 1:200  
VERTICAL SCALE 1:200

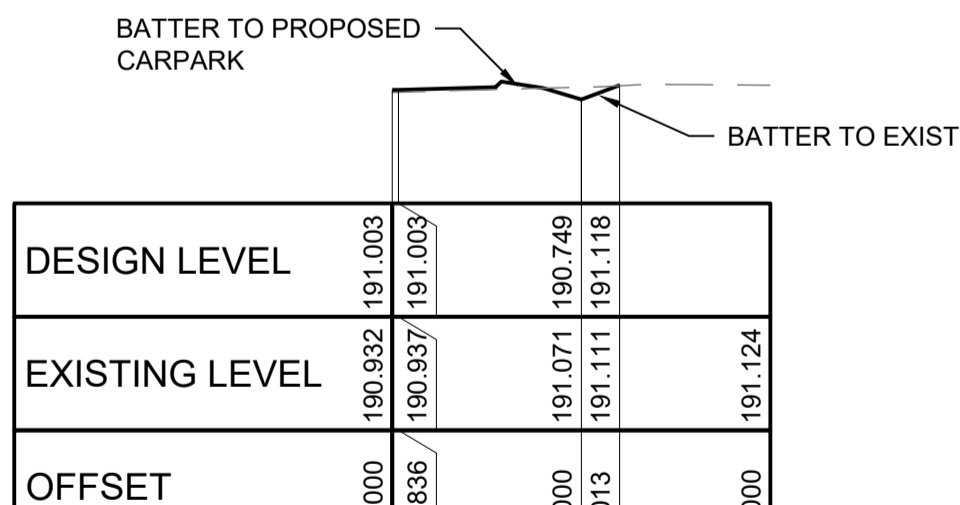

**CHAINAGE 00.00**  
HORIZONTAL SCALE 1:200  
VERTICAL SCALE 1:200

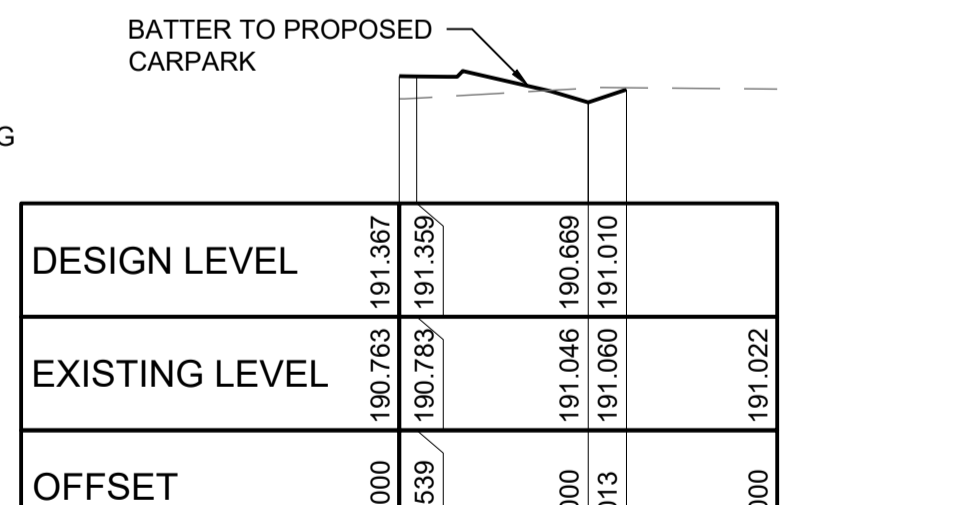

**CHAINAGE 40.00**  
HORIZONTAL SCALE 1:200  
VERTICAL SCALE 1:200

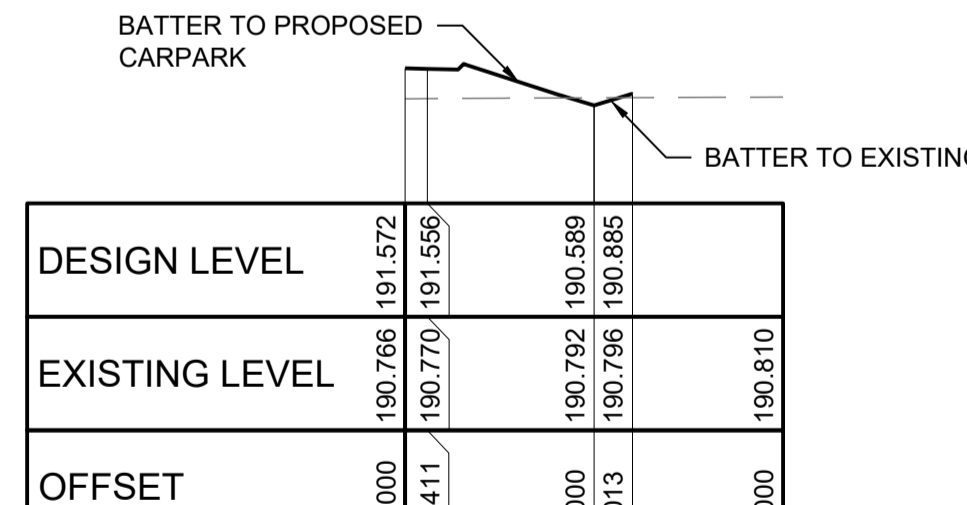

**CHAINAGE 90.00**  
HORIZONTAL SCALE 1:200  
VERTICAL SCALE 1:200

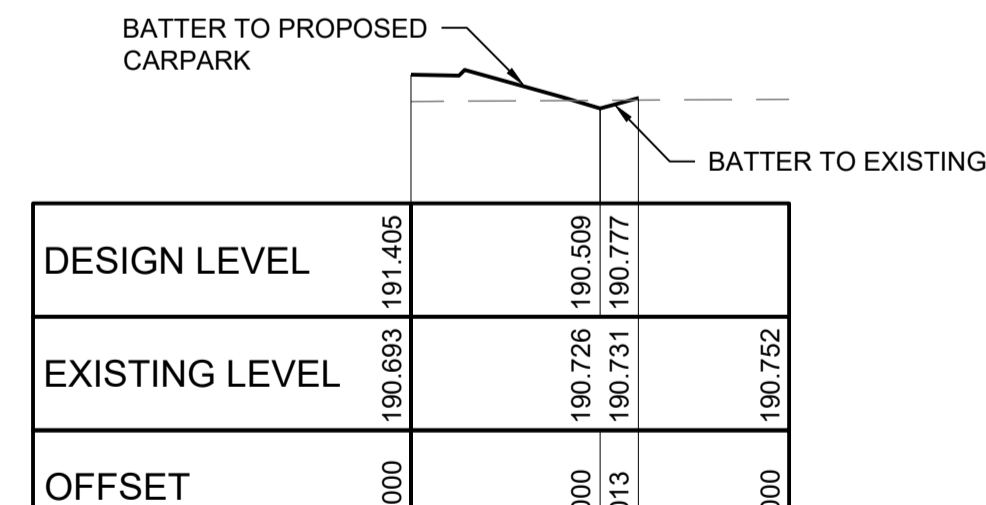

**CHAINAGE 120.00**  
HORIZONTAL SCALE 1:200  
VERTICAL SCALE 1:200

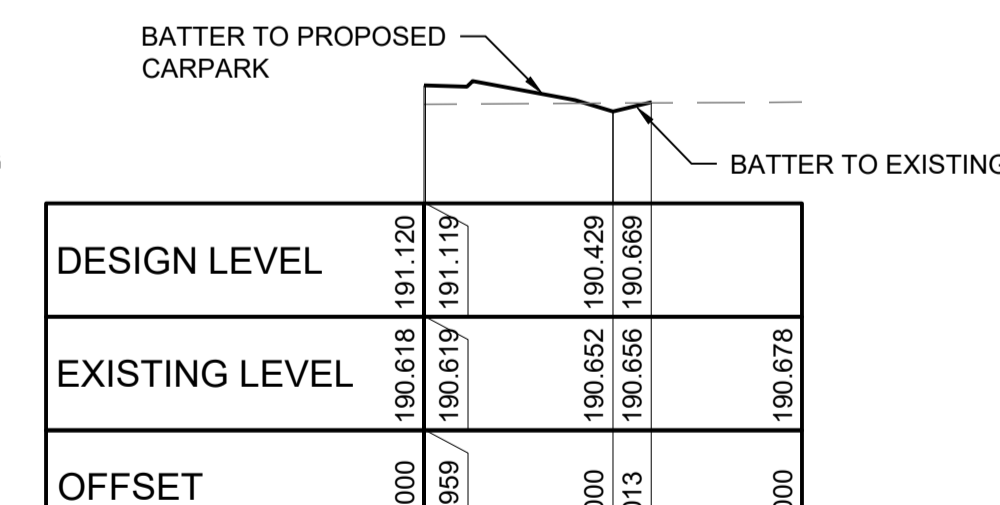

**CHAINAGE 160.00**  
HORIZONTAL SCALE 1:200  
VERTICAL SCALE 1:200

Path: X:\202003\B\_A\1\40000\SSD\CAD\Drawings\SSD\SSD\CONSTRUCTION\_X\200000\00\_Coverd  
 For Date: 22/06/2022 11:10:00 Logon Name: N52949 Cad File: \0001\NSP\_LOCAL\Drawings\40000000\Drawings\SSD\SSD\CONSTRUCTION\_X\200000\00\_Coverd.dwg  
 User: N52949

DO NOT SCALE FROM DRAWINGS, CHECK & VERIFY ALL DIMENSIONS & LEVELS BEFORE COMMENCEMENT OF ANY WORK.

THIS DRAWING IS NOT TO BE COPIED IN PART OR WHOLE WITHOUT WRITTEN PERMISSION FROM WARREN SMITH CONSULTING ENGINEERS.

**DRAWING COLOUR CODED - PRINT ALL COPIES IN COLOUR**

SCALE 1:200  
A1 SHEET

REVISION	AMENDMENT	DATE	REVISION	AMENDMENT	DATE
1	ISSUED FOR REVIEW	22/06/22			

**Built**

PROJECT: **WEE WAA HIGH SCHOOL SSD**

PREPARED BY: **Warren Smith Consulting Engineers**

WARREN SMITH CONSULTING ENGINEERS  
SINCE 1981.

NSW: 9/233 Castlereagh St, Sydney 2000 NSW Australia  
VIC: Suite 7.03, 365 Little Collins St, Melbourne 3000 VIC Australia

PH +61 (2) 9299 1312 PH +61 (3) 8648 9942  
www.warrensmith.com.au  
wsp@warrensmith.com.au

ACN 002 197 088 ABN 36 300 430 126  
Hydraulic Fire Civil Utilities Infrastructure

TITLE: **STORMWATER CHANNEL 3 CH00.00 TO CH183.93**

SCALE AS SHOWN	DRAWN N.G.	DESIGNED R.X.	CHECKED J.G.	APPROVED --
JOB No. <b>7490000</b>	DRAWING No. <b>C6.22</b>		ISSUE <b>1</b>	
DATE: MARCH 2022	STATUS: ISSUED FOR REVIEW			

**PRELIMINARY - NOT FOR CONSTRUCTION**



Name	Surface Elev. (m)	Pit Depth (m)	Pit Size and Type	From	To	Length (m)	U/S IL (m)	D/S IL (m)	Slope (%)	Pipe Type	Dia (mm)	No. Pipes
Pit 1/1	191.52	0.67	1500 SQ PIT WITH 450 X 900 CLASS D GRATE WITH 1.8m LINTEL OPENING	Pit 1/1	Pit 2/1	38.95	190.85	190.65	0.51	RCP	300	1
Pit 2/1	191.39	0.77	1500 SQ PIT WITH 450 X 900 CLASS D GRATE WITH 1.8m LINTEL OPENING	Pit 2/1	Pit 3/1	16.72	190.62	190.53	0.54	RCP	300	1
Pit 3/1	191.21	0.71	1500 SQ PIT WITH 450 X 900 CLASS D GRATE WITH 1.8m LINTEL OPENING	Pit 3/1	Pit 4/1	18.93	190.50	190.40	0.53	RCP	375	1
Pit 4/1	191.10	0.73	2000 SQ PIT WITH 450 X 900 CLASS D GRATE WITH 1.8m LINTEL OPENING	Pit 4/1	Pit 5/1	10.31	190.37	190.31	0.58	RCP	375	1
Pit 5/1	191.06	0.78	1500 SQ PIT WITH 450 X 900 CLASS D GRATE WITH 1.8m LINTEL OPENING	Pit 5/1	Pit 6/1	8.5	190.28	190.23	0.59	RCP	375	1
Pit 6/1	191.01	0.81	1500 SQ PIT WITH 450 X 900 CLASS D GRATE WITH 1.8m LINTEL OPENING	Pit 6/1	Pit 7/1	9.70	190.20	190.15	0.52	RCP	375	1
Pit 7/1	191.05	0.93	1200 SQ PIT WITH CLASS B COVER	Pit 7/1	Pit 4/5	69.50	190.12	189.77	0.50	RCP	600	1
Pit 1/2	191.05	0.69	900 SQ PIT WITH CLASS B COVER	Pit 1/2	Pit 2/2	22.5	190.36	190.24	0.53	RCP	300	1
Pit 2/2	191.03	0.82	900 SQ PIT WITH CLASS B COVER	Pit 2/2	Pit 3/2	24.3	190.212	190.09	0.50	RCP	375	1
Pit 3/2	190.8	0.74	900 SQ PIT WITH CLASS B GRATE	Pit 3/2	HEADWALL	19.8	190.06	189.96	0.51	RCP	375	1
Pit 1/3	191.01	0.55	900 SQ PIT WITH CLASS B GRATE	Pit 1/3	Pit 2/3	30.5	190.462	190.31	0.50	uPVC	225	2
Pit 2/3	190.95	0.67	900 SQ PIT WITH CLASS B GRATE	Pit 2/3	Pit 3/3	13.2	190.276	190.21	0.50	uPVC	225	2
Pit 3/3	191.09	0.91	900 SQ PIT WITH CLASS B COVER	Pit 3/3	Pit 4/3	13.3	190.182	190.11	0.54	RCP	525	1
Pit 4/3	191.01	0.93	900 SQ PIT WITH CLASS B COVER	Pit 4/3	Pit 5/3	23.8	190.079	189.96	0.50	RCP	525	1
Pit 5/3	190.87	0.94	900 SQ PIT WITH CLASS B GRATE	Pit 5/3	HEADWALL	18.2	189.925	189.83	0.52	RCP	600	1
Pit 1/4	191.33	0.58	900 SQ PIT WITH 450 X 900 CLASS D GRATE WITH 1.8m LINTEL OPENING	Pit 1/4	HEADWALL	3.3	190.75	190.69	1.82	uPVC	225	1
Pit 1/5	190.93	0.77	900 SQ PIT WITH CLASS B COVER	Pit 1/5	Pit 2/5	16.8	190.16	190.07	0.54	uPVC	225	1
Pit 2/5	190.81	0.77	900 SQ PIT WITH CLASS B COVER	Pit 2/5	Pit 3/5	24.1	190.04	189.92	0.50	uPVC	225	1
Pit 3/5	190.74	0.85	900 SQ PIT WITH CLASS B GRATE	Pit 3/5	Pit 4/5	24.4	189.89	189.77	0.49	RCP	300	1
Pit 4/5	190.70	0.96	900 SQ PIT WITH CLASS B GRATE	Pit 4/5	HEADWALL	19.3	189.74	189.62	0.62	RCP	600	1
Pit 1/6	190.95	0.51	900 SQ PIT WITH CLASS B GRATE	Pit 1/6	Pit 2/3	16.14	190.443	190.37	0.45	uPVC	225	2
Pit 1/7	190.44	0.70	900 SQ PIT WITH CLASS B GRATE	Pit 1/7	HEADWALL	60	189.739	189.44	0.50	RCP	375	1
Pit 1/8	191.08	0.75	1200SQ WITH CLASS B GRATE	Pit 1/8	Pit 2/2	15.2	190.33	190.25	0.53	RCP	375	1
Pit 1/8	191.08	0.75	1200SQ WITH CLASS B GRATE	Pit 1/8	Pit 3/3	16.4	190.33	190.22	0.67	RCP	375	1
Pit OF/1	190.90	0.60	HEADWALL	Pit OF/1	Pit 7/1	7.2	190.3	190.15	2.08	RCP	375	2
Pit EX/1	190.92	0.50	2400 SQ PIT WITH 450 X 900 CLASS D GRATE WITH 1.8m LINTEL OPENING	Pit EX/1	HEADWALL	9.71	190.42	190.22	2.06	RCP	900 X 300 (BOX CULVERT)	2

PRELIMINARY - NOT FOR CONSTRUCTION

Path: X:\2020\0310\_1119\_10 Login Name: NG:qph  
 Plot Date: 22/06/2022 11:19:10  
 Cad File: I:\001\NSP\_LOCAL\Drawings\400\001\Drawings\Civil\20\Issues for Review\C6.31 Stomwater Pit Schedule.dwg

DO NOT SCALE FROM DRAWINGS, CHECK & VERIFY ALL DIMENSIONS & LEVELS BEFORE COMMENCEMENT OF ANY WORK.  
 THIS DRAWING IS NOT TO BE COPIED IN PART OR WHOLE WITHOUT WRITTEN PERMISSION FROM WARREN SMITH CONSULTING ENGINEERS.

DRAWING COLOUR CODED - PRINT ALL COPIES IN COLOUR

REVISION	AMENDMENT	DATE	REVISION	AMENDMENT	DATE
1	ISSUE FOR REVIEW	22/06/22			

CLIENT



PROJECT

**WEE WAA HIGH SCHOOL SSD**

PREPARED BY



**WARREN SMITH CONSULTING ENGINEERS**  
SINCE 1981.

NSW: 9/233 Castlereagh St. Suite 7-03, 365 Little Collins St  
 Sydney 2000 NSW Australia Melbourne 3000 VIC Australia

PH +61 (2) 9299 1312 PH +61 (3) 8648 9942

www.warrensmith.com.au  
 wsp@warrensmith.com.au

ACN 002 197 088 ABN 36 300 430 126



Hydraulic Fire Civil Utilities Infrastructure

<b>STROMWATER PIT SCHEDULE</b>				
SCALE	DRAWN	DESIGNED	CHECKED	APPROVED
AS SHOWN	N.G.	N.G.	J.G.	--
JOB No.	DRAWING No.		ISSUE	
<b>7490000</b>	<b>C6.31</b>		<b>1</b>	
DATE	STATUS			
MARCH 2022	ISSUED FOR REVIEW			