



Waitara Public School upgrade

Frequently asked questions

What is being delivered in the upgrade of Waitara Public School?

The project is being staged to allow school operations to continue during the construction. The upgrade will provide:

Stage 1:

- New main entry
- 38 new permanent teaching spaces
- two existing permanent teaching spaces converted to special program rooms
- new staff and administration facilities
- new hall
- new canteen
- upgraded core facilities, such as increased library space, distributed within the new building
- landscaping and play areas

Stage 2:

- heritage garden
- staff carpark upgrade
- landscaping works

When are classes being relocated?

Classes will be relocated to the new buildings to ensure students can use their new learning spaces from Monday 18 May 2020.

Will there be any change to the school entrances?

Yes. From Monday 18 May, the main entrance will be on Myra Street as illustrated on the site map.

When will Stage 2 works commence?

The contractor will begin the removal of demountable classrooms on Saturday 16 May to enable the start of Stage 2 construction.

How will the operational area of the school be safely separated from the construction area?

The construction site will continue to be separated with a hoarding, the same barrier that is currently being used to separate the school's operational and construction zones.

Will there be any changes to the existing bus stop locations and/or the kiss and drop location?

No. The kiss and drop will remain on Myra Street and the bus stop will remain on Edgeworth David Avenue.

How is traffic being managed?

To ensure the safety of students, staff, the local community and our site workers, traffic management is implemented as required. This includes the use of on-site traffic control personnel to manage entry and exit of construction vehicles. Site vehicles must give way to pedestrians at all times. Wherever possible, deliveries to site are being scheduled outside of school drop off/pick up times.

For more information about this project contact School Infrastructure NSW:

Website: schoolinfrastructure.nsw.gov.au

Email: schoolinfrastructure@det.nsw.edu.au

Phone: 1300 482 651

For information about school activities and operations, contact the school directly:

Principal: Dany Coelho

Website: waitara-p.schools.nsw.gov.au

Email: waitara-p.school@det.nsw.edu.au

Phone: 02 9489 3105

Waitara Public School (Stage 1)

Welcome pack



Waitara Public School upgrade

Welcome to your school

We're excited that Stage 1 of the upgrade to Waitara Public School is complete and ready for you to use.



38 new permanent teaching spaces



Two existing permanent teaching spaces converted to special programs rooms



A new hall



A new canteen



New staff and administration facilities



Upgraded core facilities, such as increased library space distributed within the new building

Thank you for your patience during construction. We are thrilled to deliver this project for the school community.



New innovative learning space at Waitara Public School

Message from your Principal

We are extremely excited to be able to transition all students and staff into our new build. The 38 new learning hubs are innovative, connected, flexible and fully equipped with the latest technology. Each floor has Maker's Spaces, relaxing library areas and teacher hubs. The contemporary hubs were built to accommodate authentic teaching and learning practices delivered in a collaborative environment that will equip students with deep knowledge, skills and competencies for now and the future.

The new landscaping includes aesthetically pleasing outdoor spaces and a community garden.

We welcome the new staff administration space to plan and meet, as we lead collaborative learning ensuring high quality programming for our student's needs.

We look forward to utilising the new spaces to continue our delivery of innovation and excellence in education this year and beyond. We thank you for your patience during construction. We are excited to deliver this project for our Waitara school community.

Dany Coelho, Principal

Innovative learning environments

The upgrade to Waitara Public School has been completed. This exciting project now delivers innovative learning environments for the next generation of young minds.

Innovative learning environments provide flexibility where teachers can provide opportunities for student engagement. The learning spaces:

- are adaptable to accommodate small or large groups
- include learning neighbourhoods with flexible spaces that allow students to use technology in a variety of settings
- provide opportunities to enhance skills in collaboration, communication, critical thinking, problem solving and creativity.

Term 2 2020

Stage 1 of Waitara Public School upgrade is finished and will be ready for operation from Monday 18 May 2020.

This exciting project is delivering new and flexible learning environments for the next generation of students.

All classes have been relocated to the Stage 1 building to ensure students can use their new learning spaces on Monday 18 May. The move has been arranged in close consultation with the Principal and is being managed by a professional removalist/relocation company.

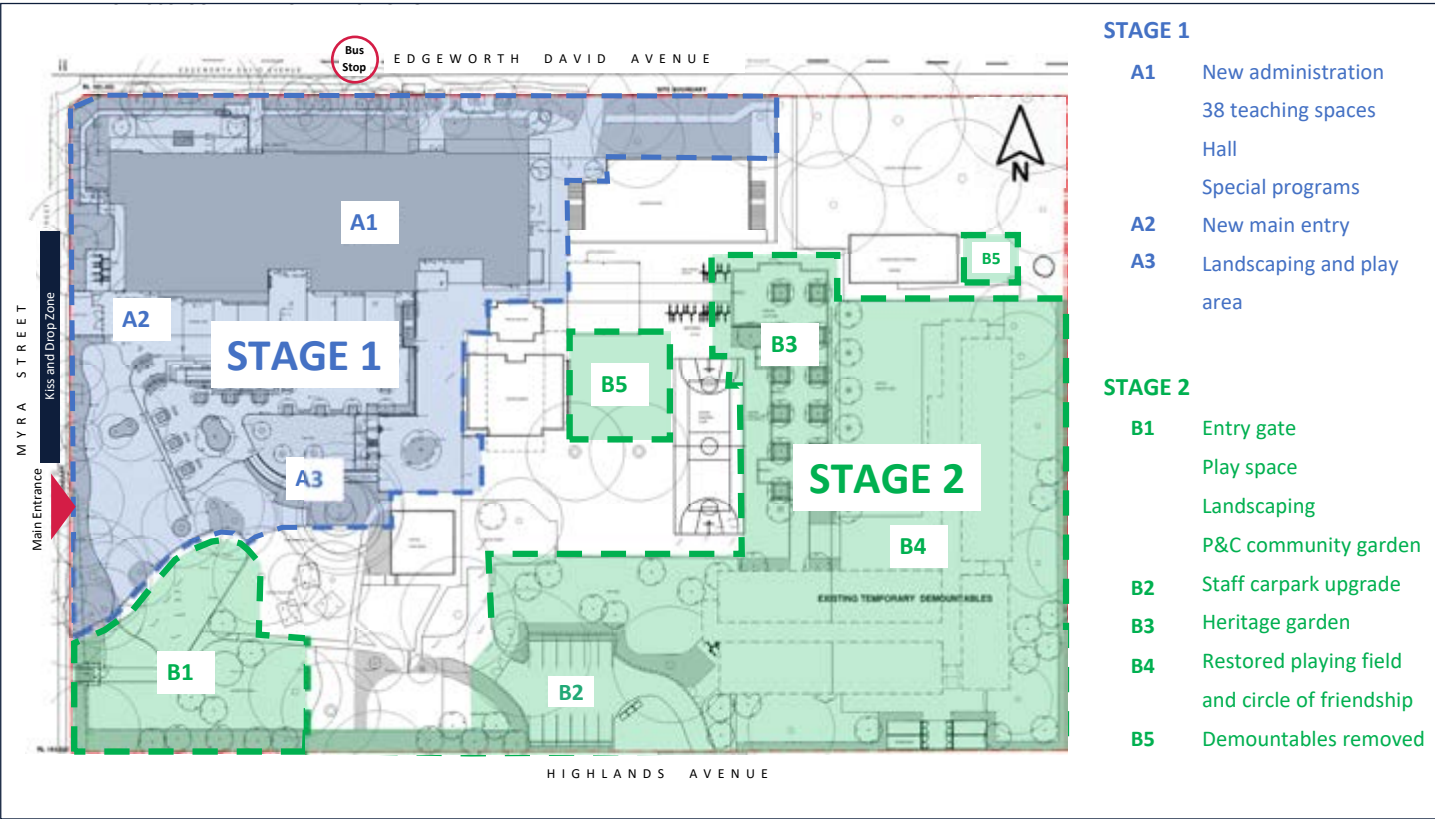

Waitara Public School Redevelopment Staging Plan

Project timeline

Construction of Stage 2 will commence mid-May and continue through until September 2020. We will keep the community updated on progress.

