

Frequently asked questions

How were the concept designs developed?

Workshops were held with staff, students and other stakeholders to understand what kinds of learning and recreation spaces Tweed Heads South Public School needs and wants.

These factors, together with current trends in education and learning, were used to guide the scope of work and concept design process.

Are plans likely to change?

Schematic designs are still being finalised in consultation with the Principal and staff, and we are working through the planning approval and tender process.

Some aspects of the design may change as we move through these processes, but the overall approach to the upgrade is likely to remain the same.

Will we need to move to a pop-up school during construction?

The preferred approach is to deliver the upgrade in stages so that the school can continue to operate on the current site during construction.

The staging approach and any impacts on school operations will be confirmed after the main works contractor is engaged.

What can I expect during construction?

During construction our contractors will follow rigorous processes to ensure the safety of students, staff, contractors, parents and other visitors.

We will work closely with the Principal to minimise any disruption throughout the project.

When will the project be finished?

The forecast completion date is currently late 2021.

We will keep you informed of any changes to the planned completion date.

How will parking and traffic be managed during and after construction?

We are in the process of finalising a Traffic Management Plan for the project which will be submitted to Tweed Shire Council as part of the Development Application (DA).

Once the DA has been submitted Council will notify adjoining and neighbouring owners that may be affected by the development. You will have the opportunity to provide feedback on traffic management at that time.

How can I get involved?

Your feedback is important to us. We are committed to working together with our school communities and stakeholders to deliver the best possible learning facilities for students.

It is not always possible to implement everyone's suggestions but we will work with school communities to ensure we have considered what is important to you.

Stay informed



Website

Stay up to date by visiting the School Infrastructure NSW website schoolinfrastructure.nsw.gov.au



Email

Contact the Community Engagement team by emailing schoolinfrastructure@det.nsw.edu.au



Phone

Contact us between 9am and 5pm, Monday to Friday on **1300 482 651**

Tweed Heads South Public School upgrade

Information pack

March 2020



Artist impression of the Tweed Heads South Public School upgrade

A project is underway to upgrade Tweed Heads South Public School. The upgrade will include:



11 new future focused learning home bases



New library



Redeveloped school entry



Improved playground and open space



New OOSH facilities



Project values

- Sense of place and belonging including connection to Indigenous culture
- Enabling future focused learning and flexibility in learning
- Whole school connections including connection with the preschool
- A school that enables an engaged community

Desired spaces

- Outdoor spaces for play and sports
- Flexible learning spaces
- A connected campus
- Enhanced library
- Out of School Hours Care

Proposed site plan

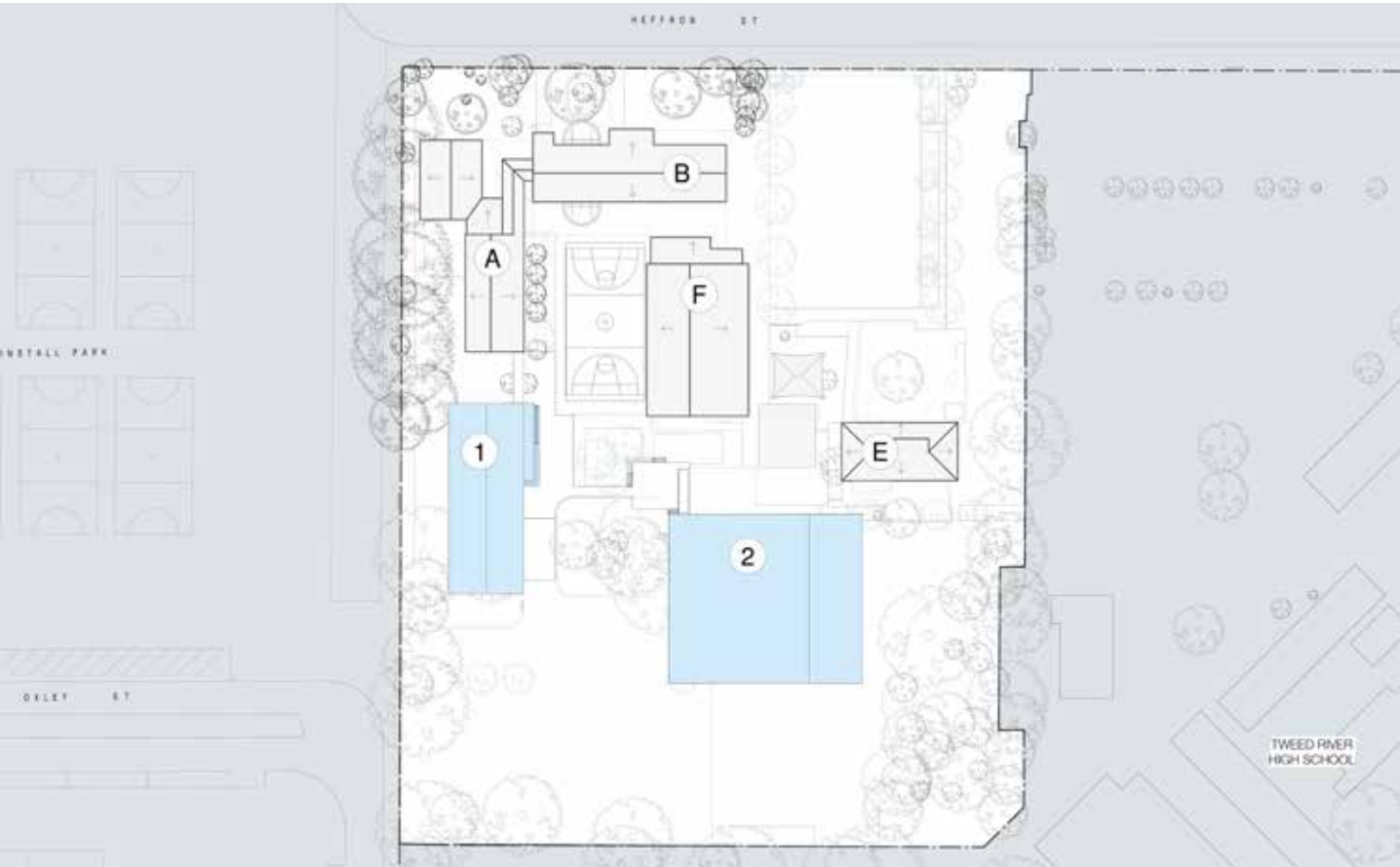

Progress summary

Concept designs for the upgrade have been developed and schematic designs are being prepared.

A tender has been released for an early works (Stage 1) package and a contractor will be engaged in March.

A main works (Stage 2) tender package will be prepared once schematic designs have been completed.

Early works

Early works at Tweed Heads South Public School will include:

- Demolition of existing canteen to create new entry
- Construction of new canteen and entry undercroft and associated landscaping
- Reconfiguration of entry gates, fences and footpaths to respond to new entry
- Provision of temporary canteen during construction period.

Timeline

