

Tweed Heads South Public School

Welcome Pack – September 2024



Tweed Heads South Public

Welcome to your upgraded school

We're excited that the new Tweed Heads South Public School is now complete and ready for you to use.

Thank you for your patience during construction. We are thrilled to deliver this project for the community.

The new permanent school facilities include:



11 new modern classrooms



New Library



Sports court and outdoor play spaces



New administration and staff facilities



Extended and refurbished preschool



New entrance



Aboriginal design garden in consultation with community



New canteen and Out of School Hours (OOSH) care facilities



For more information

Phone: 1300 482 651

Email: schoolinfrastructure@det.nsw.edu.au

Website: schoolinfrastructure.nsw.gov.au

Message from your Principal

On behalf of Tweed Heads South Public School, I welcome everyone to our new school campus. Tweed Heads South Public School is located by the Tweed River and surrounded by sacred mountain ranges on the far north coast of NSW. It has a proud history of providing a vibrant, caring and successful educational environment where all children learn and develop as individuals.

Established in 1958, Tweed Heads South Public School is culturally significant for the Minjungbal/ Ngwahal people of the Bundjalung Nation. The school's location is alongside state-of-the-art sporting facilities and Tweed River High School learning hub which guarantees a smooth transition from preschool to Year 12 and easy access to a range of excellent educational opportunities.

At Tweed Heads South Public School, we aim to achieve excellence through high expectations and evidence-based teaching in engaging, safe, supportive surroundings. A unique feature of our school is that we host the only onsite Department of Education preschool in the region fostering a seamless educational journey from the earliest stages of learning. Additionally, we have established support classes designed to assist students in their learning in a supportive and inclusive environment.

Major capital works have recently been completed resulting in 11 new permanent teaching spaces, a new library, a new canteen, a new Out of School Hours (OOSH) care facility, a refurbished Early Learning Centre (ELC), administration spaces and improved playground and outdoor spaces. The flexible and contemporary indoor/outdoor learning spaces promote curiosity, critical thinking, problem solving and creativity within a student-centred learning environment.

Our students are motivated to achieve success through a wide variety of artistic, cultural, musical, sporting, and academic development programs specifically tailored to individual interests and strengths. We empower our students to foster a love of learning and provide them with the skills and knowledge to participate in their community at a local and global level to support them as lifelong learners.

Community partnerships and authentic relationships between home, school and staff are highly valued and nurtured. The school's wellbeing approach focuses on providing an effective environment for learning and recognises that wellbeing and engagement are important conditions for success. Our staff ensure every child is known, valued, and cared for.

A highly active and involved parent body works in partnership with the staff and members of the wider community to maintain the strong and supportive spirit that is embodied in the school's values of being resilient, respectful, responsible, vibrant, caring and successful students ensuring the best possible outcomes for all.

At Tweed Heads South Public School we encourage students to be the best they can be reaching their maximum potential. I look forward to welcoming you into our school community and working with both your family and your children at our wonderful school.

Felicity Henderson

School Principal

Tweed Heads South Public School

Connecting with Country

Key features of the upgrade are the Aboriginal design garden and the new front entrance to the school. The community was deeply involved in the design process of these areas, creating spaces that reflect the stories of the land and the totems significant to the Tweed Heads area and school. From an aerial view, the Aboriginal design garden resembles an Aboriginal dot painting artwork with artworks sandblasted onto the concrete from the school's past and present families and students. Each classroom is named after animals in the local Aboriginal language, and the school has an Aboriginal Language program specifically designed to teach students the local Aboriginal language.



School entrance



Aboriginal design garden

New school map

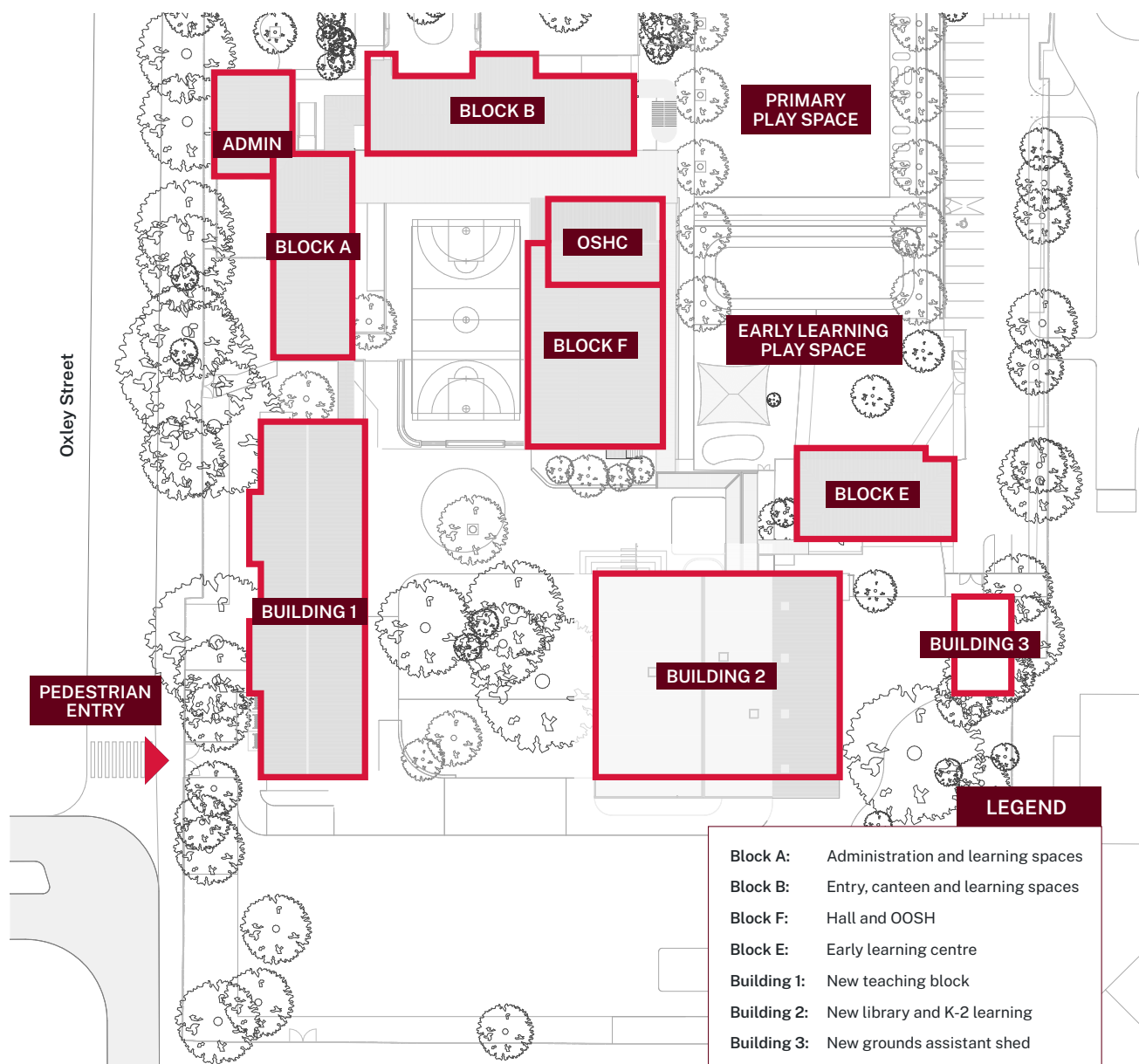

Contact us

For information about school activities and operations, contact the school directly:

Principal: Felicity Henderson

Website: tweedhdest-p.schools.nsw.gov.au

Email: tweedheads-p.school@det.nsw.edu.au

Phone: 07 5524 3408

For more information about this project, contact School Infrastructure NSW:

Website: schoolinfrastructure.nsw.gov.au

Email: schoolinfrastructure@det.nsw.edu.au

Phone: 1300 482 651