

Tumbulgum Public School

Project update | December 2024

Image caption: Artist's impression Tumbulgum Public School



Investing in our schools

The NSW Government is committed to rebuilding flood affected schools in the Northern Rivers region, ensuring we build back better with flood resilient schools for local students and local communities.

Funding for the school projects has also been provided by the Infrastructure Betterment Fund, which is jointly funded by the Australian and NSW Governments through the Disaster Recovery Funding Arrangements.

Project overview

As part of this commitment, a project is underway to rebuild Tumbulgum Public School after it was extensively damaged during floods in early 2022. The project will deliver a raised and more flood resilient school for students and staff, with modern classrooms, a new library, canteen, administration spaces, and landscaping.

Progress update

- Our planning application to rebuild Tumbulgum Public School is being assessed by the Department of Education as a Review of Environmental Factors (REF) under the *Environmental Planning Assessment Act 1979*. The REF was on public exhibition from 17 October -7 November 2024.
- The school has chosen furniture, fixtures and finishes through the Project Reference Group. This includes all new furniture for the classrooms, library and administration spaces.
- We have appointed the subcontractor for the offsite manufacturing of the school building modules.
- As part of ongoing consultation, a Walk on Country was held with the Tweed Wollumbin Aboriginal Education Consultative Group and local community on 23 October 2024 to ensure the school planting, design and daily operations reflects the cultural heritage of the school site and surrounding area.



Email: schoolinfrastructure@det.nsw.edu.au
Phone: 1300 482 651
schoolinfrastructure.nsw.gov.au

Next steps

- [As we advised in October](#), the temporary school buildings will be relocated on the school site during the summer holidays and ready for students on their first day back in 2025. You can see where the new location and layout of the temporary buildings on the map on the next page. We will remove all demountable buildings when the new school is completed.
- We will be conducting an Aboriginal Culture Heritage Assessment on the school site **during January** to assess what it required to be undertaken before, during and after any construction activity to ensure compliance with the Heritage NSW. This will determine if an Aboriginal Heritage Impact Permit (AHIP) is required. You may notice machinery and people on the school site as part of this work.
- Once all planning approvals are in place, we will begin site establishment and preparations of rebuilding. This includes consultations with the school community about how best to recognise and celebrate the long history of Tumbulgum Public School through a Heritage Interpretation Strategy.

As soon as we have planning approvals in place, we will update the school and community about the next steps. We are expecting Tumbulgum Public School staff and students to move into their new flood resilient school during 2025.

Holiday contact details

School Infrastructure will be closed from 5pm Friday 20 December 2024 to 9am Monday 6 January 2025, inclusive. You can continue to contact us during this time, and we will get back to you after we return. In an emergency, please call triple zero (000).

More information









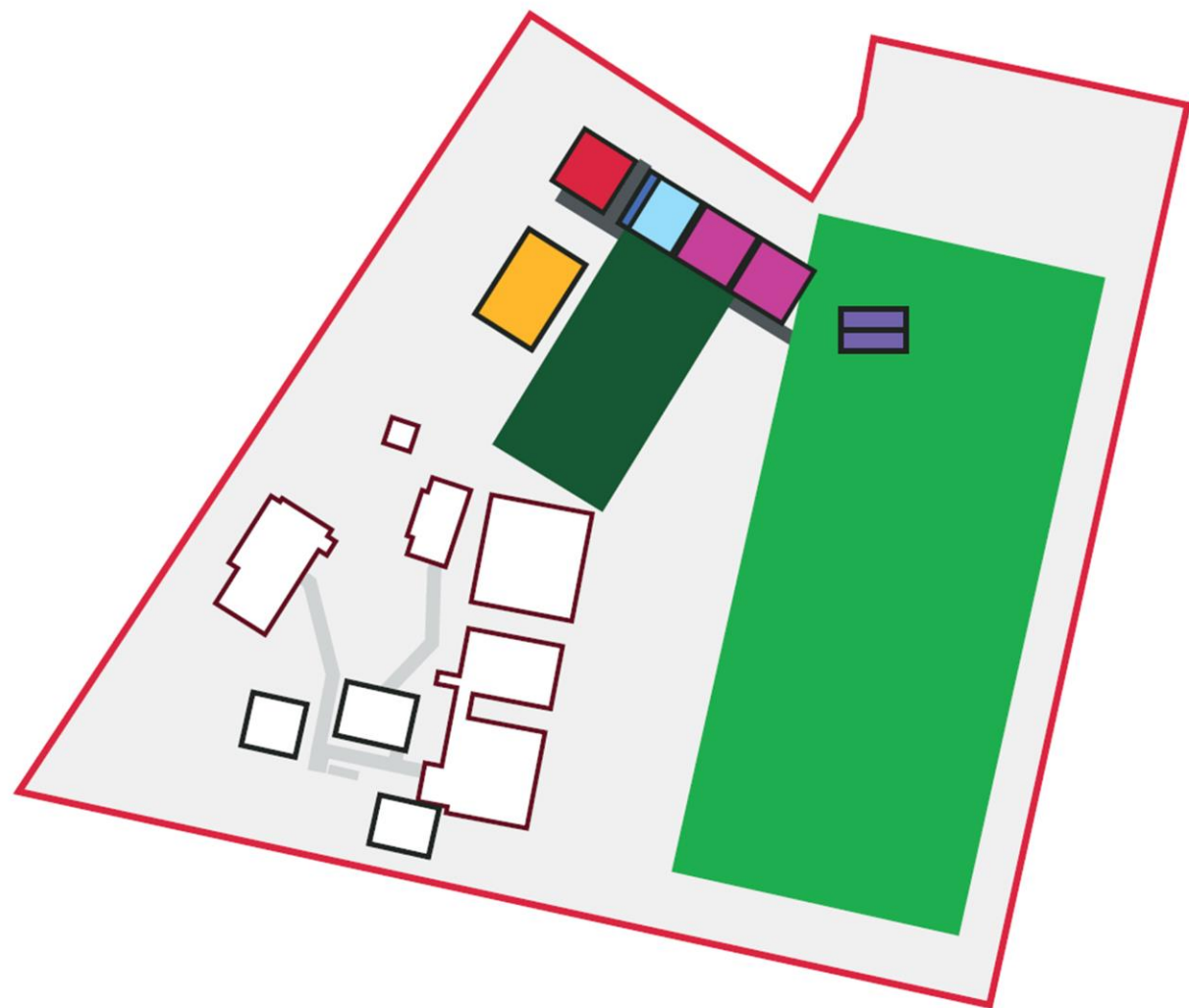

You can find more information about the project at <https://edu.nsw.link/TumbulgumPS> or by scanning the QR code to the left.

If you have any questions about this project, you can contact School Infrastructure during business hours on the contact details below.

Tumbulgum Public School temporary school layout – Term 1 2025



Legend		
	Site boundary	 Classroom
	School office and administration	 Storage
	Principal and library	 Toilets
		 Sports court
		 Sports oval
		 Play equipment