

Project overview

The Forest High School is part of the re-zoning and planning framework for Frenchs Forest to create a new town centre for the community. The Forest High School will be relocated to a portion of 187 Allambie Road, Allambie Heights. This is located within the current intake area for The Forest High School.

Student learning will continue at the current school site until the new facilities are built.

The project will apply for planning approval through the State Significant Development (SSD) application process to the Department of Planning, Industry and Environment (DPIE) in early 2022.



Modern flexible learning spaces
for up to **1500** students



New library, canteen and
administration spaces



Multi-purpose sports
and performance hall



New outdoor sports courts,
landscaped recreation and outdoor
learning spaces



Aerial view of the proposed school design looking from Allambie Road

The Forest High School relocation

For more information phone: 1300 482 651
Email: schoolinfrastructure@det.nsw.edu.au

The high school features



Visual arts, wood and metalwork workshops



Innovative design principles and focus on accessibility and sustainability (5 Star Green Star accreditation)



Library with senior study spaces and meeting areas



Technology-rich teaching and learning spaces



Performance spaces, fitness and movement studios



Green open spaces, gardens and landscaping across the school



Hospitality and kitchen spaces



Outdoor learning areas



Learning spaces for specialist support classes



Sports courts, playing field

The Forest High School relocation

For more information phone: 1300 482 651
Email: schoolinfrastructure@det.nsw.edu.au

Flexible learning spaces

Contemporary learning and teaching prepares students for a diverse and interconnected world. We are evolving the ways we teach our students new skills that are valued by a changing workforce by understanding there are different ways students learn as well as supporting new ways to interact with information through technology.

Flexible learning spaces are designed and equipped to support contemporary learning and teaching.

What makes a flexible learning space?



Learning space

- Different zones (areas of a building or floors) are designed to support a range of activities sometimes grouped by subject area.
- Varied furniture allows for student choice, comfort and flexibility.
- Spaces are flexibly connected allowing students to work in varied group sizes.
- Connection between indoor and outdoor learning spaces.

Organisation

- Movement is encouraged for students and teachers to collaborate and interact.
- More than one teacher may be available to students within the learning environment.
- Students learn in classes, small groups or individually.

Teaching and learning

- Learning is personalised.
- Learning is connected across different subject areas.
- There is a focus on creativity and innovation with students prototyping, testing and using technology in creative ways.

Technology

- Technology is integrated into spaces to extend learning opportunities.
- WiFi is available everywhere including outdoors.
- Specialist equipment is available for students to innovate, communicate and create.

The Forest High School relocation

For more information phone: 1300 482 651
Email: schoolinfrastructure@det.nsw.edu.au

Site layout



The Forest High School relocation

Layout of facilities

The layout of learning spaces and facilities have been determined in line with the department’s Educational Facilities Standards and Guidelines, and with consideration of spatial requirements, site constraints, access and operational needs of the high school.

North east view

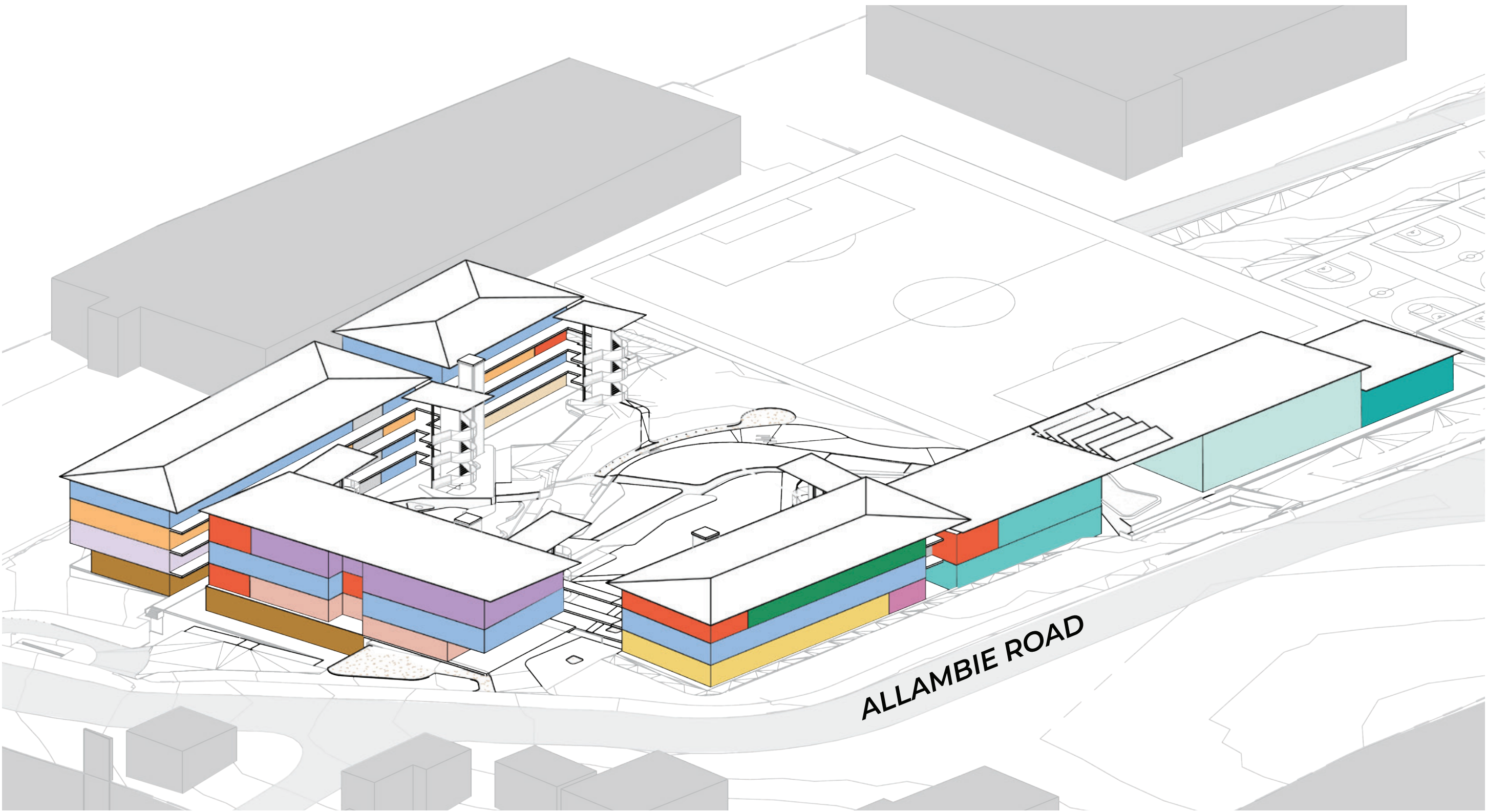

South west view

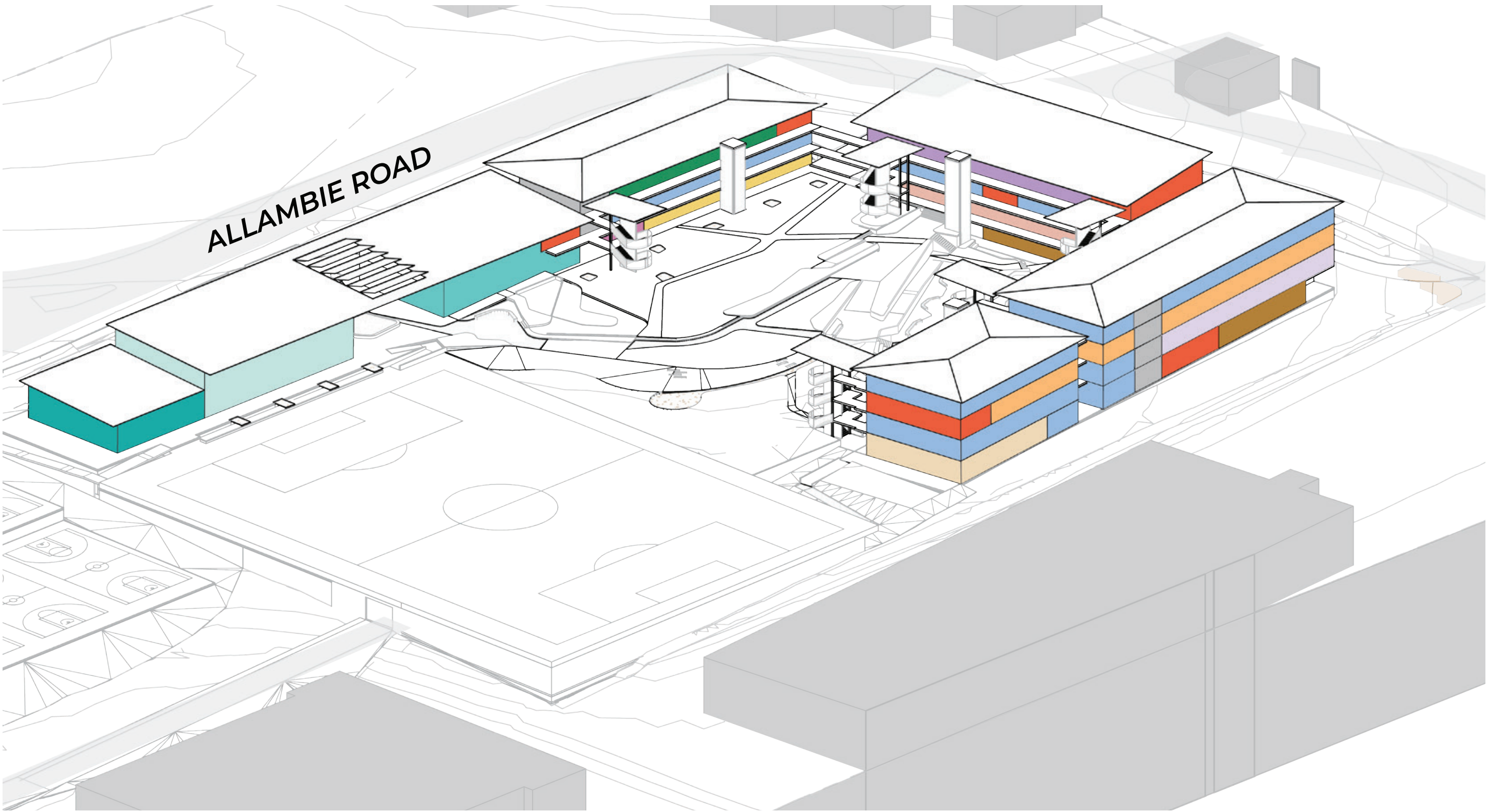

- Canteen Unit
- Gymnasium
- Student Amenities
- Administration Hub Unit
- Food + Textiles Hub
- General Learning Units
- Fitness/ Performance Hub
- General Learning Spaces (Support)
- Library
- Movement Studio
- Science Hub
- Change Rooms + Store
- Staff Support
- Visual Arts Hub
- Wood & Metal Work Hub

The Forest High School relocation

For more information phone: 1300 482 651
Email: schoolinfrastructure@det.nsw.edu.au

Artist impressions

The design of the school has considered maximising connection with outdoor spaces and connectivity and accessibility throughout the school site. The design seeks to retain as many mature trees and bushland areas as possible while also providing all the needs of a modern high school.



Aerial view of the proposed school design looking from Allambie Road



The view into the school heart from the playing field



View of the main entrance off Allambie Road (looking west)

Artist impressions only. School design may change as part of ongoing design development.

Next steps

- The final business case will submitted for government approval in the coming weeks.
- As part of the SSD application, we will prepare an Environmental Impact Statement (EIS). The EIS contains technical studies to consider matters such as traffic, noise, operations, ecology, bushfire and construction management. The technical studies involve research, site investigations, surveys and assessments, data analysis, and community and stakeholder consultation and can be viewed when the SSD application is placed on public exhibition in the coming months.
- Consultation with Northern Beaches Council, Transport for NSW and other key stakeholders is currently underway as we carry out the technical studies, detailed site investigations and design development.
- There is an existing development application approved by Council for demolition works on the site. Under this planning approval, early works are anticipated to start in mid 2022 to demolish buildings (McLeod House) and prepare the site for main construction. More information about the early works will be shared with community before it starts.

Timeline

**The below timeline shows indicative dates only. The completion date will be confirmed should the SSD application be approved and a delivery program has been finalised.*

