

Tamworth Public School

Works notification

July 2020

Notification of planned traffic changes impacting Tamworth Public School

An upgrade is underway at Tamworth Public School to deliver seven new permanent classrooms and a new hall.

This works notification is to inform you of the planned traffic and pedestrian changes impacting Tamworth Public School. The traffic changes are required to enable the temporary road closures for deliveries and concrete pours. This is a continuation of the traffic and pedestrian impacts that began 3 June 2020.

When will the traffic and pedestrian impacts start and finish?

The traffic and pedestrian impacts will continue from Wednesday 5 August 2020 until Friday 9 October. The work will take approximately four weeks and will be finished by early September 2020, weather permitting.

What are the construction hours?

Work will occur between 7:00am and 5:00pm, Monday to Saturday, as per the DA approved construction hours. No work will take place on Sundays or public holidays.

What are the traffic and pedestrian impacts?

From Wednesday 5 August 2020 until Friday 9 October 2020 traffic and pedestrian diversions will be in place from 7:00am until 2:00pm. Traffic controllers will be in place to provide safety, convenience and efficient management and control of vehicle and pedestrian traffic around the worksite.

Students and staff will continue to have pedestrian access via the Napier Street and Bourke Street gates.

A temporary 'stop and go' road closure will be in place on Brisbane Street from the teachers' car park to Napier Street. (See map overleaf for details).

The temporary closure is required to ensure the safe delivery of materials and equipment to the construction site.

What safety measures will be in place?

The works pose no risk to the local community and will be conducted in accordance with Safe Work NSW requirements and the area will be isolated within the construction zone.

The safety of the school community and local community is our top priority. During construction, the contractors will follow rigorous processes to ensure the safety of students, staff, contractors, parents and other visitors to the site is maintained.

If you have any queries relating to the ongoing work at Tamworth Public School, please contact School Infrastructure NSW using the contact information below.

Work location:

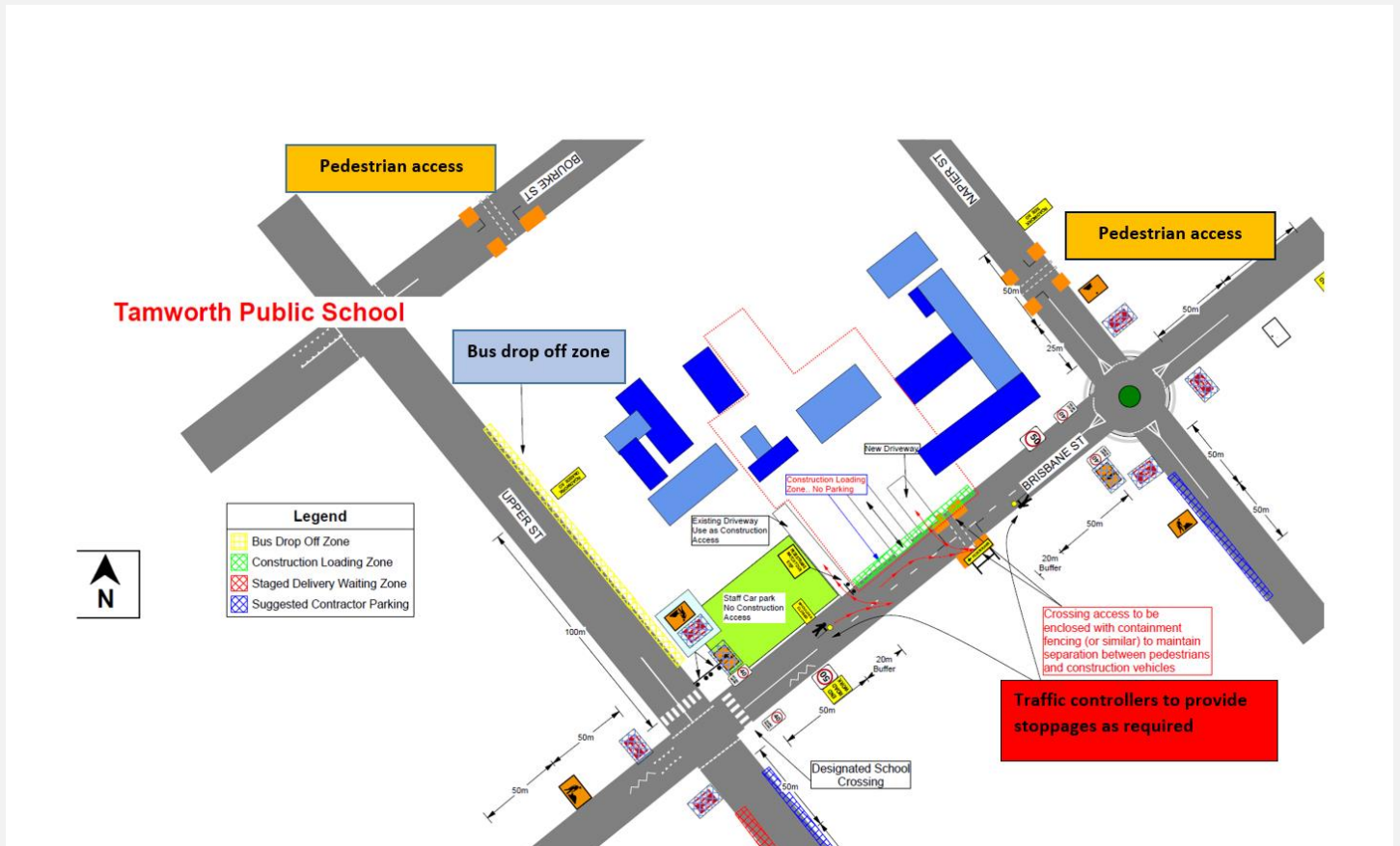

For more information contact:

School Infrastructure NSW
Email: schoolinfrastructure@det.nsw.edu.au
Phone: 1300 482 651
www.schoolinfrastructure.nsw.gov.au/