

Tallawong Public School

As part of the NSW Government’s plan to rebuild public education, the 2024-25 Budget is delivering record education funding, including \$3.6 billion for new and upgraded schools in Western Sydney. This targeted investment will ensure growing communities get access to a world class public education.

A project is underway to deliver permanent facilities for Tallawong Public School which is currently operating in temporary facilities.

The project will deliver a new school which will provide:

- 

New modern classrooms
- 

New learning support classrooms
- 

New multipurpose hall and a covered outdoor learning area (COLA)
- 

New sports court and play areas
- 

Fully accessible spaces, parking and landscaping



Tallawong Public School

For more information
Phone: 1300 482 651
Email: schoolinfrastructure@det.nsw.edu.au
Website: schoolinfrastructure.nsw.gov.au





Project summary and next steps

The Department of Planning Housing and Infrastructure (DPHI) has approved the State Significant Development (SSD) application for the project. The construction contract will be awarded shortly and we expect to begin works in the coming weeks.

Timeline

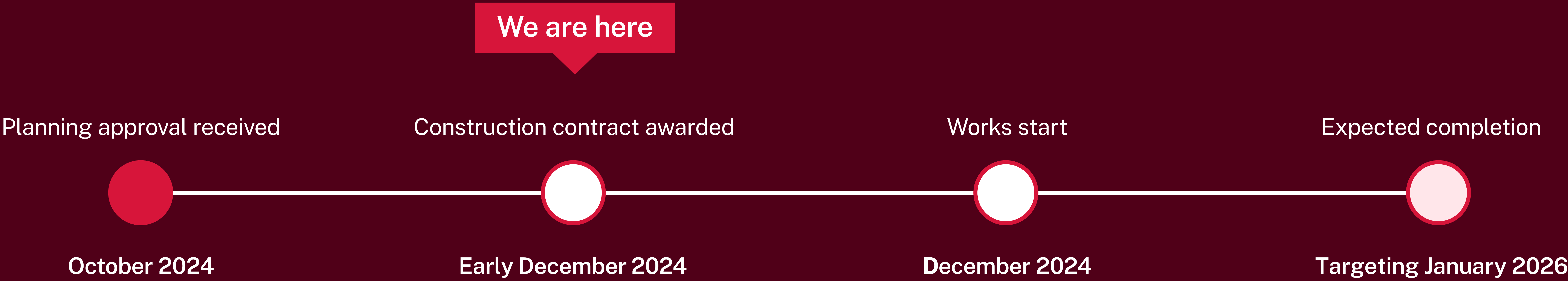

Tallawong Public School

For more information
Phone: 1300 482 651
Email: schoolinfrastructure@det.nsw.edu.au
Website: schoolinfrastructure.nsw.gov.au



Landscape site plan

LEGEND

 Site boundary

 Proposed Trees

 Existing Trees to be Retained

 Main Entrance

 Alternative School Entry

 Play area

 Sitting area

 Nature Play

 Structured Play

 Outdoor Learning

 Rain Garden

 Screen Planting (Native hedge)

 Productive/Community Gardens

 Support Classrooms

 Admin/Staff facilities

 Library/Community Hall

 Staff car park

 COLA

 Multi-sport Court

 Kick-around Space

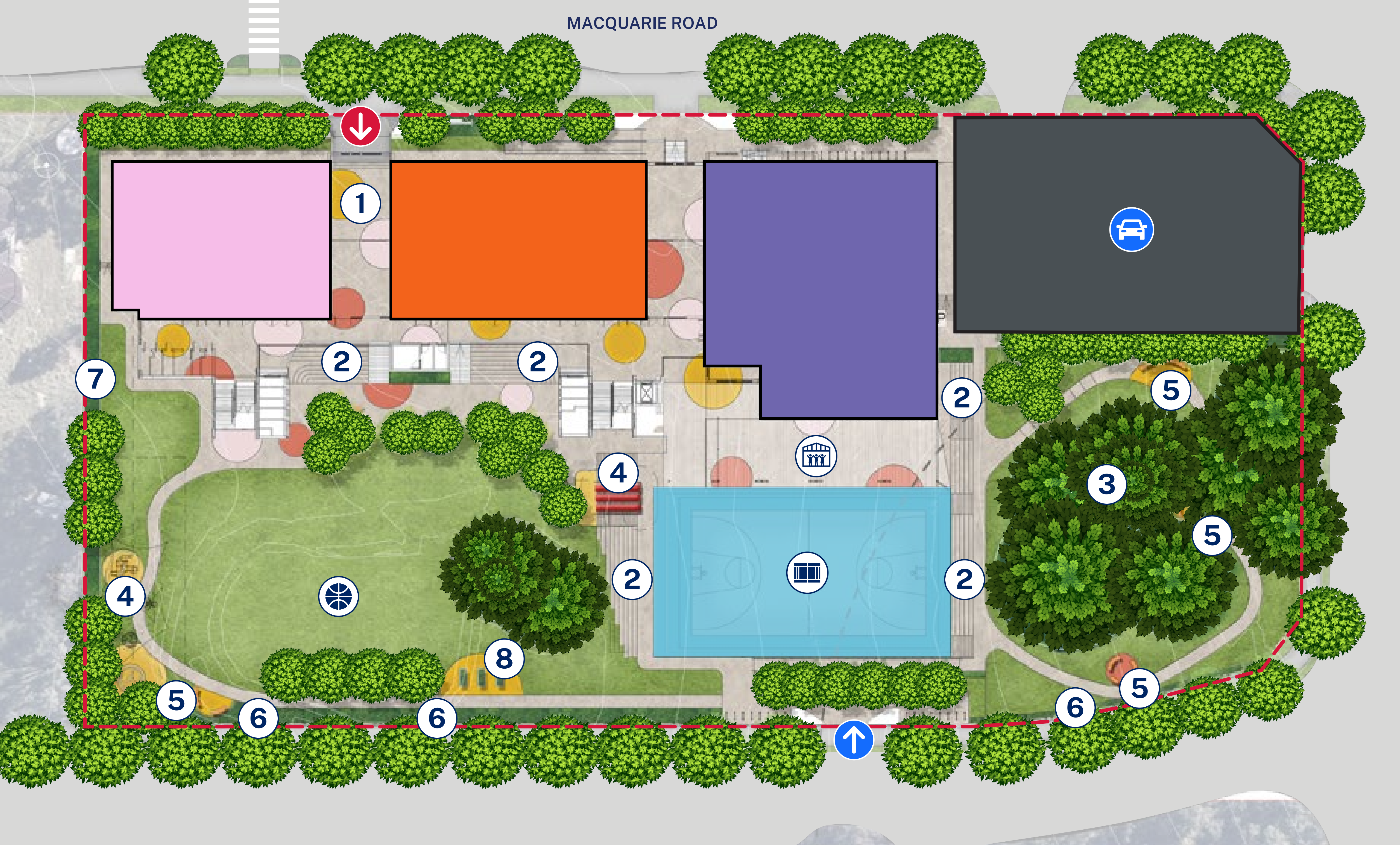

Location of trees in this map is indicative only and subject to change



Tallawong Public School

For more information
Phone: 1300 482 651
Email: schoolinfrastructure@det.nsw.edu.au
Website: schoolinfrastructure.nsw.gov.au



Floors site plan

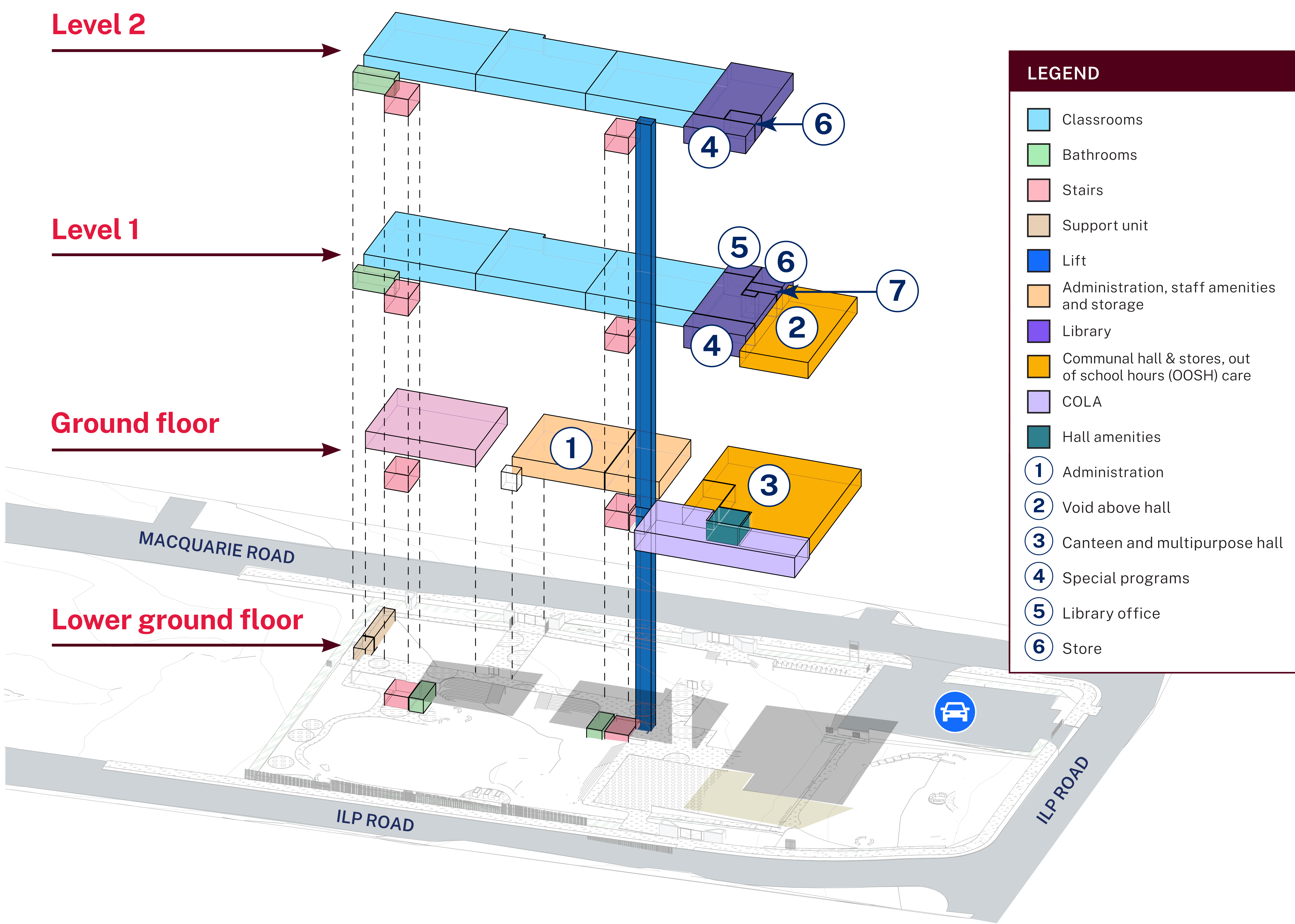

















Tallawong Public School

For more information
Phone: 1300 482 651
Email: schoolinfrastructure@det.nsw.edu.au
Website: schoolinfrastructure.nsw.gov.au



Floors site plan

LEGEND	
 Classrooms	 COLA
 Bathrooms	 Hall amenities
 Stairs	 1 Administration
 Support unit	 2 Void above hall
 Lift	 3 Canteen and multipurpose hall
 Administration, staff amenities and storage	 4 Special programs
 Library	 5 Library office
 Communal hall & stores, out of school hours (OOSH) care	 6 Store

Ground floor

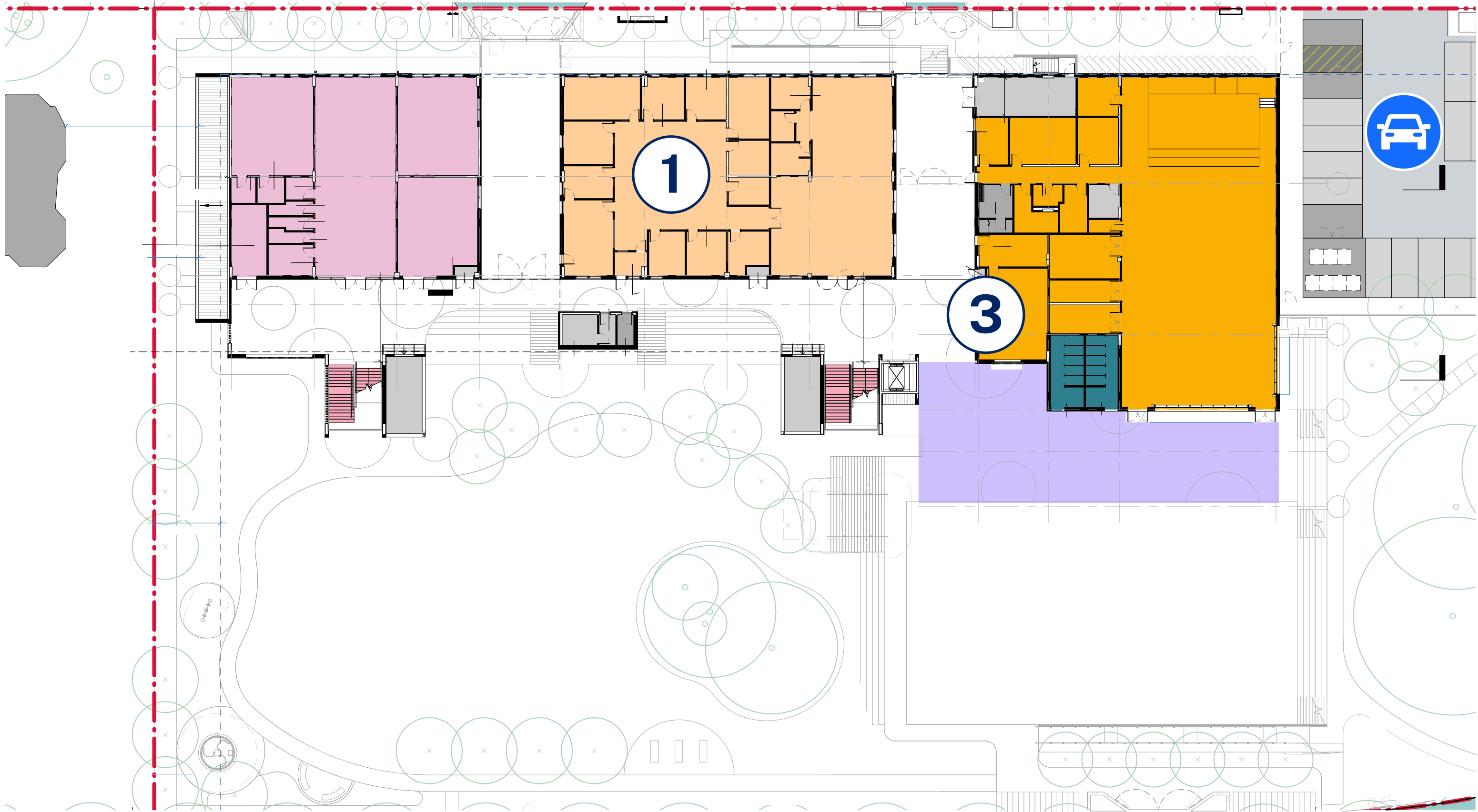

Level 1

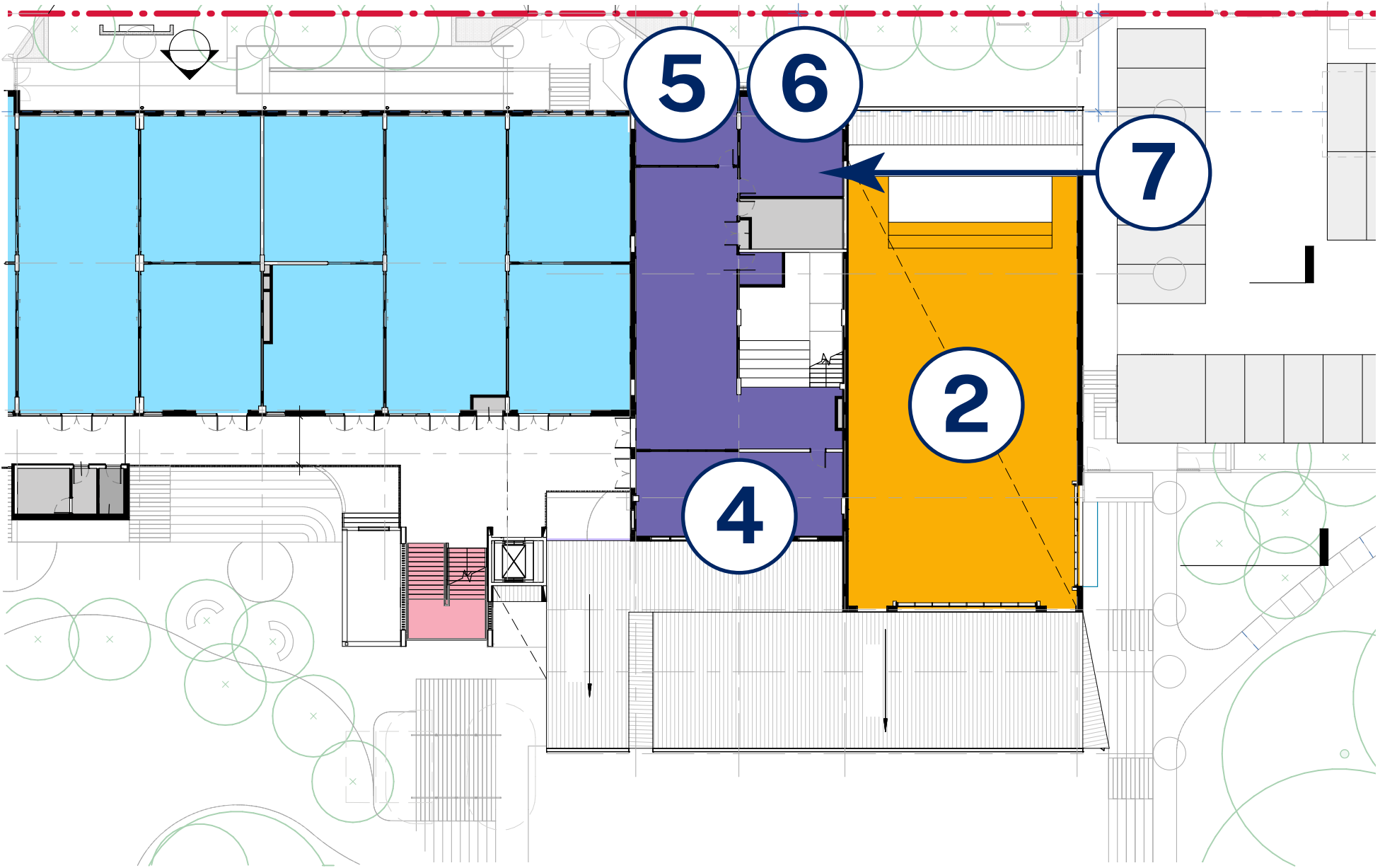

Level 2

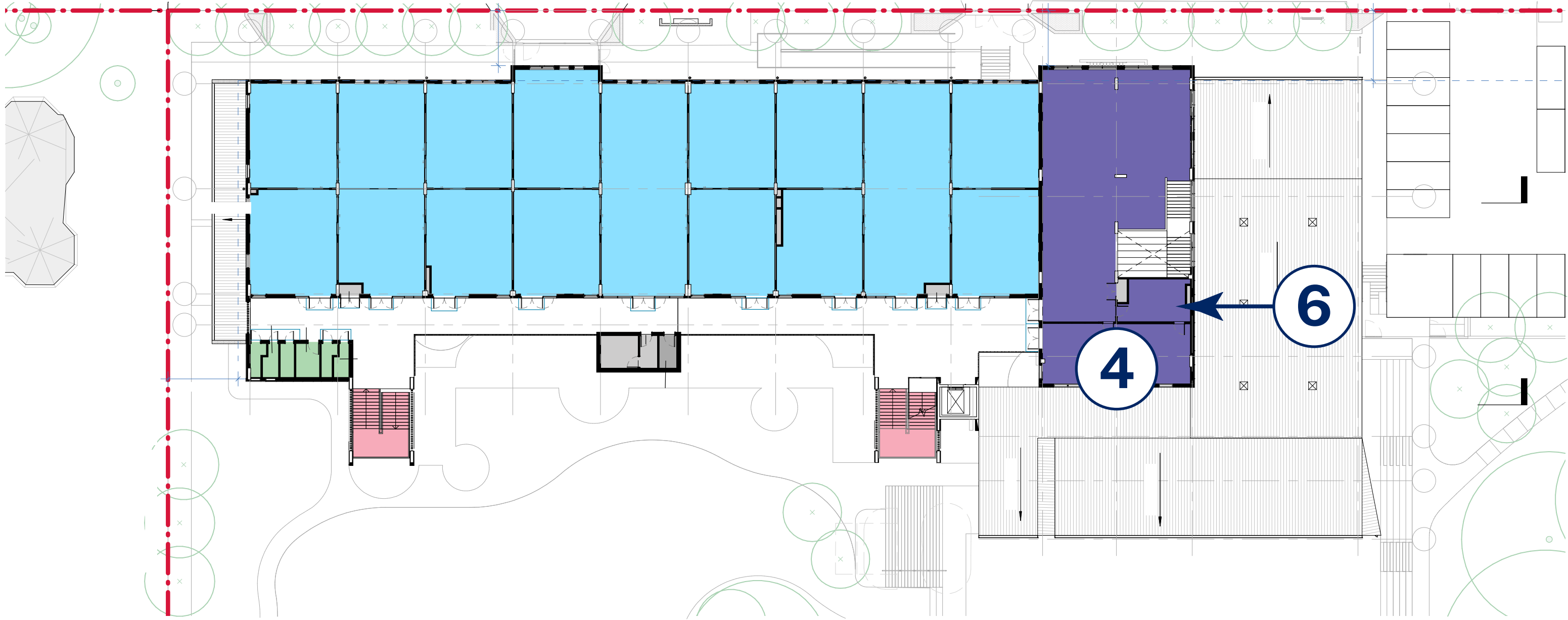

Tallawong Public School

For more information
Phone: 1300 482 651
Email: schoolinfrastructure@det.nsw.edu.au
Website: schoolinfrastructure.nsw.gov.au



Artist impressions



More information

You can find more information about the project at edu.nsw.link/TallawongNPS or by scanning the QR code.

If you have any questions about this project, you can contact School Infrastructure during business hours on the contact details below.

Keep in touch

To sign up to the project mailing list use the contact us form on the Tallawong Public School upgrade project page at edu.nsw.link/TallawongNPS.

Tallawong Public School

For more information

Phone: 1300 482 651

Email: schoolinfrastructure@det.nsw.edu.au

Website: schoolinfrastructure.nsw.gov.au

