

# Sydney Olympic Park new high school

Information pack | March 2021



Example of an innovative learning space being delivered across NSW

The NSW Government is investing \$7 billion over the next four years, continuing its program to deliver more than 200 new and upgraded schools to support communities across NSW. This is the largest investment in public education infrastructure in the history of NSW.

The NSW Department of Education is committed to delivering new and upgraded schools for communities across NSW. The delivery of these important projects is essential to the future learning needs of our students and supports growth in the local economy.

The new high school will include:



**Innovating teaching  
and learning spaces for  
more than 800 students**



**Multi-purpose hall for  
sports and performance**



**Outdoor spaces including landscaped  
recreation areas, playing field and  
games courts**



**A library**



**Canteen facilities**



**New performing arts  
spaces**

# Project overview

A new high school is being developed to cater for the growing population in the Sydney Olympic Park, Wentworth Point and Concord West communities. It will include contemporary and innovative learning environments, initially accommodating more than 800 students.

- Innovating teaching and learning spaces for more than 800 students
- Outdoor spaces including landscaped recreation areas, playing field and games courts
- Multi-purpose hall for sports and performance
- Library and canteen facilities
- New performing arts spaces.

The master plan for the high school factors in future growth.

# The new high school features

The school may be designed up to six storeys to maximise outdoor space, with learning spaces grouped in zones that may focus on curriculum or school stage.

- Innovative design principles including sustainability features
- Technology-rich teaching and learning spaces
- Library with senior study spaces and meeting areas
- Indoor/outdoor learning areas
- Visual arts workshop
- Wood and metalwork workshops
- Hospitality and kitchen spaces
- Performance spaces
- Fitness and movement studio
- Learning spaces for specialist support classes.

Further details about the high school facilities will be shared with the community as the project progresses.

# A new high school in Wentworth Point

## Location of the new high school



## Proposed school layout

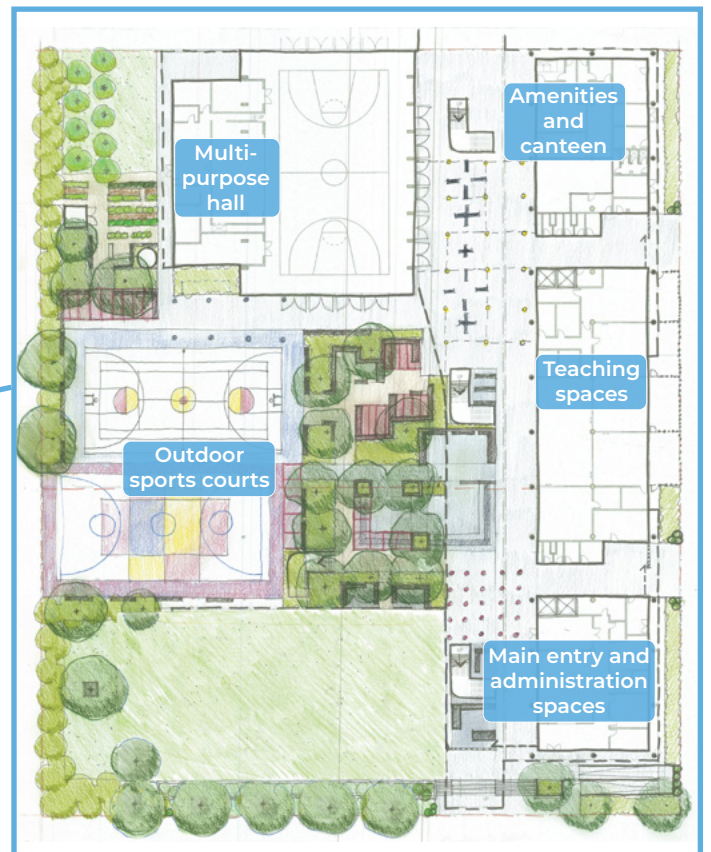



# Innovative learning spaces

Contemporary learning and teaching prepares students for a diverse and interconnected world. We are evolving the ways we teach our students new skills valued by a changing workforce, understand different ways students learn and support new ways of interacting with information through technology.

Innovative learning environments are flexible spaces designed and equipped to support contemporary learning and teaching.

## What makes an innovative learning space?

### Learning space

- Different zones (areas of a building or floors) are designed to support a range of activities sometimes grouped by subject area
- Varied furniture allows for student choice, comfort and flexibility
- Spaces are flexibly connected allowing students to work in varied group sizes
- Connection between indoor and outdoor learning spaces



Learning space

### Organisation

- Movement is encouraged for students and teachers to collaborate and interact
- More than one teacher may be available to students within the learning environment
- Students learn in classes, small groups or individually

### Teaching and learning

- Learning is personalised
- Learning is connected across different subject areas
- There is a focus on creativity and innovation with students prototyping, testing and using technology in creative ways

### Technology

- Technology is integrated into spaces to extend learning opportunities
- WiFi is available everywhere including outdoors
- Specialist equipment is available for students to innovate, communicate and create



Teaching and learning



Organisation



Technology

# Project timeline

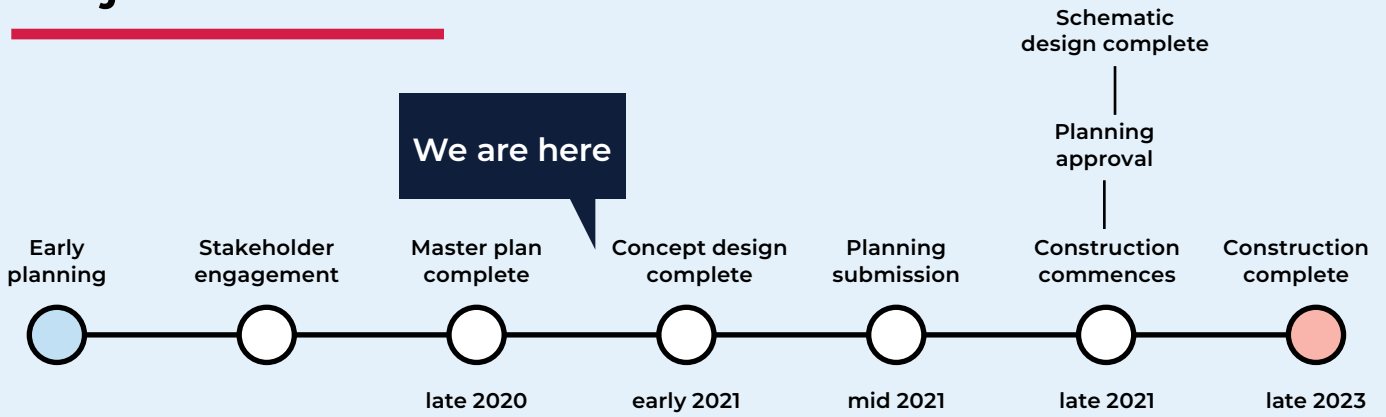

## What's next?

We will continue to work with key stakeholders so that we can deliver high quality education infrastructure for the local community. The next phase of planning aims to further develop the design to confirm the final layout of the school and its facilities.

We look forward to sharing more information with you as the project progresses. In the meantime you can stay informed by regularly visiting the project web page and you can contact us via email or phone if you have any questions or feedback about the new high school.

Stay informed about plans for the Wentworth Point Peninsula, including the Peninsula Park, by contacting Transport for NSW on 1800 684 490 or [projects@transport.nsw.gov.au](mailto:projects@transport.nsw.gov.au).



Examples of school facilities delivered across NSW



# Frequently asked questions

---

## What is being delivered as part of this project?

A new high school is being developed to cater for the growing population in the Sydney Olympic Park, Wentworth Point and Concord West communities. It will include contemporary and innovative learning environments initially accommodating more than 800 students. Facilities will include a library, a multipurpose hall and a playing field. The design will provide areas for outdoor play and sports.

The master plan accommodates for future growth, if required.

## Why was the Wentworth Point site chosen?

A comprehensive site search was undertaken and a suitable site identified on Burroway Road in Wentworth Point. The site is adjacent to Wentworth Point Public School and directly connects to the proposed Peninsula Park.

## Where is the project up to?

The new school, which will benefit families in Sydney Olympic Park, Wentworth Point and Concord West, is currently in the planning stages. Due to the level of investment involved, the new high school is a State Significant Development (SSD) and therefore the NSW Department of Planning, Industry and Environment (DPIE) will assess the development application for the project.

We have submitted a request to DPIE for the Secretary's Environmental Assessment Requirements (SEARs) for the project. DPIE has identified the site studies we will need to include in the Environmental Impact Statement (EIS) that forms part of the development application for the project. The community will be invited to provide more input during the public exhibition of the State Significant Development Application.

## What stage of design is the project in?

A master plan for the high school has been developed.

During master planning we work with key stakeholders to develop the education principles behind the project, and identify constraints and opportunities of the site which inform the building footprints. The size of the building footprints are calculated in accordance with NSW Department of Education guidelines.

The project is currently in the early concept phase and our team are working through the overall layout of the campus, staging for future growth and consideration of environmental, access, transport and other planning requirements.

## What happens next?

The next phase of planning is to further develop the design to confirm the final proposed layout of the school and its facilities and submit an application for planning approval as a State Significant Development.

The community will be invited to provide more input during the public exhibition of the State Significant Development Application.

## What is the catchment area for the new high school?

The school catchment will be confirmed closer to the school opening and will be based on the most up to date demographic data on the number of school aged children living in the local area at the time the school opens.

## When will the school open?

The new high school is scheduled to open in early 2024.

## How many students will the high school accommodate?

The new school will accommodate more than 800 students when it opens in 2024.

The master plan for the high school accommodates future growth, if required.

Core facilities such as the library, administration, canteen and multipurpose hall will be sized to accommodate a potential future growth in student population.

## How will construction impact Wentworth Point Public School?

A plan to minimise impacts to Wentworth Public School will be developed prior to construction and shared with the school and local communities when planning approval is received.

## How will students get to the new high school?

We identify and review transport impacts early in the planning process and collaborate with state, local and school stakeholders to put appropriate traffic management in place.

A preliminary transport assessment was undertaken in the early stages of planning to identify the challenges and opportunities associated with student travel to the site. This preliminary assessment identified the site is highly accessible for students to walk or use public transport to get to the school.

The project will include Drop off and Pick up facilities.

A more detailed transport assessment will be included as part of the planning approval application for the project.



Examples of school facilities delivered across NSW

### How can I find out more about the project?

School Infrastructure NSW will continue to work closely with local community to share information and seek feedback as the project progresses. The SINSW website will continue to have up-to-date information about the high school project in your area.

<http://edu.nsw.link/9dMvQE>

You can also continue to contact us via our community information line 1300 482 651 and by email [schoolinfrastructure@det.nsw.edu.au](mailto:schoolinfrastructure@det.nsw.edu.au)

### What about other plans for the Wentworth Point Peninsula?

Stay informed about plans for the Wentworth Point Peninsula, including the Peninsula Park, by contacting Transport for NSW on 1800 684 490 or [projects@transport.nsw.gov.au](mailto:projects@transport.nsw.gov.au).

## Stay informed



#### Website

Stay up to date by visiting the School Infrastructure NSW website [schoolinfrastructure.nsw.gov.au](http://schoolinfrastructure.nsw.gov.au)



#### Email

Contact the Community Engagement team by emailing [schoolinfrastructure@det.nsw.edu.au](mailto:schoolinfrastructure@det.nsw.edu.au)



#### Phone

Contact us between 9:00am and 5:00pm, Monday to Friday on **1300 482 651**