

# St Ives High School

Project update

June 2019

Artist impression of the St Ives High School upgrade



THE  
**LARGEST**  
INVESTMENT IN  
PUBLIC SCHOOL  
EDUCATION  
INFRASTRUCTURE  
IN THE HISTORY  
OF NSW

**\$6.5** Billion

FOR MORE THAN  
190 NEW AND  
UPGRADED SCHOOLS

THE DEVELOPMENT  
APPLICATION HAS  
BEEN SUBMITTED TO  
THE LOCAL COUNCIL  
FOR THE NEW INDOOR  
SPORTS CENTRE

# Investing in schools

The NSW Government is investing \$6.5 billion over the next four years to deliver more than 190 new and upgraded schools to support communities across NSW. In addition, a record \$1.3 billion is being spent on school maintenance over four years. This is the largest investment in public education infrastructure in the history of NSW.

## St Ives High School upgrade

An upgrade is being planned for St Ives High School. The project will include the construction of a new multi-use indoor sport centre and Block C refurbishment.

### Progress summary

The project team has been working closely with the School Principal and P&C representative to guide the design of the new school facilities. The development application has been submitted to the local council for the new indoor sports centre.

The refurbishment of the Block C facilities continue with classes moved to temporary learning spaces while these works are underway.

### Next steps

Pending planning approvals, works on the new sport centre is expected to commence in mid 2019.

### St Ives High School welcomes the Intensive English Centre (IEC)

The IEC will relocate from the Chatswood High School, to the St Ives High School.

The relocation of the IEC to St Ives High School builds on the already rich learning environment and provides an opportunity for the school to become a vital learning hub, supporting a diverse community.

Our students will also benefit from the rich cultural and linguistic diversity and new leadership opportunities presented as we work together.

We are in the early stages of planning and will consult with the school community as the planning progresses.

### Meet the project team and stay updated

While the exciting school upgrade continues, we are committed to openly sharing information. You can speak to us about this project using the contact details provided on the back cover.

## Indicative project timeline

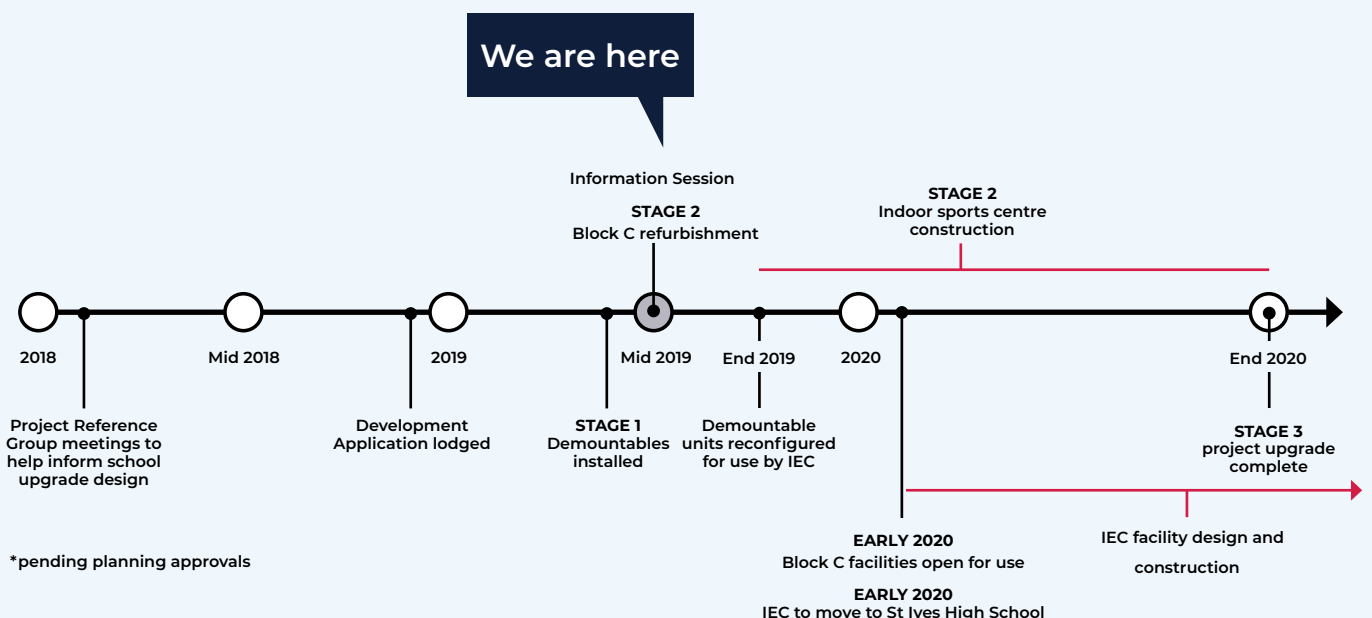

# Frequently asked questions

---

## What works are underway?

The refurbishment works on Block C facilities are underway. The internal works will improve the functionality of the spaces.

## What steps will be taken to control noise and dust impacts during construction?

Hoarding and shade cloth will be erected to reduce noise and dust impacts on the school and our neighbours. We are working with the Principal to managing the construction program to minimise disruption to students and learning.

## How will traffic be managed?

Traffic control and security measures will be in place where required for the safety of the school community.

## What is an IEC?

Intensive English Centres (IEC) provides intensive English language instruction, orientation, welfare and settlement support to newly arrived secondary school age students. We already benefit from the Intensive English Centre with many of our students having graduated from their programs.

## When will the IEC relocation take place?

The IEC will relocate to St Ives High School for the commencement of the 2020 school year.

## Where will the IEC be located?

While permanent facilities are being designed and constructed, the IEC students and teaching staff will initially move into the demountable classrooms already on site which St Ives students will vacate in Term 4.

We will be working closely with the Principal, staff and the school community during the planning process to identify the best location for permanent facilities to maximise co learning opportunities, maintain the character of St Ives High School and the identity of the IEC.

## How will this relocation impact on the construction of the indoor sports centre?

The relocation of the IEC and subsequent construction of the new facility will not impact the progress of the indoor sports centre.

## How will you keep us informed during the upgrade?

School infrastructure NSW will share construction updates and project information as the project progresses. We will provide information through information booths, face to face information sessions, project updates, our website and school newsletters.

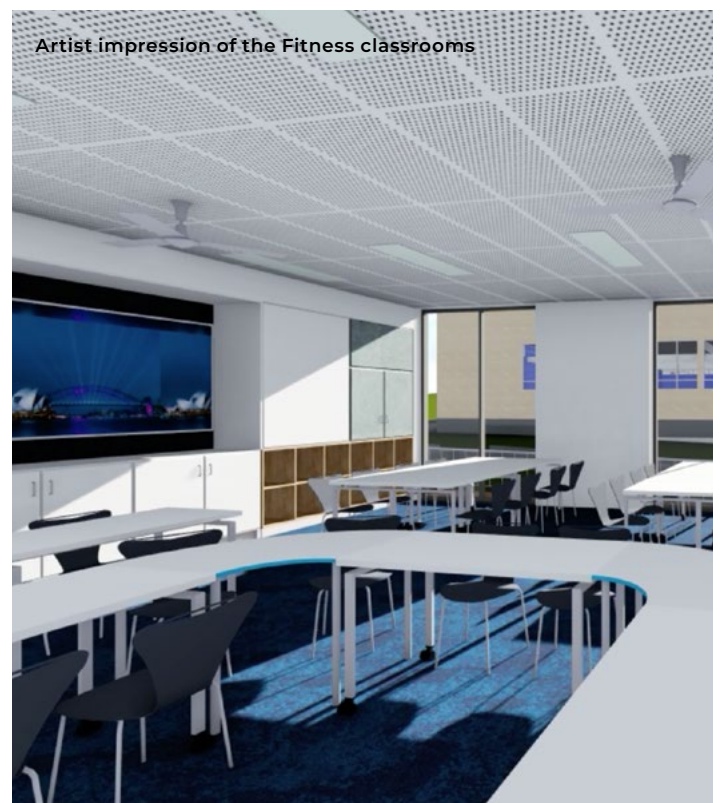

# NSW Department of Education – School Infrastructure



## For more information

We are committed to working together with our school communities and other stakeholders to deliver the best possible learning facilities for students. We encourage feedback from the school and local community about the St Ives High School project.

## Stay informed



### Website

Stay up to date by visiting the School Infrastructure NSW website  
[schoolinfrastructure.nsw.gov.au](https://schoolinfrastructure.nsw.gov.au)



### Email

Contact the Community Engagement team by emailing  
[schoolinfrastructure@det.nsw.edu.au](mailto:schoolinfrastructure@det.nsw.edu.au)



### Phone

Contact us between 9am–5pm,  
Monday to Friday on **1300 482 651**