

SMALLS ROAD

SITE BOUNDARY

10 0 10 20 30 40 50  
SCALE 1:1 @ A1  
mm  
© CONRAD GARGETT  
mail@conradgargett.com.au ABN 49 325 121 350  
DO NOT SCALE DRAWING & VERIFY ALL DIMENSIONS AND LEVELS ON SITE  
REGISTERED ARCHITECT LICENSE NO 10426 NSW Reg 1025  
REV DESCRIPTION DATE APPD  
A Preliminary Issue 10/01/18

GENERAL NOTES:

1. BUILDING BLOCKS A, B, C, D, E, G, H, L, K AND ASSOCIATED STAIRS, PATHWAYS AND BRICK PAVING BETWEEN BUILDINGS TO BE DEMOLISHED.
2. REMOVE SERVICES WITHIN EXISTING BUILDING FOOTPRINT. CAP AND MAKE SAFE FOR FUTURE WORK.
3. HANDSTAND ROAD AND DRIVEWAYS TO BE RETAINED.
4. HANDSTAND AND CARPARKING NOTED TO BE RETAINED FOR FUTURE USE TO BE PROTECTED.
5. TREE PROTECTION TO TREE MARKED AS 'RETAIN FOR FUTURE USE' TO BE PROVIDED AS ARBORIST SUPPORT.

RETAINED HANDSTAND & CARPARK

TREES TO REMAIN

COMPLYING DEVELOPMENT CERTIFICATE

Approved Plans & Specifications relating to:

Date Approved: 13 April 2018

Certificate No.: 18032

BLACKETT MAGUIRE + GOLDSMITH

ARCHITECT

Conrad Gargett

INTERNAL PROJECT No: 16321

CLIENT / APPLICANT

NSW Education School Infrastructure

PROJECT MANAGER

coffey A TETRA TECH COMPANY

PROJECT DoEAMD-16-14 Smalls Road, Ryde Public School

DRAWING Site Demolition Plan

AS SCALE As indicated

DATE 10/01/18

SCHOOL ID PAC ID STAGE DISCIPLINE DOC TYPE DRAWING No: REV: SR - 01 - DD - AR - DR - 1100 - A

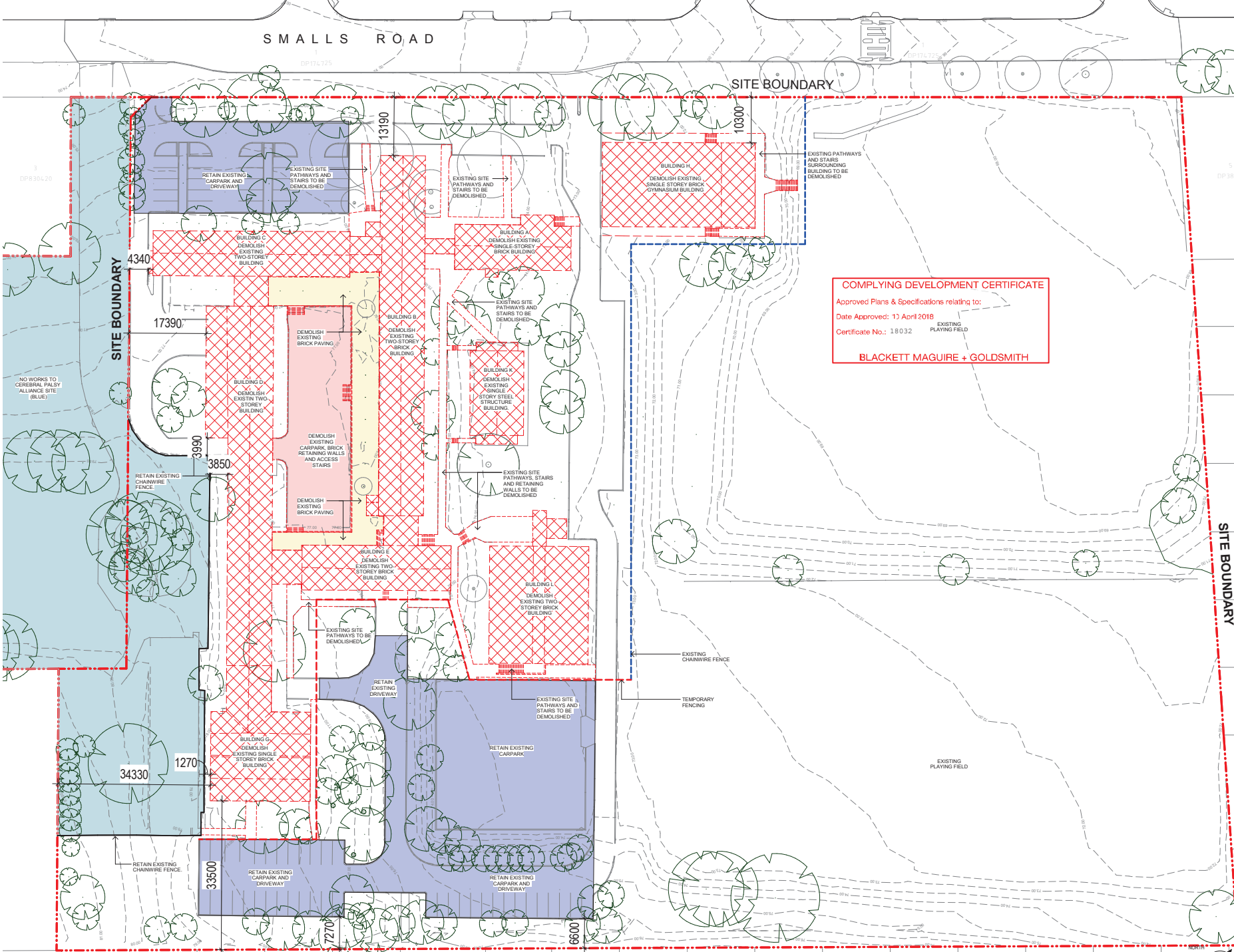

SITE BOUNDARY

