

Schofields Public School

Welcome



Welcome to your school

We're excited your new school facilities are ready for you to use.
The upgrade to your school includes:



27 new flexible
learning spaces



A new staff/
admin area



A new
library



Upgraded
amenities



A new covered outdoor
learning area (COLA)

Thank you for your patience during construction. We are delighted to deliver this project for the Schofields school community and hope you enjoy your new spaces.

Message from your Principal

We are very excited to start the next chapter in the life of Schofields Public School with the opening of our upgraded public school. The exceptional facilities will provide enhanced opportunities for innovation, creativity and collaboration ensuring all students are active participants in their respective learning journeys and inspired to be their best in all aspects of school life.

The project has effectively blended the rich history of the school with a very contemporary building, encouraging us to celebrate the past, work hard in the present and look to the future.

I would like to thank the students, families, staff and local residents for their patience, flexibility and understanding during construction and am sure everyone will be impressed with this outstanding addition to the community.

Colin Ross, Principal

What to expect

On Day 1 Term 4 2020, all students will meet under the new COLA, adjacent to the new Block P. Signage will be in place to direct students and markers will indicate where each class will line up. Class teachers will meet their students at the allocated places under the COLA.

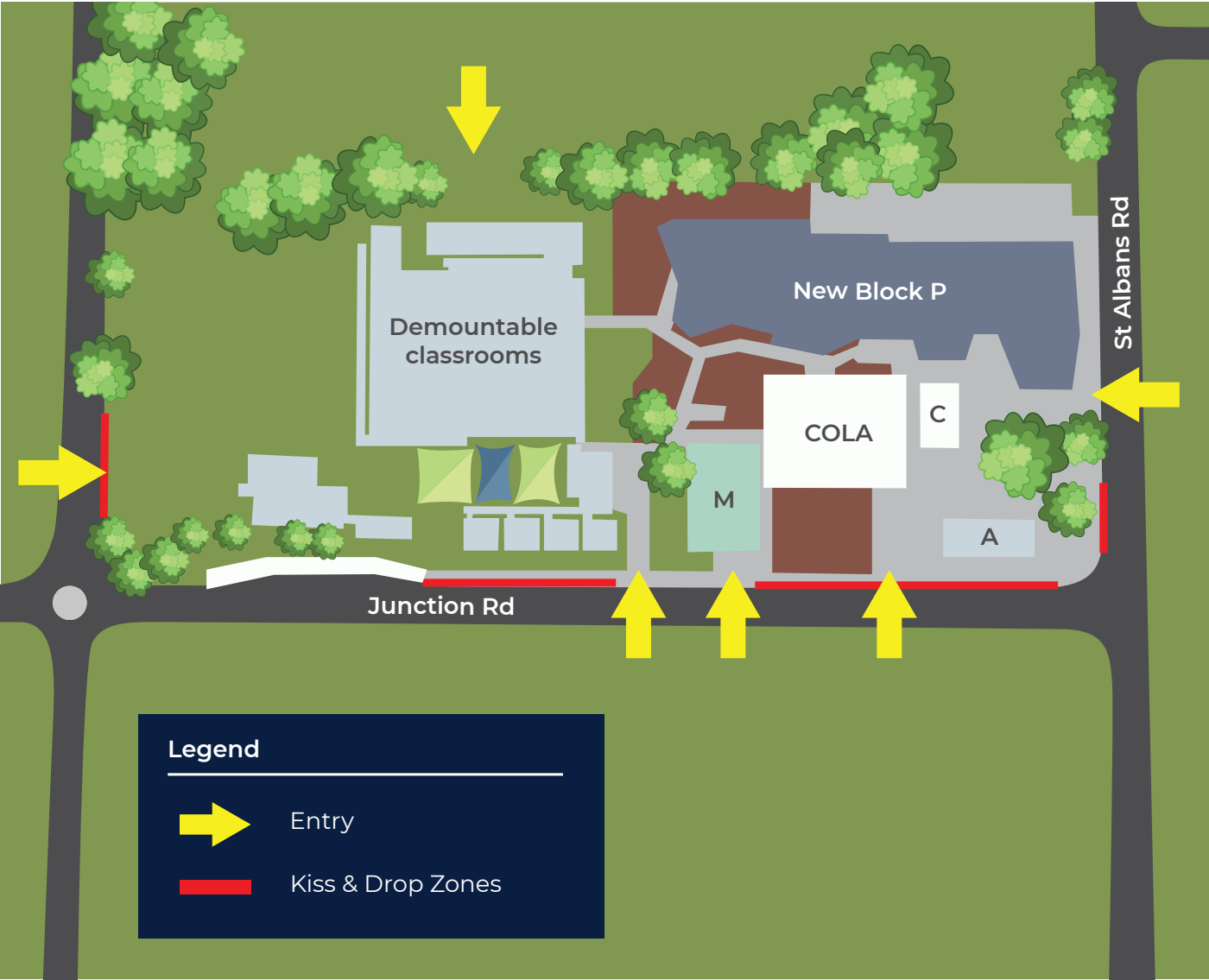

Map of Schofields Public School



Classroom schedule

Ground floor class map

First floor class map

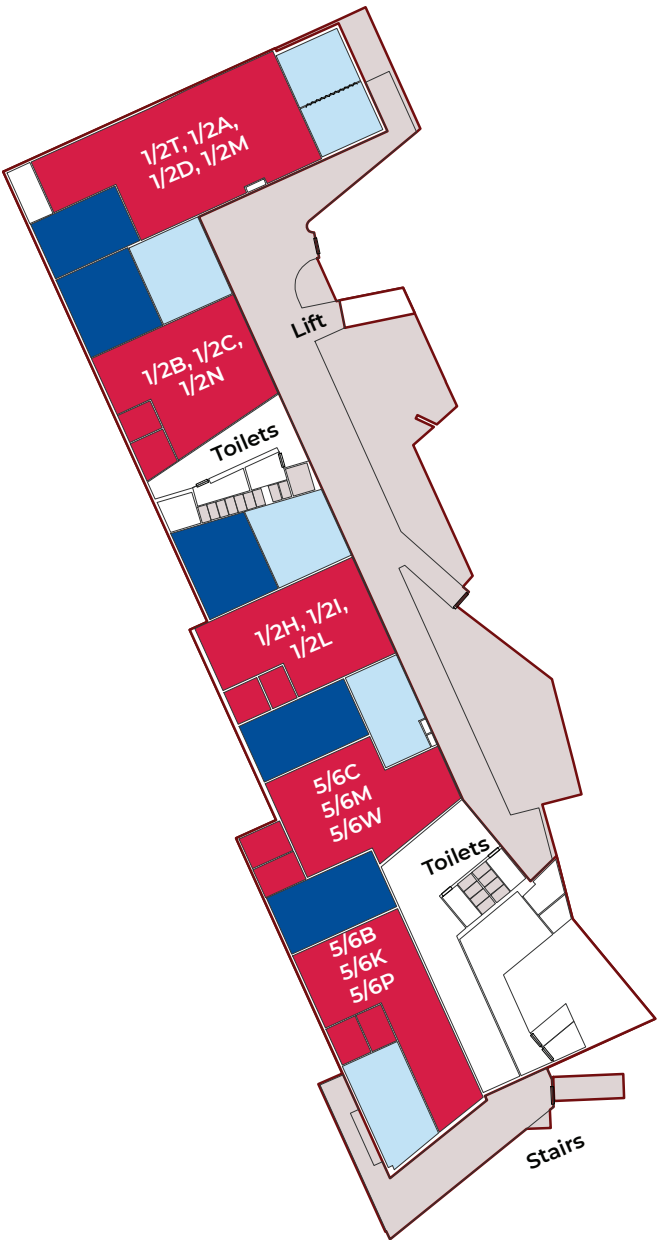
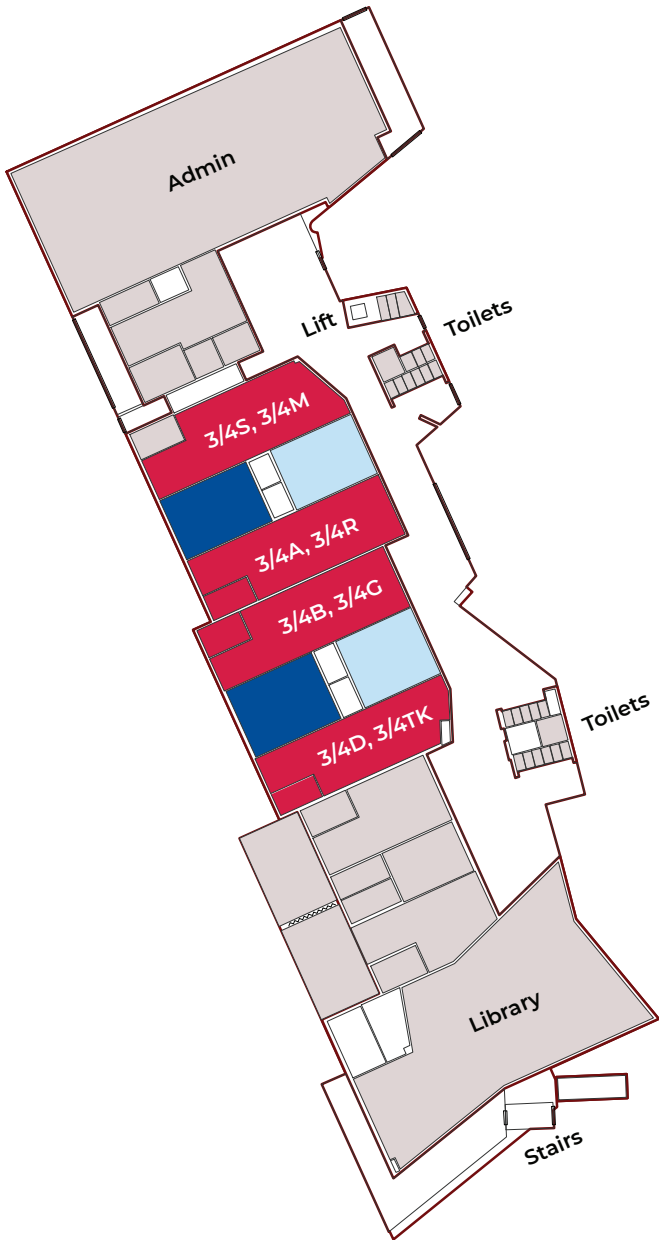

Classrooms Shared presentation space Shared practical activities



Frequently asked questions

Can I accompany my child into school grounds on Day 1 Term 4 2020?

Due to current health advice, parents and carers are not permitted onsite. School staff will be onsite to welcome students and direct them to their allocated area under the COLA. Signage will also be in place. Class teachers will wait for students under the COLA before moving to their dedicated classrooms.

Which school gates will be open?

The school gates located on St Albans Road, Junction Road, Station Street and the Park Oval will be open on Day 1 Term 4 2020.

Where are the Kiss and Drop zones?

There are four active Kiss and Drop zones, two on Junction Road, one on Station Street and one on St Albans Road.

Will the school start and finish times change?

The start time remains the same with play in the playground from 8:45 am and classes commencing at 9:15 am.

The finish times will continue to be staggered to accommodate social distancing requirements:

- 2:45 pm – Kindergarten
- 2:55 pm – Years 1 and 2
- 3:10 pm – Years 3 to 6

When will parents be able to view the new facilities?

We are aware that parents and carers would like a tour of the new facilities.

While we are unable to run physical tours of the site due to the health restrictions in place, we look forward to welcoming our school community to view our new school as soon as we can.

Contact us

For more information about this project contact School Infrastructure NSW:

Website: schoolinfrastructure.nsw.gov.au

Email: schoolinfrastructure@det.nsw.edu.au

Phone: 1300 482 651

For information about school activities and operations, contact the school directly:

Principal: Colin Ross

Website: schofields-p.schools.nsw.gov.au

Email: schofields-p.school@det.nsw.edu.au

Phone: 02 9627 1534