

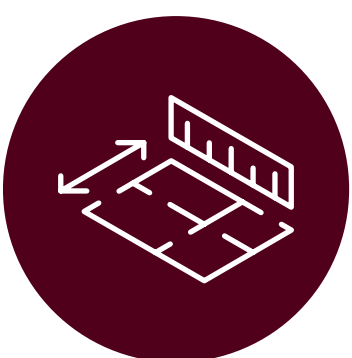









# We are rebuilding Richmond River High Campus

We are rebuilding a modern, flood resilient Richmond River High Campus to sit alongside Kadina High Campus and Lismore High Campus as part of The Rivers Secondary College.

The project will replace flood damaged facilities with new modern flood resilient spaces in a campus that is Connected to Bundjalung culture and reflects its rural school community.

 Flood resilient school site	 Green rural campus	 General and specialist classrooms	 Multipurpose hall
 Performance spaces	 Food tech	 Metal and construction tech facilities	 Agricultural facilities
 Sports fields	 Library		

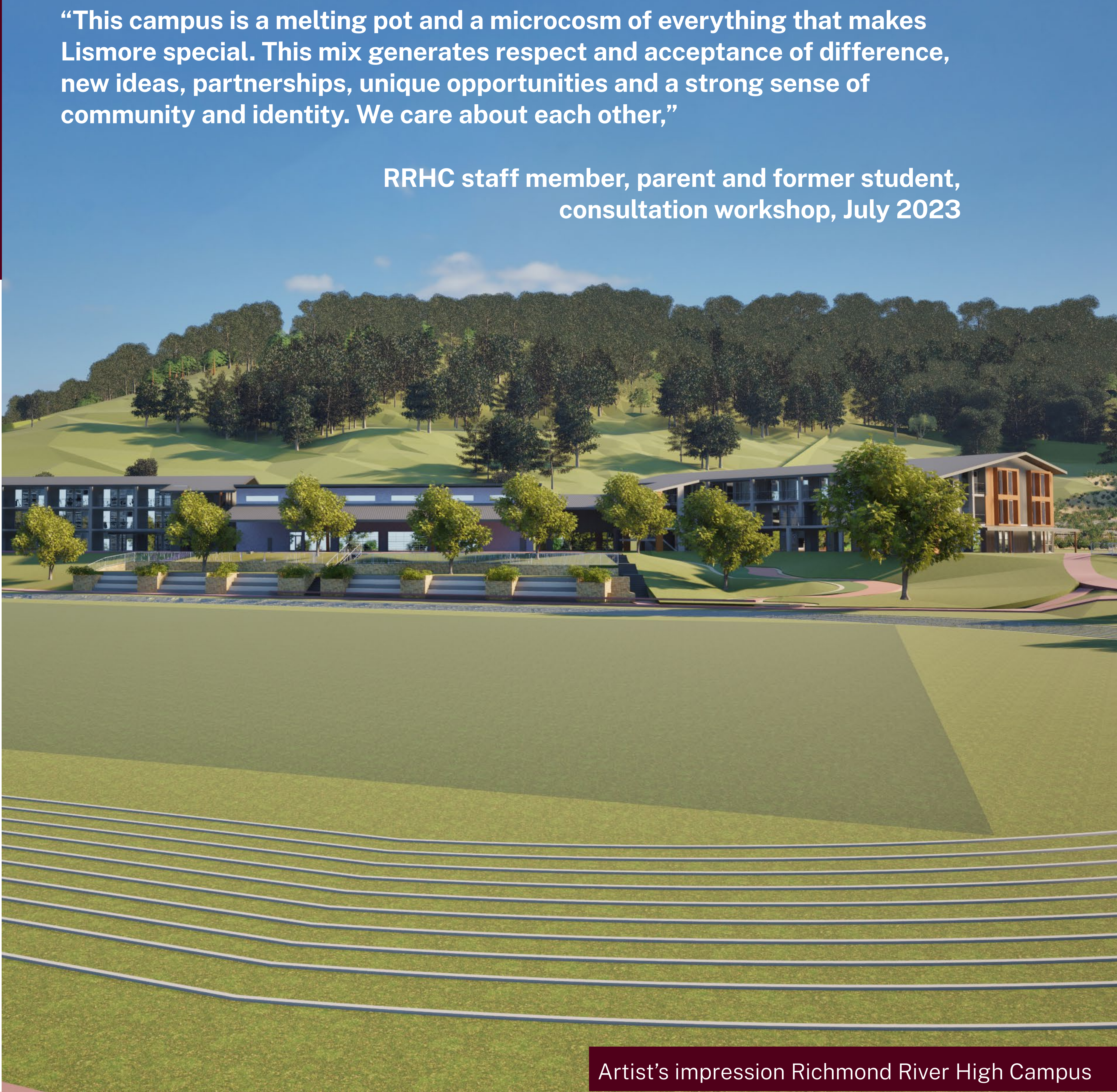

Artist's impression Richmond River High Campus

## Richmond River High Campus

**For more information**  
**Phone:** 1300 482 651  
**Email:** [schoolinfrastructure@det.nsw.edu.au](mailto:schoolinfrastructure@det.nsw.edu.au)  
**Website:** [schoolinfrastructure.nsw.gov.au](http://schoolinfrastructure.nsw.gov.au)

We would like to acknowledge the Bundjalung people as the traditional custodians of this land and pay our respects to elders both past and present.





## A new flood resilient campus location

The new campus site will support students in North and South Lismore, surrounding rural villages and the 15 partner primary schools in the campus catchment.

The school site is a two minute drive (900m) or 10 minute walk (750m) from the existing campus site at Lake Street, North Lismore.

We are consulting with Lismore City Council, Transport for NSW, local bus companies and the NSW Reconstruction Authority about transport options to the new campus site.

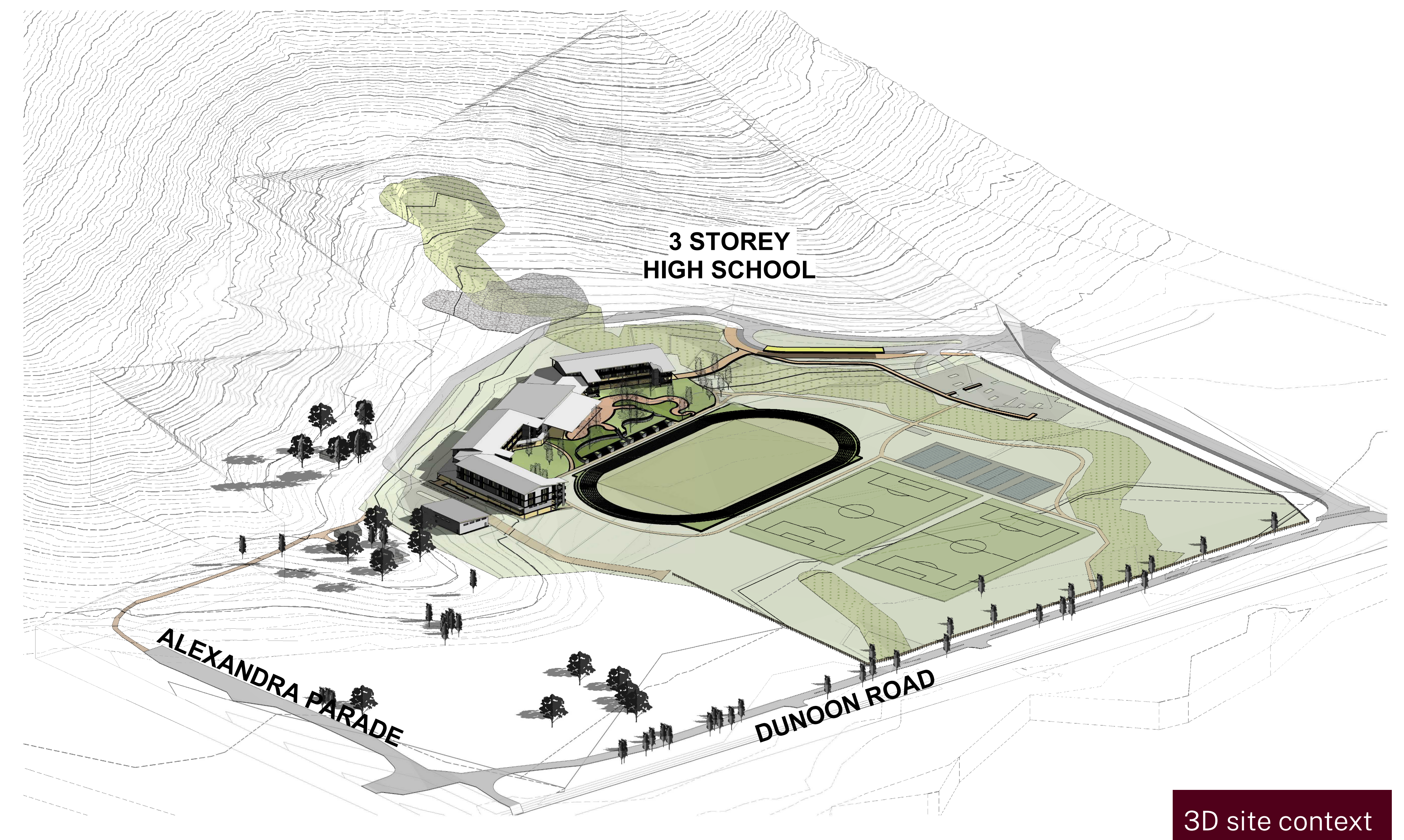

### Richmond River High Campus

**For more information**

**Phone:** 1300 482 651

**Email:** [schoolinfrastructure@det.nsw.edu.au](mailto:schoolinfrastructure@det.nsw.edu.au)

**Website:** [schoolinfrastructure.nsw.gov.au](http://schoolinfrastructure.nsw.gov.au)

We would like to acknowledge the Bundjalung people as the traditional custodians of this land and pay our respects to elders both past and present.



## Flood resilient facilities

All classrooms and learning facilities will be built above the Probable Maximum Flood (PMF) height to minimise disruption from any future flooding and allow students to return to their own school sooner.



### Richmond River High Campus

**For more information**

**Phone:** 1300 482 651

**Email:** [schoolinfrastructure@det.nsw.edu.au](mailto:schoolinfrastructure@det.nsw.edu.au)

**Website:** [schoolinfrastructure.nsw.gov.au](http://schoolinfrastructure.nsw.gov.au)

We would like to acknowledge the Bundjalung people as the traditional custodians of this land and pay our respects to elders both past and present.



## Artist's impressions



Artist's impressions of the Richmond River High Campus



Artist's impressions of the Richmond River High Campus

### Richmond River High Campus

**For more information**

**Phone:** 1300 482 651

**Email:** [schoolinfrastructure@det.nsw.edu.au](mailto:schoolinfrastructure@det.nsw.edu.au)

**Website:** [schoolinfrastructure.nsw.gov.au](http://schoolinfrastructure.nsw.gov.au)

We would like to acknowledge the Bundjalung people as the traditional custodians of this land and pay our respects to elders both past and present.



# Modern school spaces

School facilities will be funded through insurance on a like for like basis and designed to meet current Educational Facilities and Standards Guidelines.

The three separate, but connected, 2 and 3 storey buildings are laid out in a U shape that puts the hall at the centre of the school.

The campus will include 20 general classrooms, 3 support classrooms, and specialist learning spaces. The location of specialist learning spaces, including wood and metal technology and hospitality is based on function and practical considerations, such as materials delivery.

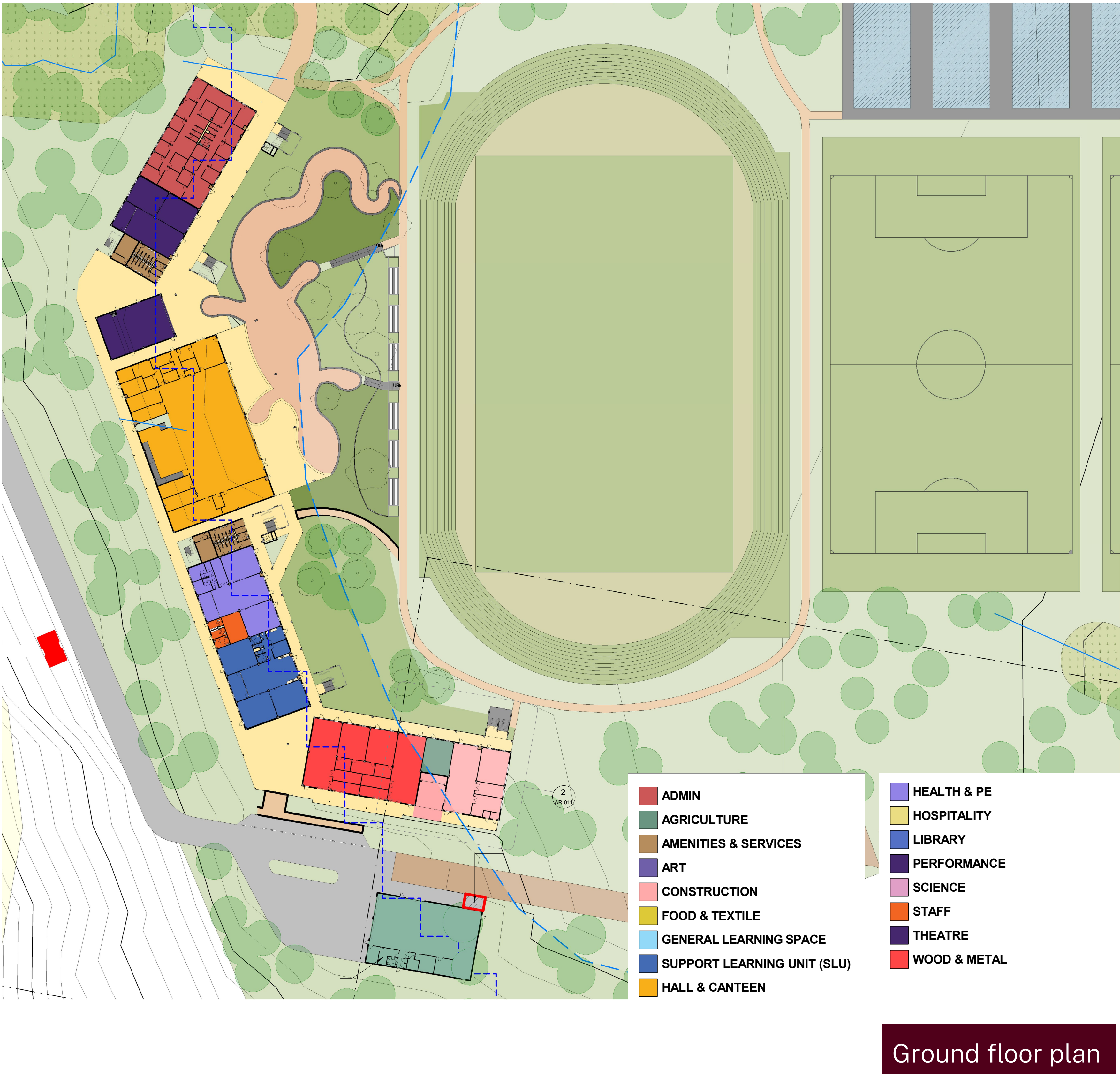
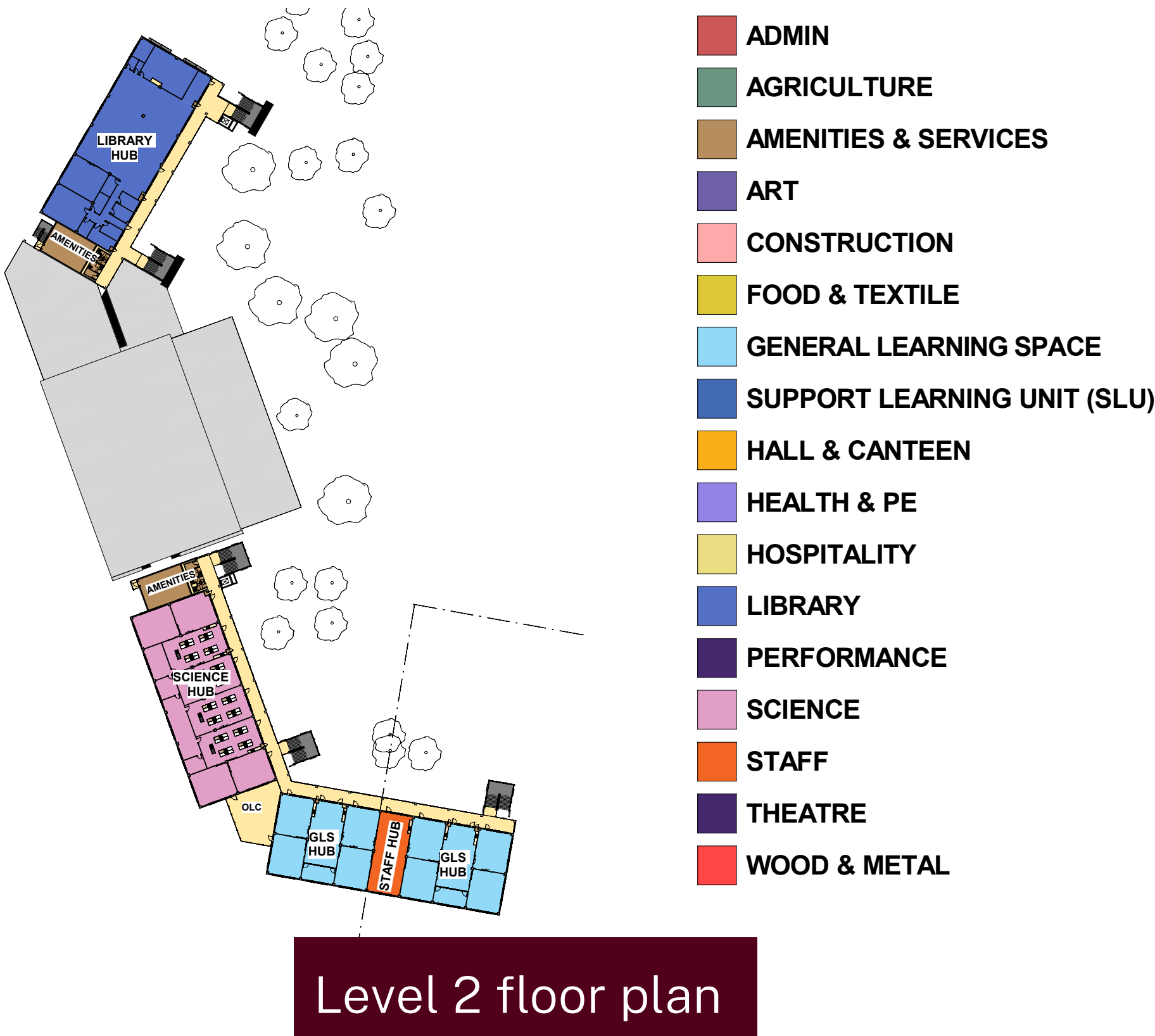
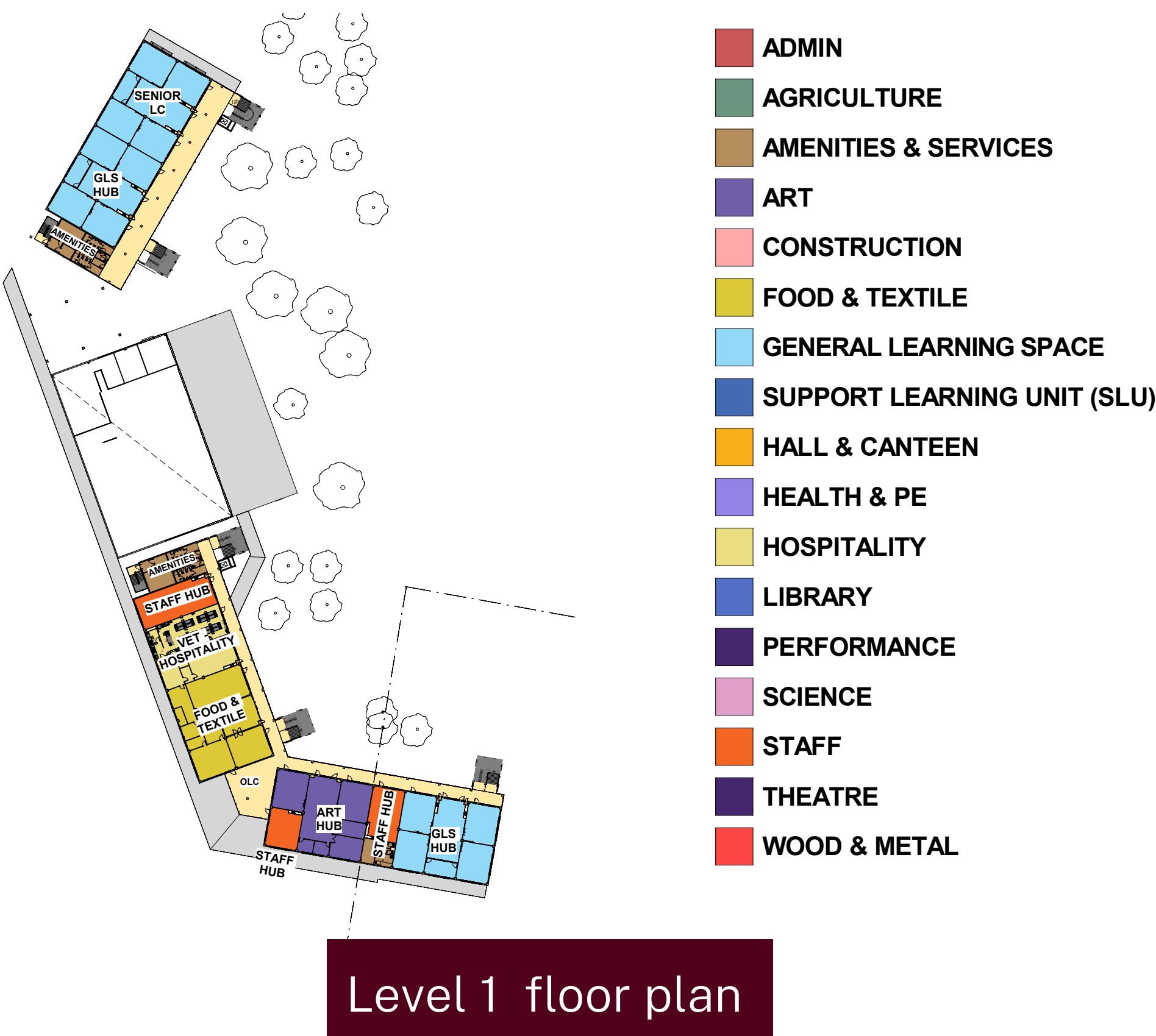

## Richmond River High Campus

**For more information**  
**Phone:** 1300 482 651  
**Email:** [schoolinfrastructure@det.nsw.edu.au](mailto:schoolinfrastructure@det.nsw.edu.au)  
**Website:** [schoolinfrastructure.nsw.gov.au](http://schoolinfrastructure.nsw.gov.au)

We would like to acknowledge the Bundjalung people as the traditional custodians of this land and pay our respects to elders both past and present.





## A green and rural campus....

The campus will retain the rural outlook that students, staff, parent and carers told us they loved about the original campus site at Lake Street. Buildings will be placed on high ground overlooking the school sports fields and green space.

## That's connected to Country

We are consulting with the traditional owners of the new school site to incorporate and celebrate the stories, traditions and Bundjalung heritage of the school site and surrounding areas, ie surrounding areas in campus design, as well as the day-to-day operations of Richmond River High Campus.

Students and staff will be an important part of this consultation in coming months.

“I would love what we learn to be more connected to the outside,”

RRHC student workshop, July 2023



Artist's impression of the view from Dunoon Road

### Richmond River High Campus

**For more information**

**Phone:** 1300 482 651

**Email:** [schoolinfrastructure@det.nsw.edu.au](mailto:schoolinfrastructure@det.nsw.edu.au)

**Website:** [schoolinfrastructure.nsw.gov.au](https://schoolinfrastructure.nsw.gov.au)

We would like to acknowledge the Bundjalung people as the traditional custodians of this land and pay our respects to elders both past and present.





## Next steps

### 1 – Design

The schematic design plans will be finalised to submit with the planning application. Once the planning application is submitted, we will finalise the detailed design needed for construction.

Connecting with Country consultation will also continue to make sure local cultural heritage is incorporated into the campus design and operations.

### 2 – Planning

Once we have finalised schematic designs and all the required information, we will submit a planning application to rebuild Richmond River High Campus. The planning application will be placed on public exhibition.

The school site will also be rezoned to allow for an educational facility.

### 3 – Construction

We will issue a request for tenders for construction of the new school facilities after we have lodged the planning application.

## How can I get involved?

We are committed to working together with our school communities and other stakeholders to deliver the best possible facilities for students.

We will keep the Lismore community up to date through the relocation and rebuilding of Richmond River High Campus.

You can stay up to date via our Richmond River High Campus project page or by scanning the QR code.



#### Contact us

**Phone:** 1300 482 651

**Email:** [schoolinfrastructure@det.nsw.edu.au](mailto:schoolinfrastructure@det.nsw.edu.au)

**Website:** [schoolinfrastructure.nsw.gov.au](https://schoolinfrastructure.nsw.gov.au)

## Richmond River High Campus

#### For more information

**Phone:** 1300 482 651

**Email:** [schoolinfrastructure@det.nsw.edu.au](mailto:schoolinfrastructure@det.nsw.edu.au)

**Website:** [schoolinfrastructure.nsw.gov.au](https://schoolinfrastructure.nsw.gov.au)

We would like to acknowledge the Bundjalung people as the traditional custodians of this land and pay our respects to elders both past and present.

