

Queanbeyan East Public School

Back to school 2020



Welcome to your school

We're excited your new school facilities are ready for you to use.
The upgrade to your school includes:



11 new flexible
learning spaces



A new
canteen



A new library



A new covered outdoor
learning area (COLA)
and landscaping works



An upgrade to the staff
and administration area

Thank you for your patience during construction. We are thrilled to deliver this project for your school community and hope you enjoy your new spaces. Share your back to school experience with **#Ready2020**.

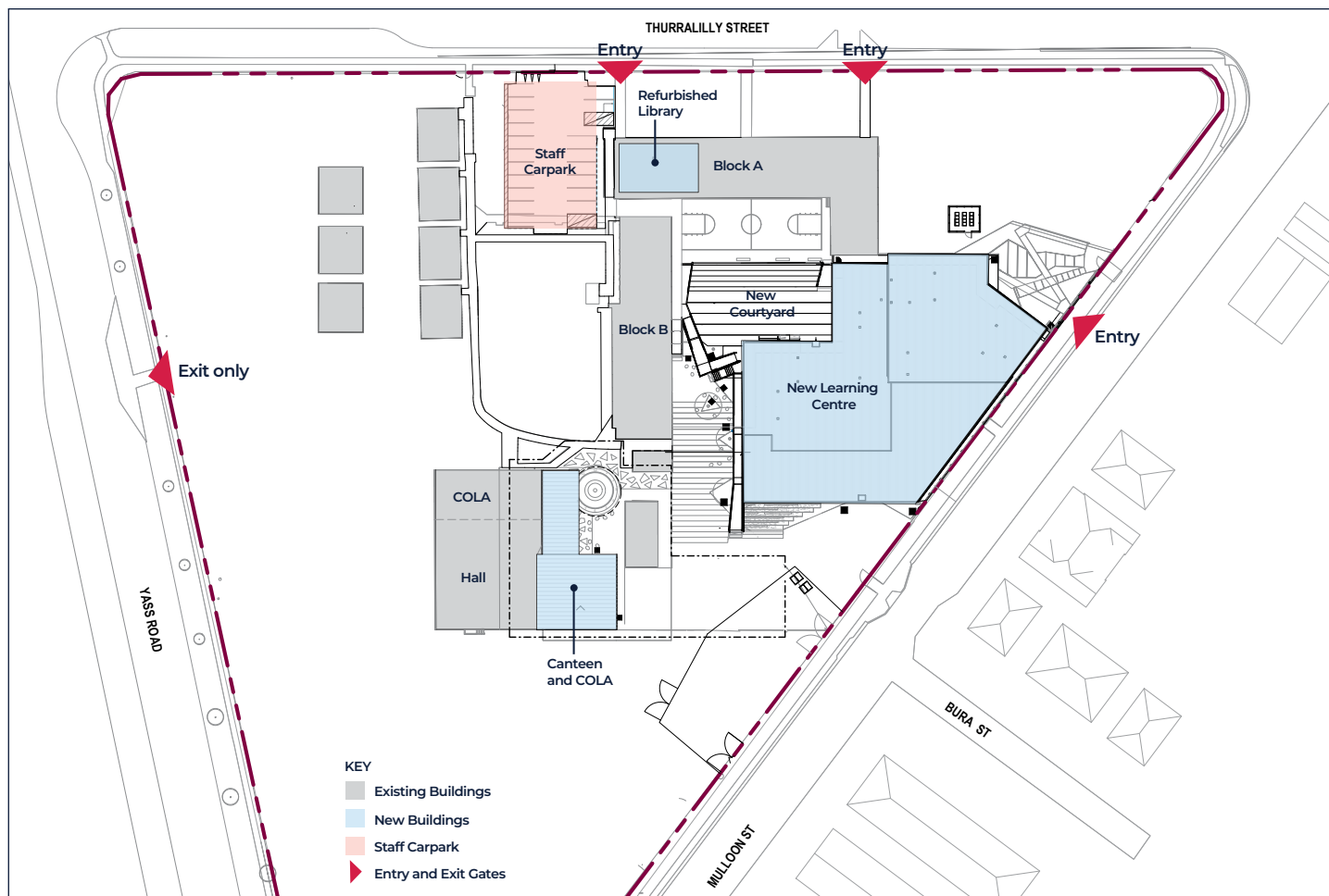

Access to new school buildings from Term 1 2020

Message from your Principal

You will notice many changes when you arrive today. We are especially proud of our 11 new classrooms and the space they provide for flexible learning. They look amazing and will serve us well as we continue to focus on quality teaching for our students. We are looking forward to learning and teaching in our innovative learning environments.

We are a dynamic school community committed to delivering a broad range of quality learning experiences, in a nurturing environment where all students have the opportunity to achieve their personal best.

I'd like to thank students, staff, parents and the local community for their patience during construction. I am sure you'll be as pleased as we are with the outcome.

Danny Scott, Principal

What to expect on Day 1

The new learning spaces and facilities will be ready and open for students from the first week of Term 1, including:

- 11 permanent flexible learning spaces
- a new canteen
- a new covered outdoor learning area (COLA) and landscaping
- new internal courtyard
- a new library
- an upgrade to the staff administration area.

The new learning building is designed to facilitate innovative learning, with spaces designed to be flexible and well-resourced so that teachers can design a wide range of learning activities.

The building architecture is designed to maximise natural ventilation and air flow, and also includes automated air-conditioning that activates as required. Solar panels on the roof will also offset the energy required for the air-conditioning.

We are currently in the process of hiring a canteen manager. Please keep an eye out for updates on when our canteen will be ready for use.

Innovative learning environments

The upgrade at Queanbeyan East Public School has been completed. This exciting project now delivers innovative learning environments for the next generation of young minds.

Innovative learning environments provide flexibility where teachers can provide opportunities for student engagement. The learning spaces:

- are adaptable to accommodate small or large groups
- include learning neighbourhoods with flexible spaces that allow students to use technology in a variety of settings
- provide opportunities to enhance skills in collaboration, communication, critical thinking, problem solving and creativity.





Frequently asked questions

What is being delivered in the upgrade at Queanbeyan East Public School?

We are excited to announce the main works for the Queanbeyan East Public School upgrade has been completed. The upgrade includes a new building with 11 flexible learning spaces, common learning areas and new student amenities.

Which classes are being relocated?

All classes will be relocating in 2020. More information will be provided to students at the start of the school term.

What are innovative or flexible learning spaces?

Innovative learning spaces are flexible and well-resourced so that teachers can design a wide range of learning activities to develop the skills and knowledge of students.

Will there be any changes to the school entrances?

In the mornings students can enter the school via the two gates on Thurrallilly Street and the new gate on Mulloon Street (near the bus stop). Exit is via these gates and at Yass Road.

Will there be any changes to the Out of School Hours Care?

No, out of school hours care will continue to operate as normal.

Will there be any changes to parking, staff parking or the bus stop?

No. These remain unchanged and will continue to operate as usual.

Contact us

For more information about this project contact School Infrastructure NSW:

Website: schoolinfrastructure.nsw.gov.au

Email: schoolinfrastructure@det.nsw.edu.au

Phone: 1300 482 651

For information about school activities and operations, contact the school directly:

Principal: Danny Scott

Website: queanbeyae-p.schools.nsw.gov.au

Email: queanbeyae-p.school@det.nsw.edu.au

Phone: 02 6297 2619