

BUS

mm

Width : 2500
 Track : 2500
 Lock to Lock Time : 6.0
 Steering Angle : 36.6

Legend

Vehicle Clearance of 600mm 

Vehicle Body 

EET

Monday, April 8, 2019 9:02:36 AM

REV	DATE	DRN	CHK	DESCRIPTION
00	05-04-19	DA		

Picton High School Redevelopment
 Swept Path Assessment
 12.5 m Long Bus

DRAWN: DA
 DATE: 08-04-19
 SCALE: 1:500 @ A3
 DWG NO: 300303009-03SB



Monday, April 8, 2019 9:02:36 AM

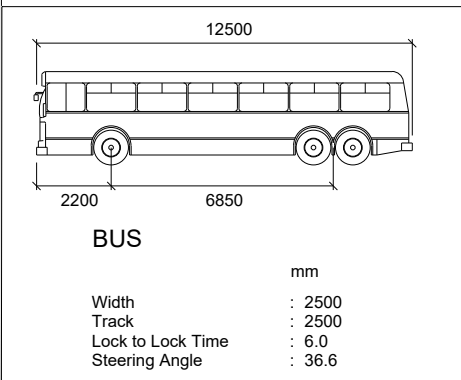

REV	DATE	DRN	CHK	DESCRIPTION
00	05-04-19	DA		

Picton High School Redevelopment
 Swept Path Assessment
 12.5 m Long Bus

DRAWN: DA --- ---
 DATE: 29-03-19 STATUS: ---
 SCALE: 1:500 @ A3
 DWG NO: 300303009-03SB

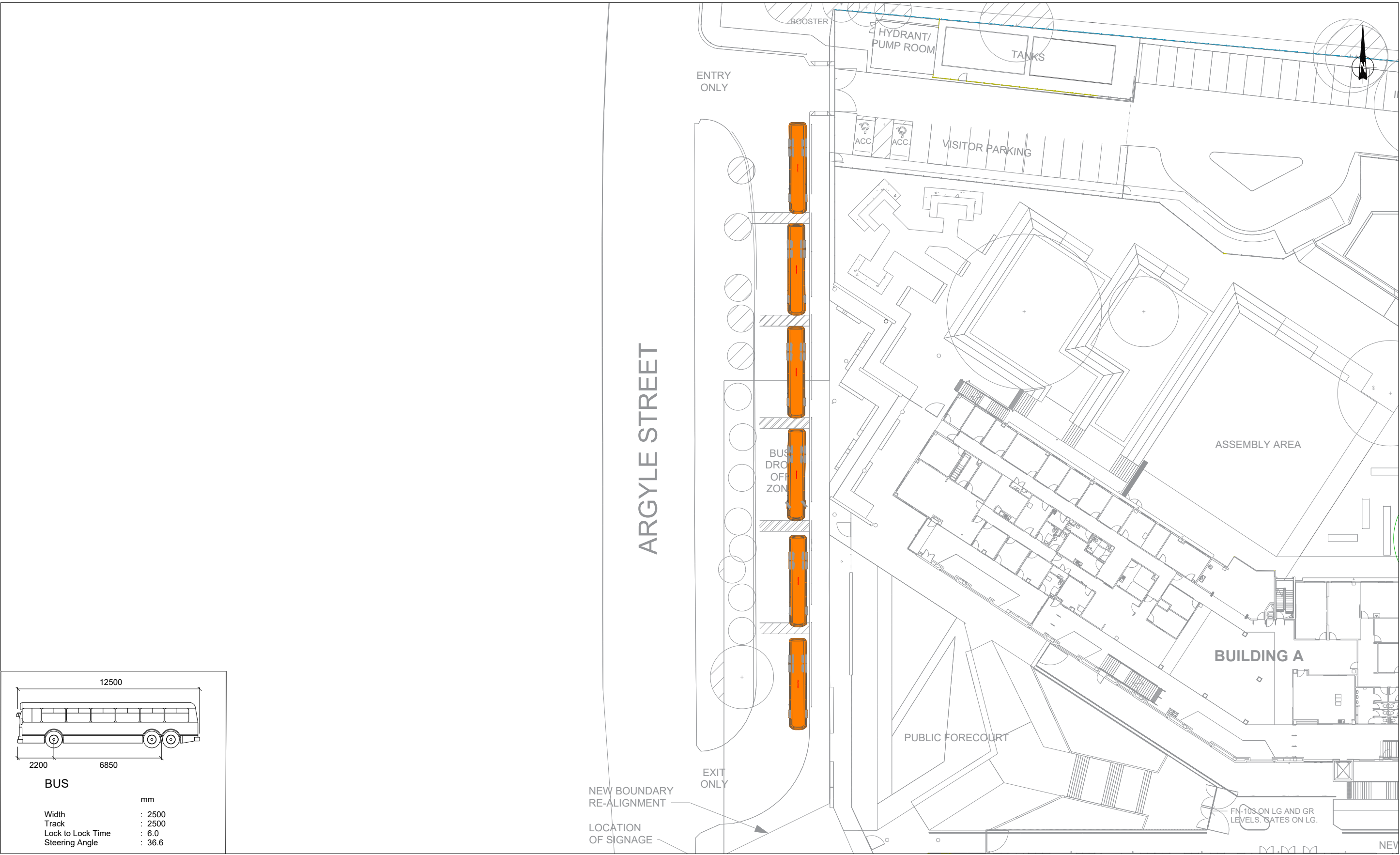

Inbound

ARGYLE STREET

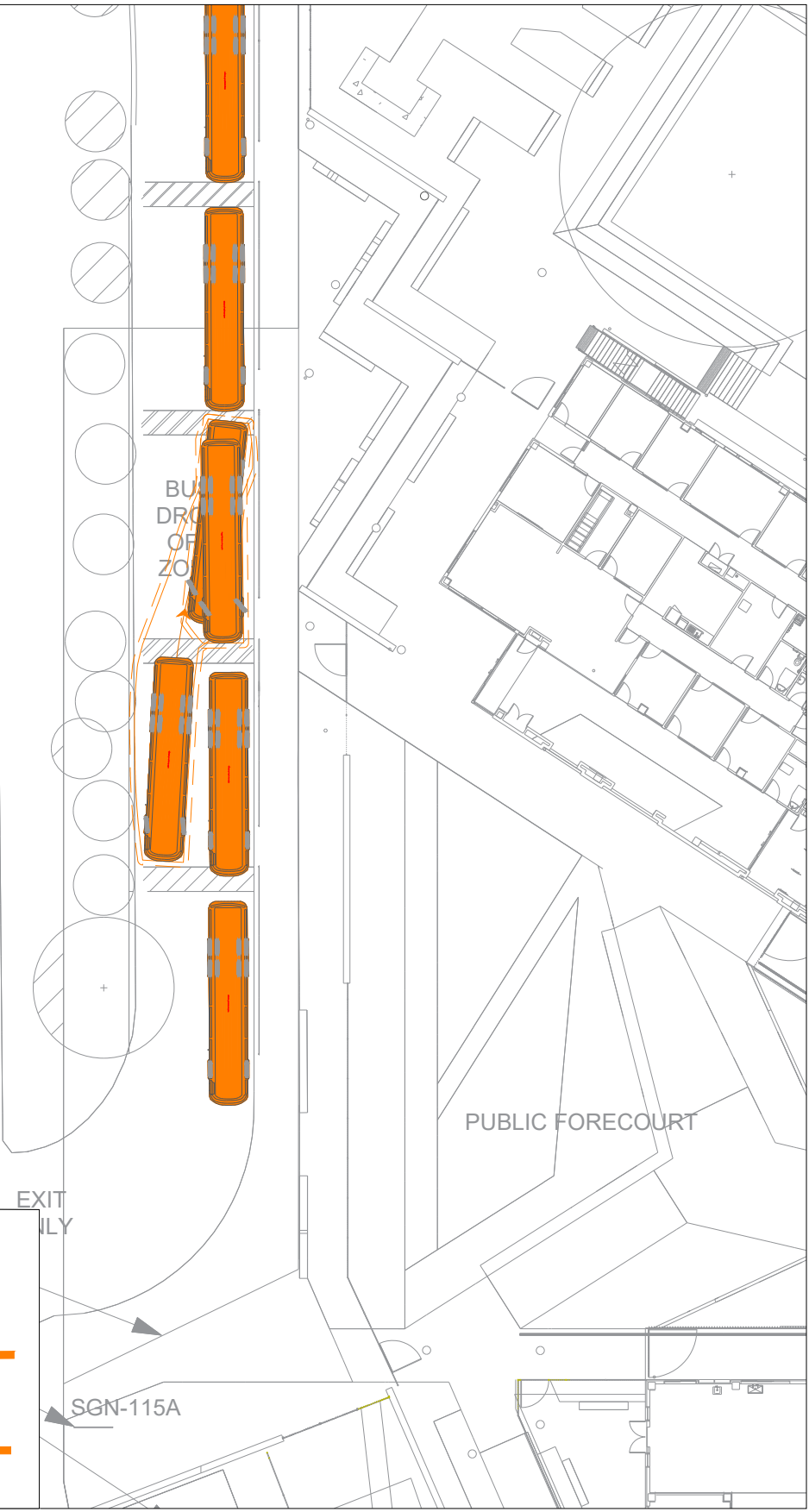

Outbound

ARGYLE STREET

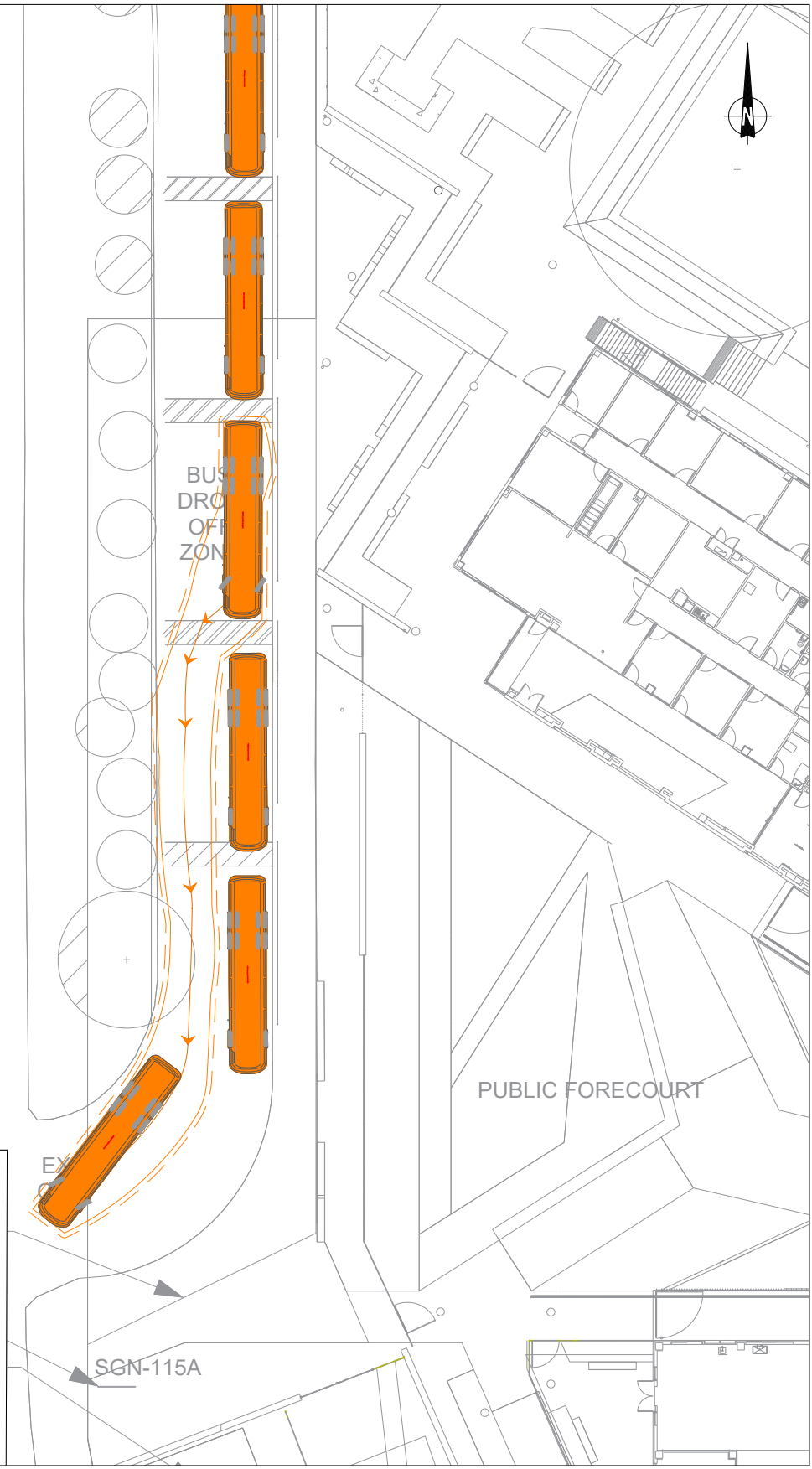

Legend

Vehicle Clearance of 300mm



Vehicle Body

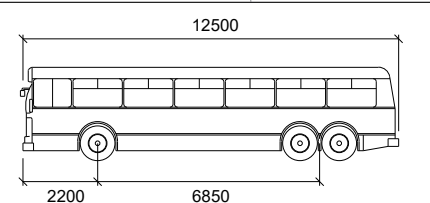

BUS

mm

Width : 2500
Track : 2500
Lock to Lock Time : 6.0
Steering Angle : 36.6

Monday, April 8, 2019 9:02:36 AM

REV	DATE	DRN	CHK	DESCRIPTION
00	08/04/19	DA		

Picton High School
LEAP FROG ANALYSIS
12.5m BUS

DRAWN: DA --- ---
DATE: 05-04-19 STATUS: ---
SCALE: 1:400 @ A3
DWG NO:300303009-03SB



Inbound

ARGYLE STREET

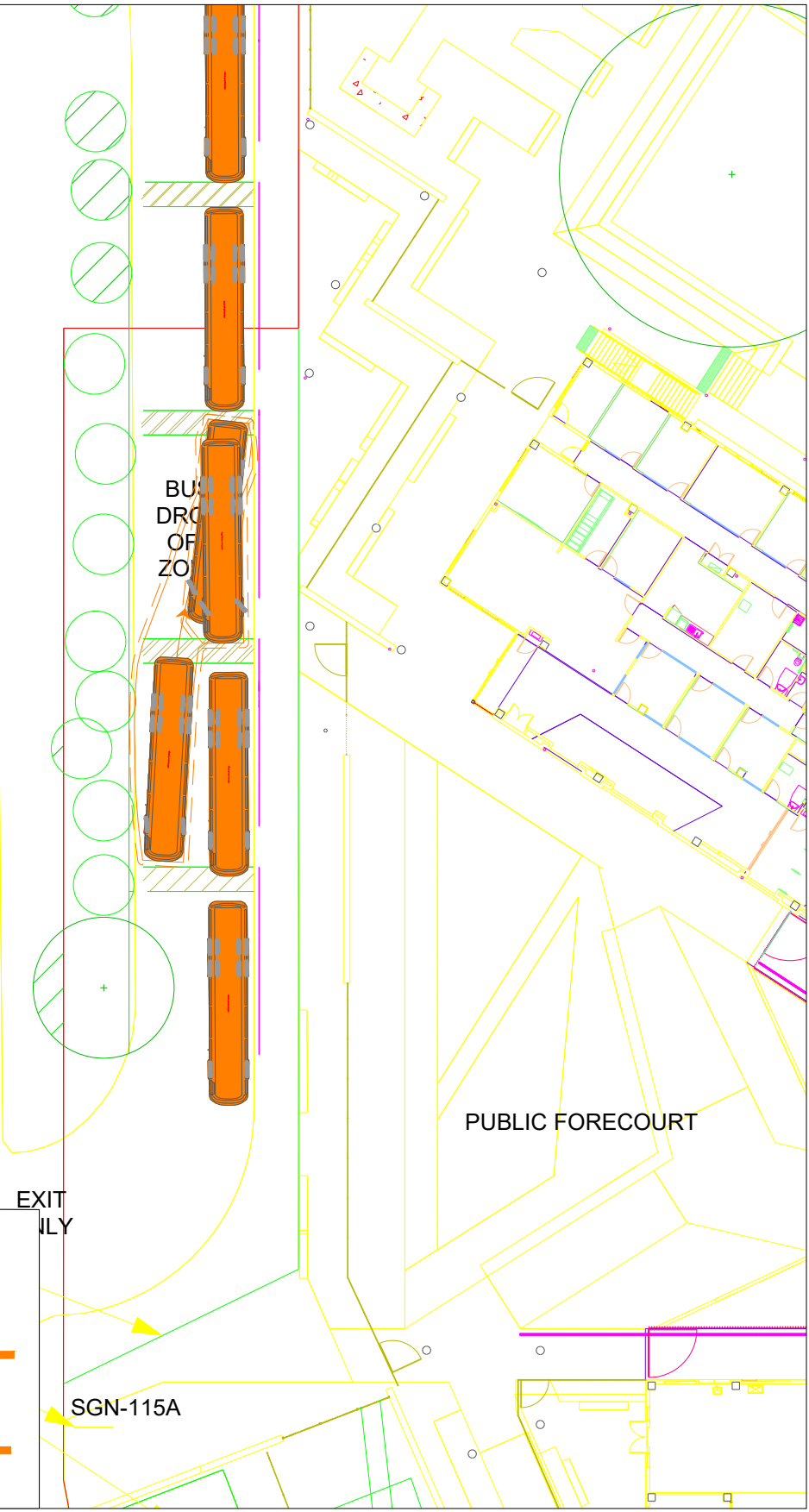

Outbound

ARGYLE STREET

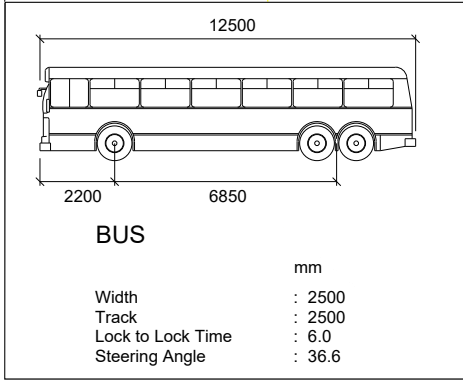
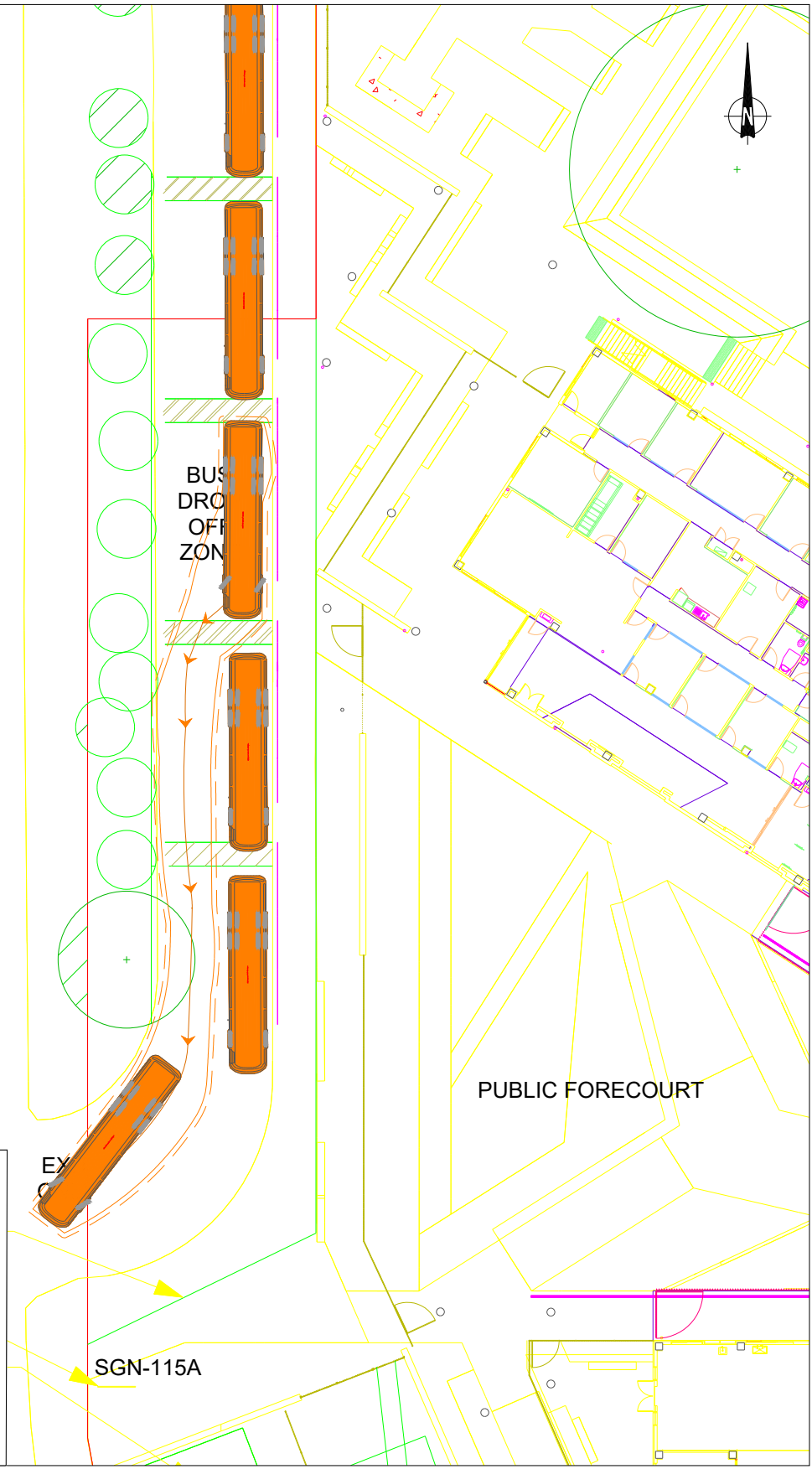

Legend

Vehicle Clearance of 300mm



Vehicle Body



Friday, April 5, 2019 9:46:00 AM

REV	DATE	DRN	CHK	DESCRIPTION
00	05/04/19	DA		

Picton High School
LEAP FROG ANALYSIS
12.5m BUS

DRAWN: DA --- ---
DATE: 05-04-19 STATUS: ---
SCALE: 1:400 @ A3
DWG NO:300303009-03SA



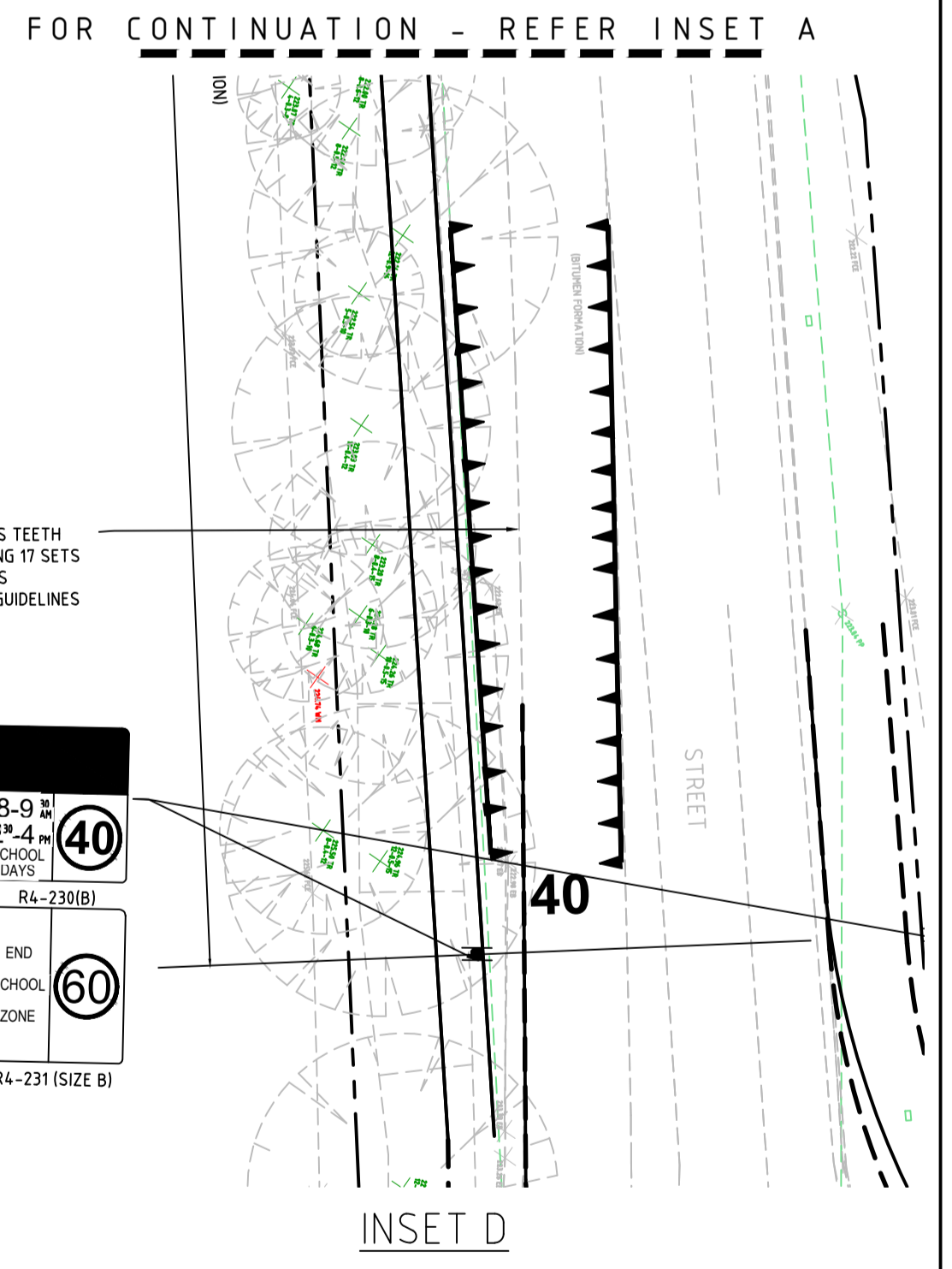
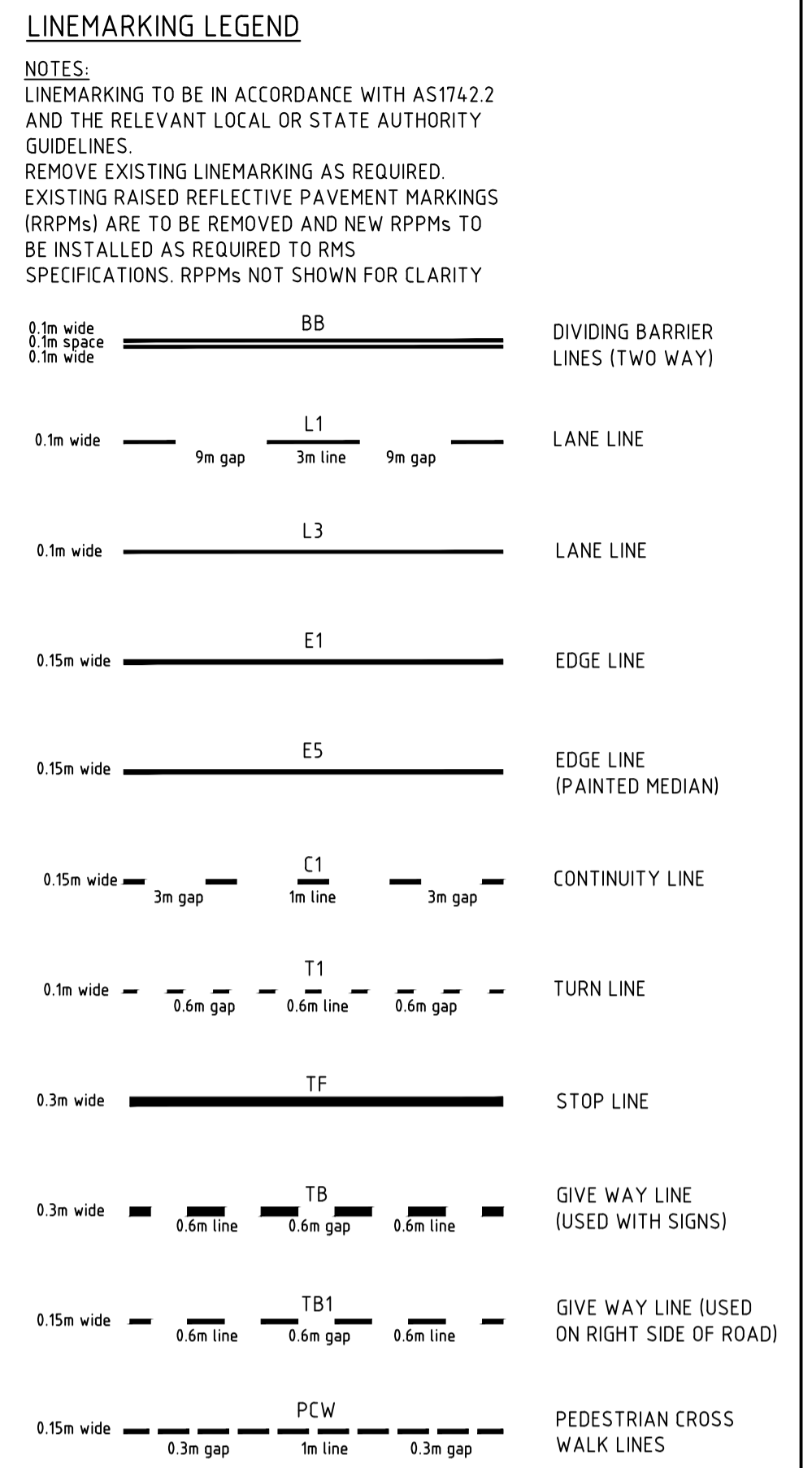
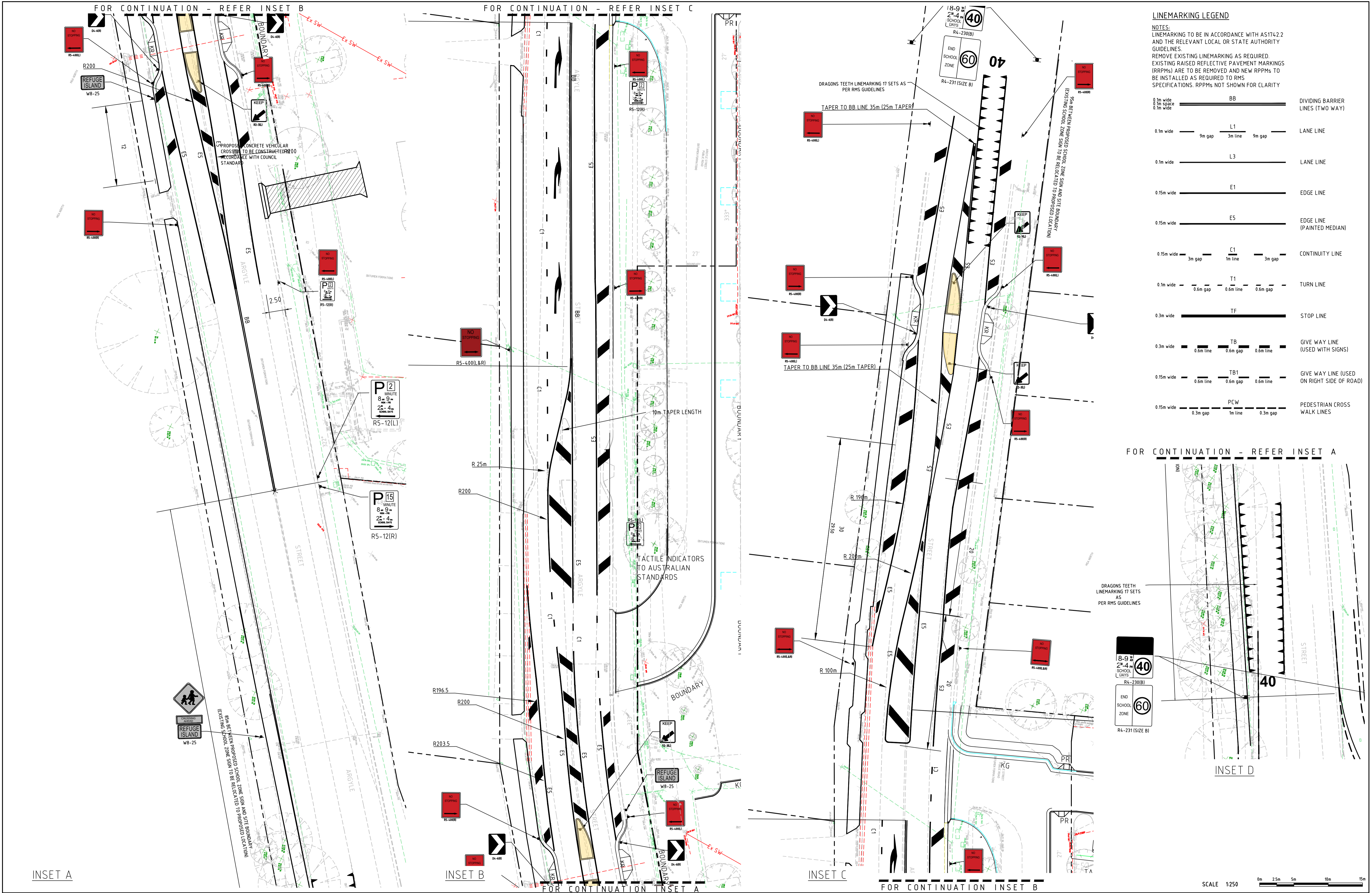

SCALE 1:250

COPYRIGHT: These drawings, plans and specifications and the copyright therein are the property of the Bonacci Group and must not be used, reproduced or copied wholly or in part without the written permission of the Bonacci Group.

Rev	Description	Date	By	App	Rev	Description	Date	By	App
AB	FOR APPROVAL	12.06.18	MJD	-					
AA	FOR APPROVAL	1.05.19	DV	-					

BONACCI

BONACCI GROUP (NSW) Pty Ltd
 ABN 29 102 716 352
 Consulting Engineers, Structural - Civil - Infrastructure
 Level 6, 37 York Street, Sydney, NSW 2000 Australia
 Tel: +61 2 8247 8400 Fax: +61 2 8247 8444
 sydney@bonaccigroup.com
 www.bonaccigroup.com

Project Name	PICTON HIGH SCHOOL REDEVELOPMENT PICTON, NSW 2571	
Drawing Title	SIGN POST AND MARKING PLAN	
Designed	SN	Project Director Approved
Drawn	DB	Date
Scale	1:250	Project Ref
Date	MAY 19	Drawing No
Sheet	A1	Rev

North

20 21888 01 C602 AB

File: G:\Jobs\2021\88801_1_Civil\Issued\DWG\2021\88801-1-C602-CAD\AB1.dwg Plot: 12.06.19 at 4:34 PM By: Mark O'Callaghan

LINEMARKING LEGEND

NOTE
LINEMARKING TO BE IN ACCORDANCE WITH AS1742.2
AND THE RELEVANT LOCAL OR STATE AUTHORITY
GUIDELINES.

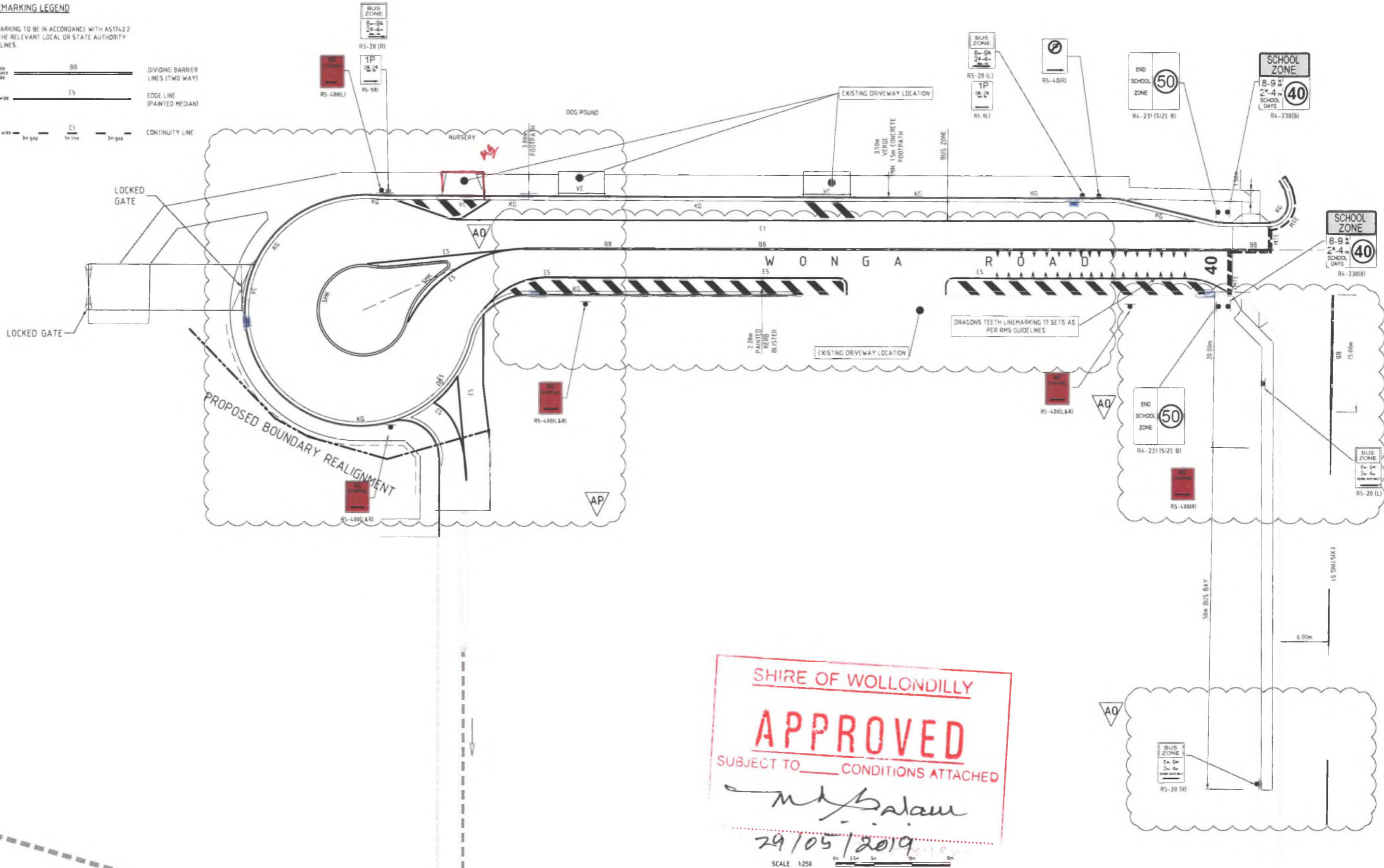
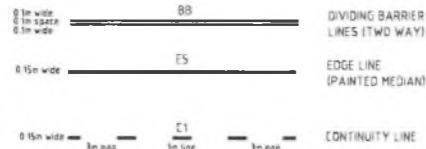

SHIRE OF WOLLONDILLY

APPROVED

SUBJECT TO _____ CONDITIONS ATTACHED

M. Salam

29/05/2019

SCALE 1:250

COPYRIGHT
These drawings, plans and specifications and the copyright therein are the property of the Council Group and must not be used, reproduced or copied wholly or in part without the written permission of the Council Group.

Rev	Description	Date	By	App
AJ	COUNCIL COMMENTS	12/02/18	MS	-
AK	DETAILED DESIGN	27/01/18	BF	-
AJ	DETAILED DESIGN	16/01/18	BF	-
AJ	DETAILED DESIGN	12/02/18	BF	-
AJ	PRELIMINARY	16/02/18	BF	-

Rev	Description	Date	By	App
AP	COUNCIL SUBMISSION (COUNCIL COMMENTS)	29/04/18	DV	-
AQ	COUNCIL SUBMISSION (COUNCIL COMMENTS)	18/04/18	DV	-
AN	COUNCIL SUBMISSION (COUNCIL COMMENTS)	27/03/18	LE	-
AM	COUNCIL SUBMISSION	20/03/18	MS	-



Project Name: PICTON HIGH SCHOOL WONGA ROAD EXTENSION PICTON, NSW 2571

Drawing Title: WONGA ROAD SIGN POST AND LINEMARKING

DETAILED DESIGN

Designed	BF	Project Director Approved	Date	
Drawn	BF			
Scale	1:250			
Date	OCT 2018			
Sheet	A1	20 21888 01	C422	AP

File: C:\Users\201801011..._Comb20180801\C422.dwg, Plot Date: 20/04/19 at 5:08 PM, By: Danyl Vitgida