



Picton High School Redevelopment

Changes to bus pick up and drop off area

July 2020

Investing in our schools

The NSW Government is investing \$6.7 billion over four years to deliver more than 190 new and upgraded schools to support communities across NSW. In addition, a record \$1.3 billion is being spent on school maintenance over five years. This is the largest investment in public education infrastructure in the history of NSW.

The NSW Department of Education is committed to delivering new and upgraded schools for communities across NSW. The delivery of these important projects is essential to the future learning needs of our students and supports growth in the local economy.

Picton High School

A major project is underway to redevelop Picton High School. The redevelopment will provide new flexible learning spaces, a new library and administration area, performing arts space, special education facilities and a covered outdoor learning area and recreation areas. The existing hall will be refurbished. The upgraded school will have capacity for 1500 students.

Changes to drop off and pickup areas

Works to install a new roundabout near the temporary school entrance in Wonga Road are nearly complete. The new roundabout and bus pick up and drop off area will allow bus and vehicle access to the temporary school while works take place on the existing Argyle Street entrance and bus area.

Commencing Week 1, Term 3, there will be changes to student drop off and pick up arrangements. Picton High School, Picton Buslines and the project team are working closely to ensure the changes create minimal impacts to students, parents and carers.

Bus pick up and drop off areas

From Week 1, Term 3 (20 July), all school buses will drop off and pick up students at the new Wonga Road bus area, near the entrance of the temporary school. Each day when school finishes, teachers will organise for students to wait within the school grounds until their bus arrives, and then will guide them safely to the bus area.

For more information contact:

School Infrastructure NSW
Email: schoolinfrastructure@det.nsw.edu.au
Phone: 1300 482 651
www.schoolinfrastructure.nsw.gov.au

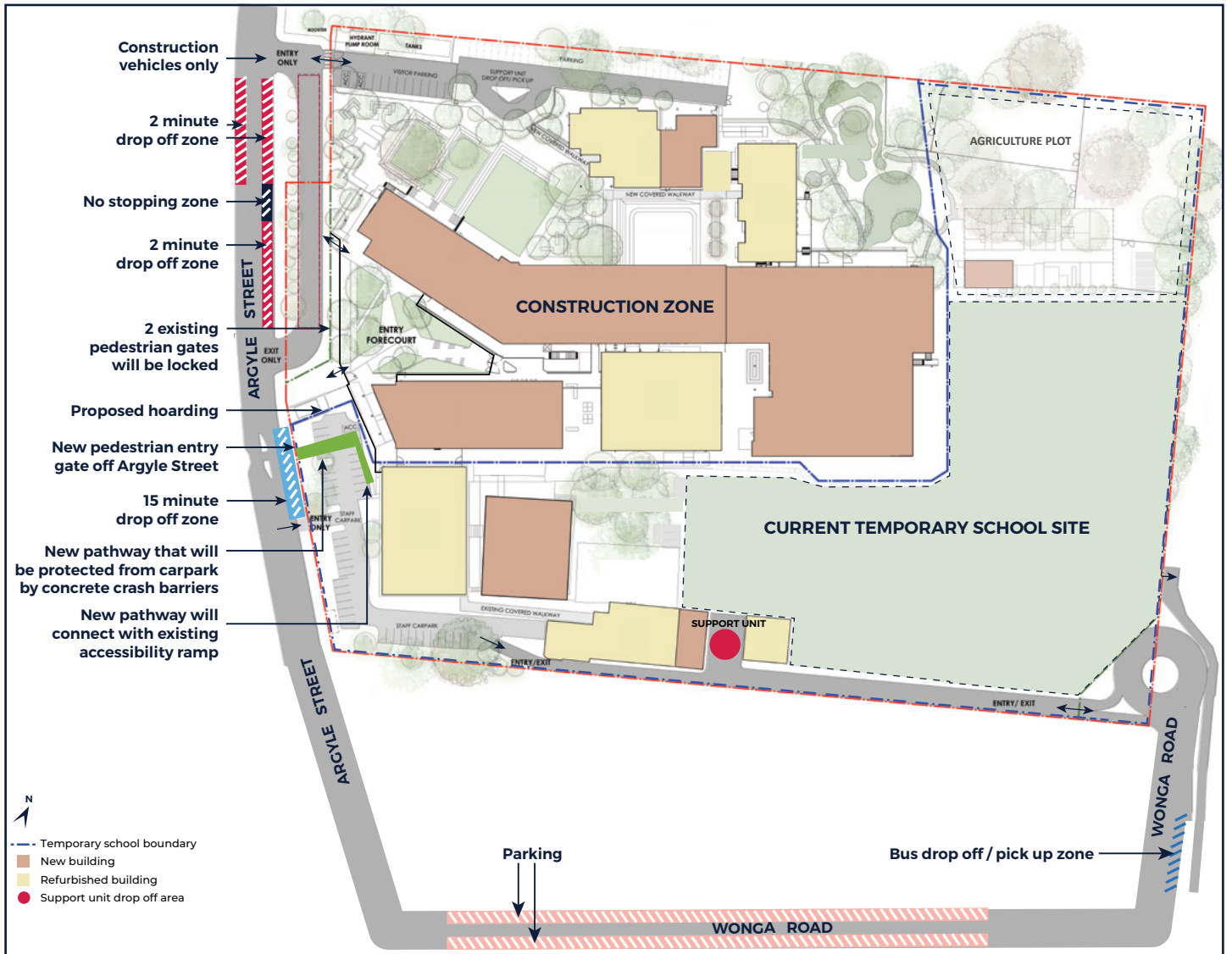

Picton High School site map

Vehicle pick up and drop off areas for parents and carers

Before 9:00am and after 2:30pm

There will be no vehicle access to the rear temporary school entrance on Wonga Road before 9:00am and after 2:30pm. During these times parents and carers can utilise the short term drop off areas on Argyle Street, or parking on Argyle Street and the section of Wonga Road opposite Derks Picton.

Parents and carers should not drive their vehicles into the existing bus area on Argyle Street or the new bus area on Wonga Road before 9:00am or after 2:30pm on school days.

During school hours (9:00am-2:30pm)

Parents and carers needing to visit the school during school hours can use the new Wonga Road bus area for short term parking to visit the school office or collect students as needed. Please note that vehicles must be moved from this area by 2:30pm each day to enable buses to be ready when students finish school.

Student parking

Students can continue using all day parking on Argyle Street and the section of Wonga Road opposite Derks Picton. Students are reminded to always cross safely and use the pedestrian islands.

Frequently asked questions

Why are the bus areas changing?

The new Wonga Road bus area will be operational while works are undertaken on the existing Argyle Street bus area. Once complete, the Argyle Street bus area will be an improved space for buses to drop off and collect students at the upgraded school.

The Wonga Road bus area will also remain once the upgrade is complete, providing a second bus area for the school and a new turning area for buses on Wonga Road.

Where do I park if I need to visit the school during school hours?

During school hours cars will be allowed to park in the new Wonga Road bus area. Please note that no cars should be parked in the Wonga Road bus area anytime before 9:00am or after 2:30pm.

Where do I park to drop off or collect students before and after school?

Parents and carers who drive their students to and from school can use the existing short term and long term parking areas on Argyle Street and on Wonga Road near Derks Picton.

Where can staff park?

There is limited staff parking available on school grounds, which is managed by Picton High School. Additional staff parking is available on Argyle Street and on Wonga Road near Derks Picton.

Is there designated car parking for workers on the school upgrade?

Yes, there is a designated car park for project workers and contractors on the corner of Wonga Road and Argyle Street. This has been arranged to minimise impacts on parking for the school community and local residents.

How long will these arrangements be in place?

The new bus drop off and pick up arrangements are scheduled to be in place until students move to the new school in late 2021.