



Example of upgraded learning facilities being delivered across NSW

## Orange Grove Public School

Planning update | June 2022

### Investing in our schools

The NSW Government is investing \$7.9 billion over the next four years, continuing its program to deliver 215 new and upgraded schools to support communities across NSW. This is the largest investment in public education infrastructure in the history of NSW.

The NSW Department of Education is committed to delivering new and upgraded schools for communities across NSW. The delivery of these important projects is essential to the future learning needs of our students and supports growth in the local economy.

### Project overview

Orange Grove Public School is being upgraded and the project will include additional fit-for-purpose learning spaces and upgraded core facilities to meet enrolment growth.

### Progress summary and next steps

We are currently in the planning phase of the project. During the project's early planning, a site analysis was conducted which takes into consideration the requirements for the growing student population of the region. An early site plan (overleaf) has been developed which proposes a new building, a hall and an outdoor learning area (COLA) along the western side of the school and the removal of the existing demountable buildings along the eastern side of the school. This layout takes into consideration a number of factors including demographic trends, educational requirements, enrolments, transport links, site analysis and due diligence studies, and partnership opportunities.

We have started early discussions with Inner West Council aimed at seeking preliminary guidance on the statutory planning process, known as 'pre-DA'. As part of this process, early planning documents have been published on the Inner West Council planning website. These documents indicate a very early proposal of the project which do not reflect the final plans or the final scope of the project to be submitted as part of the future Development Application.

We have also begun consultation with key experts such as arborists and ecologists to identify a proposed plan to minimise impact on the existing biodiversity of the site. Consultation with key stakeholders such as Inner West

### For more information contact:

School Infrastructure NSW  
Email: [schoolinfrastructure@det.nsw.edu.au](mailto:schoolinfrastructure@det.nsw.edu.au)  
Phone: 1300 482 651  
[www.schoolinfrastructure.nsw.gov.au](http://www.schoolinfrastructure.nsw.gov.au)

Council and Transport for NSW continues. The design will continue to be refined in consultation with the Project Reference Group, the project architect and other technical experts.

## Early site plan

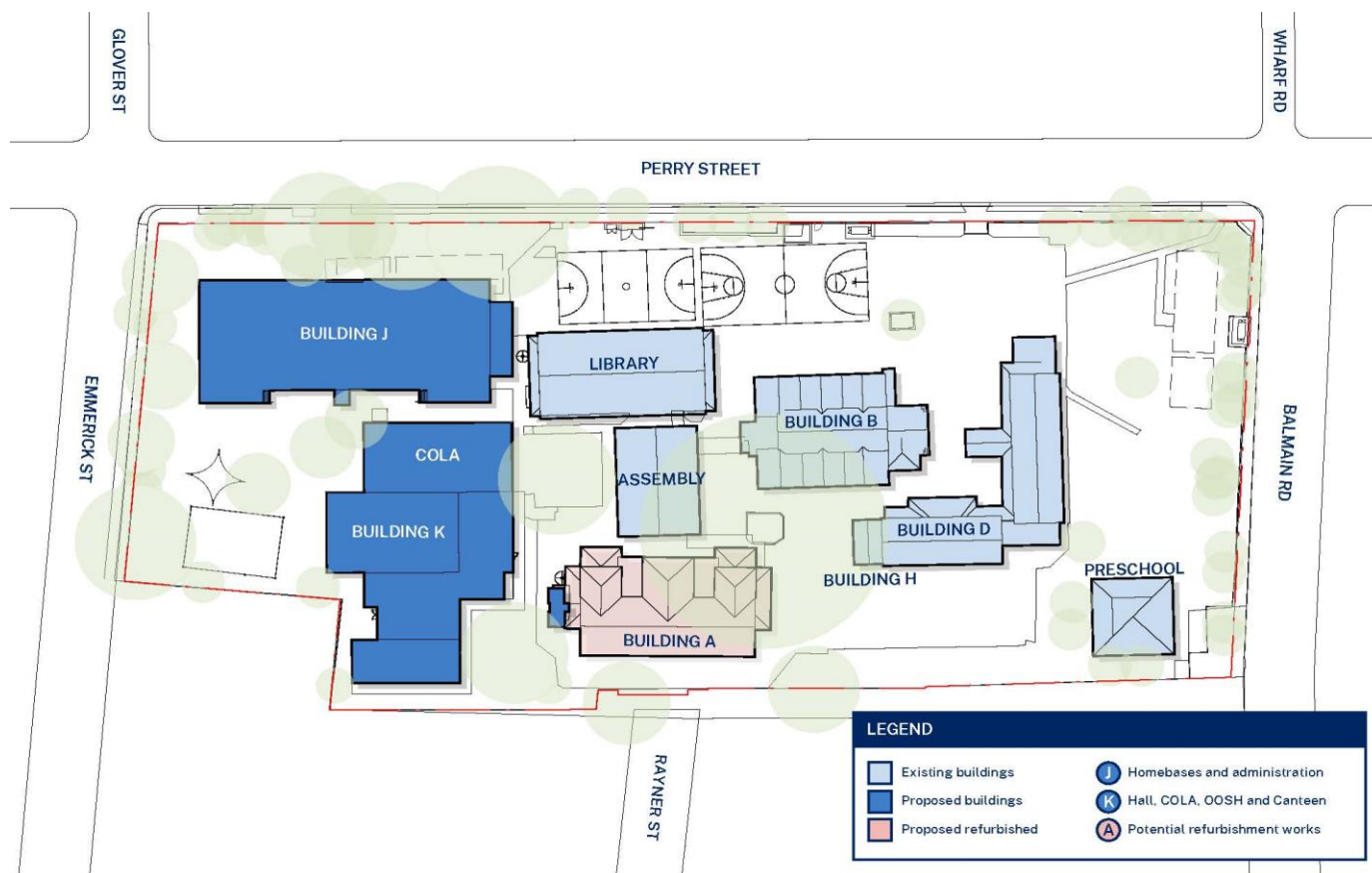

## Have your say

We are committed to working together with our school communities and other stakeholders to deliver the best possible learning facilities for students. Share with us what's important to you by completing our online survey by accessing the QR code or link below. The survey will be open from **Tuesday 14 June** until **Tuesday 28 June**.



<http://edu.nsw.link/OGPSSurvey>

We will be hosting a community information session ahead of our development application to seek feedback and provide information about the proposed scope and planning approach.

Once finalised, the plans will be shared with community for feedback prior to seeking formal planning approval at the time of lodgement of the relevant development application. Following lodgement, there will be an opportunity to submit further feedback to Council during the public exhibition process.

## For more information contact:

School Infrastructure NSW  
Email: [schoolinfrastructure@det.nsw.edu.au](mailto:schoolinfrastructure@det.nsw.edu.au)  
Phone: 1300 482 651  
[www.schoolinfrastructure.nsw.gov.au](http://www.schoolinfrastructure.nsw.gov.au)