

Oran Park High School

Welcome



Welcome to your school

We're excited your new school facilities are ready for you to use.
Your new school includes:



90 flexible
learning spaces



New hall to
accommodate two
basketball courts



Makerspace



A hospitality
cafe



Fitness and
performance studio



Senior learning
centre

Thank you for your patience during construction. We are thrilled to deliver this project for your school community and hope you enjoy your new spaces. Share your back to school experience with **#Ready2020**.

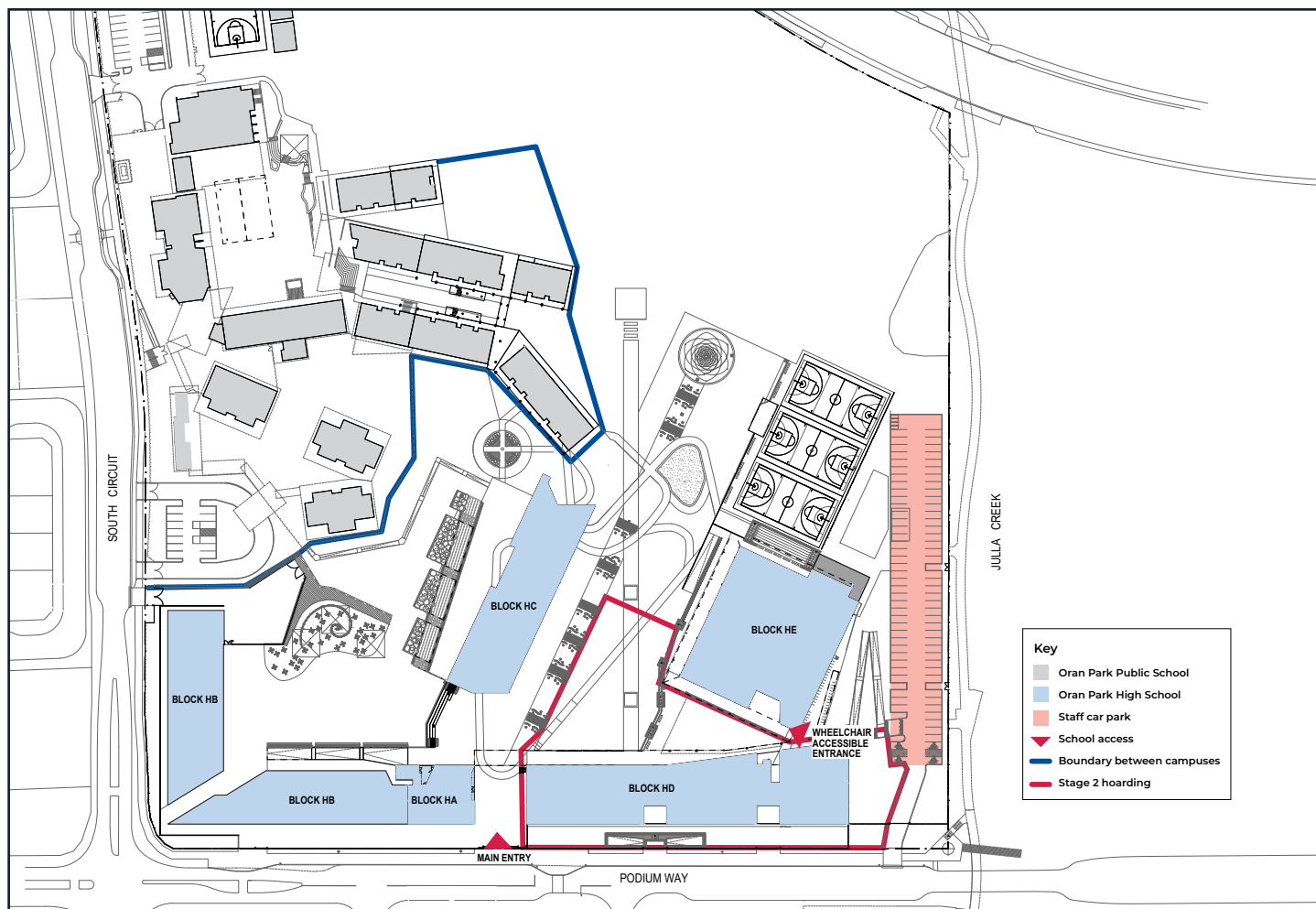

Oran Park High School site map

Message from your Principal

Coming to high school is a major event in every young person's life but being a part of the first cohort to attend a brand new school is something that very few students get to experience. My staff and I are thrilled to be able to share this wonderful journey with you.

As we move into our beautiful new learning spaces over the next few months, we need to keep in mind that great schools are not about modern buildings but about the people that work and learn within those buildings. Our highly-skilled and talented staff aim to instil in students values of team-work, being respectful, striving towards achievement and being kind.

Oran Park High School will have strong partnerships with our primary schools and become the heart of a new and growing community. We are looking forward to sharing our new school with our students and the wider school community and developing a learning partnership.

We thank you for your patience during construction. We are thrilled to deliver this project for the school community.

Brad Mitchell, Principal

Innovative learning environments

The new Oran Park High School is now in operation. This exciting project now delivers innovative learning environments for the next generation of young minds.

Innovative learning environments provide flexibility where teachers can provide opportunities for student engagement. The learning spaces:

- are adaptable to accommodate small or large groups
- include learning neighbourhoods with flexible spaces that allow students to use technology in a variety of settings
- provide opportunities to enhance skills in collaboration, communication, critical thinking, problem solving and creativity.

Frequently asked questions

What is being delivered at the new Oran Park High School

We are excited to welcome our new Year 7 and 8 students to Oran Park High School. The new school includes:

- 90 innovative learning spaces
- core facilities including fitness and performance studios, a hospitality café, makerspaces and a senior learning centre
- a hall to accommodate two basketball courts.

Delivery of this project is being coordinated with the upgrade to Oran Park Public School.

Are there ongoing works during Term 1?

Works to be undertaken during Term 1 include internal fit out of block HD, associated landscaping works and installation of external sun shades. This area will not be accessible to students or staff until works are complete. It is expected these works will be complete by Term 2 2020.

Will there be constructions work ongoing in 2020?

The majority of the classrooms have been completed. Stage 2 works will continue throughout Term 1 and will be complete by Term 2 2020.

What safety measures will be in place?

The safety of the school's students, staff and the local community is our highest priority. Construction planning has been designed so there is minimal impact on school operations. Safety measures such as hoarding, signage and separate access points are in place to ensure students are not able to enter the construction site.

To minimise disruption to school operations and activities, site deliveries will be scheduled outside of school drop off and pick up times and traffic control personnel will be on site to assist with contractor deliveries.

What steps will be taken to control noise and dust impacts?

Hoarding and shade cloth have been erected to reduce noise and dust impacts on the school and our neighbours. Other dust mitigation strategies will be used as required.

How will traffic be managed?

Traffic control and security measures are in place where required for the safety of the community.

What are the school start, finish and break times?

- School start time: 8:50am
- School finish time: 3:00pm (Tuesdays: 2:35pm)
- Recess: 10:15-10:45am
- Lunch: 1:15-1:45pm

How do I enrol my child?

Any new enrolments will be required to complete an enrolment form and provide the following information to the office:

- Birth certificate
- Two most recent school reports
- 100 point residency identification

Once this is received a risk assessment is sent to the previous school. When this is received an interview is booked with one of the deputy principals, either Ms Kristie Harris (Year 7) or Mr Chris Hollis (Year 8). A start date will be given during the interview.

How do the classes run?

A school day consists of 4 x 75 minute periods which run on a two week cycle.

Term 1: Week B start

Term 2, 3, 4: Week A start

Classes are of mixed ability and are named after gemstones:

A – Aquamarine	P – Pearl	J – Jade
D – Diamond	Q – Quartz	O – Opal
E – Emerald	S – Sapphire	R – Ruby
G – Garnet	T – Topaz	

What are the school values and the Grand Prix House Championship?

Oran Park High School is a Positive Behaviour for Success School. Our core values are TRAK.

- T – Team Work
- R – Respect
- A – Achievement
- K – Kindness

In the Grand Prix House Championship students will have the opportunity to earn individual merit points for their own achievement levels whilst also contributing to their own house in an attempt to become the House Champion. Students will achieve these points based on our school values.

Houses:

- Birrung (Yellow)
- Ngura (Green)
- Waratah (Red)
- Badu (Blue)



Oran Park High School

Frequently asked questions (cont.)

How are we working with Oran Park Public School to support student transition?

Oran Park High School and Oran Park Public School have developed a middle school program that focuses on building skills of creativity, communication, critical thinking and fostering collaboration to support a successful transition for students. The program runs each week and involves students and staff working on projects that are both interesting and educational. A showcase event will be held at the end of each semester to display the projects and celebrate student achievements.

Contact us

For more information about this project contact School Infrastructure NSW:

Website: schoolinfrastructure.nsw.gov.au

Email: schoolinfrastructure@det.nsw.edu.au

Phone: 1300 482 651

For information about school activities and operations, contact the school directly:

Principal: Brad Mitchell

Website: oranpark-h.schools.nsw.gov.au

Email: oranpark-h.school@det.nsw.edu.au

Phone: 02 4648 0057