

# New primary and high School in Box Hill

Information Pack – July 2025









Artist impression of the schools from Keeneland Street - Subject to change

Planning is well underway to deliver a new public preschool, primary school and high school for Box Hill to cater for the growing community. The new primary school will cater for up to 1,000 students and will include:

|   |  |  |                                    |  |                                       |
|---|--|--|------------------------------------|--|---------------------------------------|
|   | <b>44 classrooms</b>                                       |   | <b>3 support classrooms</b>        |   | <b>Amenities throughout</b>           |
|  | <b>Core facilities including canteen, hall and library</b> |  | <b>Sports court and play areas</b> |  | <b>Covered outdoor learning areas</b> |

The first stage of the new high school will cater for up to 1,000 students and will include:

|  |   |   |   |   |  |
|--|---|---|---|---|--|
|  | <b>50 classrooms including specialists classrooms to cater for science, arts, wood and metal work</b> |  | <b>7 support classrooms</b>                                       |  | <b>Hospitality kitchen</b>   |
|  | <b>Amenities throughout</b>   |  | <b>Modern core facilities including canteen, hall and library</b> |  | <b>Sports fields and courts and covered outdoor learning areas</b> |

The new preschool will be able to accommodate for up to 60 children per day and will include:

|  |                          |   |                          |   |   |
|--|--------------------------|---|--------------------------|---|---|
|  | <b>3 preschool rooms</b> |  | <b>Outdoor play area</b> |  | <b>Administration area, amenities and staff kitchen</b> |
|--|--------------------------|---|--------------------------|---|---|



**For more information**

Phone: 1300 482 651  
 Email: [schoolinfrastructure@det.nsw.edu.au](mailto:schoolinfrastructure@det.nsw.edu.au)  
 Website: [schoolinfrastructure.nsw.gov.au](http://schoolinfrastructure.nsw.gov.au)



# Box Hill Public School and Box Hill High School temporary facilities

Box Hill Public School opened for students in Kindergarten to Year 3 on Day 1 of Term 1, 2025, in purpose-built temporary facilities. The second stage of the school will welcome students in Years 3 to 6 on Day 1 of Term 3, 2025.

To ensure continuity of learning, the department is establishing temporary facilities for Box Hill High School students who will start Year 7 in 2026. This will expand to accommodate Year 8 students in 2027 as they progress through Box Hill Public School.

The existing site located on George Street, Box Hill, has been identified as having sufficient space to cater for 600 primary school students and up to 300 high school students.

The temporary schools will operate separately, with distinct entrances, administration areas, libraries, and classrooms to meet each school's curriculum needs.

Existing play spaces will be shared by all students, with their usage coordinated by the school's leadership teams with strategies such as staggered lunch breaks and allocated usage times. Details of these arrangements will be shared with parents once arrangements are finalised.

The site map below shows the proposed setup for the temporary schools; however, it may change as the plan is further developed.



## School enrolments and intake area

We are working to determine the intake area for the new high school using the latest demographic data and trends which encompasses population growth, residential developments, and community needs.

The school intake area will be confirmed in Term 3 2025 and will be published on the 'School Finder' web page at [schoolfinder.education.nsw.gov.au](http://schoolfinder.education.nsw.gov.au). This page is an online tool for parents to use to locate NSW public schools in their intake area. The community will be notified when this information becomes available to ensure everyone is informed and prepared for the upcoming changes.

# Box Hill Public School and Box Hill High School Permanent School Update

The development of the design for the new schools in Box Hill has continued, and we are working to finalise the necessary documentation required for the project to acquire statutory planning approval.

The planning application, known as a Review of Environmental Factors (REF), for this project will be submitted in the coming months and will be placed on public exhibition for 28 days. During this exhibition period, the community will be informed about where to submit feedback and share their thoughts regarding the proposal.

Once the planning application is approved, we will proceed to appoint a construction contractor and develop a detailed construction timeline to keep the community informed about the project's progress.

## Timeline

Expected timelines are subject to external factors such as planning approval and impact from weather.

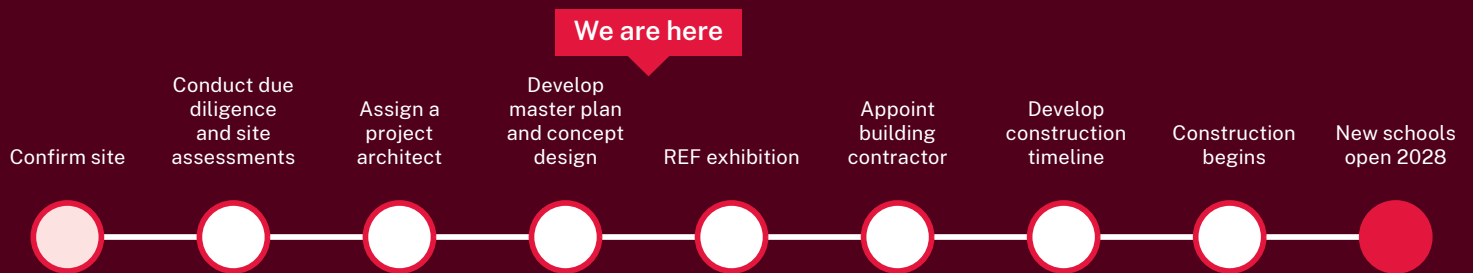

## Proposed site plan Box Hill Schools on Terry Road, Box Hill.

The site plan below shows the proposed layout of the school, this design is still in development and subject to change.

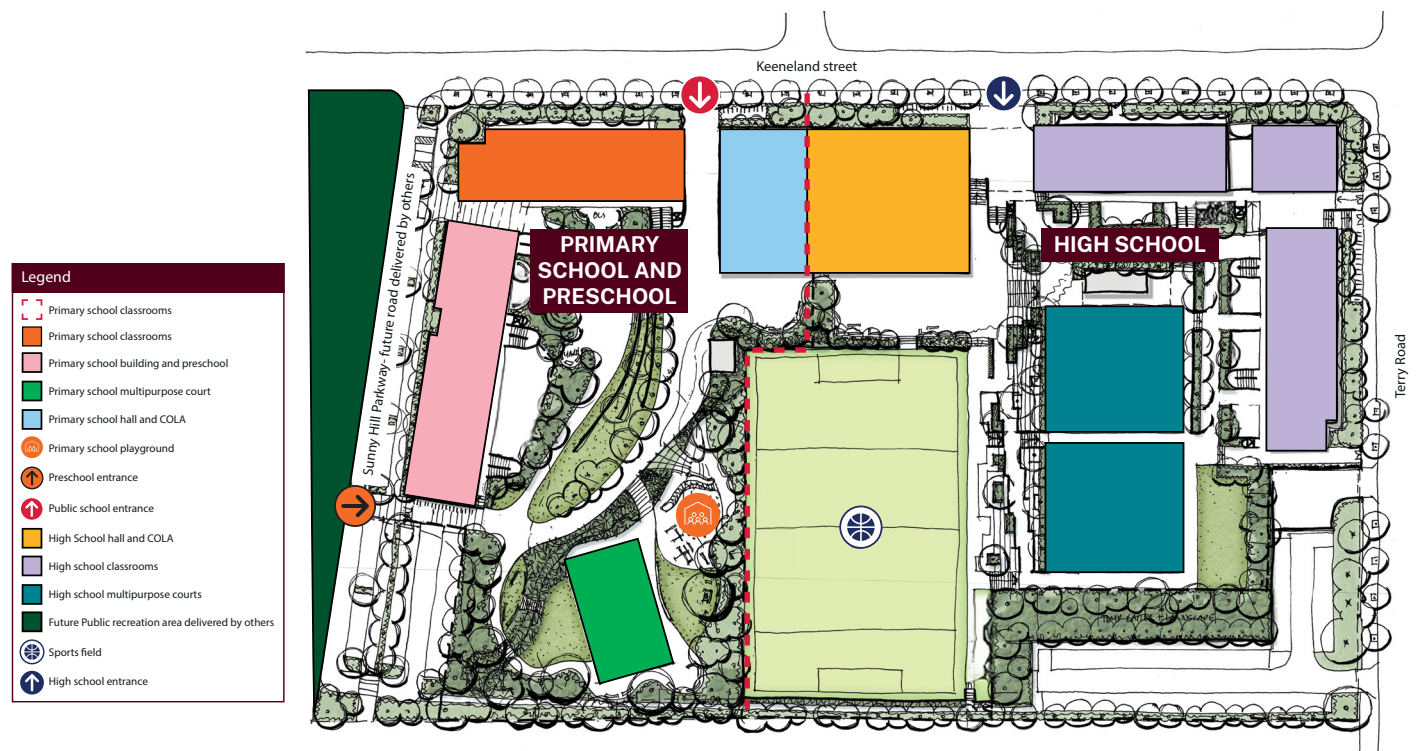

## Frequently asked questions

### How will the schools operate on the same site?

Box Hill Public School and Box Hill High School will operate as separate primary and secondary schools, each with dedicated spaces. Each school will have its own facilities, including separate entrances, administrative offices, libraries, playgrounds, canteens, and toilets, ensuring that students have access to resources tailored to their educational stage.

To promote safety and minimise interactions between primary and high school students, the playgrounds will be separated by fencing and landscaped barriers. This design aims to create a secure environment conducive to age-appropriate play and learning.

While the school halls and administration offices will be located within the same buildings, they will be configured specifically for the dedicated use of each school, ensuring that both institutions can operate independently.

Additionally, the new public preschool will be integrated into the primary school, featuring a separate entrance, amenities, and designated play areas specifically designed for preschoolers. This integration will provide a cohesive educational pathway for children from early learning through to primary school.

### What outdoor space will be available for the permanent facilities?

The new school facilities will provide a variety of outdoor spaces designed for both learning and play. These will include both covered and open-air areas to accommodate different activities and weather conditions.

The facilities will feature several Covered Outdoor Learning Areas (COLAs) and a Covered Outdoor Play Area (COPA) specifically designed for the preschool. These spaces will allow for outdoor learning and play while providing shelter from the elements.

For the primary school, there will be a designated playground area that includes playground equipment, complemented by natural canopy cover from mature trees that will enhance the outdoor experience. An outdoor multipurpose court will also be provided.

The new high school will include sports courts and a field that students can use for various sports and recreational activities. These outdoor spaces are intended to promote physical activity, teamwork, and outdoor learning opportunities for all students.

### Are the new facilities accessible?

The new school facilities will be fully accessible. The main entrance to the new buildings will have level access, providing the same access options for all students regardless of their mobility requirements. Lift access will be available to children and staff who require it. Accessible toilets are available on each level, and outdoor areas have accessible paths to navigate changes in outdoor ground levels.

Other elements that support accessibility include tactile signage, appropriate lighting, hearing support systems to enhance sound and reduce background noise for users of hearing aids and cochlear implants, and ample space in common areas in line with current Australian Building Standards.

### Will Outside of School Hours (OOSH) care be available?

Outside Of School Hours (OOSH) care will be available. The OOSH service will work with the Box Hill Public School leadership team closer to the school being completed to determine the usage of facilities.

### What years will the temporary high school cater for?

The temporary high school will open in a phased manner. Initially, it will only accommodate Year 7 students on Day 1 Term 1 2026. This phased approach will allow us to establish the necessary facilities, staffing, and resources, ensuring that everything is in place before we expand the intake of students.

In the second year of operation from Day 1 Term 1 2027, the school will grow to include both Year 7 and Year 8, with a total capacity to accommodate up to 300 high school students.

### Why does the site for the permanent schools not include 48 Terry Road?

The department has acquired 50 and 52 Terry Road, Box Hill for the new Box Hill primary and high schools. The combined area of 4.7 hectares is big enough to accommodate a large primary and high school along with a public preschool.

The land at 48 Terry Road was originally identified for educational purposes in the Box Hill Industrial Indicative Layout Plan, however, detailed analysis and due diligence confirmed the site did not meet the Department of Education's site selection guidelines. With the acquisition of 50 and 52 Terry Road, Box Hill, it was also determined as surplus to needs for the new school facilities.

Further information about the site selection and design process for new schools is available at [EFSG 2025 Part A](#).

### What amount of play space will the students have in the new schools?

The current design provides approximately 10000 sqm of outdoor play space for the students of Box Hill Public School and 16000 sqm of outdoor play space for the students of Box Hill High School. Additional indoor play space will be provided inside the respective multipurpose halls.

## Contact us

For more information about this project, contact School Infrastructure:

**Website:** [schoolinfrastructure.nsw.gov.au](https://schoolinfrastructure.nsw.gov.au)

**Email:** [schoolinfrastructure@det.nsw.edu.au](mailto:schoolinfrastructure@det.nsw.edu.au)

**Phone:** 1300 482 651