

Day 1  
Term 1

# Welcome



North Kellyville Public School innovative learning space



new modern teaching spaces  
and facilities for up to **1,000** primary  
school students



**40**  
new classrooms



a new hall



a library



enhanced  
open spaces



a canteen



innovative  
learning



covered outdoor  
learning areas (COLA)

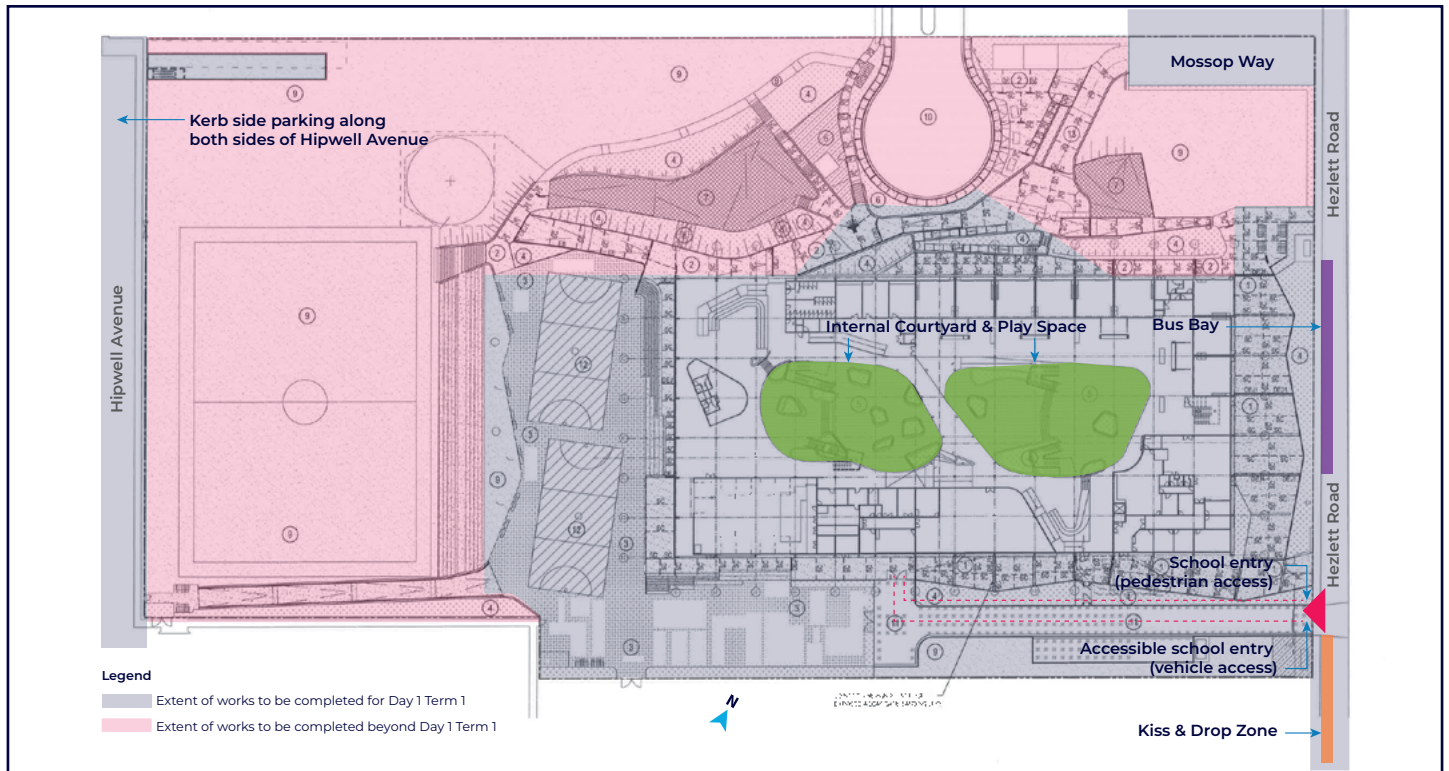

Access to new school buildings for Term 1, 2019

## Day 1 Term 1, 2019

The first day of the 2019 school year will be exciting for the students, teachers and parents at North Kellyville Public School.

### What to expect

Learning spaces and facilities will be ready and open for K-6 students for Day 1 Term 1, 2019.

Teachers will be ready to meet their students to guide them to their classrooms.

### Transport

On Day 1 Term 1 the school entry will be from Hezlett Road near the Kiss & Drop zone and bus bay. Hezlett Road will provide both pedestrian and accessible access.

What this means for students, teachers and parents is that there will be dedicated access paths (shown by dotted lines in the picture above) through the front of the school site to get to the new buildings.

## Staged delivery

\* **Stage 1** – learning spaces and facilities to open for K-6 students for Day 1 Term 1, 2019.

\* **Stage 2** – facilities for up to 1,000 students, including additional play space to be completed by early 2020.

### Safety

Safety is our highest priority for students, staff and visitors.

Some final landscaping works will take place in 2019 and temporary fencing is in place to separate the work area and workers from the school and students. These works will be carefully planned to avoid disruption to the school's operation.

## Contact us

For more information about this project contact School Infrastructure NSW:

**Website:** [schoolinfrastructure.nsw.gov.au](http://schoolinfrastructure.nsw.gov.au)

**Email:** [schoolinfrastructure@det.nsw.edu.au](mailto:schoolinfrastructure@det.nsw.edu.au)

**Phone:** 1300 482 651

For information about school activities and operations, contact the school directly:

**Principal:** Tom Moth

**Website:** [northkellyville-p.schools.nsw.gov.au](http://northkellyville-p.schools.nsw.gov.au)

**Email:** [northkellyville-p.school@det.nsw.edu.au](mailto:northkellyville-p.school@det.nsw.edu.au)

**Phone:** 0415 610 041