

Example of upgraded high school facilities being delivered across NSW

Newcastle Education Campus

Project update | June 2022

Investing in our schools

The NSW Government is investing \$8.6 billion in school infrastructure over the next four years, continuing its program to deliver 160 new and upgraded schools to support communities across NSW. This builds on the more than \$9.1 billion invested in projects delivered since 2017, a program of \$17.7 billion in public education infrastructure.

The NSW Department of Education is committed to delivering new and upgraded schools for communities across NSW. The delivery of these important projects is essential to the future learning needs of our students and supports growth in the local economy.

Project overview

Located on the main Newcastle High School site, the Newcastle Education Campus (NEC) will cater for the growing population in the region by delivering: 37 new permanent learning spaces; 5 new support learning spaces; and a new library, multi-purpose facility (hall), canteen and science laboratories.

Joint use opportunities are being considered for the provision of facilities that can be shared with the community.

Space on the site has also been allocated for a future new primary school, subject to enrolment demand and a second business case.

Progress Summary

A request for the Secretary's Environmental Assessment Requirements (SEARs) was submitted to the NSW Department of Planning and Environment (DPE) in May 2022. DPE assessed the submission and have issued the SEARs, which sets out the studies that need to be included in the Environmental Impact Statement (EIS). The EIS provides a comprehensive description of the project's environmental, social and economic impacts. It includes detailed information on the project scope and design plans, and is the key document for the State Significant Development (SSD) application.

Earlier this month the final business case was approved by NSW Treasury. This is a key milestone and means that the project now has delivery funding for the construction phase, pending approval of the development application.

For more information contact:

School Infrastructure NSW
Email: schoolinfrastructure@det.nsw.edu.au
Phone: 1300 482 651
www.schoolinfrastructure.nsw.gov.au

Next steps

Early site investigations are scheduled to occur during the upcoming Winter school holidays. These tests will include drilling and testing of ground conditions to inform planning and design for the project. A separate works notification will be distributed to the school community and neighbours ahead of these works occurring.

Work will continue to refine the design of the facility in consultation with the school, architects, planners, consultants and the department's technical stakeholder group. This will allow us to properly consider the educational, operational and service delivery requirements of the school while maintaining the heritage of the site and surrounds.

How can I get involved?

We are committed to ensuring that the school and local community are kept informed about the progress of this project. You can expect to receive more regular communication from us as this project progresses.

Your feedback on this project is important to us. For more information, comments, or to make a comment please email us at schoolinfrastructure@det.nsw.edu.au or phone 1300 482 651.

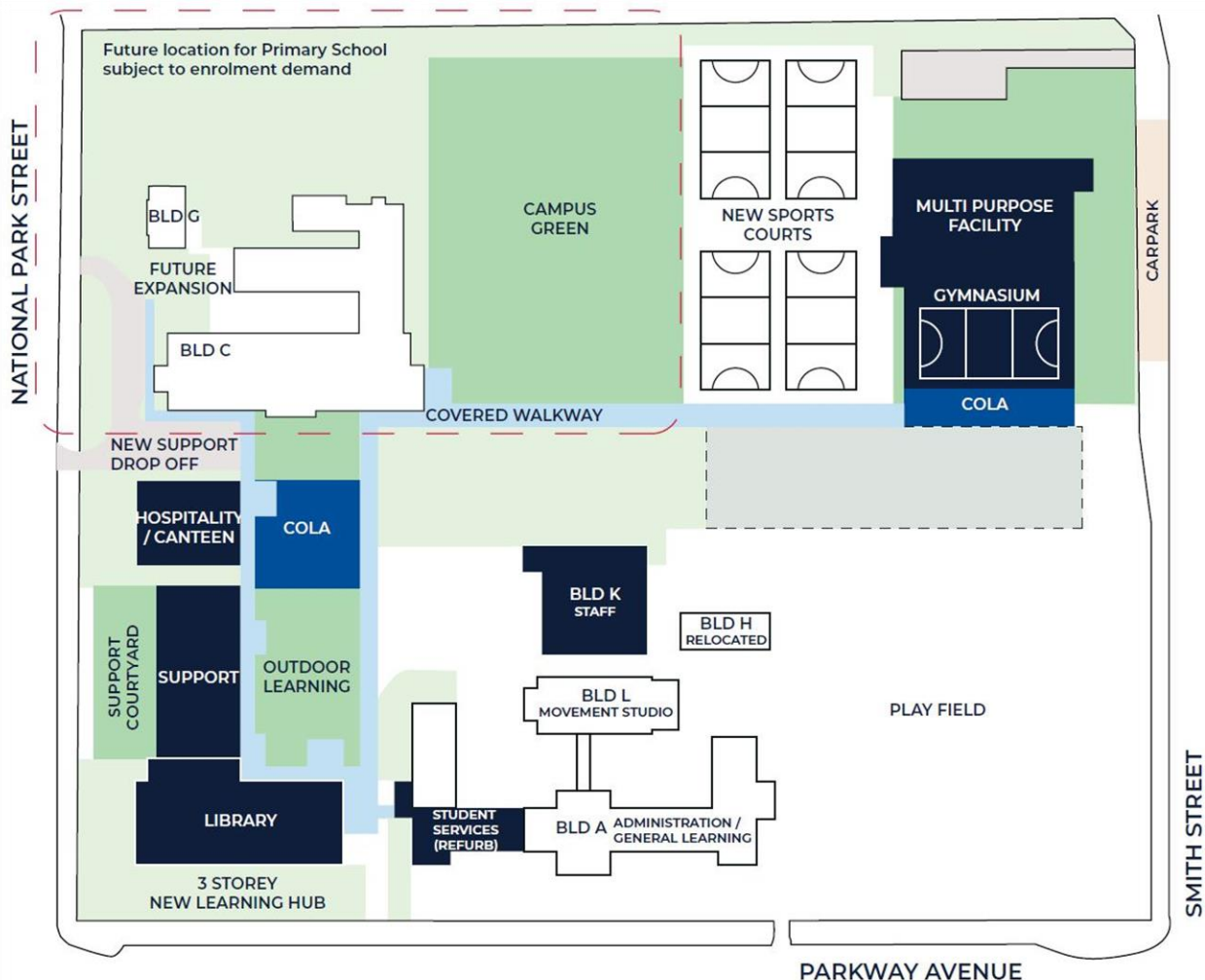

Indicative masterplan only and subject to change.

For more information contact:

School Infrastructure NSW
Email: schoolinfrastructure@det.nsw.edu.au
Phone: 1300 482 651
www.schoolinfrastructure.nsw.gov.au