



Example of upgraded high school facilities being delivered across NSW

# Newcastle Education Campus

## Project update

May 2022

### Investing in our schools

The NSW Government is investing \$7.9 billion over the next four years, continuing its program to deliver 215 new and upgraded schools to support communities across NSW. This is the largest investment in public education infrastructure in the history of NSW.

The NSW Department of Education is committed to delivering new and upgraded schools for communities across NSW. The delivery of these important projects is essential to the future learning needs of our students and supports growth in the local economy.

### Project overview

The NSW Government included funding in the 2018/19 budget for the Newcastle Education Campus. Located on the main Newcastle High School site, the Newcastle Education Campus will cater for the growing population in the region by:

- Upgrading Newcastle High School with new flexible learning spaces, a new library, new science laboratories, kitchens, canteen, support class facilities and gymnasium.
- Expanding facilities for shared public use.

Space on the site has also been allocated for a future new primary school, subject to enrolment demand and a second business case.

### Progress summary

Masterplanning and the concept designs for the site were completed last year. These are the first two of four design phases and provide a high level vision for the site. The final designs for the new high school will be determined in future design phases, in consultation with stakeholders.

The statutory planning process for the Newcastle Education Campus has started. The project is considered a State Significant Development and therefore the NSW Department of Planning and Environment (DPE) will assess the application for planning approval for the project.

### For more information contact:

School Infrastructure NSW  
Email: [schoolinfrastructure@det.nsw.edu.au](mailto:schoolinfrastructure@det.nsw.edu.au)  
Phone: 1300 482 651  
[www.schoolinfrastructure.nsw.gov.au](http://www.schoolinfrastructure.nsw.gov.au)

## Request for SEARs

We have submitted a request to DPE for the Secretary's Environmental Assessment Requirements (SEARs), which is a key step in the planning process. The SEARs are the set of terms by which DPE will assess School Infrastructure NSW's application for planning approval. The SEARs advise the studies that need to be included as part of the SSD application to gain development approval. To satisfy the SEARs, School Infrastructure NSW must prepare a document called an Environmental Impact Statement (EIS). An EIS provides a comprehensive description of the project's environmental, social and economic impacts. It includes detailed information on the project scope and design plans, and is the key document for a State Significant Development application.

## The design of the new site plan

A site plan has been submitted as part of the Request for SEARs. During the planning phase we work with key stakeholders to develop the education principles behind the new facilities, and identify constraints and opportunities of the site which inform the building footprints. The size of the building footprints and the general relationship between types of learning spaces and facilities are determined in accordance with NSW Department of Education guidelines.

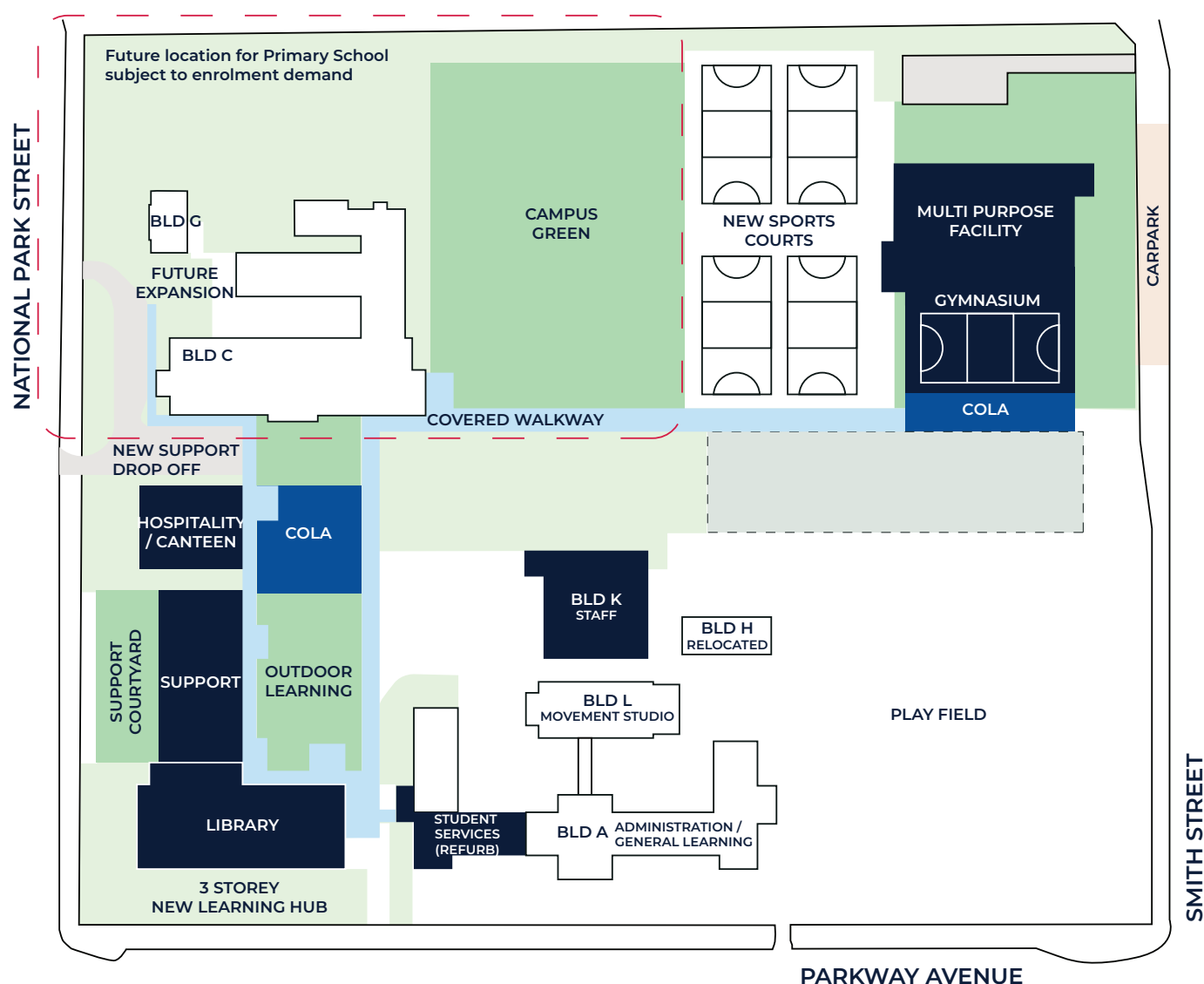

*Indicative masterplan only and subject to change.*

### For more information contact:

School Infrastructure NSW  
Email: [schoolinfrastructure@det.nsw.edu.au](mailto:schoolinfrastructure@det.nsw.edu.au)  
Phone: 1300 482 651  
[www.schoolinfrastructure.nsw.gov.au](http://www.schoolinfrastructure.nsw.gov.au)



Example of upgraded high school facilities being delivered across NSW

### Next steps

We are continuing to refine the design, considering educational, operational and service delivery requirements. The next design phase will be the schematic design followed by the detailed design. This involves consultation with the school, consultants, architects, planners and the department's technical stakeholder group to confirm:

- the final location of all facilities
- look and feel of the new buildings
- internal layouts and learning space configurations.

### Heritage

The city of Newcastle, and in particular the grounds of Newcastle High School, have a strong heritage tradition that reflects the strength and diversity of the community. We are conscious of the impacts that construction can have on the identity of buildings and the conservation areas that surround them, and are committed to respecting the history and maintaining the heritage of the site and surrounds.

## Frequently asked questions

---

### What is the statutory planning approval process?

School Infrastructure NSW requires development approval to build the new high school. The formal process of gaining this approval is called the statutory planning approval process. DPE is responsible for managing the assessment and determination of the statutory planning application for this project because it is a State Significant Development (SSD).

An SSD is a development of particular significance to the people and state of NSW. The approval process for an SSD is different to that of other types of development. It involves requesting the SEARs and then preparing an Environmental Impact Statement (EIS) in response to these requirements.

### How can I get involved in the project?

We are committed to working together with our school communities and other stakeholders to deliver the best possible learning facilities for students. Your feedback on this project is important to us.

For more information, questions, or to make a comment please contact us on the details below or visit the project webpage by searching "[Newcastle Education Campus](#)" on [schoolinfrastructure.nsw.gov.au](http://schoolinfrastructure.nsw.gov.au).

---

### For more information contact:

School Infrastructure NSW  
Email: [schoolinfrastructure@det.nsw.edu.au](mailto:schoolinfrastructure@det.nsw.edu.au)  
Phone: 1300 482 651  
[www.schoolinfrastructure.nsw.gov.au](http://www.schoolinfrastructure.nsw.gov.au)