

# Project overview

Planning is underway for the establishment of a new high school in Jerrabomberra to accommodate approximately 500 students.

The new high school will have modern facilities with 25 flexible learning spaces including 3 support learning spaces, library, multi-purpose hall, sports courts, covered outdoor learning area (COLA), outdoor space, canteen, and administration facilities.

Learning spaces will be built to enable teaching of subjects offered by secondary schools to enable students to receive their Record of School Achievement or Higher School Certificate. The school will also offer vocational education and training (VET) programs.

The design of the new high school anticipates the need for potential future growth with core facilities sized to facilitate expansion if necessary. The new high school in Jerrabomberra will be a 7-12 comprehensive high school.



Artist impression of the new high school in Jerrabomberra, looking along the bus bay with learning spaces on the right. Indicative only and subject to change.

## Features



Library



Multi-purpose hall

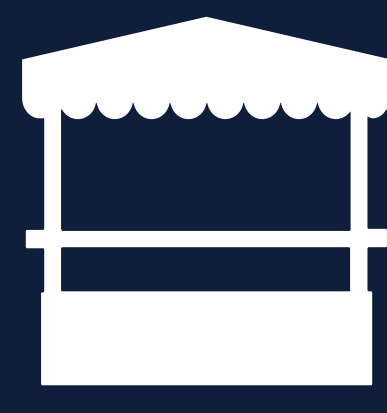

Canteen

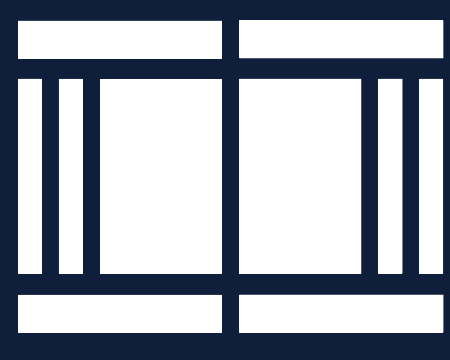

Sports courts



Covered outdoor learning area (COLA)



Outdoor space



Administration facilities

## New high school in Jerrabomberra

For more information phone: 1300 482 651  
Email: [schoolinfrastructure@det.nsw.edu.au](mailto:schoolinfrastructure@det.nsw.edu.au)



# Timeline

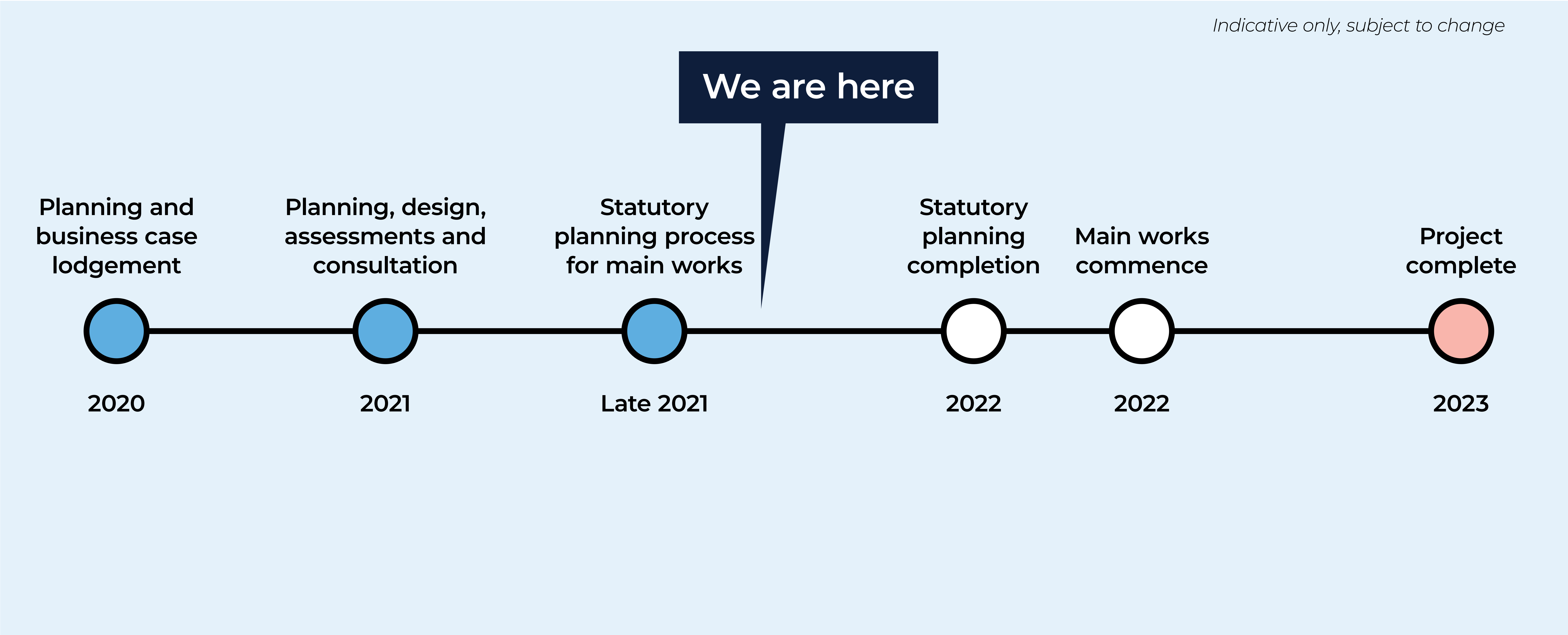

## New high school in Jerrabomberra

For more information phone: 1300 482 651  
Email: [schoolinfrastructure@det.nsw.edu.au](mailto:schoolinfrastructure@det.nsw.edu.au)



# Flexible learning spaces

Learning is changing. Contemporary learning and teaching prepares students for a diverse and interconnected world. We are evolving the way we teach our students to deliver new skills valued by a changing workforce, understand different ways students learn and support new ways of interacting with information through technology.

Learning environments are flexible spaces designed and equipped to support contemporary learning and teaching.

## What makes a flexible learning space?



### Space

- Different zones (areas of a building or floors) are designed to support a range of activities sometimes grouped by subject area
- Varied furniture allows for student choice, comfort and flexibility
- Spaces are flexibly connected allowing students to work in varied group sizes
- Connection between indoor and outdoor learning spaces



### Organisation

- Movement is encouraged for students and teachers to collaborate and interact
- More than one teacher may be available to students within the learning environment
- Students learn in large groups, small groups or individually



### Teaching and learning

- Learning is personalised with students supported to learn and achieve at their own pace
- Learning is connected across different subject areas
- There is a focus on creativity and innovation with students prototyping, testing and using technology in creative ways



### Technology

- Technology is integrated into spaces to extend learning opportunities
- WiFi is available everywhere including outdoors
- Specialist equipment is available for students to innovate, communicate and create

## New high school in Jerrabomberra

For more information phone: 1300 482 651  
Email: [schoolinfrastructure@det.nsw.edu.au](mailto:schoolinfrastructure@det.nsw.edu.au)



# Becoming part of the Jerrabomberra community

The new high school in Jerrabomberra is designed to be a part of the local community. The school responds to the natural environment and topography, with the aim of providing contemporary, sustainable learning environments that are integrated into, and maximise the use of the natural environment.

Materials for the new high school have been selected for their natural tones and textures, as well as for durability and maintenance characteristics. Metal roofing has been selected for its durability and the roof pitch has been minimised to keep the building appearing low-lying in the landscape.

The buildings are set back from the adjoining wetlands and residential area, and also stepped down the slope towards the west and south.

The school will include a productive garden with raised planter beds and seating opportunities, semi enclosed outdoor learning areas, garden beds, shade trees, open play spaces, planted embankments and tiered seating.

All terraced outdoor spaces are connected by flights of stairs and ramps ensuring an inclusive and accessible learning environment for all students and staff. The embankments between the levels are to be planted with native grasses, shrubs and trees. A total of 160 trees are proposed, including a mix of native and exotic trees.

The Educational Walk will showcase endemic plant species and the surrounding landscape and provide teaching spaces to learn on Country.

Perimeter planting of native grass along the boundaries strengthens the school's interface with the surrounding landscape and provides additional biodiversity and habitat for local fauna.

The Environmental Impact Statement, along with architectural drawings, the landscape report, and other key information about the high school project can be viewed at: [www.planningportal.nsw.gov.au/major-projects/project/42416](http://www.planningportal.nsw.gov.au/major-projects/project/42416)



The landscaping of the new high school is integrated with the building design, ensuring students have easy and frequent access to outdoor spaces.



While the learning spaces have been designed to accommodate approximately 500 students, the design of the new high school anticipates the need for possible future expansion with core facilities sized to facilitate expansion if necessary.

The above images are indicative only and subject to change.

## New high school in Jerrabomberra

For more information phone: 1300 482 651  
Email: [schoolinfrastructure@det.nsw.edu.au](mailto:schoolinfrastructure@det.nsw.edu.au)



# A school for now and into the future

The new high school in Jerrabomberra will have modern facilities to accommodate approximately 500 students.

The school will be a 7-12 comprehensive high school. The design of the new high school anticipates the need for possible future expansion with core facilities sized to facilitate expansion if necessary.

The school in Jerrabomberra is designed to enable modern teaching methods. Learning and breakout spaces are designed with large, glazed sliding doors to provide connections and opportunity for flexible learning environments that can accommodate individual classrooms or opportunities for collaboration between classes.

The Department of Education is committed to working together with local school communities to deliver the best possible outcomes for all students. See examples of new and upgraded learning environments in other local projects.



**Tirriwirri School**

Open in 2021, the Tirriwirri School provides specialist and intensive support in a dedicated setting for students with moderate to high learning and support needs. The project has delivered seven learning spaces for Kindergarten through to Year 12, break out spaces for students and staff, interactive and inclusive learning areas, special programs rooms for activity-based learning, a library and gym area, school café, and administration and staff area.



**Queanbeyan High School**

Completed in June 2020, the upgrade to Queanbeyan High School delivered eight refurbished general learning spaces, two learning spaces devoted to STEM (science, technology, engineering and mathematics), including a human movement studio and STEM studio, expansion and new fit-out of food technology and hospitality facilities, new covered outdoor learning area (COLA) and resurfacing of the sports courts, refurbishment and expansion of administration and staff facilities, new walkways and ramps, upgrade of school entry area, a new bus shelter and gates, and landscape improvement works.

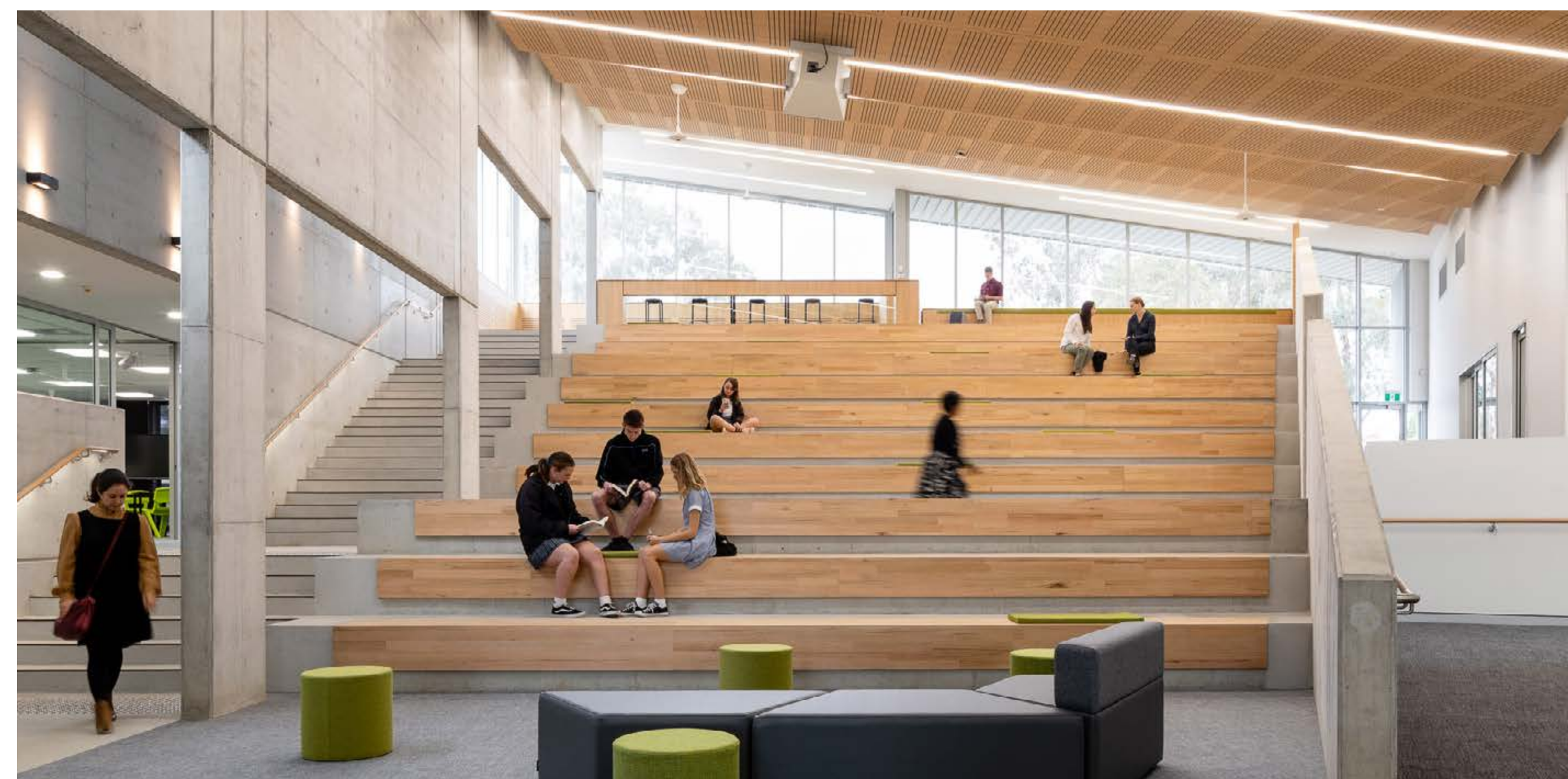

**Karabar High School**

Completed in mid-2020, the new facilities at Karabar High School include 10 new permanent learning spaces, a new seminar space, new staff study facilities, new covered walkways and ramps, landscaping and accessibility improvement works.



**Braidwood Central School**

The Braidwood Central School upgrade was completed in 2021 and includes eight new flexible learning spaces, two new specialist learning spaces for drama and music, expanded and improved administration and staff areas, refurbishment of two existing buildings, upgraded and landscaped outdoor and play areas, new covered walkways and ramps, and a new accessible car park.

## New high school in Jerrabomberra

For more information phone: 1300 482 651  
Email: [schoolinfrastructure@det.nsw.edu.au](mailto:schoolinfrastructure@det.nsw.edu.au)