



Nangamay Public School Hall

Nangamay Public School

Day 1 Term 1 Welcome Pack | January 2023

Welcome to your new school

The new Nangamay Public School is now open and ready to use. The new facilities include:



New modern teaching spaces and facilities for up to **400** students



20 air-conditioned flexible learning spaces



Library



Multipurpose hall



Sports court



Canteen



Special program unit



Covered outdoor learning area (COLA)

Thank you for your patience during construction. We are delighted to deliver this project for the Glenmore Park and Mulgoa Rise communities and hope you enjoy your new spaces.

Message from your Principal

As Foundation Principal, I am both honoured and excited to welcome you to Nangamay Public School, located on beautiful Darug Country.

I feel a strong connection to the Glenmore Park community as I have lived in Glenmore Park for over 26 years, raised my family here, and continue to live in the area. I bring this authentic connection, and over 30 years educational experience, to the role.

I am incredibly proud to lead our talented and dedicated staff as we work together to implement our innovative education model. A student's potential grows in the face of challenge and our teaching and learning will encourage our students to embrace challenge in a learning culture that feels safe for students.

The goal of Nangamay's innovative educational model is to support students to become independent and resilient learners who possess the learning dispositions required for success in an everchanging world. This will be strengthened and enhanced by our new learning spaces, supporting students to develop their knowledge and skills in a collaborative learning environment.

Our school environment has an open-plan design featuring a series of flexible, modern learning spaces. Our students can move around, and furniture can be arranged in multiple ways to enable students to work together in smaller and larger groups as needed. These environments will help foster creative, critical and innovative thinking.

I am very proud to welcome you as partners in learning as we begin our journey together at our beautiful Nangamay Public School.

Sharon Gordon
Foundation Principal



Library seating space

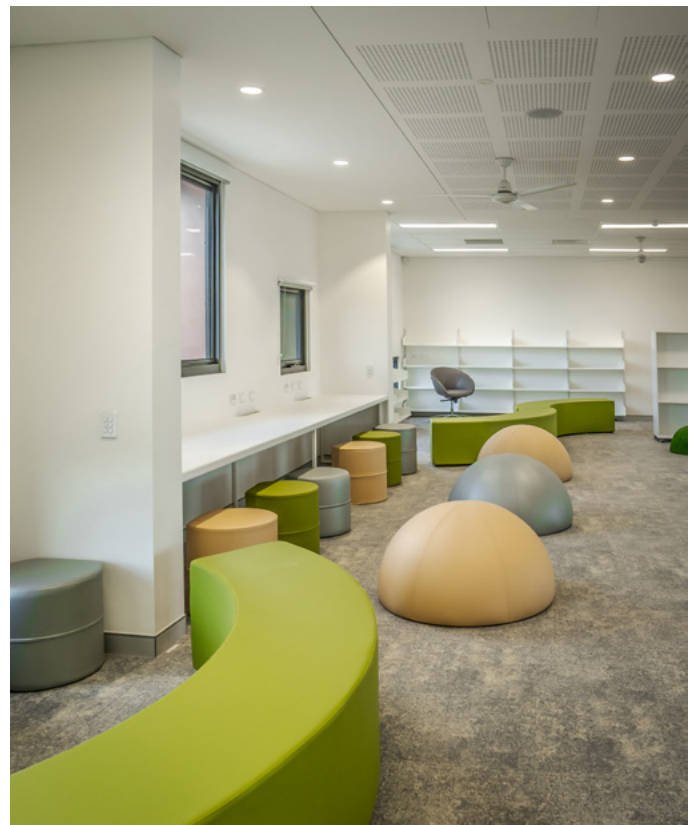

Flexible learning space in library

Flexible learning spaces

The new facilities incorporate flexible learning spaces with moveable furniture and adaptable room configurations.

The learning spaces are technology-enabled to serve multiple learning contexts from home class groups to smaller groups and independent study, providing better opportunities for collaboration and personalised learning.



Flexible learning spaces

Site plan

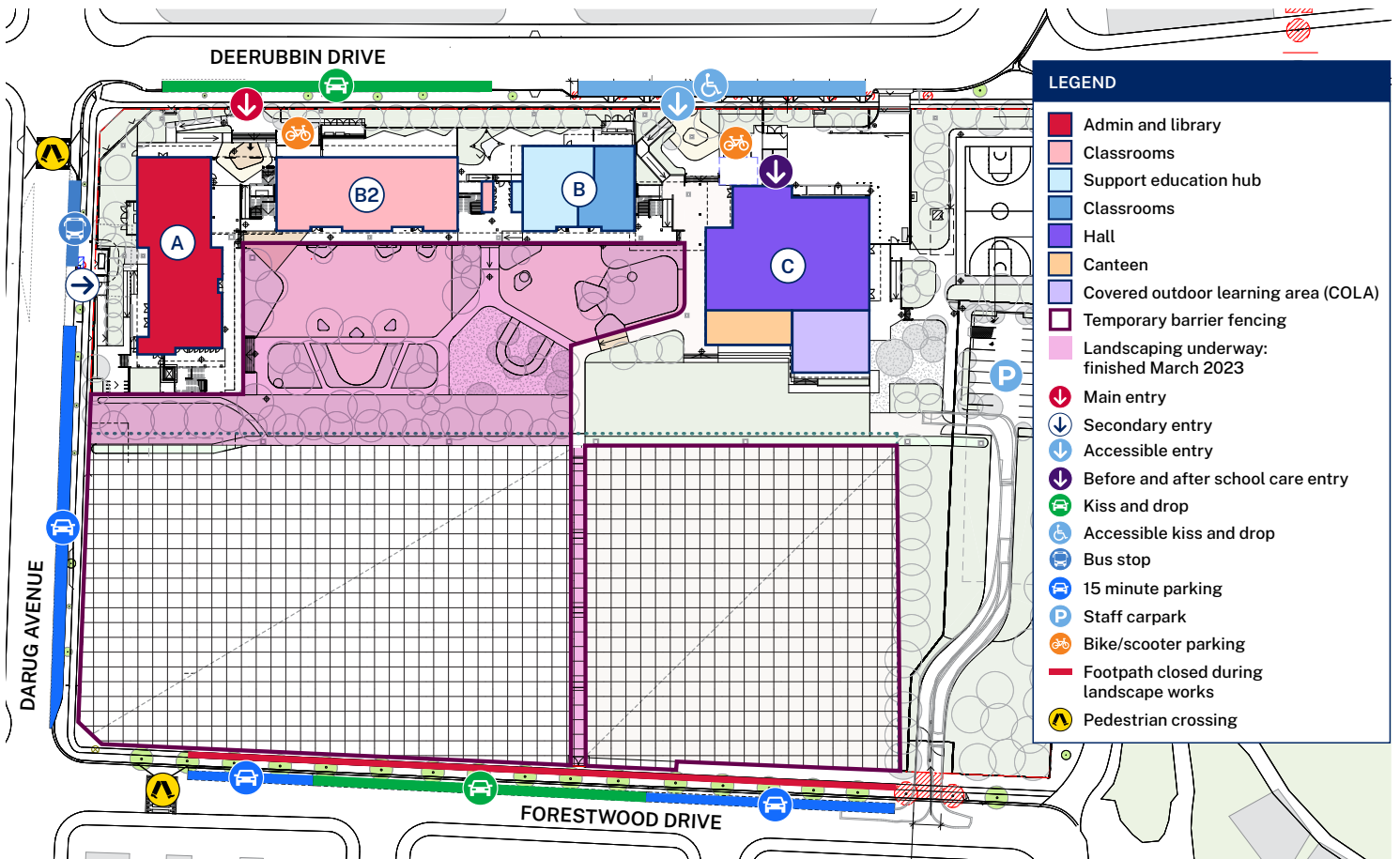

LEGEND	
[Red square]	Admin and library
[Pink square]	Classrooms
[Light blue square]	Support education hub
[Blue square]	Classrooms
[Purple square]	Hall
[Orange square]	Canteen
[Light purple square]	Covered outdoor learning area (COLA)
[Pink square with border]	Temporary barrier fencing
[Pink square with border]	Landscaping underway: finished March 2023
[Red circle with arrow]	Main entry
[Blue circle with arrow]	Secondary entry
[Blue circle with arrow]	Accessible entry
[Purple circle with arrow]	Before and after school care entry
[Green circle with car]	Kiss and drop
[Blue circle with wheelchair]	Accessible kiss and drop
[Blue circle with bus]	Bus stop
[Blue circle with car]	15 minute parking
[Blue circle with P]	Staff carpark
[Orange circle with bike]	Bike/scooter parking
[Red line]	Footpath closed during landscape works
[Yellow triangle]	Pedestrian crossing

Frequently asked questions

What works are still to be completed in Term 1 2023?

Landscaping will continue on the southern part of the school grounds in early Term 1 and is expected to be finished in March. We will separate the areas being landscaped from the rest of the school with temporary fencing and shade cloth. The contractors will also schedule the work around hours of school operations to reduce any disruption.

Does Nangamay Public School have before and after school care (OHSC)?

Yes, Penrith City Council Children's Services runs the OHSC which is in the school hall. The centre opens at 6:30 am and closes at 6 pm and is closed in school hours. To find out more please call Lauren Golding on 47327959 or email Lauren.Golding@penrith.city.

Is there a kiss and drop zone?

Yes, there is a kiss and drop zone on Deerubin Drive, near Darug Avenue, outside the main entry gate, and a second one on Forestwood Drive (see the school site map above).

Please be advised the accessible parking bays and drop off further along Deerubin Drive are only for students with disabilities and their parents and carers.

Where can I park?

There is 15-minute parking along Darug Avenue and Forestwood Drive on school days. Other areas around the school are unrestricted parking.

What time can my child arrive at school?

There is supervision on school grounds from 8:15 am.

Stay informed



Website

Stay up to date by visiting the School Infrastructure NSW website schoolinfrastructure.nsw.gov.au



Email

Contact the Community Engagement team by emailing schoolinfrastructure@det.nsw.edu.au



Phone

Contact us between 9 am and 5 pm, Monday to Friday on **1300 482 651**