

Project overview

Planning is underway to upgrade Mosman High School to cater for projected enrolment growth and to provide students with new and improved educational facilities.

The State Significant Development (SSD) application will be lodged with the Department of Planning, Industry and Environment (DPIE) in late September.

The project will deliver new flexible learning spaces in a new building as well as new core facilities and site improvements, including access and play space.

Indicative project timeline

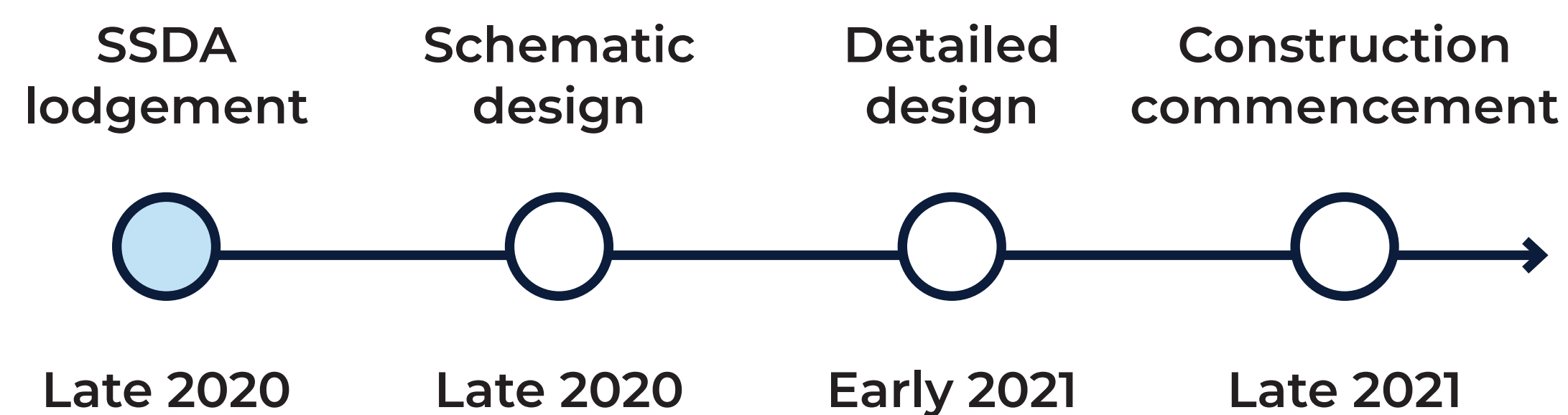

Artist impression of the Mosman High School upgrade



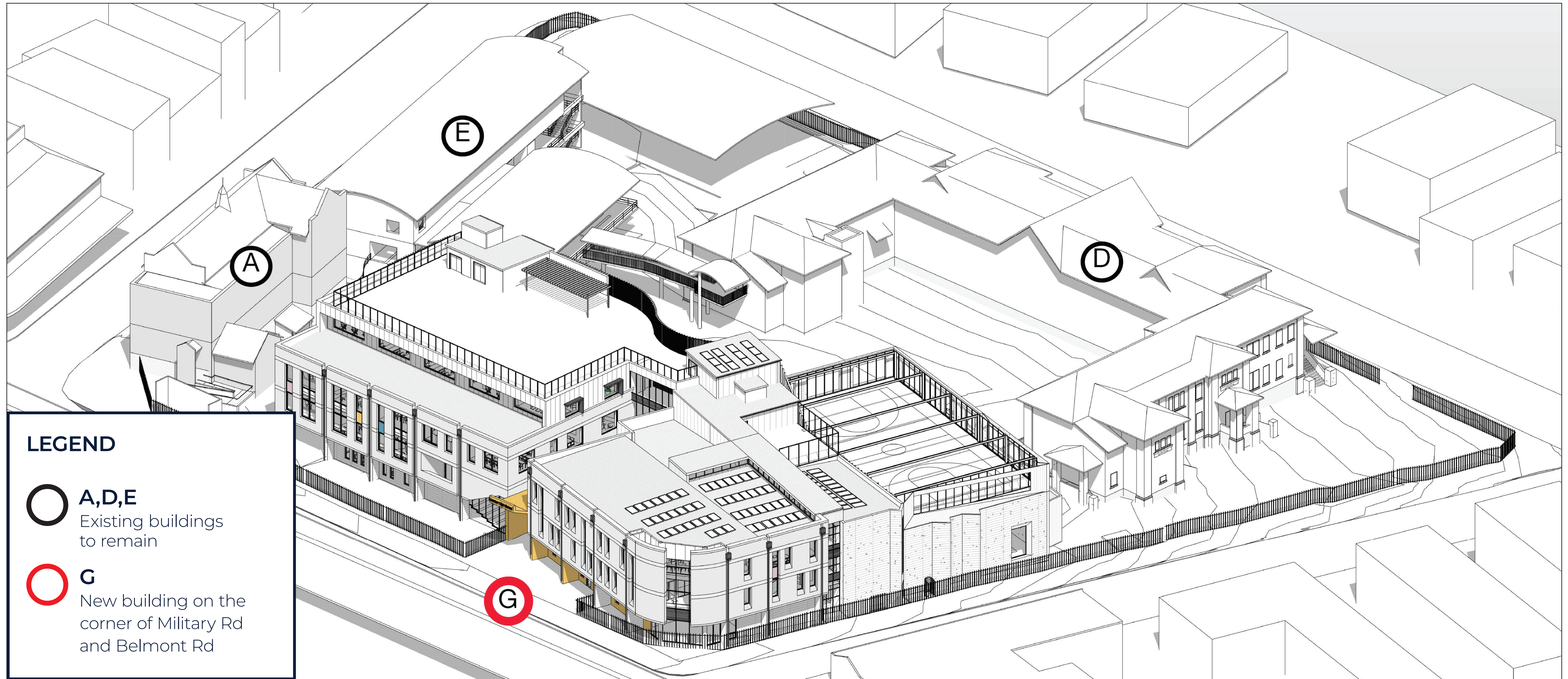



Artist impression

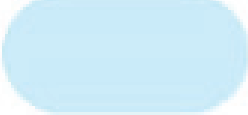

Mosman High School upgrade

For more information phone: 1300 482 651
Email: schoolinfrastructure@det.nsw.edu.au

Map of the proposed school upgrade

-  STAFF ENTRY
-  STUDENT ENTRY
-  CARPARK
-  OUTDOOR PLAY SPACE
-  NEW BUILDING
-  EXISTING BUILDING
-  CIRCULATION THROUGH SITE

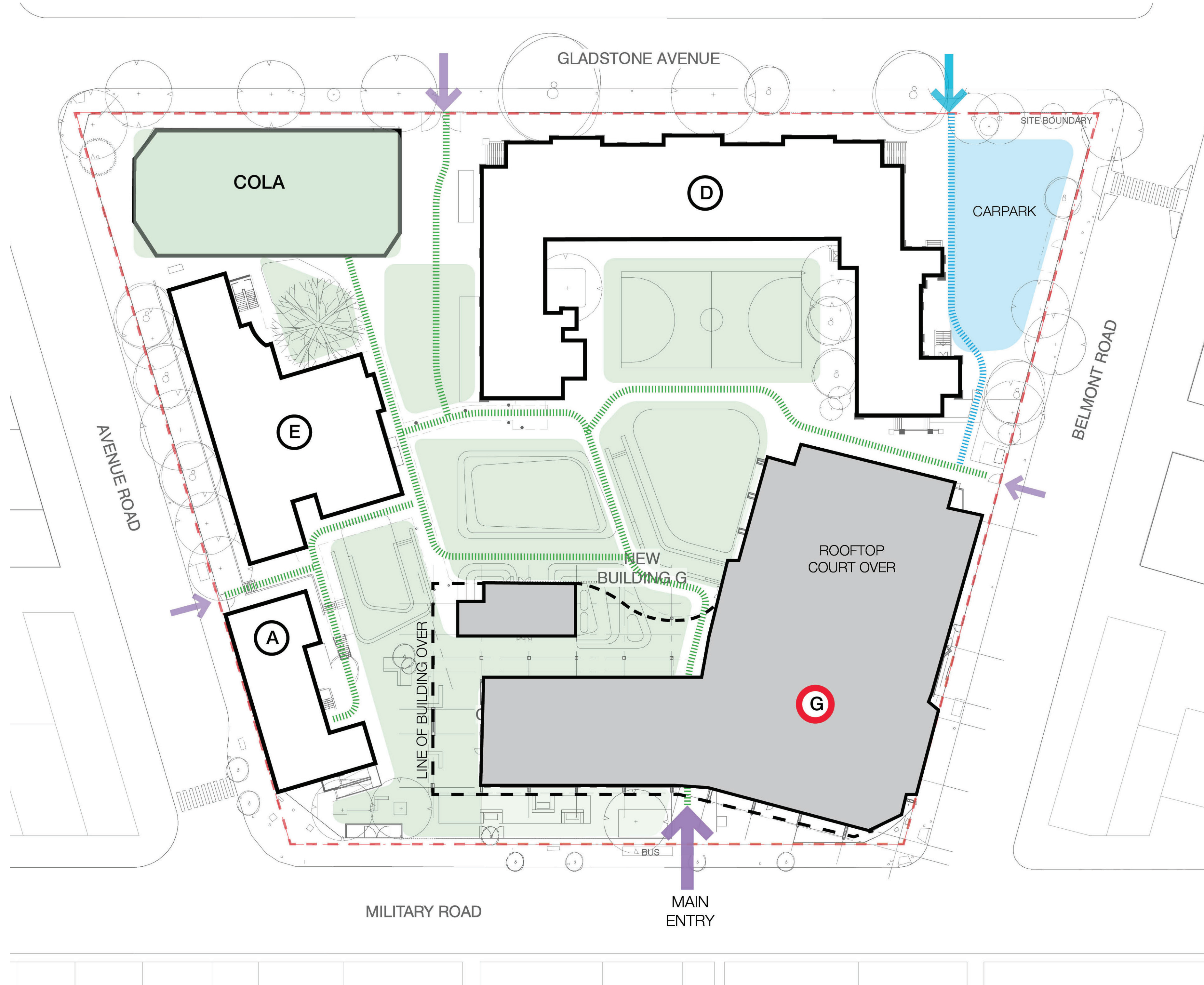

Mosman High School upgrade

For more information phone: 1300 482 651
Email: schoolinfrastructure@det.nsw.edu.au

Proposed scope of demolition works

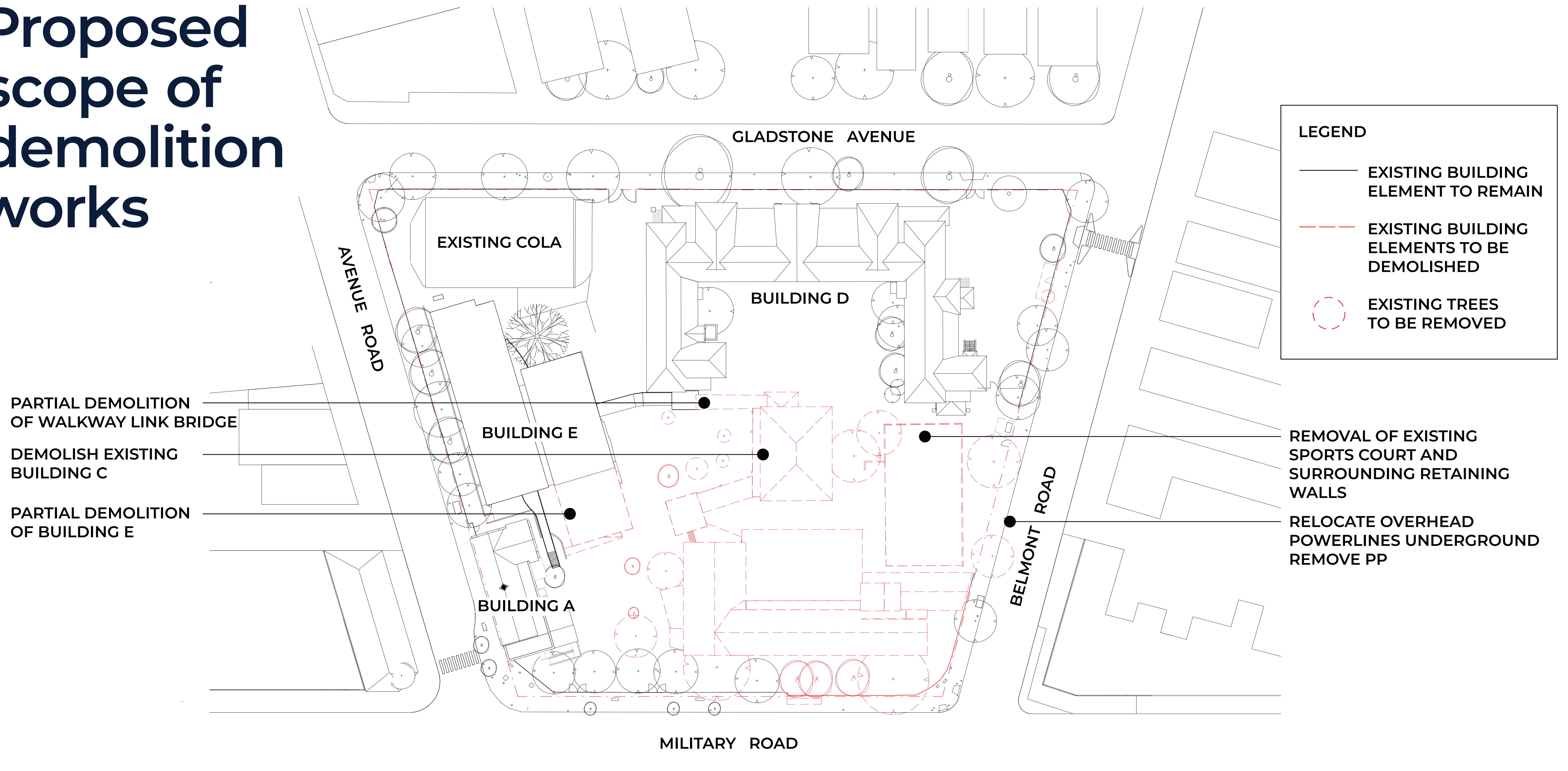

Mosman High School upgrade

For more information phone: 1300 482 651
Email: schoolinfrastructure@det.nsw.edu.au

Proposed landscape plans

- 01 Integrated landscape tired seating
- 02 School green
- 03 Amphitheatre
- 04 Building E forecourt
- 05 Arts plaza
- 06 Landscape area

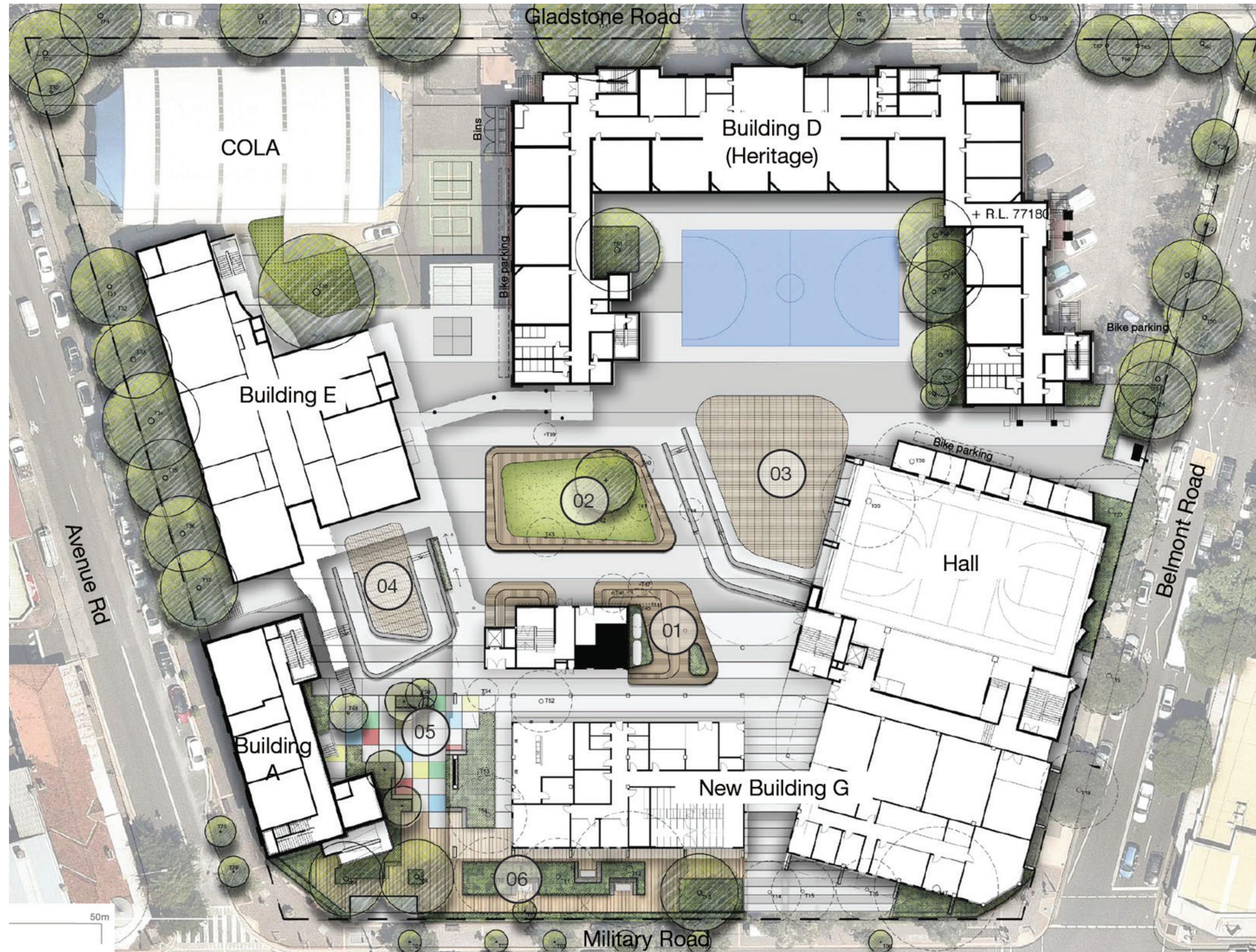

Mosman High School upgrade

For more information phone: 1300 482 651
Email: schoolinfrastructure@det.nsw.edu.au