

# Moruya High School

## Project update | August 2024

Image caption: Artist impression of Support Unit



### Investing in our schools

As part of the NSW Government's plan to rebuild public education, the 2024-25 Budget is delivering record education funding, including \$1.4 billion for new and upgraded schools in regional NSW. This targeted investment will ensure growing communities get access to a world class public education.

### Project overview

We are upgrading the Support Unit at Moruya High School to better support students with additional needs. The project will replace the existing temporary classrooms with a Support Unit that will cater to the needs of students now and into the future.

The upgrade will deliver 7 new permanent support classroom spaces including practical activities areas, break out spaces, accessible toilet and change rooms, laundry, kitchen, and staffroom as well as an outdoor play area and a covered outdoor learning area (COLA).

All classrooms within the Support Unit will be fitted with air conditioning. Work will also include a new access road and undercover drop off area and carpark.

### Progress update

We have dealt with complexities in the early planning for this upgrade, and we are now finalising the concept design for the upgrade. The concept design stage looks at detailed room and space layouts and high-level building services like power supply, water supply and drainage. It also looks at how the building interacts with the site and other buildings. The proposed location is shown on the map on the next page followed by the indicative design of a classroom and multipurpose space from the Support Unit.

### Next steps

The next steps are to seek planning approval and tender for a construction contractor. We anticipate the contractor to be appointed in early December.

When the contractor has been appointed, we can share start and anticipated completion dates for the project.



Email: [schoolinfrastructure@det.nsw.edu.au](mailto:schoolinfrastructure@det.nsw.edu.au)  
Phone: 1300 482 651  
[schoolinfrastructure.nsw.gov.au](http://schoolinfrastructure.nsw.gov.au)

## Support unit location



### Indicative design of classroom

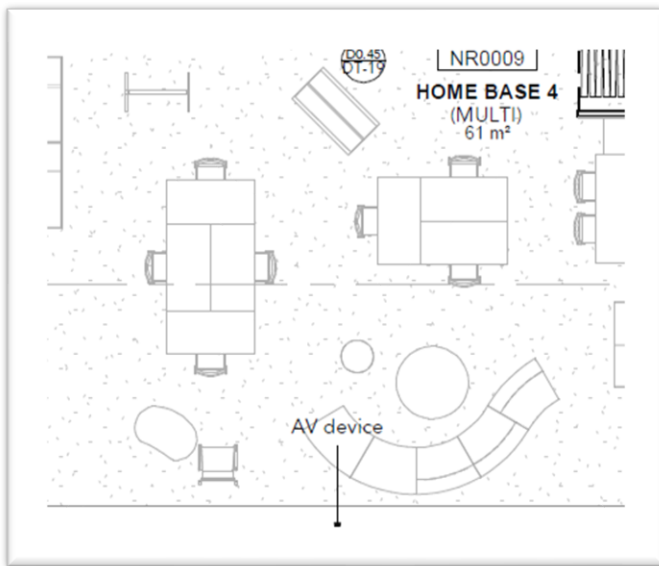

### Indicative design of multipurpose space

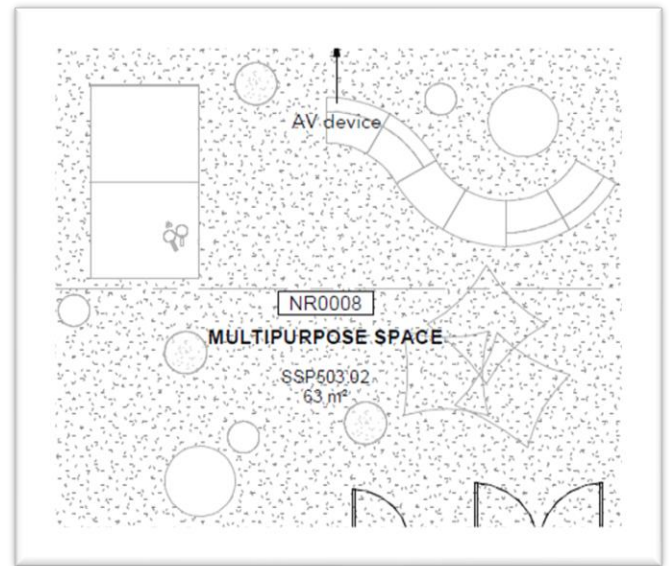

### More information



You can find more information about the project at [edu.nsw.link/MoruyaHS-SupportUnit](https://edu.nsw.link/MoruyaHS-SupportUnit) or by scanning the QR code.

If you have any questions about this project, you can contact School Infrastructure NSW during business hours on the contact details below.