

Frequently asked questions

What stage is the project at?

The design has progressed through concept and schematic design. The construction tender is expected to be awarded in late September. Once the construction contract has been awarded, the detailed design process will commence. It is anticipated that construction works will commence in late 2019, subject to planning approval.

What stage is the project at?

Concept and schematic design is complete. The construction tender is expected to be awarded in September. Once the construction contract has been awarded, detailed design will commence. It is anticipated that construction works will commence in late 2019, subject to planning approval.

How will they minimise the construction impacts on the school and its students?

Steps will be taken to minimise disruption to learning time during construction. The safety and wellbeing of students is the Department’s upmost priority. All construction on site will be conducted in accordance with state noise, safety and building regulations.

How will traffic be managed?

A traffic control plan will be developed to manage traffic and ensure site safety. Construction vehicle movements and deliveries will be scheduled outside of peak school operation times. The school community and residents will be kept updated by School Infrastructure NSW about heavy vehicle routes, site entry and traffic disruptions on public roads over the course of the project.

What steps will be taken to control dust and noise impacts?

Fencing and shade cloth will be erected to reduce dust and noise impacts on the school and our neighbours. Dust from demolition and construction works will be hosed down with water as required. Trucks entering and leaving the site will cover their loads.

A particular focus has been placed on ensuring there is minimal noise during school hours and examination periods. When potentially disruptive work needs to be carried out, advance notice will be provided to the school community and neighbours.

Stay informed

School Infrastructure NSW are committed to working with the school and the wider community to deliver the best possible facility.

Throughout the project there will be opportunities to view plans, ask questions and give feedback.

School Infrastructure NSW’s website will include details of upcoming opportunities to find out more.



Information booth

Information booths will be staged throughout the project’s development



Website

Stay up to date by visiting the School Infrastructure NSW website schoolinfrastructure.nsw.gov.au



Email

Contact the Community Engagement team by emailing schoolinfrastructure@det.nsw.edu.au



Phone

Contact us between 9am–5pm, Monday to Friday on **1300 482 651**

Monaro High School

Project update

August 2019



Artist’s impression of the new Monaro High School Performing Arts Centre

THE
LARGEST
INVESTMENT IN
PUBLIC SCHOOL
EDUCATION
INFRASTRUCTURE
IN THE HISTORY
OF NSW

A NEW TWO-STOREY
PERFORMING ARTS
CENTRE WITH
CAPACITY FOR
350 PEOPLE,
INCLUDING HEALTH
AND PHYSICAL
EDUCATION FACILITIES

THE PROPOSED
MONARO HIGH SCHOOL
UPGRADE PROJECT
AIMS TO IMPROVE
THE FUNCTIONALITY
OF THE SCHOOL,
CREATING MORE
FLEXIBLE, INNOVATIVE
LEARNING SPACES TO
ACCOMMODATE NEW
WAYS OF TEACHING

Project overview

The NSW Government is investing \$6.7 billion over the next four years to deliver 190 new and upgraded schools to support communities across NSW. In addition, a record \$1.3 billion is being spent on school maintenance over five years. This is the largest investment in public education infrastructure in the history of NSW.

Monaro High School upgrade

A project is underway to upgrade Monaro High School. The project will deliver:

- 31 new flexible learning spaces, including 11 specialised learning spaces for art, performance, and technology in a dedicated STEAM (Innovation) hub
- a new two-storey performing arts centre with capacity for 350 people, including health and physical education facilities
- a new semi-commercial kitchen
- upgrade of wood and metal workshops
- refurbished staff facilities
- landscaping

Progress summary

The design has progressed through concept and schematic design. The construction tender is expected to be awarded in late September. Once the construction contract has been awarded, the detailed design process will commence. It is anticipated that construction works will commence in late 2019, subject to planning approval.

Site establishment – commencing late 2019

Site establishment and minor early works to prepare the sites for construction will commence from late 2019. This site will include the erection of site fencing and signage, the setup of site facilities, installation of site access points and the commencement of preparation works for building conversions and refurbishments.

Keeping you updated

We will continue to keep you updated about project information as the project progresses. This information will be provided through project updates, information booths, works notifications and our website. You can also speak with us about this project by calling 1300 482 651 or emailing schoolinfrastructure@det.nsw.edu.au.

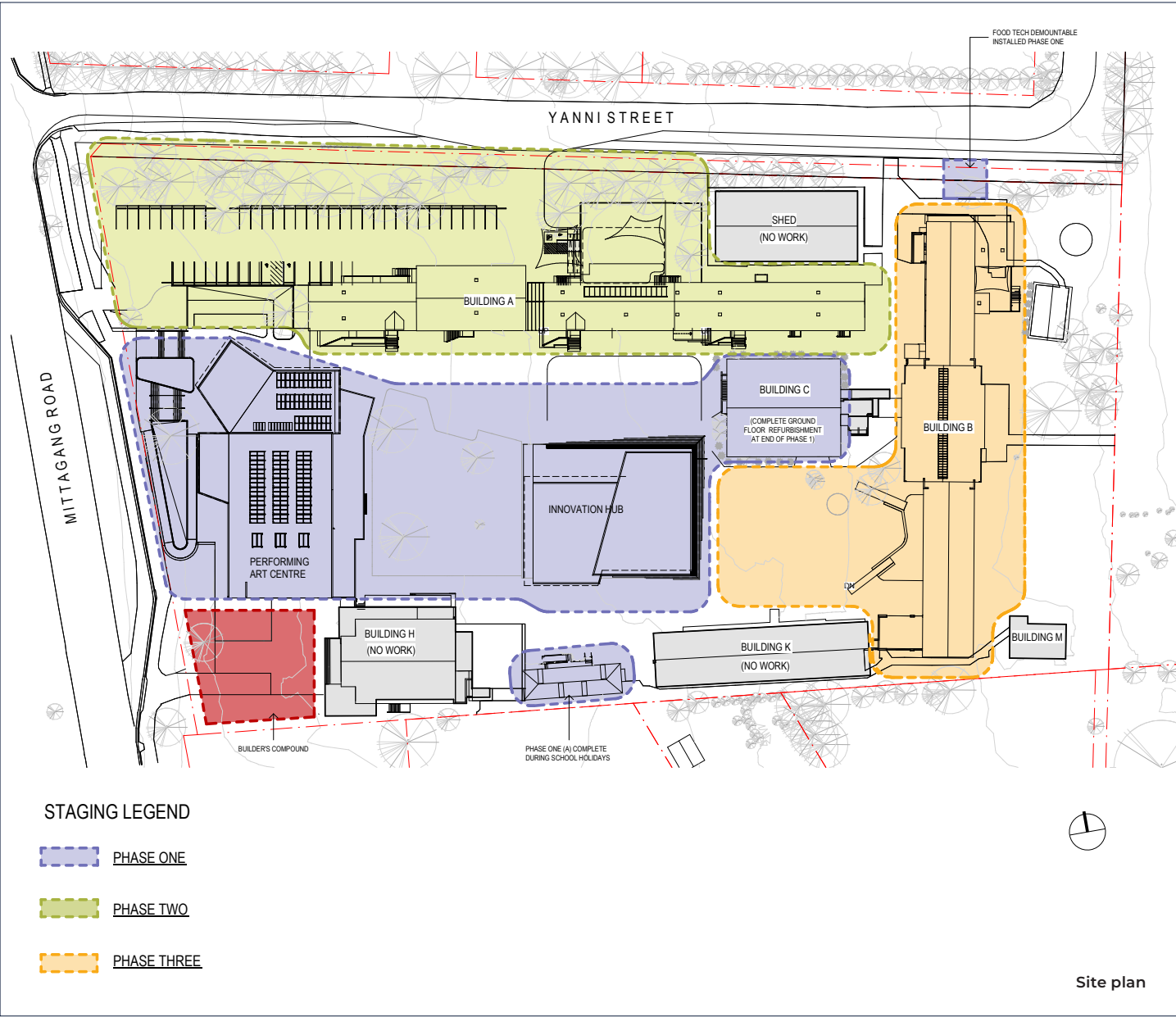

Timeline

