



Artist impression of the new primary school at Midtown Macquarie Park (indicative only and subject to change)

Midtown Macquarie Park new primary school

Information pack | May 2023

A project is underway to deliver a new primary school as part of the Midtown Macquarie Park development to meet anticipated enrolment growth in the area.

The new primary school will accommodate 750 students from kindergarten to year 6 and will provide:

-  Flexible learning spaces
-  A canteen
-  A multipurpose hall
-  A library
-  Administration and staff facilities
-  Covered outdoor learning areas (COLAs)

Project overview

The new primary school will be located at Midtown Macquarie Park, in the City of Ryde. Midtown is a new neighbourhood being built on the site of the former Ivanhoe Estate that will include social, affordable and private housing, community facilities, retail, and green space.

The school will accommodate 750 students and provide flexible learning spaces, administration and staff facilities, a canteen, a library, covered and landscaped outdoor learning areas.

This project forms part of a broader strategy of investment in the Ryde area to cater for predicted enrolment growth. The investment also includes the Macquarie Park Education Campus and an upgrade to Ryde Secondary College.

Location

The concept design below shows the location of the new primary school in Midtown, Macquarie Park. The site for the new school is well connected to public transport. It is also close to public parkland and sports fields with Wilga Park, Shrimptons Creek and ELS Hall Park a short walk away.

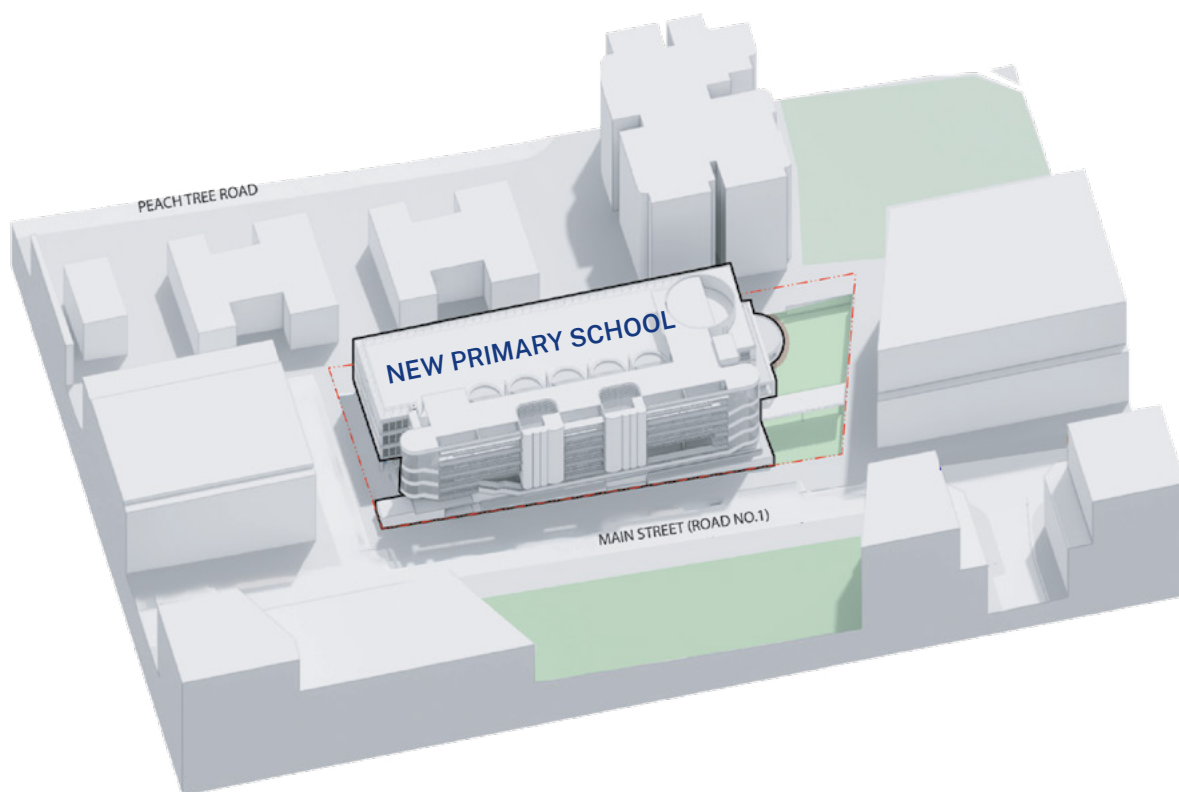
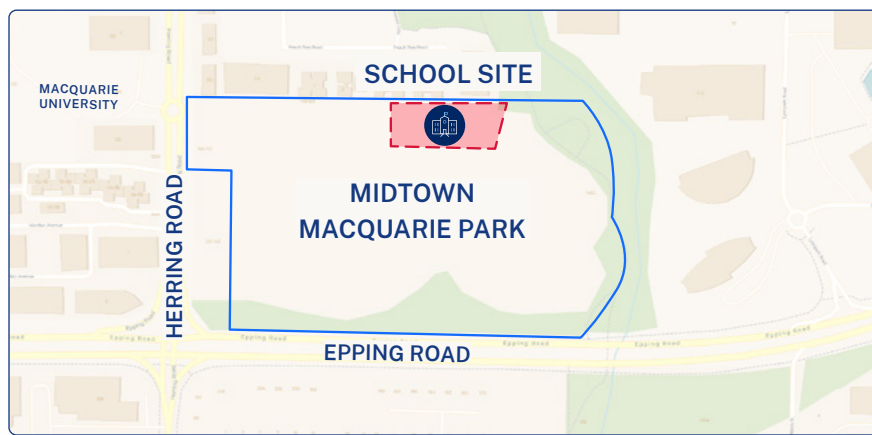

Concept design showing the new primary school in Midtown (indicative only and subject to change)

Designing an urban school

Architectus has been appointed as the architect for the new primary school. The school is being designed in line with the Department of Education’s Educational Facilities Standards and Guidelines and guidelines for designing urban schools.

The current school design is for a six-storey building with learning spaces grouped together based on curriculum or school stage. It features standardised learning hubs, flexible spaces that allow for multiple uses, outdoor learning areas that promote active play, and facilities that offer opportunities for shared use with the community.

We are targeting Green Star certification for the school design which will provide independent verification that the project is sustainable. The design for the school aims to maximise natural cross ventilation and reduce carbon emissions, and it uses smart materials to improve thermal comfort. The school will also provide sustainable transport infrastructure, including cycle parking.

The school design may change as part of ongoing design development and is subject to planning approval.

For more information about how we build schools visit edu.nsw.link/SchoolShowcase



Example of a covered outdoor learning area (COLA)



Example of a multipurpose hall



Example of a primary school flexible learning space

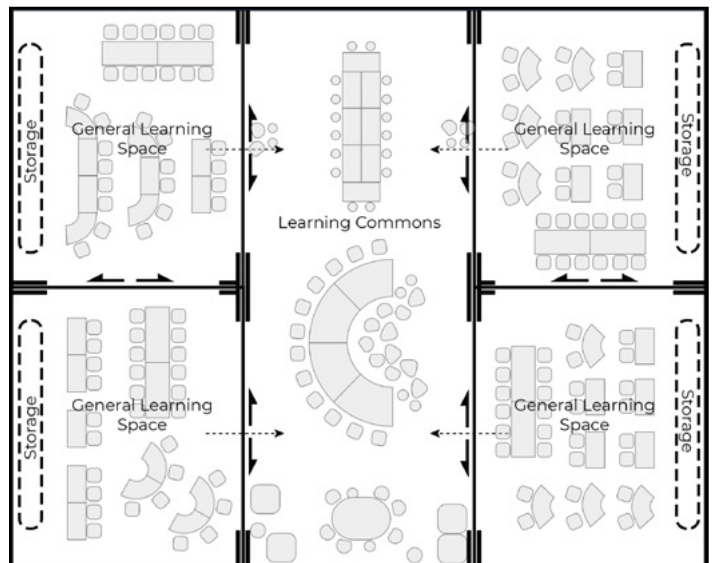

A standardised learning hub design with 4 learning spaces and a learning commons

Next steps

The project to build the new school is a State Significant Development (SSD) and so the NSW Department of Planning and Environment (DPE) will assess our development application.

DPE has provided the Secretary's Environmental Assessment Requirements (SEARs) for the project. This tells us the technical studies we need to include in the Environmental Impact Statement (EIS) that forms part of the SSD application.

Technical studies consider aspects such as traffic, noise, operations, biodiversity, sustainability and plans for construction management.

We are now working on the EIS for the SSD application. The EIS will be available to view when the SSD application is placed on public exhibition later this year. We will inform the community when we have lodged the application, and will let you know how you can have your say.

Timeline

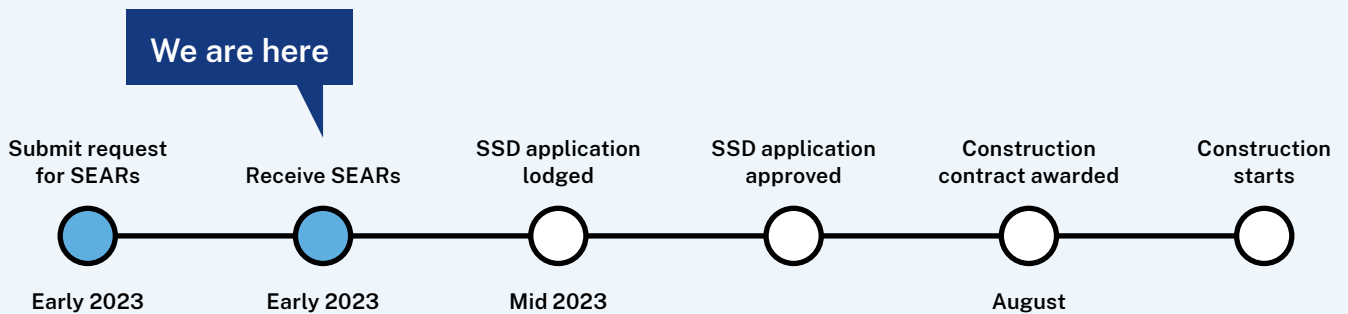

The indicative timeline above shows the steps that need to be taken before we can start to build the new school.

Get involved

We are committed to working together with our school communities and stakeholders to deliver the best learning facilities for students. A dedicated project page has been published on the School Infrastructure NSW website which will be updated as the project progresses. edu.nsw.link/MacquarieParkNPS.



For more information about this project, contact School Infrastructure NSW:

- Website:** schoolinfrastructure.nsw.gov.au
- Email:** schoolinfrastructure@det.nsw.edu.au
- Phone:** 1300 482 651



For a Translation and Interpreting Service call **131 450** and ask them to call the Department of Education - School Infrastructure NSW on **1300 482 651**.