

Manly Village Public School upgrade

Information pack | August 2022



Proposed external works to Buildings C and D

The NSW Government is investing \$8.6 billion in school infrastructure over the next four years, continuing its program to deliver 160 new and upgraded schools to support communities across NSW. This builds on the more than \$9.1 billion invested in projects delivered since 2017, a program of \$17.7 billion in public education infrastructure.

The NSW Department of Education is committed to delivering new and upgraded schools for communities across NSW. The delivery of these important projects is essential to the future learning needs of our students and supports growth in the local economy.

Project overview

School Infrastructure NSW (SINSW) is upgrading Manly Village Public School to meet the needs of the local community. The benefits of the project will include:



New fit for purpose learning spaces including a new special programs space and additional breakout rooms and storage spaces



New out of school hours care (OOSH) facilities in the school hall



Relocation and upgrade of administration facilities

Progress summary

The concept design for the Manly Village Public School upgrade has been approved. A head design consultant has completed the design and technical documentation required for the upgrade and a heritage architectural consultant will ensure the project's scope sits within the existing building fabric.

In addition, SINSW awarded an early works contract to RJ Electrical, which covers an electrical upgrade at the school. These works include the relocation of the main switchboard from the existing administration area to the new administration area in Building D. The electrical upgrade began in July 2022, and is due for completion in late 2022.

Timeline

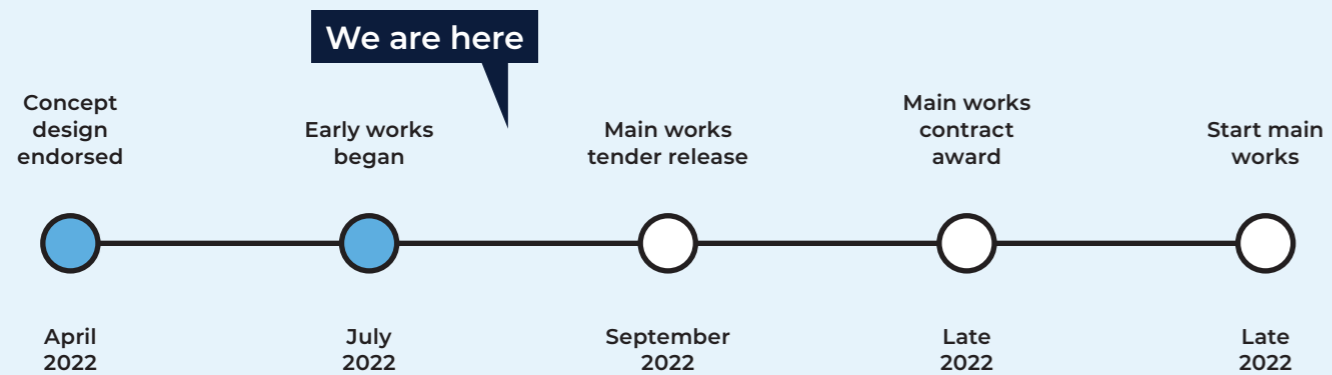

Next steps

The main works will be delivered in three stages via a development without consent planning pathway. The associated planning document, called a Review of Environmental Factors (REF), is under review by the SINSW statutory planning team as they consider feedback from Northern Beaches Council. If approved, SINSW plan to release a tender and appoint a builder in September 2022 before starting Stage 1 construction in late 2022.

Site plan

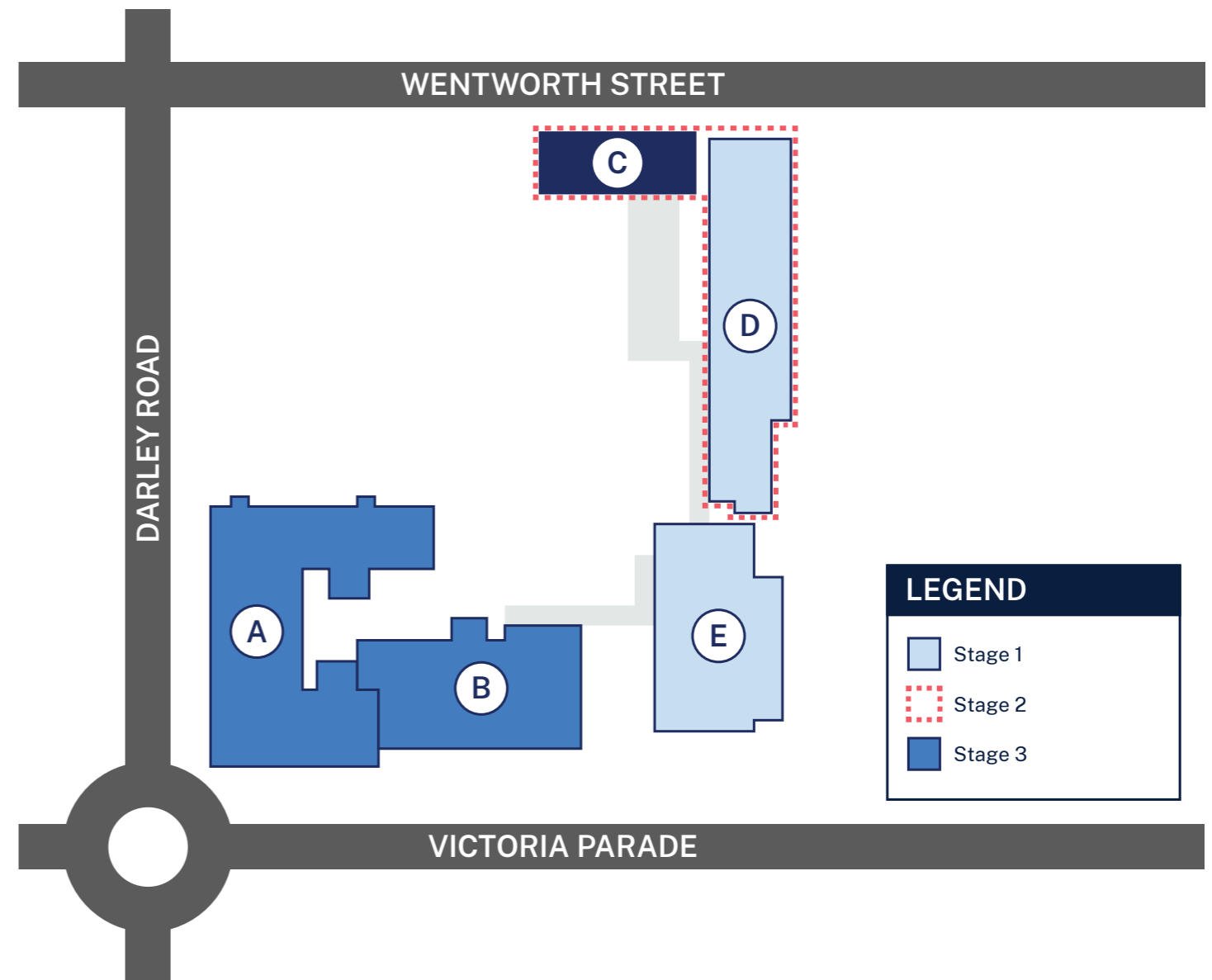

View of Building D from playground

Stage 1

During Stage 1, the contractor will relocate the outside of school hours care (OOSH) from Building D to Building E and install a new OOSH office and kitchenette adjacent to the covered outdoor learning area (COLA).

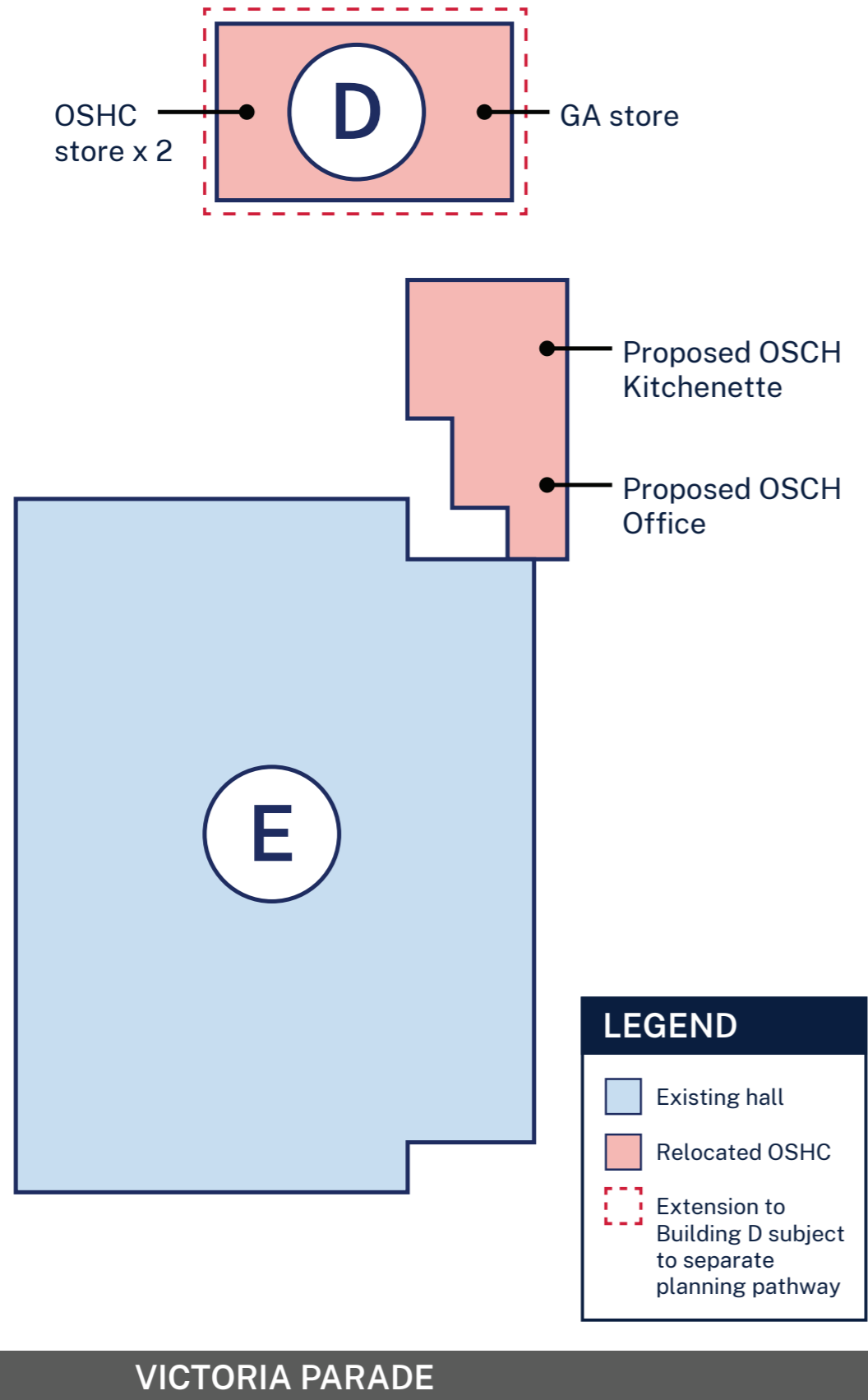

Stage 2

During Stage 2, the contractor will upgrade parts of Buildings C and D.

External works to Buildings C and D will include:

- removal of existing entry ramps to Buildings C & D
- removal of awning to Building C
- removal of existing external stairs between Buildings C & D
- new entry gate/fence from Wentworth Street
- new covered walkway
- new entry stair into Building C
- new covered walkway between Building C & D.

Internal alterations to Building C will include:

- demolition of existing internal stairs, toilet on the ground floor, first floor toilets and some internal walls
- conversion of ground floor of Building C for use as a classroom with new lightweight partition walls to provide practical activities area and withdrawal room
- installation of new lift and construction of new stairs
- upgrades to first floor classroom with new lightweight partition walls to provide PAA and withdrawal room.
- Internal alterations to Building D including:
 - conversion of ground floor for use as school administration with separate parent and student entries
 - conversion of first floor for use as two classrooms with new lightweight partition walls to provide withdrawal rooms and PAA.

Finally, the contractor will refurbish the external facades of Buildings C and D by painting, replacing gutters and downpipes, repointing masonry, and installing new roofing.

Ground floor

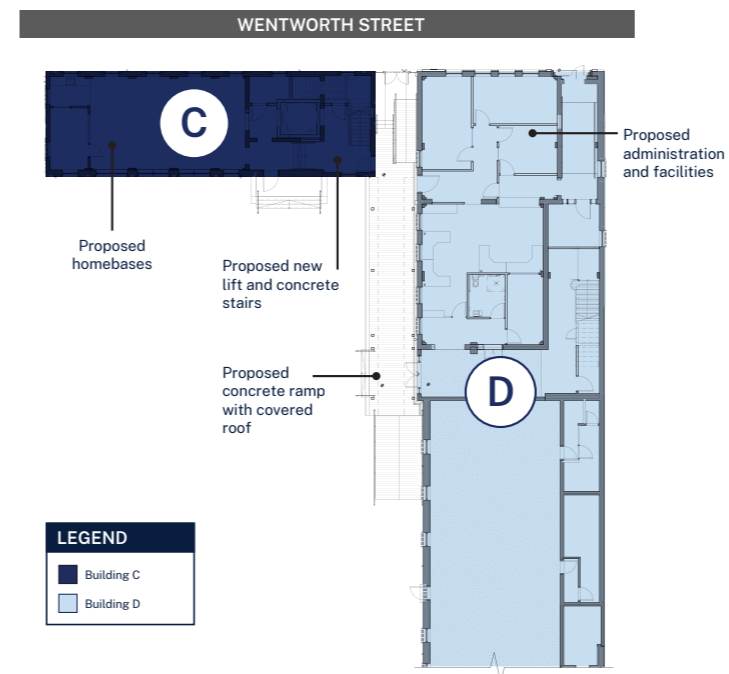

First floor

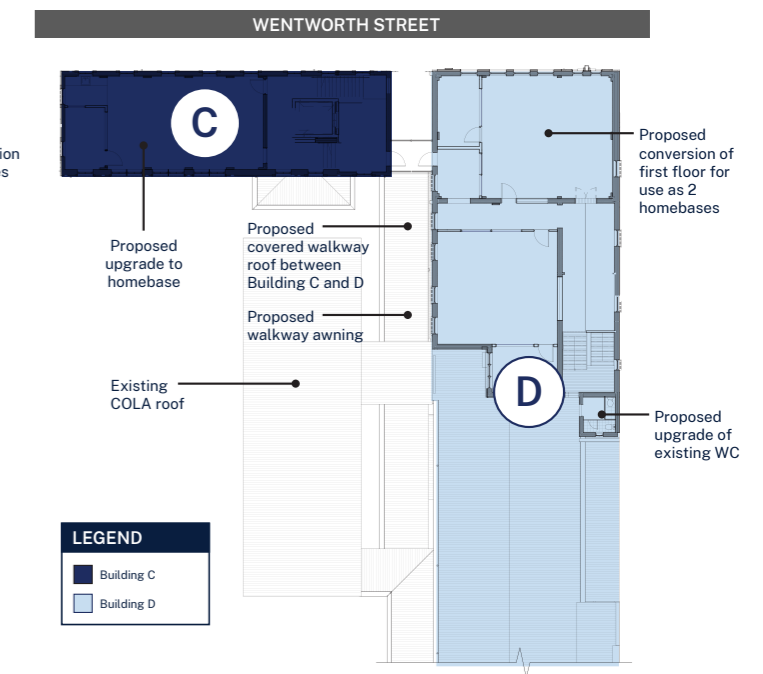

Stage 3

During Stage 3, the contractor will refurbish internal sections of Buildings A and B, including converting the existing administration area on ground floor of Building A to special programs classrooms.

Ground floor

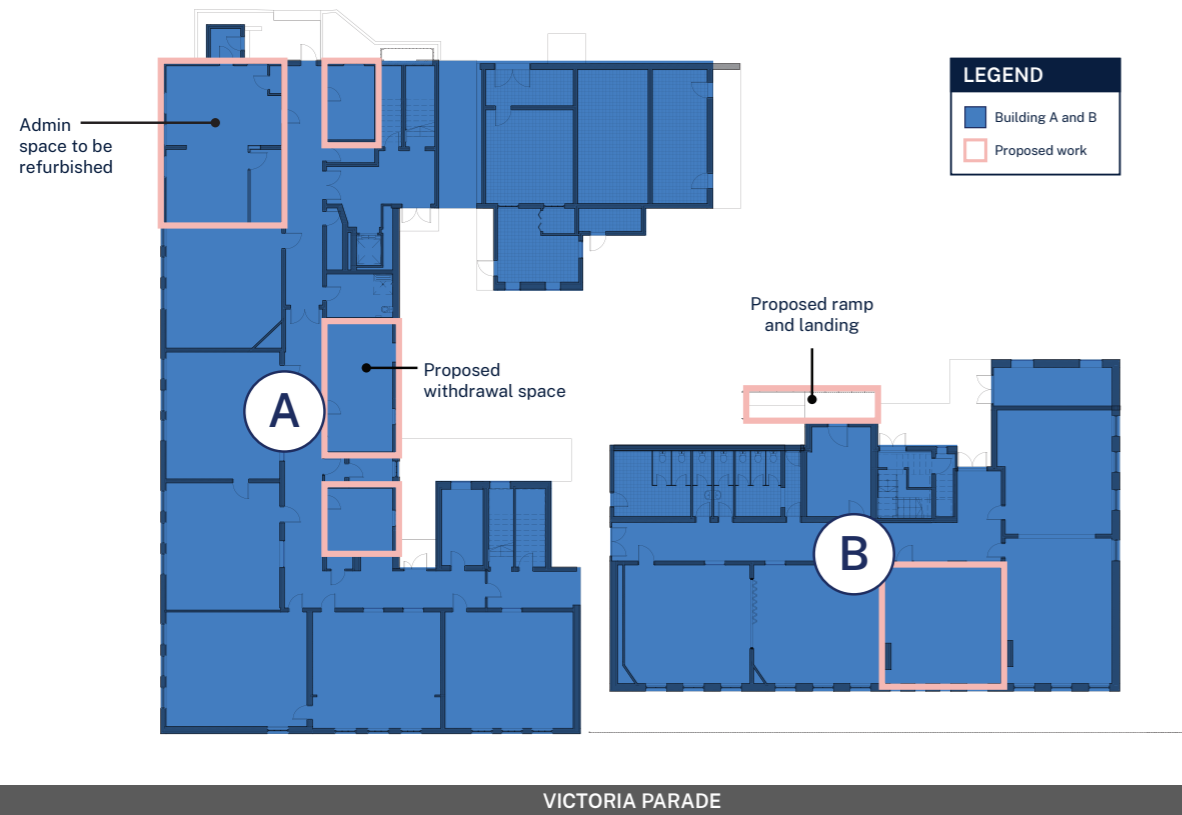

First floor

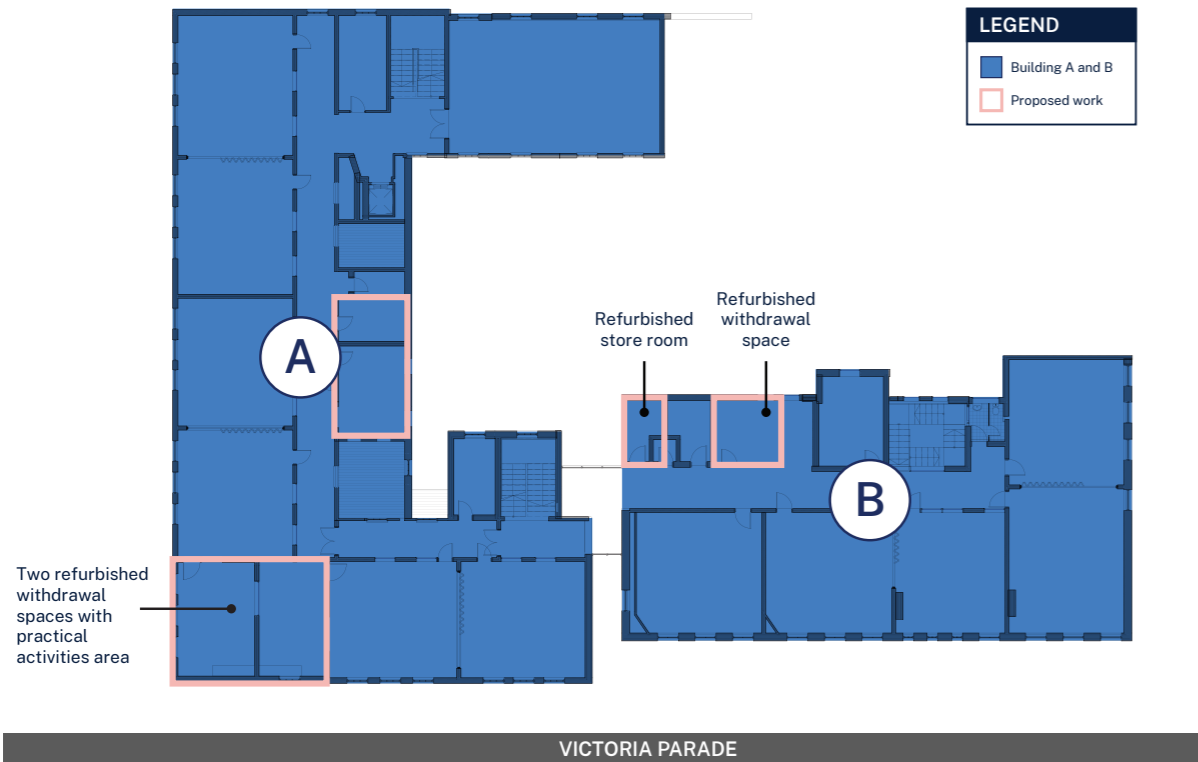

Third floor

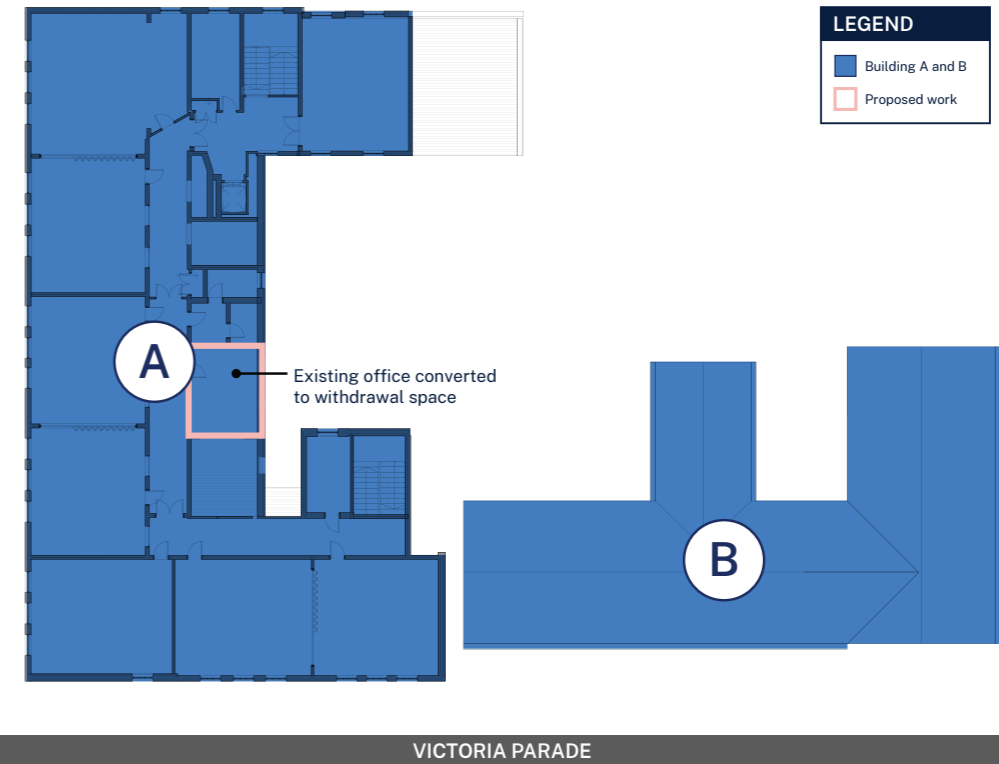

Frequently asked questions

Under what planning pathway will these works take place?

SINSW is proposing to undertake the works as development without consent pursuant to Section 3.37 of State Environmental Planning Policy (Transport and Infrastructure) 2021 (T&I SEPP).

In addition, it is proposed to undertake some works as part of Stage 1 as exempt development.

When will construction start?

Stage 1 construction is due to start in late 2022. During Stage 1, the contractor will relocate the OOSHC from Building D to Building E and install a new OOSHC office and kitchenette adjacent to the COLA.

How do you plan for construction before works start?

SINSW prepares various documents including construction and environmental management plans, which outline how construction impacts will be managed. Residents and businesses that may be impacted are also considered to ensure disruption is minimised wherever possible.

SINSW's planning approach includes:

- identifying the people who may hear or feel construction noise and vibration or be impacted by the work
- adopting statutory and regulatory conditions and requirements for the project
- identifying ways to reduce the impact of noise and vibration we will make on the site
- identifying the safest routes for construction traffic to enter and exit the site
- managing safe access for our neighbours to get to and from their own properties
- making plans for parking, both on the site and near it
- setting up measures to control dust on the site.

Frequently asked questions (continued)

How do you reduce your impact on the local community?

Construction can be disruptive and SINSW appreciates your patience throughout these works. There are many ways SINSW and its contractors can reduce the impact of noise and vibration from construction including:

- positioning noisy equipment away from classrooms and homes
- maintaining equipment to keep it in good working order
- installing noise controls on very noisy equipment and tools
- timing noisy works for less sensitive periods
- timing very noisy construction outside school exam periods and other important school events
- including rest breaks from high-noise activities during construction hours.

What are the construction work hours?

Standard construction working hours are 7 am to 6 pm, Monday to Friday, 8 am to 1 pm on Saturdays, and no work on Sundays or public holidays.

Sometimes SINSW's contractors need to work outside normal working hours. Out-of-hours work might include:

- road closures to allow oversize trucks to make large deliveries to site
- relocating pipes and cables for telephone, water, power or sewerage emergency works on site.

How will you communicate with neighbours during construction?

During construction, we will notify our neighbours before disruptive work takes place. These notices will detail:

- when works will start and finish
- the types of work
- the type of disruption to expect
- a phone number to contact SINSW with your questions or complaints about the work.

If we need to perform unexpected out-of-hours work, SINSW will explain the reasons why as soon as possible afterwards.

How will the community be kept safe during construction?

The safety of the school and the local community is SINSW's highest priority. Throughout the entire construction period rigorous safety and security measures will be put in place. There will be regular consultation with the school to discuss construction progress.

How can I get involved?

We are committed to working together with our school communities and other stakeholders to deliver the best possible learning facilities for students. Your feedback on this project is important to us. For more information, questions or to make a comment please email SINSW at schoolinfrastructure@det.nsw.edu.au or phone 1300 482 651.

Stay informed



Website

Stay up to date by visiting the project page at edu.nsw.link/MVPSupgrade



Email

Contact the Community Engagement team by emailing schoolinfrastructure@det.nsw.edu.au



Phone

Contact us between 9:00am and 5:00pm, Monday to Friday on **1300 482 651**