



This is an example of innovative learning spaces we are delivering for students in NSW

Liverpool West Public School upgrade

Project update

October 2020

Investing in our schools

The NSW Government is investing \$6.7 billion over four years to deliver more than 190 new and upgraded schools to support communities across NSW. This is the largest investment in public education infrastructure in the history of NSW.

The NSW Department of Education is committed to delivering new and upgraded schools for communities across NSW. The delivery of these important projects is essential to the future learning needs of our students and supports growth in the local economy.

Project overview

Early planning is underway to upgrade Liverpool West Public School to cater for projected growth.

The project proposes to deliver new flexible learning spaces in new buildings as well as upgrades to core facilities.

The new school will help cater for the fast-growing school age population in the Liverpool area.

Further planning will inform the size of the upgrade, extent of work, any potential staging requirements, and take into consideration future student enrolment projections for Liverpool West.

Significant milestones

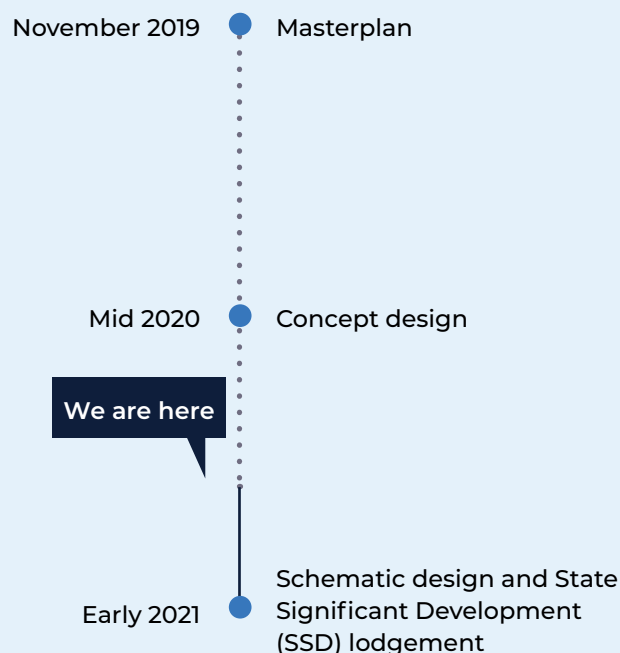

For more information contact:

School Infrastructure NSW
Email: schoolinfrastructure@det.nsw.edu.au
Phone: 1300 482 651
www.schoolinfrastructure.nsw.gov.au

Indicative site plan

Note: The image shows an indicative plan of the school upgrade. The final scope will be subject to business case and funding approval.

FIRST FLOOR

- () DEMOLITION
- ABORIGINAL GARDEN
- HALL & OSHC
- CANTEEN
- LIBRARY
- ADMINISTRATION & STAFF
- HOMEBASES (HBs)
- DEMOUNTABLE HOMEBASES

GROUND FLOOR

- SPECIAL PROGRAMS UNIT
- CIRCULATION & AMENITIES
- SUPPORT UNIT
- PRESCHOOL
- BUS PICK UP & DROP OFF
- PARENT PICK UP & DROP OFF

EXISTING BUILDINGS

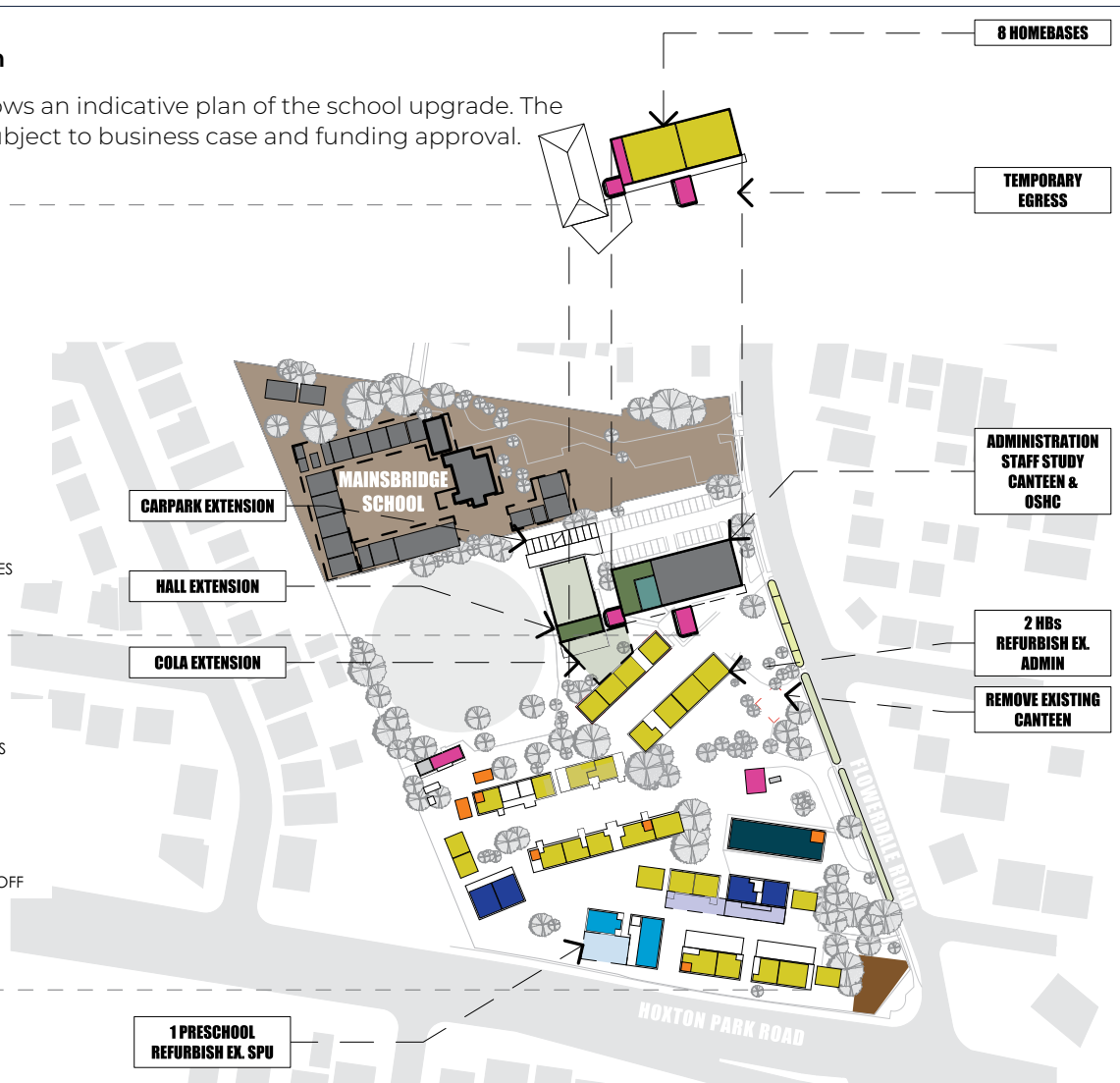

Current site plan

- HOME BASE
- SUPPORT UNIT
- STAFF/ADMINISTRATION BOH/STORE
- AMENITIES
- MULTIPURPOSE/HALL/GYMNASIUM
- LIBRARY
- EARLY LEARNING CENTRE
- CANTEEN

