

Leppington Public School

Project update | November 2024



Investing in our schools

As part of the NSW Government's plan to rebuild public education, the 2024-25 Budget is delivering record education funding, including \$3.6 billion for new and upgraded schools in Western Sydney. This targeted investment will ensure growing communities get access to a world class public education.

Project overview

The upgrade for Leppington Public School is in progress and will include new fit-for-purpose learning spaces and improved core facilities to support the growing student population in the area. The upgrades will be delivered in two stages. Stage 1 is forecast to open by 2026 and will include:

- 20 new permanent classrooms
- 3 new support learning classrooms
- a new hall and covered outdoor learning area (COLA), and
- upgrade and refurbishment of administration facilities and library

In addition to Stage 1, the 2024-25 Budget has committed funding to progress with Stage 2 of the project which will add additional capacity for this growing community. Stage 2 also includes an on-site public preschool as shown in the map on the next page. Further detail on the scope and timing of Stage 2 will be shared as the project progresses.

The new preschools are scheduled to be open by 2027. Each school will communicate with their community when enrolment applications can be taken, which is expected to be approximately 6 months before the preschool opening date.

Progress update

We are pleased to confirm the detailed design and construction tender for Stage 1 upgrade for Leppington Public School has been released. The contractor, once appointed, will advance



Email: schoolinfrastructure@det.nsw.edu.au
Phone: 1300 482 651
www.schoolinfrastructure.nsw.gov.au

the design of the new building to prepare for construction, which will start once the upgrade receives planning approval.

Next steps

- Complete the tender process and award the construction contract.
- When the contractor has been appointed, we will establish the timeline for delivery of the upgrades and share with school community.

Map of proposed upgrades for Leppington Public School upgrade – Stage 1

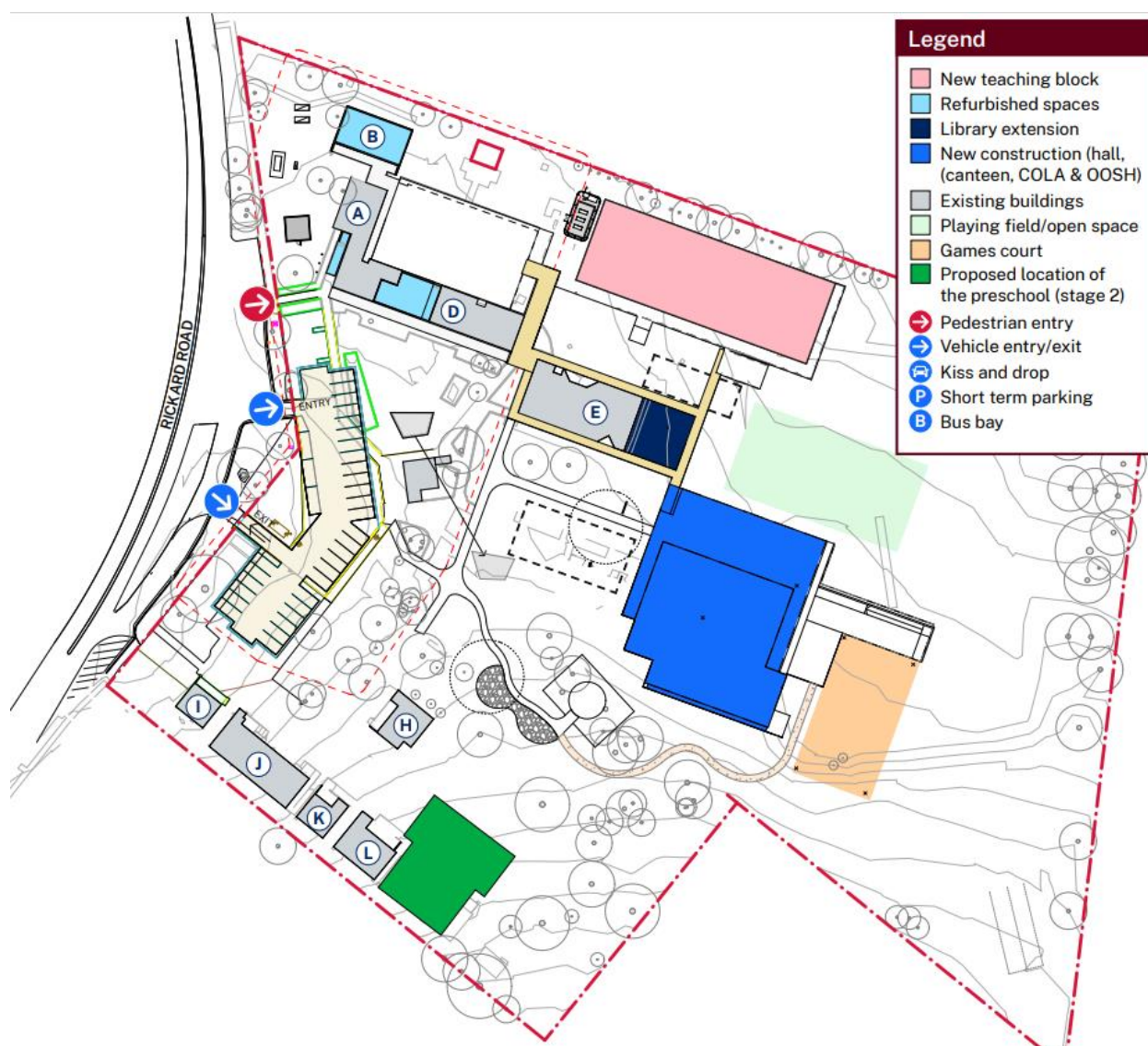

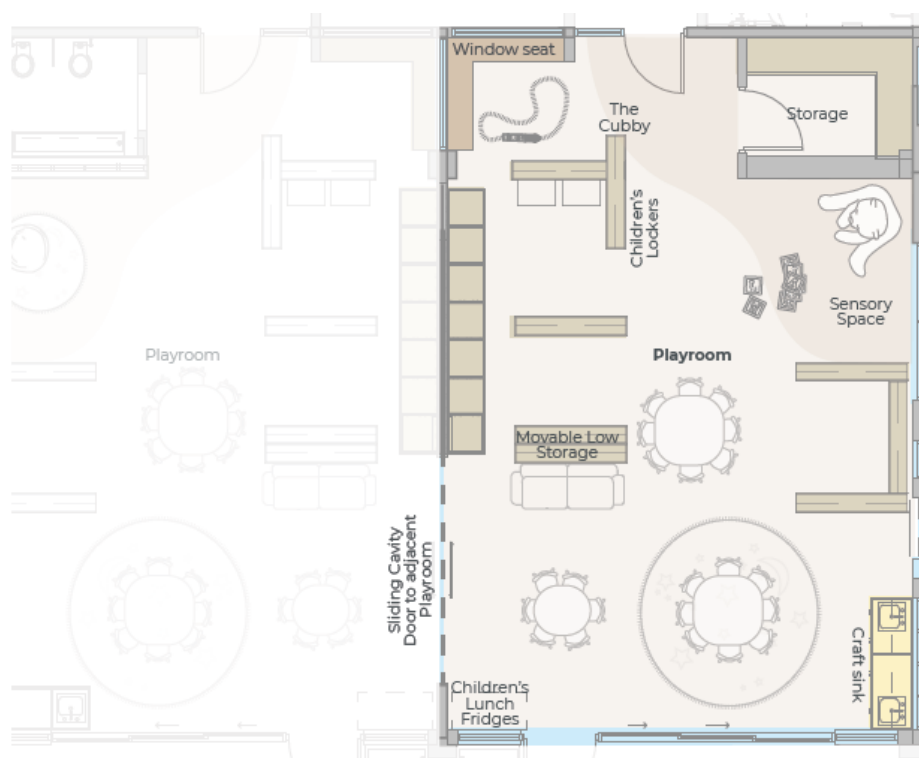
Example of a preschool playroom layout (indicative only)**Staying informed**

We are committed to working together with our school communities and stakeholders to deliver the best learning facilities for students. We will continue to distribute regular project updates to keep the community up to date with our progress. You can stay updated by visiting the project webpage at edu.nsw.link/LeppingtonPS-Upgrade. You can also access the project's webpage using the QR code.

If you have any queries or concerns about this project, you can contact School Infrastructure NSW email at schoolinfrastructure@det.nsw.edu.au or phone during business hours on 1300 482 651.

