

Artist impression of the new Lane Cove Public School canteen area

Lane Cove Public School

Project update

July 2021

Project overview

Construction has begun at Lane Cove Public School to replace the school hall and canteen facilities that were destroyed in a fire at the school in 2020.

The upgrade works include a covered outdoor learning area (COLA) attached to the school hall, and a playground area in front of the canteen building.

These works will be delivered in two stages:

- a new replacement school canteen with restoration works to the adjacent playground area (Stage 1)
- a new school hall and attached COLA (stage 2).

The new canteen facilities will be located on the site where the previous school hall was located. The new school hall will be built on the site known as “The Bullring”.

Progress Summary

Excavation and demolition of the old building has finished and construction of the new school canteen is progressing well.

The new hall design is finished.

Next steps

- Continue construction of canteen and new playground.
- The construction tender for the new hall has been released.
- Award the tender and finalise the construction program.
- Start construction of the new hall.

For more information contact:

School Infrastructure NSW
Email: schoolinfrastructure@det.nsw.edu.au
Phone: 1300 482 651
www.schoolinfrastructure.nsw.gov.au

Frequently asked questions

What is being built at Lane Cove Public School?

The project will deliver a new canteen with an adjacent playground area, and a new school hall with an attached covered outdoor learning area (COLA).

These buildings are replacements for the old hall and canteen which were destroyed in a fire.

How was the decision to change location of the hall made?

The relocation of the hall is necessary for it to be built in line with current Building Code of Australia (BCA) and Educational Facilities Standards and Guidelines (EFSG). The hall's original location is no longer suitable to accommodate the new building in line with current standards. The new hall will be built in the area known as "The Bullring". This decision was made in consultation with the school leadership team and a representative from the P&C.

The relocation of the hall provides additional benefits of increased open play space and improved access to the hall and out of school hours care (OSHC) facilities.

Will the designs for the new hall be shared with community?

The site layout and concept design images for the new hall are included in this project update.

What is the planning approval pathway for the hall?

To meet the requirements of the State Environmental Planning Policy (SEPP), School Infrastructure NSW will undertake a Review of Environmental Factors (REF) to determine whether there will be any potential impacts on the environment. As part of the REF process, we have issued a letter to neighbouring residents, providing them with details of the proposed work and contact details for feedback or further information.

What are the construction hours?

Construction works will take place 7 am to 5 pm Monday to Friday, and 8 am to 1 pm on Saturdays. No work will take place on Sundays or public holidays.

Will Lane Cove Netball Club continue to train at the school?

Yes. At this stage we anticipate that Lane Cove Netball Club will continue to train at Lane Cove Public School utilising alternative spaces in the school playground. This will be negotiated privately by the school.

Will the Tennis Club still use our tennis courts?

The tennis courts in The Bullring will not be accessible to the school community once construction of the new hall starts. The school is working with the tennis club to find a suitable alternate location.

Will this project have an SINSW website page?

The SINSW website highlights projects funded by the government, including new and upgraded schools and other targeted programs.

The Lane Cove Public School hall and canteen rebuild is to replace the previous facilities that were destroyed by a fire and is funded by insurance.

The latest project update will be available on the school page on the SINSW website:

<https://www.schoolinfrastructure.nsw.gov.au/schools/2/2368.html>

Who is managing the insurance claim?

School Infrastructure NSW have appointed iCare as the loss assessor to review and assess all aspects of the claim.

Get in touch

For any inquiries or further comments, please contact us on schoolinfrastructure@det.nsw.edu.au or phone 1300 482 651.

For more information contact:

School Infrastructure NSW
Email: schoolinfrastructure@det.nsw.edu.au
Phone: 1300 482 651
www.schoolinfrastructure.nsw.gov.au

Concept designs of the new hall at Lane Cove Public School



Hall with attached covered outdoor learning area (COLA)



Tiers for increased audience

For more information contact:

School Infrastructure NSW
Email: schoolinfrastructure@det.nsw.edu.au
Phone: 1300 482 651
www.schoolinfrastructure.nsw.gov.au

Site map of the new hall at Lane Cove Public School

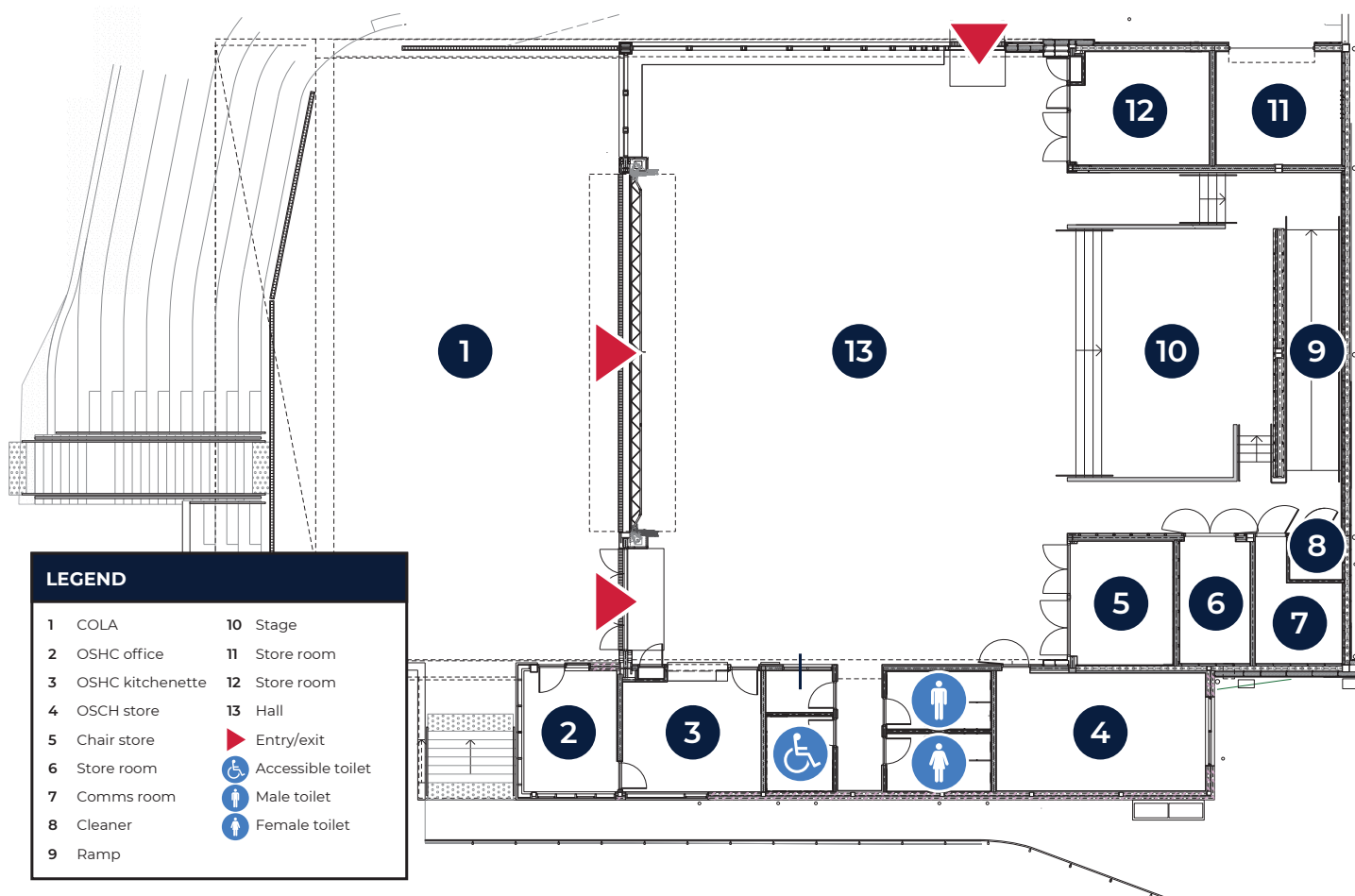

For more information contact:

School Infrastructure NSW
 Email: schoolinfrastructure@det.nsw.edu.au
 Phone: 1300 482 651
www.schoolinfrastructure.nsw.gov.au