

**NOTICE NO. DWY23/0070**  
**ASSOCIATED PARENT APPLICATION NO: DA20/0608**

**NOTICE OF DETERMINATION OF AN APPLICATION UNDER SECTION 138  
OF THE ROADS ACT, 1993 FOR CONSENT TO CONSTRUCT A PRIVATE  
ACCESS DRIVEWAY ON A PUBLIC ROAD**

To: Richard Crookes Construction  
8/6-10 Moss Street  
KINGSCLIFF NSW 2487

Pursuant to Section 138 of the Act, notice is hereby given of the determination by the Tweed Shire Council of Section 138 Application No. DWY23/0070 relating to land described as:

**LOT 57 DP 803814; NO. 33 OXFORD STREET KINGSCLIFF ,**

**DETERMINATION OF APPLICATION**

The access driveway works detailed in your application are approved.

For any enquiries relating to this approval please contact Council's Roads & Stormwater Unit.

Approved works are to be carried out in accordance with required attachments and drawings submitted with the application, except as amended by the following conditions of consent.

**CONDITIONS OF CONSENT**

1. All driveway works are to be done in accordance with Council's "*Driveway Access to Property - Construction Specification*".  
[DWY0010]
2. Concrete must not be poured (or other permanent materials or pavers placed) until the excavation, formwork and reinforcing has been inspected by Council's Supervising Officer. The contractor/owner/applicant must arrange an inspection by contacting Council's Engineering Division on (02) 6670 2400 between 8.30am and 4.30pm Monday to Friday, giving at least twenty four hours notice. Failure to have work inspected may result in the access being removed and reconstructed at the contractor/owner/applicant's expense.  
[DWY0020]
3. The owner is responsible to ensure that the driveway is located so that the sight lines specified in "AS2890.1 Off Street Car Parking" Figure 3.3 and Council's "Driveway Access to Property Design Specification" are provided and maintained.  
[DWY0030]
4. This approval only covers works that are undertaken within the public road reserve shown on the attached approved plans, which is generally between the property boundary and kerb & guttering. It is not an approval for any structures or works on private property including, but not limited to, any type of fence, letterbox, carport or internal driveways and paths, even if they are shown on the S138 approved plans. Council's Building Services Unit should be contacted for advice prior to undertaking any work or erecting any structure or fence on private property.  
[DWY0040]
5. Approval is given subject to the location of, protection of, and/or any necessary approved modifications to any existing public utilities situated within or adjacent to the subject property. Any necessary adjustment or modification of existing services is to be undertaken in accordance

with the requirements of the relevant authority, at the Developer's expense.

[GEN0135]

6. All existing trees within the road reserve are to be retained and protected during construction. Where existing trees within the road reserve cannot be adequately retained and protected, approval from Council's General Manager or their delegate is required to remove street trees and they are to be replaced with a similar species in a 45L pot in accordance with Council's Development Design Specification D14.08.03C Tree Planting and Location (for distances away from infrastructure such as light poles and driveways) and Standard Drawing 'Tree and Shrub Planting Details' Dwg. No. SD701 (including the installation of root barrier) to the satisfaction of Council's General Manager or their delegate.

[GEN0355]
7. Building materials used in the construction of the building are not to be deposited or stored on Council's footpath or road reserve, unless prior approval is obtained from Council.

[DUR0395]
8. Where the construction work is on or adjacent to public roads, parks or drainage reserves the development shall provide and maintain all warning signs, lights, barriers and fences in accordance with AS 1742 (Manual of Uniform Traffic Control Devices). The contractor or property owner shall be adequately insured against Public Risk Liability and shall be responsible for any claims arising from these works.

[DUR1795]
9. The proponent must not undertake any work within the public road reserve without giving Council's Development Engineering Unit 48 hours notice of proposed commencement. Failure to comply with this condition may result in a stop work notice being issued and/or rejection of the works undertaken.

[DUR1845]
10. Any damage caused to public infrastructure (roads, footpaths, water and sewer mains, power and telephone services etc) during construction of the development shall be repaired in accordance with Council's Development Design and Construction Specifications prior to the issue of a Subdivision Certificate and/or prior to any use or occupation of the buildings.

[DUR1875]
11. Where existing kerb or footpath is to be removed for driveway laybacks, stormwater connections, kerb ramps or any other reason, the kerb or footpath must be sawcut on each side of the work to enable a neat and tidy joint to be constructed.

[DUR1905]
12. The applicant is required to do a letter box drop to all affected residents of the impending works 7 days prior to works commencing.
13. All new paths are to be a minimum 1.5 metres wide unless noted on the plan.
14. Some sections of the new paths may be reduced in width to allow for the formation around existing tree's and constructed as per Council's standard drawing S.D.013 section B, Council officer is to determine widths at each location.
15. Any tree's to be removed are to be replaced with a *Cupananiopsis anacardioides* (Tuckeroo).
16. Root barrier is to be installed were required as per Council's standard drawing S.D.701.
17. All affected existing infrastructure is to be altered to match new footpath levels.
18. All pavement marking, removal, installation and raised reflective pavement markers are to comply with the latest guidelines from Transport for New South Wales and the work is to be completed by an approved Tweed Shire Council contractor, all signage is to be installed by

Tweed Shire Council please contact Council's signage and linemarking forman for the list of contractors and a signage quote on 0408 295 846.

19. The proposed traffic island in Oxford Street is to be reduced in length to allow suitable access to No 60 Cudgen Road.
20. Asphalt is to be minimum 35mm thick AC10 with a 300mm step as per Tweed Shire Council Standard.
21. All new kerb island(s) are to be cast insitu (cast ontop of the pavement & locked in with 35mm asphalt) and not precast bolt downs.

[DURNS01]

22. Prior to the issue of an Occupation Certificate a Defect Liability Bond (in cash **or** unlimited time Bank Guarantee) shall be lodged with Council.

The bond shall be based on 5% of the value of the public infrastructure works approved under Section 138 of the Roads Act and Section 68 of the Local Government Act (as set out in Councils Fees and Charges current at the time of payment) which will be held by Council for a period of 6 months from the date on which the Occupation Certificate is issued. It is the responsibility of the Proponent to apply for refund following the remedying of any defects arising within the 6 month period.

[POC0165]

23. Prior to the issue of an Occupation Certificate, the applicant shall produce a copy of the "Final Satisfactory Inspection Report" issued by Council for all works required under Section 138 of the Roads Act 1993.

24. The approved works are subject to the following inspections by Council's Engineering Division officer (contact 02 6670 2571).

Prior to the issue of an Occupation Certificate, the applicant must provide satisfactory inspection certificates for all works within the road reserve, including but not limited too.

Sub base, base material, kerb and gutter, crossover/driveway, foot paving, kerb ramps, signage and line marking, ground anchor removal, and a final certificate for all works within the road reserve.

The above inspections are subject to fees in accordance with Council's Fees and Charges Table and must be paid prior to the issue of the Occupation Certificate, Council's Road And Stormwater Unit is to be contacted for the invoice.

[POC0745]

25. Council's standard "Asset Creation Form" shall be completed (including all quantities and unit rates) and submitted to Council. Written approval from Councils General Manager or his delegate must be issued prior to the issue of an Occupation Certificate.

[POC0865]

26. Prior to the release of the **5% Compliance Bond associated with a Section 138 application**, Work as Executed Plans (WAX Plans) and an accompanying ADAC XML Digital File shall be submitted to Council for endorsement in accordance with the provisions of Tweed Shire Council's Development Control Plan Part A5 - Subdivision Manual and Council's Development Design Specification, D13 - Engineering Plans.

The WAX Plans are to be endorsed by a NSW Registered Surveyor AND/OR a Consulting Engineer as specified in D13, certifying that:

- a. all drainage lines, sewer lines, services and structures are wholly contained within the relevant easement(s) created by the subdivision;
- b. the plans accurately reflect the Work as Executed, including all the actual asset types and materials used in the construction;

- c. the accompanying ADAC XML Digital File corresponds exactly with all details of the Summary WAX plan(s) including lot and easement details, geometries, relative levels, assets and material types.

**Note: Where works are carried out by Council on behalf of the developer it is the responsibility of the DEVELOPER to prepare and submit Works-As-Executed (WAX) plans.**

[POC1120]

27. Prior to the issue of the Final Certificate, Work as Executed Plans (WAX Plans) and an accompanying ADAC XML Digital File shall be submitted to Council for endorsement in accordance with the provisions of Tweed Shire Council's Development Control Plan Part A5 - Subdivision Manual and Council's Development Design Specification, D13 - Engineering Plans.

The WAX Plans are to be endorsed by a NSW Registered Surveyor AND/OR a Consulting Engineer as specified in D13, certifying that:

- a. all drainage lines, sewer lines, services and structures are wholly contained within the relevant easement(s) created by the subdivision;
- b. the plans accurately reflect the Work as Executed, including all the actual asset types and materials used in the construction;
- c. the accompanying ADAC XML Digital File corresponds exactly with all details of the Summary WAX plan(s) including lot and easement details, geometries, relative levels, assets and material types.

**Note: Where works are carried out by Council on behalf of the developer it is the responsibility of the DEVELOPER to prepare and submit Works-As-Executed (WAX) plans.**

[PSC0735]

28. Council's standard "Asset Creation Form" shall be completed (including all quantities and unit rates) and submitted to Council.

[PSC0855]

**Signed on behalf of the Tweed Shire Council:**

**Per Danny Rose  
Manager Roads & Stormwater  
21 July 2023**

# KINGSCLIFF HIGH SCHOOL

## STAGE 2 MAIN WORKS 33 OXFORD ST, KINGSCLIFF NSW EXTERNAL CIVIL WORKS

© COPYRIGHT of this design and plan is the property of ACOR Consultants (QLD) Pty Ltd, ACN 126 011 087 ABN 18 126 011 087, all rights reserved. It must not be used, modified, reproduced or copied wholly or in part without written permission from ACOR Consultants (QLD) Pty Ltd. ACOR Consultants is a trademark licensed to ACOR Consultants (QLD) Pty Ltd by ACOR Consultants Pty Ltd.

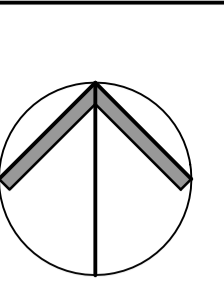

This drawing has been assigned an electronic code that signifies the drawing has been checked and approved by:

Issue	Description	Date	Drawn	Approved
A	ISSUED FOR INFORMATION	15/12/22	MCG	ND
---	---	---	---	---
---	---	---	---	---
---	---	---	---	---
---	---	---	---	---
---	---	---	---	---
---	---	---	---	---
---	---	---	---	---
---	---	---	---	---
---	---	---	---	---
---	---	---	---	---
---	---	---	---	---

**ENGINEER'S CERTIFICATION**  
This drawing has been assigned an electronic code that signifies the drawing has been checked and approved by:

DRAWING INDEX	
DWG No.	DESCRIPTION
<b>GENERAL</b>	
KHS-C20.01	COVER SHEET DRAWING INDEX AND LOCALITY PLAN
KHS-C20.11	GENERAL NOTES
<b>SITWORKS</b>	
KHS-C20.21	SITWORKS OVERALL LAYOUT PLAN
KHS-C24.01	SITWORKS LAYOUT PLAN SHEET 1 OF 11
KHS-C24.02	SITWORKS LAYOUT PLAN SHEET 2 OF 11
KHS-C24.03	SITWORKS LAYOUT PLAN SHEET 3 OF 11
KHS-C24.04	SITWORKS LAYOUT PLAN SHEET 4 OF 11
KHS-C24.05	SITWORKS LAYOUT PLAN SHEET 5 OF 11
KHS-C24.06	SITWORKS LAYOUT PLAN SHEET 6 OF 11
KHS-C24.07	SITWORKS LAYOUT PLAN SHEET 7 OF 11
KHS-C24.08	SITWORKS LAYOUT PLAN SHEET 8 OF 11
KHS-C24.09	SITWORKS LAYOUT PLAN SHEET 9 OF 11
KHS-C24.10	SITWORKS LAYOUT PLAN SHEET 10 OF 11
KHS-C24.11	SITWORKS LAYOUT PLAN SHEET 11 OF 11

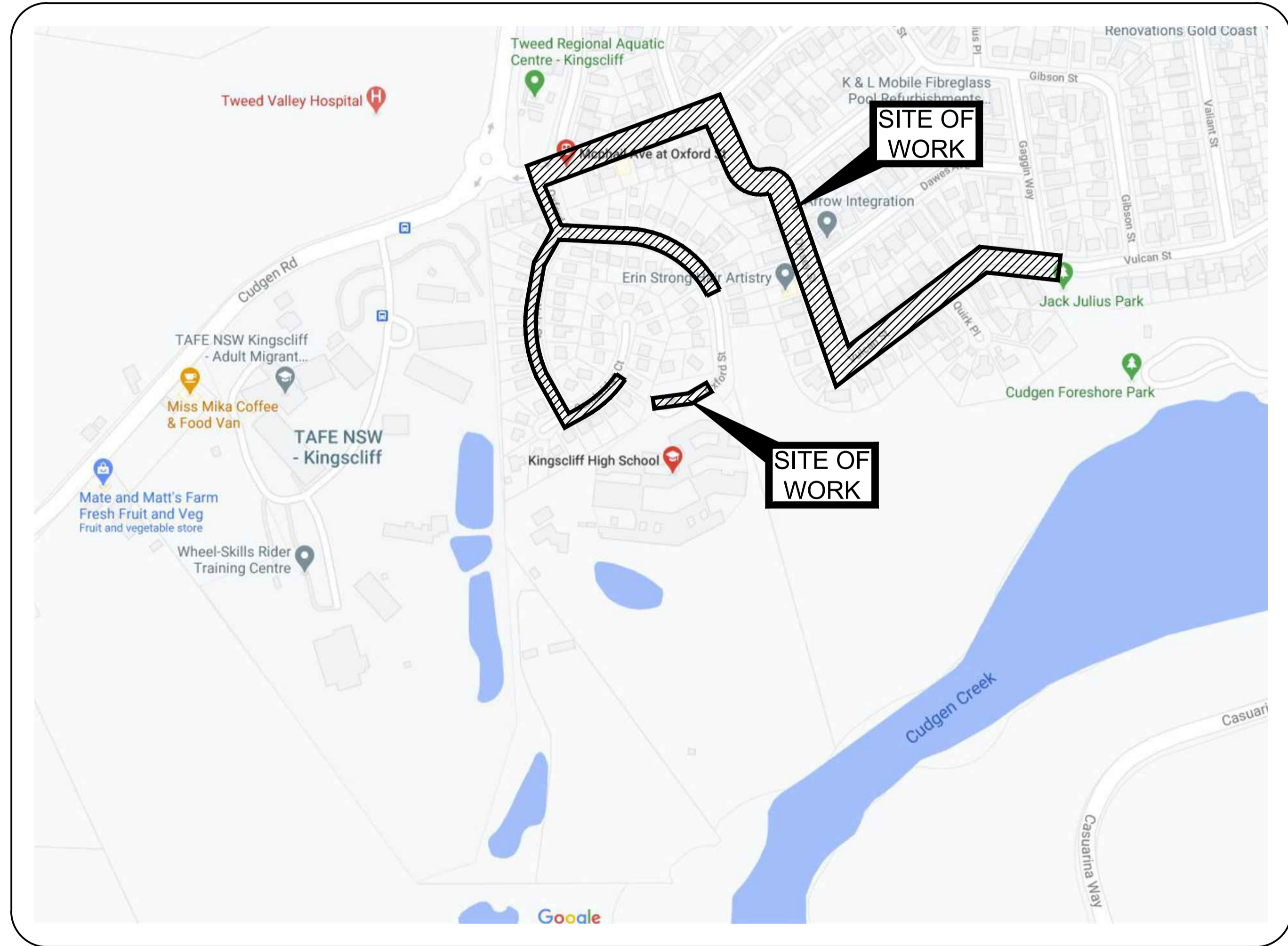

LOCALITY PLAN  
N.T.S.

S138 ROADS ACT 1993  
DRIVEWAYS AND OTHER WORKS  
ON PUBLIC ROADS  
APPROVAL  
APPROVAL NO DWY23/0070  
**TWEED SHIRE COUNCIL**

ISSUED FOR INFORMATION

Client

Project  
**KINGSCLIFF HIGH SCHOOL  
STAGE 2 MAIN WORKS  
(EXTERNAL CIVILS)**  
33 OXFORD STREET  
KINGSCLIFF NSW 2487

**ACOR** CONSULTANTS  
ACOR Consultants (QLD) Pty Ltd  
Level 7, 22 Cordelia Street  
South Brisbane QLD 4101  
T +61 7 3844 5900

ENGINEERS | MANAGERS | INFRASTRUCTURE PLANNERS | DEVELOPMENT CONSULTANTS  
Drawing Title  
COVER SHEET AND LOCALITY PLAN

Drawn	Date	Scale	Sheet Size	C.A. Check	Date
MCG	08/12/22	NTS	A1	ND	15/12/22
Designed	Project No.	Dwg. No.	Issue		
ND	BR210028	KHS-C20.01	A		

C:\Users\mccg\OneDrive - ACOR Consultants (QLD) Pty Ltd\Desktop\BR210028\KHS-C20.01 COVER SHEET AND LOCALITY PLAN.dwg

**GENERAL**

- ORIGINAL SITE SURVEY PREPARED BY: B & P SURVEYS, CONSULTING SURVEYORS  
 DATUMS USED: VIDE SSM 41488 AHD  
 VERT: RL 16.476  
 CONTOUR INTERVAL: 0.10m  
 CONTRACTOR MUST VERIFY ALL DIMENSIONS AND EXISTING LEVELS ON SITE PRIOR TO COMMENCEMENT OF WORK.
- EXISTING SERVICES HAVE BEEN PLOTTED FROM SUPPLIED DATA AND AS SUCH THEIR ACCURACY CANNOT BE GUARANTEED. IT IS THE RESPONSIBILITY OF THE CONTRACTOR TO ESTABLISH THE LOCATION AND LEVEL OF ALL EXISTING SERVICES PRIOR TO COMMENCEMENT OF ANY WORK. ANY DISCREPANCIES SHALL BE REPORTED TO THE SUPERINTENDENT.
  - THE CONTRACTOR SHALL ARRANGE ALL SURVEY SETOUT BY A LICENSED LAND SURVEYOR. CONFIRM SETOUT WITH ARCHITECT.
  - ALL SERVICE TRENCHES UNDER VEHICULAR PAVEMENTS SHALL BE BACKFILLED WITH APPROVED FILL MATERIAL AND COMPACTED TO 100% STANDARD MAXIMUM DRY DENSITY IN ACCORDANCE WITH AS1289.5.1.1:2017.
  - ON COMPLETION OF SERVICES INSTALLATION, ALL DISTURBED AREAS SHALL BE RESTORED TO ORIGINAL, INCLUDING KERBS, FOOTPATHS, CONCRETE AREAS, GRAVEL AREAS, GRASSED AREAS AND ROAD PAVEMENTS.
  - WHERE NEW WORK ABUTS EXISTING, THE CONTRACTOR SHALL ENSURE THAT A SMOOTH EVEN PROFILE FREE FROM ABRUPT CHANGES, IS OBTAINED.
  - CARE TO BE TAKEN WHEN EXCAVATING ELECTRICAL, COMMUNICATIONS AND ORIGIN GAS SERVICES. NO MECHANICAL EXCAVATION TO BE UNDERTAKEN OVER ELECTRICAL, COMMUNICATIONS AND GAS; HAND EXCAVATE IN THESE AREAS. LIAISE WITH RELEVANT LOCAL AUTHORITY.
  - ALL WORKS SHALL BE IN ACCORDANCE WITH RELEVANT THE LOCAL AUTHORITY STANDARDS, DETAILS SHOWN ON THE DRAWINGS, THE SPECIFICATION AND THE DIRECTIONS OF THE ARCHITECT.
  - THE CONTRACTOR SHALL NOT DISTURB ANY EXISTING SURVEY BENCH MARKS OR REFERENCE MARKS (UNLESS INDICATED FOR REMOVAL) WITHOUT DEPT. OF NATURAL RESOURCES APPROVAL IN WRITING. THE CONTRACTOR SHALL OBTAIN ALL RELEVANT AUTHORITIES APPROVALS. (PRIOR TO COMMENCEMENT AND UPON COMPLETION).
  - WORK ON EXISTING EXTERNAL STORMWATER SERVICES BY CONTRACTOR ARE SUBJECT TO INSPECTION AND APPROVAL BY THE LOCAL AUTHORITY.
  - THE CONTRACTOR SHALL LOCATE AND CONFIRM LEVELS OF ALL EXISTING SERVICE CONNECTIONS PRIOR TO COMMENCING WORK.
  - THE CONTRACTOR SHALL REFER TO LANDSCAPE DRAWINGS FOR DETAILS OF TREATMENT OF BATTERS, SWALE DRAINS AND ANY OTHER AREAS DISTURBED AS PART OF CIVIL WORKS.
  - ROAD OPENINGS:  
 THE CONTRACTOR'S ATTENTION IS DRAWN TO THE REQUIREMENTS OF THE LOCAL AUTHORITY. WHERE THE WORK IS LOCATED IN A ROAD RESERVE OR CROSSES THE PAVEMENT OF A PUBLIC ROADWAY OR FOOTWAY, OBTAIN A CONSENT COVERING THE NECESSARY OPENINGS AND COMPLY WITH ALL THE CONDITIONS COVERING THE ISSUE OF SUCH A CONSENT. A CHARGE IS MADE FOR PERMITS ISSUED IN RESPECT OF PAVEMENT OPENINGS. CONTRACTOR TO OBTAIN DETAILS FROM THE LOCAL AUTHORITY. MEET ALL REQUIREMENTS AND PAYMENTS, AND CARRY OUT ALL LIAISON AT NO EXTRA COST. ALL PAVEMENT SURFACING IS TO BE UNDERTAKEN BY THE CONTRACTOR. ALL PAVEMENT REINSTATEMENT TO BE UNDERTAKEN BY THE CONTRACTOR.
  - REFER ALSO TO HYDRAULIC, LANDSCAPING, MECHANICAL AND ELECTRICAL CONSULTANTS' DRAWINGS FOR ADDITIONAL SITE SERVICES TO BE CO-ORDINATED FOR CONSTRUCTION UNDER PROPOSED CARPARK PAVEMENTS.
  - A GEOTECHNICAL INVESTIGATION FOR THE ORIGINAL SITE HAS BEEN PREPARED BY DOUGLAS PARTNERS, PROJECT No. 200062.00 DATED 1 APRIL 2021. THE CONTRACTOR SHALL ENSURE THAT THEY ARE FAMILIAR WITH THE CONTENTS OF THIS REPORT AND THE REPORT DOES FORM PART OF THE CONTRACT.
  - ALL CONSTRUCTION WORK SHALL BE CARRIED OUT SO THAT AT ANY TIME ADJOINING PROPERTY OWNERS ARE NOT DEPRIVED OF AN ALL-WEATHER ACCESS OR SUBJECTED TO ADDITIONAL STORM WATER RUN-OFF DURING THE PERIOD OF CONSTRUCTION.
  - CONTRACTOR SHALL BE RESPONSIBLE FOR REPAIR OF ANY DAMAGE TO THE LOCAL AUTHORITY'S INFRASTRUCTURE. SUCH REPAIR OR REINSTATEMENT TO BE CARRIED OUT IMMEDIATELY TO THE SATISFACTION OF THE SUBDIVISION AND DEVELOPMENT MANAGER OF THE LOCAL AUTHORITY.
  - SITE INSPECTIONS REQUIRED AS SPECIFIED.
  - FOR CIVIL SETOUT INFORMATION CONTACT ACOR QLD PTY LTD (PH +61 7 3844 5900) AND AN AUTOCAD DRAWING FILE WILL BE ISSUED FOR INFORMATION TO ASSIST WITH THE SITE SETOUT.
  - CONTRACTOR IS TO ALLOW TO INCLUDE ANY REQUIRED THE LOCAL AUTHORITY INSPECTION AND COMPLIANCE FEES IN THE CONTRACT.

**EARTHWORKS**

- FOLLOWING DEMOLITION OF EXISTING STRUCTURES, ALL VEGETATION, SOILS CONTAINING ORGANIC AND DELETERIOUS MATERIAL, CONCRETE SLABS, CONCRETE BUILDING FOOTINGS AND PAVEMENT AREAS SHALL BE STRIPPED AND REMOVED FROM SITE.
- ALL EXISTING TREE STUMPS AND ROOTS SHALL BE GRUBBED OUT TO A MINIMUM DEPTH OF 750mm.
- DEPRESSIONS FORMED BY REMOVAL OF UNDERGROUND ELEMENTS AND OR WEAKENED AREAS SHOULD BE CLEANED OUT AND FILLED WITH COMPACTED IMPORTED FILL MATERIAL.
- EXPOSED CONSTRUCTION AREAS SHALL BE PROOF ROLLED USING A VEHICLE WITH A TARE OF AT LEAST 5 TONNES PER AXLE IN THE PRESENCE OF THE NOMINATED GEOTECHNICAL TESTING AUTHORITY AND A REPRESENTATIVE OF ACOR QLD PTY LTD. AREAS DEMONSTRATING EXCESSIVE MOVEMENT SHALL BE TREATED IF POSSIBLE, OR REMOVED TO COMPETENT MATERIAL AND REPLACED WITH COMPACTED IMPORTED FILL MATERIAL. CONTRACTOR TO ALLOW A PROVISIONAL SUM FOR REMOVAL OF UNSUITABLE MATERIAL AND REPLACEMENT WITH COMPACTED IMPORTED FILL MATERIAL.
- ALL SOFT, WET OR UNSUITABLE MATERIAL IS TO BE REMOVED AND REPLACED WITH APPROVED MATERIAL SATISFYING THE REQUIREMENTS LISTED BELOW FOR IMPORTED FILL MATERIAL.
- PLACE IMPORTED FILL MATERIALS SATISFYING THE REQUIREMENTS LISTED BELOW TO NOMINATED BULK EARTHWORKS LEVELS ON BULK EARTHWORKS PLAN.
- ALL IMPORTED FILL MATERIAL SHALL BE FROM A SOURCE APPROVED BY THE SUPERINTENDENT AND SHALL COMPLY WITH THE FOLLOWING:
  - FREE FROM ORGANIC AND PERISHABLE MATTER
  - MAXIMUM PARTICLE SIZE 75mm
  - PLASTICITY INDEX MAXIMUM 15%
  - LIQUID LIMIT, MAX OF 45%
  - PASSING 19mm SIEVE, MAX 80%
  - MINIMUM CBR 10%
  - SHRINK/SWELL INDEX, MAX OF 1.0%
- CONTRACTOR TO PROVIDE CERTIFICATION TO SUPERINTENDENT FROM NATA REGISTERED LAB THAT THE FILL MATERIAL IS FREE OF ACTUAL OR POTENTIAL ACID SULFATE SOILS AND MEETS CURRENT DPI REGULATIONS FOR THE CONTROL OF RED IMPORTED FIRE ANTS (RIFIA).
- ALL ENGINEERED FILL MATERIAL SHALL BE PLACED IN MAXIMUM 200mm THICK LAYERS AND COMPACTED AT OPTIMUM MOISTURE CONTENT (+ OR - 2%) TO ACHIEVE THE FOLLOWING MINIMUM COMPACTION VALUES:
 

LOCATION	COHESIVE SOILS	COHESIONLESS SOILS
BUILDING AREAS • FOUNDATION SUPPORT • FLOOR SLABS PAVEMENT AREAS	98% 98%	80% 80%
• TOP 300mm BELOW SUBGRADE LEVEL • BELOW THE TOP 300mm LANDSCAPE AREAS	98% 95% 95%	80% 75% 75%

 WHERE THE ABOVE VALUES ARE DETERMINED IN ACCORDANCE WITH AS1289.5.1.1 (STANDARD COMPACTION) FOR COHESIVE SOILS AND AS1289.5.6.1 (STANDARD METHOD) FOR COHESIONLESS SOILS.
- ALL EARTHWORKS OPERATIONS SHALL BE CARRIED OUT WITH LEVEL 1' ENGINEERING SUPERVISION IN ACCORDANCE WITH APPENDIX B OF AS 3798. THE NOMINATED GEOTECHNICAL TESTING AUTHORITY SHALL PROVIDE RPEQ CERTIFICATION AS NOTED IN THE GEOTECHNICAL REPORT THAT ALL GENERAL EARTHWORKS OPERATIONS HAVE BEEN CARRIED OUT IN ACCORDANCE WITH THE DRAWINGS AND SPECIFICATIONS AND THE CONTROLLED FILL IS SUITABLE FOR PURPOSE WITH A MINIMUM 100 KPa BEARING CAPACITY UNDER THE BUILDING.
- THE CONTRACTOR SHALL PROGRAMME THE EARTHWORKS OPERATION SO THAT THE WORKING AREAS ARE ADEQUATELY DRAINED DURING THE PERIOD OF CONSTRUCTION. THE SURFACE SHALL BE GRADED AND SEALED OFF TO REMOVE DEPRESSIONS, ROLLER MARKS AND SIMILAR WHICH WOULD ALLOW WATER TO POND AND PENETRATE THE UNDERLYING MATERIAL. ANY DAMAGE RESULTING FROM THE CONTRACTOR NOT OBSERVING THESE REQUIREMENTS SHALL BE RECTIFIED BY THE CONTRACTOR AT THEIR COST.
- TESTING OF THE SUBGRADE SHALL BE CARRIED OUT IN ACCORDANCE WITH AS 3798 BY AN APPROVED NATA REGISTERED LABORATORY AT THE CONTRACTOR'S EXPENSE.
- ALL BASE AND SUB-BASE MATERIALS SHALL BE PLACED IN MAXIMUM 150mm THICK LAYERS AND COMPACTED AT OPTIMUM MOISTURE CONTENT OF (+ OR - 2%) TO ACHIEVE A DRY DENSITY IN ACCORDANCE WITH AS 1289.5.2.1 OF NOT LESS THAN THE FOLLOWING:
 

LAYER	MODIFIED DRY DENSITY
BASE COURSE	98% MODIFIED (AS 1289.5.2.1)
SUB-BASE COURSE	95% MODIFIED (AS 1289.5.2.1)
- CONTRACTOR TO ENSURE VIA THE APPROPRIATE SELECTION OF FILL MATERIAL AND EARTHWORKS THAT, UPON COMPLETION OF THE EARTHWORKS, THAT THE BUILDING PLATFORM HAS A CLASS 'S' CLASSIFICATION IN ACCORDANCE WITH AS2870.
- ANY SURPLUS EXCAVATED MATERIAL SHALL BE DISPOSED OF OFF SITE AT AN APPROVED TIP SITE. CONTRACTOR TO ALLOW TO COMPLY WITH CURRENT DEPARTMENT OF AGRICULTURAL AND WATER RESOURCES REGULATIONS FOR THE CONTROL OF RED IMPORTED FIRE ANTS.
- ANY CONTAMINATED MATERIAL SHALL BE MANAGED AND DISPOSED OF ACCORDING TO THE LOCAL AUTHORITY AND EPA REQUIREMENTS INCLUDING CERTIFICATION.
- THE USE OF POTABLE WATER IS NOT PERMITTED IN ACTIVITIES ASSOCIATED WITH ROAD AND PAVEMENT CONSTRUCTION. THE COMPACTION OF FILL MATERIAL OR DUST SUPPRESSION CONTRACTOR TO UTILISE RECYCLED OR SUITABLE NON POTABLE WATER FOR THESE ACTIVITIES WITHIN THE CONTRACT. USE OF RECYCLED WATER MUST BE IN ACCORDANCE WITH THE REQUIREMENTS OF THE LOCAL AUTHORITY.

**EXISTING SERVICES AND FEATURES**

- THE CONTRACTOR SHALL ALLOW FOR THE CAPPING OFF, EXCAVATION AND REMOVAL IF REQUIRED OF ALL EXISTING SERVICES IN AREAS AFFECTED BY THE WORKS WITHIN THE CONTRACT AREA, AS SHOWN ON THE DRAWINGS UNLESS DIRECTED OTHERWISE BY THE SUPERINTENDENT. ALL TO REGULATORY AUTHORITY STANDARDS AND APPROVAL.
- THE CONTRACTOR SHALL ENSURE THAT AT ALL TIMES SERVICES TO ALL BUILDINGS NOT AFFECTED BY THE WORKS ARE NOT DISRUPTED.
- PRIOR TO COMMENCEMENT OF ANY WORKS THE CONTRACTOR SHALL OBTAIN THE SUPERINTENDENT'S APPROVAL FOR HIS PROGRAMME FOR THE RELOCATION/CONSTRUCTION OF TEMPORARY SERVICES.
- EXISTING BUILDINGS, EXTERNAL STRUCTURES, AND TREES SHOWN ON THESE DRAWINGS ARE FEATURES EXISTING PRIOR TO ANY SEPARATE AND PRECEDING DEMOLITION WORKS.
- CONTRACTOR SHALL CONSTRUCT TEMPORARY SERVICES TO MAINTAIN EXISTING SUPPLY TO BUILDINGS REMAINING IN OPERATION DURING WORKS TO THE SATISFACTION AND APPROVAL OF THE SUPERINTENDENT. ONCE DIVERSION IS COMPLETE AND COMMISSIONED THE CONTRACTOR SHALL REMOVE ALL SUCH TEMPORARY SERVICES AND MAKE GOOD TO THE SATISFACTION OF THE SUPERINTENDENT.
- INTERRUPTION TO SUPPLY OF EXISTING SERVICES SHALL BE DONE SO AS NOT TO CAUSE ANY INCONVENIENCE TO THE ADJACENT RESIDENCES. CONTRACTOR TO GAIN APPROVAL OF THE SUPERINTENDENT FOR TIME OF INTERRUPTION.

**STORMWATER**

- ALL 300 DIA. DRAINAGE PIPES AND LARGER SHALL BE CLASS "3" APPROVED SPIGOT AND SOCKET RCP PIPES WITH RUBBER RING JOINTS, (U.N.O.). ALL DRAINAGE PIPES UP TO AND INCLUDING 225 DIA. SHALL BE SEWER GRADE DWV uPVC CLASS "SN8" WITH SOLVENT WELD JOINTS OR RUBBER RING JOINTS (U.N.O.)
- EQUIVALENT STRENGTH FRC PIPES MAY BE USED.
- ALL PIPE JUNCTIONS UP TO AND INCLUDING 450 DIA. AND ALL TAPERS SHALL BE VIA PURPOSE MADE FITTINGS.
- MINIMUM GRADE TO STORMWATER LINES TO BE 1%. (U.N.O.)
- CONTRACTOR TO SUPPLY AND INSTALL ALL FITTINGS AND SPECIALS INCLUDING VARIOUS PIPE ADAPTORS TO ENSURE PROPER CONNECTION TO DISSIMILAR PIPEWORK.
- ALL CONNECTIONS TO EXISTING DRAINAGE PITS SHALL BE MADE IN A TRADESMAN-LIKE MANNER AND THE INTERNAL WALL OF THE PIT AT THE POINT OF ENTRY SHALL BE CEMENT RENDERED TO ENSURE A SMOOTH FINISH.
- WHERE SUBSOIL DRAINAGE LINES PASS UNDER FLOOR SLABS AND VEHICULAR PAVEMENTS UNSLOTTED uPVC SEWER GRADE PIPE SHALL BE USED.
- PROVIDE 3.0m LENGTH OF 100 DIA. SUBSOIL DRAINAGE PIPE WRAPPED IN FABRIC SOCK, AT UPSTREAM END OF EACH PIT.(UNO)
- BEDDING SHALL BE TYPE H1 (U.N.O.) IN ACCORDANCE WITH CURRENT AUSTRALIAN STANDARDS.
- AT CONNECTION TO PITS, INVERT OF SUBSOIL DRAINS TO BE ABOVE MAIN STORMWATER PIPE OBVERT.
- EQUIVALENT STRENGTH PRECAST STORMWATER PITS AND MANHOLES MAY BE USED.

**RETAINING WALLS**

- THE RETAINING WALL SYSTEM DESIGN IS TO BE UNDERTAKEN AS PART OF THE OPERATIONAL DESIGN WORKS PHASE (AND TO BE IN ACCORDANCE WITH THE ASSOCIATED GEOTECHNICAL SITE INVESTIGATION FINDINGS AND RECOMMENDATIONS).
- FORM 15 DESIGN CERTIFICATE & FORM 16 CERTIFICATION SIGNED BY A RPEQ IN A FORMAT ACCEPTABLE TO THE CERTIFIER SHALL BE PROVIDED WITH THE DESIGN AND CONSTRUCTION OF THE PROPOSED RETAINING WALL SYSTEM.
- PROPOSED TEMPORARY EXCAVATIONS FROM FACE OF RETAINING WALL SYSTEM SHALL NOT SIGNIFICANTLY IMPACT OR ENCROACH INTO ADJACENT CORRIDORS. SHOULD TEMPORARY OVER-EXCAVATION OCCUR, THIS DIMENSION SHALL BE MINIMISED (LIMITED TO 100mm MAXIMUM) WITH DISTURBED AREAS MADE GOOD TO REFLECT ORIGINAL SURFACE PROFILE AND NATURAL VEGETATE CONDITIONS.
- INFORMATION PRESENTED REGARDING THE PROPOSED RETAINING WALL SYSTEM IS CONCEPTUAL ONLY AND IS SUBJECT TO DEVELOPMENT APPROVAL CONDITIONS AND LOCAL GOVERNMENT AUTHORITY REQUIREMENTS.

S138 ROADS ACT 1993  
 DRIVEWAYS AND OTHER WORKS  
 ON PUBLIC ROADS  
 APPROVAL  
 APPROVAL NO DWY23/0070



COPYRIGHT of this design and plan is the property of ACOR Consultants (QLD) Pty Ltd, ACN 126 011 087 ABN 18 126 011 087, all rights reserved. It must not be used, modified, reproduced or copied wholly or in part without written permission from ACOR Consultants (QLD) Pty Ltd. ACOR Consultants is a trademark licensed to ACOR Consultants (QLD) Pty Ltd by ACOR Consultants Pty Ltd.

This drawing has been assigned an electronic code that signifies the drawing has been checked and approved by

Issue	Description	Date	Drawn	Approved
A	ISSUED FOR INFORMATION	15/12/22	MCG	ND
----	----	----	----	----
----	----	----	----	----
----	----	----	----	----
----	----	----	----	----
----	----	----	----	----
----	----	----	----	----
----	----	----	----	----
----	----	----	----	----
----	----	----	----	----

ISSUED FOR INFORMATION

Client

Project  
**KINGSCLIFF HIGH SCHOOL  
 STAGE 2 MAIN WORKS  
 (EXTERNAL CIVILS)**  
 33 OXFORD STREET  
 KINGSCLIFF NSW 2487

**ACOR Consultants (QLD) Pty Ltd**  
 Level 7, 22 Cordelia Street  
 South Brisbane QLD 4101  
 T +61 7 3844 5900

ENGINEERS | MANAGERS | INFRASTRUCTURE PLANNERS | DEVELOPMENT CONSULTANTS

Drawing Title  
**GENERAL NOTES**

Drawn	Date	Scale	Sheet Size	G.A. Check	Date
MCG	08/12/22	NTS	A1	ND	15/12/22
Designed	Project No.	Dwg. No.	Issue		
ND	BR210028	KPS-C20.11	A		

**EXISTING SERVICES NOTE:**

- NOTWITHSTANDING THAT EXISTING SERVICES MAY OR MAY NOT BE SHOWN ON THE DRAWINGS, NO RESPONSIBILITY IS TAKEN BY THE SUPERINTENDENT OR THE PRINCIPAL FOR THIS INFORMATION WHICH HAS BEEN SUPPLIED BY OTHERS. THE DETAILS ARE PROVIDED FOR INFORMATION ONLY. THE CONTRACTOR SHALL ASCERTAIN THE POSITION OF ANY UNDERGROUND SERVICES IN THIS AREA AND SHALL BE RESPONSIBLE FOR MAKING GOOD ANY DAMAGE CAUSED ON SITE.
- ALL REASONABLE CARE HAS BEEN TAKEN TO ACCURATELY SHOW THE POSITION OF EXISTING SERVICES. HOWEVER, THE POSITION OF SUCH SERVICES SHOULD BE PROVEN ON SITE AND NO GUARANTEE CAN BE GIVEN THAT ALL EXISTING SERVICES ARE SHOWN. AREAS SURROUNDING EXISTING SERVICES ARE TO BE EXCAVATED BY HAND OR BY APPROVED VACUUM EXCAVATION CONTRACTOR.
- CONTRACTOR TO CONFIRM THE LOCATION, SIZE AND DEPTH OF ALL EXISTING SERVICES PRIOR TO CONSTRUCTION.
- 3.1. WHERE REQUIRED, CONTRACTOR TO POTHOLE TO CONFIRM LOCATION AND DEPTHS OF ALL UNDERGROUND SERVICES PRIOR TO UNDERTAKING ANY WORKS.
- ALL EXISTING SERVICE STRUCTURES OR LIDS AFFECTED BY THE WORKS ARE TO BE ADJUSTED TO MATCH PROPOSED NEW SURFACE LEVELS.
- CONTRACTOR TO LIAISE WITH RELEVANT AUTHORITY ON ANY REQUIRED PROTECTION/RELOCATION MEASURES AND INFORM ENGINEER OF APPROVED DESIGN PRIOR TO UNDERTAKING ANY WORKS.

**LINEMARKING LEGEND**

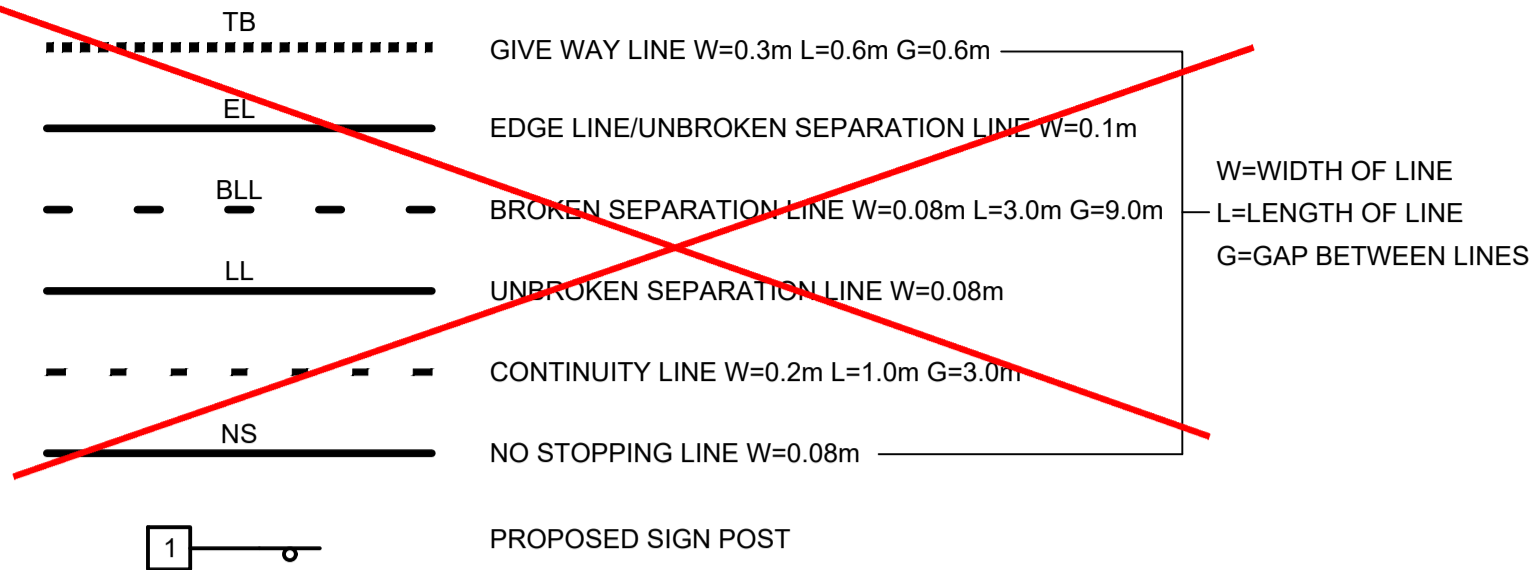

**SIGNAGE TABLE**

SIGN No.	SIGN NAMES	DESCRIPTION	NO. REQUIRED
1	R2-3L	KEEP LEFT	3
2	R1-2A	GIVE WAY	2

**EXISTING SERVICES LEGEND**

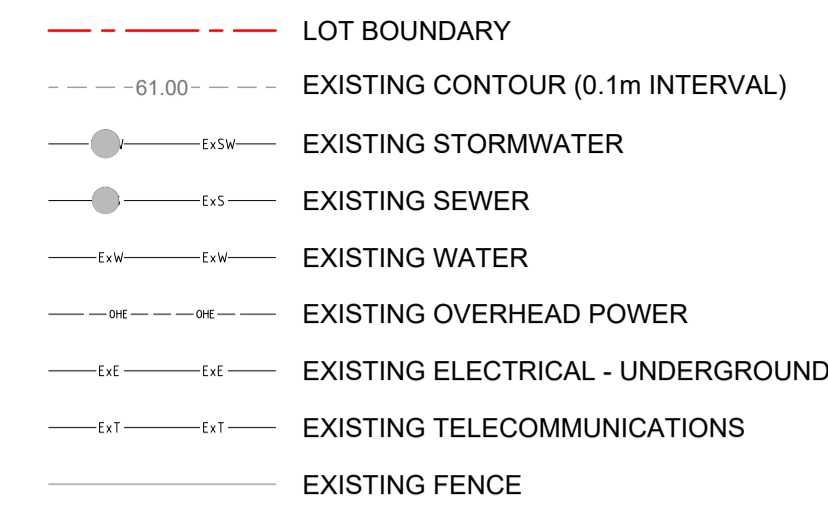

**LEGEND**

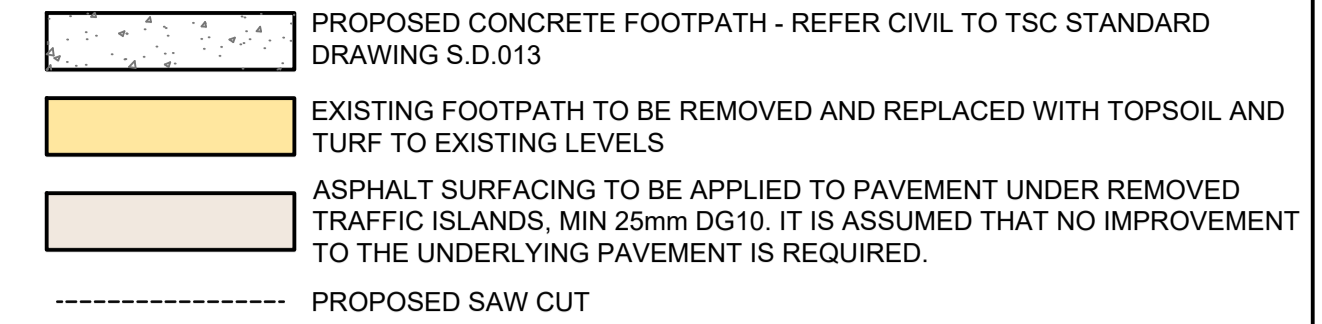

TREES WITHIN PRIVATE PROPERTY HAVE NOT BEEN IDENTIFIED IN THE DETAILED SURVEY. CONTRACTOR TO ENGAGE AN ARBORIST TO ENSURE PROPOSED WORKS WILL NOT NEGATIVELY IMPACT TREES LOCATED WITHIN THE VERGE AND WITHIN ADJACENT PRIVATE PROPERTIES.

S138 ROADS ACT 1993  
 DRIVEWAYS AND OTHER WORKS  
 ON PUBLIC ROADS  
 APPROVAL  
 APPROVAL NO DWY23/0070

**TWEED SHIRE COUNCIL**

**SIGNS AND LINEMARKING NOTES:**

- ALL LINEMARKING AND SIGNS SHALL BE IN ACCORDANCE WITH THE MANUAL OF UNIFORM TRAFFIC CONTROL DEVICES AND TSC STANDARDS
- TRAFFIC SIGN POSTS SHALL BE IN ACCORDANCE WITH TSC
- STREET NAME SIGNS SHALL BE IN ACCORDANCE WITH TSC
- ALL EXISTING SIGNS AND LINEMARKING TO REMAIN U.N.O.
- NOSES OF ALL ISLANDS SHALL BE PAINTED WITH WHITE RETROREFLECTIVE PAINT
- CONTRACTOR TO ENSURE SIGNS ARE CLEAR OF FUTURE DRIVEWAY LOCATIONS (I.E. LOCATE ON PROPERTY BOUNDARY OR MID BLOCK)

© COPYRIGHT of this design and plan is the property of ACOR Consultants (QLD) Pty Ltd, ACN 126 011 087 ABN 18 126 011 087, all rights reserved. It must not be used, modified, reproduced or copied wholly or in part without written permission from ACOR Consultants (QLD) Pty Ltd. ACOR Consultants is a trademark licensed to ACOR Consultants (QLD) Pty Ltd by ACOR Consultants Pty Ltd.

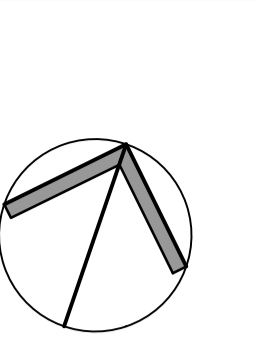

This drawing has been assigned an electronic code that signifies the drawing has been checked and approved by:

Issue	Description	Date	Drawn	Approved
A	FOR INFORMATION	15/12/22	MCG	ND
---	---	---	---	---
---	---	---	---	---
---	---	---	---	---
---	---	---	---	---

**ENGINEER'S CERTIFICATION**  
 This drawing has been assigned an electronic code that signifies the drawing has been checked and approved by:

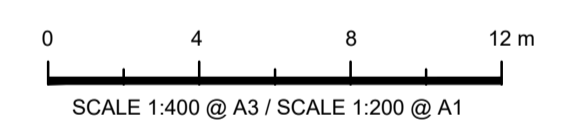
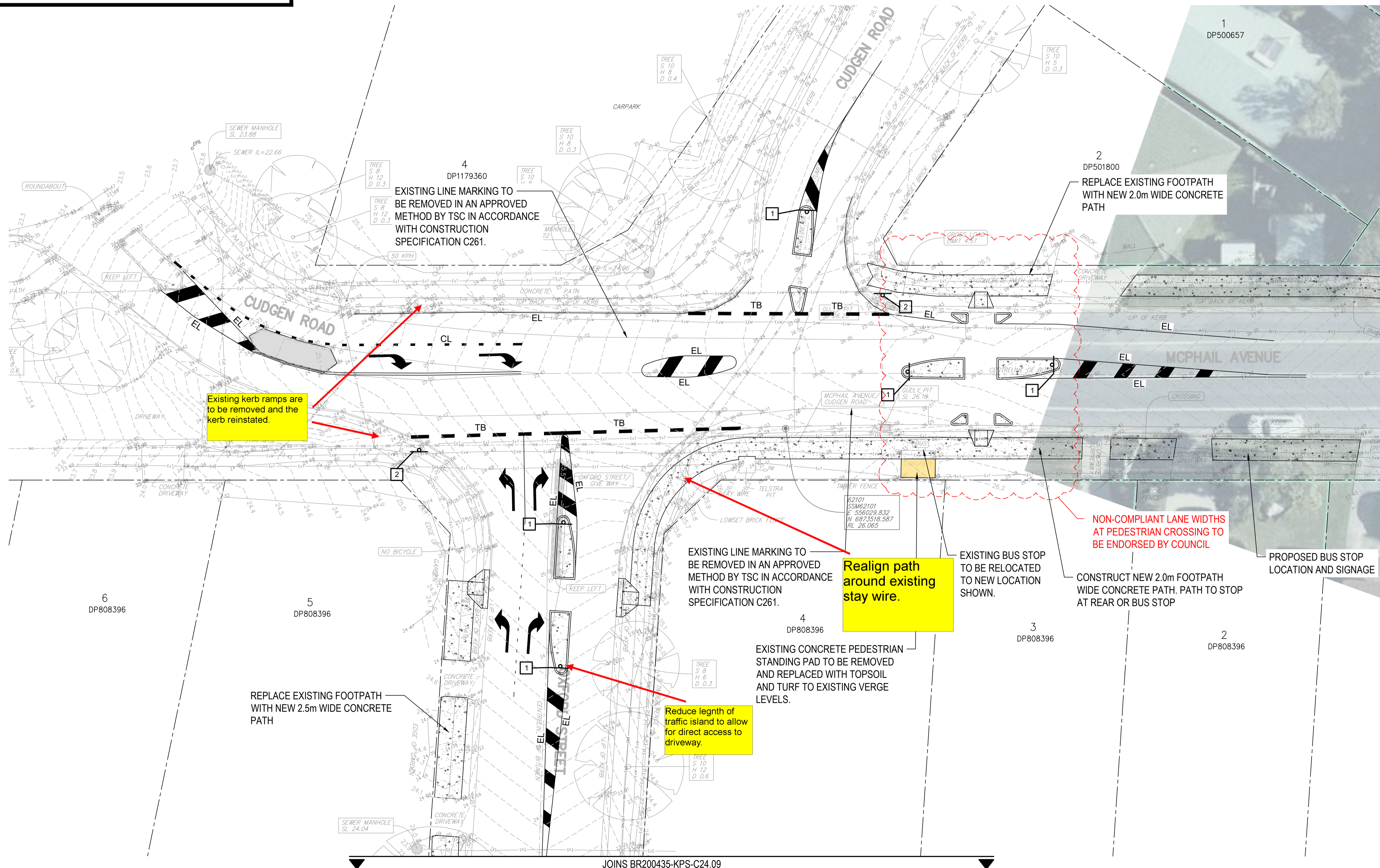

FOR INFORMATION

Client

Project  
**KINGSLIFF HIGH SCHOOL  
 STAGE 2 MAIN WORKS  
 (EXTERNAL CIVILS)**  
 33 OXFORD STREET  
 KINGSLIFF NSW 2487

**ACOR** CONSULTANTS (QLD) Pty Ltd  
 Level 7, 22 Cordelia Street  
 South Brisbane QLD 4101  
 T +61 7 3844 5900

ENGINEERS | MANAGERS | INFRASTRUCTURE PLANNERS | DEVELOPMENT CONSULTANTS

EXTERNAL SITE WORKS  
 LAYOUT PLAN  
 SHEET 1 OF 11

Drawn	Date	Scale	Sheet Size	C.A. Check	Date
MCG	08/12/22	1:200	A1	ND	15/12/22
Designed	Project No.	Dwg. No.	Issue		
ND	BR210028	KPS-C24.01	A		

JOINS BR200435-KPS-C24.02

C:\Users\mccg\OneDrive - ACOR Consultants (QLD) Pty Ltd\Desktop\BR210028\BR210028-KPS-C24.01.dwg

**EXISTING SERVICES NOTE:**

1. NOTWITHSTANDING THAT EXISTING SERVICES MAY OR MAY NOT BE SHOWN ON THE DRAWINGS, NO RESPONSIBILITY IS TAKEN BY THE SUPERINTENDENT OR THE PRINCIPAL FOR THIS INFORMATION WHICH HAS BEEN SUPPLIED BY OTHERS. THE DETAILS ARE PROVIDED FOR INFORMATION ONLY. THE CONTRACTOR SHALL ASCERTAIN THE POSITION OF ANY UNDERGROUND SERVICES IN THIS AREA AND SHALL BE RESPONSIBLE FOR MAKING GOOD ANY DAMAGE CAUSED ON SITE.
2. ALL REASONABLE CARE HAS BEEN TAKEN TO ACCURATELY SHOW THE POSITION OF EXISTING SERVICES. HOWEVER, THE POSITION OF SUCH SERVICES SHOULD BE PROVEN ON SITE AND NO GUARANTEE CAN BE GIVEN THAT ALL EXISTING SERVICES ARE SHOWN. AREAS SURROUNDING EXISTING SERVICES ARE TO BE EXCAVATED BY HAND OR BY APPROVED VACUUM EXCAVATION CONTRACTOR.
3. CONTRACTOR TO CONFIRM THE LOCATION, SIZE AND DEPTH OF ALL EXISTING SERVICES PRIOR TO CONSTRUCTION.
  - 3.1. WHERE REQUIRED, CONTRACTOR TO POTHOLE TO CONFIRM LOCATION AND DEPTHS OF ALL UNDERGROUND SERVICES PRIOR TO UNDERTAKING ANY WORKS.
4. ALL EXISTING SERVICE STRUCTURES OR LIDS AFFECTED BY THE WORKS ARE TO BE ADJUSTED TO MATCH PROPOSED NEW SURFACE LEVELS. CONTRACTOR TO LIAISE WITH RELEVANT AUTHORITY ON ANY REQUIRED PROTECTION/RELOCATION MEASURES AND INFORM ENGINEER OF APPROVED DESIGN PRIOR TO UNDERTAKING ANY WORKS.

TREES WITHIN PRIVATE PROPERTY HAVE NOT BEEN IDENTIFIED IN THE DETAILED SURVEY. CONTRACTOR TO ENGAGE AN ARBORIST TO ENSURE PROPOSED WORKS WILL NOT NEGATIVELY IMPACT TREES LOCATED WITHIN THE VERGE AND WITHIN ADJACENT PRIVATE PROPERTIES.

**EXISTING SERVICES LEGEND**

- LOT BOUNDARY
- - - - -81.00 - - - - - EXISTING CONTOUR (0.1m INTERVAL)
- EXISTING STORMWATER
- EXISTING SEWER
- EXISTING WATER
- EXISTING OVERHEAD POWER
- EXISTING ELECTRICAL - UNDERGROUND
- EXISTING TELECOMMUNICATIONS
- EXISTING FENCE

**LEGEND**

- PROPOSED CONCRETE FOOTPATH - REFER CIVIL TO TSC STANDARD DRAWING S.D.013
- EXISTING FOOTPATH TO BE REMOVED AND REPLACED WITH TOPSOIL AND TURF TO EXISTING LEVELS
- PROPOSED SAW CUT
- 100mm 'NO STOPPING' LINE - YELLOW PAINT IN ACCORDANCE WITH TSC CONSTRUCTION SPECIFICATION C261

S138 ROADS ACT 1993  
DRIVEWAYS AND OTHER WORKS  
ON PUBLIC ROADS  
APPROVAL  
APPROVAL NO DWY23/0070

**TWEED SHIRE COUNCIL**

© COPYRIGHT of this design and plan is the property of ACOR Consultants (QLD) Pty Ltd, ACN 126 011 087 ABN 18 126 011 087, all rights reserved. It must not be used, modified, reproduced or copied wholly or in part without written permission from ACOR Consultants (QLD) Pty Ltd. ACOR Consultants is a trademark licensed to ACOR Consultants (QLD) Pty Ltd by ACOR Consultants Pty Ltd.

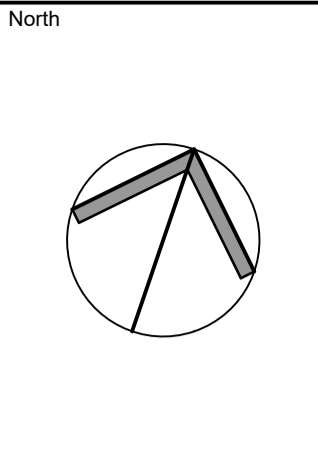

This drawing has been assigned an electronic code that signifies the drawing has been checked and approved by:

Issue	Description	Date	Drawn	Approved
A	FOR INFORMATION	15/12/22	MCG	ND
---	---	---	---	---
---	---	---	---	---
---	---	---	---	---
---	---	---	---	---
---	---	---	---	---
---	---	---	---	---
---	---	---	---	---
---	---	---	---	---
---	---	---	---	---
---	---	---	---	---

**ENGINEER'S CERTIFICATION**  
This drawing has been assigned an electronic code that signifies the drawing has been checked and approved by:

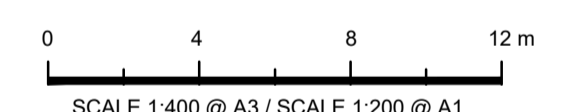

FOR INFORMATION

Client

115 DP241663

Project  
**KINGSLIFF HIGH SCHOOL  
STAGE 2 MAIN WORKS  
(EXTERNAL CIVILS)**  
33 OXFORD STREET  
KINGSLIFF NSW 2487

**ACOR Consultants (QLD) Pty Ltd**  
Level 7, 22 Cordelia Street  
South Brisbane QLD 4101  
T +61 7 3844 5900

**CONSULTANTS**  
ENGINEERS | MANAGERS | INFRASTRUCTURE PLANNERS | DEVELOPMENT CONSULTANTS

Drawing Title  
**EXTERNAL SITE WORKS  
LAYOUT PLAN  
SHEET 2 OF 11**

Drawn	Date	Scale	Sheet Size	O.A. Check	Date
MCG	08/12/22	1:200	A1	ND	15/12/22
Designed	Project No	Dwg. No.	Issue		
ND	BR210028	KPS-C24.02	A		

JOINS BR200435-KPS-C24.01

JOINS BR200435-KPS-C24.03

C:\Users\mccg\OneDrive\Work\Projects\Kingscliff\KPS-C24.02\KPS-C24.02.dwg 15/12/22 14:14



### EXISTING SERVICES NOTE:

- NOTWITHSTANDING THAT EXISTING SERVICES MAY OR MAY NOT BE SHOWN ON THE DRAWINGS, NO RESPONSIBILITY IS TAKEN BY THE SUPERINTENDENT OR THE PRINCIPAL FOR THIS INFORMATION WHICH HAS BEEN SUPPLIED BY OTHERS. THE DETAILS ARE PROVIDED FOR INFORMATION ONLY. THE CONTRACTOR SHALL ASCERTAIN THE POSITION OF ANY UNDERGROUND SERVICES IN THIS AREA AND SHALL BE RESPONSIBLE FOR MAKING GOOD ANY DAMAGE CAUSED ON SITE.
- ALL REASONABLE CARE HAS BEEN TAKEN TO ACCURATELY SHOW THE POSITION OF EXISTING SERVICES. HOWEVER, THE POSITION OF SUCH SERVICES SHOULD BE PROVEN ON SITE AND NO GUARANTEE CAN BE GIVEN THAT ALL EXISTING SERVICES ARE SHOWN. AREAS SURROUNDING EXISTING SERVICES ARE TO BE EXCAVATED BY HAND OR BY APPROVED VACUUM EXCAVATION CONTRACTOR.
- CONTRACTOR TO CONFIRM THE LOCATION, SIZE AND DEPTH OF ALL EXISTING SERVICES PRIOR TO CONSTRUCTION.
- WHERE REQUIRED, CONTRACTOR TO POTHOLE TO CONFIRM LOCATION AND DEPTHS OF ALL UNDERGROUND SERVICES PRIOR TO UNDERTAKING ANY WORKS.
- ALL EXISTING SERVICE STRUCTURES OR LIDS AFFECTED BY THE WORKS ARE TO BE ADJUSTED TO MATCH PROPOSED NEW SURFACE LEVELS. CONTRACTOR TO LIAISE WITH RELEVANT AUTHORITY ON ANY REQUIRED PROTECTION/RELOCATION MEASURES AND INFORM ENGINEER OF APPROVED DESIGN PRIOR TO UNDERTAKING ANY WORKS.

### LINEMARKING LEGEND

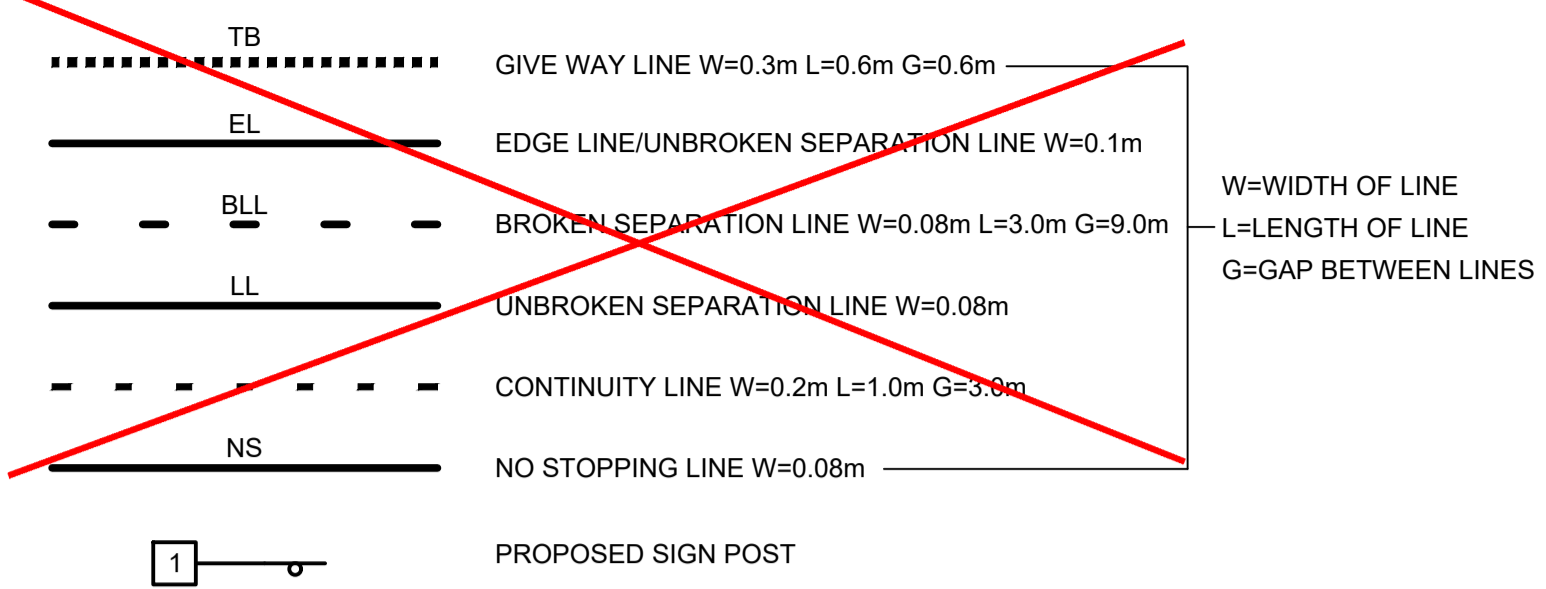

### SIGNAGE TABLE

SIGN No.	SIGN NAMES	DESCRIPTION	NO. REQUIRED
1	R2-3L	KEEP LEFT	2

### EXISTING SERVICES LEGEND

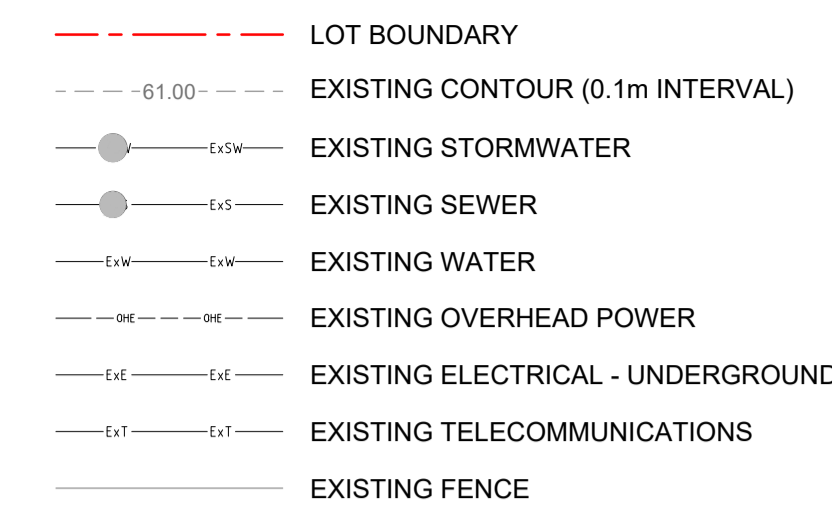

### LEGEND

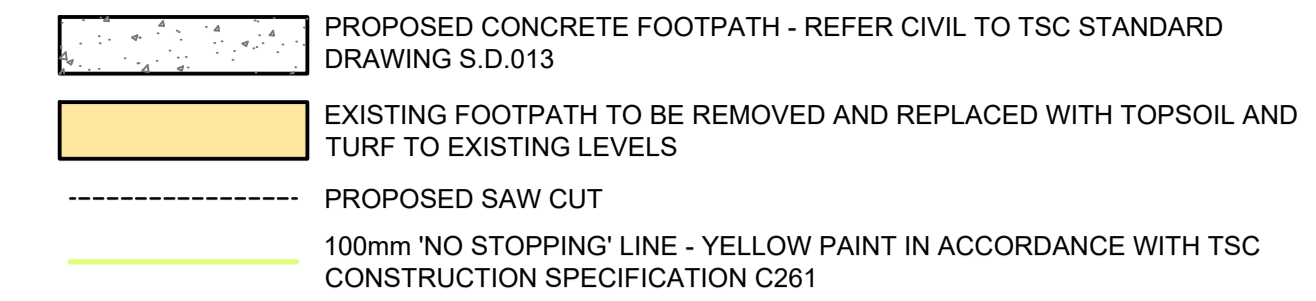

TREES WITHIN PRIVATE PROPERTY HAVE NOT BEEN IDENTIFIED IN THE DETAILED SURVEY. CONTRACTOR TO ENGAGE AN ARBORIST TO ENSURE PROPOSED WORKS WILL NOT NEGATIVELY IMPACT TREES LOCATED WITHIN THE VERGE AND WITHIN ADJACENT PRIVATE PROPERTIES.

S138 ROADS ACT 1993  
DRIVEWAYS AND OTHER WORKS  
ON PUBLIC ROADS  
APPROVAL  
APPROVAL NO DWY23/0070

TWEED SHIRE COUNCIL

© COPYRIGHT of this design and plan is the property of ACOR Consultants (QLD) Pty Ltd, ACN 126 011 087 ABN 18 126 011 087, all rights reserved. It must not be used, modified, reproduced or copied wholly or in part without written permission from ACOR Consultants (QLD) Pty Ltd. ACOR Consultants is a trademark licensed to ACOR Consultants (QLD) Pty Ltd by ACOR Consultants Pty Ltd.

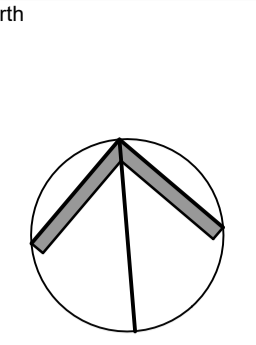

This drawing has been assigned an electronic code that signifies the drawing has been checked and approved by:

Issue	Description	Date	Drawn	Approved
A	FOR INFORMATION	15/12/22	MCG	ND
---	---	---	---	---
---	---	---	---	---
---	---	---	---	---
---	---	---	---	---
---	---	---	---	---
---	---	---	---	---
---	---	---	---	---
---	---	---	---	---
---	---	---	---	---
---	---	---	---	---

ENGINEER'S CERTIFICATION  
This drawing has been assigned an electronic code that signifies the drawing has been checked and approved by:



Client

Project  
KINGSLIFF HIGH SCHOOL  
STAGE 2 MAIN WORKS  
(EXTERNAL CIVILS)  
33 OXFORD STREET  
KINGSLIFF NSW 2487

ACOR CONSULTANTS (QLD) PTY LTD  
Level 7, 22 Cordelia Street  
South Brisbane QLD 4101  
T +61 7 3844 5900

ENGINEERS | MANAGERS | INFRASTRUCTURE PLANNERS | DEVELOPMENT CONSULTANTS  
Drawing Title  
EXTERNAL SITE WORKS  
LAYOUT PLAN  
SHEET 9 OF 11

Drawn	Date	Scale	Sheet Size	C.A. Check	Date
MCG	08/12/22	1:200	A1	ND	15/12/22
Designed	Project No.	Dwg. No.	Issue		
ND	BR210028	KPS-C24.09	A		

**EXISTING SERVICES NOTE:**

1. NOTWITHSTANDING THAT EXISTING SERVICES MAY OR MAY NOT BE SHOWN ON THE DRAWINGS, NO RESPONSIBILITY IS TAKEN BY THE SUPERINTENDENT OR THE PRINCIPAL FOR THIS INFORMATION WHICH HAS BEEN SUPPLIED BY OTHERS. THE DETAILS ARE PROVIDED FOR INFORMATION ONLY. THE CONTRACTOR SHALL ASCERTAIN THE POSITION OF ANY UNDERGROUND SERVICES IN THIS AREA AND SHALL BE RESPONSIBLE FOR MAKING GOOD ANY DAMAGE CAUSED ON SITE.
2. ALL REASONABLE CARE HAS BEEN TAKEN TO ACCURATELY SHOW THE POSITION OF EXISTING SERVICES. HOWEVER, THE POSITION OF SUCH SERVICES SHOULD BE PROVEN ON SITE AND NO GUARANTEE CAN BE GIVEN THAT ALL EXISTING SERVICES ARE SHOWN. AREAS SURROUNDING EXISTING SERVICES ARE TO BE EXCAVATED BY HAND OR BY APPROVED VACUUM EXCAVATION CONTRACTOR.
3. CONTRACTOR TO CONFIRM THE LOCATION, SIZE AND DEPTH OF ALL EXISTING SERVICES PRIOR TO CONSTRUCTION.
  - 3.1. WHERE REQUIRED, CONTRACTOR TO POTHOLE TO CONFIRM LOCATION AND DEPTHS OF ALL UNDERGROUND SERVICES PRIOR TO UNDERTAKING ANY WORKS.
4. ALL EXISTING SERVICE STRUCTURES OR LIDS AFFECTED BY THE WORKS ARE TO BE ADJUSTED TO MATCH PROPOSED NEW SURFACE LEVELS.
5. CONTRACTOR TO LAISE WITH RELEVANT AUTHORITY ON ANY REQUIRED PROTECTION/RELOCATION MEASURES AND INFORM ENGINEER OF APPROVED DESIGN PRIOR TO UNDERTAKING ANY WORKS.

**S138 ROADS ACT 1993  
DRIVEWAYS AND OTHER WORKS  
ON PUBLIC ROADS  
APPROVAL  
APPROVAL NO DWY23/0070**



**EXISTING SERVICES LEGEND**

- - - - - LOT BOUNDARY
- - - - -81.00- - - - - EXISTING CONTOUR (0.1m INTERVAL)
- EXISTING STORMWATER
- EXISTING SEWER
- EXISTING WATER
- EXISTING OVERHEAD POWER
- EXISTING ELECTRICAL - UNDERGROUND
- EXISTING TELECOMMUNICATIONS
- EXISTING FENCE

**LEGEND**

- PROPOSED CONCRETE FOOTPATH - REFER CIVIL TO TSC STANDARD DRAWING S.D.013
- EXISTING FOOTPATH TO BE REMOVED AND REPLACED WITH TOPSOIL AND TURF TO EXISTING LEVELS
- - - - - PROPOSED SAW CUT
- 100mm 'NO STOPPING' LINE - YELLOW PAINT IN ACCORDANCE WITH TSC CONSTRUCTION SPECIFICATION C261

TREES WITHIN PRIVATE PROPERTY HAVE NOT BEEN IDENTIFIED IN THE DETAILED SURVEY. CONTRACTOR TO ENGAGE AN ARBORIST TO ENSURE PROPOSED WORKS WILL NOT NEGATIVELY IMPACT TREES LOCATED WITHIN THE VERGE AND WITHIN ADJACENT PRIVATE PROPERTIES.

© COPYRIGHT of this design and plan is the property of ACOR Consultants (QLD) Pty Ltd, ACN 126 011 087 ABN 18 126 011 087, all rights reserved. It must not be used, modified, reproduced or copied wholly or in part without written permission from ACOR Consultants (QLD) Pty Ltd. ACOR Consultants is a trademark licensed to ACOR Consultants (QLD) Pty Ltd by ACOR Consultants Pty Ltd.

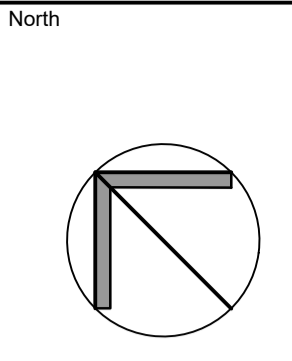

This drawing has been assigned an electronic code that signifies the drawing has been checked and approved by:

Issue	Description	Date	Drawn	Approved
A	FOR INFORMATION	15/12/22	MCG	ND
---	---	---	---	---
---	---	---	---	---
---	---	---	---	---
---	---	---	---	---

**ENGINEER'S CERTIFICATION**

This drawing has been assigned an electronic code that signifies the drawing has been checked and approved by:

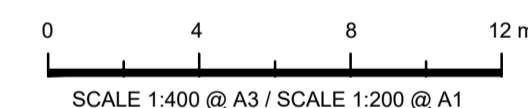

FOR INFORMATION

Client

**Project**  
KINGSLIFF HIGH SCHOOL  
STAGE 2 MAIN WORKS  
(EXTERNAL CIVILS)  
33 OXFORD STREET  
KINGSLIFF NSW 2487

**ACOR Consultants (QLD) Pty Ltd**  
Level 7, 22 Cordelia Street  
South Brisbane QLD 4101  
T +61 7 3844 5900

**CONSULTANTS**  
ENGINEERS | MANAGERS | INFRASTRUCTURE PLANNERS | DEVELOPMENT CONSULTANTS

Drawing Title  
**EXTERNAL SITE WORKS  
LAYOUT PLAN  
SHEET 10 OF 11**

Drawn	Date	Scale	Sheet Size	C.A. Check	Date
MCG	08/12/22	1:200	A1	ND	15/12/22
Designed	Project No.	Dwg. No.	Issue		
ND	BR210028	KPS-C24.10	A		

## EXISTING SERVICES NOTE:

1. NOTWITHSTANDING THAT EXISTING SERVICES MAY OR MAY NOT BE SHOWN ON THE DRAWINGS, NO RESPONSIBILITY IS TAKEN BY THE SUPERINTENDENT OR THE PRINCIPAL FOR THIS INFORMATION WHICH HAS BEEN SUPPLIED BY OTHERS. THE DETAILS ARE PROVIDED FOR INFORMATION ONLY. THE CONTRACTOR SHALL ASCERTAIN THE POSITION OF ANY UNDERGROUND SERVICES IN THIS AREA AND SHALL BE RESPONSIBLE FOR MAKING GOOD ANY DAMAGE CAUSED ON SITE.
2. ALL REASONABLE CARE HAS BEEN TAKEN TO ACCURATELY SHOW THE POSITION OF EXISTING SERVICES. HOWEVER, THE POSITION OF SUCH SERVICES SHOULD BE PROVEN ON SITE AND NO GUARANTEE CAN BE GIVEN THAT ALL EXISTING SERVICES ARE SHOWN. AREAS SURROUNDING EXISTING SERVICES ARE TO BE EXCAVATED BY HAND OR BY APPROVED VACUUM EXCAVATION CONTRACTOR.
3. CONTRACTOR TO CONFIRM THE LOCATION, SIZE AND DEPTH OF ALL EXISTING SERVICES PRIOR TO CONSTRUCTION.
  - 3.1. WHERE REQUIRED, CONTRACTOR TO POTHOLE TO CONFIRM LOCATION AND DEPTHS OF ALL UNDERGROUND SERVICES PRIOR TO UNDERTAKING ANY WORKS.
4. ALL EXISTING SERVICE STRUCTURES OR LIDS AFFECTED BY THE WORKS ARE TO BE ADJUSTED TO MATCH PROPOSED NEW SURFACE LEVELS.
5. CONTRACTOR TO LAISE WITH RELEVANT AUTHORITY ON ANY REQUIRED PROTECTION/RELOCATION MEASURES AND INFORM ENGINEER OF APPROVED DESIGN PRIOR TO UNDERTAKING ANY WORKS.

TREES WITHIN PRIVATE PROPERTY HAVE NOT BEEN IDENTIFIED IN THE DETAILED SURVEY. CONTRACTOR TO ENGAGE AN ARBORIST TO ENSURE PROPOSED WORKS WILL NOT NEGATIVELY IMPACT TREES LOCATED WITHIN THE VERGE AND WITHIN ADJACENT PRIVATE PROPERTIES.

All new paths are to be a minimum 1.5mts in width.

## EXISTING SERVICES LEGEND

- LOT BOUNDARY
- - - - -81.00--- EXISTING CONTOUR (0.1m INTERVAL)
- E15W EXISTING STORMWATER
- E15 EXISTING SEWER
- E1W E1W EXISTING WATER
- 0E---0E--- EXISTING OVERHEAD POWER
- E1E E1E EXISTING ELECTRICAL - UNDERGROUND
- E1T E1T EXISTING TELECOMMUNICATIONS
- EXISTING FENCE

## LEGEND

- PROPOSED CONCRETE FOOTPATH - REFER CIVIL TO TSC STANDARD DRAWING S.D.013
- EXISTING FOOTPATH TO BE REMOVED AND REPLACED WITH TOPSOIL AND TURF TO EXISTING LEVELS
- PROPOSED SAW CUT
- 100mm 'NO STOPPING' LINE - YELLOW PAINT IN ACCORDANCE WITH TSC CONSTRUCTION SPECIFICATION C261

S138 ROADS ACT 1993  
DRIVEWAYS AND OTHER WORKS  
ON PUBLIC ROADS  
APPROVAL  
APPROVAL NO DWY23/0070



© COPYRIGHT of this design and plan is the property of ACOR Consultants (QLD) Pty Ltd, ACN 126 011 087 ABN 18 126 011 087, all rights reserved. It must not be used, modified, reproduced or copied wholly or in part without written permission from ACOR Consultants (QLD) Pty Ltd. ACOR Consultants is a trademark licensed to ACOR Consultants (QLD) Pty Ltd by ACOR Consultants Pty Ltd.

North

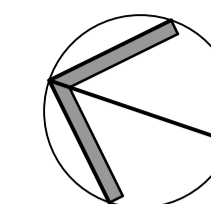

This drawing has been assigned an electronic code that signifies the drawing has been checked and approved by:

Issue	Description	Date	Drawn	Approved
A	FOR INFORMATION	15/12/22	MCG	ND
---	---	---	---	---
---	---	---	---	---
---	---	---	---	---
---	---	---	---	---
---	---	---	---	---
---	---	---	---	---
---	---	---	---	---
---	---	---	---	---
---	---	---	---	---
---	---	---	---	---
---	---	---	---	---
---	---	---	---	---
---	---	---	---	---

## ENGINEER'S CERTIFICATION

This drawing has been assigned an electronic code that signifies the drawing has been checked and approved by:

0 4 8 12 m  
SCALE 1:400 @ A3 / SCALE 1:200 @ A1

FOR INFORMATION

Client

Project  
KINGSLIFF HIGH SCHOOL  
STAGE 2 MAIN WORKS  
(EXTERNAL CIVILS)  
33 OXFORD STREET  
KINGSLIFF NSW 2487

**ACOR** Consultants (QLD) Pty Ltd  
Level 7, 22 Cordelia Street  
South Brisbane QLD 4101  
T +61 7 3844 5900

CONSULTANTS  
ENGINEERS | MANAGERS | INFRASTRUCTURE PLANNERS | DEVELOPMENT CONSULTANTS

Drawing Title  
EXTERNAL SITE WORKS  
LAYOUT PLAN  
SHEET 3 OF 11

Drawn	Date	Scale	Sheet Size	C.A. Check	Date
MCG	08/12/22	1:200	A1	ND	15/12/22
Designed	Project No	Dwg. No.	Issue		
ND	BR210028	KPS-C24.03	A		

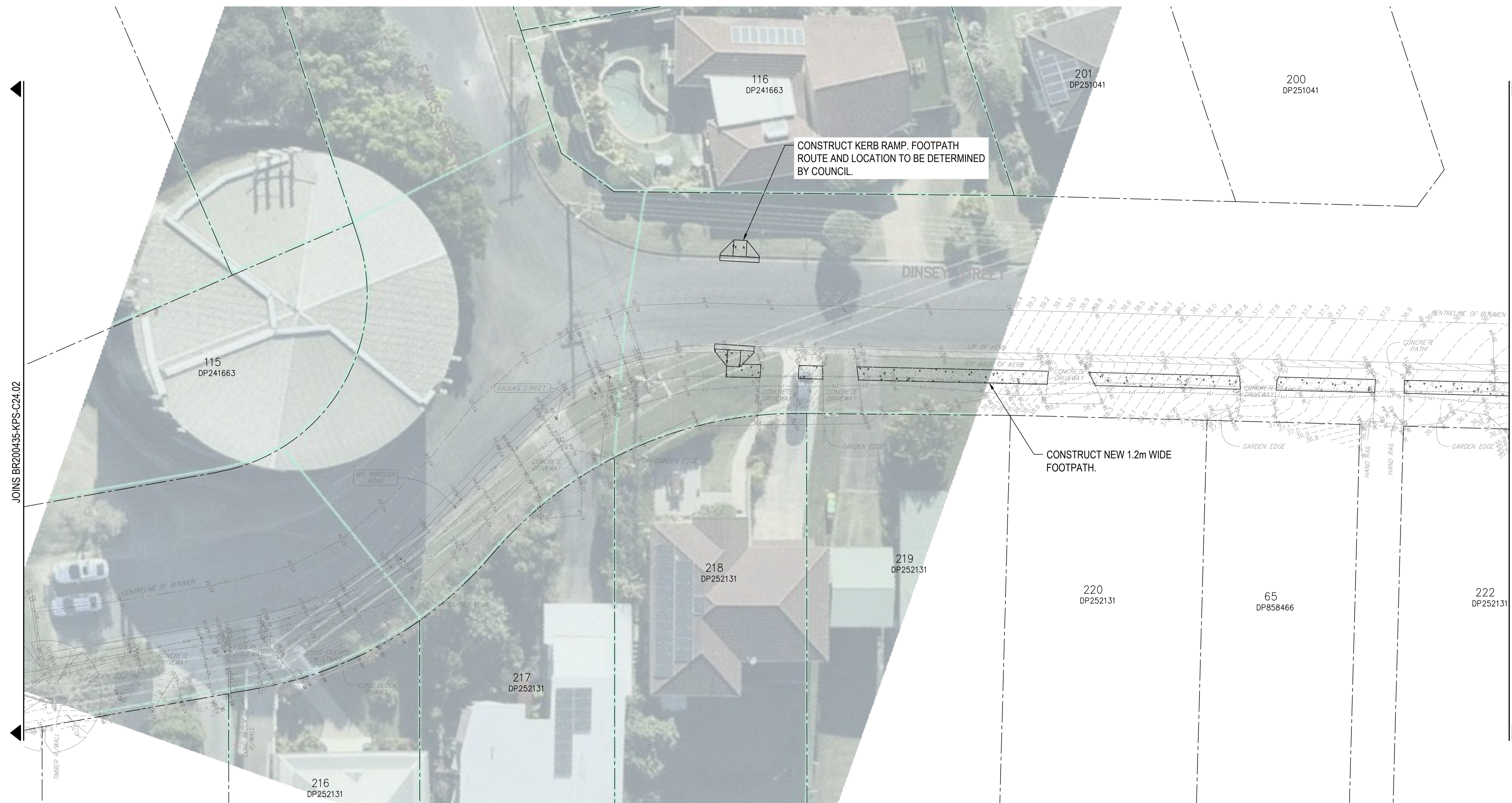

JOINS BR200435-KPS-C24.02

JOINS BR200435-KPS-C24.04

© Licensed under Creative Commons Attribution-NonCommercial-ShareAlike license. All rights reserved. ACOR Consultants (QLD) Pty Ltd. ACN 126 011 087 ABN 18 126 011 087. S:\Projects\BR210028\KPS-C24.03\KPS-C24.03.DWG

### EXISTING SERVICES NOTE:

1. NOTWITHSTANDING THAT EXISTING SERVICES MAY OR MAY NOT BE SHOWN ON THE DRAWINGS, NO RESPONSIBILITY IS TAKEN BY THE SUPERINTENDENT OR THE PRINCIPAL FOR THIS INFORMATION WHICH HAS BEEN SUPPLIED BY OTHERS. THE DETAILS ARE PROVIDED FOR INFORMATION ONLY. THE CONTRACTOR SHALL ASCERTAIN THE POSITION OF ANY UNDERGROUND SERVICES IN THIS AREA AND SHALL BE RESPONSIBLE FOR MAKING GOOD ANY DAMAGE CAUSED ON SITE.
2. ALL REASONABLE CARE HAS BEEN TAKEN TO ACCURATELY SHOW THE POSITION OF EXISTING SERVICES. HOWEVER, THE POSITION OF SUCH SERVICES SHOULD BE PROVEN ON SITE AND NO GUARANTEE CAN BE GIVEN THAT ALL EXISTING SERVICES ARE SHOWN. AREAS SURROUNDING EXISTING SERVICES ARE TO BE EXCAVATED BY HAND OR BY APPROVED VACUUM EXCAVATION CONTRACTOR.
3. CONTRACTOR TO CONFIRM THE LOCATION, SIZE AND DEPTH OF ALL EXISTING SERVICES PRIOR TO CONSTRUCTION.
- 3.1. WHERE REQUIRED, CONTRACTOR TO POTHOLE TO CONFIRM LOCATION AND DEPTHS OF ALL UNDERGROUND SERVICES PRIOR TO UNDERTAKING ANY WORKS.
4. ALL EXISTING SERVICE STRUCTURES OR LIDS AFFECTED BY THE WORKS ARE TO BE ADJUSTED TO MATCH PROPOSED NEW SURFACE LEVELS.
5. CONTRACTOR TO LAISE WITH RELEVANT AUTHORITY ON ANY REQUIRED PROTECTION/RELOCATION MEASURES AND INFORM ENGINEER OF APPROVED DESIGN PRIOR TO UNDERTAKING ANY WORKS.

TREES WITHIN PRIVATE PROPERTY HAVE NOT BEEN IDENTIFIED IN THE DETAILED SURVEY. CONTRACTOR TO ENGAGE AN ARBORIST TO ENSURE PROPOSED WORKS WILL NOT NEGATIVELY IMPACT TREES LOCATED WITHIN THE VERGE AND WITHIN ADJACENT PRIVATE PROPERTIES.

All new paths are to be a minimum 1.5mts in width.

### EXISTING SERVICES LEGEND

- LOT BOUNDARY
- - - - - EXISTING CONTOUR (0.1m INTERVAL)
- EXISTING STORMWATER
- EXISTING SEWER
- EXISTING WATER
- EXISTING OVERHEAD POWER
- EXISTING ELECTRICAL - UNDERGROUND
- EXISTING TELECOMMUNICATIONS
- EXISTING FENCE

### LEGEND

- ▬ PROPOSED CONCRETE FOOTPATH - REFER CIVIL TO TSC STANDARD DRAWING S.D.013
- ▬ EXISTING FOOTPATH TO BE REMOVED AND REPLACED WITH TOPSOIL AND TURF TO EXISTING LEVELS
- PROPOSED SAW CUT
- 100mm 'NO STOPPING' LINE - YELLOW PAINT IN ACCORDANCE WITH TSC CONSTRUCTION SPECIFICATION C261

S138 ROADS ACT 1993  
DRIVEWAYS AND OTHER WORKS  
ON PUBLIC ROADS  
APPROVAL  
APPROVAL NO DWY23/0070



© COPYRIGHT of this design and plan is the property of ACOR Consultants (QLD) Pty Ltd, ACN 126 011 087 ABN 18 126 011 087, all rights reserved. It must not be used, modified, reproduced or copied wholly or in part without written permission from ACOR Consultants (QLD) Pty Ltd. ACOR Consultants is a trademark licensed to ACOR Consultants (QLD) Pty Ltd by ACOR Consultants Pty Ltd.

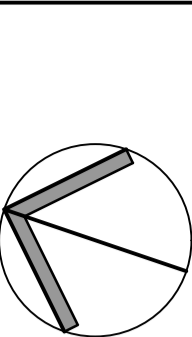

This drawing has been assigned an electronic code that signifies the drawing has been checked and approved by:

Issue	Description	Date	Drawn	Approved
A	FOR INFORMATION	15/12/22	MCG	ND
---	---	---	---	---
---	---	---	---	---
---	---	---	---	---
---	---	---	---	---
---	---	---	---	---
---	---	---	---	---
---	---	---	---	---
---	---	---	---	---
---	---	---	---	---

ENGINEER'S CERTIFICATION  
This drawing has been assigned an electronic code that signifies the drawing has been checked and approved by:

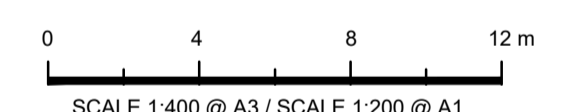
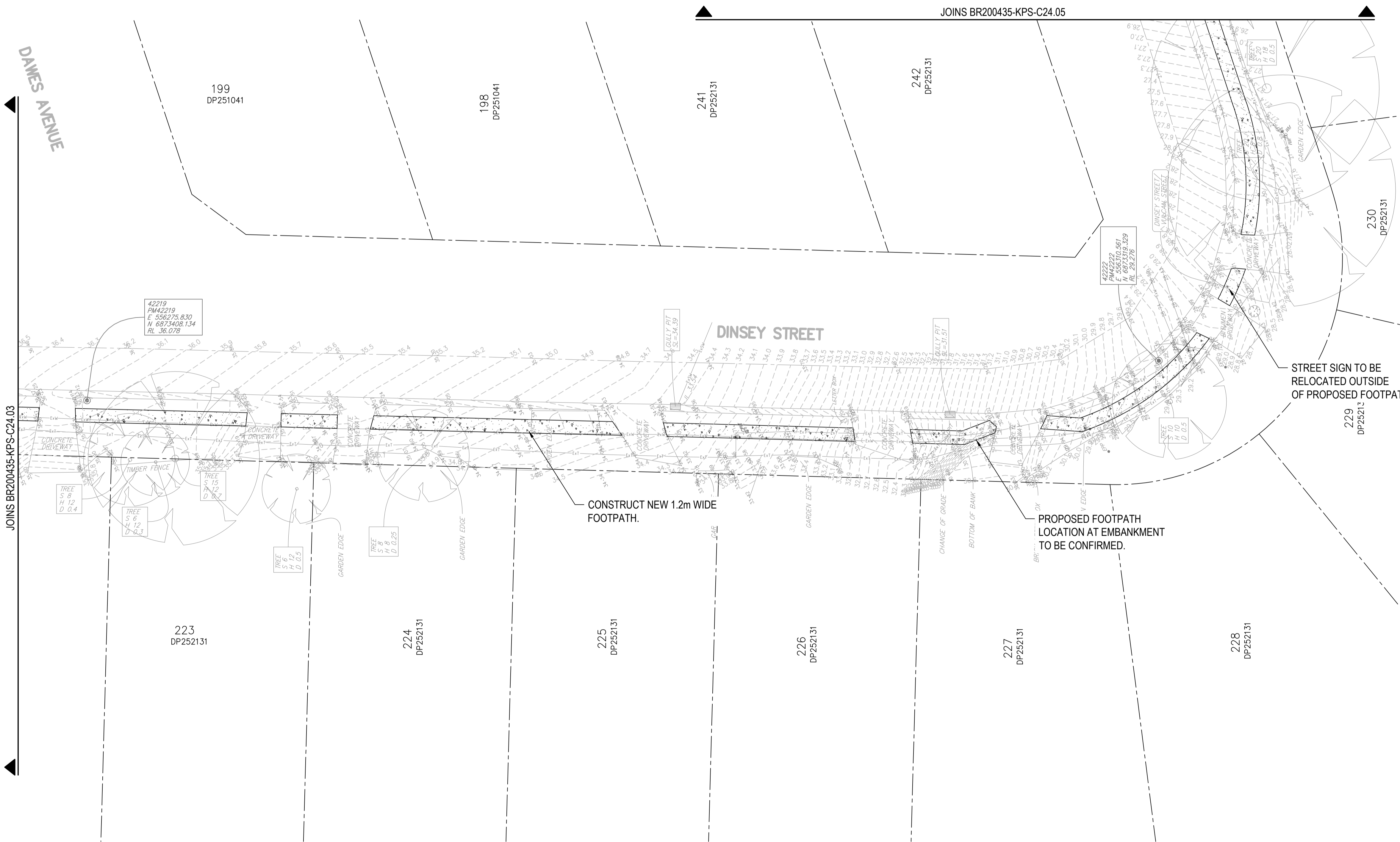

SCALE 1:400 @ A3 / SCALE 1:200 @ A1

FOR INFORMATION

Client

Project  
**KINGSLIFF HIGH SCHOOL  
STAGE 2 MAIN WORKS  
(EXTERNAL CIVILS)**  
33 OXFORD STREET  
KINGSLIFF NSW 2487

**ACOR** CONSULTANTS  
ACOR Consultants (QLD) Pty Ltd  
Level 7, 22 Cordelia Street  
South Brisbane QLD 4101  
T +61 7 3844 5900  
CONSULTANTS

ENGINEERS | MANAGERS | INFRASTRUCTURE PLANNERS | DEVELOPMENT CONSULTANTS  
Drawing Title  
EXTERNAL SITE WORKS  
LAYOUT PLAN  
SHEET 4 OF 11

Drawn	Date	Scale	Sheet Size	C.A. Check	Date
MCG	08/12/22	1:200	A1	ND	15/12/22
Designed	Project No	Dwg. No.	Issue		
ND	BR210028	KPS-C24.04	A		

© Licensed under Creative Commons License: CC BY-NC-SA. All Rights Reserved.

**EXISTING SERVICES NOTE:**

1. NOTWITHSTANDING THAT EXISTING SERVICES MAY OR MAY NOT BE SHOWN ON THE DRAWINGS, NO RESPONSIBILITY IS TAKEN BY THE SUPERINTENDENT OR THE PRINCIPAL FOR THIS INFORMATION WHICH HAS BEEN SUPPLIED BY OTHERS. THE DETAILS ARE PROVIDED FOR INFORMATION ONLY. THE CONTRACTOR SHALL ASCERTAIN THE POSITION OF ANY UNDERGROUND SERVICES IN THIS AREA AND SHALL BE RESPONSIBLE FOR MAKING GOOD ANY DAMAGE CAUSED ON SITE.
2. ALL REASONABLE CARE HAS BEEN TAKEN TO ACCURATELY SHOW THE POSITION OF EXISTING SERVICES. HOWEVER, THE POSITION OF SUCH SERVICES SHOULD BE PROVEN ON SITE AND NO GUARANTEE CAN BE GIVEN THAT ALL EXISTING SERVICES ARE SHOWN. AREAS SURROUNDING EXISTING SERVICES ARE TO BE EXCAVATED BY HAND OR BY APPROVED VACUUM EXCAVATION CONTRACTOR.
3. CONTRACTOR TO CONFIRM THE LOCATION, SIZE AND DEPTH OF ALL EXISTING SERVICES PRIOR TO CONSTRUCTION.
  - 3.1. WHERE REQUIRED, CONTRACTOR TO POTHOLE TO CONFIRM LOCATION AND DEPTHS OF ALL UNDERGROUND SERVICES PRIOR TO UNDERTAKING ANY WORKS.
4. ALL EXISTING SERVICE STRUCTURES OR LIDS AFFECTED BY THE WORKS ARE TO BE ADJUSTED TO MATCH PROPOSED NEW SURFACE LEVELS.
5. CONTRACTOR TO LAISE WITH RELEVANT AUTHORITY ON ANY REQUIRED PROTECTION/RELOCATION MEASURES AND INFORM ENGINEER OF APPROVED DESIGN PRIOR TO UNDERTAKING ANY WORKS.

All new paths are to be a minimum 1.5mts in width.

TREES WITHIN PRIVATE PROPERTY HAVE NOT BEEN IDENTIFIED IN THE DETAILED SURVEY. CONTRACTOR TO ENGAGE AN ARBORIST TO ENSURE PROPOSED WORKS WILL NOT NEGATIVELY IMPACT TREES LOCATED WITHIN THE VERGE AND WITHIN ADJACENT PRIVATE PROPERTIES.

**EXISTING SERVICES LEGEND**

- - - - - LOT BOUNDARY
- - - - - EXISTING CONTOUR (0.1m INTERVAL)
- - - - EXISTING STORMWATER
- - - - EXISTING SEWER
- EXISTING WATER
- EXISTING OVERHEAD POWER
- EXISTING ELECTRICAL - UNDERGROUND
- EXISTING TELECOMMUNICATIONS
- EXISTING FENCE

**LEGEND**

- PROPOSED CONCRETE FOOTPATH - REFER CIVIL TO TSC STANDARD DRAWING S.D.013
- EXISTING FOOTPATH TO BE REMOVED AND REPLACED WITH TOPSOIL AND TURF TO EXISTING LEVELS
- - - - - PROPOSED SAW CUT
- 100mm 'NO STOPPING' LINE - YELLOW PAINT IN ACCORDANCE WITH TSC CONSTRUCTION SPECIFICATION C261

© COPYRIGHT of this design and plan is the property of ACOR Consultants (QLD) Pty Ltd, ACN 126 011 087 ABN 18 126 011 087, all rights reserved. It must not be used, modified, reproduced or copied wholly or in part without written permission from ACOR Consultants (QLD) Pty Ltd. ACOR Consultants is a trademark licensed to ACOR Consultants (QLD) Pty Ltd by ACOR Consultants Pty Ltd.

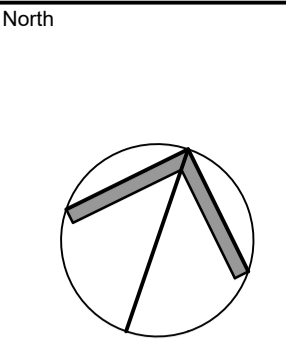

This drawing has been assigned an electronic code that signifies the drawing has been checked and approved by:

Issue	Description	Date	Drawn	Approved
A	FOR INFORMATION	15/12/22	MCG	ND
---	---	---	---	---
---	---	---	---	---
---	---	---	---	---
---	---	---	---	---
---	---	---	---	---
---	---	---	---	---
---	---	---	---	---
---	---	---	---	---
---	---	---	---	---
---	---	---	---	---
---	---	---	---	---
---	---	---	---	---
---	---	---	---	---
---	---	---	---	---
---	---	---	---	---
---	---	---	---	---
---	---	---	---	---

**ENGINEER'S CERTIFICATION**

This drawing has been assigned an electronic code that signifies the drawing has been checked and approved by:

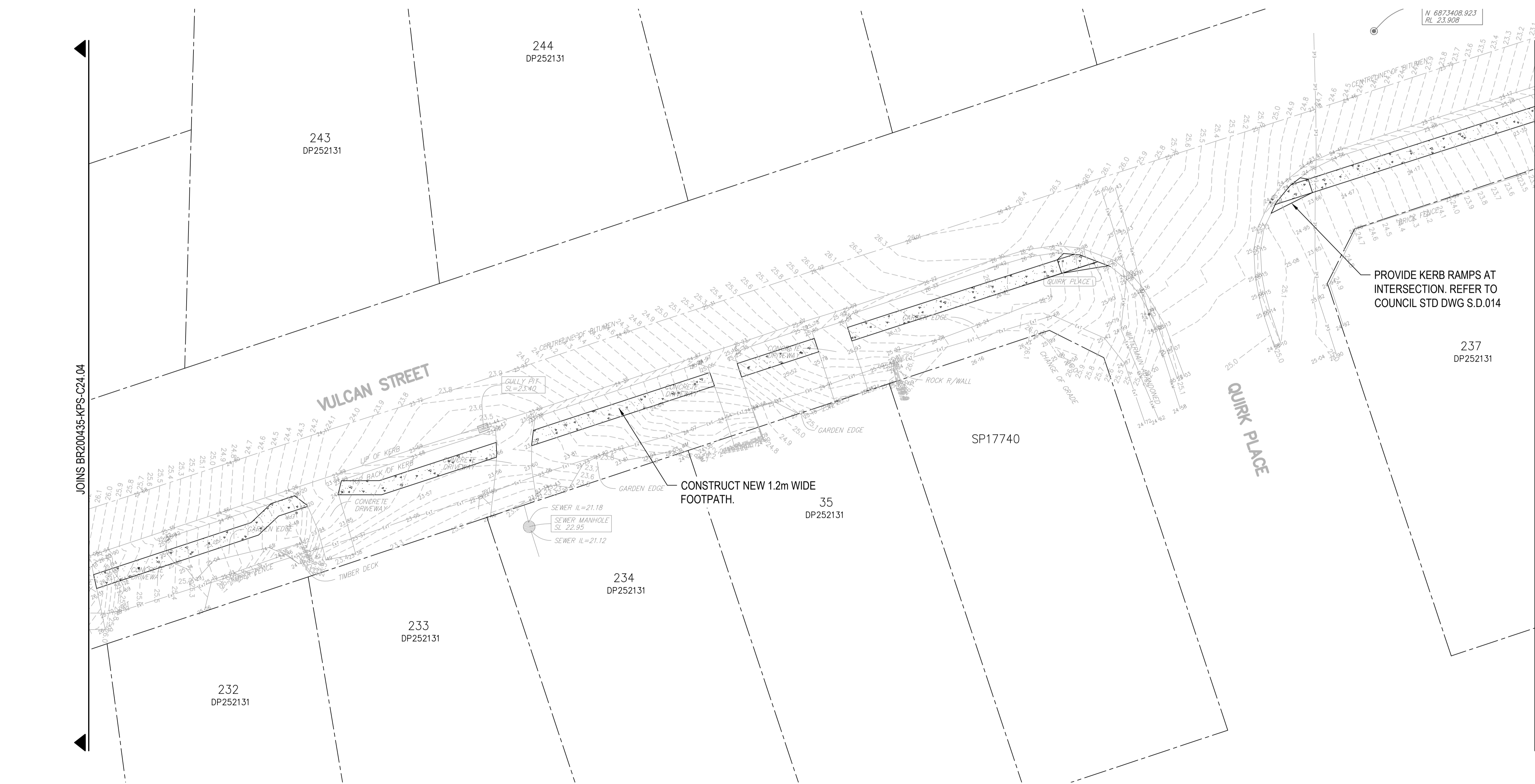

S138 ROADS ACT 1993  
DRIVEWAYS AND OTHER WORKS  
ON PUBLIC ROADS  
APPROVAL  
APPROVAL NO DWY23/0070  
**TWEED SHIRE COUNCIL**

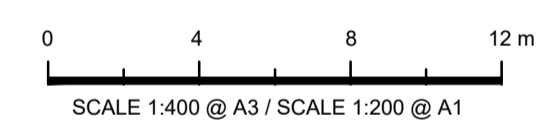

FOR INFORMATION

Client

Project  
**KINGSCLIFF HIGH SCHOOL  
STAGE 2 MAIN WORKS  
(EXTERNAL CIVILS)**  
33 OXFORD STREET  
KINGSCLIFF NSW 2487

**ACOR Consultants (QLD) Pty Ltd**  
Level 7, 22 Cordelia Street  
South Brisbane QLD 4101  
T +61 7 3844 5900

CONSULTANTS  
ENGINEERS | MANAGERS | INFRASTRUCTURE PLANNERS | DEVELOPMENT CONSULTANTS

Drawing Title  
**EXTERNAL SITE WORKS  
LAYOUT PLAN  
SHEET 5 OF 11**

Drawn	Date	Scale	Sheet Size	C.A. Check	Date
MCG	08/12/22	1:200	A1	ND	15/12/22
Designed	Project No	Dwg. No.	Issue		
ND	BR210028	KPS-C24.05	A		

**EXISTING SERVICES NOTE:**

1. NOTWITHSTANDING THAT EXISTING SERVICES MAY OR MAY NOT BE SHOWN ON THE DRAWINGS, NO RESPONSIBILITY IS TAKEN BY THE SUPERINTENDENT OR THE PRINCIPAL FOR THIS INFORMATION WHICH HAS BEEN SUPPLIED BY OTHERS. THE DETAILS ARE PROVIDED FOR INFORMATION ONLY. THE CONTRACTOR SHALL ASCERTAIN THE POSITION OF ANY UNDERGROUND SERVICES IN THIS AREA AND SHALL BE RESPONSIBLE FOR MAKING GOOD ANY DAMAGE CAUSED ON SITE.
2. ALL REASONABLE CARE HAS BEEN TAKEN TO ACCURATELY SHOW THE POSITION OF EXISTING SERVICES. HOWEVER, THE POSITION OF SUCH SERVICES SHOULD BE PROVEN ON SITE AND NO GUARANTEE CAN BE GIVEN THAT ALL EXISTING SERVICES ARE SHOWN. AREAS SURROUNDING EXISTING SERVICES ARE TO BE EXCAVATED BY HAND OR BY APPROVED VACUUM EXCAVATION CONTRACTOR.
3. CONTRACTOR TO CONFIRM THE LOCATION, SIZE AND DEPTH OF ALL EXISTING SERVICES PRIOR TO CONSTRUCTION.
  - 3.1. WHERE REQUIRED, CONTRACTOR TO POTHOLE TO CONFIRM LOCATION AND DEPTHS OF ALL UNDERGROUND SERVICES PRIOR TO UNDERTAKING ANY WORKS.
4. ALL EXISTING SERVICE STRUCTURES OR LIDS AFFECTED BY THE WORKS ARE TO BE ADJUSTED TO MATCH PROPOSED NEW SURFACE LEVELS.
5. CONTRACTOR TO LIAISE WITH RELEVANT AUTHORITY ON ANY REQUIRED PROTECTION/RELOCATION MEASURES AND INFORM ENGINEER OF APPROVED DESIGN PRIOR TO UNDERTAKING ANY WORKS.

TREES WITHIN PRIVATE PROPERTY HAVE NOT BEEN IDENTIFIED IN THE DETAILED SURVEY. CONTRACTOR TO ENGAGE AN ARBORIST TO ENSURE PROPOSED WORKS WILL NOT NEGATIVELY IMPACT TREES LOCATED WITHIN THE VERGE AND WITHIN ADJACENT PRIVATE PROPERTIES.

All new paths are to be a minimum 1.5mts in width.

**EXISTING SERVICES LEGEND**

- LOT BOUNDARY
- - - - -81.00--- EXISTING CONTOUR (0.1m INTERVAL)
- E15W EXISTING STORMWATER
- E15 EXISTING SEWER
- E1W-E1W EXISTING WATER
- - - - -9E--- EXISTING OVERHEAD POWER
- E1E-E1E EXISTING ELECTRICAL - UNDERGROUND
- - - - -1T--- EXISTING TELECOMMUNICATIONS
- EXISTING FENCE

**LEGEND**

- PROPOSED CONCRETE FOOTPATH - REFER CIVIL TO TSC STANDARD DRAWING S.D.013
- EXISTING FOOTPATH TO BE REMOVED AND REPLACED WITH TOPSOIL AND TURF TO EXISTING LEVELS
- - - - - PROPOSED SAW CUT
- 100mm 'NO STOPPING' LINE - YELLOW PAINT IN ACCORDANCE WITH TSC CONSTRUCTION SPECIFICATION C261

S138 ROADS ACT 1993  
DRIVEWAYS AND OTHER WORKS  
ON PUBLIC ROADS  
APPROVAL  
APPROVAL NO DWY23/0070  
**TWEED SHIRE COUNCIL**

© COPYRIGHT of this design and plan is the property of ACOR Consultants (QLD) Pty Ltd, ACN 126 011 087 ABN 18 126 011 087, all rights reserved. It must not be used, modified, reproduced or copied wholly or in part without written permission from ACOR Consultants (QLD) Pty Ltd. ACOR Consultants is a trademark licensed to ACOR Consultants (QLD) Pty Ltd by ACOR Consultants Pty Ltd.

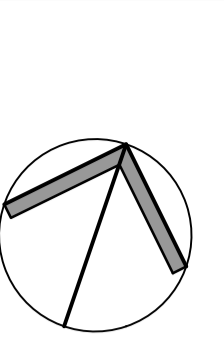

This drawing has been assigned an electronic code that signifies the drawing has been checked and approved by:

Issue	Description	Date	Drawn	Approved
A	FOR INFORMATION	15/12/22	MCG	ND
---	---	---	---	---
---	---	---	---	---
---	---	---	---	---
---	---	---	---	---
---	---	---	---	---
---	---	---	---	---
---	---	---	---	---
---	---	---	---	---
---	---	---	---	---

**ENGINEER'S CERTIFICATION**  
This drawing has been assigned an electronic code that signifies the drawing has been checked and approved by:

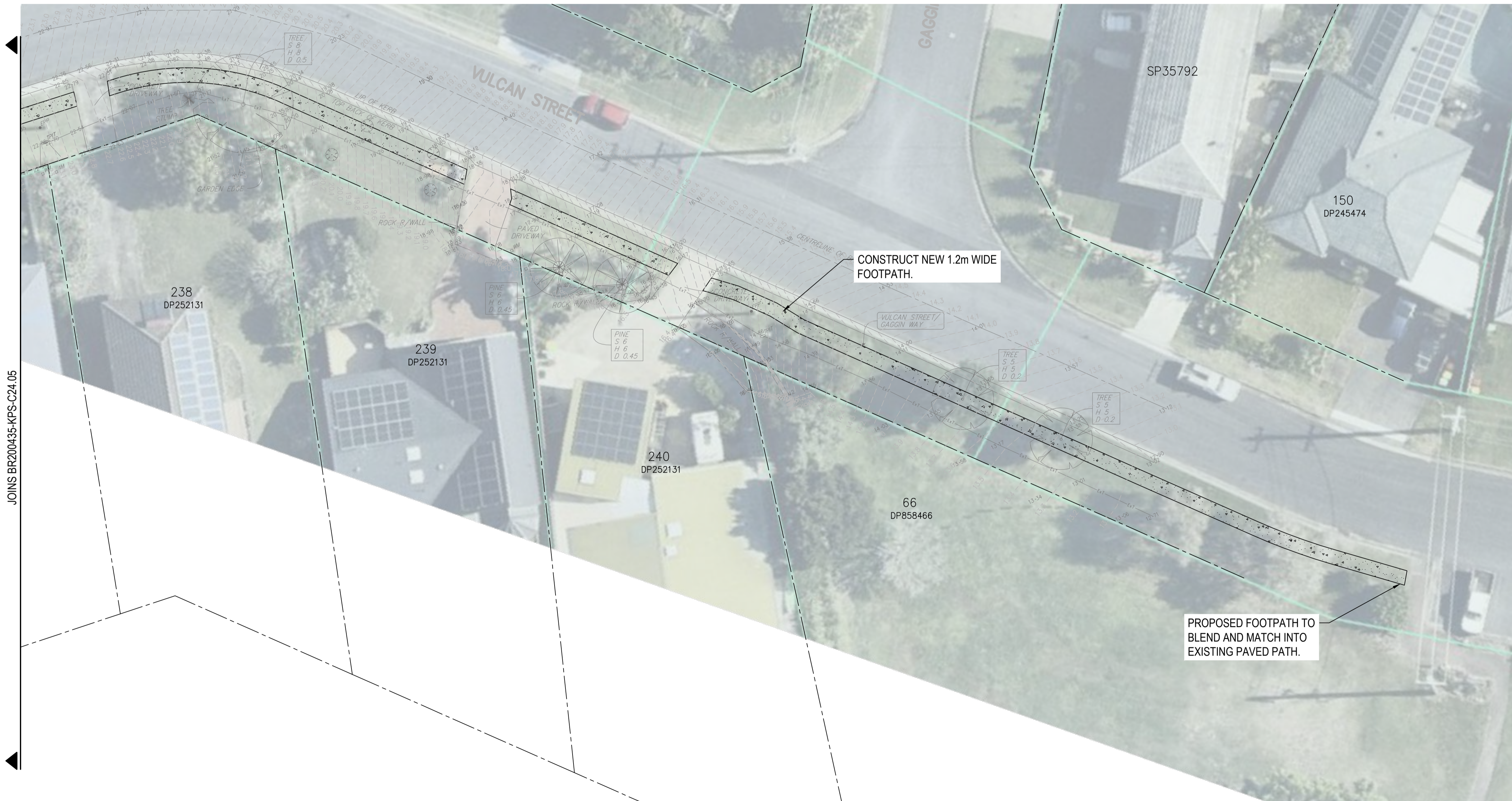

JOINS BR200435-KPS-C24.05



FOR INFORMATION

Client

Project  
**KINGSLIFF HIGH SCHOOL  
STAGE 2 MAIN WORKS  
(EXTERNAL CIVILS)**  
33 OXFORD STREET  
KINGSLIFF NSW 2487

**ACOR** **ACOR Consultants (QLD) Pty Ltd**  
Level 7, 22 Cordelia Street  
South Brisbane QLD 4101  
T +61 7 3844 5900

CONSULTANTS  
ENGINEERS | MANAGERS | INFRASTRUCTURE PLANNERS | DEVELOPMENT CONSULTANTS  
Drawing Title  
**EXTERNAL SITE WORKS  
LAYOUT PLAN  
SHEET 6 OF 11**

Drawn	Date	Scale	Sheet Size	O.A. Check	Date
MCG	08/12/22	1:200	A1	ND	15/12/22
Designed	Project No	Dwg. No.	Issue		
ND	BR210028	KPS-C24.06	A		

**EXISTING SERVICES NOTE:**

1. NOTWITHSTANDING THAT EXISTING SERVICES MAY OR MAY NOT BE SHOWN ON THE DRAWINGS, NO RESPONSIBILITY IS TAKEN BY THE SUPERINTENDENT OR THE PRINCIPAL FOR THIS INFORMATION WHICH HAS BEEN SUPPLIED BY OTHERS. THE DETAILS ARE PROVIDED FOR INFORMATION ONLY. THE CONTRACTOR SHALL ASCERTAIN THE POSITION OF ANY UNDERGROUND SERVICES IN THIS AREA AND SHALL BE RESPONSIBLE FOR MAKING GOOD ANY DAMAGE CAUSED ON SITE.
2. ALL REASONABLE CARE HAS BEEN TAKEN TO ACCURATELY SHOW THE POSITION OF EXISTING SERVICES. HOWEVER, THE POSITION OF SUCH SERVICES SHOULD BE PROVEN ON SITE AND NO GUARANTEE CAN BE GIVEN THAT ALL EXISTING SERVICES ARE SHOWN. AREAS SURROUNDING EXISTING SERVICES ARE TO BE EXCAVATED BY HAND OR BY APPROVED VACUUM EXCAVATION CONTRACTOR.
3. CONTRACTOR TO CONFIRM THE LOCATION, SIZE AND DEPTH OF ALL EXISTING SERVICES PRIOR TO CONSTRUCTION.
  - 3.1. WHERE REQUIRED, CONTRACTOR TO POTHOLE TO CONFIRM LOCATION AND DEPTHS OF ALL UNDERGROUND SERVICES PRIOR TO UNDERTAKING ANY WORKS.
4. ALL EXISTING SERVICE STRUCTURES OR LIDS AFFECTED BY THE WORKS ARE TO BE ADJUSTED TO MATCH PROPOSED NEW SURFACE LEVELS.
5. CONTRACTOR TO LAISE WITH RELEVANT AUTHORITY ON ANY REQUIRED PROTECTION/RELOCATION MEASURES AND INFORM ENGINEER OF APPROVED DESIGN PRIOR TO UNDERTAKING ANY WORKS.

TREES WITHIN PRIVATE PROPERTY HAVE NOT BEEN IDENTIFIED IN THE DETAILED SURVEY. CONTRACTOR TO ENGAGE AN ARBORIST TO ENSURE PROPOSED WORKS WILL NOT NEGATIVELY IMPACT TREES LOCATED WITHIN THE VERGE AND WITHIN ADJACENT PRIVATE PROPERTIES.

All new paths are to be a minimum 1.5mts in width.

**EXISTING SERVICES LEGEND**

- LOT BOUNDARY
- - - 0.1m INTERVAL EXISTING CONTOUR (0.1m INTERVAL)
- EXISTING STORMWATER
- EXISTING SEWER
- EXISTING WATER
- EXISTING OVERHEAD POWER
- EXISTING ELECTRICAL - UNDERGROUND
- EXISTING TELECOMMUNICATIONS
- EXISTING FENCE

**LEGEND**

- [Pattern] PROPOSED CONCRETE FOOTPATH - REFER CIVIL TO TSC STANDARD DRAWING S.D.013
- [Pattern] EXISTING FOOTPATH TO BE REMOVED AND REPLACED WITH TOPSOIL AND TURF TO EXISTING LEVELS
- PROPOSED SAW CUT
- 100mm 'NO STOPPING' LINE - YELLOW PAINT IN ACCORDANCE WITH TSC CONSTRUCTION SPECIFICATION C261

S138 ROADS ACT 1993  
DRIVEWAYS AND OTHER WORKS  
ON PUBLIC ROADS  
APPROVAL  
APPROVAL NO DWY23/0070  
**TWEEED SHIRE COUNCIL**

© COPYRIGHT of this design and plan is the property of ACOR Consultants (QLD) Pty Ltd, ACN 126 011 087 ABN 18 126 011 087, all rights reserved. It must not be used, modified, reproduced or copied wholly or in part without written permission from ACOR Consultants (QLD) Pty Ltd. ACOR Consultants is a trademark licensed to ACOR Consultants (QLD) Pty Ltd by ACOR Consultants Pty Ltd.

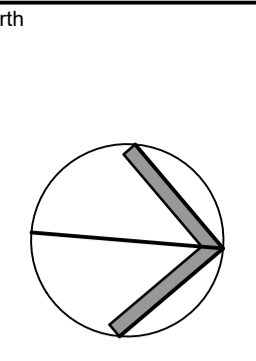

This drawing has been assigned an electronic code that signifies the drawing has been checked and approved by:

Issue	Description	Date	Drawn	Approved
A	FOR INFORMATION	15/12/22	MCG	ND
---	---	---	---	---
---	---	---	---	---
---	---	---	---	---
---	---	---	---	---
---	---	---	---	---
---	---	---	---	---
---	---	---	---	---
---	---	---	---	---
---	---	---	---	---
---	---	---	---	---

**ENGINEER'S CERTIFICATION**  
This drawing has been assigned an electronic code that signifies the drawing has been checked and approved by:

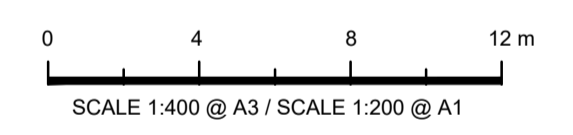

FOR INFORMATION

Client  
  
Project

**KINGSLIFF HIGH SCHOOL  
STAGE 2 MAIN WORKS  
(EXTERNAL CIVILS)**  
33 OXFORD STREET  
KINGSLIFF NSW 2487

**ACOR CONSULTANTS**  
**ACOR Consultants (QLD) Pty Ltd**  
Level 7, 22 Cordelia Street  
South Brisbane QLD 4101  
T +61 7 3844 5900  
ENGINEERS | MANAGERS | INFRASTRUCTURE PLANNERS | DEVELOPMENT CONSULTANTS

Drawing Title  
**EXTERNAL SITE WORKS  
LAYOUT PLAN  
SHEET 8 OF 11**

Drawn	Date	Scale	Sheet Size	C.A. Check	Date
MCG	08/12/22	1:200	A1	ND	15/12/22
Designed	Project No	Dwg. No.	Issue		
ND	BR210028	KPS-C24.08	A		

JOINS BR200435-KPS-C24.07

JOINS BR200435-KPS-C24.09

C:\Users\mcarroll\OneDrive\Desktop\Kingscliff\KPS-C24.08\KPS-C24.08.dwg

### EXISTING SERVICES NOTE:

1. NOTWITHSTANDING THAT EXISTING SERVICES MAY OR MAY NOT BE SHOWN ON THE DRAWINGS, NO RESPONSIBILITY IS TAKEN BY THE SUPERINTENDENT OR THE PRINCIPAL FOR THIS INFORMATION WHICH HAS BEEN SUPPLIED BY OTHERS. THE DETAILS ARE PROVIDED FOR INFORMATION ONLY. THE CONTRACTOR SHALL ASCERTAIN THE POSITION OF ANY UNDERGROUND SERVICES IN THIS AREA AND SHALL BE RESPONSIBLE FOR MAKING GOOD ANY DAMAGE CAUSED ON SITE.
2. ALL REASONABLE CARE HAS BEEN TAKEN TO ACCURATELY SHOW THE POSITION OF EXISTING SERVICES. HOWEVER, THE POSITION OF SUCH SERVICES SHOULD BE PROVEN ON SITE AND NO GUARANTEE CAN BE GIVEN THAT ALL EXISTING SERVICES ARE SHOWN. AREAS SURROUNDING EXISTING SERVICES ARE TO BE EXCAVATED BY HAND OR BY APPROVED VACUUM EXCAVATION CONTRACTOR.
3. CONTRACTOR TO CONFIRM THE LOCATION, SIZE AND DEPTH OF ALL EXISTING SERVICES PRIOR TO CONSTRUCTION.
  - 3.1. WHERE REQUIRED, CONTRACTOR TO POTHOLE TO CONFIRM LOCATION AND DEPTHS OF ALL UNDERGROUND SERVICES PRIOR TO UNDERTAKING ANY WORKS.
4. ALL EXISTING SERVICE STRUCTURES OR LIDS AFFECTED BY THE WORKS ARE TO BE ADJUSTED TO MATCH PROPOSED NEW SURFACE LEVELS.
5. CONTRACTOR TO LIAISE WITH RELEVANT AUTHORITY ON ANY REQUIRED PROTECTION/RELOCATION MEASURES AND INFORM ENGINEER OF APPROVED DESIGN PRIOR TO UNDERTAKING ANY WORKS.

TREES WITHIN PRIVATE PROPERTY HAVE NOT BEEN IDENTIFIED IN THE DETAILED SURVEY. CONTRACTOR TO ENGAGE AN ARBORIST TO ENSURE PROPOSED WORKS WILL NOT NEGATIVELY IMPACT TREES LOCATED WITHIN THE VERGE AND WITHIN ADJACENT PRIVATE PROPERTIES.

### EXISTING SERVICES LEGEND

- LOT BOUNDARY
- -0.100 --- EXISTING CONTOUR (0.1m INTERVAL)
- EX-SW --- EXISTING STORMWATER
- EX-S --- EXISTING SEWER
- EX-W --- EXISTING WATER
- -0E --- EXISTING OVERHEAD POWER
- EX-E --- EXISTING ELECTRICAL - UNDERGROUND
- EX-T --- EXISTING TELECOMMUNICATIONS
- EX-F --- EXISTING FENCE

### LEGEND

- PROPOSED CONCRETE FOOTPATH - REFER CIVIL TO TSC STANDARD DRAWING S.D.013
- EXISTING FOOTPATH TO BE REMOVED AND REPLACED WITH TOPSOIL AND TURF TO EXISTING LEVELS
- PROPOSED SAW CUT
- 100mm 'NO STOPPING' LINE - YELLOW PAINT IN ACCORDANCE WITH TSC CONSTRUCTION SPECIFICATION C261

S138 ROADS ACT 1993  
DRIVEWAYS AND OTHER WORKS  
ON PUBLIC ROADS  
APPROVAL  
APPROVAL NO DWY23/0070



© COPYRIGHT of this design and plan is the property of ACOR Consultants (QLD) Pty Ltd, ACN 126 011 087 ABN 18 126 011 087, all rights reserved. It must not be used, modified, reproduced or copied wholly or in part without written permission from ACOR Consultants (QLD) Pty Ltd. ACOR Consultants is a trademark licensed to ACOR Consultants (QLD) Pty Ltd by ACOR Consultants Pty Ltd.

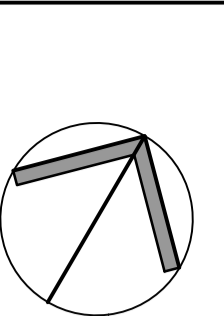

This drawing has been assigned an electronic code that signifies the drawing has been checked and approved by:

Issue	Description	Date	Drawn	Approved
A	FOR INFORMATION	15/12/22	MCG	ND
---	---	---	---	---
---	---	---	---	---
---	---	---	---	---
---	---	---	---	---
---	---	---	---	---
---	---	---	---	---
---	---	---	---	---
---	---	---	---	---
---	---	---	---	---
---	---	---	---	---

ENGINEER'S CERTIFICATION  
This drawing has been assigned an electronic code that signifies the drawing has been checked and approved by:

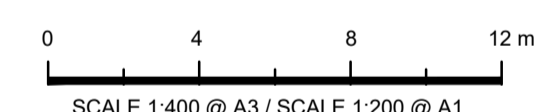
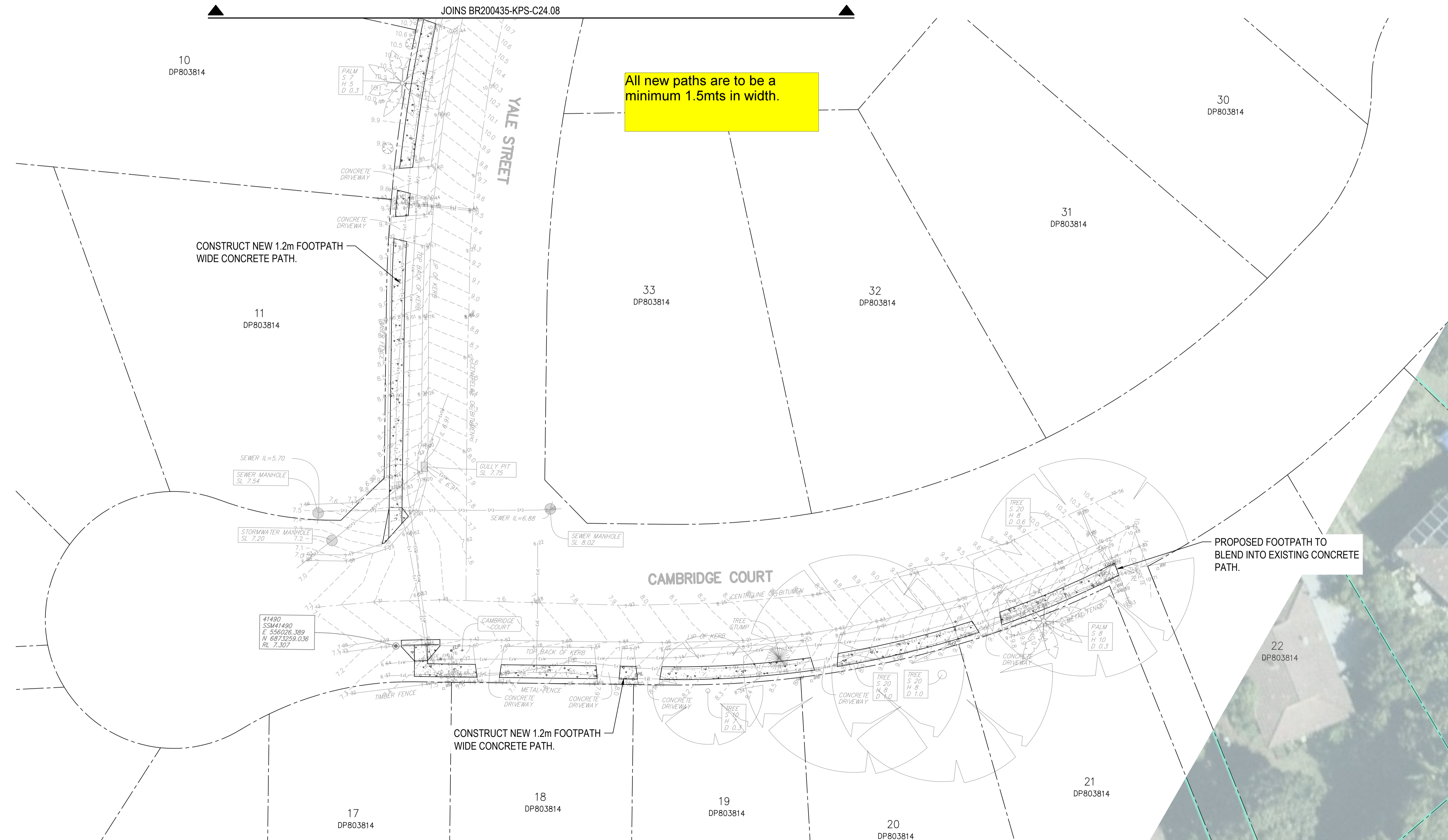

SCALE 1:400 @ A3 / SCALE 1:200 @ A1

FOR INFORMATION

Client

Project  
KINGSCLIFF HIGH SCHOOL  
STAGE 2 MAIN WORKS  
(EXTERNAL CIVILS)  
33 OXFORD STREET  
KINGSCLIFF NSW 2487

**ACOR Consultants (QLD) Pty Ltd**  
Level 7, 22 Cordelia Street  
South Brisbane QLD 4101  
T +61 7 3844 5900

CONSULTANTS  
ENGINEERS | MANAGERS | INFRASTRUCTURE PLANNERS | DEVELOPMENT CONSULTANTS

Drawing Title  
EXTERNAL SITE WORKS  
LAYOUT PLAN  
SHEET 7 OF 11

Drawn	Date	Scale	Sheet Size	C.A. Check	Date
MCG	08/12/22	1:200	A1	ND	15/12/22
Designed	Project No.	Dwg. No.	Issue		
ND	BR210028	KPS-C24.07	A		

C:\Users\mccg\OneDrive - ACOR Consultants Pty Ltd\Desktop\Projects\Kingscliff High School Stage 2 Main Works (External Civils)\Sheet 7 of 11.dwg



### EXISTING SERVICES NOTE:

1. NOTWITHSTANDING THAT EXISTING SERVICES MAY OR MAY NOT BE SHOWN ON THE DRAWINGS, NO RESPONSIBILITY IS TAKEN BY THE SUPERINTENDENT OR THE PRINCIPAL FOR THIS INFORMATION WHICH HAS BEEN SUPPLIED BY OTHERS. THE DETAILS ARE PROVIDED FOR INFORMATION ONLY. THE CONTRACTOR SHALL ASCERTAIN THE POSITION OF ANY UNDERGROUND SERVICES IN THIS AREA AND SHALL BE RESPONSIBLE FOR MAKING GOOD ANY DAMAGE CAUSED ON SITE.
2. ALL REASONABLE CARE HAS BEEN TAKEN TO ACCURATELY SHOW THE POSITION OF EXISTING SERVICES. HOWEVER, THE POSITION OF SUCH SERVICES SHOULD BE PROVEN ON SITE AND NO GUARANTEE CAN BE GIVEN THAT ALL EXISTING SERVICES ARE SHOWN. AREAS SURROUNDING EXISTING SERVICES ARE TO BE EXCAVATED BY HAND OR BY APPROVED VACUUM EXCAVATION CONTRACTOR.
3. CONTRACTOR TO CONFIRM THE LOCATION, SIZE AND DEPTH OF ALL EXISTING SERVICES PRIOR TO CONSTRUCTION.
  - 3.1. WHERE REQUIRED, CONTRACTOR TO POTHOLE TO CONFIRM LOCATION AND DEPTHS OF ALL UNDERGROUND SERVICES PRIOR TO UNDERTAKING ANY WORKS.
4. ALL EXISTING SERVICE STRUCTURES OR LIDS AFFECTED BY THE WORKS ARE TO BE ADJUSTED TO MATCH PROPOSED NEW SURFACE LEVELS.
5. CONTRACTOR TO LIAISE WITH RELEVANT AUTHORITY ON ANY REQUIRED PROTECTION/RELOCATION MEASURES AND INFORM ENGINEER OF APPROVED DESIGN PRIOR TO UNDERTAKING ANY WORKS.

### LINEMARKING LEGEND

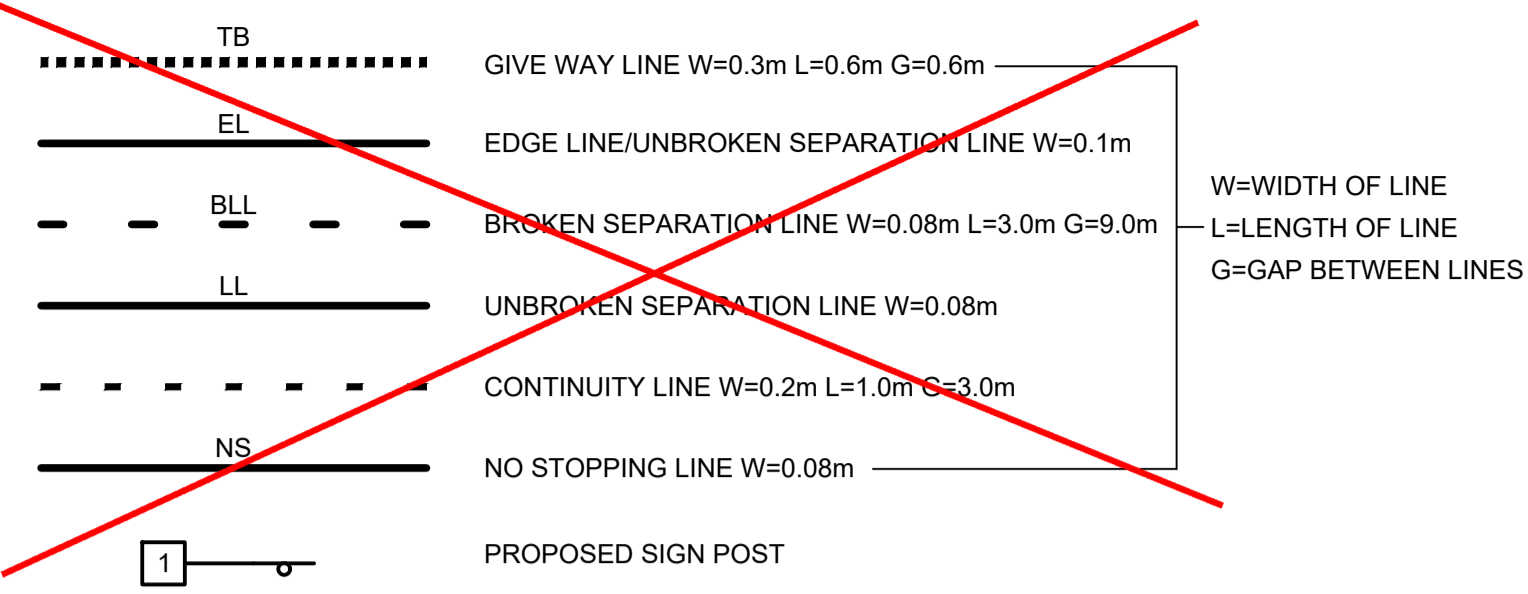

### SIGNAGE TABLE

SIGN No.	SIGN NAMES	DESCRIPTION	NO. REQUIRED
2	R1-2A	GIVE WAY	1

### EXISTING SERVICES LEGEND

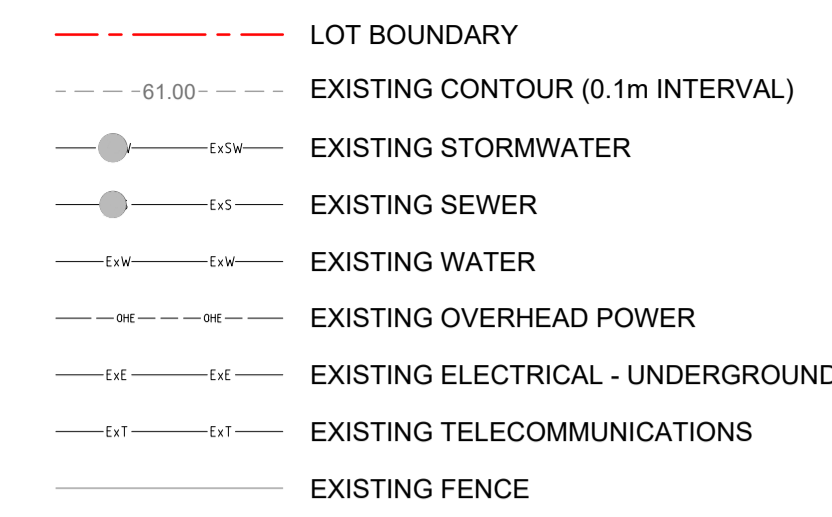

### LEGEND

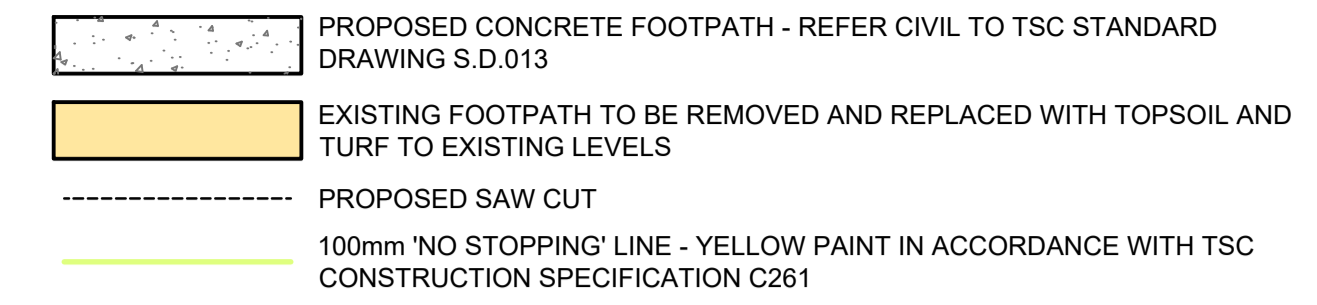

TREES WITHIN PRIVATE PROPERTY HAVE NOT BEEN IDENTIFIED IN THE DETAILED SURVEY. CONTRACTOR TO ENGAGE AN ARBORIST TO ENSURE PROPOSED WORKS WILL NOT NEGATIVELY IMPACT TREES LOCATED WITHIN THE VERGE AND WITHIN ADJACENT PRIVATE PROPERTIES.

S138 ROADS ACT 1993  
DRIVEWAYS AND OTHER WORKS  
ON PUBLIC ROADS  
APPROVAL  
APPROVAL NO DWY23/0070



© COPYRIGHT of this design and plan is the property of ACOR Consultants (QLD) Pty Ltd, ACN 126 011 087 ABN 18 126 011 087, all rights reserved. It must not be used, modified, reproduced or copied wholly or in part without written permission from ACOR Consultants (QLD) Pty Ltd. ACOR Consultants is a trademark licensed to ACOR Consultants (QLD) Pty Ltd by ACOR Consultants Pty Ltd.

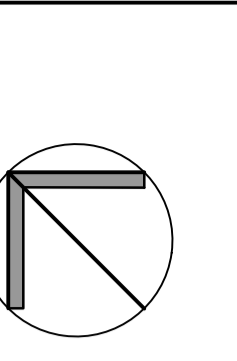

This drawing has been assigned an electronic code that signifies the drawing has been checked and approved by:

Issue	Description	Date	Drawn	Approved
A	FOR INFORMATION	15/12/22	MCG	ND
---	---	---	---	---
---	---	---	---	---
---	---	---	---	---
---	---	---	---	---
---	---	---	---	---
---	---	---	---	---
---	---	---	---	---
---	---	---	---	---
---	---	---	---	---
---	---	---	---	---
---	---	---	---	---
---	---	---	---	---

ENGINEER'S CERTIFICATION  
This drawing has been assigned an electronic code that signifies the drawing has been checked and approved by:



FOR INFORMATION

Client

Project  
**KINGSCLIFF HIGH SCHOOL  
STAGE 2 MAIN WORKS  
(EXTERNAL CIVILS)**  
33 OXFORD STREET  
KINGSCLIFF NSW 2487

**ACOR Consultants (QLD) Pty Ltd**  
Level 7, 22 Cordelia Street  
South Brisbane QLD 4101  
T +61 7 3844 5900

CONSULTANTS  
ENGINEERS | MANAGERS | INFRASTRUCTURE PLANNERS | DEVELOPMENT CONSULTANTS  
Drawing Title  
**EXTERNAL SITE WORKS  
LAYOUT PLAN  
SHEET 11 OF 11**

Drawn	Date	Scale	Sheet Size	C.A. Check	Date
MCG	08/12/22	1:200	A1	ND	15/12/22
Designed	Project No.	Dwg. No.	Issue		
ND	BR210028	KPS-C24.11	A		