

# Killarney Heights Public School

## Works notification

November 2019

### Notification of structural steel delivery and KHOOSH relocation during works

Dear school community and local residents,

We are writing to inform you that as part of a project to upgrade the Killarney Heights Public School, there will be increased traffic on Melwood Avenue, closures to the Melwood Avenue school access gate and relocation of the Killarney Heights Out of School Hours (KHOOSH).

This is to allow delivery of structural steel to the school oval, where it will be erected on site, then craned to the main building construction area.

Work will take place between Monday 25 November and Thursday 28 November, during the hours of 7:00am to 2:45pm.

School access via Melwood Avenue will be closed off during drop off times and we encourage parents to use Tralee Avenue or Tramore Place access points. The Melwood Avenue gates will be open for student departure and bus access in the afternoon.

Traffic control will be in place on Melwood Avenue for the entry and exit of large construction vehicles onto the site, to ensure pedestrian safety. There will be no major impact for local residents accessing their property. Please follow direction of the traffic control personnel at all times.

KHOOSH services will be relocated during these works to Kildare and Killkenny classrooms in B Block near the office, with access via Tralee Avenue or Tramore Place access gates.

The school oval will not be accessed by students or staff during this time and 'spotters' will be onsite to undertake planned escorted access to the Hall and ensure safety at all times.

A site layout map is provided overleaf, showing the location of the work area and the access points.

We are here to make sure that work is completed safely and efficiently and will minimise impacts on the school and community at every opportunity.

If you have any queries relating to this work, please contact School Infrastructure NSW using the contact information overleaf.

Thank you for your patience during this important school upgrade.

## Killarney Heights Public School – location of works

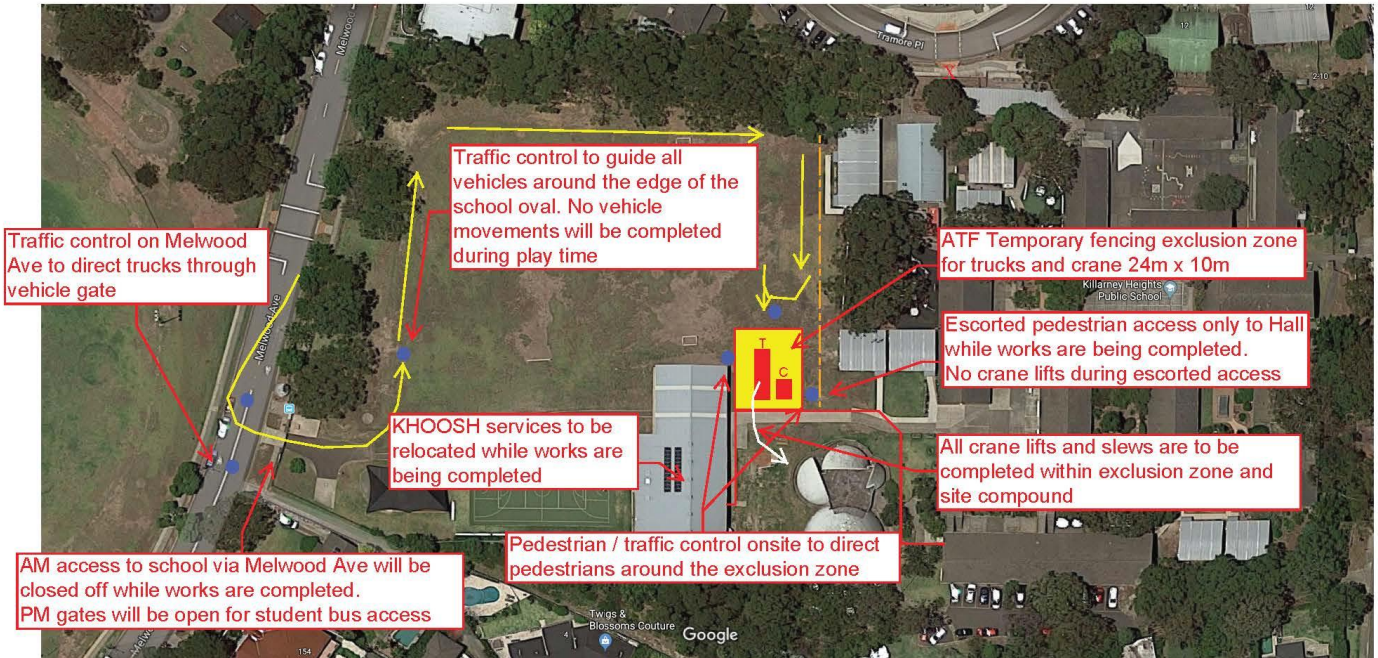

Works to be completed on the school oval as per mark-up 7:00am - 2:45pm  
Monday 25th Nov  
Tuesday 26th Nov  
Wednesday 27th Nov  
Thursday 28th Nov - Hall Bookings 10-10.30am and 11am - TBC  
Works to stop while children are escorted to the hall

**Legend**  
● Spotter / traffic & pedestrian control  
↑ Vehicle movement around the oval  
⚡ Bunting / barrier to be installed to close off access to the oval  
X Gate access point

If you have any queries relating to these maintenance works, please contact us using the information below.

### For more information contact:

School Infrastructure NSW  
Email: [schoolinfrastructure@det.nsw.edu.au](mailto:schoolinfrastructure@det.nsw.edu.au)  
Phone: 1300 482 651  
[www.schoolinfrastructure.nsw.gov.au](http://www.schoolinfrastructure.nsw.gov.au)