

# Kent Road Public School

## Works notification

10 August 2021

### Upgrade to kiss and ride area

As part of the recently completed Kent Road Public School upgrade project, work to improve the kiss and ride area for the school is planned to start **week beginning Monday 16 August 2021**. The proposed changes will improve vehicular access and pedestrian safety for the Kent Road Public School community and local residents.

The work will involve relocating the current kiss and ride area on Kent Road to east of the existing pedestrian crossing and creating a partial bay of up to 1.5m in width. This will allow through traffic to safely pass the kiss and ride area.

### Duration of work and working hours

Works are planned to start from Monday 16 August 2021 and are anticipated to take approximately eight (8) weeks to complete. Working hours will be 7am to 5:30pm Monday to Friday and 8am to 4pm on Saturday.

### Traffic and pedestrian impacts

During works, traffic on Kent Road will be reduced to one lane.

Traffic controllers will be in place to provide safety, convenience and efficient management and control of vehicle and pedestrian traffic around the worksite (See map overleaf for details).

Parking will be unavailable where the construction works are to be undertaken, however the other existing kiss and ride locations will still be available during works.

### What safety measures will be in place?

The safety of the school community and local community is our top priority. During construction, the contractors will follow rigorous processes to ensure the safety of students, staff, contractors, parents and other visitors to the site is maintained.

If you have any queries relating to the ongoing work at Kent Road Public School, please contact School Infrastructure NSW using the contact information below.

Thank you for your patience while we deliver this important school infrastructure.

---

#### For more information contact:

School Infrastructure NSW  
Email: [schoolinfrastructure@det.nsw.edu.au](mailto:schoolinfrastructure@det.nsw.edu.au)  
Phone: 1300 482 651  
[www.schoolinfrastructure.nsw.gov.au](http://www.schoolinfrastructure.nsw.gov.au)

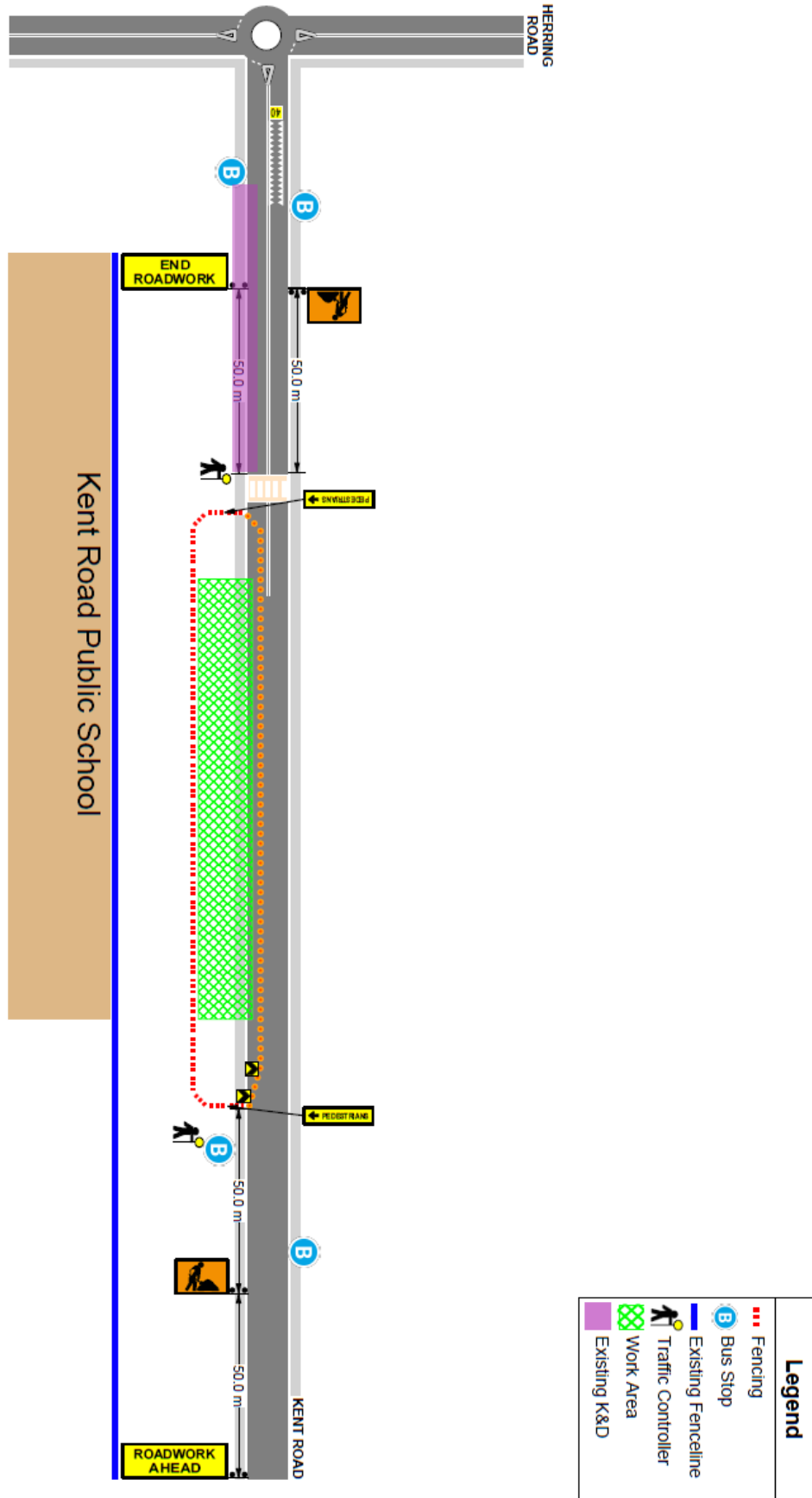

**For more information contact:**

School Infrastructure NSW  
 Email: [schoolinfrastructure@det.nsw.edu.au](mailto:schoolinfrastructure@det.nsw.edu.au)  
 Phone: 1300 482 651  
[www.schoolinfrastructure.nsw.gov.au](http://www.schoolinfrastructure.nsw.gov.au)

