



Artist render Kent Road Public School upgrade

## Kent Road Public School

### Project update

February 2019

#### Kent Road Public School upgrade

Kent Road Public School is currently undergoing redevelopment, to provide new facilities for staff and students. Once completed in late 2020, the project will enable the school to accommodate more than 900 students through:

- new innovative learning environments
- 34 permanent teaching spaces
- administration and staff facilities
- hall extension and refurbishment
- a new library
- a canteen
- more functional open outdoor play space.

#### Progress summary

The installation of the temporary pop-up school was completed ahead of Day 1, Term 1 ready to accommodate staff and students for Term 1 2019.

Early works in preparation for the construction of the new permanent facilities will be undertaken in the coming months. This work will include:

- Construction of a temporary hoarding, separating the work area for students, staff and the community
- The demolition of some existing buildings, near the Kent Road entrance
- Site works including refurbishment of the existing administration building to a new library and extension of the existing hall.

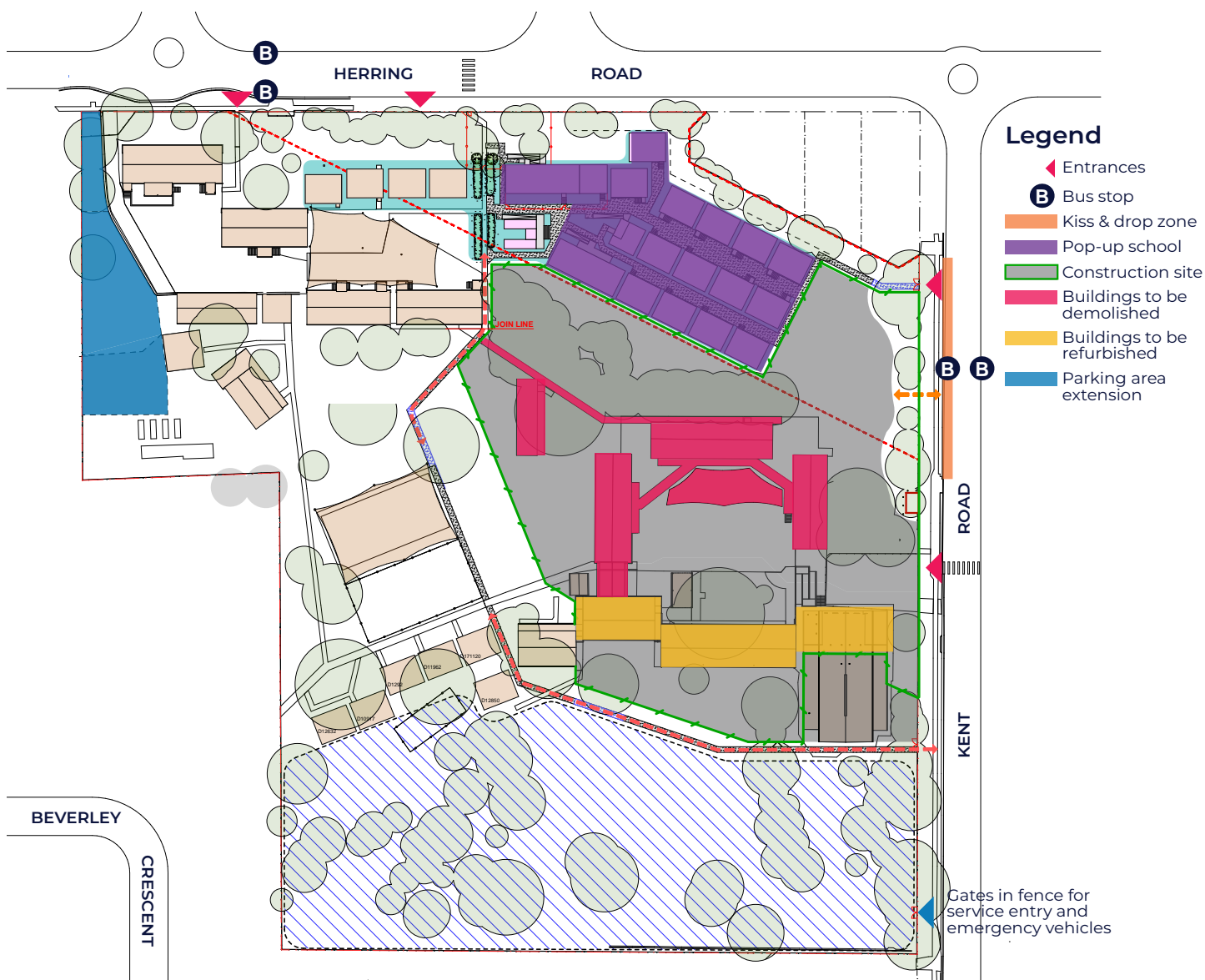

## What to expect

- Throughout the construction period, efforts will be put in place to mitigate disruption to teaching and learning for staff and students as well as impacts to the community. An Environmental Management Plan is in place for this work which includes strategies for managing noise, dust, air quality and hazardous materials
- A dedicated entrance has been established for the contractor, with all vehicles entering and exiting via Kent Road
- The delivery of construction materials and equipment will be scheduled outside of school drop-off and pick-up times to minimise disruption
- Construction work will take place during approved hours which are between 7am-5pm Monday to Saturday. No work will take place on Sundays or public holidays.

## Contact us

We are committed to working with our schools and local communities to deliver the best possible learning facilities for students.

### For more information contact:

School Infrastructure NSW  
 Email: [schoolinfrastructure@det.nsw.edu.au](mailto:schoolinfrastructure@det.nsw.edu.au)  
 Phone: 1300 482 651  
[www.schoolinfrastructure.nsw.gov.au](http://www.schoolinfrastructure.nsw.gov.au)