

Project overview

A project is underway to upgrade Irrawang High School to bring students the latest educational facilities and support the local community. The project will provide upgrades to the school including additional permanent learning spaces and core facilities.



New learning hub with 8 general learning spaces and 6 support learning spaces



Expansion and refurbishment of the library



New school entry



New support student drop-off / pick-up area



Artist impression of Irrawang High School new learning hub

Irrawang High School

For more information phone: 1300 482 651
Email: schoolinfrastructure@det.nsw.edu.au

Progress summary

A Project Reference Group (PRG) has been established which includes architects, planners, design professionals, and Department of Education, Irrawang High School, and P&C leadership representatives.

The schematic design has been finalised in consultation with the PRG to meet Irrawang High School's educational and operational requirements.

Further details about the high school features facilities will be shared with the community as the project progresses.

Next steps

- Develop the detailed design for the upgrades, including the internal layout of spaces and how they will function.
- Planning application submission and approval by relevant authorities.
- A builder will be appointed following the tender process.
- Start of construction, subject to planning approval.



Artist impression of Irrawang High School new learning hub

Irrawang High School

For more information phone: 1300 482 651
Email: schoolinfrastructure@det.nsw.edu.au

Indicative site layout

The layout of new learning spaces and facilities have been determined in line with the department's Educational Facilities Standards and Guidelines, and with consideration of spatial requirements, site constraints, access and operational needs of the high school.

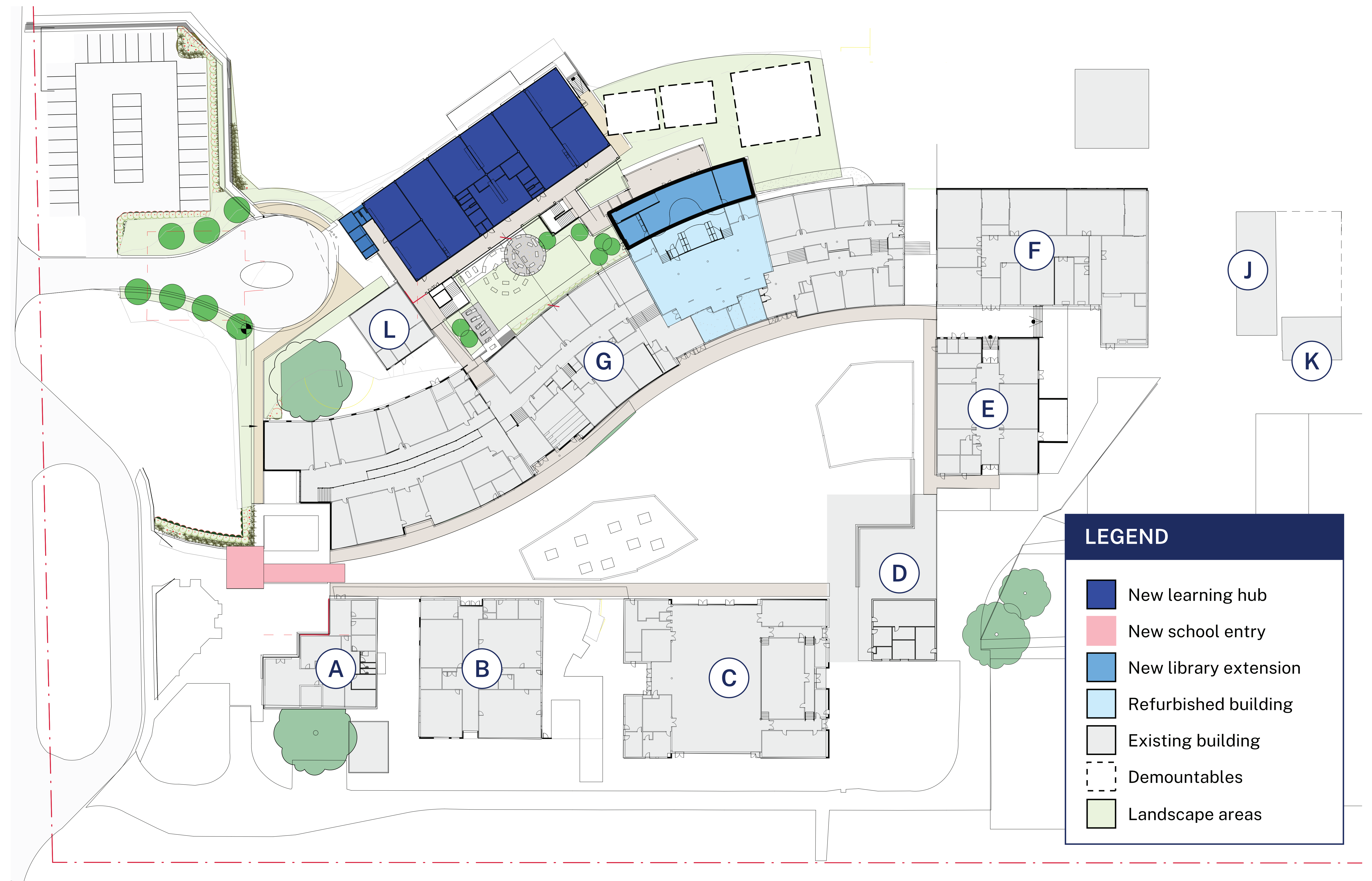

Irrawang High School

For more information phone: 1300 482 651
Email: schoolinfrastructure@det.nsw.edu.au



Artist impressions of Irrawang High School upgrade

Irrawang High School

For more information phone: 1300 482 651
Email: schoolinfrastructure@det.nsw.edu.au

Flexible learning spaces

Contemporary learning and teaching prepares students for a diverse and interconnected world. We are evolving the ways we teach our students new skills valued by a changing workforce, understand different ways students learn and support new ways of interacting with information through technology.

Flexible learning spaces are designed and equipped to support contemporary learning and teaching.

What makes a flexible learning space?



Learning space

- Different zones (areas of a building or floors) are designed to support a range of activities sometimes grouped by subject area
- Varied furniture allows for student choice, comfort and flexibility
- Spaces are flexibly connected allowing students to work in varied group sizes
- Connection between indoor and outdoor learning spaces



Organisation

- Movement is encouraged for students and teachers to collaborate and interact
- More than one teacher may be available to students within the learning environment
- Students learn in classes, small groups or individually



Teaching and learning

- Learning is personalised
- Learning is connected across different subject areas
- There is a focus on creativity and innovation with students prototyping, testing and using technology in creative ways



Technology

- Technology is integrated into spaces to extend learning opportunities
- WiFi is available everywhere including outdoors
- Specialist equipment is available for students to innovate, communicate and create

Irrawang High School

For more information phone: 1300 482 651
Email: schoolinfrastructure@det.nsw.edu.au

Contemporary high school learning spaces

These are some examples of contemporary learning environments for high school students across NSW.



Karabar High School



Queanbeyan High School



Canley Vale High School



Ballina Coast High School



Westfield Sports High School



Yass High School

Irrawang High School

For more information phone: 1300 482 651
Email: schoolinfrastructure@det.nsw.edu.au