

# Inner Sydney High School

## Works notification

October 2020

### Notification of tower crane removal and traffic changes at the Inner Sydney High School site

Dear Neighbour,

The new 14-storey building being delivered as part of the Inner City High School project is progressing well.

We are writing to inform you that Reds Global will be removing the tower crane on Sunday 11 October at 1224 Chalmers Street, Surry Hills.

The scheduled works will start at 12:00am on the morning of 11 October, and will continue for at least 24 hours.

Traffic changes will occur on Chalmers street reducing the traffic flow from four lanes to one lane on the eastern side. The surrounding street speed limits will be reduced to 40 Km/h at the Chalmers Street and Cleveland Street intersection. These changes will occur on Sunday 11 October and will be in place until the tower crane removal works are complete (approximately 24 hours). Please refer to traffic management map overleaf.

All care will be taken to minimize noise and disruption to the surrounding community.

We thank you for your patience and understanding.

The emergency site contacts during these hours are:

Marc Oriel Phone: 0448 189 729

If you have any queries relating to the tower crane removal or traffic changes at the new Inner Sydney High School, please contact School Infrastructure NSW using the contact information below.

**For more information contact:**

School Infrastructure NSW  
Level 8, 259 George Street, Sydney 2000 NSW  
Email: [schoolinfrastructure@det.nsw.edu.au](mailto:schoolinfrastructure@det.nsw.edu.au)  
Phone: 1300 482 651  
[www.schoolinfrastructure.nsw.gov.au](http://www.schoolinfrastructure.nsw.gov.au)

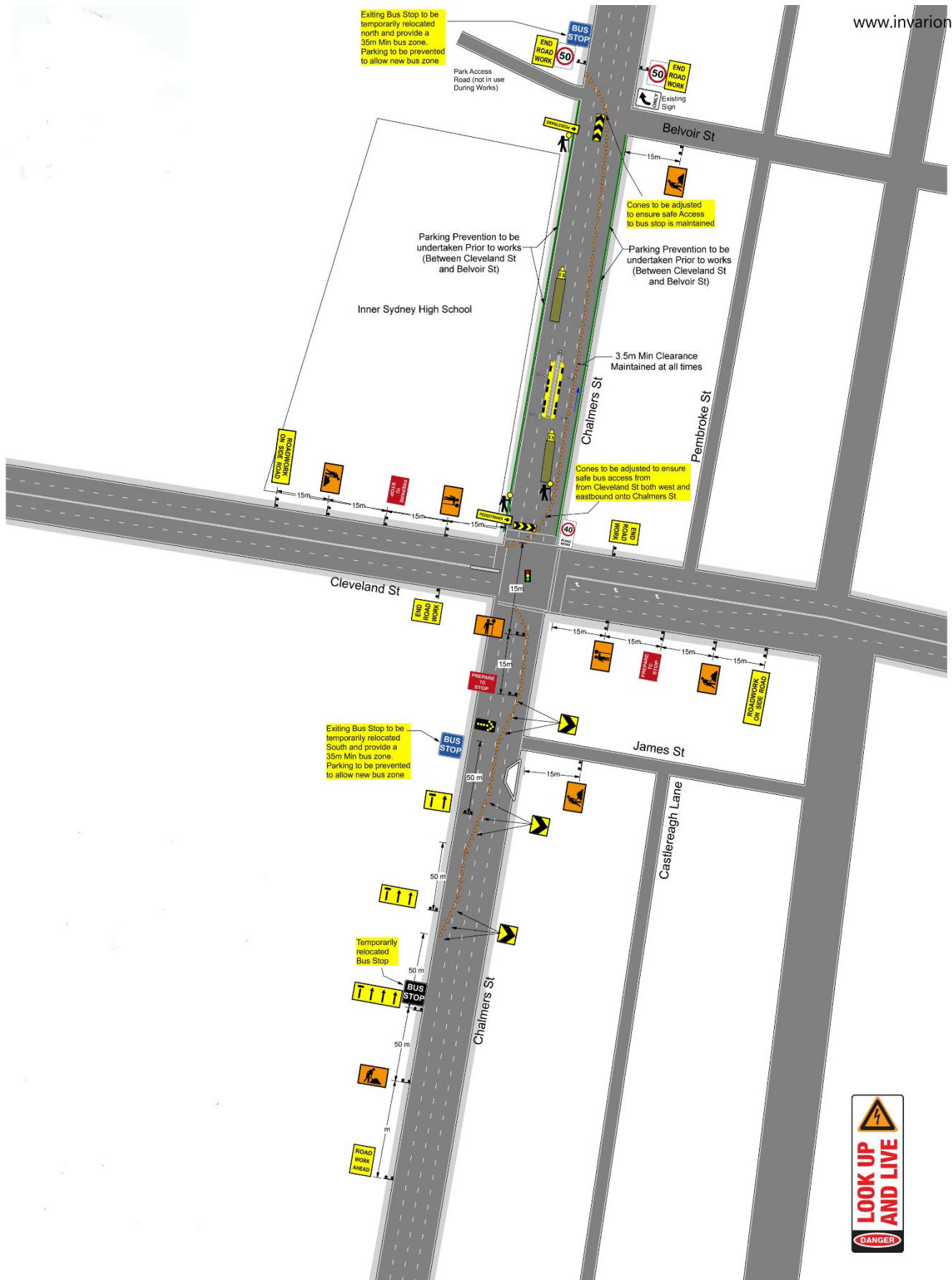

Map of traffic management plan