



Hunter River High School upgrade

Project update | October 2023

As part of the NSW Government's plan to rebuild essential services, the 2023-24 Budget is delivering a record \$8.8 billion for new and upgraded schools. This targeted investment in growing communities will ensure working families get access to a world class public education.

Project overview

A project is underway to upgrade Hunter River High School to bring students the latest educational facilities and support the local community.

The project has been approved to proceed to the delivery phase and will provide:

- a new support learning hub with 8 support classrooms
- a new double-height gymnasium
- a new administration building
- internal refurbishments to some existing buildings and learning spaces
- upgraded outdoor areas
- improved parking and drop-off/pick up area.

Progress summary

The builder has been appointed with the construction contract awarded to Richard Crookes Constructions. We will work with the builder to further progress the detailed design and develop the program of works to deliver the Hunter River High School upgrade.

Next steps

- Development of detailed design, the fourth and final stage of the design, which provides the level of detail required for construction.
- Determination of the Development Application by council.
- Construction is anticipated to start in late 2023, pending planning approvals.

Keep in touch





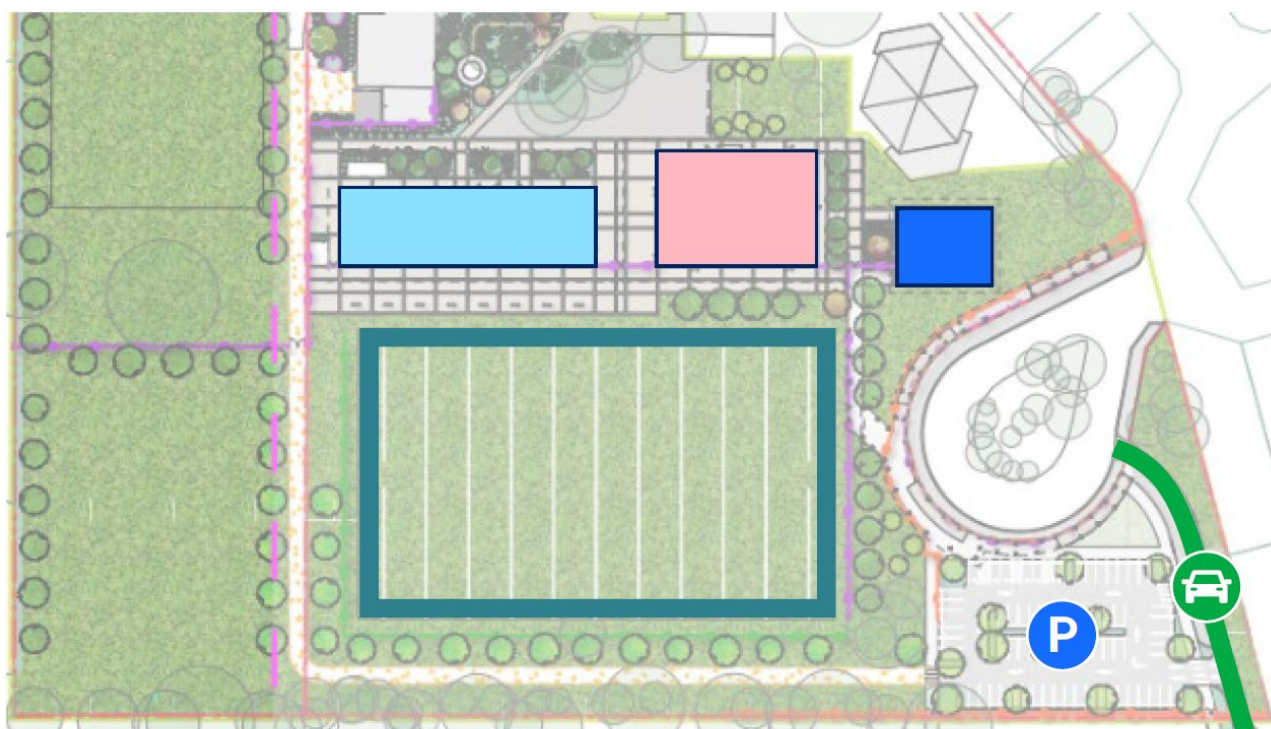

The School Infrastructure NSW (SINSW) website will continue to have up-to- date information about the Hunter River High School upgrade on the project page at <https://www.schoolinfrastructure.nsw.gov.au/projects/h/hunter-river-high-school-upgrade.html>

Your feedback on this project is important to us. For more information, questions or to make a comment, please email us at schoolinfrastructure@det.nsw.edu.au.

Indicative site plan of the Hunter River High School upgrade



Pacific Highway

LEGEND	
 New Support Learning Hub	 New drop-off / pick-up
 New Gymnasium	 New carpark
 New Administration	 Reorientated sporting field