

Project overview

We are upgrading Hastings Secondary College to support the student community. Hastings Secondary College comprises of the Port Macquarie Campus (PMC) and Westport Campus (WPC). The upgrade will involve work at both campuses and is being staged to ensure the school remains operational during construction and to minimise disruption to learning.

Port Macquarie Campus features:

**14 new or upgraded innovative learning spaces**

**3 supported learning spaces**

**New Technological and Applied Studies facilities**

**New Creative and Performing Arts (CAPA) building**

**Increase student accessibility with 3 lifts installed**

**Redeveloped school entry**

Westport Campus features:

**Relocate and upgrade administration office**

**3 innovative flexible learning spaces**

**Redeveloped school entry**

A separate proposal also includes a shared use multi-sports facility at the Port Macquarie campus, in partnership with the Police Citizens Youth Clubs (PCYC) NSW.



Artist impression of the redeveloped school entry at Port Macquarie Campus



Artist impression of the redeveloped school entry at Westport Campus

Port Macquarie Campus

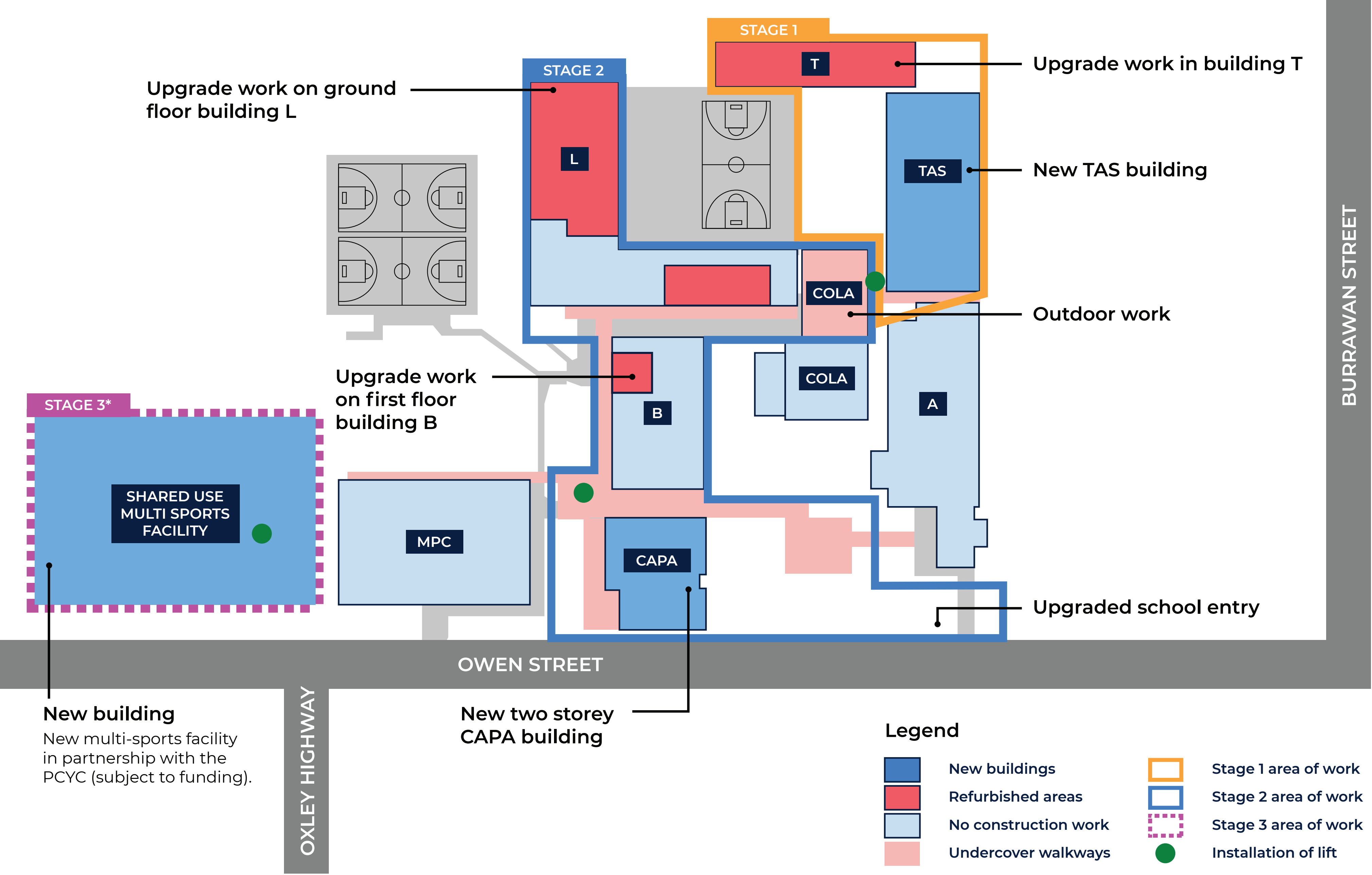

Artist impression of the upgrade at Hastings Secondary College Port Macquarie Campus

Hastings Secondary College

For more information phone: 1300 482 651
Email: schoolinfrastructure@det.nsw.edu.au
schoolinfrastructure.nsw.gov.au



Port Macquarie Campus Stage 1

The first stage of the upgrade at the Port Macquarie Campus is construction of a new Technical and Applied Sciences (TAS) building, upgrade to facilities in building T and increased open landscaped areas with accessibility to areas within the campus.

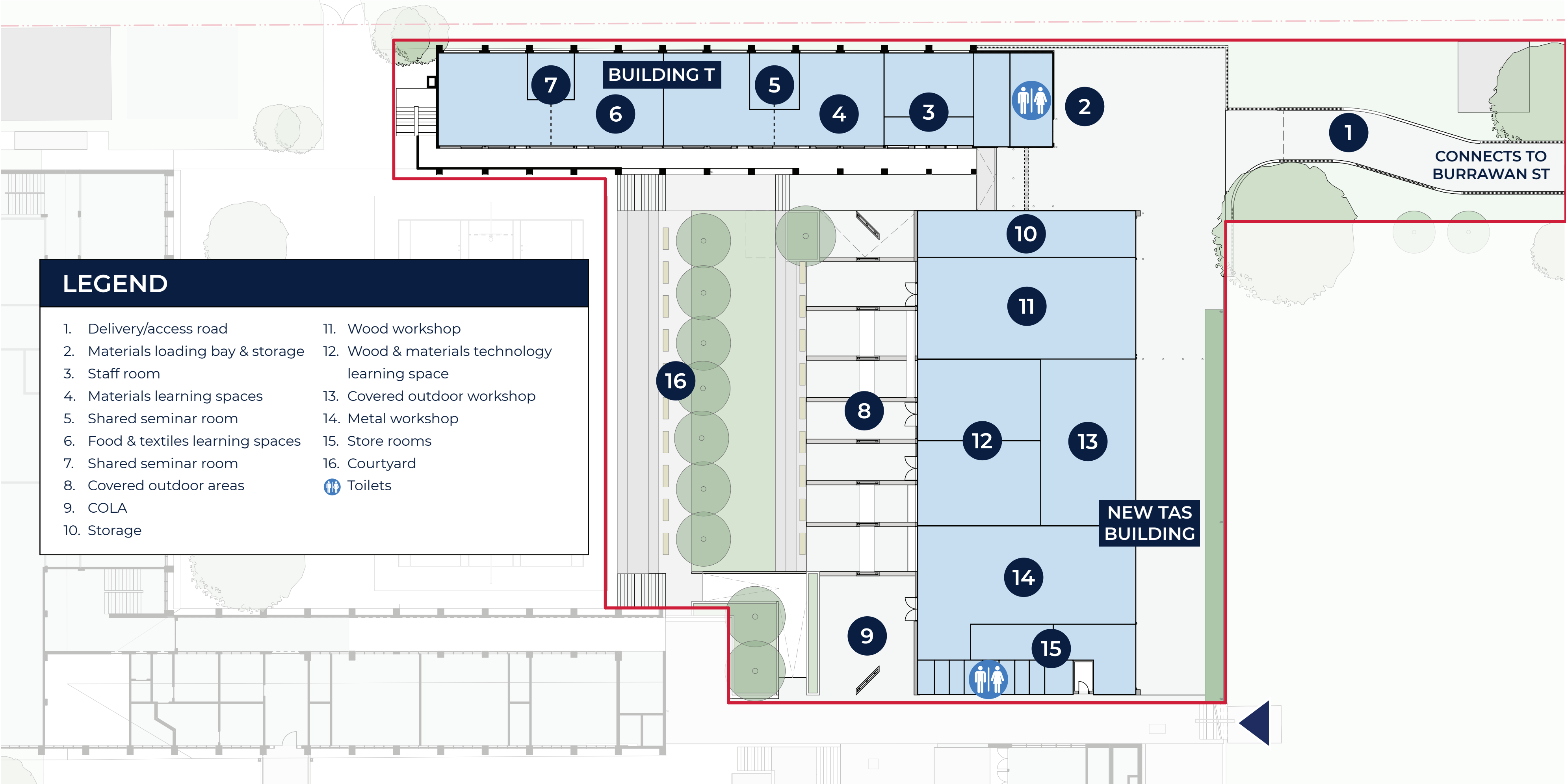

Artist impression of Building T, new TAS building and shared courtyard at Hastings Secondary College Port Macquarie Campus.



Artist impression of new TAS building at Hastings Secondary College Port Macquarie Campus.

Hastings Secondary College

For more information phone: 1300 482 651
Email: schoolinfrastructure@det.nsw.edu.au
schoolinfrastructure.nsw.gov.au

Port Macquarie Campus Stage 2

Stage 2 includes the new Creative and Performing Arts (CAPA) building, refurbishment of Blocks L and B, external works and a new school entrance.

Ground floor

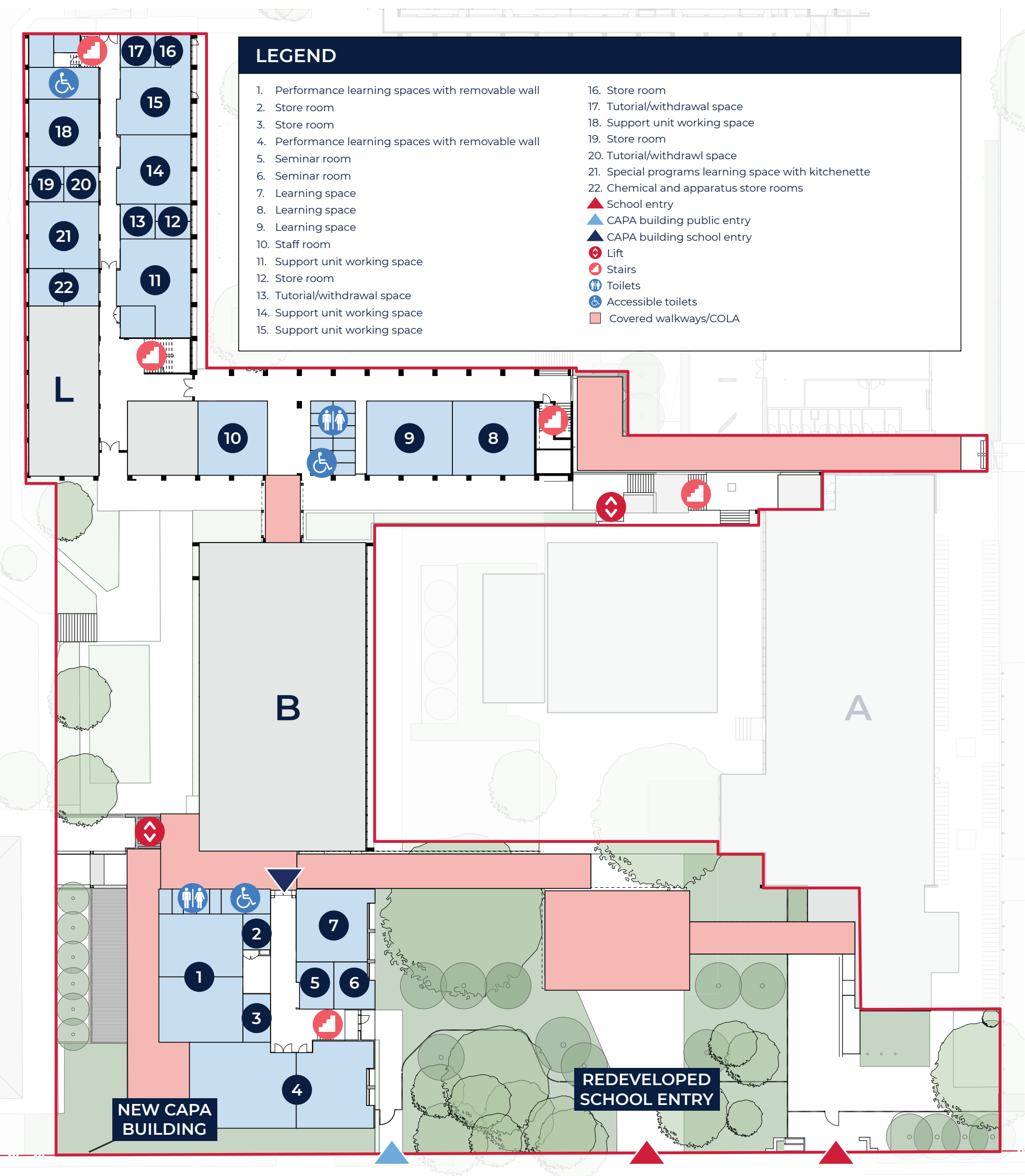

Level 1

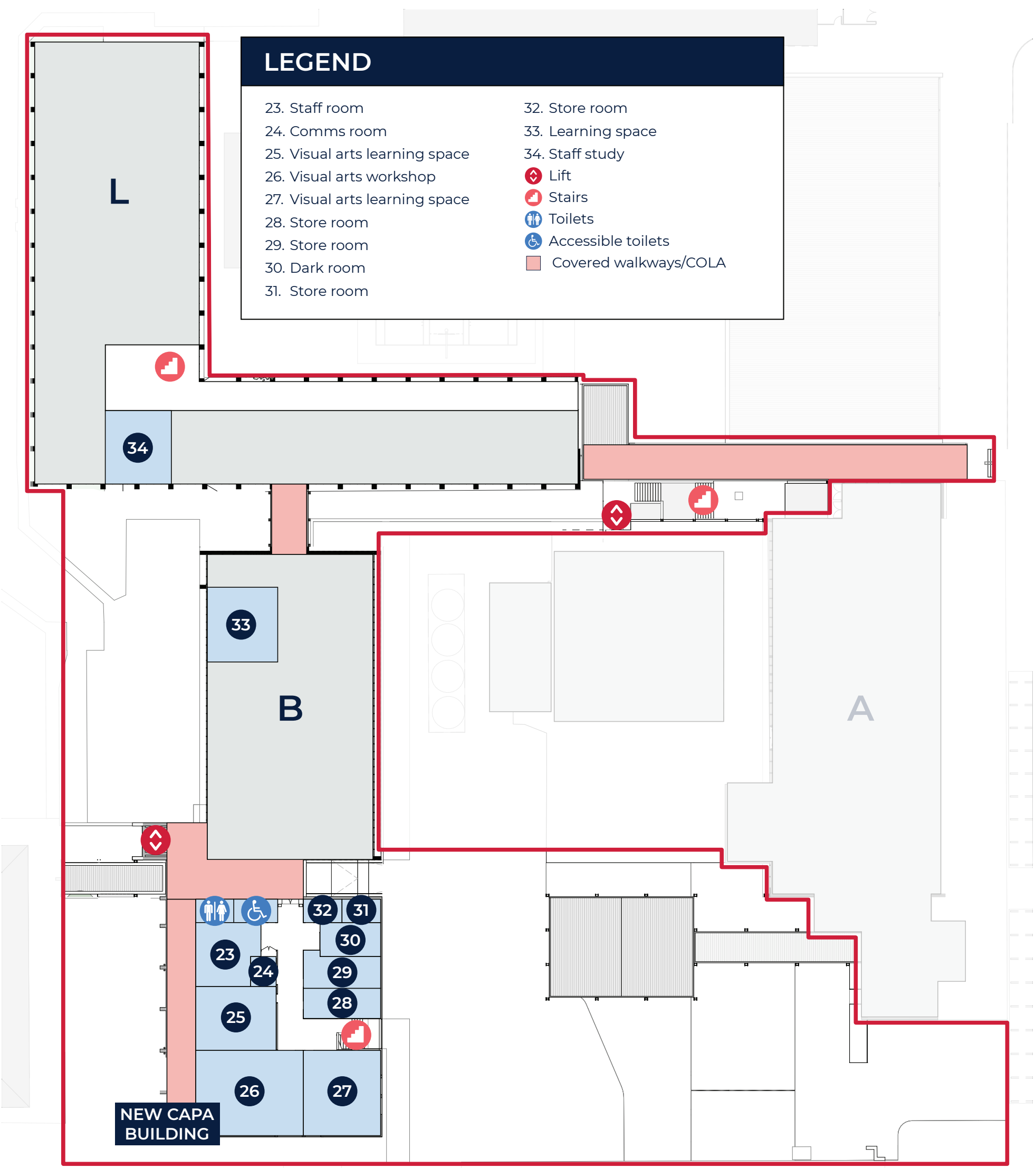

Designs may change as part of the detailed design phase.



Artist impression of the new CAPA building

Hastings Secondary College

For more information phone: 1300 482 651
Email: schoolinfrastructure@det.nsw.edu.au
schoolinfrastructure.nsw.gov.au



Westport Campus

The upgrade at the Westport Campus will provide new permanent general learning spaces and provide a new school administration building and upgraded entrance.

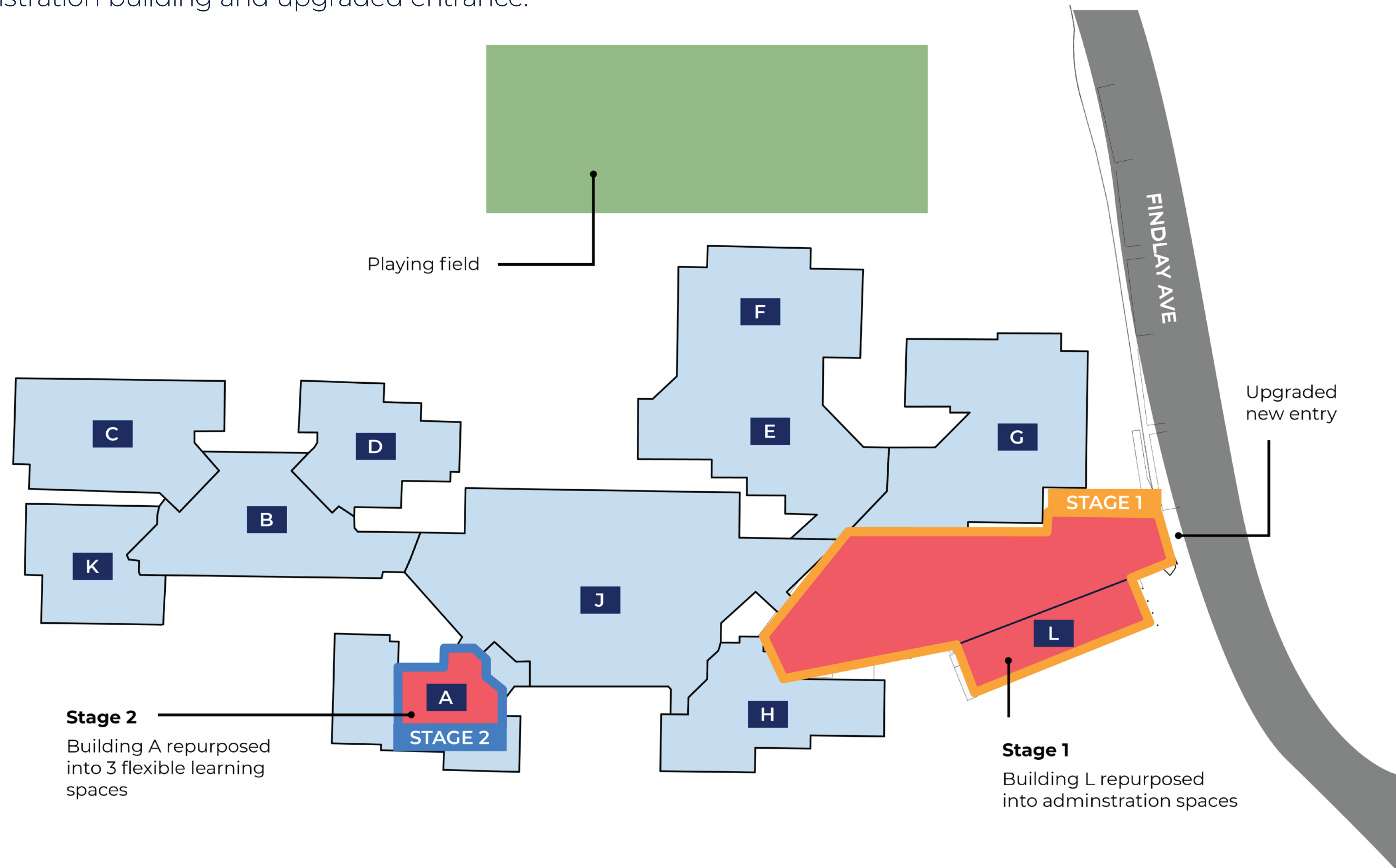

Legend

	Refurbished areas		New learning spaces		General learning		Multi-purpose/Music
	No construction work		Library		General learning		Art/TAS
	Stage 1 area of work		General learning		TAS		New administration
	Stage 2 area of work		General learning		Science learning		



Repurposing of Building L into new administration facilities at Hastings Secondary College Westport Campus

Hastings Secondary College

For more information phone: 1300 482 651
Email: schoolinfrastructure@det.nsw.edu.au
schoolinfrastructure.nsw.gov.au



Westport Campus

Stage 1 – Administration

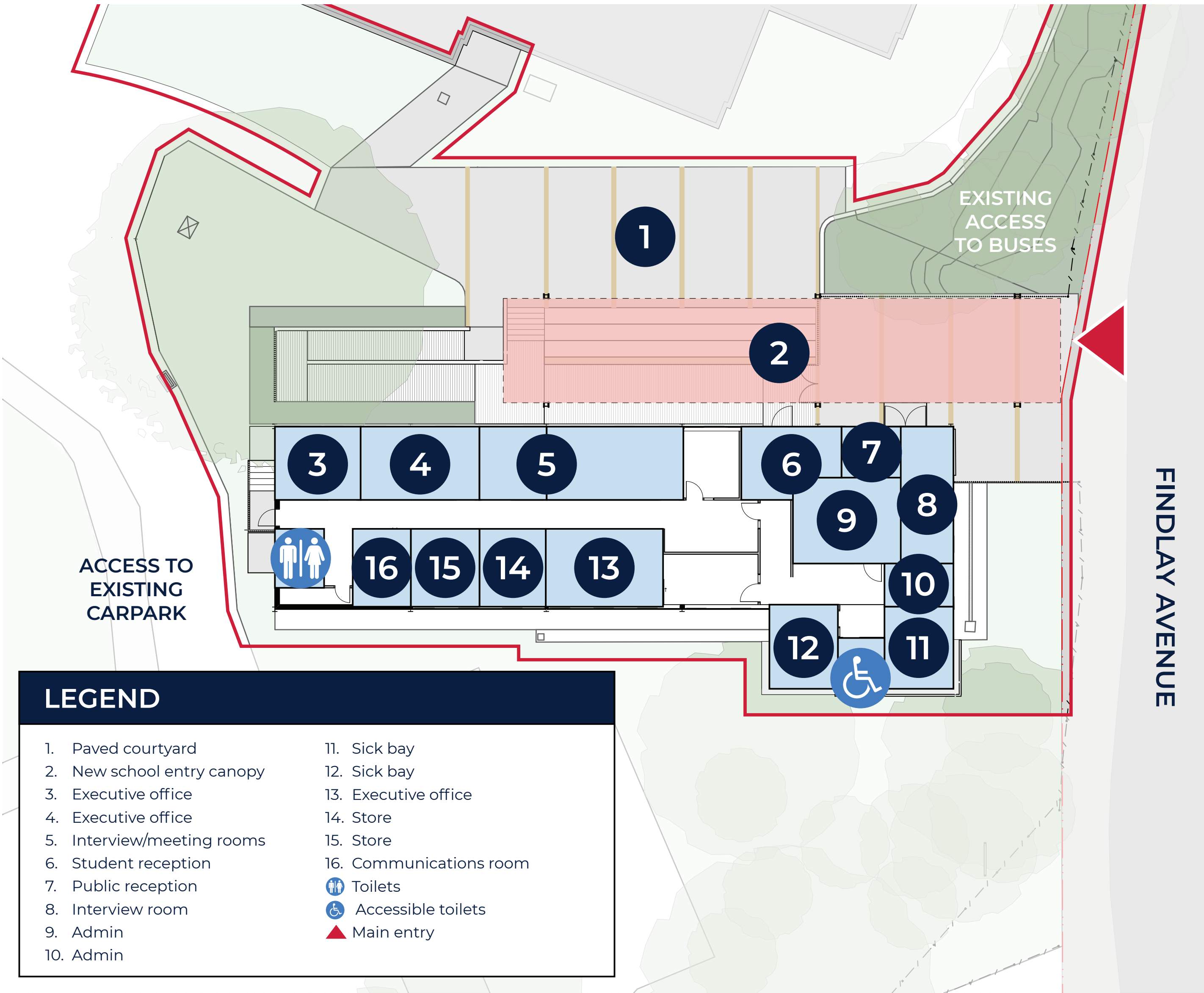

Stage 2 – Building A



Designs may change as part of the detailed design phase.

Port Macquarie Campus Stage 3

There is a separate proposal for a shared use multi-sport facility in partnership with Police Citizens Youth Clubs NSW (PCYC).

The master plan of the Port Macquarie Campus site was developed to ensure these two projects could proceed separately and independently of each other.

The multi-sport facility is being designed and has been submitted as part of the State Significant Development planning application for Port Macquarie Campus as Stage 3. However, construction of this facility is subject to separate funding approval.

Features of the design:

- Below ground car parking
- 2 multi-purpose sports courts
- Gymnastics facilities
- PCYC Police office, youth hub, admin, staff and kitchen facilities
- Mezzanine level with multipurpose rooms and gym
- Clontarf Academy, including meeting and kitchen facilities
- Separate access into the school and for public into the PCYC



Artist impression of the proposed shared use multi-sport facility

Progress summary and next steps

The Hastings Secondary College schematic design is complete for Stages 1 & 2 at both campuses. The internal layout of spaces and how they will function were finalised in consultation with school representatives to ensure classroom designs and layouts support teaching and learning requirements.

The Development Application (DA) for the Westport Campus upgrade was submitted to Port Macquarie-Hastings Council in April. Submissions on this DA can be made directly to Council.

The State Significant Development (SSD) Application for Port Macquarie Campus has been submitted to the Department of Planning, Industry and Environment (DPIE). This includes the Environmental Impact Statement responding to requirements for the project requested by DPIE. Community has the opportunity to view the proposal and provide formal comments directly to DPIE via www.planningportal.nsw.gov.au/major-projects and search for “Hastings Secondary College”.

A Complying Development Certificate (CDC) has been issued for Port Macquarie Campus Stage 1 and construction will commence in mid 2021 and will continue while planning approval is being considered for other stages.

