

Hastings Secondary College

Works notification

July 2021

We are upgrading Hastings Secondary College to support the student community. Hastings Secondary College comprises the Port Macquarie Campus (PMC) and Westport Campus (WPC). The upgrade will involve work at both campuses.

The main works construction contract has been awarded to FKG Group.

Site establishment

Main works construction for the Hastings Secondary College upgrade will start with Stage 1 at Port Macquarie Campus. Stage 1 includes the new TAS building and refurbishment works to building T.

From 26 July 2021, site sheds and additional temporary fencing will be installed around the premises. Site sheds will be delivered by flat bed and tilt tray trucks from Burrawan Street and unloaded with either a truck mounted crane or tilt tray trucks. See map overleaf for the site establishment area.

Once set up, services (water and electricity) will then be connected to site sheds.

Traffic management

Deliveries for Stage 1 will use the driveway on Burrawan Street. Traffic control measures will be in place for the site shed delivery. Traffic management will be in place to safely direct traffic and pedestrians.

All other deliveries for the project will be outside school drop off and pick up times, unless otherwise advised.

Next steps - excavation and removal of materials

In the weeks following site establishment, there will be excavation and removal of materials as part of the preparation for the site, along with provision of in-ground services.

Earthmoving equipment will be moved onto site and will include some noisy work. School Infrastructure NSW (SINSW) will work closely with the school leadership team to ensure continuity of school operations and to minimise any potential impact on student learning during construction.

Hours of work

Works will be completed between the hours of 7am and 5pm Monday to Saturdays, with no work on public holidays or Sundays.

We are here to make sure that the works are completed safely and efficiently and we will minimise impacts on the community at every opportunity.

Thank you for your patience while we deliver this important school infrastructure.

For more information contact:

School Infrastructure NSW
Email: schoolinfrastructure@det.nsw.edu.au
Phone: 1300 482 651
www.schoolinfrastructure.nsw.gov.au

Map outlining site establishment at Port Macquarie Campus, Hastings Secondary College.

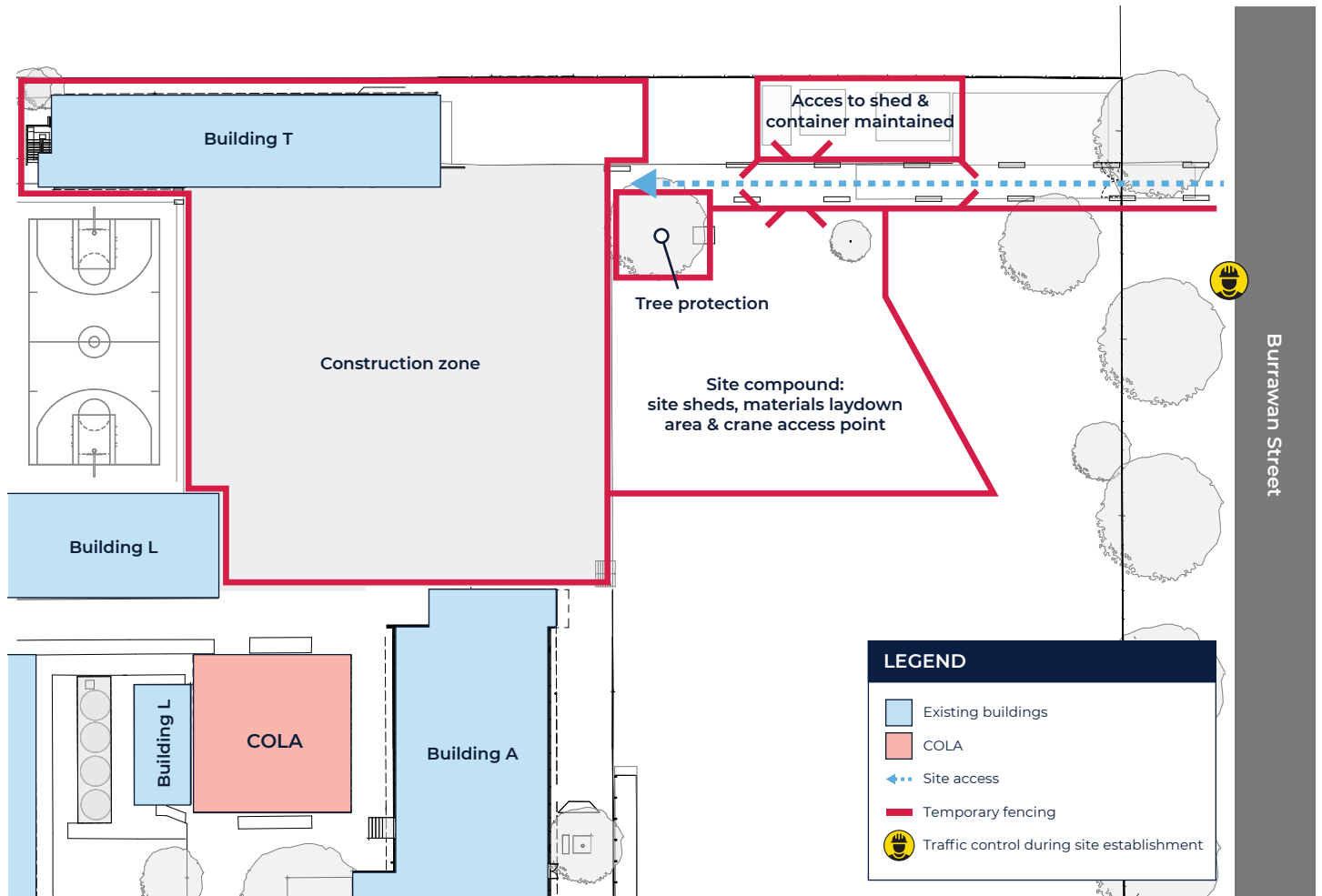

For more information contact:

School Infrastructure NSW
Email: schoolinfrastructure@det.nsw.edu.au
Phone: 1300 482 651
www.schoolinfrastructure.nsw.gov.au