



Department of Planning,
Housing and Infrastructure

Issued under the Environmental Planning and Assessment Act 1979

Approved Section 4.55(1A) Application Application No.: SSD-41306367-MOD-3

Granted: 18 September 2024 Sheet No.: 1 of 11

Signed: GS



1

GROUND LEVEL
1:500

NORTH

KEY PLAN

Drawing Disclaimer:
Do not scale from drawings.
Verify all dimensions on site before
commencing work.

Copying or reproduction of this drawing is
strictly prohibited without the consent of
Bennett and Trimble

NOTE:
Bennett and Trimble takes no responsibility
for external building elements. Anything
connected with any design, materials
selection, construction or installation of any
cladding, facade or external building element
must be checked by and remains the
responsibility of others, including suitably
qualified experts as may be required.

ISSUE

REV	FOR	Date
D	FINAL DESIGN REPORT	5/10/2022
E	RESPONSE TO SUBMISSIONS	3/8/2022
F	RESPONSE TO SUBMISSIONS	14/2/2023
G	SSD MODIFICATION	25/10/2023
H	SSD MODIFICATION	26/6/2024

CLIENT



LIPMAN
Level 6, 66 Berry St
North Sydney NSW 2060
www.lipman.com.au

ARCHITECT

BENNETT AND TRIMBLE
L2, 333 George Street
Sydney NSW 2000
+61 2 8065 8766
bennettandtrimble.com

ABN 20 125 950 816
NSW Nominated Architects
M Trimble No. 7625
M Bennett No. 8538

PROJECT NAME

GREGORY HILLS PUBLIC SCHOOL

ADDRESS

28 Wallarah Circuit
Gregory Hills NSW 2557

PROJECT NUMBER

211020

STATUS

FOR APPROVAL

DRAWING TITLE

SITE PLAN - GF

DRAWING NUMBER

SSDA.03

SCALE

1:500 @ A1

REVISION

H

DATE

26/6/2024



Department of Planning,
Housing and Infrastructure

Issued under the Environmental Planning and Assessment Act 1979
Approved Section 4.55(1A) Application Application No: SSD-41306367-MOD-3
Granted: 18 September 2024 Sheet No: 2 of 11 Signed: GS

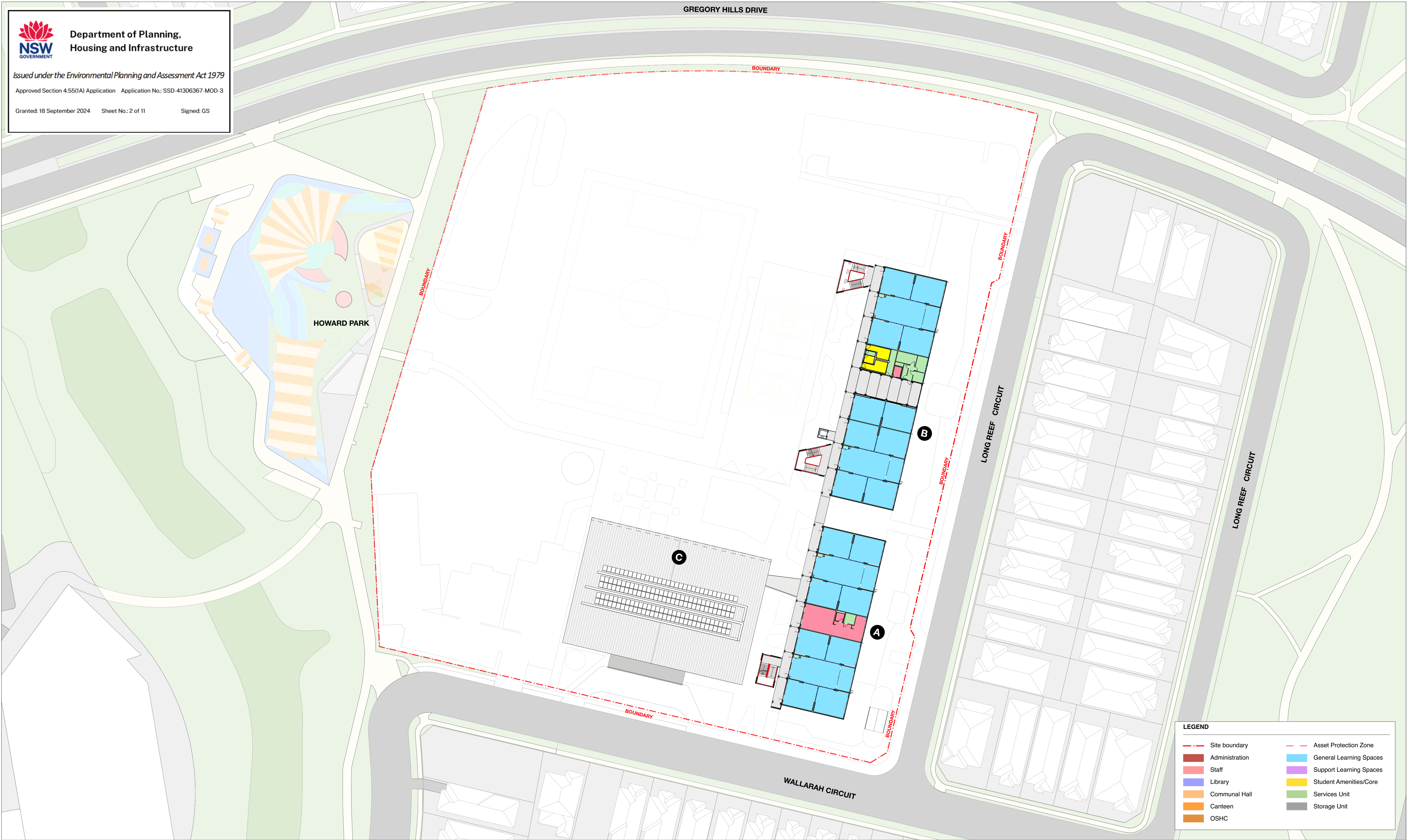

1

NORTH

KEY PLAN

LEVEL 1

1:500

Drawing Disclaimer:
Do not scale from drawings.
Verify all dimensions on site before commencing work.

Copying or reproduction of this drawing is strictly prohibited without the consent of Bennett and Trimble

NOTE:
Bennett and Trimble takes no responsibility for external building elements. Anything connected with any design, materials selection, construction or installation of any cladding, facade or external building element must be checked by and remains the responsibility of others, including suitably qualified experts as may be required.

ISSUE		
REV	FOR	Date
B	FINAL DESIGN REPORT REVIEW	23/9/2022
C	FINAL DESIGN REPORT	5/10/2022
D	RESPONSE TO SUBMISSIONS	3/8/2022
E	RESPONSE TO SUBMISSIONS	14/2/2023
F	SSD MODIFICATION	26/6/2024

CLIENT

 **LIPMAN**

LIPMAN
Level 6, 66 Berry St
North Sydney NSW 2060
www.lipman.com.au

ARCHITECT

BENNETT AND TRIMBLE
L2, 333 George Street
Sydney NSW 2000
+61 2 8065 8766
bennettandtrimble.com

ABN 20 125 950 816
NSW Nominated Architects
M Trimble No. 7625
M Bennett No. 8538

PROJECT NAME

GREGORY HILLS PUBLIC SCHOOL

ADDRESS

28 Wallarah Circuit
Gregory Hills NSW 2557

PROJECT NUMBER

211020

STATUS

FOR APPROVAL

DRAWING TITLE

SITE PLAN - L1

DRAWING NUMBER

SSDA.04

REVISION

F

SCALE

1:500 @ A1

DATE

26/6/2024



Department of Planning,
Housing and Infrastructure

Issued under the Environmental Planning and Assessment Act 1979

Approved Section 4.55(1A) Application Application No.: SSD-41306367-MOD-3

Granted: 18 September 2024 Sheet No.: 3 of 11 Signed: GS

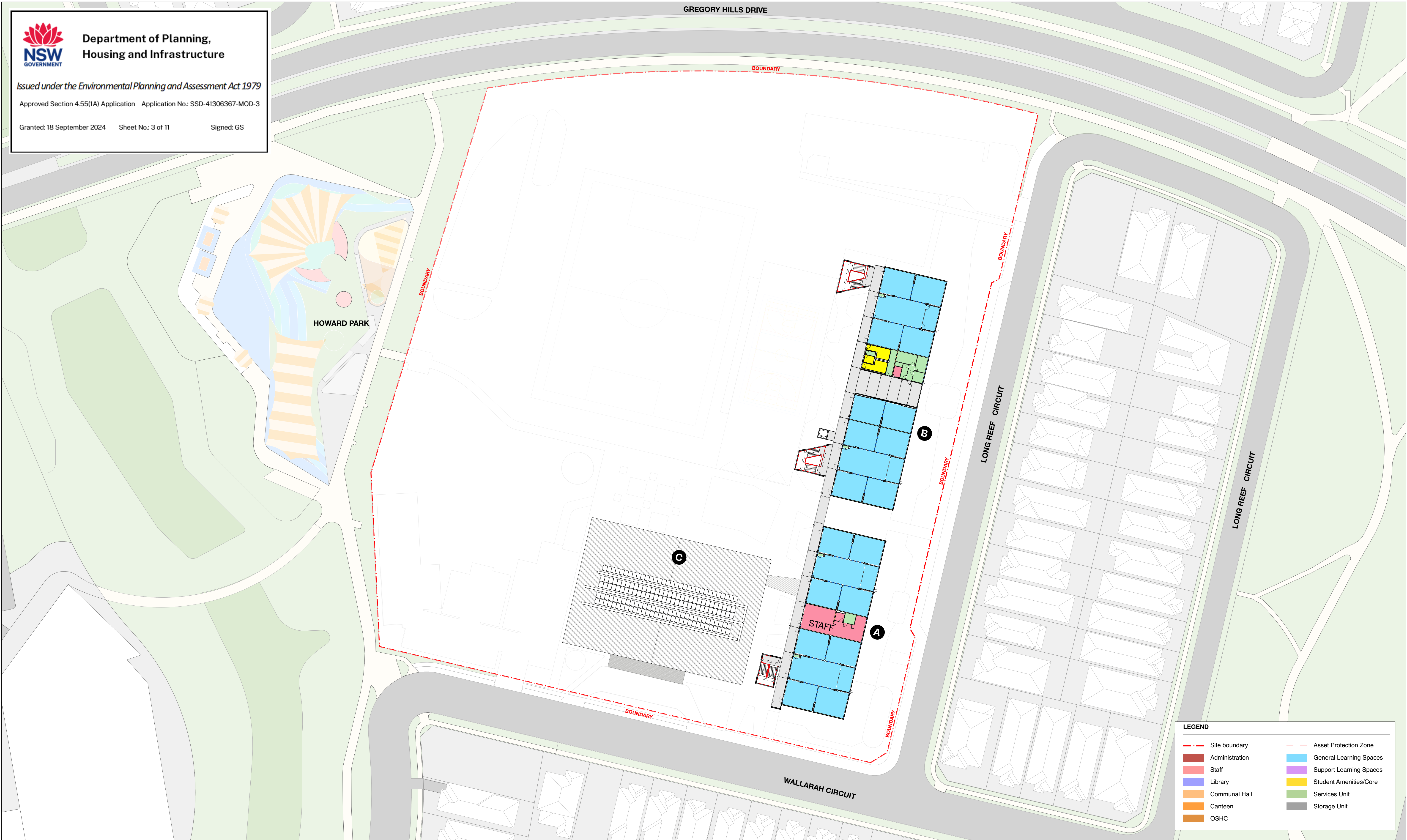

LEGEND

- | | |
|----------------|-------------------------|
| Site boundary | Asset Protection Zone |
| Administration | General Learning Spaces |
| Staff | Support Learning Spaces |
| Library | Student Amenities/Core |
| Communal Hall | Services Unit |
| Canteen | Storage Unit |
| OSHC | |

1

LEVEL 2
1:500

NORTH

KEY PLAN

Drawing Disclaimer:
Do not scale from drawings.
Verify all dimensions on site before
commencing work.

Copying or reproduction of this drawing is
strictly prohibited without the consent of
Bennett and Trimble

NOTE:
Bennett and Trimble takes no responsibility
for external building elements. Anything
connected with any design, materials
selection, construction or installation of any
cladding, facade or external building element
must be checked by and remains the
responsibility of others, including suitably
qualified experts as may be required.

ISSUE

REV	FOR	Date
B	FINAL DESIGN REPORT REVIEW	23/9/2022
C	FINAL DESIGN REPORT	5/10/2022
D	RESPONSE TO SUBMISSIONS	3/8/2022
E	RESPONSE TO SUBMISSIONS	14/2/2023
F	SSD MODIFICATION	26/6/2024

CLIENT



LIPMAN
Level 6, 66 Berry St
North Sydney NSW 2060
www.lipman.com.au

ARCHITECT

BENNETT AND TRIMBLE
L2, 333 George Street
Sydney NSW 2000
+61 2 8065 8766
bennettandtrimble.com

ABN 20 125 950 816
NSW Nominated Architects
M Trimble No. 7625
M Bennett No. 8538

PROJECT NAME

GREGORY HILLS PUBLIC SCHOOL

ADDRESS

28 Wallarah Circuit
Gregory Hills NSW 2557

PROJECT NUMBER

211020

STATUS

FOR APPROVAL

DRAWING TITLE

SITE PLAN - L2

DRAWING NUMBER

SSDA.05

SCALE

1:500 @ A1

REVISION

F

DATE

26/6/2024



Department of Planning,
Housing and Infrastructure

Issued under the Environmental Planning and Assessment Act 1979

Approved Section 4.55(1A) Application Application No: SSD-41306367-MOD-3

Granted: 18 September 2024 Sheet No: 4 of 11

Signed: GS

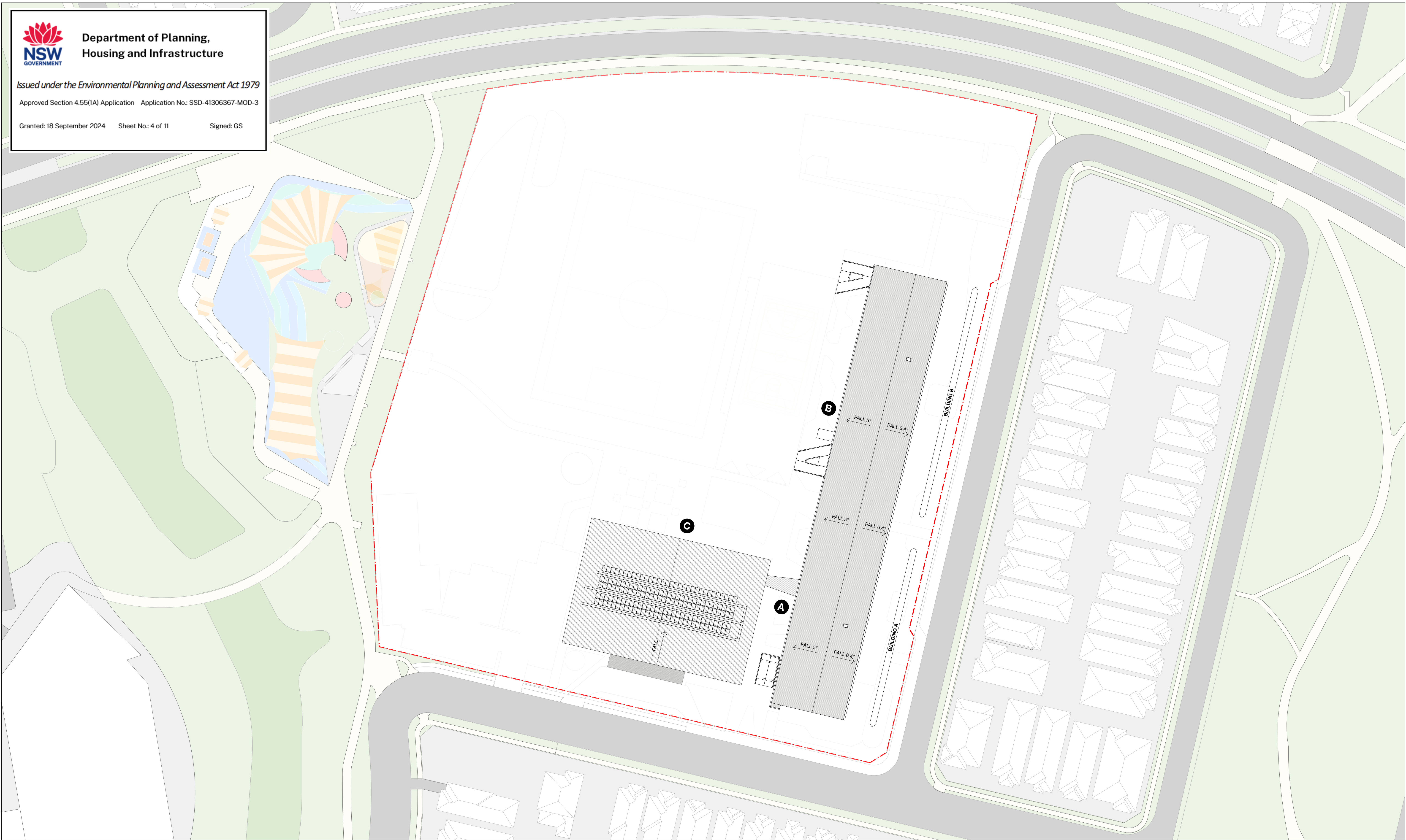

1

ROOF
1:500

NORTH

KEY PLAN

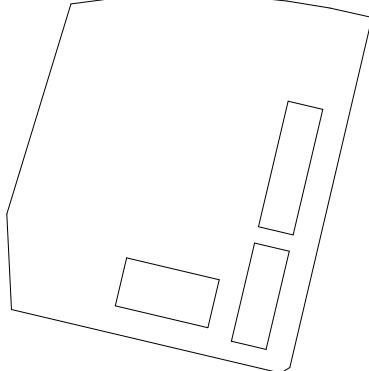

Drawing Disclaimer:
Do not scale from drawings.
Verify all dimensions on site before
commencing work.

Copying or reproduction of this drawing is
strictly prohibited without the consent of
Bennett and Trimble

NOTE:
Bennett and Trimble takes no responsibility
for external building elements. Anything
connected with any design, materials
selection, construction or installation of any
cladding, facade or external building element
must be checked by and remains the
responsibility of others, including suitably
qualified experts as may be required.

ISSUE

REV	FOR	Date
B	FINAL DESIGN REPORT REVIEW	23/9/2022
C	FINAL DESIGN REPORT	5/10/2022
D	RESPONSE TO SUBMISSIONS	3/8/2022
E	RESPONSE TO SUBMISSIONS	14/2/2023
F	SSD MODIFICATION	26/6/2024

CLIENT



LIPMAN
Level 6, 66 Berry St
North Sydney NSW 2060
www.lipman.com.au

ARCHITECT

BENNETT AND TRIMBLE
L2, 333 George Street
Sydney NSW 2000
+61 2 8065 8766
bennettandtrimble.com

ABN 20 125 950 816
NSW Nominated Architects
M Trimble No. 7625
M Bennett No. 8538

PROJECT NAME

GREGORY HILLS PUBLIC SCHOOL

ADDRESS

28 Wallarah Circuit
Gregory Hills NSW 2557

PROJECT NUMBER

211020

STATUS

FOR APPROVAL

DRAWING TITLE

SITE PLAN - ROOF

DRAWING NUMBER

SSDA.06

SCALE

1:500 @ A1

REVISION

F

DATE

26/6/2024

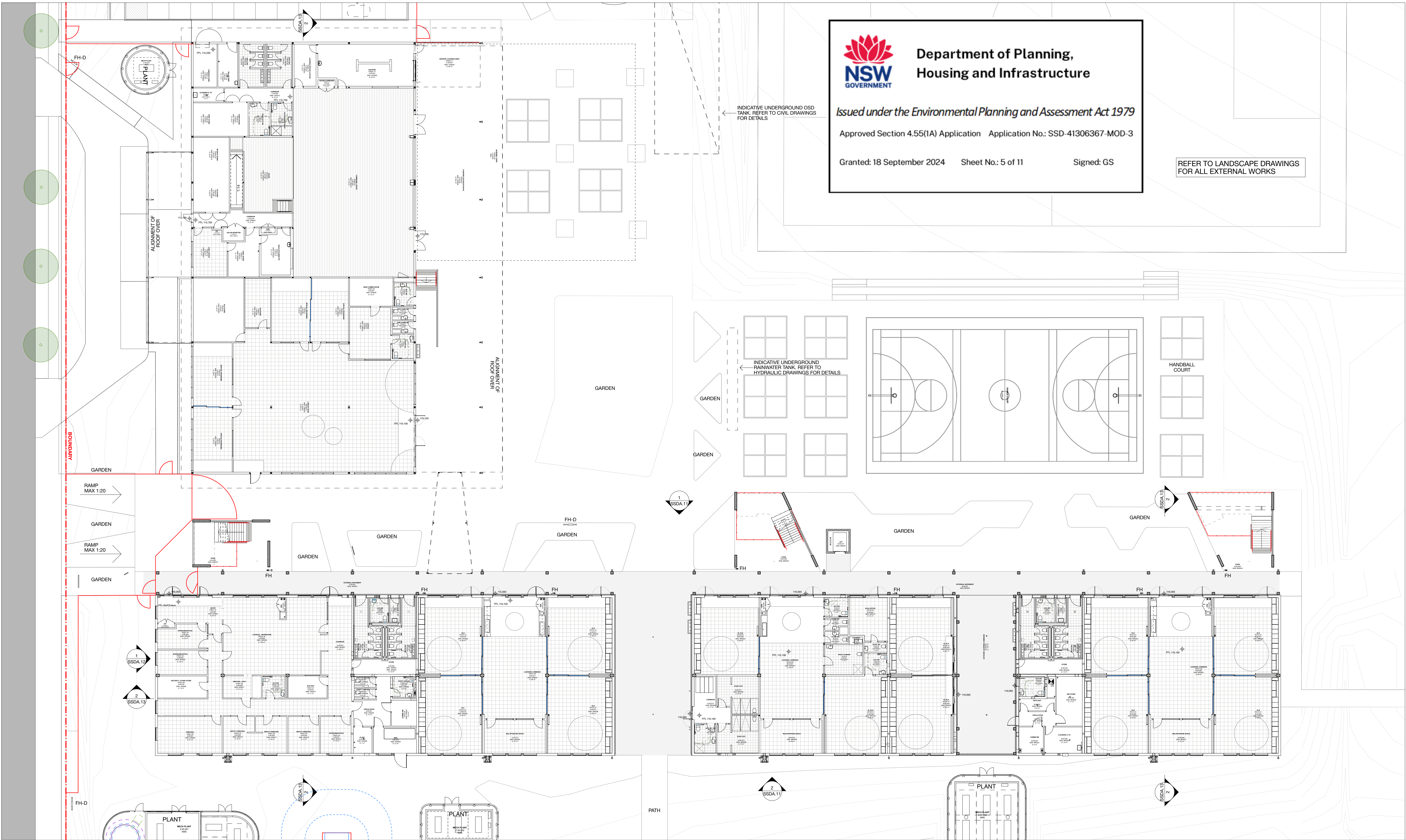

Department of Planning,
Housing and Infrastructure

Issued under the *Environmental Planning and Assessment Act 1979*

Approved Section 4.55(1A) Application Application No.: SSD-41306367-MOD-3

Granted: 18 September 2024

Sheet No.: 5 of 11

Signed: GS

REFER TO LANDSCAPE DRAWINGS
FOR ALL EXTERNAL WORKS

1

NORTH

KEY PLAN

GROUND LEVEL - SSDA
1:200

Drawing Disclaimer:
Do not scale from drawings.
Verify all dimensions on site before
commencing work.

Copying or reproduction of this drawing is
strictly prohibited without the consent of
Bennett and Trimble

NOTE:
Bennett and Trimble takes no responsibility
for external building elements. Anything
connected with any design, materials
selection, construction or installation of any
cladding, facade or external building element
must be checked by and remains the
responsibility of others, including suitably
qualified experts as may be required.

ISSUE

REV	FOR	Date
01	FOR INFORMATION	19/9/2022
B	FINAL DESIGN REPORT REVIEW	23/9/2022
C	FINAL DESIGN REPORT	5/10/2022
D	RESPONSE TO SUBMISSIONS	14/2/2023
E	SSD MODIFICATION	26/6/2024

CLIENT



LIPMAN
Level 6, 66 Berry St
North Sydney NSW 2060
www.lipman.com.au

ARCHITECT
BENNETT AND TRIMBLE
L2, 333 George Street
Sydney NSW 2000
+61 2 8065 8766
bennettandtrimble.com

ABN 20 125 950 816
NSW Nominated Architects
M Trimble No. 7625
M Bennett No. 8538

PROJECT NAME
GREGORY HILLS PUBLIC SCHOOL

ADDRESS
28 Wallarah Circuit
Gregory Hills NSW 2557

PROJECT NUMBER
211020

STATUS
26/6/2024

DRAWING TITLE
GA - GROUND LEVEL

DRAWING NUMBER
SSDA.07

SCALE
1:200 @ A1

REVISION
E

DATE
26/6/2024



LEGEND

Site boundary	2150mm palisade fence	Proposed deciduous trees
Existing contours	900mm mesh fence	Proposed native trees
Proposed contours	900mm masonry fence	Existing trees to be retained
Spot levels	1200mm non-climbable fence	Existing trees to be removed
Concrete paving	Seat	Existing tree protection zone
Games court	Mass planting	
Playground	Turf	
Yarning Circle (turf with sandstone log seat)	Mulch bed	

DIALOGUE

- 1 Main pedestrian entry from Wallarah Circuit formed by a 1 in 20 accessible pathway and terraced steps. Marker tree and feature planting provide an entry statement.
- 2 Low planting, turfed area and deciduous tree planting provide a permeable surface and shade.
- 3 Carpark (South West corner) layout responds to existing Cumberland Plain Woodland trees and reflects bushfire asset protection requirements (holds 60 vehicles).
- 4 Access into school grounds from the carpark (South West corner). Turf cell surfacing with bollards to the edge.
- 5 Retention of existing Cumberland Plain Woodland (*Eucalyptus tereticornis*) trees that are in good health. Removal of (*Eucalyptus tereticornis*) trees that are dead, in poor health or pose a risk to future users (as per Arboricultural Assessment Report dated 07-10-2022).
- 6 Trees to be removed will have their stumps and the root systems retained during removal to minimise the disturbance to trees identified as retained. The area identified as Cumberland Plain Woodland is to be fenced off and left to rehabilitate naturally (as per Ecological Report dated 20.02.2023)
- 7 Situated outside of risk of potential limb dropping, the Yarning Circle sits with an outlook towards onto the remnant Cumberland Plain Woodland.
- 8 COLA forecourt/assembly area with handball courts, native tree planting and seating.
- 9 Extent of cumberland plain woodland Patch and 10m offset (ecological assessment report prepared by kleinfelder 1 october 2022)
- 10 Turf lawn with deciduous tree planting provides a comfortable place for flexible outdoor learning connected to the Library.
- 11 Bike storage area
- 12 Secondary pedestrian and bike entrance from Long Reef Circuit
- 13 Varying sizes of outdoor learning connected to general learning areas and games court. Mix of evergreen and deciduous tree planting provides shade.
- 14 Tree planting along pedestrian pathways
- 15 Secondary pedestrian and bike entrance with bike racks, from Howard Park and riparian
- 16 Nature play with a range of climbing, and outdoor learning opportunities. Re-use of on-site tree logs sit within the garden to provide a border.
- 17 Planted on-site dention and bio-retention basins
- 18 Extension of the Cumberland Plain Woodland character with informal tree planting to the school around the perimeter, providing a buffer between the basin and swale.
- 19 Under 11 sized playing field allows all age groups to compete.
- 20 Tiered seating with staired access provides seating and viewing opportunities over the playing field
- 21 Multi use games court and handball courts
- 22 Open play space
- 23 Informal groups of native trees in mulch to street frontage. Turf to the building frontage provides open access.
- 24 Existing carpark (North East) waste pad and footpath to be retained

LIST OF CHANGES

- (7) Yarning circle relocated approximately 1m to the south to accommodate revised internal footpath connecting to the western entry gate
(15) Internal footpath to the western entry gate adjusted to accommodate the sports field which is to be relocated to the south. Footpath is designed is 2.4m wide, minimum 1:20 gradients and 600mm kerb grading either side of the footpath for accessible compliance.
(16) Playground adjustment to coordinate with the revised internal footpath connecting to western entry gate
(19) Sports field relocated to the south to provide a larger open space area to the north of the field in-lieu of two smaller open space areas



Department of Planning,
Housing and Infrastructure

Issued under the Environmental Planning and Assessment Act 1979

Approved Section 4.55(1A) Application Application No.: SSD-41306367-MOD-3

Granted: 18 September 2024

Sheet No.: 7 of 11

Signed: GS



Perimeter planting



Grassed bank



Nature Play



Playing field



Shaded outdoor learning



Tiered seating



Bike parking



Deciduous trees



Entry planting



LIST OF CHANGES

- (7) Yarning circle relocated approximately 1m to the south to accommodate revised internal footpath connecting to the western entry gate
- (15) Internal footpath to the western entry gate adjusted to accommodate the sports field which is to be relocated to the south. Footpath is designed is 2.4m wide, minimum 1:20 gradients and 600mm kerb grading either side of the footpath for accessible compliance.
- (16) Playground adjustment to coordinate with the revised internal footpath connecting to western entry gate
- (19) Sports field relocated to the south to provide a larger open space area to the north of the field in-lieu of two smaller open space areas

SECTION ELEVATIONS

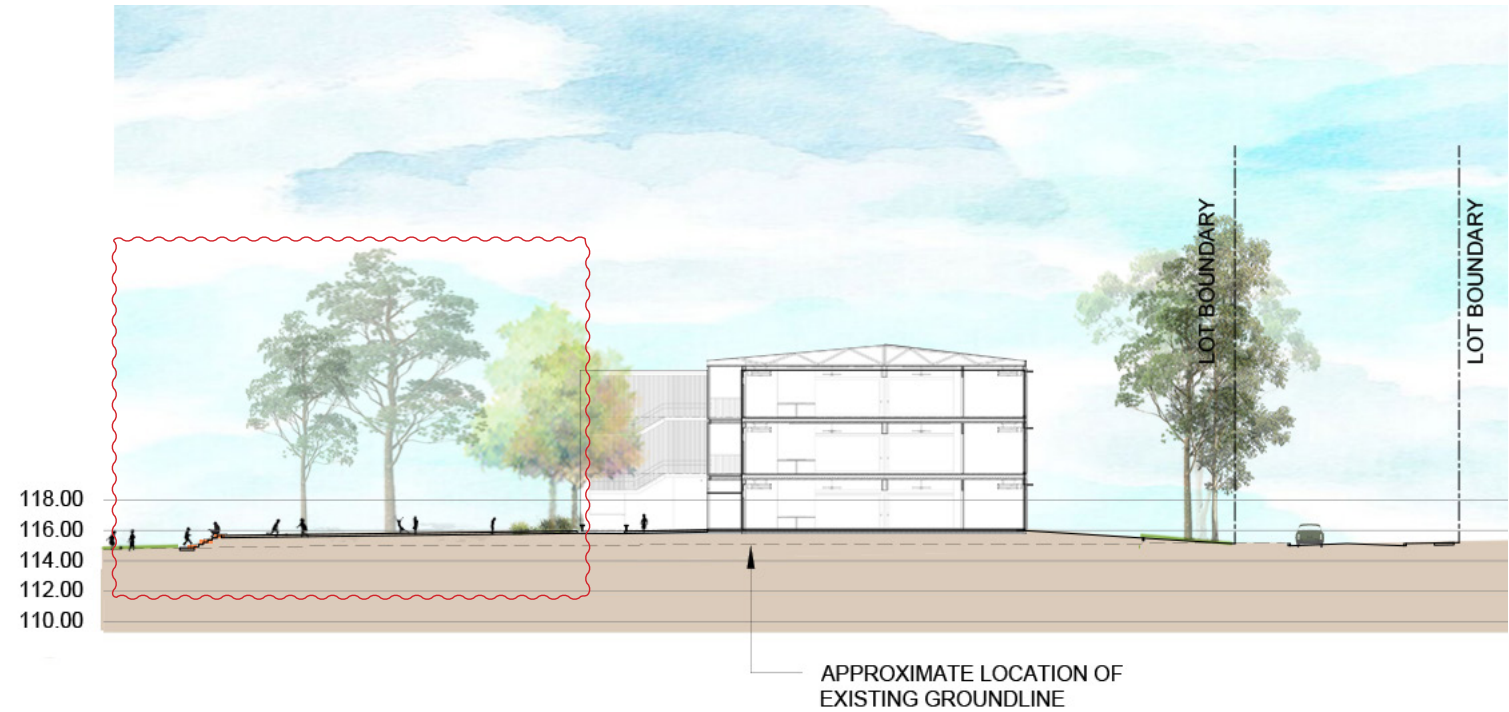

SECTION AA 1:100 @ A3



Department of Planning,
Housing and Infrastructure

Issued under the Environmental Planning and Assessment Act 1979

Approved Section 4.55(1A) Application Application No.: SSD-41306367-MOD-3

Granted: 18 September 2024 Sheet No.: 8 of 11 Signed: GS



KEY PLAN

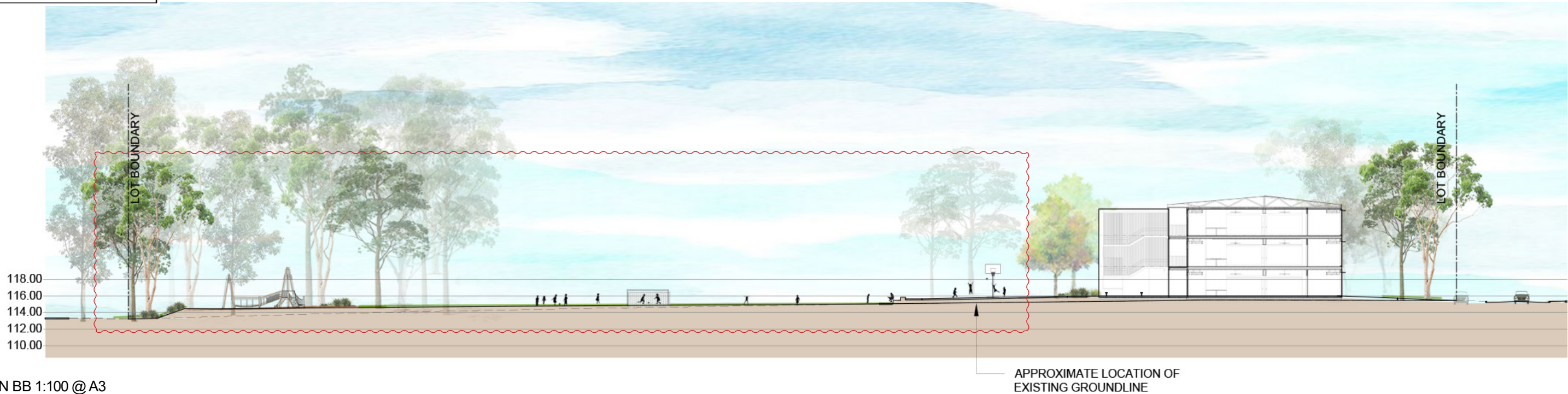

SECTION BB 1:100 @ A3

LIST OF CHANGES	
Cross sections updated to reflect the changes.	

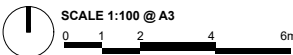

Landscape Section Elevations

Project: New Primary School in Gregory Hills
Client: Lipman
Date: 04.07.2024

Revision: 10
Drawn: ES/BH
Checked: JH

TaylorBrammer

GH_LA_SSDA_1002



Department of Planning,
Housing and Infrastructure

Issued under the Environmental Planning and Assessment Act 1979

Approved Section 4.55(1A) Application Application No.: SSD-41306367-MOD-3

Granted: 18 September 2024 Sheet No.: 9 of 11 Signed: GS



KEY PLAN

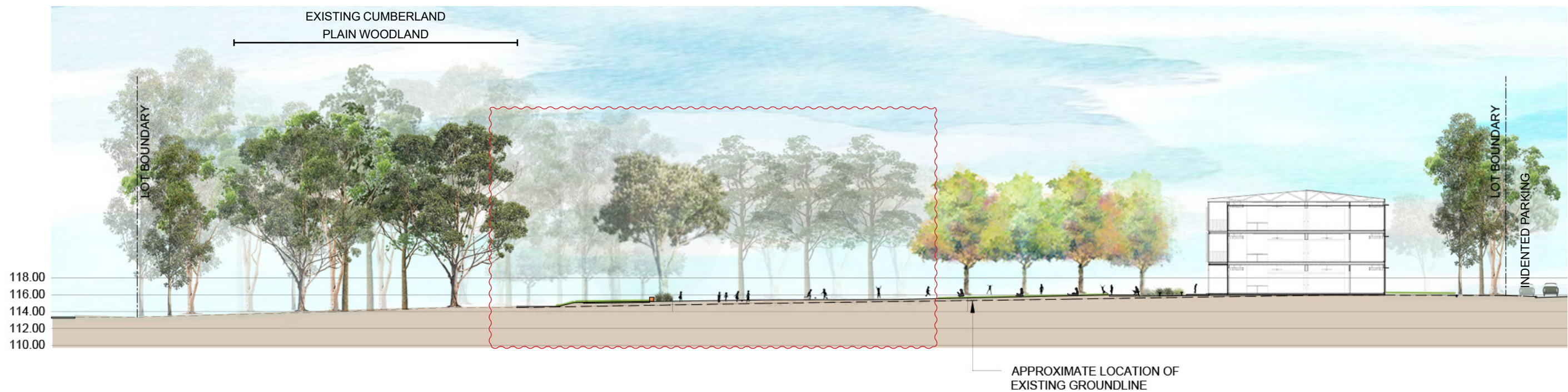

SECTION CC 1:100 @ A3

LIST OF CHANGES
Cross sections updated to reflect the changes.

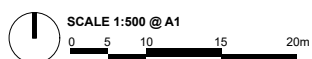

Landscape Section Elevations

Project: New Primary School in Gregory Hills
Client: Lipman
Date: 04.07.2024

Revision: 10
Drawn: ES/BH
Checked: JH

TaylorBrammer

GH_LA_SSDA_1003

PLANTING STRATEGY

The below planting strategy refers to the Plant Schedule in regards to species selection.



The plants species for the Gregory Hills Public school have been carefully selected from the local indigenous ecological community of the Cumberland Plain Woodland. Local indigenous species have also been selected from the Camden LGA Indicative Planting list.

Suitable species of the Cumberland Plain Woodland that can be supported on the school site have been selected to assist in highlighting the remnant cluster of *Eucalyptus tereticornis* in the sites south-west corner while also providing great educational value. This existing character is to be extended and enhanced to the school perimeter in informal groups to provide a vegetation buffer that is suitable for the locality.

Suitable deciduous trees have been chosen to provide colour and balance to the existing school paved areas that will provide comfort and shade during the summer and allow for sunlight during the winter. Suitable trees have been selected to integrate into the existing vegetation and character of the site at the street frontage. Marker trees that are uniquely identifiable have been chosen at points of entry to the school.

Species selection for the carpark (South West corner) retains the native character that is present adjacent in the existing Cumberland Plain Woodland tree cluster. Trees have been strategically placed to provide the greatest amount of shade while meeting bushfire asset protection guidelines.

Shrubs and groundcovers that are not sharp or poisonous have been specifically selected for safety. The species are also suitable climatically, low maintenance and water wise.

References

- 1. Cumberland Plain Woodland in the Sydney Basin Bioregion - critically endangered ecological community listing, NSW Department of Planning, Industry and Environment, 27 May 2019 <https://www.environment.nsw.gov.au/topics/animals-and-plants/threatened-species/nsw-threatened-species-scientific-committee/determinations/final-determinations/2008-2010/cumberland-plain-woodland-critically-endangered-ecological-community-listing>
- 2. Indicative Planting Lists for the Camden LGA <https://www.camden.nsw.gov.au/assets/pdfs/Council/Plans-and-Strategies/General-and-BASIX-Indicative-Tree-List.pdf>

BOTANICAL NAME	COMMON NAME	QUANTITY	POT SIZE	SPACING	HEIGHT X WIDTH	NATIVE	PERIMETER	STREET FRONTAGE	CARPARK	ENTRY	GENERAL	BIO-RETENTION BASIN
CUMBERLAND PLAINS WOODLAND PLANT SCHEDULE												
TREES												
Acacia floribuna	Gossamer Wattle	4	300 pot	As Shown	3m x 6m	Y						
Brachychiton populneus	Kurrajong Tree	14	400L	As Shown	15m x 8m	Y						
Casuarina glauca	She Oak	36	300 pot	As Shown	15m x 8m	Y						
Eucalyptus crebra	Narrow Leaved Ironbark	2	300 pot	As Shown	18m x 12m	Y						
Eucalyptus tereticornis	Forest Red Gum	1	300 pot	As Shown	25m x 15m	Y						
Eucalyptus moluccana	Grey Box	2	300 pot	As Shown	25m x 15m	Y						
Melaleuca decora	White Feather Honey Myrtle	7	300 pot	As Shown	10m x 5m	Y						
Melaleuca quinquenervia	Broad-Leaf Paperbark	3	300 pot	As Shown	12m x 4m	Y						
Melaleuca styphelioides	Prickly leaf paperbark	9	300 pot	As Shown	10m x 8m	Y						

SHRUBS												
Bursaria spinosa	Sweet Bursaria	10	150mm	As Shown	4m x 3m	Y						
GRASSES AND GROUNDCOVERS												
Brachyscome angustifolia	Rock Daisy	3	150mm	4/m2	0.4m x 0.3m	Y						
Brachyscome multifida	Cut-leaved Daisy	39	150mm	4/m2	0.3m x 0.3m	Y						
Dianella longifolia	Flax Lily	183	150mm	4/m2	1m x 1m	Y						
Dianella revoluta	Black Anther Flax Lily	183	150mm	4/m2	0.4m x 0.4m	Y						
Hardenbergia violacea	Purple Coral Pea	359	150mm	4/m2	3 x 2m	Y						
Lomandra multiflora	Mat Rush	839	150mm	4/m2	0.5m x 0.5m	Y						
Scaevola aemula	Fan Flower	12	150mm	4/m2	0.5m x 1m	Y						
Viola hederacea	Native Violet	159	150mm	4/m2	0.15m x 1m	Y						

GENERAL PLANTING												
EVERGREEN TREES												
Allocasuarina littoralis	Narrow She Oak	2	300 pot	As Shown	10m x 5m	Y						
Allocasuarina tortulosa	Forest She Oak	5	300 pot	As Shown	15m x 5m	Y						
Elaeocarpus reticulatus	Blueberry Ash	5	300 pot	As Shown	8m x 6m	Y						
Angophora floribunda	Rough Bark Apple	16	300 pot	As Shown	18m x 10m	Y						
Angophora subvelutina	Broad Leaved Apple	4	300 pot	As Shown	20m x 10m	Y						
Banksia myrtifolia	Grey Myrtle	1	300 pot	As Shown	7m x 4m	Y						
Casuarina cunninghamiana	River Oak	1	300 pot	As Shown	15-30m	Y						
Callistemon viminalis	Weeping Bottlebrush	6	300 pot	As Shown	8m x 4m	Y						

DECIDUOUS TREES												
Brachychiton acerifolius	Illawarra Flame Tree	9	400L	As Shown	12m x 6m	Y						
Pyrus calleryana 'Chanticleer'	Ornamental Pear	14	400L	As Shown	11m x 5m	N						
Zelkova serrata	Japanese Elm	17	400L	As Shown	13m x 10m	N						

SHRUBS												
Aeonium arboreum 'Zwartkop	Black Rose Succulent	5	150mm	As Shown	1m x 0.50m	N						
Banksia spinulosa 'Bush Candles	Hairpin Banksia	10	150mm	As Shown	0.5m x 1.5m	Y						
Breynia cernua	Apple Berry	14	150mm	As Shown	2m x 1m	Y						
Casuarina glauca 'Cousin It	Casuarina shagpile	26	150mm	As Shown	0.1m x 1m	Y						
Cordyline fruticosa 'Rubra'		56	150mm	As Shown	1.5 x 1m	Y						
Doryanthes excelsa	Gymea Lily	16	150mm	As Shown	3m x 4m	Y						
Ozothamnus diasmifolius	Rice Flower	12	150mm	As Shown	1.5 x 1.5	Y						



Department of Planning,
Housing and Infrastructure

Issued under the Environmental Planning and Assessment Act 1979

Approved Section 4.55(1A) Application Application No.: SSD-41306367-MOD-3

Granted: 18 September 2024 Sheet No.: 10 of 11 Signed: GS

PLANTING IMAGERY



Acacia floribuna



Casuarina glauca



Eucalyptus tereticornis



Bursaria spinosa



Hardenbergia violacea

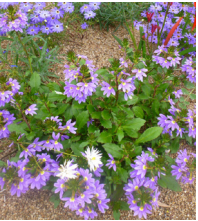

Scaevola aemula



Allocasuarina littoralis



Elaeocarpus reticulatus



Callistemon viminalis



Brachychiton acerifolius



Pyrus calleryana
'Chanticleer'



Zelkova serrata



Aeonium arboreum
'Zwartkop



Banksia spinulosa
'Bush Candles



Ozothamnus diasmifolius

PLANTING STRATEGY

The below planting strategy refers to the Plant Schedule in regards to species selection.



GROUNDCOVERS												
<i>Achillea millefolium</i> 'Terracotta'	Yarrow	359	150mm	4/m2	0.5 x 0.5m	N						
<i>Bergenia cordifolia</i>	Elephant's Ears, Saxifraga0.20 x	56	150mm	4/m2	0.6 0.5m	N						
<i>Bidens ferulifolia</i> 'Campfire'	Biden's Campfire	11	150mm	4/m2	0.5 x 0.5	N						
<i>Lomandra</i> 'Little Con'	Mat Rush	96	150mm	4/m2	0.3 x 0.3m	Y						
<i>Clematis armandii</i>	Evergreen Clematis	359	150mm	4/m2	9 x 1m	Y						
<i>Ajuga australis</i>	Australian Bugle	56	150mm	4/m2	0.5 x 3m	Y						

GRASSES												
<i>Carex appressa</i>	Tall Sedge	839	150mm	4/m2	1m x 1m	Y						
<i>Dianella caerulea</i>	Blue Flax Lily	183	150mm	4/m2	1m x 2m	Y						
<i>Festuca glauca</i>	Blue tussock	240	150mm	4/m2	0.4 x 0.4	N						
<i>Juncus usitatus</i>	Common Rush	183	150mm	4/m2	1.2m x 1m	Y						
<i>Lomandra confertifolia</i>	Mat Rush	839	150mm	4/m2	0.4m x 0.7m	Y						
<i>Lomandra longifolia</i>	Mat Rush	839	150mm	4/m2	1m x 0.6m	Y						
<i>Microlaena stipoides</i>	Weeping Grass	240	150mm	4/m2	0.6m x 0.3m	Y						
<i>Poa labillardierei</i> var. <i>labillardierei</i>	Tufted Grass	574	150mm	4/m2	0.8m x 0.3m	Y						
<i>Rydosperma caespitosum</i>	Wallaby Grass	240	150mm	4/m2	0.70 x .30	Y						
<i>Themeda triandra</i>	Kangaroo Grass	574	150mm	4/m2	0.5m x 0.5m	Y						

BIO-RETENTION BASIN												
<i>Austrostipa stipoides</i>	Coast Spear Grass	600	150mm	4/m2	0.8 x 0.8m	Y						
<i>Bolboschoenus caldwellii</i>	Marsh Club Rush	600	150mm	4/m2	1 x 0.6m	Y						
<i>Carex appressa</i>	Tall Sedge	600	150mm	4/m2	0.60 x 0.60	Y						
<i>Ficinia nodosa</i>	Knobby Club Rush	600	150mm	4/m2	1m x 0.60m	Y						
<i>Ghania filum</i>	Saw Sedge	600	150mm	4/m2	1m x 1m	Y						
<i>Juncus usitas</i>	Sedge	600	150mm	4/m2	1m x 0.60m	Y						
<i>Lomandra longifolia</i>	Mat Rush	600	150mm	4/m2	1m x 1m	Y						

PLANTING IMAGERY

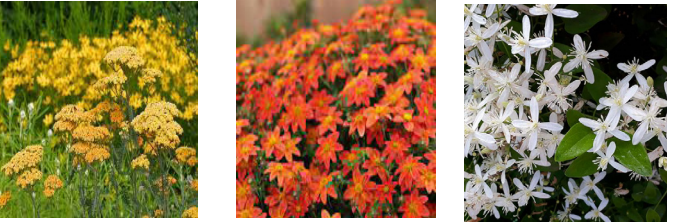

Achillea millefolium 'Terracotta' *Bidens ferulifolia* 'Campfire' *Clematis armandii*



Festuca glauca *Rydosperma caespitosum* *Themeda triandra*



Austrostipa stipoides *Ghania filum* *Juncus usitas*