

1 JUNE 21ST - 9AM
1:1000

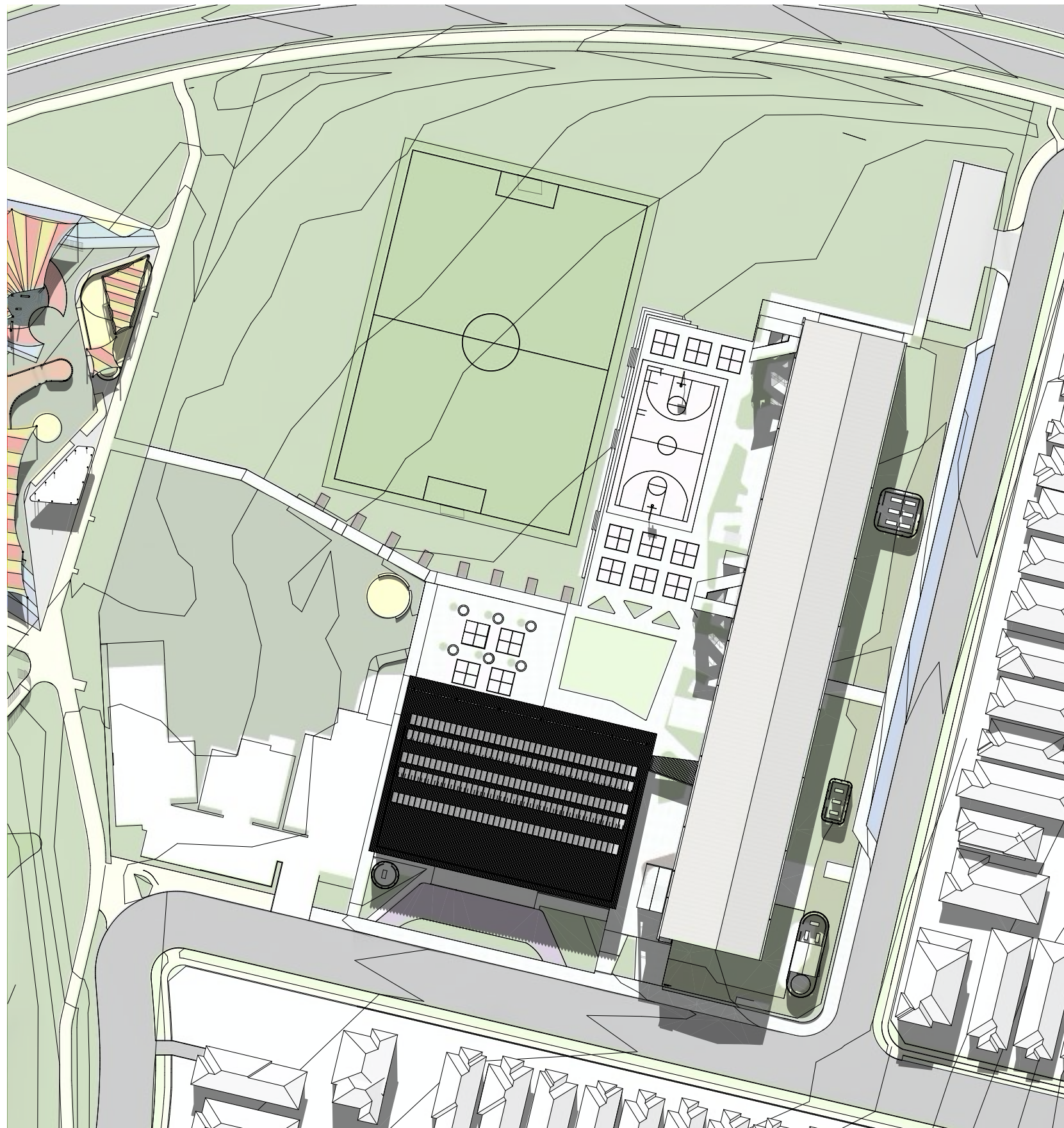

2 JUNE 21ST - 12PM
1:1000

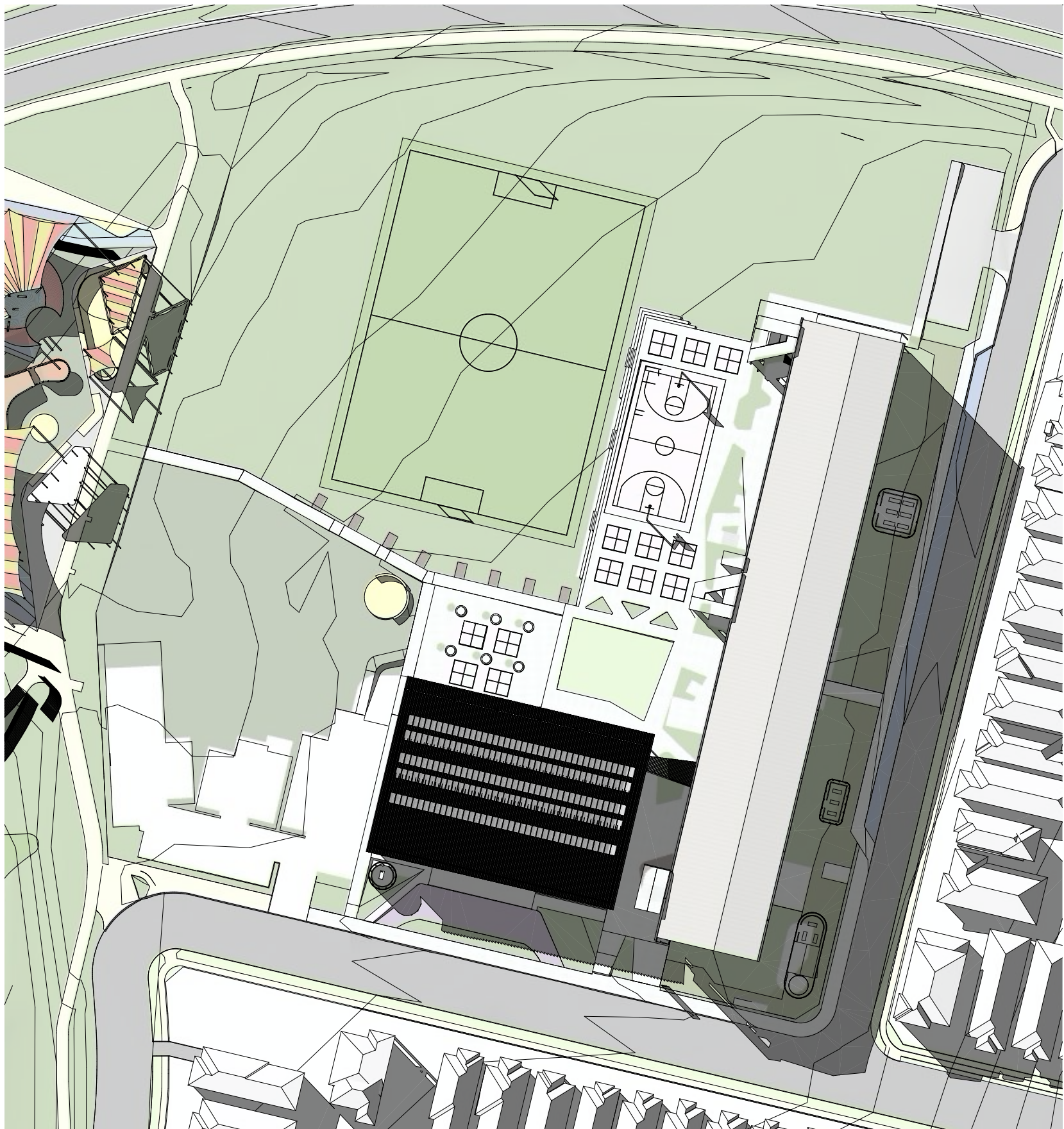

3 JUNE 21ST - 3PM
1:1000

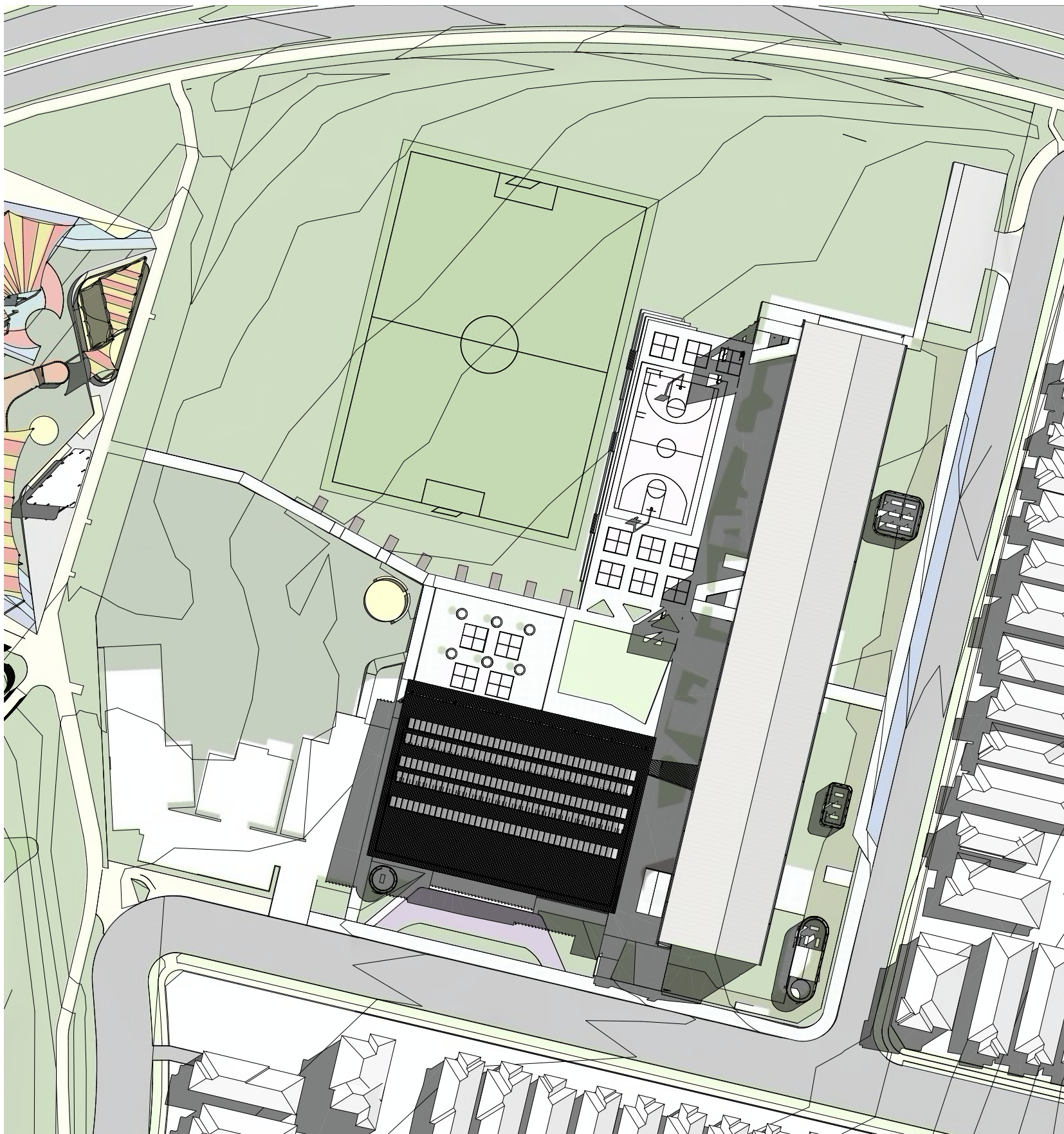

4 SEPTEMBER 21ST 9AM
1:1000

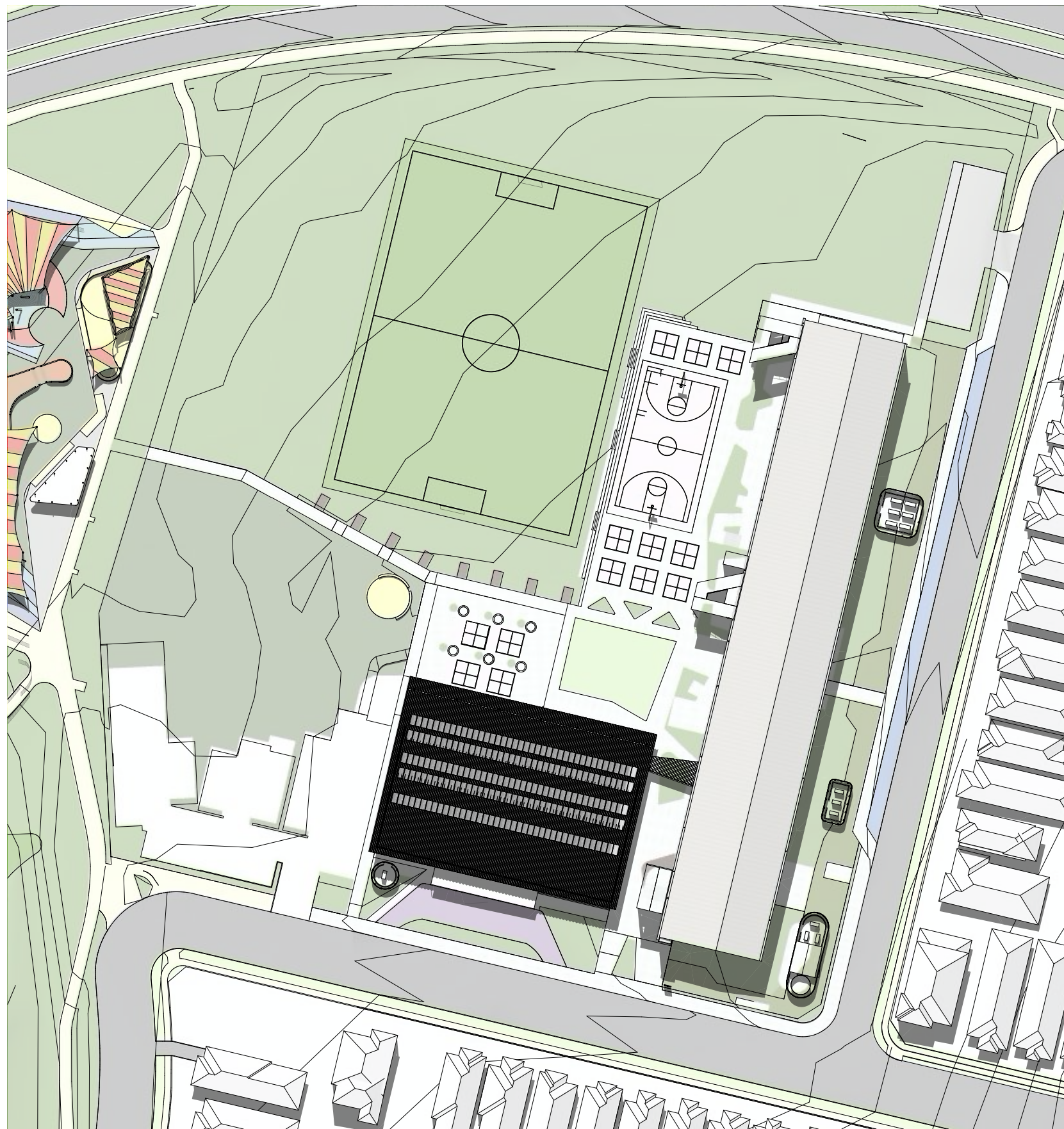

5 SEPTEMBER 21ST 12PM
1:1000

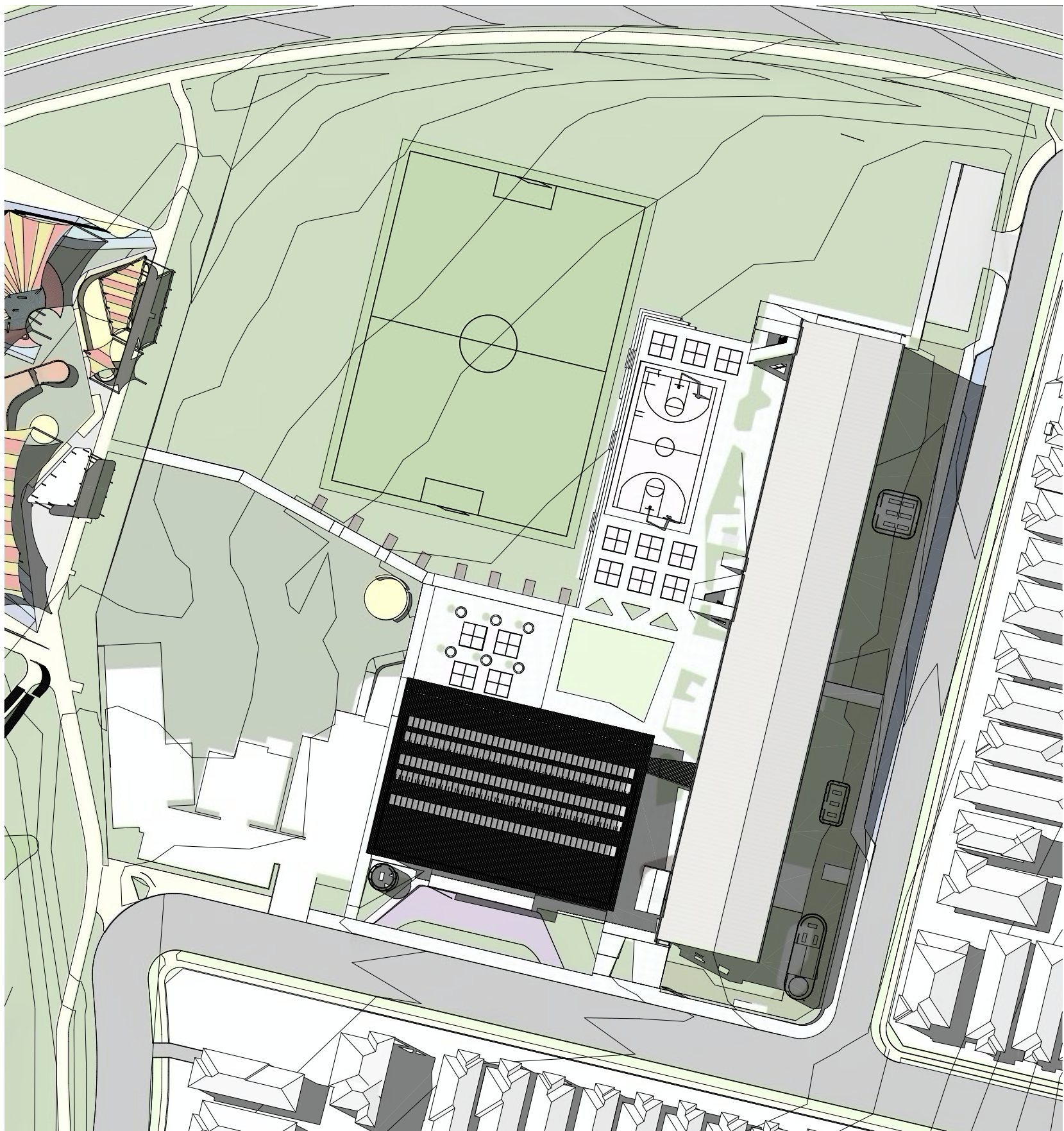

6 SEPTEMBER 21ST 3PM
1:1000

NORTH

KEY PLAN

Drawing Disclaimer:
Do not scale from drawings.
Verify all dimensions on site before commencing work.

Copying or reproduction of this drawing is strictly prohibited without the consent of Bennett and Trimble

NOTE:
Bennett and Trimble takes no responsibility for external building elements. Anything connected with any design, materials selection, construction or installation of any cladding, facade or external building element must be checked by and remains the responsibility of others, including suitably qualified experts as may be required.

ISSUE		
REV	FOR	Date
01	FOR INFORMATION	19/9/2022
B	FINAL DESIGN REPORT REVIEW	23/9/2022
C	FINAL DESIGN REPORT	5/10/2022
D	RESPONSE TO SUBMISSIONS	14/2/2023

CLIENT

LIPMAN
Level 6, 66 Berry St
North Sydney NSW 2060
www.lipman.com.au

ARCHITECT
BENNETT AND TRIMBLE
L2, 333 George Street
Sydney NSW 2000
+61 2 8065 8766
bennettandtrimble.com

ABN 20 125 950 816
NSW Nominated Architects
M Trimble No. 7625
M Bennett No. 8538

PROJECT NAME
NEW PRIMARY SCHOOL AT GREGORY HILLS

ADDRESS
28 Wallarah Circuit
Gregory Hills NSW 2557

PROJECT NUMBER
211020

STATUS
DETAILED DESIGN

DRAWING TITLE
SHADOW DIAGRAMS

DRAWING NUMBER
SSDA.16

SCALE
1:1000 @ A1

REVISION
D

DATE
14/2/2023



1 **TEMPORARY SCHOOL RETENTION PLAN**
1:500

NORTH

KEY PLAN

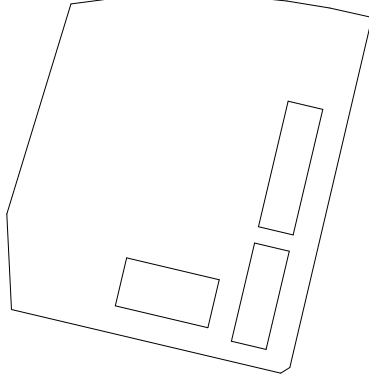

Drawing Disclaimer:
Do not scale from drawings.
Verify all dimensions on site before commencing work.

Copying or reproduction of this drawing is strictly prohibited without the consent of Bennett and Trimble

NOTE:
Bennett and Trimble takes no responsibility for external building elements. Anything connected with any design, materials selection, construction or installation of any cladding, facade or external building element must be checked by and remains the responsibility of others, including suitably qualified experts as may be required.

ISSUE		
REV	FOR	Date
A	RESPONSE TO SUBMISSIONS	16/5/2023

CLIENT

 **LIPMAN**

LIPMAN
Level 6, 66 Berry St
North Sydney NSW 2060
www.lipman.com.au

ARCHITECT
BENNETT AND TRIMBLE
L2, 333 George Street
Sydney NSW 2000
+61 2 8065 8766
bennettandtrimble.com

ABN 20 125 950 816
NSW Nominated Architects
M Trimble No. 7625
M Bennett No. 8538

PROJECT NAME
NEW PRIMARY SCHOOL AT GREGORY HILLS

ADDRESS
28 Wallarah Circuit
Gregory Hills NSW 2557

PROJECT NUMBER
211020

STATUS
DETAILED DESIGN

DRAWING TITLE
TEMPORARY SCHOOL RETENTION PLAN

DRAWING NUMBER
SSDA.17

REVISION
A

SCALE
1:500 @ A1

DATE
16/5/2023