

NEW PRIMARY SCHOOL AT GREGORY HILLS



		REVISION
ARCHITECTURAL PLANS		
COVER	SSDA.01	D
EXISTING SITE PLAN	SSDA.02	D
SITE PLAN - GF	SSDA.03	F
SITE PLAN - L1	SSDA.04	E
SITE PLAN - L2	SSDA.05	E
SITE PLAN - ROOF	SSDA.06	E
GA - GROUND LEVEL	SSDA.07	D
GA - LEVEL 1	SSDA.08	D
GA - LEVEL 2	SSDA.09	D
GA - ROOF	SSDA.10	D
ELEVATIONS	SSDA.11	D
ELEVATIONS	SSDA.12	D
SITE SECTIONS	SSDA.13	D
SIGNAGE	SSDA.14	D
MATERIAL SCHEDULE	SSDA.15	D
SHADOW DIAGRAMS	SSDA.16	D

NORTH

KEY PLAN

Drawing Disclaimer:

Do not scale from drawings.
Verify all dimensions on site before commencing work.

Copying or reproduction of this drawing is strictly prohibited without the consent of Bennett and Trimble

NOTE:

Bennett and Trimble takes no responsibility for external building elements. Anything connected with any design, materials selection, construction or installation of any cladding, facade or external building element must be checked by and remains the responsibility of others, including suitably qualified experts as may be required.

ISSUE		
REV	FOR	Date
01	FOR INFORMATION	19/9/2022
B	FINAL DESIGN REPORT REVIEW	23/9/2022
C	FINAL DESIGN REPORT	5/10/2022
D	RESPONSE TO SUBMISSIONS	14/2/2023

CLIENT

LIPMAN

LIPMAN

Level 6, 66 Berry St
North Sydney NSW 2060
www.lipman.com.au

ARCHITECT

BENNETT AND TRIMBLE

L2, 333 George Street
Sydney NSW 2000
+61 2 8065 8766
bennettandtrimble.com

ABN 20 125 950 816
NSW Nominated Architects
M Trimble No. 7625
M Bennett No. 8538

PROJECT NAME

NEW PRIMARY SCHOOL AT GREGORY HILLS

ADDRESS

28 Wallarah Circuit
Gregory Hills NSW 2557

PROJECT NUMBER

211020

STATUS

DETAILED DESIGN

DRAWING TITLE

COVER

DRAWING NUMBER

SSDA.01

REVISION

D

SCALE

@ A1

DATE

14/2/2023



1
EXISTING SITE PLAN
1:500

NORTH

KEY PLAN

Drawing Disclaimer:
Do not scale from drawings.
Verify all dimensions on site before commencing work.

NOTE:
Bennett and Trimble takes no responsibility for external building elements. Anything connected with any design, materials selection, construction or installation of any cladding, facade or external building element must be checked by and remains the responsibility of others, including suitably qualified experts as may be required.

ISSUE		
REV	FOR	Date
01	FOR INFORMATION	19/9/2022
B	FINAL DESIGN REPORT REVIEW	23/9/2022
C	FINAL DESIGN REPORT	5/10/2022
D	RESPONSE TO SUBMISSIONS	14/2/2023

CLIENT

LIPMAN
Level 6, 66 Berry St
North Sydney NSW 2060
www.lipman.com.au

ARCHITECT
BENNETT AND TRIMBLE
L2, 333 George Street
Sydney NSW 2000
+61 2 8065 8766
bennettandtrimble.com

ABN 20 125 950 816
NSW Nominated Architects
M Trimble No. 7625
M Bennett No. 8538

PROJECT NAME
NEW PRIMARY SCHOOL AT GREGORY HILLS

ADDRESS
28 Wallarah Circuit
Gregory Hills NSW 2557

PROJECT NUMBER
211020

STATUS
DETAILED DESIGN

DRAWING TITLE
EXISTING SITE PLAN

DRAWING NUMBER
SSDA.02

SCALE
1:500 @ A1

REVISION
D

DATE
14/2/2023



1
GROUND LEVEL
1:500

NORTH

KEY PLAN

Drawing Disclaimer:
Do not scale from drawings.
Verify all dimensions on site before commencing work.

Copying or reproduction of this drawing is strictly prohibited without the consent of Bennett and Trimble

NOTE:
Bennett and Trimble takes no responsibility for external building elements. Anything connected with any design, materials selection, construction or installation of any cladding, facade or external building element must be checked by and remains the responsibility of others, including suitably qualified experts as may be required.

ISSUE		
REV	FOR	Date
B	FINAL DESIGN REPORT REVIEW	23/9/2022
C	FINAL DESIGN REPORT	29/9/2022
D	FINAL DESIGN REPORT	5/10/2022
E	RESPONSE TO SUBMISSIONS	3/8/2022
F	RESPONSE TO SUBMISSIONS	14/2/2023

CLIENT

LIPMAN
Level 6, 66 Berry St
North Sydney NSW 2060
www.lipman.com.au

ARCHITECT
BENNETT AND TRIMBLE
L2, 333 George Street
Sydney NSW 2000
+61 2 8065 8766
bennettandtrimble.com

ABN 20 125 950 816
NSW Nominated Architects
M Trimble No. 7625
M Bennett No. 8538

PROJECT NAME
NEW PRIMARY SCHOOL AT GREGORY HILLS

ADDRESS
28 Wallarah Circuit
Gregory Hills NSW 2557

PROJECT NUMBER
211020

STATUS
DETAILED DESIGN

DRAWING TITLE
SITE PLAN - GF

DRAWING NUMBER
SSDA.03

SCALE
1:500 @ A1

REVISION
F

DATE
14/2/2023

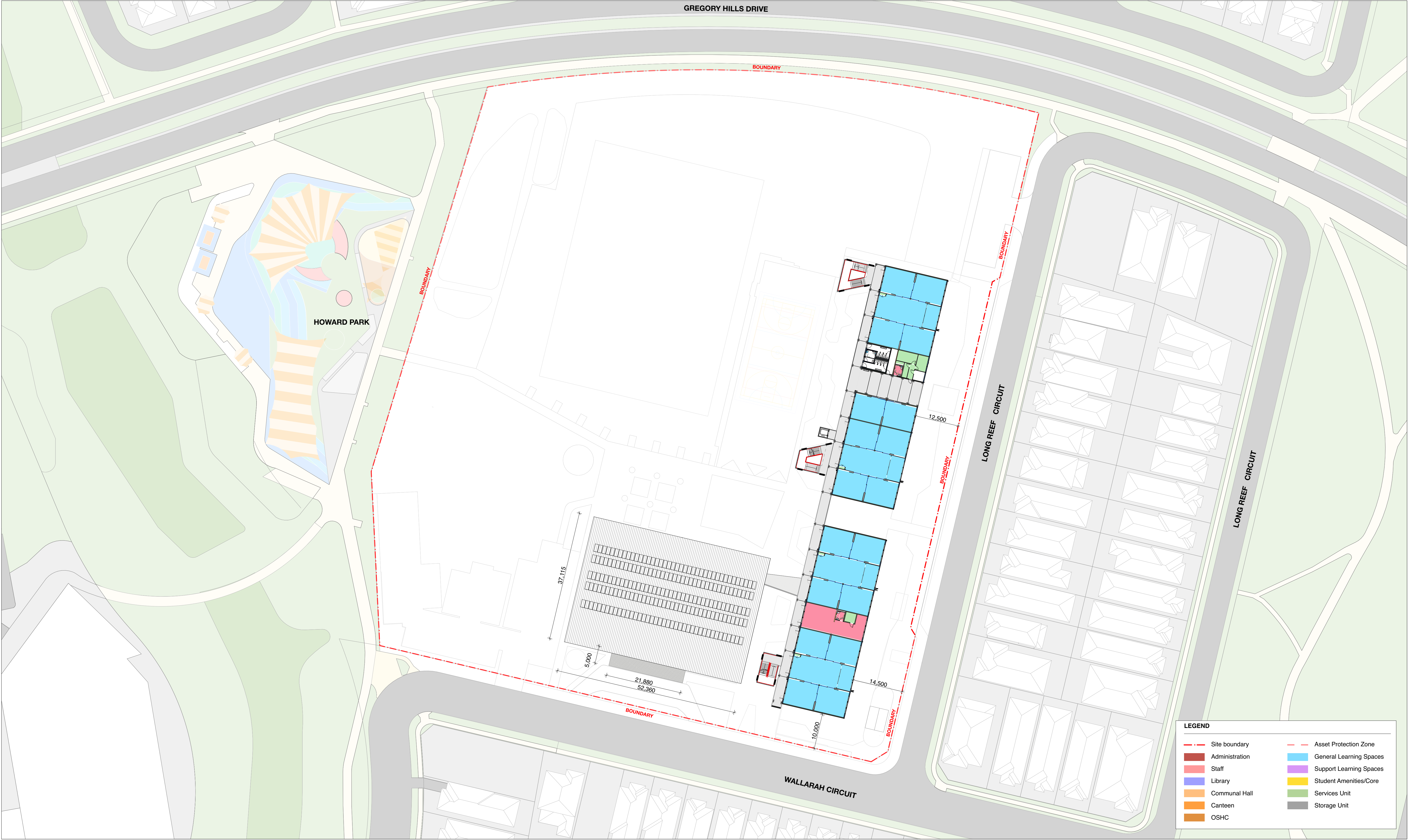

1

NORTH

KEY PLAN

Drawing Disclaimer:

Do not scale from drawings. Verify all dimensions on site before commencing work.

NOTE:

Bennett and Trimble takes no responsibility for external building elements. Anything connected with any design, materials selection, construction or installation of any cladding, facade or external building element must be checked by and remains the responsibility of others, including suitably qualified experts as may be required.

ISSUE		
REV	FOR	Date
01	FOR INFORMATION	19/9/2022
B	FINAL DESIGN REPORT REVIEW	23/9/2022
C	FINAL DESIGN REPORT	5/10/2022
D	RESPONSE TO SUBMISSIONS	3/8/2022
E	RESPONSE TO SUBMISSIONS	14/2/2023

CLIENT

LIPMAN

LIPMAN
Level 6, 66 Berry St
North Sydney NSW 2060
www.lipman.com.au

ARCHITECT

BENNETT AND TRIMBLE
L2, 333 George Street
Sydney NSW 2000
+61 2 8065 8766
bennettandtrimble.com

ABN 20 125 950 816
NSW Nominated Architects
M Trimble No. 7625
M Bennett No. 8538

PROJECT NAME

NEW PRIMARY SCHOOL AT GREGORY HILLS

ADDRESS
28 Wallarah Circuit
Gregory Hills NSW 2557

PROJECT NUMBER
211020

STATUS
DETAILED DESIGN

DRAWING TITLE

SITE PLAN - L1

DRAWING NUMBER
SSDA.04

SCALE
1:500 @ A1

REVISION

E

DATE
14/2/2023

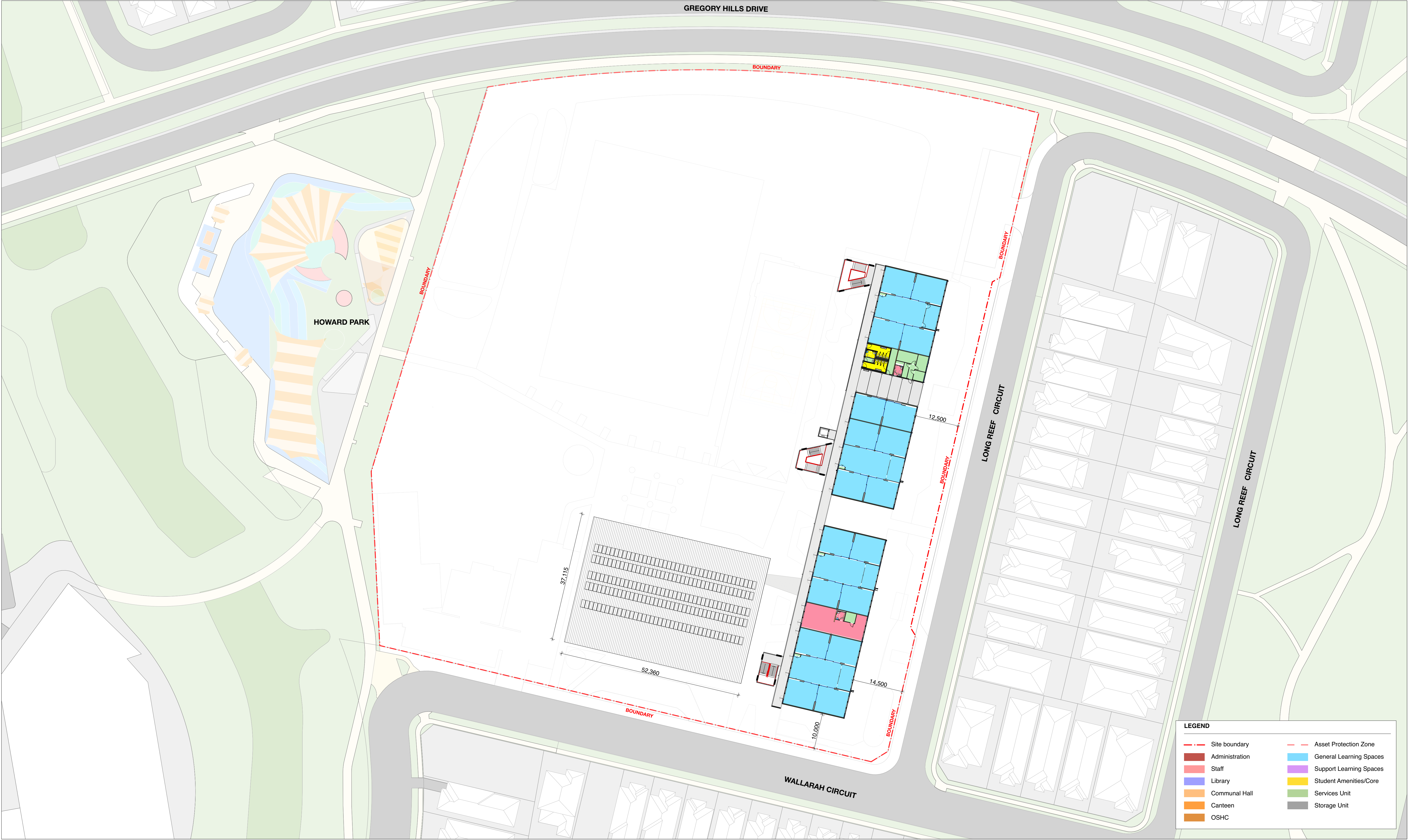

1

NORTH

KEY PLAN

Drawing Disclaimer:

Do not scale from drawings.
Verify all dimensions on site before commencing work.

NOTE:

Bennett and Trimble takes no responsibility for external building elements. Anything connected with any design, materials selection, construction or installation of any cladding, facade or external building element must be checked by and remains the responsibility of others, including suitably qualified experts as may be required.

ISSUE		
REV	FOR	Date
01	FOR INFORMATION	19/9/2022
B	FINAL DESIGN REPORT REVIEW	23/9/2022
C	FINAL DESIGN REPORT	5/10/2022
D	RESPONSE TO SUBMISSIONS	3/8/2022
E	RESPONSE TO SUBMISSIONS	14/2/2023

CLIENT

LIPMAN

LIPMAN

Level 6, 66 Berry St
North Sydney NSW 2060
www.lipman.com.au

ARCHITECT

BENNETT AND TRIMBLE

L2, 333 George Street
Sydney NSW 2000
+61 2 8065 8766
bennettandtrimble.com

ABN 20 125 950 816
NSW Nominated Architects
M Trimble No. 7625
M Bennett No. 8538

PROJECT NAME

NEW PRIMARY SCHOOL AT GREGORY HILLS

ADDRESS

28 Wallarah Circuit
Gregory Hills NSW 2557

PROJECT NUMBER

211020

STATUS

DETAILED DESIGN

DRAWING TITLE

SITE PLAN - L2

DRAWING NUMBER

SSDA.05

SCALE

1:500 @ A1

REVISION

E

DATE

14/2/2023

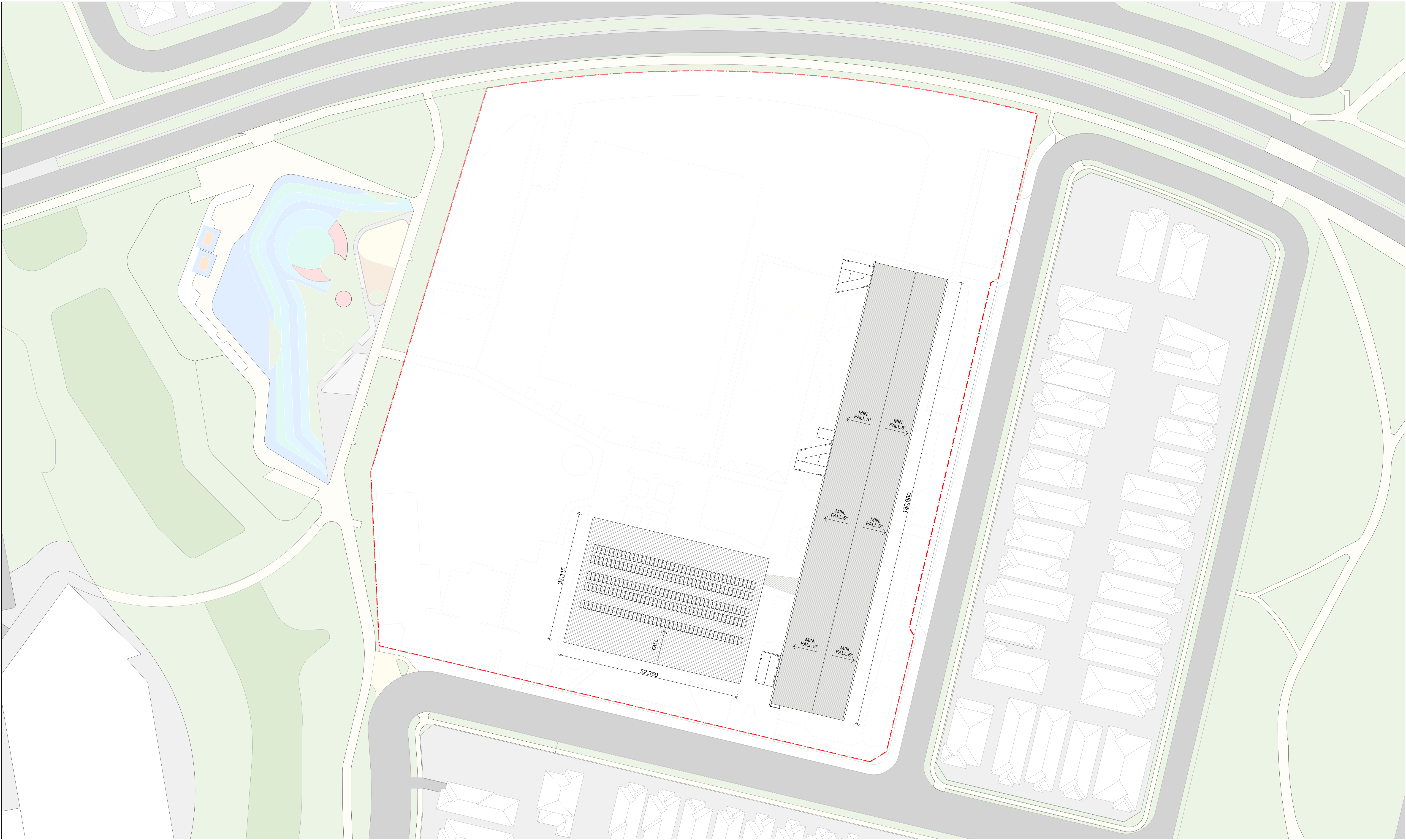

1

ROOF
1:500

1

KEY PLAN

Drawing Disclaimer:
Do not scale from drawings.
Verify all dimensions on site before commencing work.

NOTE:
Bennett and Trimble takes no responsibility for external building elements. Anything connected with any design, materials selection, construction or installation of any cladding, facade or external building element must be checked by and remains the responsibility of others, including suitably qualified experts as may be required.

ISSUE	REV	FOR	Date
	01	FOR INFORMATION	19/9/2022
	B	FINAL DESIGN REPORT REVIEW	23/9/2022
	C	FINAL DESIGN REPORT	5/10/2022
	D	RESPONSE TO SUBMISSIONS	3/8/2022
	E	RESPONSE TO SUBMISSIONS	14/2/2023

CLIENT

LIPMAN

Level 6, 66 Berry St
North Sydney NSW 2060
www.lipman.com.au

ARCHITECT

BENNETT AND TRIMBLE

L2, 333 George Street
Sydney NSW 2000
+61 2 8065 8766
bennettandtrimble.com

ABN 20 125 950 816
NSW Nominated Architects
M Trimble No. 7625
M Bennett No. 8538

PROJECT NAME

NEW PRIMARY SCHOOL AT GREGORY HILLS

ADDRESS

28 Wallarah Circuit
Gregory Hills NSW 2557

PROJECT NUMBER

211020

STATUS

DETAILED DESIGN

DRAWING TITLE

SITE PLAN - ROOF

DRAWING NUMBER

SSDA.06

SCALE

1:500 @ A1

REVISION

E

DATE

14/2/2023



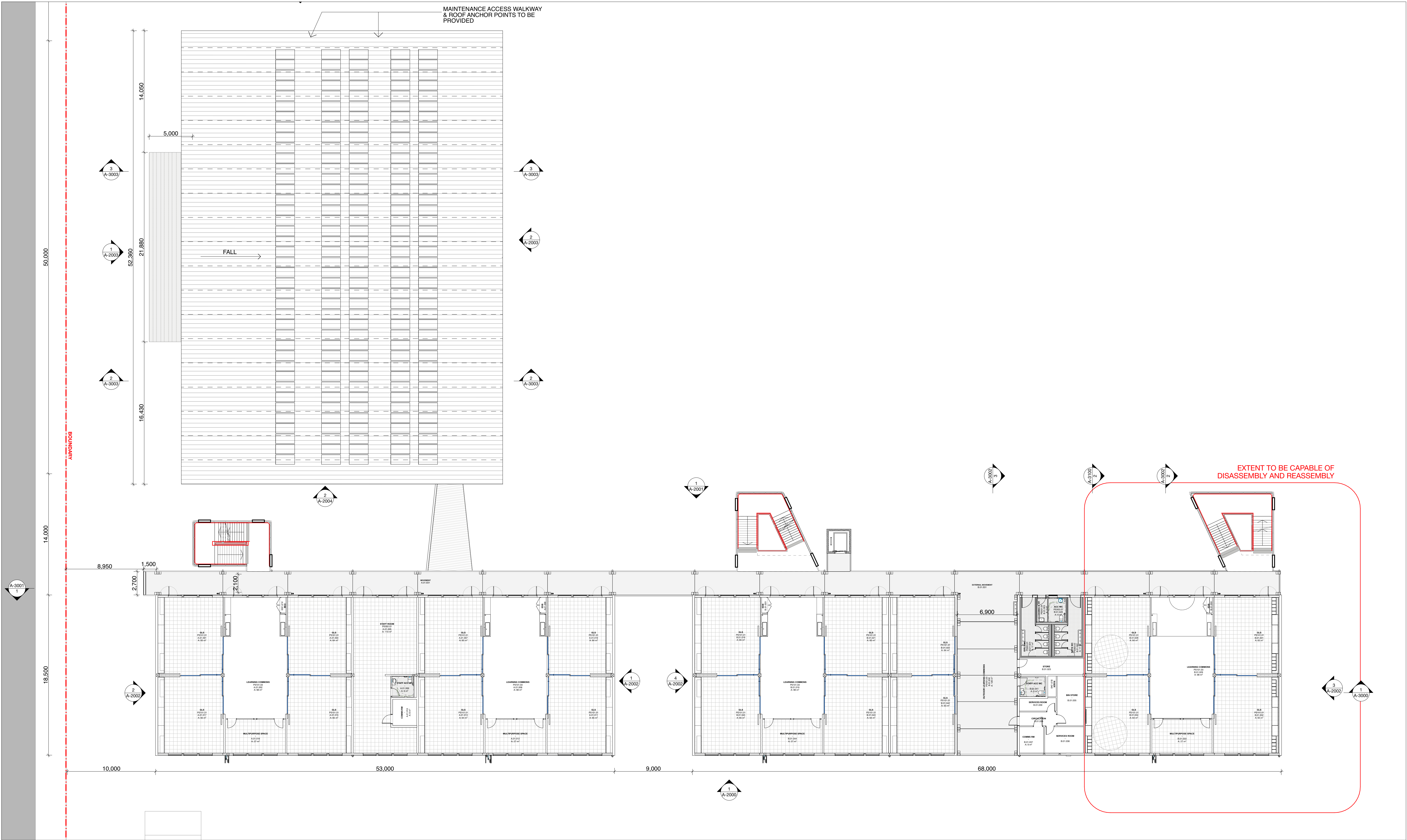

1

NORTH

KEY PLAN

LEVEL 1

1:200

Drawing Disclaimer:
Do not scale from drawings.
Verify all dimensions on site before commencing work.

Copying or reproduction of this drawing is strictly prohibited without the consent of Bennett and Trimble

NOTE:
Bennett and Trimble takes no responsibility for external building elements. Anything connected with any design, materials selection, construction or installation of any cladding, facade or external building element must be checked by and remains the responsibility of others, including suitably qualified experts as may be required.

ISSUE		
REV	FOR	Date
01	FOR INFORMATION	19/9/2022
B	FINAL DESIGN REPORT REVIEW	23/9/2022
C	FINAL DESIGN REPORT	5/10/2022
D	RESPONSE TO SUBMISSIONS	14/2/2023

CLIENT

LIPMAN
Level 6, 66 Berry St
North Sydney NSW 2060
www.lipman.com.au

ARCHITECT

BENNETT AND TRIMBLE
L2, 333 George Street
Sydney NSW 2000
+61 2 8065 8766
bennettandtrimble.com

ABN 20 125 950 816
NSW Nominated Architects
M Trimble No. 7625
M Bennett No. 8538

PROJECT NAME

NEW PRIMARY SCHOOL AT GREGORY HILLS

ADDRESS

28 Wallarah Circuit
Gregory Hills NSW 2557

PROJECT NUMBER

211020

STATUS

DETAILED DESIGN

DRAWING TITLE

GA - LEVEL 1

DRAWING NUMBER

SSDA.08

SCALE

1:200 @ A1

REVISION

D

DATE

14/2/2023

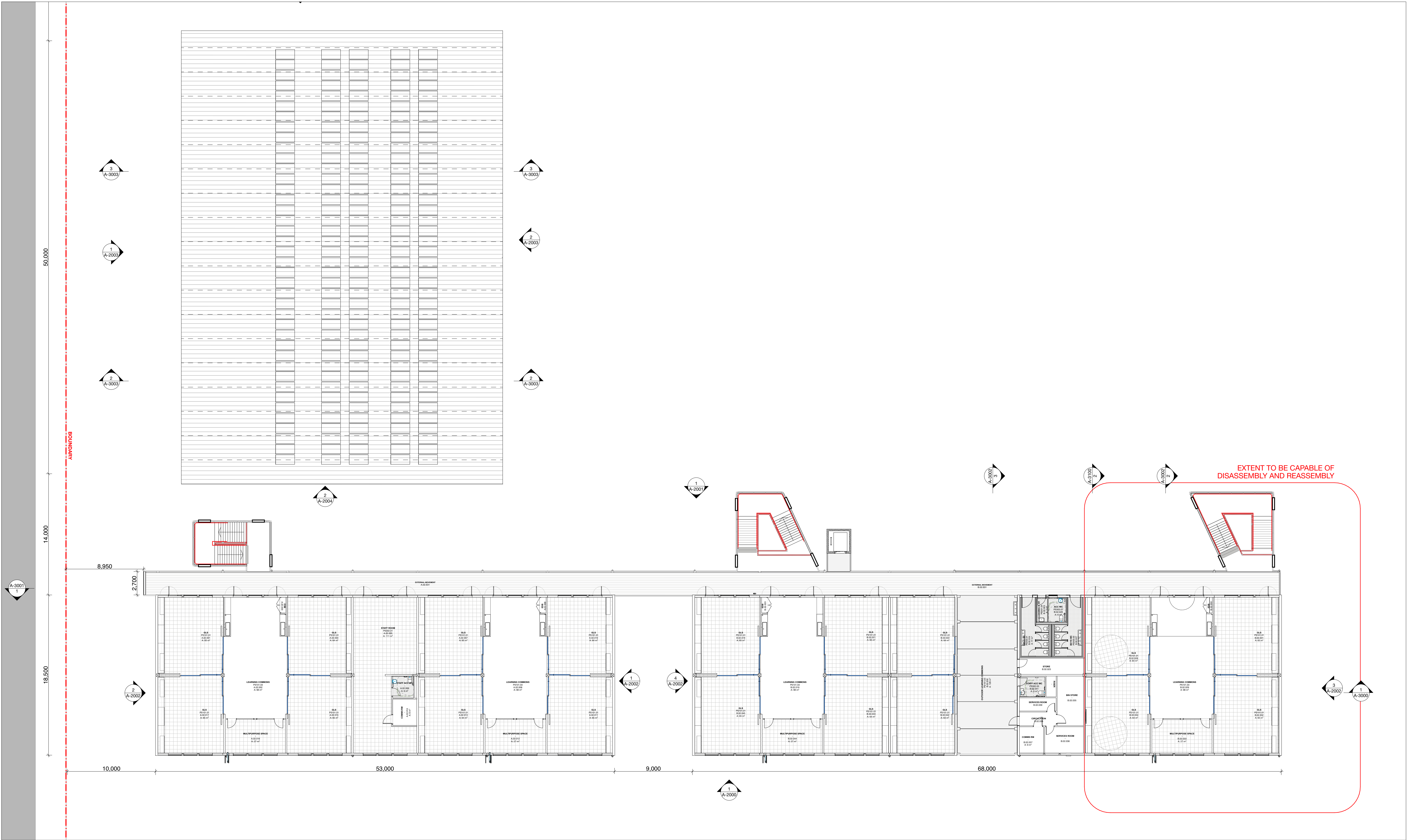

1

NORTH

KEY PLAN

LEVEL 2
1:200

Drawing Disclaimer:
Do not scale from drawings.
Verify all dimensions on site before commencing work.

Copying or reproduction of this drawing is strictly prohibited without the consent of Bennett and Trimble

NOTE:
Bennett and Trimble takes no responsibility for external building elements. Anything connected with any design, materials selection, construction or installation of any cladding, facade or external building element must be checked by and remains the responsibility of others, including suitably qualified experts as may be required.

ISSUE		
REV	FOR	Date
01	FOR INFORMATION	19/9/2022
B	FINAL DESIGN REPORT REVIEW	23/9/2022
C	FINAL DESIGN REPORT	5/10/2022
D	RESPONSE TO SUBMISSIONS	14/2/2023

CLIENT

LIPMAN
Level 6, 66 Berry St
North Sydney NSW 2060
www.lipman.com.au

ARCHITECT

BENNETT AND TRIMBLE
L2, 333 George Street
Sydney NSW 2000
+61 2 8065 8766
bennettandtrimble.com

ABN 20 125 950 816
NSW Nominated Architects
M Trimble No. 7625
M Bennett No. 8538

PROJECT NAME

NEW PRIMARY SCHOOL AT GREGORY HILLS

ADDRESS
28 Wallarah Circuit
Gregory Hills NSW 2557

PROJECT NUMBER

211020

STATUS

DETAILED DESIGN

DRAWING TITLE

GA - LEVEL 2

DRAWING NUMBER

SSDA.09

REVISION

D

SCALE

1:200 @ A1

DATE

14/2/2023

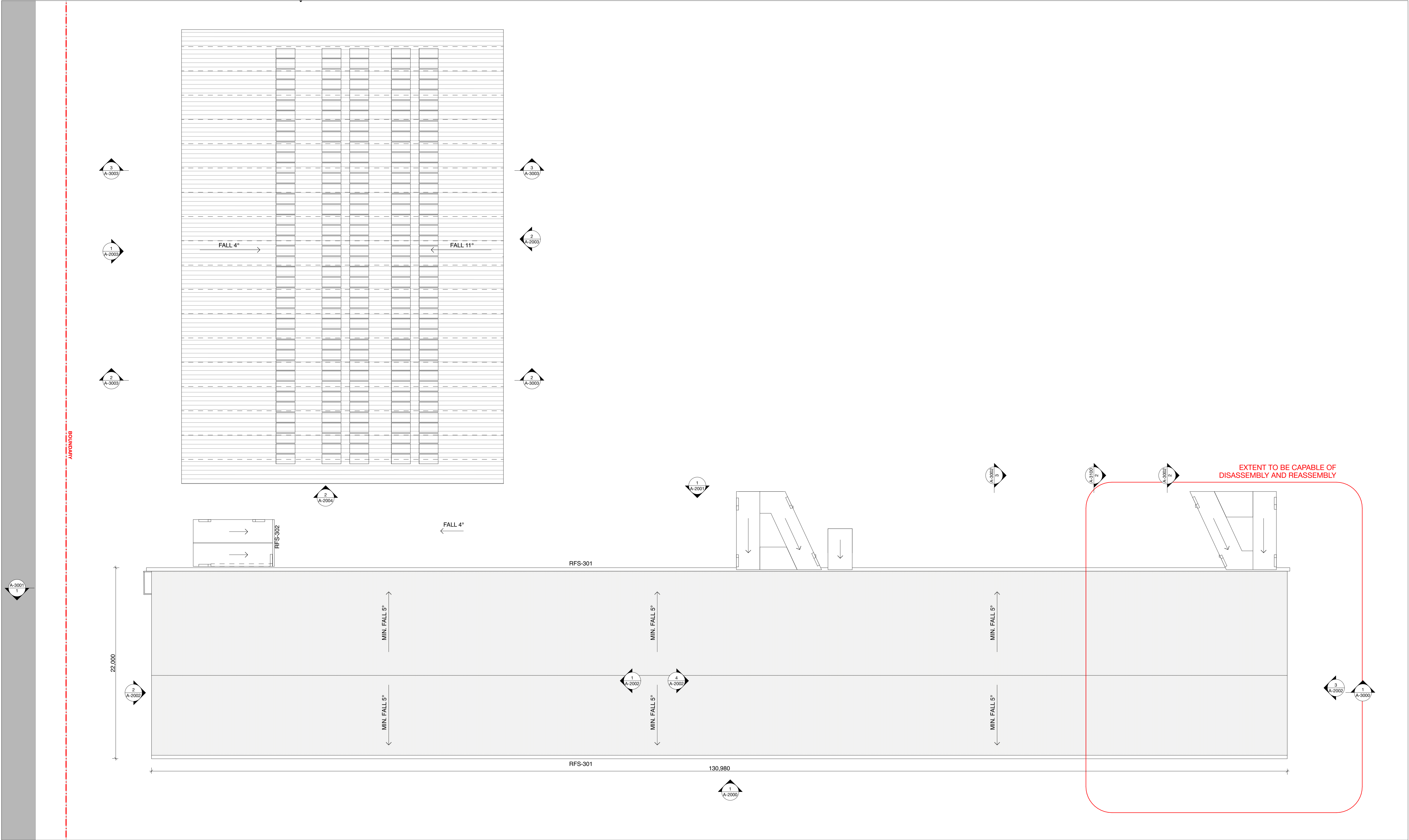

1

NORTH

KEY PLAN

ROOF

1:200

Drawing Disclaimer:

Do not scale from drawings. Verify all dimensions on site before commencing work.

NOTE:

Bennett and Trimble takes no responsibility for external building elements. Anything connected with any design, materials selection, construction or installation of any cladding, facade or external building element must be checked by and remains the responsibility of others, including suitably qualified experts as may be required.

ISSUE

REV	FOR	Date
01	FOR INFORMATION	19/9/2022
B	FINAL DESIGN REPORT REVIEW	23/9/2022
C	FINAL DESIGN REPORT	5/10/2022
D	RESPONSE TO SUBMISSIONS	14/2/2023

CLIENT

LIPMAN

LIPMAN
Level 6, 66 Berry St
North Sydney NSW 2060
www.lipman.com.au

ARCHITECT

BENNETT AND TRIMBLE

L2, 333 George Street
Sydney NSW 2000
+61 2 8065 8766
bennettandtrimble.com

ABN 20 125 950 816
NSW Nominated Architects
M Trimble No. 7625
M Bennett No. 8538

PROJECT NAME

NEW PRIMARY SCHOOL AT GREGORY HILLS

ADDRESS

28 Wallarah Circuit
Gregory Hills NSW 2557

PROJECT NUMBER

211020

STATUS

DETAILED DESIGN

DRAWING TITLE

GA - ROOF

DRAWING NUMBER

SSDA.10

SCALE

1:200 @ A1

REVISION

D

DATE

14/2/2023