

- LEGEND
- NEW-GENERAL LEARNING UNIT
 - NEW-SHARED LEARNING SPACE
 - NEW-SCIENCE LEARNING UNIT
 - NEW-SCIENCE LABORATORY
 - NEW-SCIENCE STORE
 - NEW-STORAGE UNIT / COMMS
 - NEW-STUDENT AMENITIES
 - NEW-STAFF AMENITIES

1 LEVEL 01 - GA
1 : 300 @A1

Key Plan:

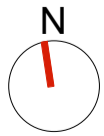
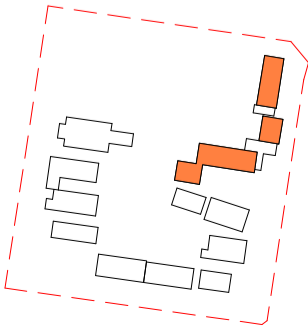

Drawing Disclaimer:
Do not scale from drawings.
Verify all dimensions on site before commencing work.
Copying or reproduction of this drawing is strictly prohibited without the consent of PTW Architects

Note
PTW takes no responsibility for external building elements. Anything connected with any design, materials selection, construction or installation of any cladding, facade or external building element must be checked by and remains the responsibility of others, including suitably qualified experts as may be required.

Rev	Amendment	By	Chk*	Date
E	SSDA SUBMISSION	FJ	DJ	22/09/12
D	SSDA SUBMISSION	QF	DJ	21/11/10
C	DRAFT SSDA SUBMISSION	MB	DJ	21/11/01
B	DRAFT SSDA SUBMISSION	MB	DJ	21/10/25
A	DRAFT SSDA SUBMISSION	MB	DJ	21/10/01

*Registered Architect
DHJ Diane H Jones NSW Arch 4778

Consultants

Client



Education

Architect
PTW Architects
Level 11, 88 Phillip Street
Sydney NSW 2000 Australia
T +61 2 9232 5877
ptw.com.au

Peddie Thorp & Walker P/L
ABN 23 000 454 624
trading as PTW Architects

NSW Nominated Architects
S Parsons Architect No.6098
D Jones Architect No.4778



1 : 300 @A1

Project PA030471

GLENWOOD HIGH SCHOOL
FORMAN AVENUE, GLENWOOD, NSW
2768

Status
SSDA SUBMISSION

Title
SSDA

GA - LEVEL 01

Drawing Number

DA-AR-N113

Revision

E

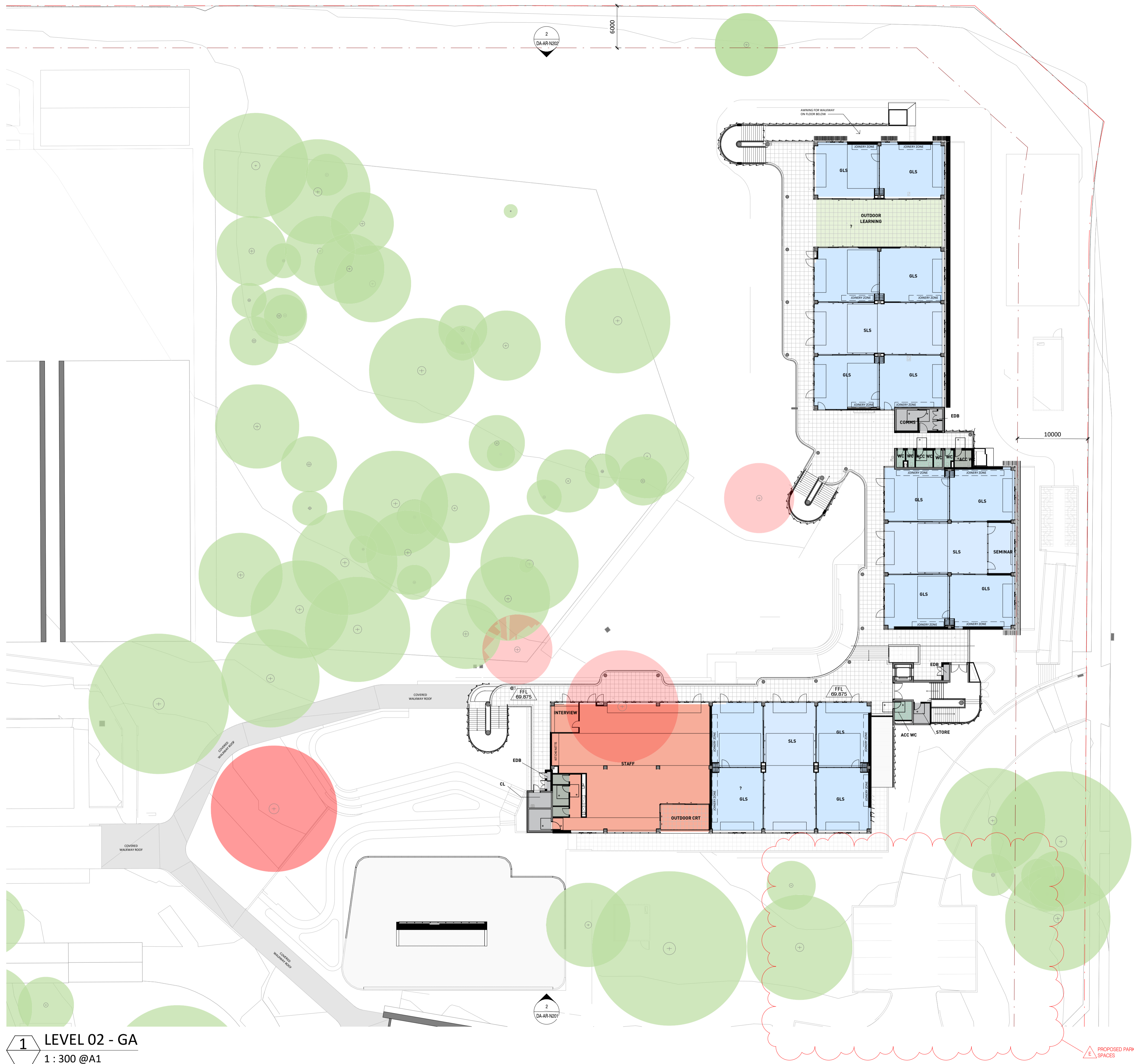

- LEGEND
- NEW-GENERAL LEARNING UNIT
 - NEW-SHARED LEARNING SPACE
 - NEW-OUTDOOR COVERED LEARNING
 - NEW-STAFF UNIT
 - NEW-STORAGE UNIT / COMMS
 - NEW-STUDENT AMENITIES
 - NEW-STAFF AMENITIES

1 LEVEL 02 - GA
1 : 300 @A1

Key Plan:

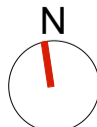
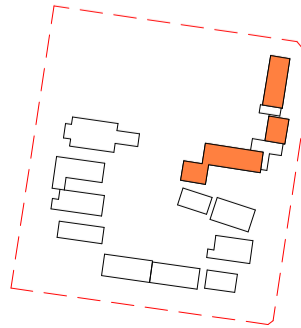

Drawing Disclaimer:
Do not scale from drawings.
Verify all dimensions on site before commencing work.
Copying or reproduction of this drawing is strictly prohibited without the consent of PTW Architects

Note
PTW takes no responsibility for external building elements. Anything connected with any design, materials selection, construction or installation of any cladding, facade or external building element must be checked by and remains the responsibility of others, including suitably qualified experts as may be required.

Rev	Amendment	By	Chk*	Date
E	SSDA SUBMISSION	FJ	DJ	22/09/12
D	SSDA SUBMISSION	QF	DJ	21/11/10
C	DRAFT SSDA SUBMISSION	MB	DJ	21/11/01
B	DRAFT SSDA SUBMISSION	MB	DJ	21/10/25
A	DRAFT SSDA SUBMISSION	MB	DJ	21/10/01

*Registered Architect
DHJ Diane H Jones NSW Arch 4778

Consultants

Client



Education

Architect
PTW Architects
Level 11, 88 Phillip Street
Sydney NSW 2000 Australia
T +61 2 9232 5877
ptw.com.au

Peddie Thorp & Walker P/L
ABN 23 000 454 624
trading as PTW Architects

NSW Nominated Architects
S Parsons Architect No.6098
D Jones Architect No.4778



1 : 300 @ A1
Project PA030471
GLENWOOD HIGH SCHOOL
FORMAN AVENUE, GLENWOOD, NSW
2768
Status
SSDA SUBMISSION

Title
SSDA
GA - LEVEL 02
Drawing Number
DA-AR-N123

Revision
E

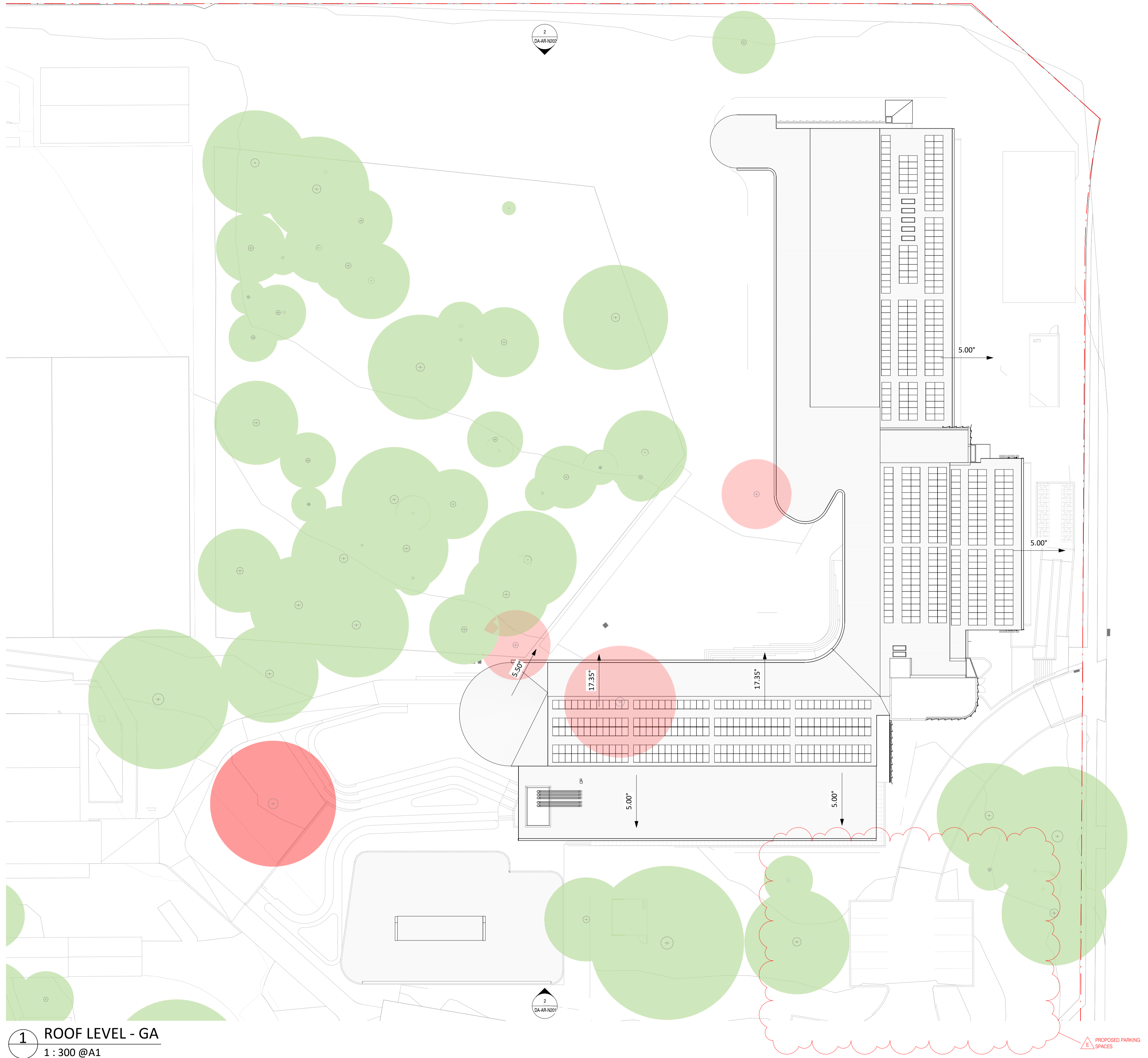

1 ROOF LEVEL - GA
1 : 300 @ A1

Key Plan:

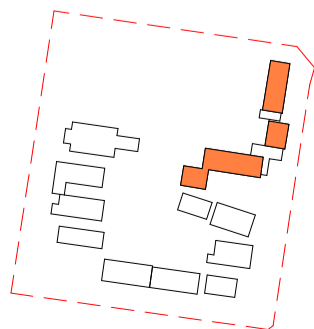

Drawing Disclaimer:
Do not scale from drawings.
Verify all dimensions on site before commencing work.
Copying or reproduction of this drawing is strictly prohibited without the consent of PTW Architects

Note
PTW takes no responsibility for external building elements. Anything connected with any design, materials selection, construction or installation of any cladding, facade or external building element must be checked by and remains the responsibility of others, including suitably qualified experts as may be required.

Rev	Amendment	By	Chk*	Date
E	SSDA SUBMISSION	FJ	DJ	22/09/12
D	SSDA SUBMISSION	QF	DJ	21/11/10
C	DRAFT SSDA SUBMISSION	MB	DJ	21/11/01
B	DRAFT SSDA SUBMISSION	MB	DJ	21/10/25
A	DRAFT SSDA SUBMISSION	MB	DJ	21/10/01

*Registered Architect
DHJ Diane H Jones NSW Arch 4778

Consultants

Client



Education

Architect
PTW Architects
Level 11, 88 Phillip Street
Sydney NSW 2000 Australia
T +61 2 9232 5877
ptw.com.au

Peddie Thorp & Walker P/L
ABN 23 000 454 624
trading as PTW Architects

NSW Nominated Architects
S Parsons Architect No.6098
D Jones Architect No.4778



1 : 300 @ A1
Project PA030471
GLENWOOD HIGH SCHOOL
FORMAN AVENUE, GLENWOOD, NSW
2768
Status
SSDA SUBMISSION

Title
SSDA
GA - LEVEL 03 - ROOF PLAN
Drawing Number
DA-AR-N133

Revision
E

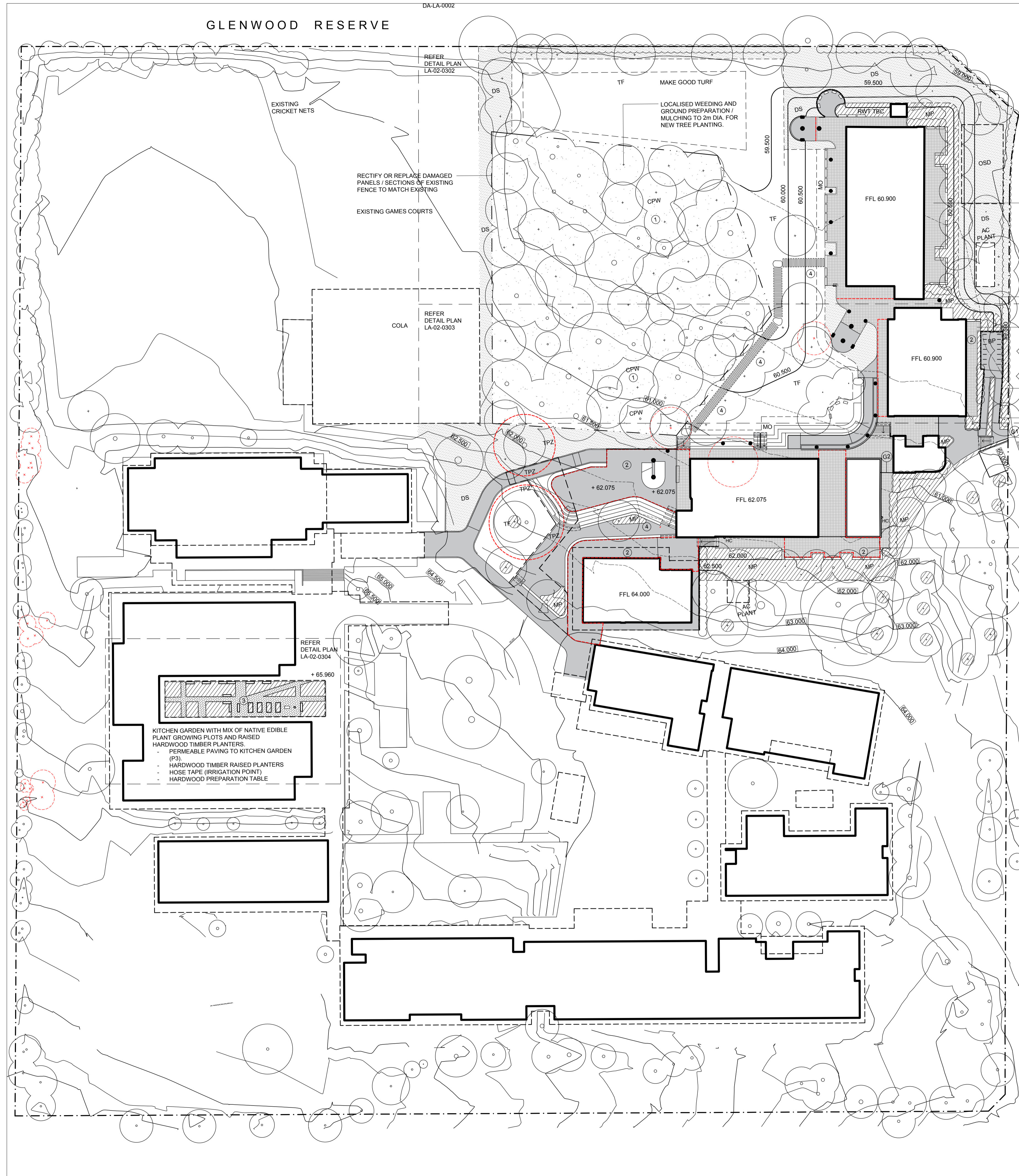

PLANTING SCHEDULE						
SYM	Botanical Name	Common Name	Height x Width	Pot	Spacing	QTY
Tree Planting						
Fa	<i>Pinus australis</i>	Native teak ash	12m x 6m	100L	As Shown	23
Lc	<i>Lophostemon confertus</i>	Brush box	12m x 6m	100L	As Shown	9
Mq	<i>Melaleuca quinquenervia</i>	Paperbark	8m x 4m	100L	As Shown	20
Sg	<i>Syncarpia glomulifera</i>	Turpentin tree	20m+ x 6m+	200L	As Shown	22
Tree Planting (Cumberland Plain Woodland)*						
Cm	<i>Corymbia maculata</i>	Spotted gum	12m x 6m	25L	As Shown	7
Ec	<i>Eucalyptus crebra</i>	Ironbark	12m x 6m	25L	As Shown	7
Ef	<i>Eucalyptus fibrosa</i>	Red ironbark	12m x 6m	25L	As Shown	5
Et	<i>Eucalyptus tereticornis</i>	Forest red gum	12m x 6m	25L	As Shown	4

* Tree species planting within the existing Cumberland Plain Woodland

Shrub Planting						
As	<i>Acmena smithii</i>	Lilly pilly	3m x 2m	25L	As Shown	190
Md	<i>Melaleuca decora</i>	White honeymyrtle	7m x 4m	25L	As Shown	10
Ri	<i>Raphiolepis indica</i>	Indian hawthorn	1.5m x 1.5m	25L	800mm	40
Wf	<i>Westringia fruticosa</i>	Coastal rosemary	1.5-2m+ x 1m	25L	800mm	40
Groundcovers						
Cl	<i>Carex inversa</i>	Knob sedge	0.7m x 0.7m	150mm	500mm	840
Dr	<i>Dianella revoluta</i>	Blue berry lily	0.7m x 0.7m	150mm	500mm	1000
Lj	<i>Lomandra longifolia</i>	Mat rush	0.7m x 0.7m	150mm	500mm	1000
Ju	<i>Juncus ustulatus</i>	Common rush	0.6m x 0.5m	150mm	500mm	840

Groundcovers / understorey (Cumberland Plain Woodland)**						
Cares inversa	Knob sedge	0.7m x 0.7m	-	Direct seeded		
Dianella longifolia	Flax lily	0.7m x 0.7m	-	Direct seeded		
Lomandra longifolia	Mat rush	0.7m x 0.7m	-	Direct seeded		
Poa labillardierei	Tussock grass	0.7m+ x 0.7m	-	Direct seeded		
Juncus ustulatus	Common rush	0.7m+ x 0.7m	-	Direct seeded		
Themeda australis	Kangaroo grass	0.7m+ x 0.7m	-	Direct seeded		

** Potential future regeneration of the Cumberland Plain Woodland Community including staged removal of weeds and replacement with native understorey planting species identified, including suitable cover crop. Develop native seed mix, including planting (seeding) management and techniques with Greening Australia - Cumberland Seed Production Area (SPA): <https://greeningaustralia.org>

LEGEND

[Symbol] SITE BOUNDARY

[Symbol] EXTENT OF PROPOSED EXTERNAL AND LANDSCAPE WORKS

[TF] NEW TURF (TF)

[CPW] EXISTING AND PROPOSED RESTORATION OF CUMBERLAND PLAIN WOODLAND (CPW)

[MP/MS] NEW GROUNDCOVER MASS PLANTING (MP) AND MULCH ONLY (MO)

[DS] NEW GROUNDCOVER GRASSES DIRECT SEEDING (DS)

[SSZ] STRUCTURAL SOIL ZONE (SSZ)

[Symbol] EXISTING MAJOR CONTOUR (1m INTERVALS)

[Symbol] EXISTING MINOR CONTOUR

[Symbol] EXISTING CONTOUR REMOVED

[Symbol] PROPOSED NEW CONTOURS

[TE] TIMBER EDGE

[TP] TREE PIT

[SST1] STEPPING STONE TYPE 1, SANDSTONE PLANK

[SST2] STEPPING STONE TYPE 2, SANDSTONE ROCK

[SST3] LARGE, SINGLE STEPPING STONE TYPE 3 SANDSTONE 'KNUCKLE'

[BAL] BALUSTRADE TO MATCH ARCHITECTURAL DETAIL

[BP] BICYCLE PARKING LOOP

[ex.F1] EXISTING TUBULAR STEEL SECURITY FENCE.

[F1] NEW FENCE TYPE 1 (F1) TO MATCH EXISTING TUBULAR STEEL SECURITY FENCE (ex.F1).

[ex.F2] EXISTING CHAIN LINK AND BARBED WIRE TOPPED FENCING.

[ex.F3] EXISTING CHAIN LINK FENCING.

[G#] GATE TO MATCH ex.F1

[Symbol] EXISTING TREE TO BE RETAINED. T# (TREE NUMBER). TPZ DASHED RED REFER ARBORIST REPORT

[Symbol] EXISTING TREE TO BE REMOVED FOR DA. T# (TREE NUMBER) REFER ARBORIST REPORT

[Symbol] EXISTING TREE TO BE REMOVED FOR SSD. T# (TREE NUMBER) REFER ARBORIST REPORT

[Symbol] NEW TREE PLANTING Gs (Genus species) REFER PLANTING SCHEDULE

[BS1] BENCH SEATING TYPE 1, SANDSTONE LOG 2m LONG x 500mm WIDE x 500mm HIGH.

[BS2] BENCH SEATING TYPE 2, SANDSTONE LOG 1m LONG x 500mm WIDE x 500mm HIGH.

[OSD] ON SITE DETENTION BASIN (OSD)

[P1] PAVING TYPE 1 CONCRETE PAVING

[P1A] PAVING TYPE 1 ZONE PAVING WITH APPLIED PAINTED GRAPHICS / ART WORK

[P2] PAVING TYPE 2A PAVING ON PEDESTALS

[P2A] PAVING TYPE 2A PAVING ON PEDESTALS WITH APPLIED GRAPHICS / ART WORK

[P3] PAVING TYPE 3 PERMEABLE PAVING

NOTE:

- PROVIDE AUTOMATIC TIMED IRRIGATION SYSTEM TO COVER EXTENT OF NEW TREE AND MASS PLANTING ZONES. CONNECT IRRIGATION SYSTEM TO EXISTING POTABLE WATER SUPPLY
- REFER ARCHITECTURAL DRAWINGS FOR EXTENT OF STRUCTURAL SLAB
- ARBORIST TO BE PRESENT DURING WORKS AROUND TREES.
- ARBORIST TO CONFIRM AND ADVISE ON CONSTRUCTION APPROACH TO WORKS WITHIN TREE PROTECTION (TPZ) AND STRUCTURAL ROOT ZONES (SRZ) OF EXISTING TREES.

KEY

① EXISTING PATCH OF CUMBERLAND PLAIN WOODLAND.

- RETAIN EXISTING TREES
- POTENTIAL FUTURE REGENERATION WORKS MAY INCLUDE THE STAGED REMOVAL OF WEEDS AND REPLACEMENT WITH NATIVE UNDERSTOREY PLANTING AND TREE SPECIES OF THE CUMBERLAND PLAIN WOODLAND.
- SEVERAL SPECIES OF THE CUMBERLAND PLAIN WOODLAND ARE IDENTIFIED IN THE EFGS UNDER SECTION 92.08. HAZARDOUS TREES / PLANTS TREES THAT MAY SHED LARGE BRANCHES*. AN ARBORCULTURAL ASSESSMENT SHOULD BE COMPLETED WITH RECOMMENDATIONS REGARDING LIMB AND TREE REMOVAL CARRIED OUT PRIOR TO ACCESS BEING PROVIDED.

② EXTERNAL ACTIVE PLAY AND PERFORMANCE SPACE CONNECTED TO NEW PERFORMING ART BUILDING WITH OPPORTUNITIES TO:

- EXPLORE AND REFLECT LOCAL STORIES IN THE FORM OF COLOUR AND GRAPHICS

③ KITCHEN GARDEN WITH MIX OF NATIVE EDIBLE PLANT GROWING PLOTS AND RAISED PLANTER BEDS.

- EXISTING PAVING TO PERIMETER OF GARDEN.
- INTEGRATED INTERNAL PERMEABLE PAVING CIRCULATION PATHS.
- HARDWOOD TIMBER RAISED PLANTERS
- HOSE TAPE (IRRIGATION POINT)
- HARDWOOD PREPARATION TABLE

④ SANDSTONE PLANKS (STEPPING STONES) WITH INCORPORATED INTERPRETATION PANELS THAT PROVIDE INFORMATION ON PLANT AND ANIMAL SPECIES OF THE CUMBERLAND PLAIN WOODLAND.

Key Plan:

Drawing Disclaimer:

Do not scale from drawings. Verify all dimensions on site before commencing work. Copying or reproduction of this drawing is strictly prohibited without the consent of PTW Architects

Note:

PTW takes no responsibility for external building elements. Anything connected with any design, materials selection, construction or installation of any cladding, facade or external building element must be checked by and remains the responsibility of others, including suitably qualified experts as may be required.

Rev	Amendment	By	Chk**	Date
1	DRAFT 85% DD	GM	GM	22/06/10
2	SECOND ISSUE DD	GM	GM	22/06/21
3	100% DD	GM	GM	22/08/23
4	CDVC-01	GM	GM	22/09/04

Rev	Amendment	By	Chk*	Date
*Registered Architect				
DJ	DIANE H. JONES		NSW Arch 4778	

Consultant

SINSW

Client

SINSW

Architect

PTW Architects
Level 11, 88 Phillip Street
Sydney NSW 2000 Australia
T +61 2 9232 5877
ptw.com.au

Peddie Thorp & Walker P/L
ABN 23 000 454 624
trading as PTW Architects

NSW Nominated Architects
S Parsons Architect No.6098
D Jones Architect No.4778

Project PA030471

GLENWOOD HIGH SCHOOL
FORMAN AVENUE, GLENWOOD, NSW 2768

Title

LANDSCAPE PLAN

Drawing Number

GHS-LS-SW-DRW-0301

Revision

04

Status

CDVC-01

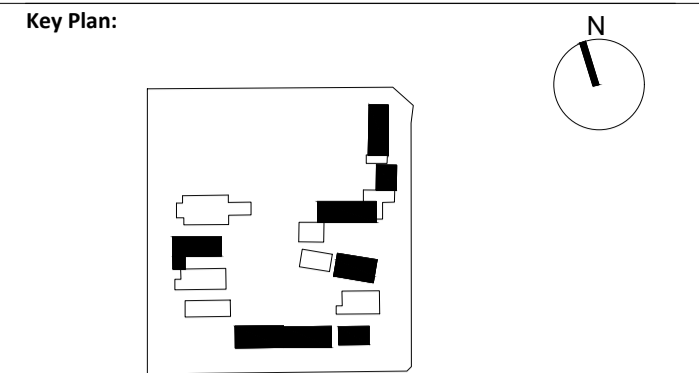
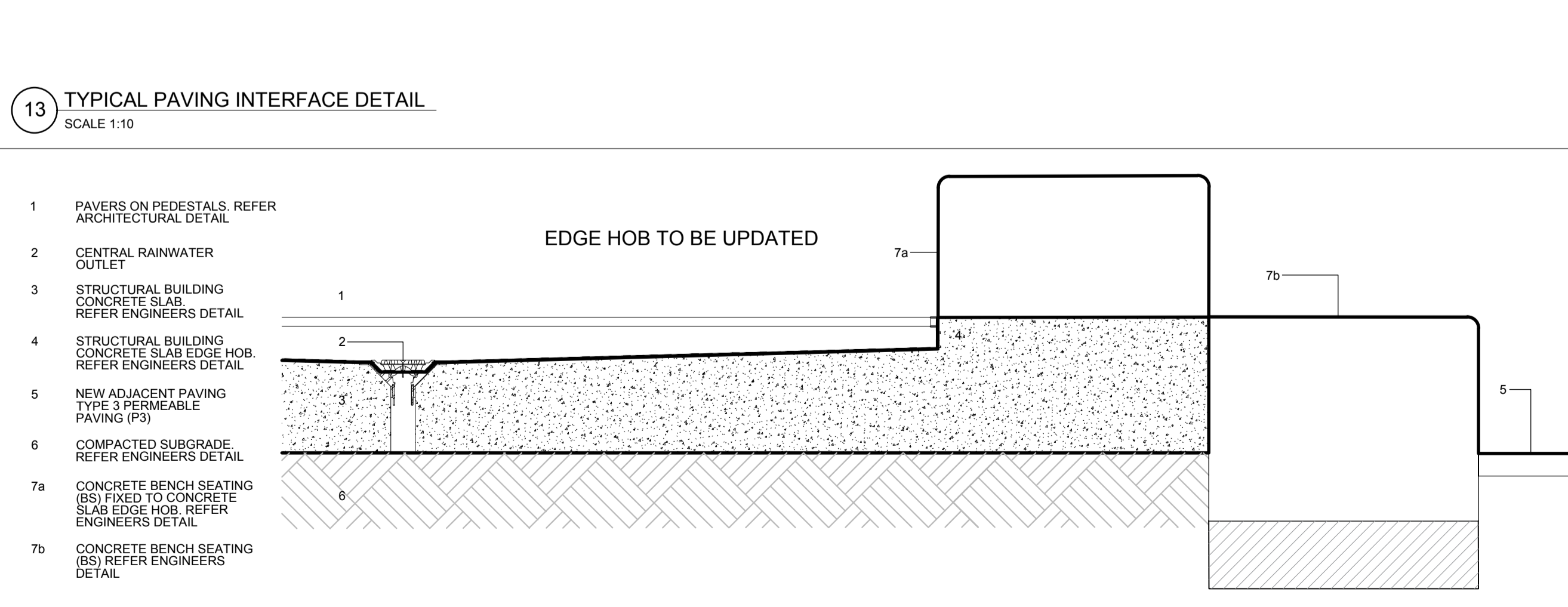
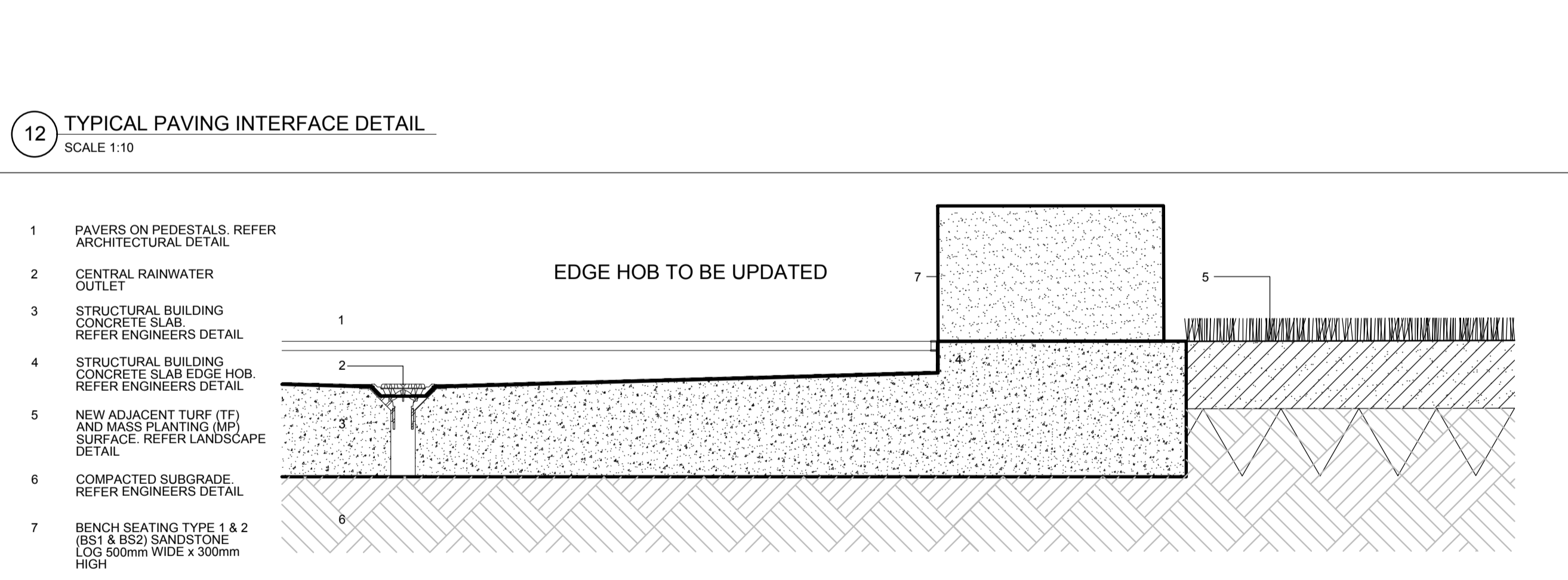
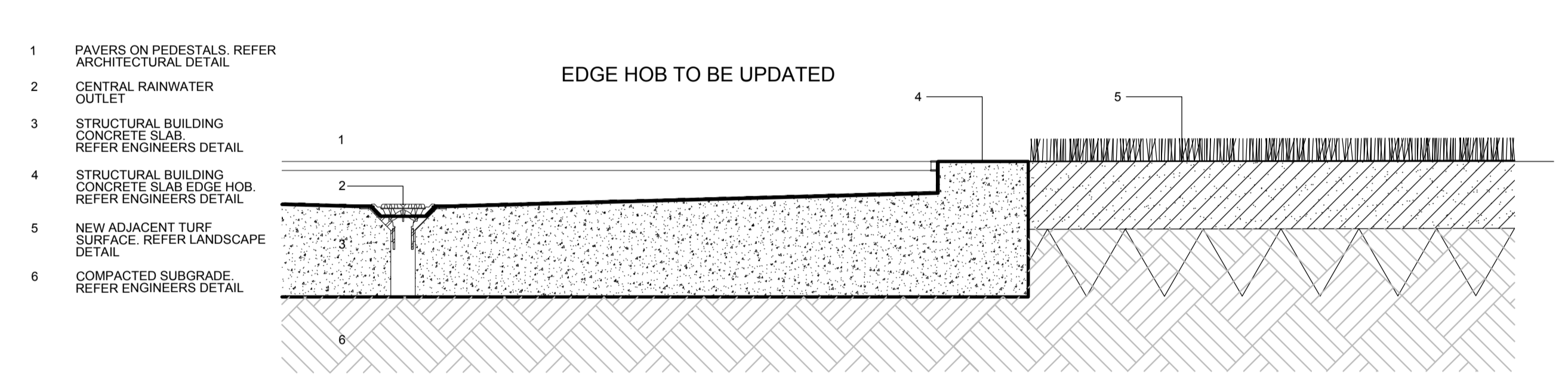
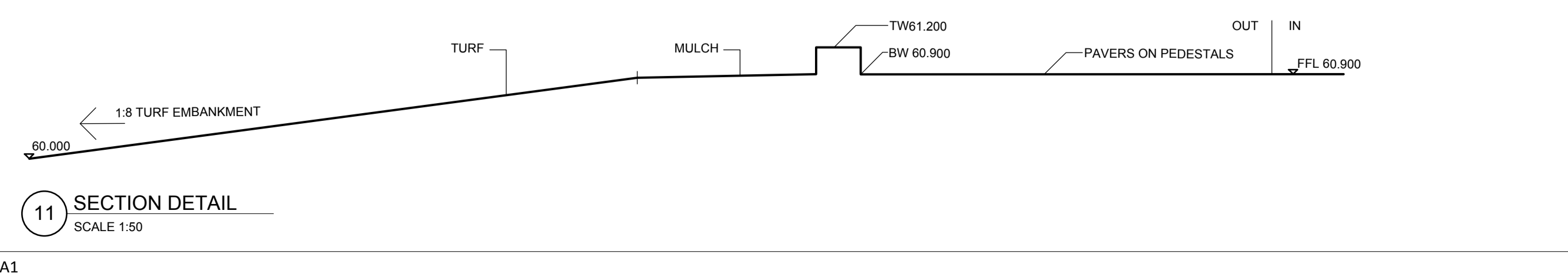
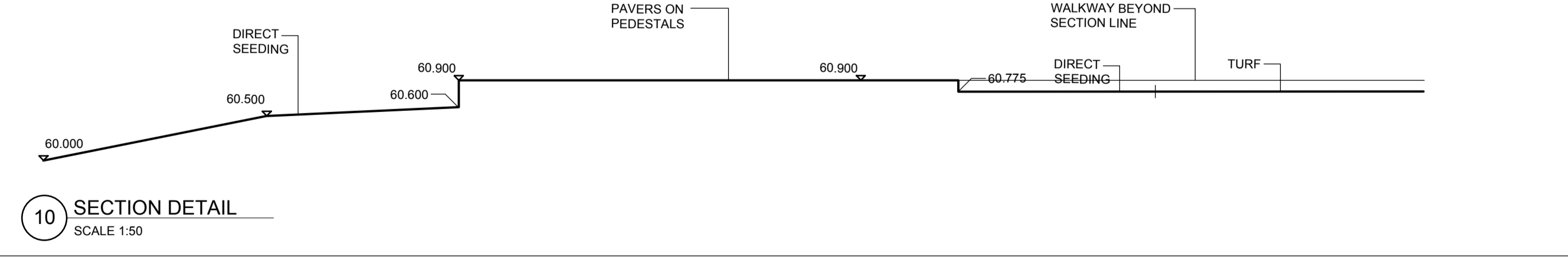
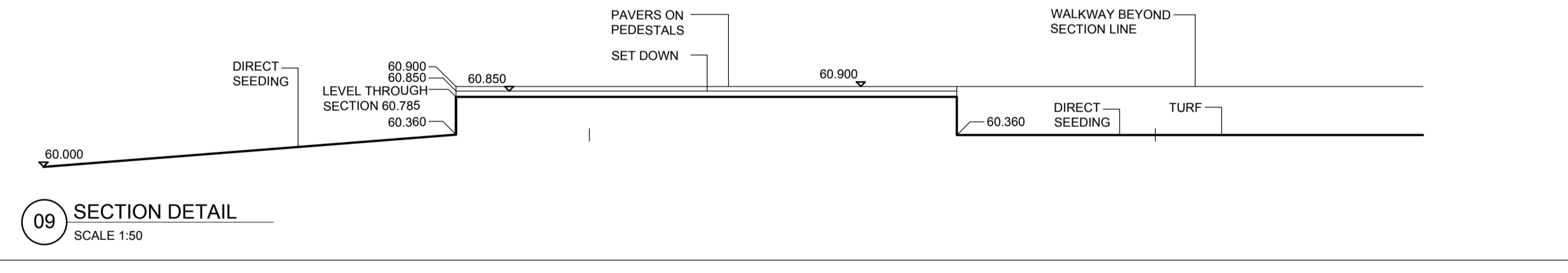
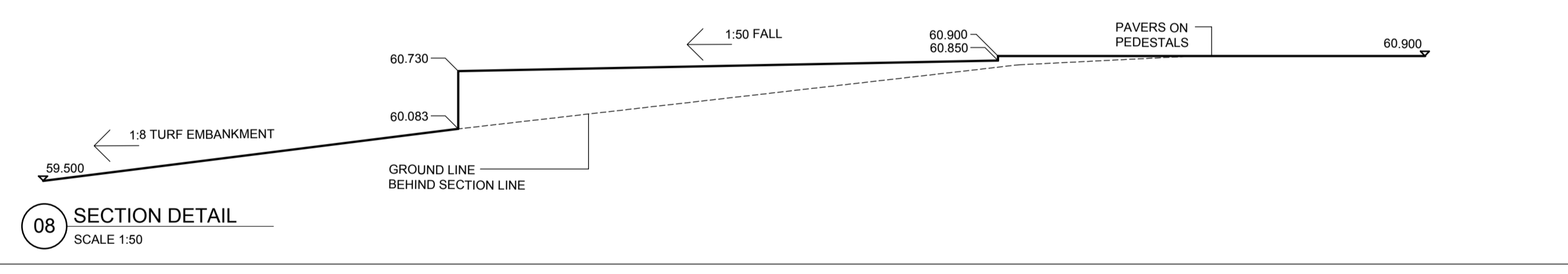
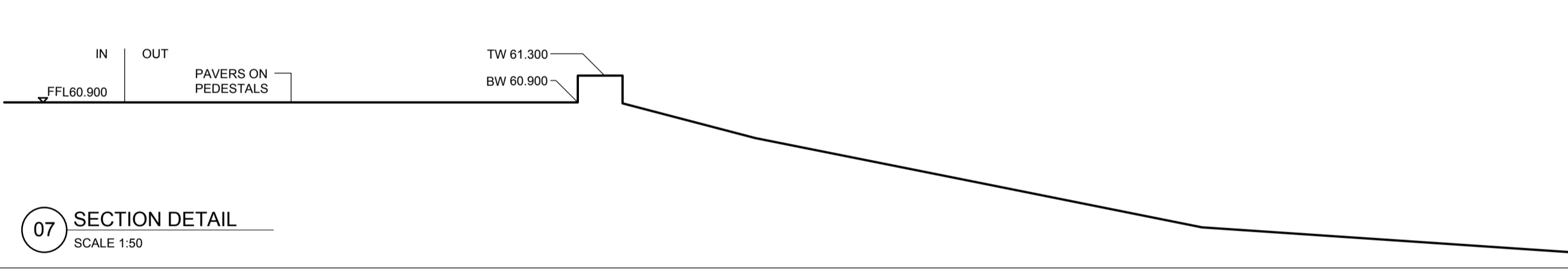
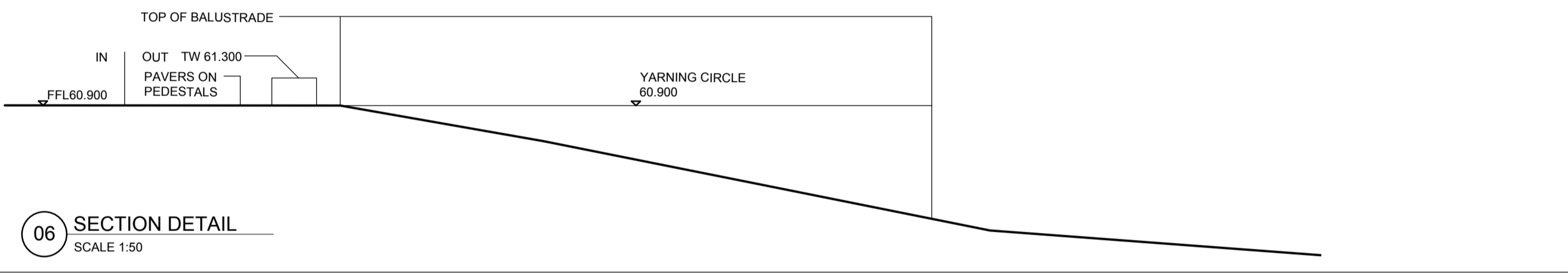
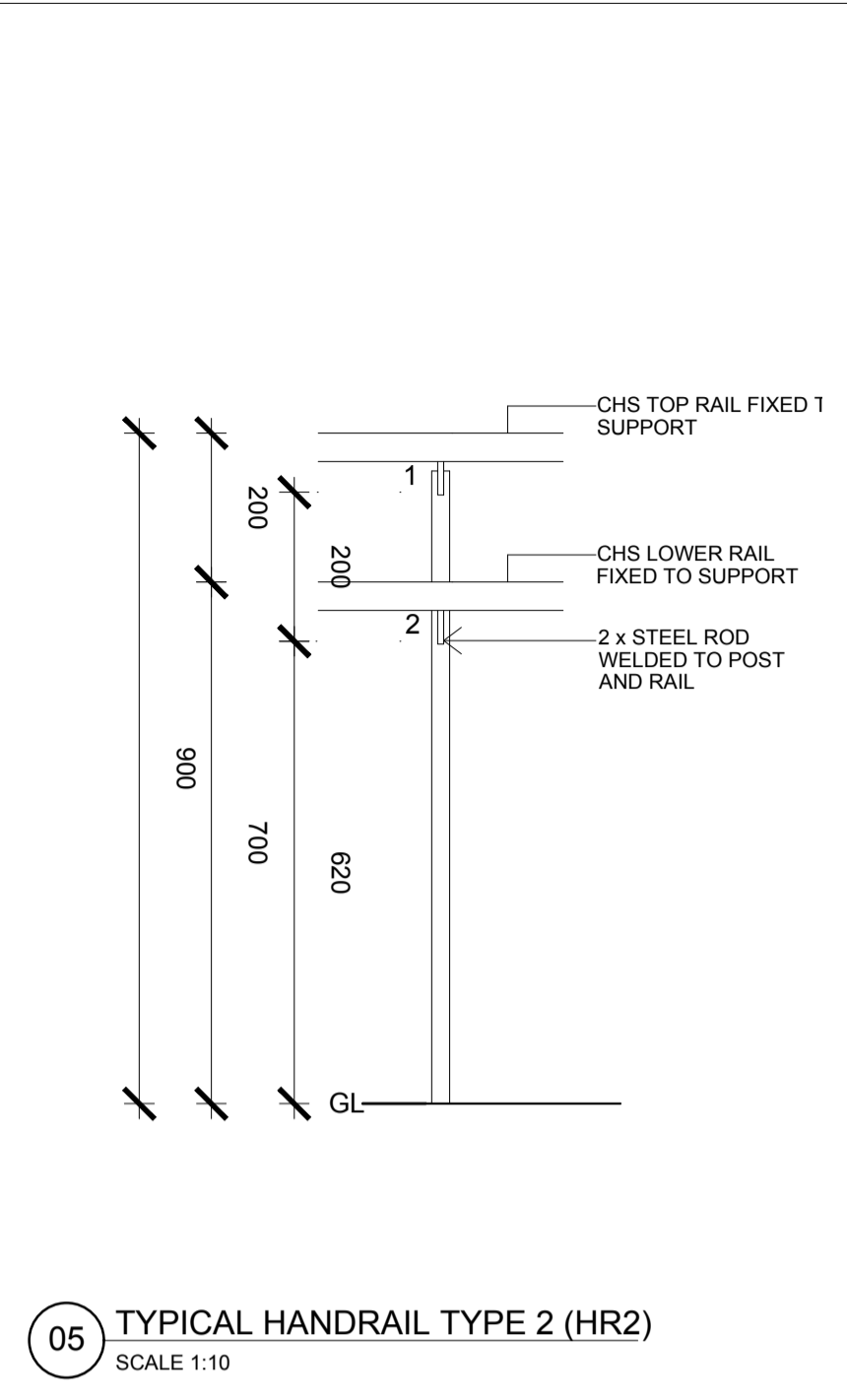
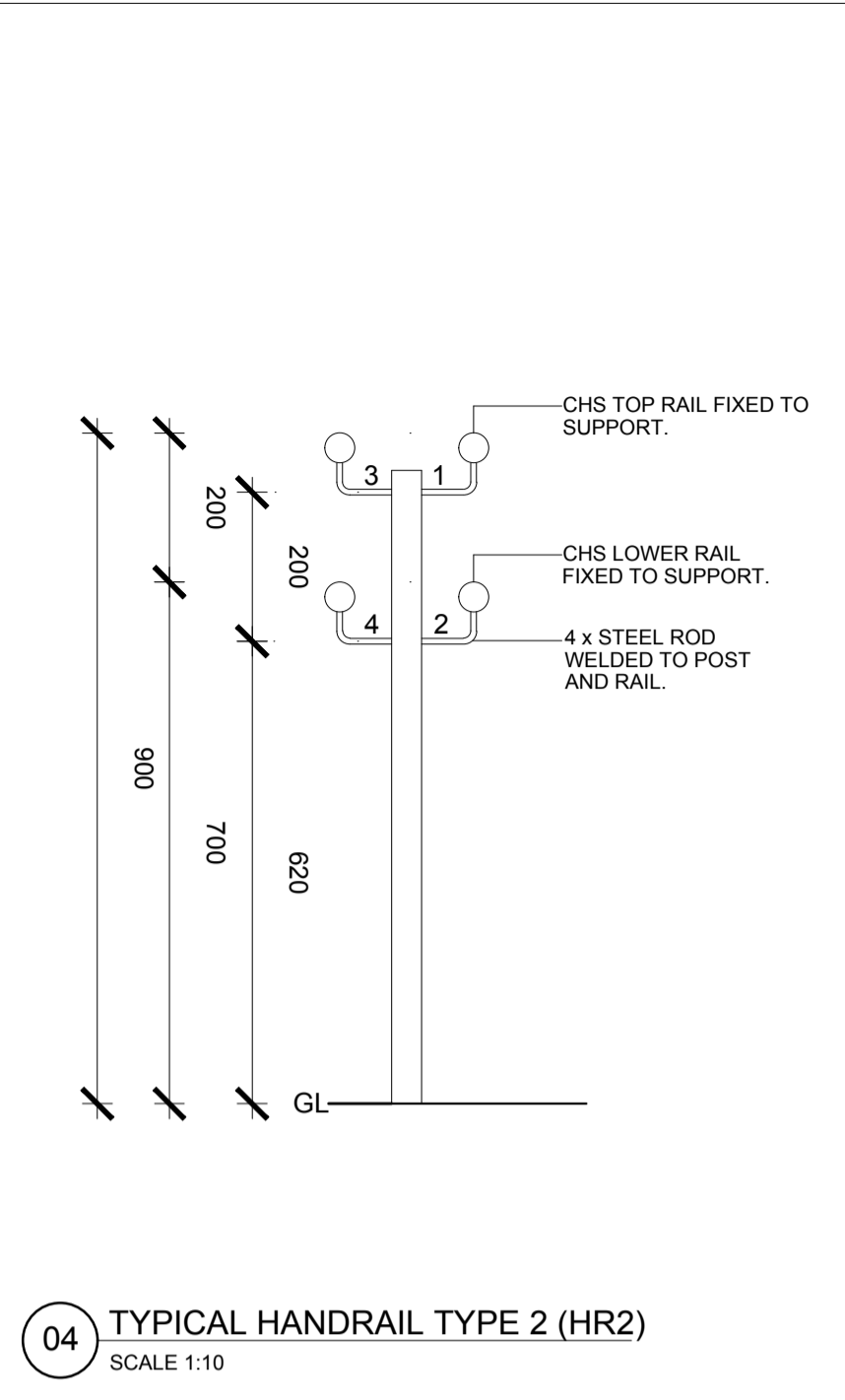
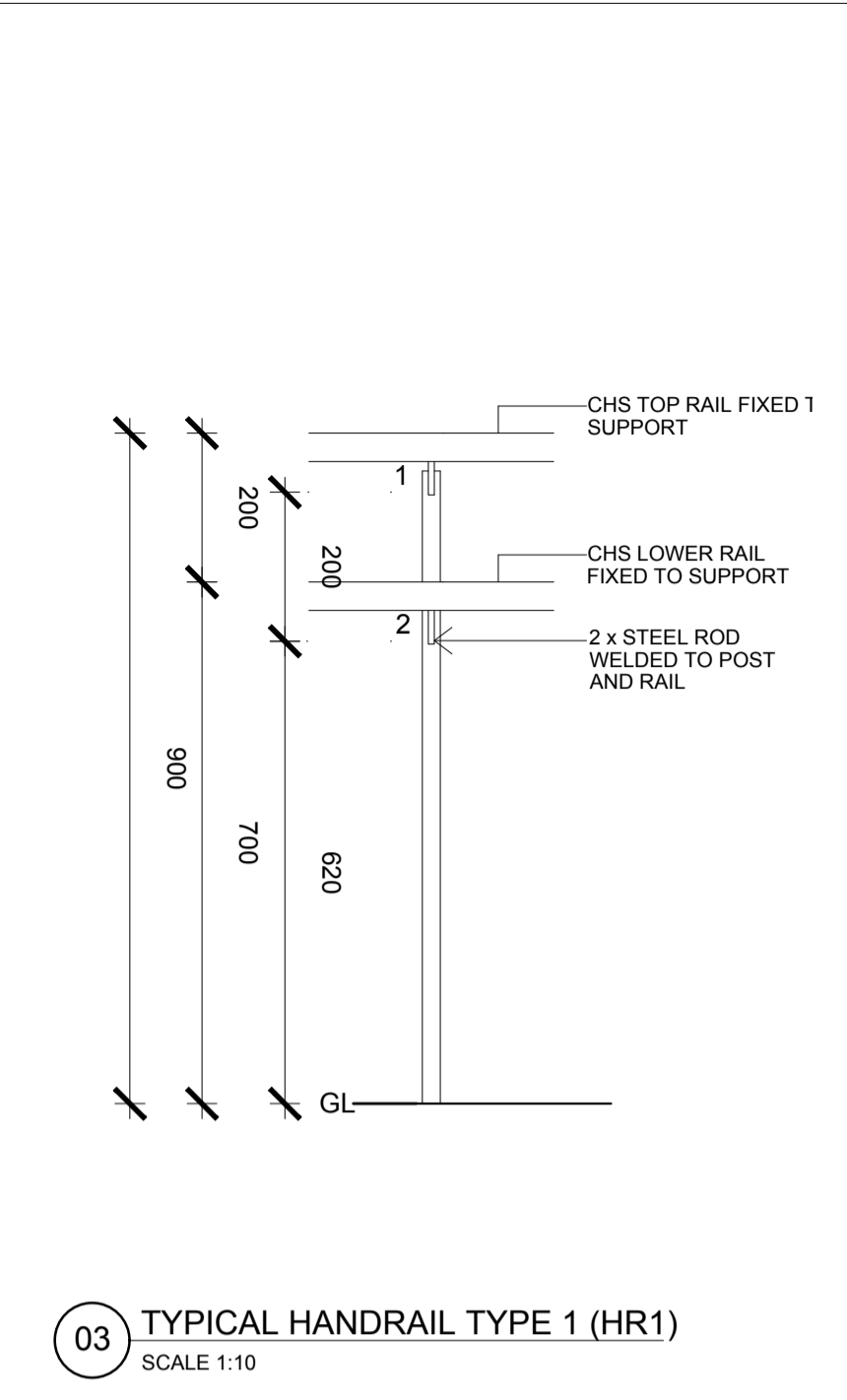
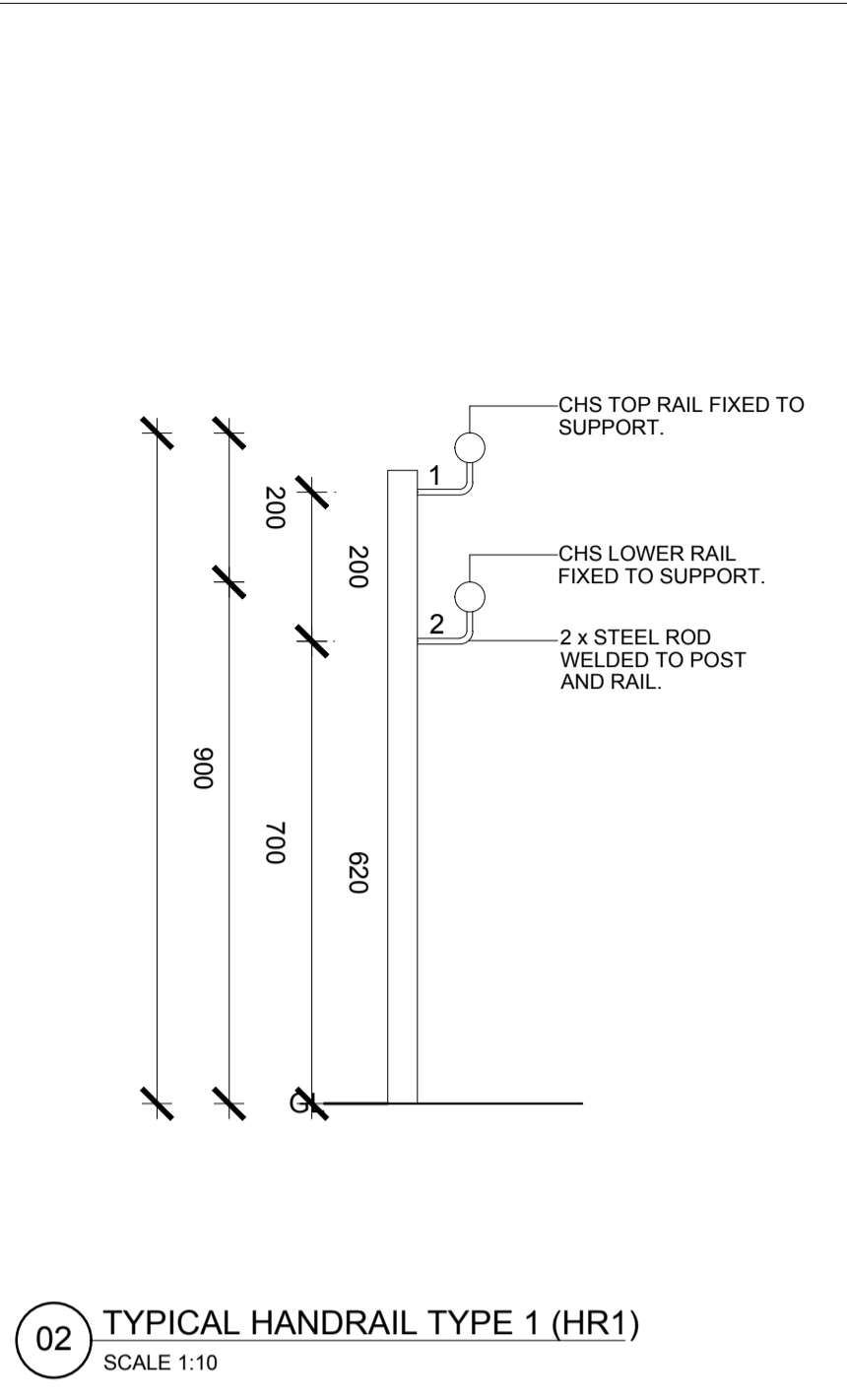
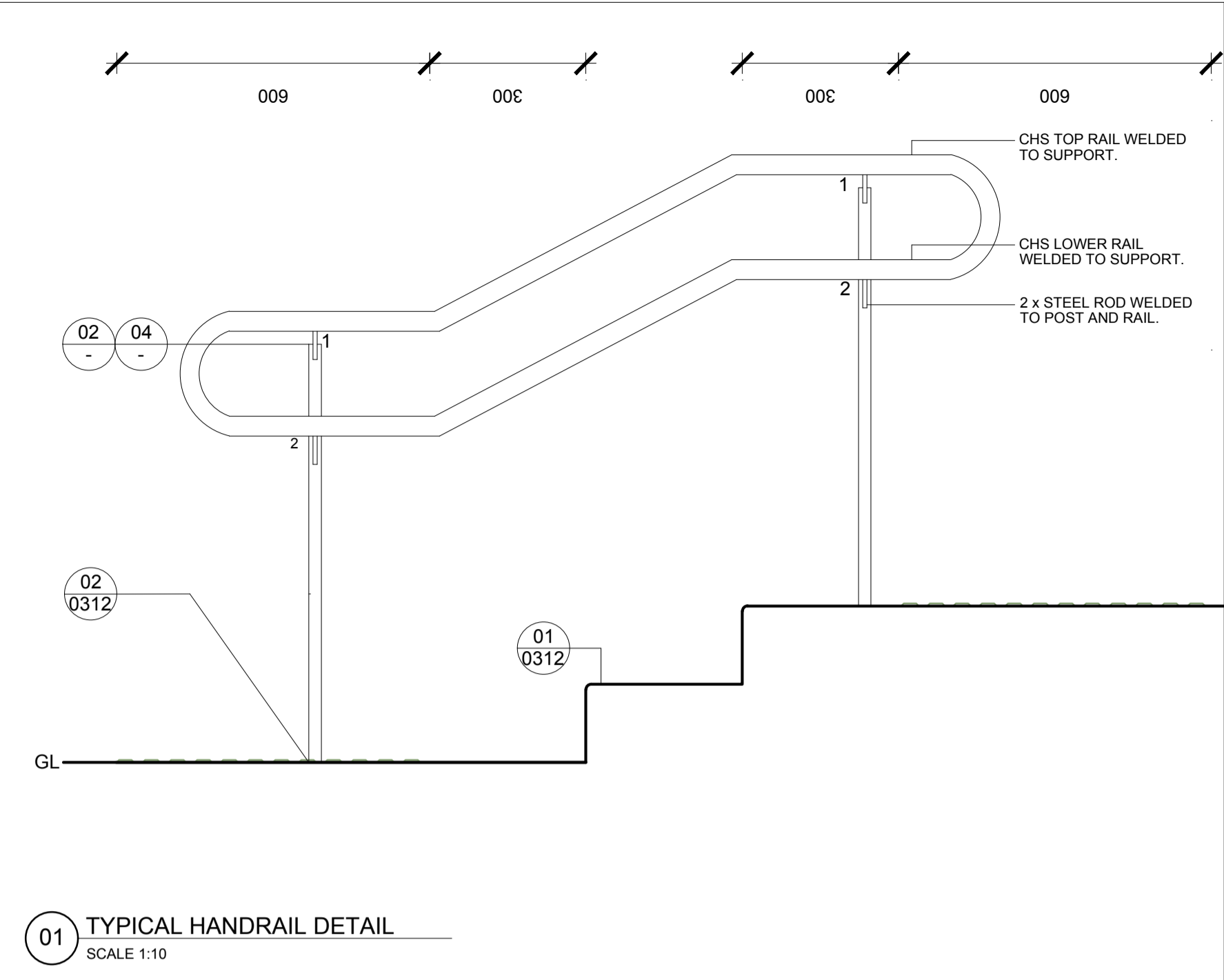

Drawing Disclaimer:
Do not scale from drawings.
Verify all dimensions on site before commencing work.
Copying or reproduction of this drawing is strictly prohibited without the consent of PTW Architects

Note:
PTW takes no responsibility for external building elements. Anything connected with any design, materials selection, construction or installation of any cladding, facade or external building element must be checked by and remains the responsibility of others, including suitably qualified experts as may be required.

Rev	Amendment	By	Chk**	Date
1	100% DD	GM	GM	22/08/23
2	CDVC-01	GM	GM	22/09/04

Rev	Amendment	By	Chk*	Date
-----	-----------	----	------	------

*Registered Architect				
DJ	DIANE H. JONES		NSW Arch 4778	

Consultant

Client
SINSW

Architect
PTW Architects
Level 11, 88 Phillip Street
Sydney NSW 2000 Australia
T +61 2 9232 5877
ptw.com.au
Peddie Thorp & Walker P/L NSW Nominated Architects
ABN 23 000 454 624 S Parsons Architect No.6098
trading as PTW Architects D Jones Architect No.4778

Project PA030471
GLENWOOD HIGH SCHOOL
FORMAN AVENUE, GLENWOOD, NSW 2768

Title
DETAILED SHEET 2

SCALE: AS SHOWN
Drawing Number GHS-LS-SW-DRW-0311
Revision 02

Status
CDVC-01