

PLOT DATE 25/1/23

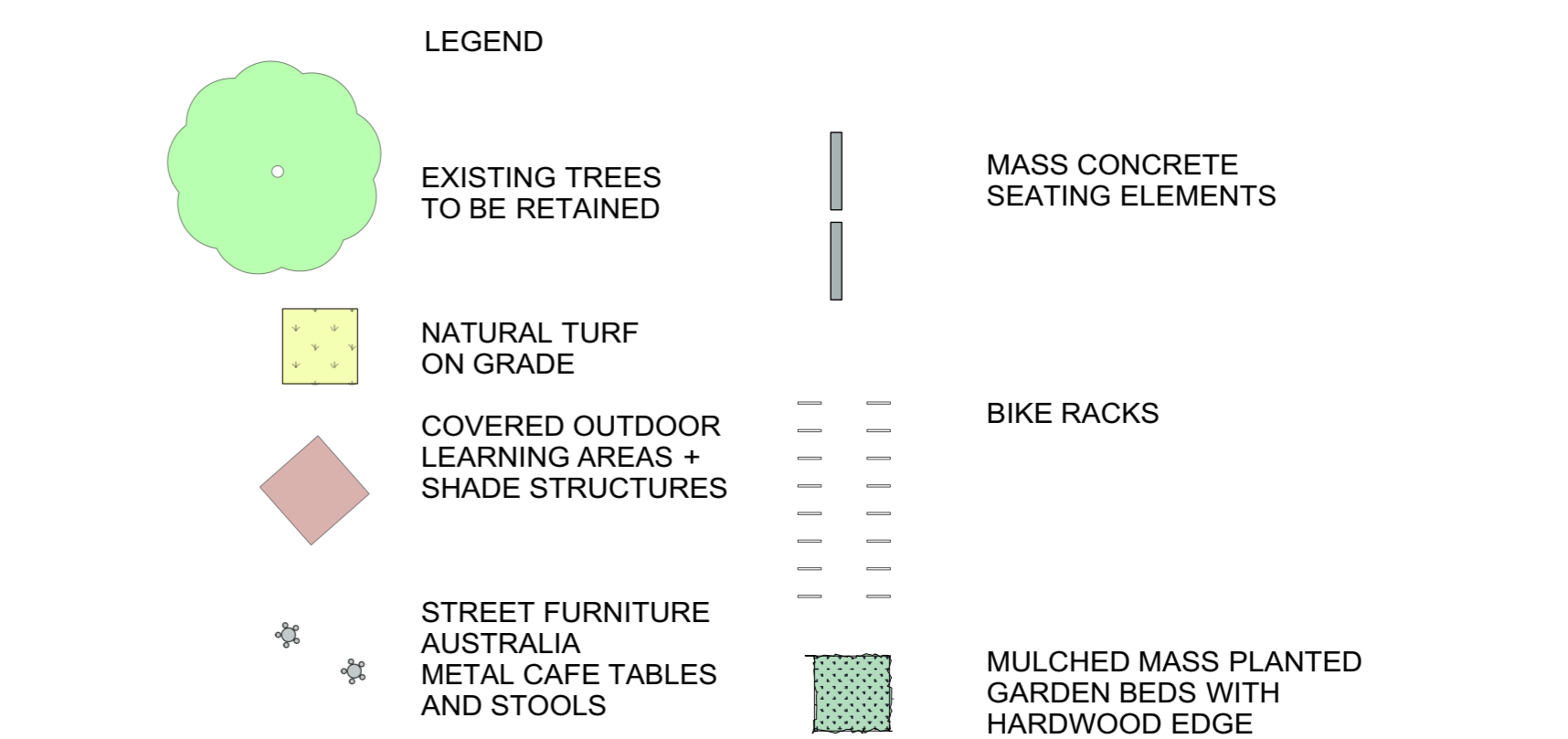

BOTANICAL NAME	COMMON NAME	MATURE H x W	INSTALL POT SIZE	NO OFF
MEDIUM SCALE DECIDUOUS TREES				
MAIN EAST WEST AVENUE PLANTING				
Sapium sebiferum	Chinese Tallowood	8 x 8	75 litre	22
MEDIUM SCALE FLOWERING TREE TO CENTRAL COURTYARD				
Lagerstroemia 'Natchez'	Crepe Myrtle	7 x 5	200 litre	17
MEDIUM SCALE FOLIAGE DECIDUOUS TREES TO WESTERN BOUNDARY				
Pistacia chinensis	Pistacia tree	7 x 5	200 litre	7
PAPERBARK/BOTTLEBRUSH 'FOREST'				
Callistemon salignus	White Bottlebrush	8 x 5	100 litre	55
Callistemon viminalis	Weeping Bottlebrush	8 x 5	100 litre	7
Melaleuca quinquenervia	Broad Leaved Paperbark	8 x 5	100 litre	16
EVERGREEN NATIVE TREES				
Backhousia myrtifolia	Cinnamon Myrtle	8 x 6	100 litre	26
Cupaniopsis ancardioides	Tuckeroo	5 x 4	45 litre	21
Elaeocarpus reticulatus	Blueberry Ash	5 x 4	45 litre	6
Hymenosporum flavum	Native frangipani	7 x 7	100 litre	11
Tristanopsis 'Luscious'	Water Gum	7 x 7	45 litre	46
SILVER FOLIAGED OLIVE GROVE				
Olea europea 'Swan Hill'	Olive	7 x 7	100 litre	17
MULCHED MASS PLANTING - SHRUBS				
Callistemon Scarlet Flame	Bottlebrush	1 x 1	200mm	717
Callistemon 'Macarthur'	Bottlebrush	1 x 1	200mm	717
Grevillea 'Crimson Villea'	Grevillea	1 x 1	200mm	717
Loropetalum 'China Pink'	Chinese Fringe Flower	1 x 1	200mm	80
Raphiolepis 'Cosmic Pink'	Indian Hawthorn	1 x 1	200mm	717
Westringia 'Grey Box'	Coastal Rosemary	1 x 1	200mm	717
GRASSES + CLUMPING PLANTS				
Doryanthes excelsa	Gynea Lily	1 x 1	150mm	31
Liriope 'Just Right'	Liriope	200 x 300	150mm	80
Lomandra longifolia	Lomandra	1 x 1	150mm	181
Lomandra 'Tanika'	Lomandra	600 x 600	150mm	3308



AMENDMENTS

REV	BY	DATE	DESCRIPTION
A	LH	19.10.17	ISSUED FOR SSD APPROVAL
B	LH	28.05.18	REISSUED FOR SSD APPROVAL
C	LH	12.08.22	REDUCTION IN POT SIZES
D	LH	22.01.23	AMEND MULCH AREA TO EAST OF STEPS STAGE 2A

NOTE: WORK TO FOLLOW DIMENSIONS, DO NOT SCALE FROM DRAWING, ANY DIMENSION DISCREPANCIES TO BE CLARIFIED WITH ARCHITECT. CONTRACTOR TO VERIFY SITE CONDITIONS PRIOR TO CONSTRUCTION AND REVIEW ANY DISCREPANCIES TO ARCHITECT. INCLUDE TO JARGON, ALL NECESSARY FOOTNOTES. ALL ASPECTS OF CONSTRUCTION TO COMPLY WITH BCA AND ALL RELEVANT AUSTRALIAN STANDARDS. DRAWINGS TO BE READ IN CONJUNCTION WITH THE TOTAL PACKAGE INCLUDING BUT NOT LIMITED TO ANY AUTHORITY COMMENTS AND COORDINATE SCA STATEMENTS, SECTIONS & SERVICE SPECIFICATION, FIXTURES & FINISHES SCHEDULE AND TENDER FORMS.

NSW Government Planning & Environment
 Issued under the Environmental Planning and Assessment Act 1979
 Approved Section: 4.55(1A) Application No: SSD-8378-Mod-2
 Granted on: 17th April 2023 Sheet no: 1 of 3 Signed: [Signature]

GEOTECHNICAL + ENVIRONMENTAL
 JK Geotechnics T: 02 9888 5000
ACOUSTIC
 Day Design Pty Ltd T: 02 9048 3800
BCA
 Group CLA Pty Ltd T: 02 9055 3160
CIVIL/HYDRAULIC/ STRUCTURAL/ TRAFFIC
 Woolacotts Consulting Engineers T: 02 9445 2900
PLANNER
 DFP Planning T: 02 9980 6933
SURVEYOR
 Franklin Engineering Surveys T: 02 9836 5248
 DDA du Chateau Chen T: 03 9006 2343
PERFORMAL PEDAVOLI ARCHITECTS
 DATE T: +61 2 9291 0000
 WEB: www.pp-a.com.au
 Nominated Architect: Vince Pedavoli NSW reg No. 5045
ELECTRICAL/COMMS/ SECURITY/ESD
 LIFT/MECHANICAL JHA Consulting Engineers T: 02 9437 1000
FIRE ENGINEER
 MCD Fire Engineering T: 0423 902 740

NSW Education

LORNA HARRISON LANDSCAPE ARCHITECTS
 68 Beattie Street BALMAIN NSW 2041
 M 0403350023
 E lorna@landarchitects.com

GLEDSDOOD HILLS PUBLIC SCHOOL
 HERMITAGE WAY GLEDSDOOD HILLS NSW 2557
 LANDSCAPE SITE PLAN

SCALE 1:500 @ A1
 28 May 2018
 DRAWING NUMBER: 554 DISCIPLINE: LAN DA SERIES NUMBER: 00_02 REVISION: D

PLOT DATE 25/1/23



AMENDMENTS

REV	BY	DATE	DESCRIPTION
A	LH	30.05.18	ISSUED FOR SSD APPROVAL
B	LH	22.01.23	AMENDED EXTENT OF MULCH EAST OF STAGE 2A

NOTE: WORK TO FOLLOW DIMENSIONS, DO NOT SCALE FROM DRAWING. ANY DIMENSION DISCREPANCIES TO BE CLARIFIED WITH ARCHITECT.
 CONTRACTOR TO VERIFY SITE CONDITIONS PRIOR TO CONSTRUCTION AND REPORT ANY DISCREPANCIES TO ARCHITECT.
 ALL ASPECTS OF CONSTRUCTION TO COMPLY WITH BCA AND ALL RELEVANT AUSTRALIAN STANDARDS.
 DRAWINGS TO BE READ IN CONJUNCTION WITH THE TOTAL PACKAGE INCLUDING BUT NOT LIMITED TO ANY AUTHORITY CONSENTS AND CONDITIONS, BCA STATEMENT, SECTION 8 DRAWING SPECIFICATION, FIXTURES & FINISHES SCHEDULE AND TENDER FORMS.

NSW GOVERNMENT
Planning & Environment
 Issued under the Environmental Planning and Assessment Act 1979
 Approved Section: 4.55(1A) Application No: SSD-8378-Med-2
 Granted on: 17th April 2023 Sheet no: 2 of 3 Signed: [Signature]

GEOTECHNICAL + ENVIRONMENTAL
 JK Geotechnics
 T: 02 9888 5000
ACOUSTIC
 Day Design Pty Ltd
 T: 02 9048 3800
BCA
 Group OLA Pty Ltd
 T: 02 9055 3160

CIVIL/HYDRAULIC/STRUCTURAL/TRAFFIC
 Woolacotts Consulting Engineers
 T: 02 8448 2900
PLANNER
 DFP Planning
 T: 02 9980 6933
SURVEYOR
 Frimham Engineering Surveys
 T: 02 9836 5248
DDA
 du Chateau Chan
 T: 03 9006 2343

PERFORMAL PEDAUVOLI ARCHITECTS
 DATE: 12/01/2023
 T: +61 2 9291 0000
 WEB: www.pp-a.com.au
 Nominated Architect:
 Vince Pedavoli NSW reg No. 5045
ELECTRICAL/COMMS/SECURITY/ESD
 UPTI MECHANICAL
 JHA Consulting Engineers
 T: 02 9437 1000
FIRE ENGINEER
 MCD Fire Engineering
 T: 0423 922 745

NSW GOVERNMENT Education

LORNA HARRISON
 LANDSCAPE ARCHITECTS
 68 Beattie Street
 BALMAIN
 NSW 2041
 M 0403350023
 E lorna@landarchitects.com

GLEDSDWOOD HILLS PUBLIC SCHOOL
 HERMITAGE WAY
 GLEDSDWOOD HILLS NSW 2557
 LANDSCAPE PLANTING PLAN SOUTH

SCALE 1:200 @ A1
 NOVEMBER 2017
 DRAWING NUMBER: 554
 DISCIPLINE: LAN
 PHASE: DA
 SERIES NUMBER: 00_04
 REVISION: B

PLOT DATE 25/1/23

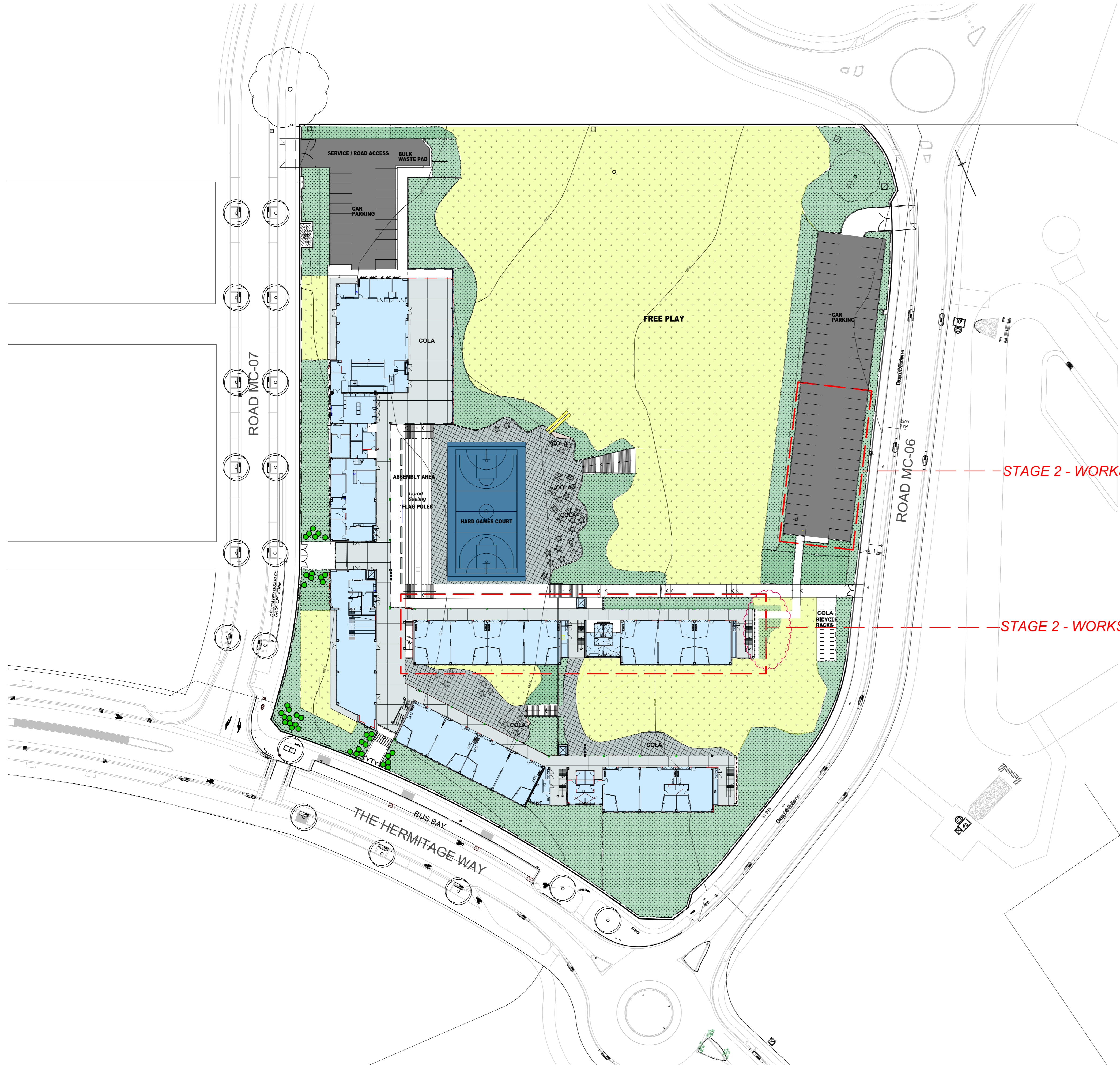

SURFACE LEGEND

-  CONCRETE PAVING TYPE 1
INTEGRATED COLOUR: LIGHT GREY
-  CONCRETE PAVING TYPE 2
INTEGRATED COLOUR: DARK GREY
-  CONCRETE PAVING TYPE 3
PAINTED COLOUR: BLUE
-  BITUMEN PAVING
-  MULCHED MASS PLANTED
GARDEN BEDS WITH
HARDWOOD EDGE
-  TURF

REV	BY	DATE	DESCRIPTION
A	LH	05.06.18	ISSUED FOR SSD APPROVAL
B	LH	22.10.19	SSD MOD
C	LH	25.01.23	AMENDED MULCHED ARE TO EAST OF STAGE 2

NOTE:
WORK TO DIMENSIONS, DO NOT SCALE FROM DRAWING. ANY DIMENSION DISCREPANCIES TO BE CLARIFIED WITH ARCHITECT.
CONTRACTOR TO VERIFY SITE CONDITIONS PRIOR TO CONSTRUCTION AND REPORT ANY DISCREPANCIES TO ARCHITECT.
BUILD TO STANDARD, ALL NECESSARY PROVISIONS.
ALL ASPECTS OF CONSTRUCTION TO COMPLY WITH BCA AND ALL RELEVANT AUSTRALIAN STANDARDS.
DRAWINGS TO BE READ IN CONJUNCTION WITH THE TOTAL PACKAGE INCLUDING BUT NOT LIMITED TO ANY AUTHORITY CONSENTS AND COORDINATE SCA STATEMENT, SECTION 8 SERVICES SPECIFICATION, FIXTURES & FINISHES SCHEDULE AND TENDER FORMS.

NSW Planning & Environment
 Issued under the Environmental Planning and Assessment Act 1979
 Approved Section: 4.55(1A) Application No: SSD-8378-Mod-2
 Granted on: 17th April 2023 Sheet no: 3 of 3 Signed: 

GEOTECHNICAL + ENVIRONMENTAL
 JK Geotechnics
 T: 02 9888 5000
 ACUSTIC
 Day Design Pty Ltd
 T: 02 9048 3800
 BCA
 Group CoLA Pty Ltd
 T: 02 9055 3160

CIVIL/HYDRAULIC/ STRUCTURAL/ TRAFFIC
 Woolcotts Consulting Engineers
 T: 02 8445 2900
 PLANNER
 DFP Planning
 T: 02 9980 6933
 SURVEYOR
 Frankham Engineering Surveys
 T: 02 9836 5248
 DDA
 du Chateau, Chen
 T: 03 9006 2243

PERFORMA PEDAVOLI ARCHITECTS
 T: +61 2 9291 0000
 WEB: www.pp-a.com.au
 Nominated Architect:
 Vince Pedavoli NSW reg No. 5045
 ELECTRICAL/COMMS/ SECURITY/ESD
 LFTI MECHANICAL
 JHA Consulting Engineers
 T: 02 9437 1000
 FIRE ENGINEER
 MCD Fire Engineering
 T: 0403 902 745



LORNA HARRISON
 LANDSCAPE ARCHITECTS
 68 Beattie Street
 BALMAIN
 NSW 2041
 M 0403350023
 E lorna@landarchitects.com

GLEDSDWOOD HILLS PUBLIC SCHOOL
 HERMITAGE WAY
 GLEDSDWOOD HILLS NSW 2557
 LANDSCAPE PAVING PLAN

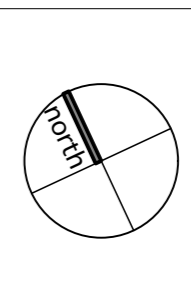

0m 10m 20m 30m 40m 50m			
SCALE 1:500 @ A1			
28 May 2018			
DRAWING NUMBER	DISCIPLINE	PHASE	SERIES NUMBER
554	LAN	DA	00_05
			REVISION
			C

NSW GOVERNMENT
Planning, Industry & Environment
 Issued under the Environmental Planning and Assessment Act 1979
 Approved Section: 4.55(1A) Application No: SSD-8378-Mod-1
 Granted on the: 9 Dec 2019 Signed: *[Signature]*
 Sheet No: 7 of 8

SERVICE / ROAD ACCESS

BULK WASTE PAD

MULCHED MASS PLANTED GARDEN BED:
 800 Lomandra 'Tanika'
 @4/m²

CAR PARKING

DECIDUOUS CANOPY TREES TO WESTERN BOUNDARY
 7 Pistacia chinensis PC

MULCHED MASS PLANTED GARDEN BED:
 1256 Lomandra 'Tanika'
 @4/m²

COLA

EVERGREEN CANOPY TREE PLANTING
 8 Cv
 29 CS
 12 Hf
 14 H Mq
 10 OSH

MULCHED MASS PLANTED GARDEN BED:
 150 Callistemon 'Scarlet Flame'
 150 Callistemon 'Macarthur'
 150 Grevillea 'Crimson Villea'
 150 Raphiolepis 'Cosmic Pink'
 150 Westringia 'Grey Box'
 ALL PLANTS AT 1/M² SPACINGS IN LOOSE RANDOM DRIFTS OF MIN 9 MAX 15 PER SPECIES

FREE PLAY

EVERGREEN CANOPY TREE PLANTING
 14 Ca
 3 Erv
 6 TL

MULCHED MASS PLANTED GARDEN BED:
 180 Callistemon 'Scarlet Flame'
 180 Callistemon 'Macarthur'
 180 Grevillea 'Crimson Villea'
 180 Raphiolepis 'Cosmic Pink'
 180 Westringia 'Grey Box'
 ALL PLANTS AT 1/M² SPACINGS IN LOOSE RANDOM DRIFTS OF MIN 9 MAX 15 PER SPECIES

EVERGREEN CANOPY TREE PLANTING
 7 Ca
 3 Er
 5 TL
 with understorey planting in mulched garden bed of:-
 181 Lomandra longifolia @1/m²

MULCHED MASS PLANTED GARDEN BED:
 62 Callistemon 'Scarlet Flame'
 62 Callistemon 'Macarthur'
 62 Grevillea 'Crimson Villea'
 62 Raphiolepis 'Cosmic Pink'
 62 Westringia 'Grey Box'
 ALL PLANTS AT 1/M² SPACINGS IN LOOSE RANDOM DRIFTS OF MIN 9 MAX 15 PER SPECIES

ASSEMBLY AREA

FLAG POLES

HARD GAMES COURT

H 10 Sapium sebiferum SB.

CAR PARKING

ROAD MC-06

PLOT DATE 22/10/19

REV	BY	DATE	DESCRIPTION
A	LH	30.05.18	ISSUED FOR SSD APPROVAL
B	LH	22.10.19	SSD MOD 1

NOTE:
 WORK TO FIGURED DIMENSIONS DO NOT SCALE FROM DRAWING ANY DIMENSION DISCREPANCIES TO BE CLARIFIED WITH ARCHITECT.
 CONTRACTOR TO VERIFY SITE CONDITIONS PRIOR TO CONSTRUCTION AND REPORT ANY DISCREPANCIES TO ARCHITECT.
 ALL ASPECTS OF CONSTRUCTION TO COMPLY WITH BCA AND ALL RELEVANT AUSTRALIAN STANDARDS.
 DRAWINGS TO BE READ IN CONJUNCTION WITH THE TOTAL PACKAGE INCLUDING BUT NOT LIMITED TO ANY AUTHORITY CONSENTS AND CONDITIONS BCA STATEMENTS, SPECIFICATIONS, SCHEDULES, SPECIFICATION, FIXTURES & FINISHES SCHEDULE AND TENDER FORMS.

GEOTECHNICAL / ENVIRONMENTAL / CIVIL / PHYSICAL / LANDSCAPE ARCHITECTS
 JK Geotechnics T: 02 9888 5000
 WOODSCOTTS CONSULTING ENGINEERS T: 02 9448 2900
 PLANNER DFP Planning T: 02 9980 6933

BCA Group CL&A Pty Ltd T: 02 9555 3160
 SURVEYOR Frankham Engineering Surveys T: 02 9636 5248
 DDA du Chateau Chan T: 03 9006 2243

PERFORMA PEDILOTTI ARCHITECTS T: +61 2 9291 0000
 WEB: www.pp-a.com.au
 Nominated Architect: NSW 2041
 Vice President NSW reg No. 5045

ELECTRICAL/COMMS/SECURITY/ESD/ LIFT/MECHANICAL/PLA CONSULTING ENGINEERS T: 02 9437 1000
 FIRE ENGINEER MCD Fire Engineering T: 0423 922 740

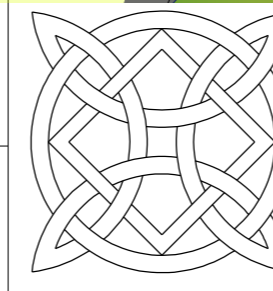

LORNA HARRISON LANDSCAPE ARCHITECTS
 68 Beattie Street BALMAIN NSW 2041
 M 0403350023
 E lorna@landarchitects.com

GLEDSDWOOD HILLS PUBLIC SCHOOL
 HERMITAGE WAY GLEDSDWOOD HILLS NSW 2557
LANDSCAPE PLANTING PLAN NORTH

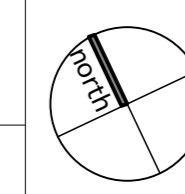

SCALE 1:200 @ A1

21 MARCH 2019

DRAWING NUMBER	DISCIPLINE	PHASE	SERIES NUMBER	REVISION
554	LAN	DA	00_03	B