



Entry to Galungara Public School

Galungara Public School

Project update

November 2022

Investing in our schools

The NSW Government is investing \$8.6 billion in school infrastructure over the next four years, continuing its program to deliver 160 new and upgraded schools to support communities across NSW. This builds on the more than \$9.1 billion invested in projects delivered since 2017, a program of \$17.7 billion in public education infrastructure.

The NSW Department of Education is committed to delivering new and upgraded schools for communities across NSW. The delivery of these important projects is essential to the future learning needs of our students and supports growth in the local economy.

Stage 2 for Galungara Public School

Construction on Stage 2 of the Galungara Public School began in March 2022. The school was planned and designed to be constructed in stages. Stage 2 is now progressing and will provide additional capacity to meet the need of the growing local community. Stage 2 includes:

- 20 new learning spaces
- three additional covered outdoor learning areas
- landscaping works.

For more information contact:

School Infrastructure NSW
Email: schoolinfrastructure@det.nsw.edu.au
Phone: 1300 482 651
www.schoolinfrastructure.nsw.gov.au

Progress summary

Work continues on Block B3 (8 learning spaces) and Block B4 (12 learning spaces), with internal works currently underway. External landscaping works are progressing to schedule. COLA construction and the covered walkway are now completed. See below site map which provides a visual outline of the Galungara Public School Stage 2 works.

A revised School Travel Plan has also been prepared incorporating a relocated pedestrian crossing on Farmland Drive, a proposed pedestrian crossing and refuse on Jerralong Drive, together with additional traffic signage on Farmland Drive, to manage the increased enrolments for Day 1 Term 1 2023.

Next steps

The next steps for Stage 2 of the Galungara Public School include:

- landscaping around the learning buildings (Block B3 and Block B4)
- the commissioning and handover process with the school leadership and staff.

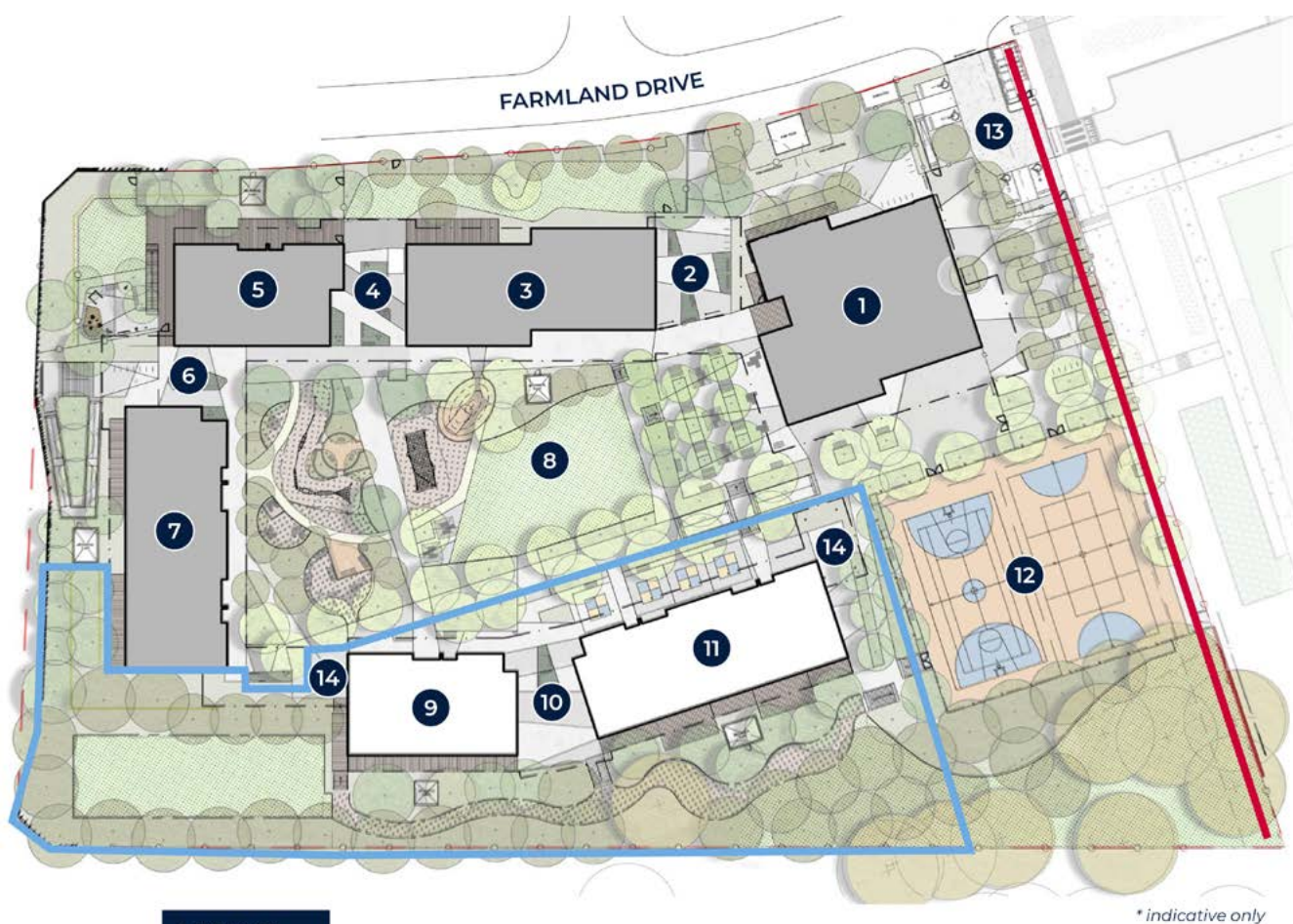

LEGEND			
Stage 2 works	Library and Administration	Building B2	Building B4
Easement A	COLA	Playground	Multipurpose court
Hall and OHSC	Building B1	Building B3	Special needs drop-off
Entry COLA	COLA	COLA	COLA

For more information contact:

School Infrastructure NSW
 Email: schoolinfrastructure@det.nsw.edu.au
 Phone: 1300 482 651
www.schoolinfrastructure.nsw.gov.au

