

# Galungara Public School Stage 2

## Works notification

7 March 2022

### Stage 2 Works Commencement

Site establishment has commenced for construction of Stage 2 of Galungara Public School, with construction to start on 14 March 2022.

Stage 2 will include:

- 20 new learning spaces
- Two additional covered outdoor learning areas
- Two new multipurpose games courts
- Landscaping works.

The first phase of Stage 2 works will include Buildings B3, B4 and associated stairs and external works (see map overleaf).

These works will take place between 7 am and 6 pm, Monday to Friday and 8 am to 1 pm on Saturdays.

Site signage is in place and hoarding will be put up to minimise noise and ensure the safety of the local community.

There will be no work zones in place for this project. Works will be conducted from the confines of the site during construction.

We will continue to work with the contractor, Richard Crookes Constructions, to ensure any disruption to our neighbours is kept to a minimum.

School Infrastructure NSW is also working closely with the principal and staff to ensure that school operations continue with minimal disruption. This includes, to prevent disruption to school operations and activities, site deliveries being scheduled with consideration for school drop off and pick up times, and traffic control personnel are on site to assist with contractor deliveries.

For further information see the February 2022 Project Update on the School Infrastructure NSW project webpage.

We will provide further updates as the project progresses.

For more information please contact School Infrastructure NSW using the details below.

---

### For more information contact:

School Infrastructure NSW  
Email: [schoolinfrastructure@det.nsw.edu.au](mailto:schoolinfrastructure@det.nsw.edu.au)  
Phone: 1300 482 651  
[www.schoolinfrastructure.nsw.gov.au](http://www.schoolinfrastructure.nsw.gov.au)

Site plan

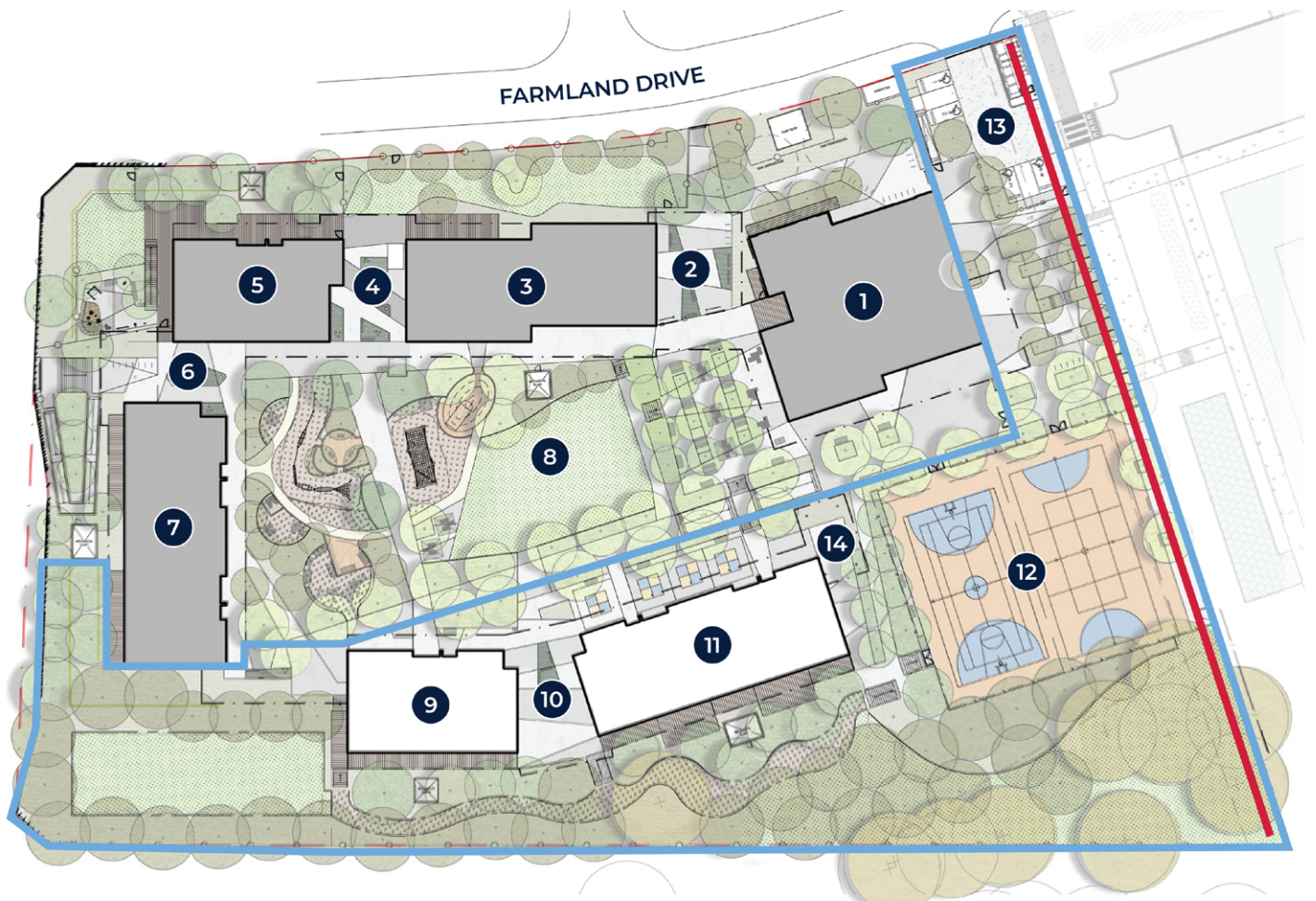

\* indicative only

LEGEND			
Stage 2 works	Library and Administration	Building B2	Building B4
Easement A	COLA	Playground	Multipurpose court
Hall and OHSC	Building B1	Building B3	Special needs drop-off
Entry COLA	COLA	COLA	COLA

For more information contact:

School Infrastructure NSW  
 Email: [schoolinfrastructure@det.nsw.edu.au](mailto:schoolinfrastructure@det.nsw.edu.au)  
 Phone: 1300 482 651  
[www.schoolinfrastructure.nsw.gov.au](http://www.schoolinfrastructure.nsw.gov.au)