

# Galungara Public School Stage 2

Information pack | March 2022



School entry at Galungara Public School

The NSW Government is investing \$7.9 billion over the next four years, continuing its program to deliver 215 new and upgraded schools to support communities across NSW. This is the largest investment in public education infrastructure in the history of NSW.

The NSW Department of Education is committed to delivering new and upgraded schools for communities across NSW. The delivery of these important projects is essential to the future learning needs of our students and supports growth in the local economy.

Galungara Public School was planned and designed to be constructed in stages and Stage 2 will include:



20 new learning spaces



Two additional covered outdoor learning areas



Two new multipurpose games courts



Landscaping works

# Progress summary

Construction of Stage 2 of the Galungara Public School has now commenced. This will provide additional accommodation to meet the need of the growing local community. The school was planned and designed to be constructed in stages and Stage 2 will include:

- 20 new learning spaces
- Two additional covered outdoor learning areas
- Two new multipurpose games courts
- Landscaping works.

## Project timeline

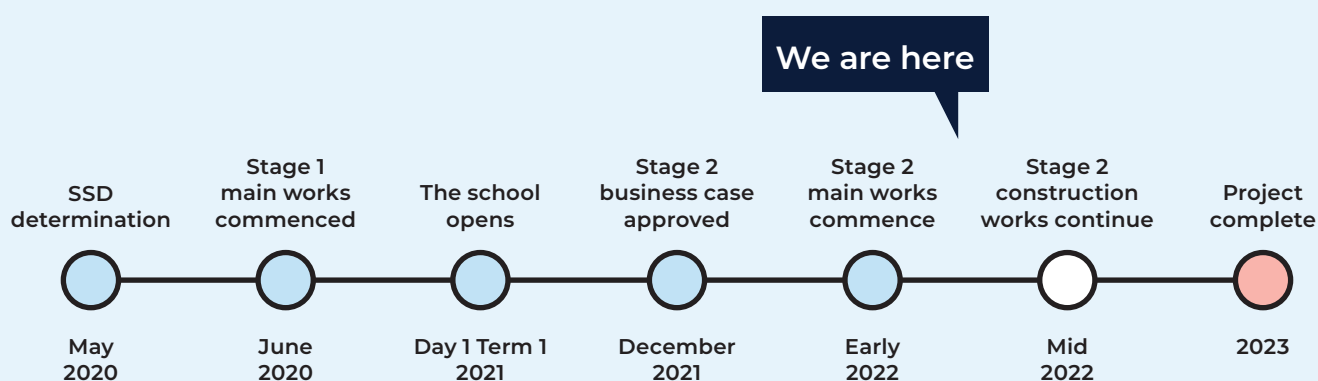

Artist impression of Stage 2 of the Galungara Public School. Indicative only.

# Frequently asked questions

---

## **When will main construction works start?**

The construction commences in mid March 2022. Work hours are 7 am to 6 pm, Monday to Friday and 8 am to 1 pm on Saturdays. There will be no work on Sundays or public holidays.

## **When will construction be complete?**

The construction is scheduled to be completed in 2023.

## **What steps will be taken to control noise and dust impacts?**

The contractor will continue to implement dust and noise control measures. Dust and noise are minimised with hoarding, shade cloth and spraying water.

## **Will there be any road or lane closures?**

The works will not require any road or lane closures.

## **What considerations are there for pedestrians and cyclists?**

All works will take into consideration pedestrians and cyclists. Advanced warning signage will be in place to warn pedestrians of the entry and exiting of vehicles to and from the site.

Only authorised personnel will be permitted within the building site unless accompanied by site management (1.8m chain wire fencing will surround the perimeter), if not inducted to the site. Whilst within the confines of the building site, all personnel will attire in correct PPE to ensure that they are visible to moving traffic.

No change to the footpaths or bike paths will be made, pedestrians and cyclists will follow the pathways as normal. Certified traffic controllers will be on site during times of vehicular movements and heavy loading.

## **How will traffic be managed?**

Traffic management will be in place where required for the safety of the local community and workers. Traffic controllers will be used to manage the entry and exit of vehicles to and from the construction site as necessary. Vehicles will give way to pedestrians at all times.

Traffic controllers will be positioned at the intersection of Farmland Drive and the vehicle entry to the Stage 2 school construction and Easement A to manage the pedestrian and vehicle movements during construction hours. Easement A will be used as a temporary right of access and easement for services.

## **Will street parking be impacted during construction?**

Street parking impacts will be minimised where possible. Contractors are encouraged to carpool and parking will be made available on site for construction vehicles. We will work with local communities to identify issues and put in place measures to mitigate the effects.

## **What are some of the plans to minimise disruption to the local community?**

During each stage of work the disruption to residents will be minimised by using routes which aim to reduce travel distance through residential areas as well as eliminating movements through shopping and significant public areas. Disruption to neighbours will be minimised by using pre-arranged arrival times for construction vehicles, ensuring no construction vehicles are illegally parked on Council/Transport for NSW roads and by conducting a letterbox drop to affected neighbours if any out of hours or disruptive works are required.

## **Will utility services be interrupted as part of the construction?**

School Infrastructure NSW coordinates upgrades or new supplies of utility services with local providers to minimise disruption. In the event of a disruption to services in the local area, we will notify businesses and residents in advance.

## **What is the use of the Council carpark?**

The school uses the Council's shared use carpark in Farmland Drive as the pick-up/drop-off zone as well as for staff parking. Access from the carpark to the school is from the internal footpath of the joint use car park, and then across the street footpaths at the north-east corner of the project and directly into the main entry to school along Farmland Drive.



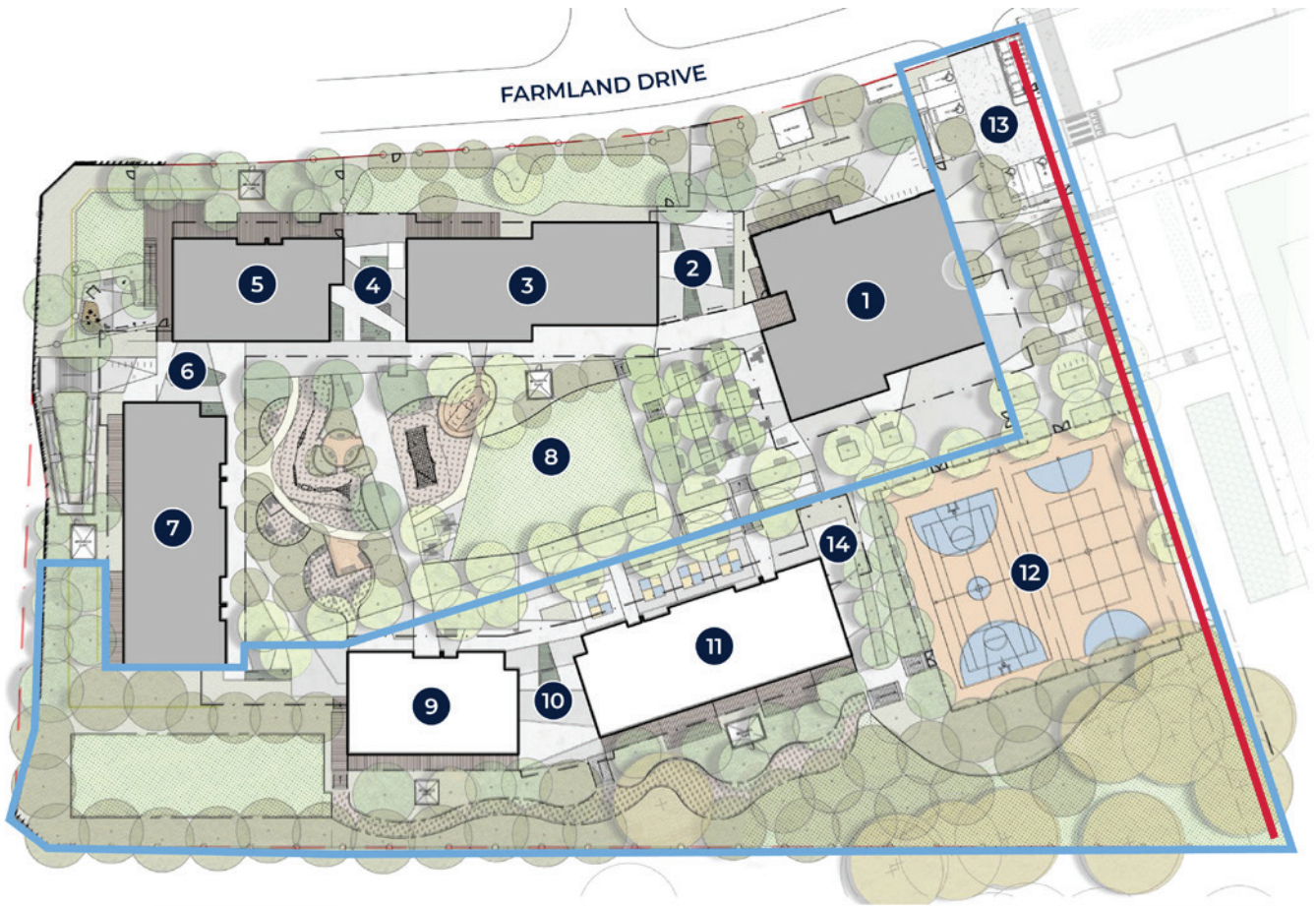

\* indicative only

LEGEND			
Stage 2 works	Library and Administration	Building B2	Building B4
Easement A	COLA	Playground	Multipurpose court
Hall and OHSC	Building B1	Building B3	Special needs drop-off
Entry COLA	COLA	COLA	COLA

Site map of Galungara Public School with the Stage 2 works now under construction

## Next steps

Works are anticipated to be complete in 2023. We will continue to work with the contractor, Richard Crookes Construction, to ensure any disruption to our neighbors is kept to a minimum.

We will provide information through information sessions, project updates and the [project website](https://www.schoolinfrastructure.nsw.gov.au/project-website) at [edu.nsw.gov.au/link/blJJzi](https://www.edu.nsw.gov.au/link/blJJzi).



## Stay informed



**Website**  
Stay up to date by visiting the School Infrastructure NSW website [schoolinfrastructure.nsw.gov.au](https://www.schoolinfrastructure.nsw.gov.au)



**Email**  
Contact the Community Engagement team by emailing [schoolinfrastructure@det.nsw.edu.au](mailto:schoolinfrastructure@det.nsw.edu.au)



**Phone**  
Contact us between 9:00am and 5:00pm, Monday to Friday on **1300 482 651**